



Oliver Stedman Government Center
4808 Tower Hill Road; Suite 116
Wakefield, RI 02879
401-783-3370

PUBLIC NOTICE

File Number: 1992-01-023 (MODIFICATION) Date: May 10, 2013

This office has under consideration the application of:

John M. and Jeanne M. Blasberg
28 Chestnut Street
Boston, MA 02108

for a State of Rhode Island Assent to modify an existing residential boating facility with a new ramp and float extending 50 feet beyond mean low water and five new tie-off piles extending up to 78 feet beyond mean low water.

Project Location:	19 Breen Road
City/Town:	Westerly
Plat/Lot:	172 / 17
Waterway:	Pawcatuck River

Plans of the proposed work may be seen at the CRMC office in Wakefield.

In accordance with the Administrative Procedures Act (Chapter 42-35 of the Rhode Island General Laws) you may request a hearing on this matter.

You are advised that if you have good reason to enter protests against the proposed work it is your privilege to do so. It is expected that objectors will review the application and plans thoroughly, visit site of proposed work if necessary, to familiarize themselves with the conditions and cite what law or laws, if any, would in their opinion be violated by the work proposed.

If you desire to protest, you must attend the scheduled hearing and give sworn testimony. A notice of the time and place of such hearing will be furnished you as soon as possible after receipt of your request for hearing. If you desire to request a hearing, to receive consideration, it should be in writing (**with your correct mailing address, e-mail address and valid contact number**) and be received at this office on or before June 10, 2013.

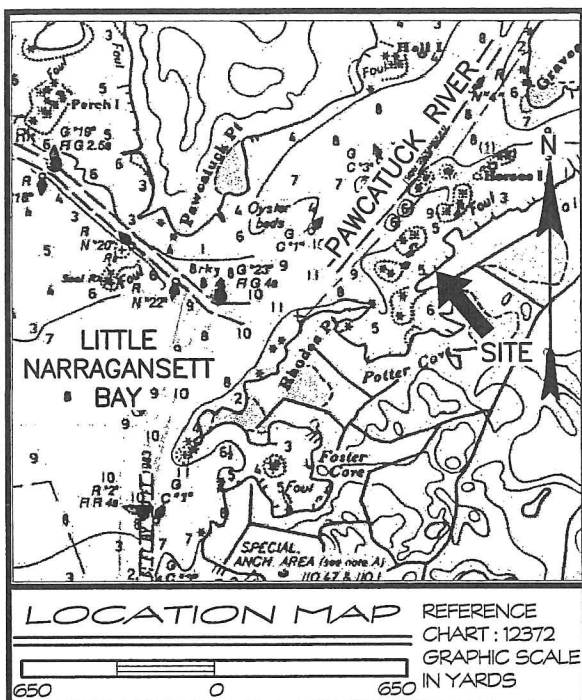

NOTES:

1. ELEVATION DATUM IS MLW.
2. TIDE DATA IS TAKEN FROM 2013 NOAA TIDE TABLES REFERENCE: NEW LONDON WATCH HILL.

3. PROJECT DESCRIPTION:

ASSENT MODIFICATION TO INSTALL A NEW 10-FT WIDE X 15-FT FLOAT WITH ASSOCIATED RAMP, RESTRAINT PILES AND FIVE TIE-OFF PILES ALSO INSTALL NEW RAILS WITH SUPPORT POSTS AND A ELECTRIC/WATER UTILITY POST ON THE EXISTING PIER, ALL WATERWARD OF THE HIGH TIDE LINE.

4. PROJECT PURPOSE:

THIS IS A PREVIOUSLY PERMITTED PRIVATE DOCK USED FOR RECREATIONAL BOATING.

5. THESE APPLICATION DRAWINGS REPRESENT A COMPILATION OF SURVEYS FOR ENVIRONMENTAL PERMIT PURPOSES. THEY ARE NOT CONSTRUCTION CONTRACT DOCUMENTS. A TOWN BUILDING PERMIT MAY BE REQUIRED.

6. ADJOINING PROPERTY OWNERS:

NORTHEAST:

ROBERT C. & ELLEN M. MURRAY
32 NORTH BROOK ROAD
IRVINGTON, NY 10533

SOUTHEAST:

DEBORAH T. SLOAN TRUST
c/o BRUNO KOSHELEFF TRUSTEE
KEENE, NH 03431

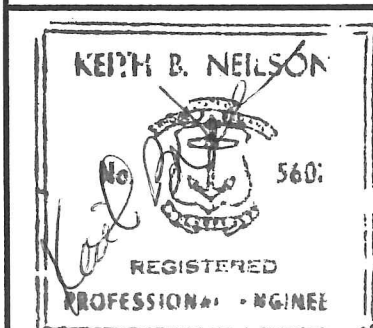
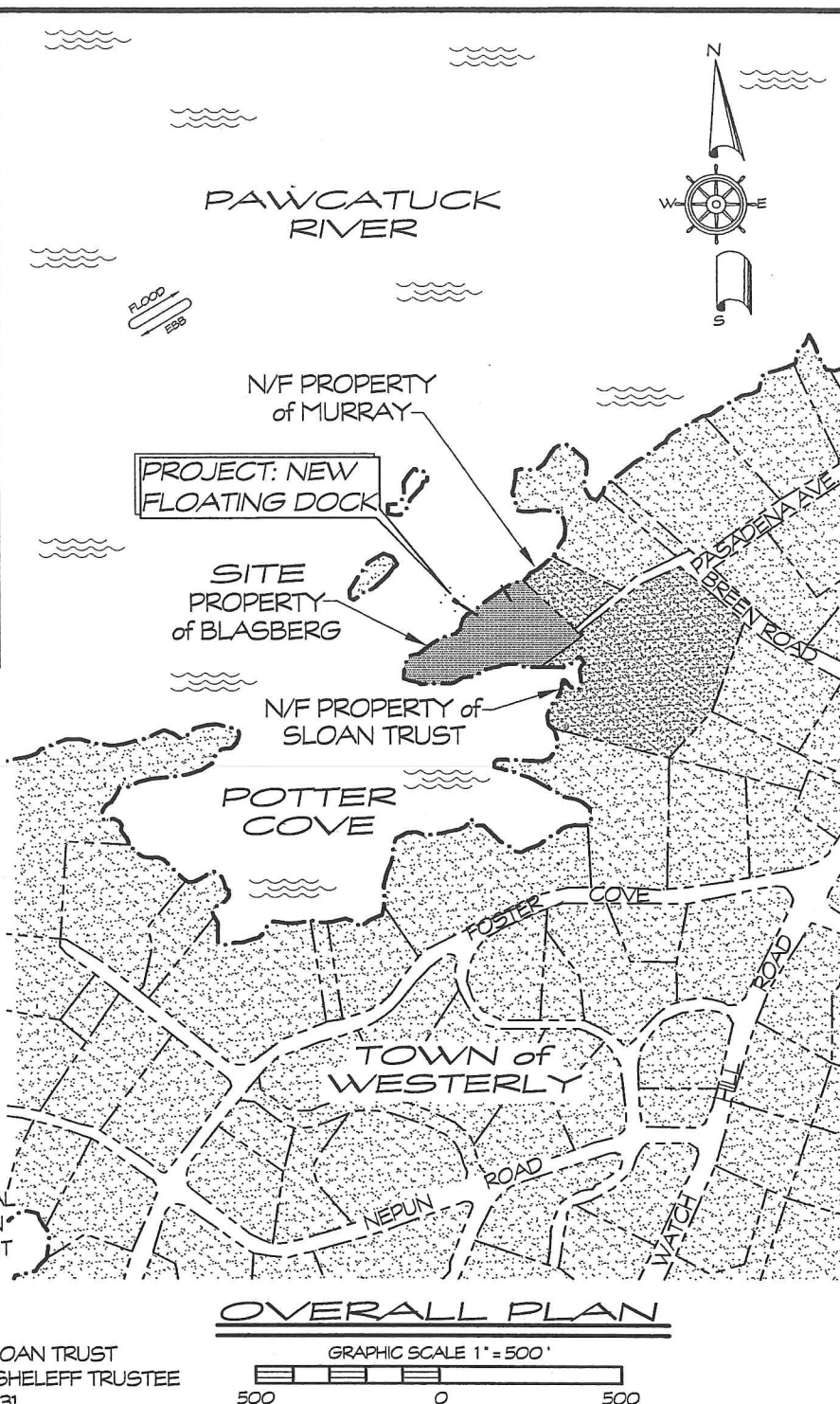

PROJECT: FLOAT MODIFICATIONS
ASSENT A92-1-23 MODIFICATION
LOCATION: TOWN of WESTERLY
WASHINGTON COUNTY, RI
WATERWAY: PAWCATUCK RIVER
DATE: FEBRUARY 6, 2013
APPLICANT: JOHN BLASBERG

AGENT: SHEET 1 OF 4
DOCKO, INC.

Keith B. Neilson, PE
Mystic, CT 06355
860 572 8939 FAX 860 572 7569
EMAIL: permits@docko.com



DWG 12-09-2442

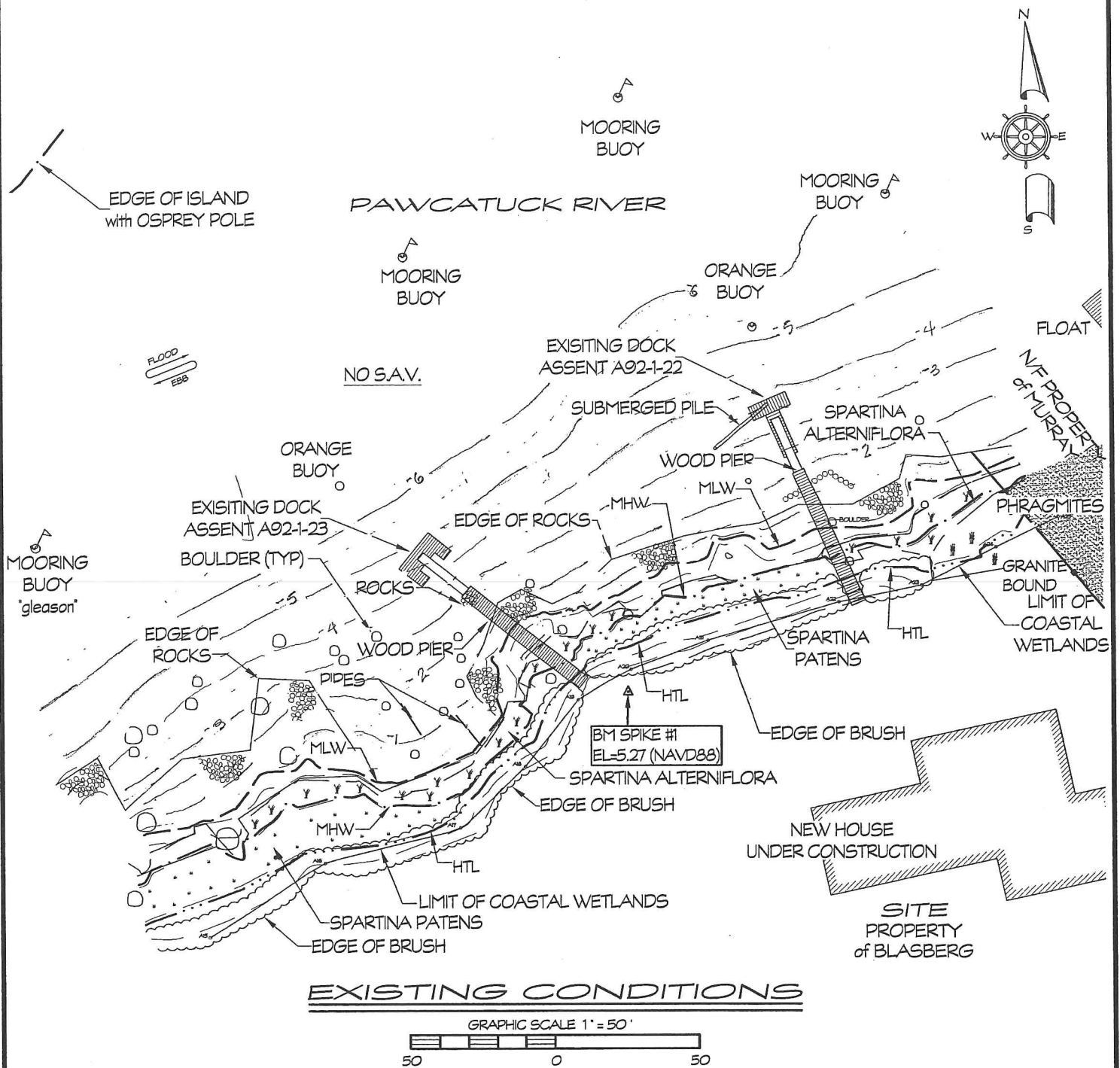

SURVEY by James Bernardo Land Surveying
Elevations are based on Mean Low Water (MLW)

PROJECT: FLOAT MODIFICATIONS
ASSENT A92-1-23 MODIFICATION
LOCATION: TOWN of WESTERLY
WASHINGTON COUNTY, RI
WATERWAY: PAWCATUCK RIVER
DATE: FEBRUARY 6, 2013
APPLICANT: JOHN BLASBERG

AGENT: SHEET 2 OF 4

DOCKO, INC.

Keith B. Nelson, PE
Mystic, CT 06355
860 572 8939 FAX 860 572 7569
EMAIL: permits@docko.com



DWG 12-09-2442

KEITH B. NELSON

No. 5601

REGISTERED
PROFESSIONAL ENGINEER

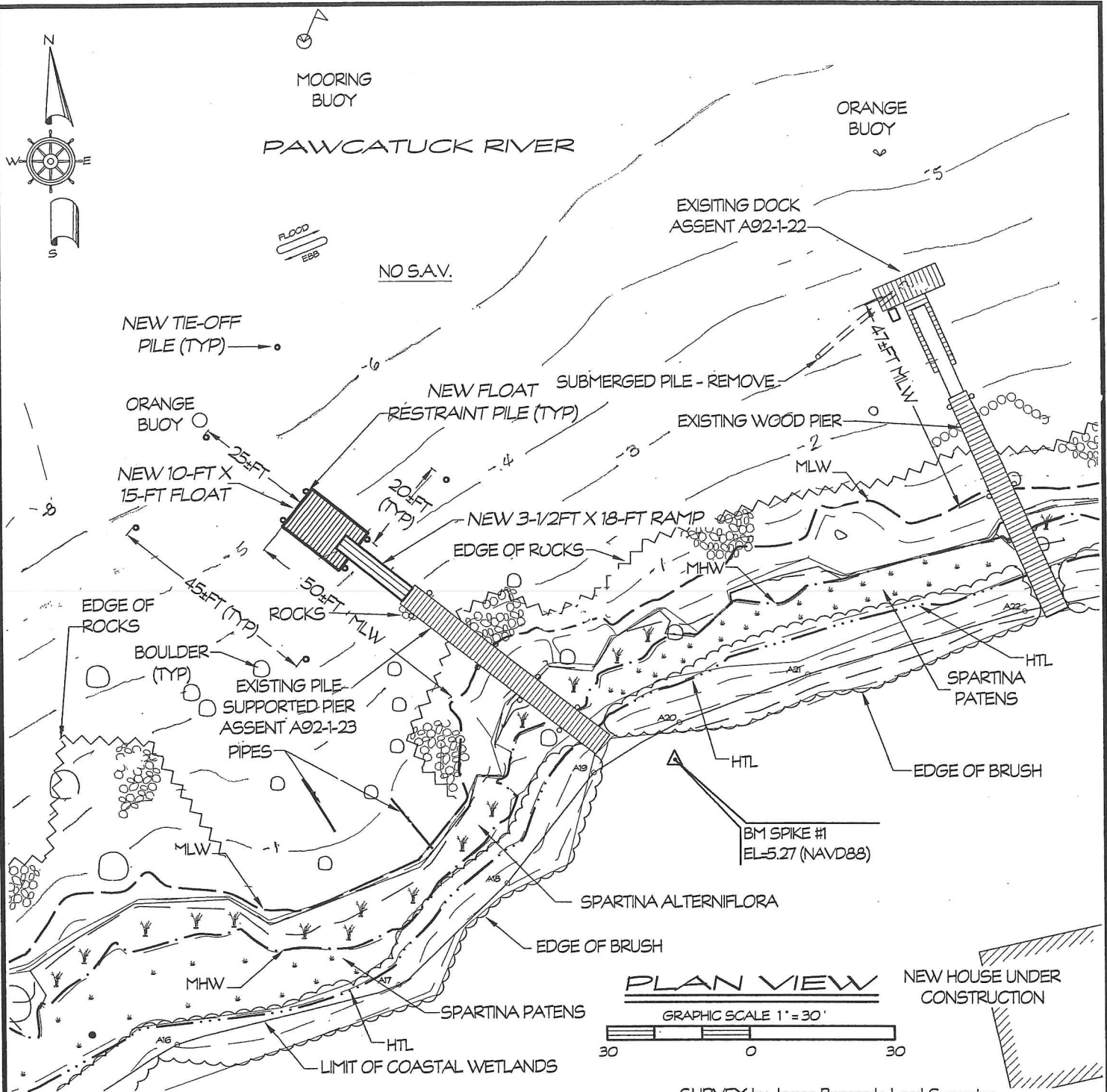

SURVEY by James Bernardo Land Surveying
Elevations are based on Mean Low Water (MLW)

PROJECT: FLOAT MODIFICATIONS
ASSENT A92-1-23 MODIFICATION
LOCATION: TOWN of WESTERLY
WASHINGTON COUNTY, RI
WATERWAY: PAWCATUCK RIVER
DATE: FEBRUARY 6, 2013
APPLICANT: JOHN BLASBERG

AGENT: SHEET 3 OF 4
DOCKO, INC.
Keith B. Nelson, PE
Mystic, CT 06355
860 572 8939 FAX 860 572 7569
EMAIL: permits@docko.com



DWG 12-09-2442

KEITH B. NELSON

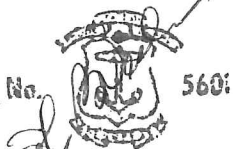

REGISTERED
PROFESSIONAL ENGINEER



MATERIAL SPECIFICATIONS RHODE ISLAND CRMC APPLICATIONS

DESIGN LIVE LOADS FOR FIXED PIER IS 40PSF MINIMUM IAW CRMC STANDARDS AND 25 PSF FOR FLOATS

WOOD SPECIFICATIONS:

PILES SHALL BE DRIVEN NOT VIBRATED TO MINIMUM 10-FT EMBEDMENT IN BEARING STRATUM. PILES SHALL BE 12-INCH BUTT OR CLASS 'B' AS APPROPRIATE FOR BOAT SIZE AND SEA CONDITIONS. WOOD SHALL BE GREENHEART, OAK, HICKORY OR AT OWNERS PREFERENCE, SOUTHERN PINE PRESSURE-TREATED. TIMBERS FOR SUPPORT AND BRACING SHALL BE GREENHEART, OAK, CLEAR CEDAR, HICKORY OR AT OWNERS PREFERENCE SOUTHERN PINE PRESSURE-TREATED.

BRACING AND SPLIT CLAMPS: 3X10 MINIMUM FOR SPANS OF 6FT OR LESS

DECK STRINGERS: 3X8 AT 16-INCH CENTERS OR 3X10 AT 24-INCH CENTERS AT BENT INTERVALS OF 10 FEET

DECKING: OAK OR CEDAR 2X6 MINIMUM FOR STRINGERS AT 16-INCH CENTERS, 2X8 MINIMUM FOR STRINGERS AT 24-INCH CENTERS. PAU LOPE DECKING MAY BE 5/4 X 6 STOCK AT 24-INCH STRINGER INTERVALS

RAILING: 2X6 OAK, CEDAR OR DOUGLAS FIR OR 5/4 X 6 PAU LOPE

NOTE OAK SHOULD BE COATED WITH WATERPROOFING

BOLTS:

3/4" INCH MINIMUM W/ WASHERS, HOT DIP (AMERICAN) GALVANIZED (2oz/SF)

NAILS AND SPIKES:

HEAVY DUTY (AMERICAN) GALVANIZED CONNECTIONS PER ANSI/NFPA INDS - 1991 NATIONAL DESIGN SPECIFICATIONS, LATEST EDITION. SCREWS WILL BE STAINLESS STEEL

FLOATATION:

CLOSED CELL EXPANDED POLYSTYRENE(EPS) FOAM BILLETS OR POLYETHYLENE ENCASED EXPANDED POLYSTYRENE FLOATATION UNITS, MINIMUM 12-INCHES HIGH AND INSTALLED CONTINUOUSLY BENEATH FLOAT FRAME

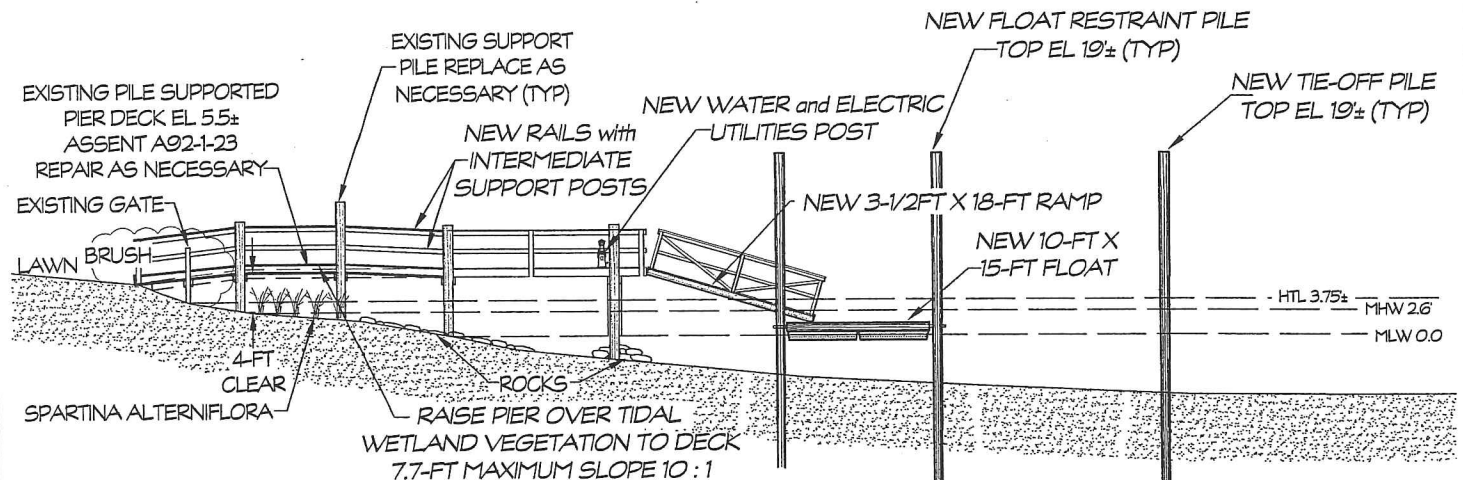
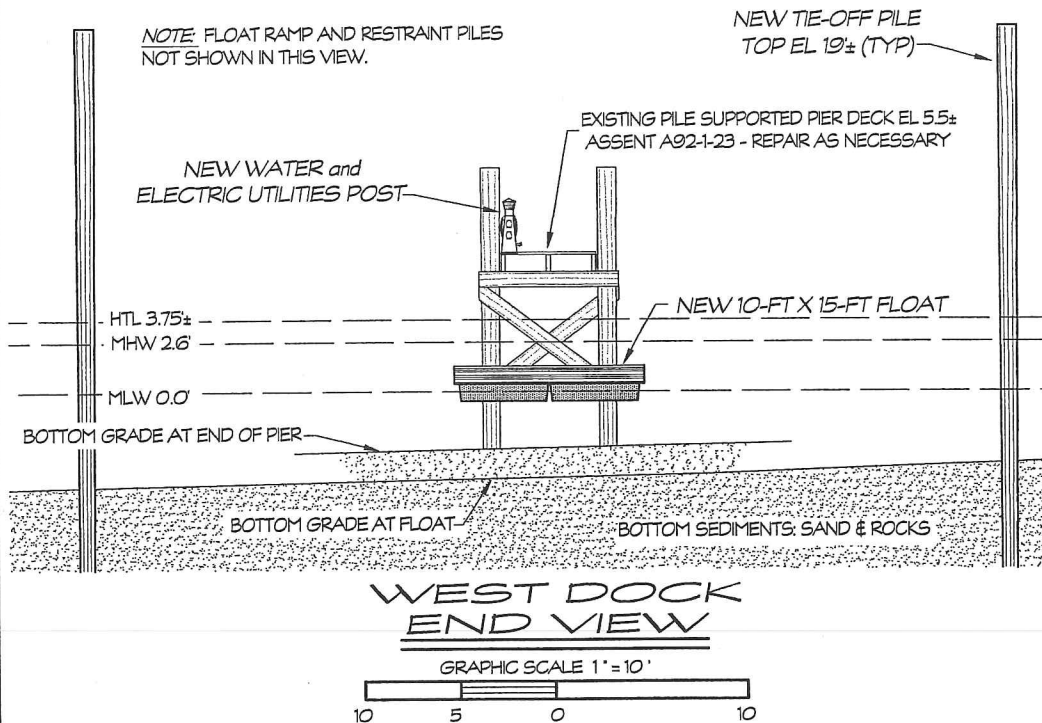

Elevations are based on NAVD '88

WEST DOCK PROFILE



PROJECT: FLOAT MODIFICATIONS
ASSENT A92-1-23 MODIFICATION

LOCATION: TOWN of WESTERLY
WASHINGTON COUNTY, RI

WATERWAY: PAWCATUCK RIVER

DATE: FEBRUARY 6, 2013

APPLICANT: JOHN BLASBERG

AGENT: SHEET 4 OF 4

DOCKO, INC.

Keith B. Neilson, PE

Mystic, CT 06355

860 572 8939 FAX 860 572 7569

EMAIL: permits@docko.com



DWG 12-09-2442

KEITH B. NELSON

No.

5601

REGISTERED

PROFESSIONAL ENGINEER

RECEIVED

APR 10 2013

CRMC