

STATE OF RHODE ISLAND AND PROVIDENCE PLANTATIONS  
COASTAL RESOURCES MANAGEMENT COUNCIL

Oliver Stedman Government Center  
4808 Tower Hill Road, Wakefield, RI 02879

PUBLIC NOTICE

Modification 1994-09-084

Date: May 2, 2008

File Number: \_\_\_\_\_

This office has under consideration the application of:

Douglas W Hollenbeck and Susan L Lloyd  
37 Avondale Road  
Westerly, RI 02891

for a State of Rhode Island Assent to : Modify CRMC Assent 1994-09-084, ramp and float will be relocated 16' inboard along fixed pier. Relocate tie-off piles from 15' to 24' parallel to fixed pier. Relocate tie-off pile inboard of float 15' landward of permitted float location and set new tie-off piles 16' seaward of permitted float location.

Project Location:	37 Avondale Road
City/Town:	Westerly
Plat/Lot:	136 / 1
Waterway:	Pawcatuck River

Plans of the proposed work may be seen at the CRMC office in Wakefield.

In accordance with the Administrative Procedures Act (Chapter 42-35 of the Rhode Island General Laws) you may request a hearing on this matter.

You are advised that if you have good reason to enter protests against the proposed work it is your privilege to do so. It is expected that objectors will review the application and plans thoroughly, visit site of proposed work if necessary, to familiarize themselves with the conditions and cite what law or laws, if any, would in their opinion be violated by the work proposed.

If you desire to protest, you must attend the scheduled hearing and give sworn testimony. A notice of the time and place of such hearing will be furnished you as soon as possible after receipt of your request for hearing. If you desire to request a hearing, to receive consideration, it should be in writing and be received at this office on or before June 1, 2008.

RECEIVED

APR 07 2008

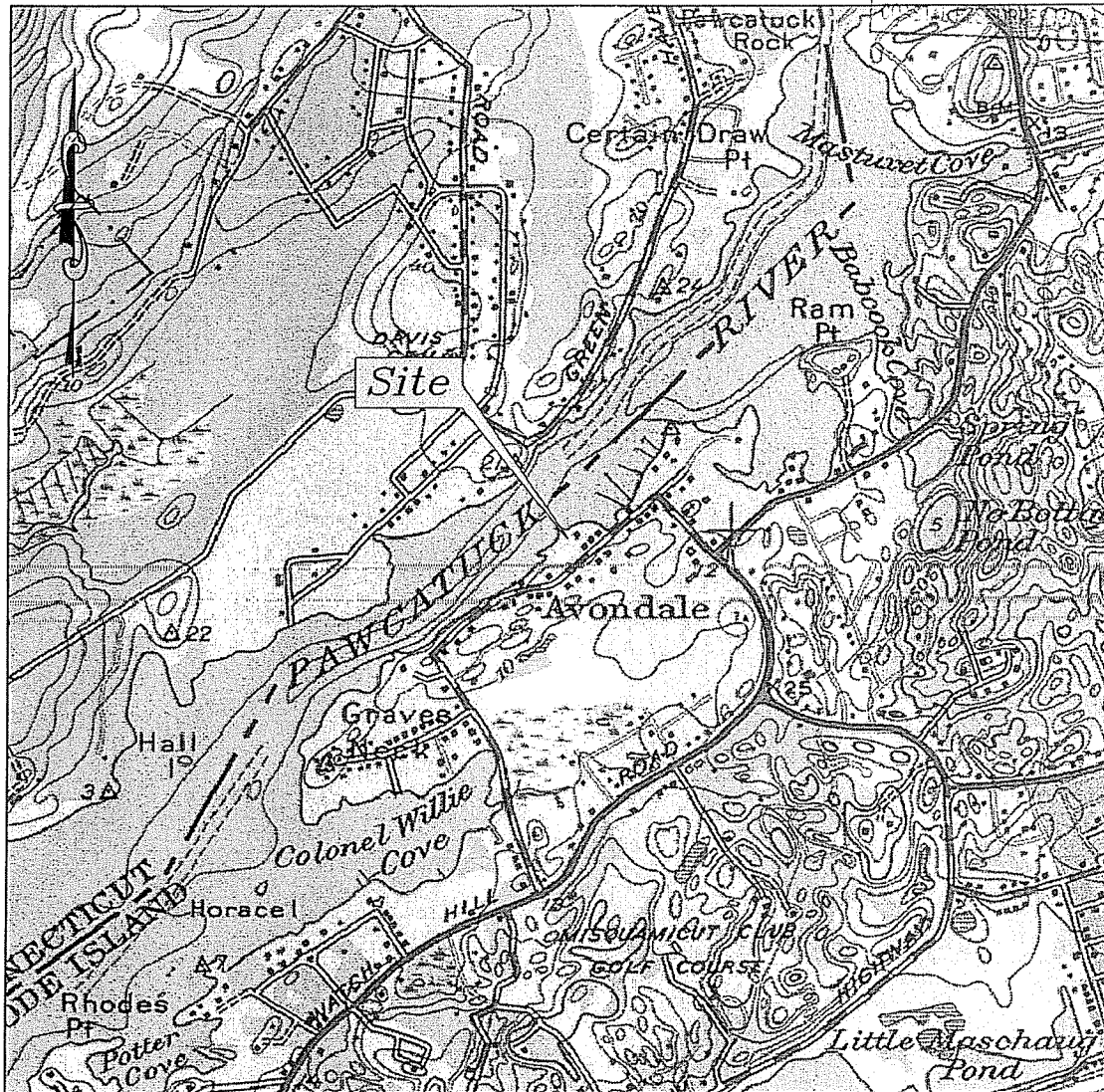

Locus Map

Note: Original approved plans dated 6/11/07, revised through 6/22/07

Dock Modification

Prepared For:  
Doug Hollenbeck  
37 Avondale Road  
In The Town Of Westerly  
Map 136, Lot 1

3/20/08

Job Number: 7393.001

© 2008 ENVIRONMENTAL PLANNING & SURVEYING, INC.

Environmental Planning & Surveying, Inc.

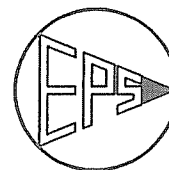

Civil Engineering  
Surveying  
C A D Drafting

52 Dugway Bridge Road West Kingston, Rhode Island 02892 (401) 789-3628

Page 1 of 12

## General Specifications

THE PROPOSED DOCK IS LOCATED IN TYPE 2 WATERS AS DESIGNATED BY THE RHODE ISLAND COASTAL RESOURCES MANAGEMENT COUNCIL.

NO MORE THAN FOUR BOATS ARE PERMITTED TO USE THE PROPOSED DOCK AT ONCE

### Structural

DESIGNED PEDESTRIAN LIVE LOAD:

FIXED PIER = 40 P.S.F. (10 PSF DEAD LOAD)

FLOATS = 20 P.S.F. OR 400 LBS. CONCENTRATED.

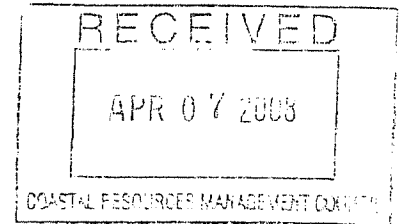

### Materials

#### Wood

ALL WOOD IS TO BE SOUTHERN YELLOW PINE, PRESSURE TREATED WITH TYPE III CHROMATED COPPER ARSENATE (CCA) TO THE FOLLOWING DENSITIES:

DECKING: .4 POUNDS PER CUBIC FOOT (PCF)

PILES: 1.0 - 1.5 PCF

ALL OTHERS: .6 PCF

### Hardware

ALL HARDWARE IS TO BE HOT DIPPED GALVANIZED OR STAINLESS STEEL.

### Pilings

PILINGS SHALL BE 10" TIP DIAMETER, DRIVEN TO A MINIMUM DEPTH OF 10' BELOW BOTTOM SEDIMENTS. IF REFUSAL IS ENCOUNTERED BEFORE THE PILING IS DRIVEN TO A 10' DEPTH. THE CONTRACTOR IS TO DETERMINE IF THE PILING IS ADEQUATELY SUPPORTED OR SHOULD BE RELOCATED TO ACHIEVE A DEEPER PENETRATION.

Note: Original approved plans dated 6/11/07, revised through 6/22/07

#### Dock Modification

Prepared For:  
Doug Hollenbeck  
37 Avondale Road  
In The Town Of Westerly  
Map 136, Lot 1

3/20/08

Job Number: 7393.001

© 2008 ENVIRONMENTAL PLANNING & SURVEYING, INC.

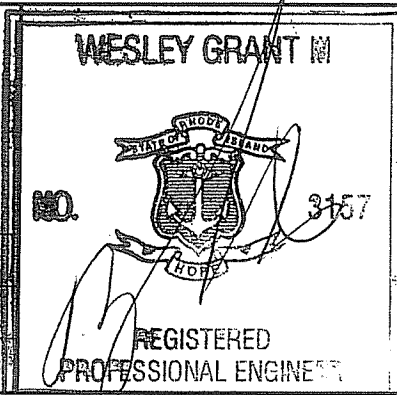

Environmental Planning & Surveying, Inc.

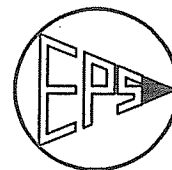

Civil Engineering  
Surveying  
C A D Drafting

52 Dugway Bridge Road West Kingston, Rhode Island 02892 (401) 789-3628

Page 2 of 12

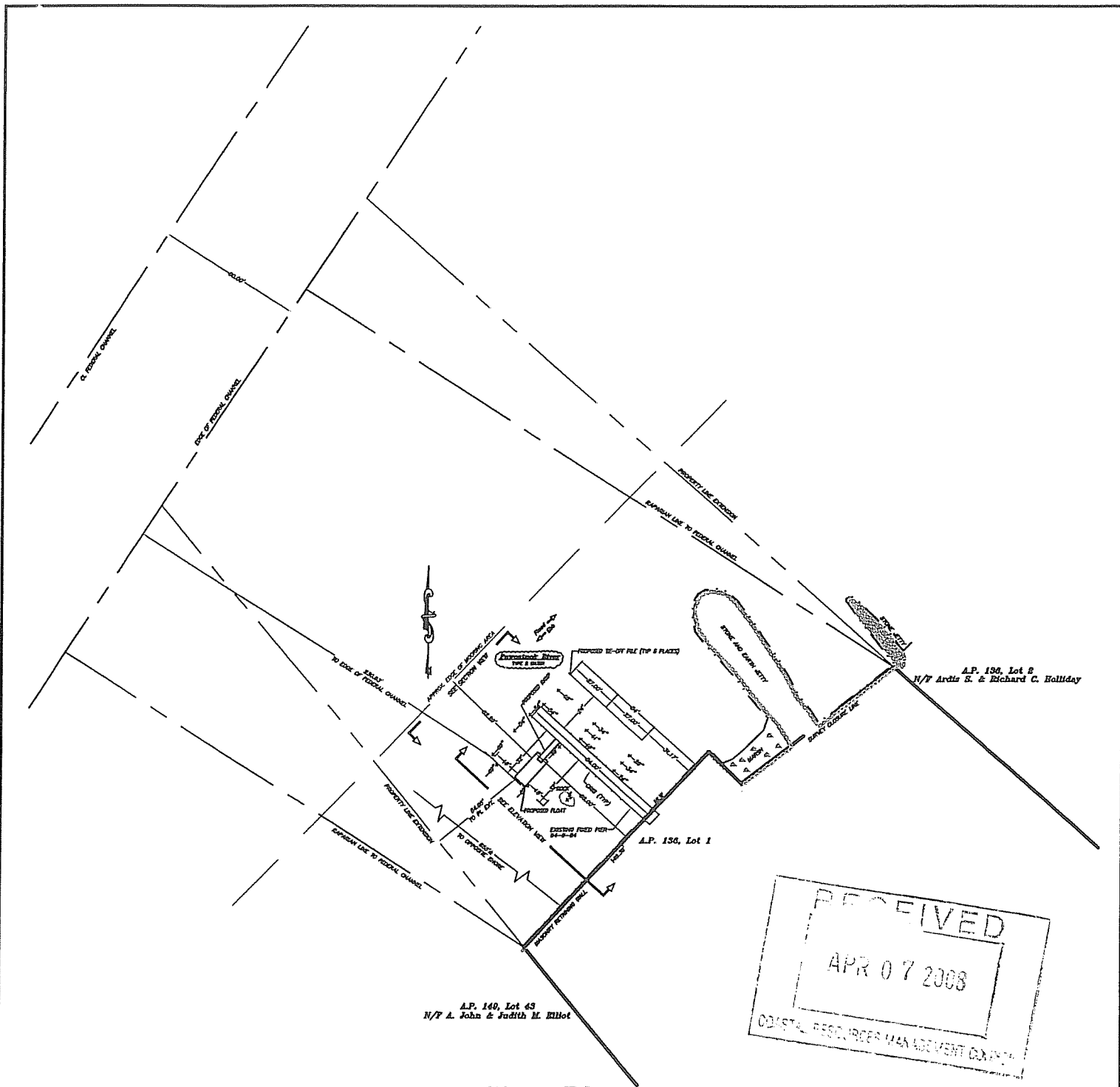

# Site Plan

Scale: 1"=80'

Note: Original approved plans dated 6/11/07, revised through 6/22/07

## Dock Modification

Prepared For:  
 Doug Hollenbeck  
 37 Avondale Road  
 In The Town Of Westerly  
 Map 136, Lot 1

3/20/08

Job Number: 7393.001

© 2008 ENVIRONMENTAL PLANNING & SURVEYING, INC.

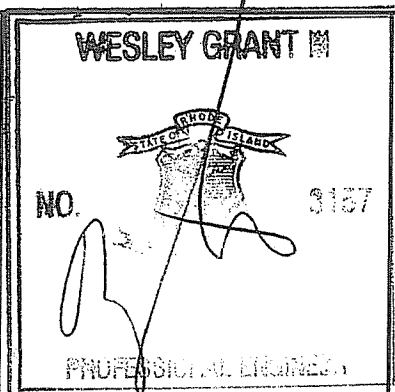

Environmental Planning & Surveying, Inc.

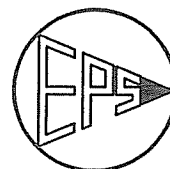

Civil Engineering  
 Surveying  
 C A D Drafting

52 Dugway Bridge Road West Kingston, Rhode Island 02892 (401) 789-3628

Page 3 of 12

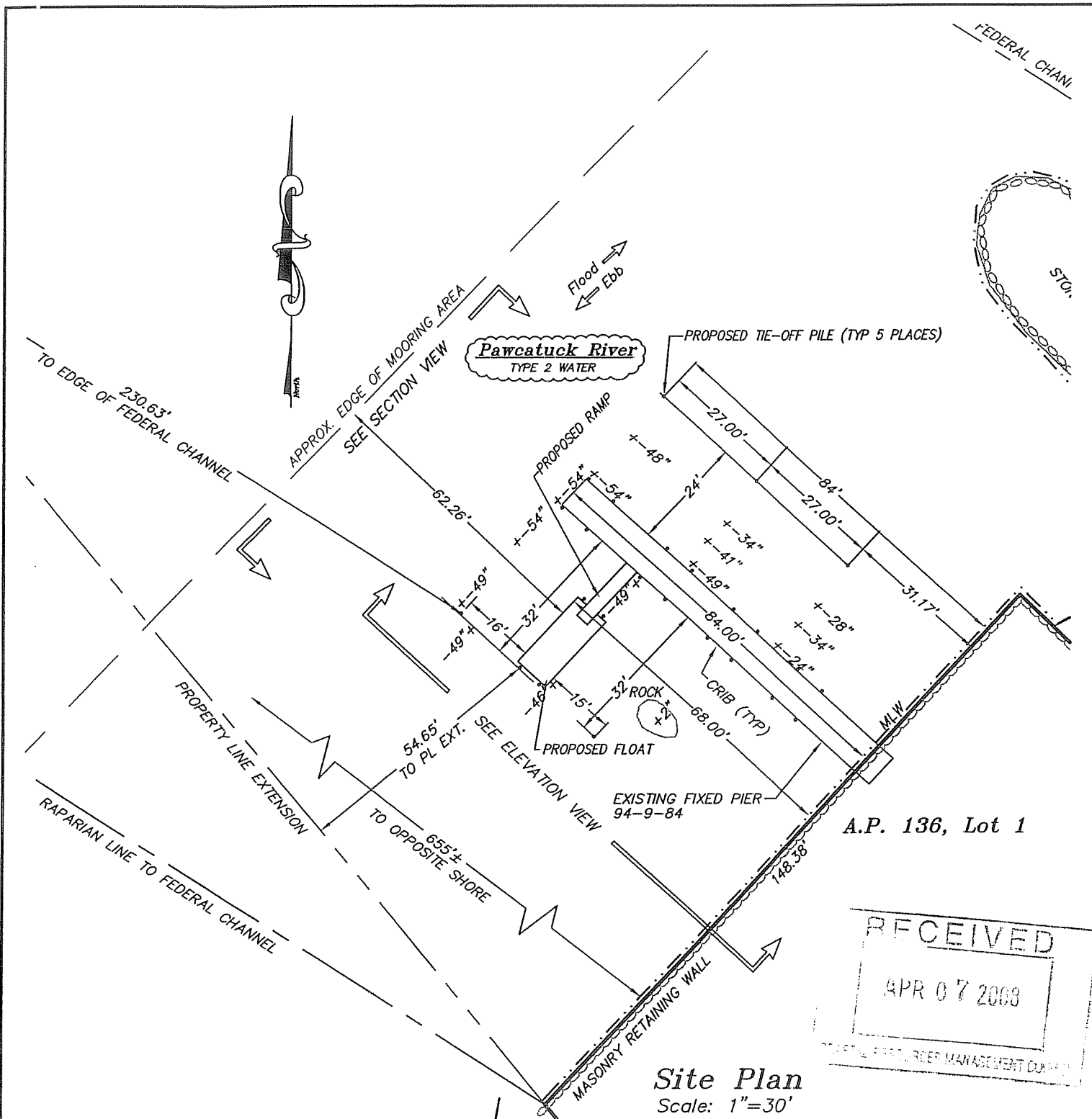

Note: Original approved plans dated 6/11/07, revised through 6/22/07

### Dock Modification

Prepared For:  
**Doug Hollenbeck**  
 37 Avondale Road  
 In The Town Of Westerly  
 Map 136, Lot 1

3/20/08

Job Number: 7393.001

© 2008 ENVIRONMENTAL PLANNING & SURVEYING, INC.

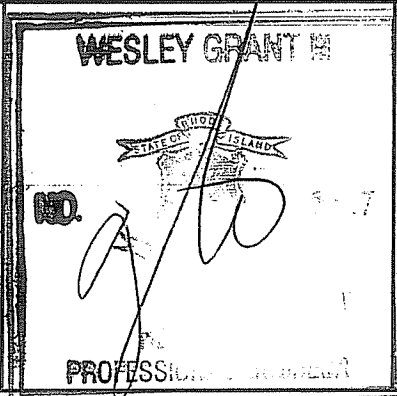

*Environmental Planning & Surveying, Inc.*

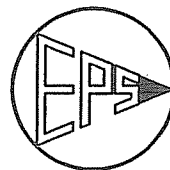

Civil Engineering  
 Surveying  
 C A D Drafting

52 Dugway Bridge Road West Kingston, Rhode Island 02892 (401) 789-3628

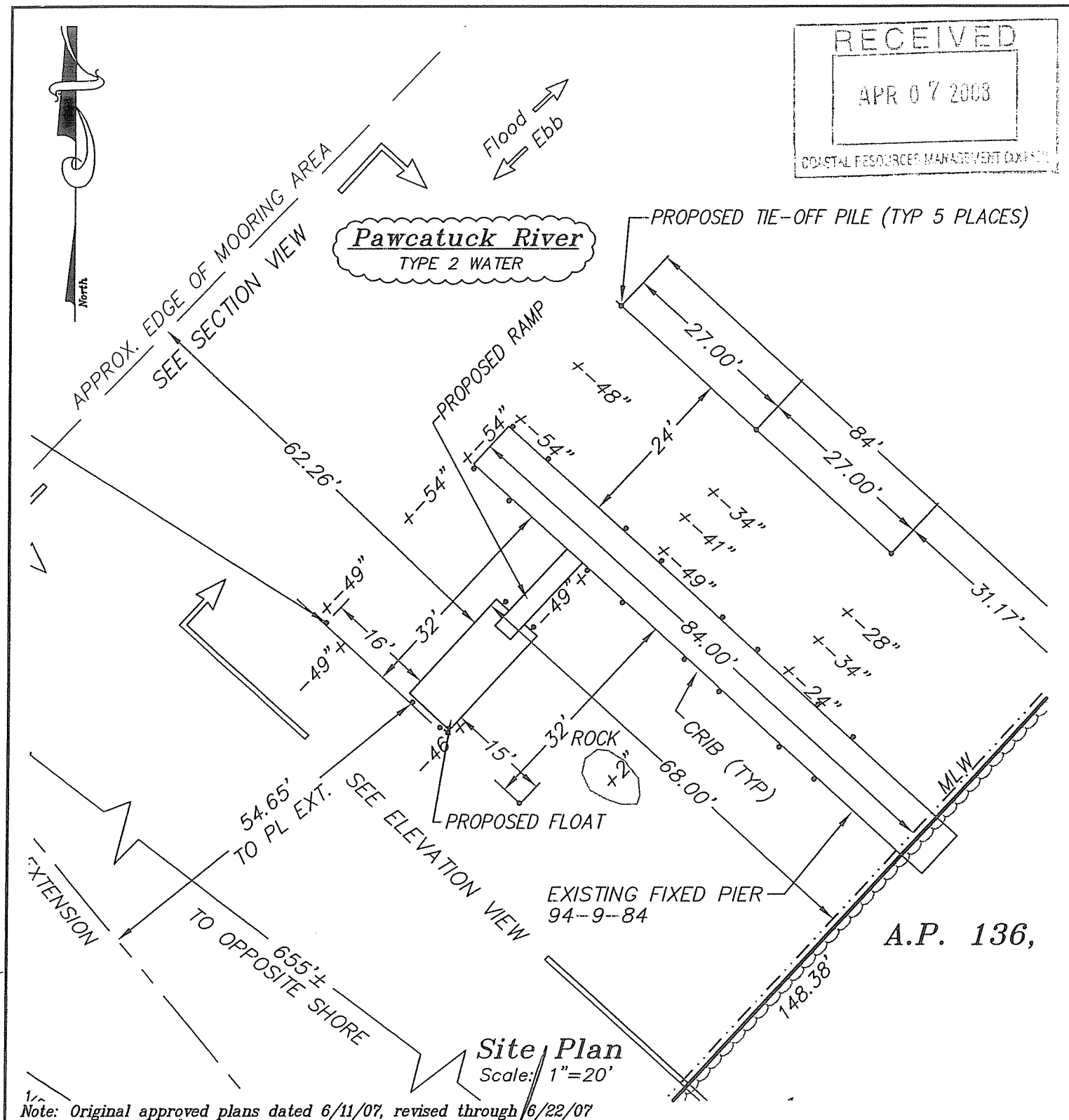
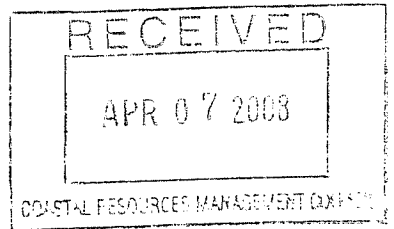

Note: Original approved plans dated 6/11/07, revised through 6/22/07

### Dock Modification

Prepared For:  
Doug Hollenbeck  
37 Avondale Road  
In The Town Of Westerly  
Map 136, Lot 1

3/20/08

Job Number: 7393.001

© 2008 ENVIRONMENTAL PLANNING & SURVEYING, INC.

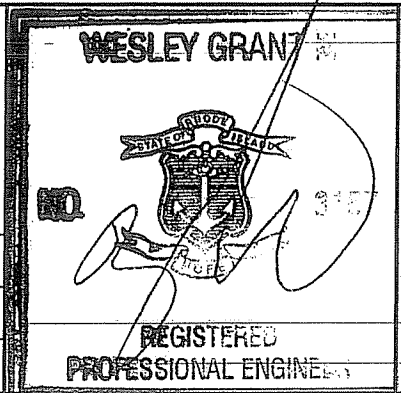

Environmental Planning & Surveying, Inc.

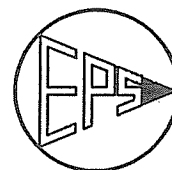

Civil Engineering  
Surveying  
C A D Drafting

52 Dugway Bridge Road West Kingston, Rhode Island 02892 (401) 789-3628

Page 5 of 12

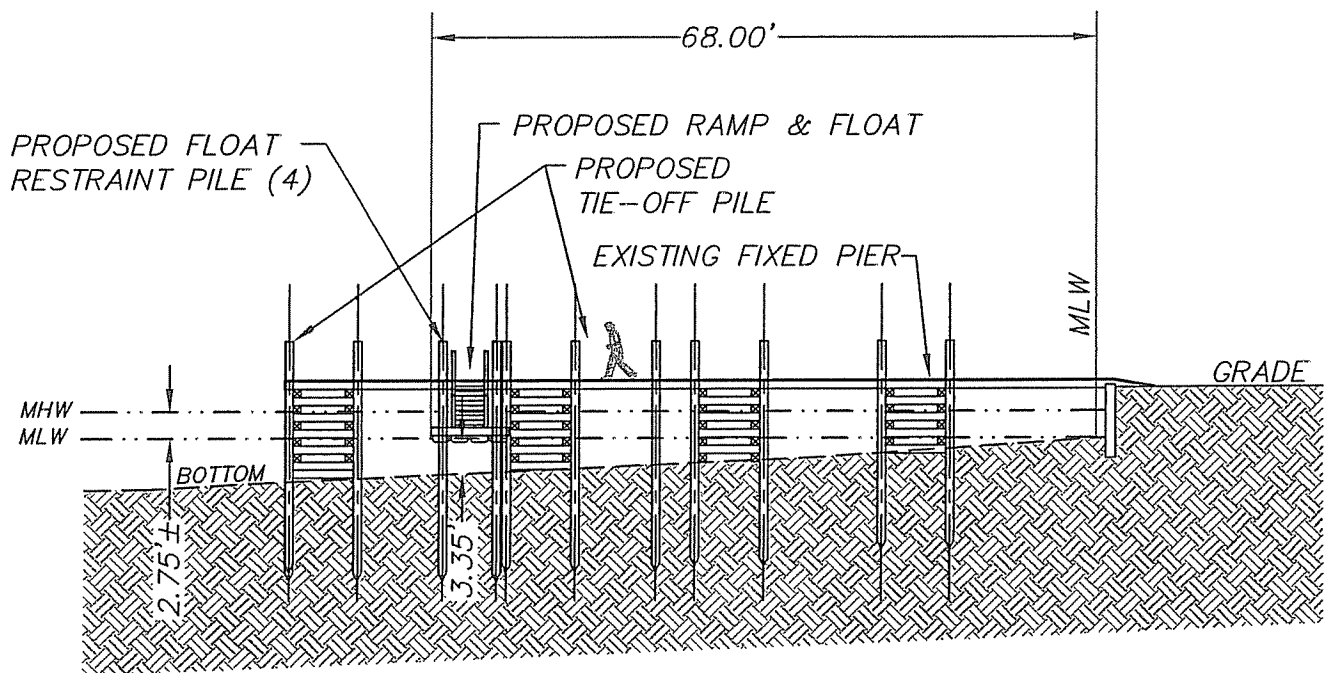
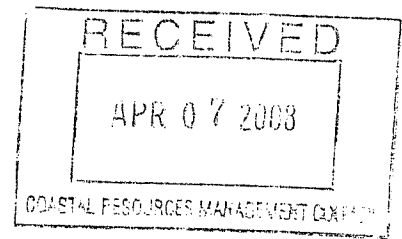

*Elevation Looking North*  
Scale: 1"=20'

Note: Original approved plans dated 6/11/07, revised through 6/22/07

Dock Modification

Prepared For:  
Doug Hollenbeck  
37 Avondale Road  
In The Town Of Westerly  
Map 136, Lot 1

3/20/08

Job Number: 7393.001

©2008 ENVIRONMENTAL PLANNING & SURVEYING, INC.

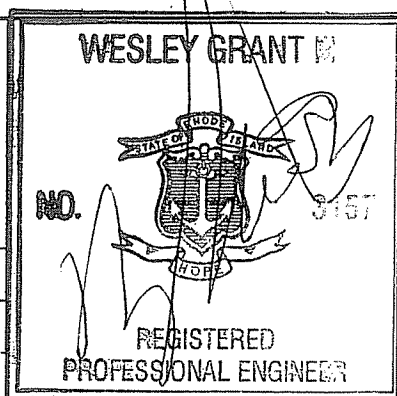

*Environmental Planning & Surveying, Inc.*

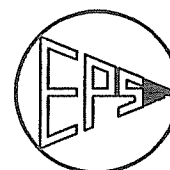

Civil Engineering  
Surveying  
C A D Drafting

52 Dugway Bridge Road West Kingston, Rhode Island 02892 (401) 789-3628

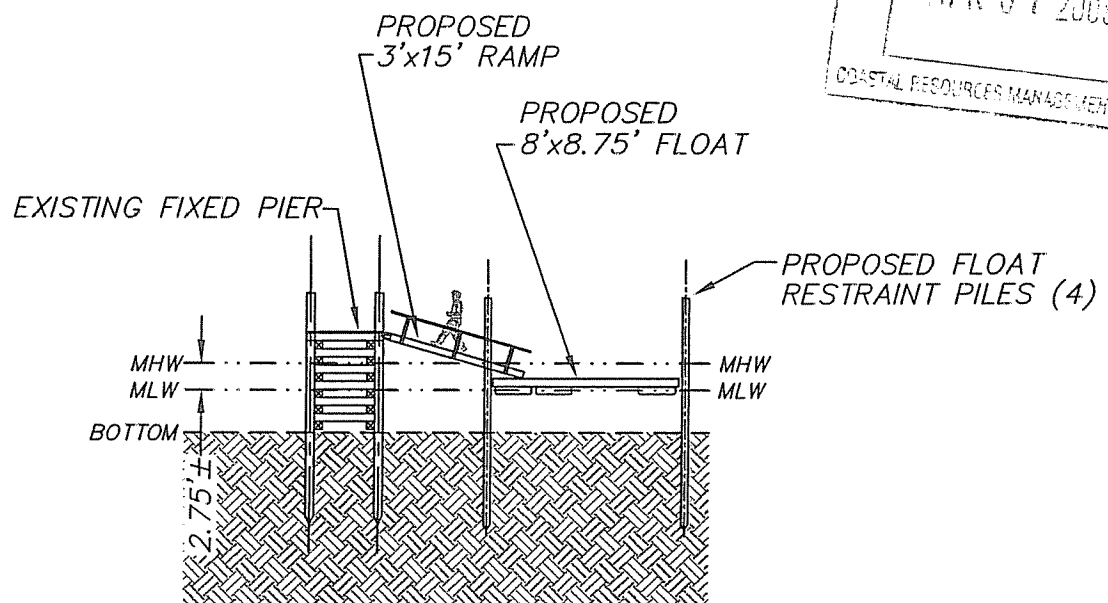
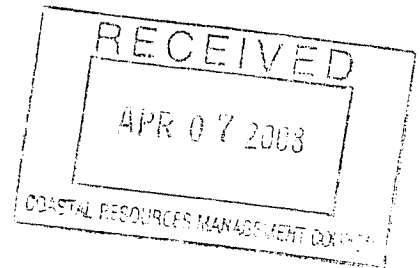

### Section Looking East

Scale: 1"=20'

Note: Original approved plans dated 6/11/07, revised through 6/22/07

#### Dock Modification

Prepared For:  
Doug Hollenbeck  
37 Avondale Road  
In The Town Of Westerly  
Map 136, Lot 1

3/20/08

Job Number: 7393.001

© 2008 ENVIRONMENTAL PLANNING & SURVEYING, INC.

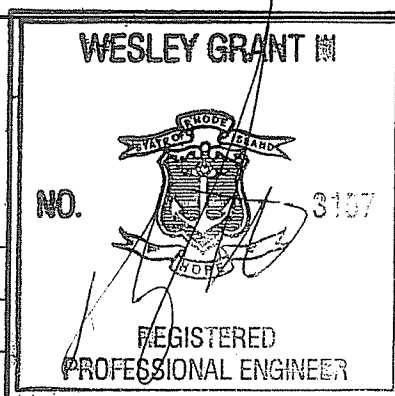

Environmental Planning & Surveying, Inc.

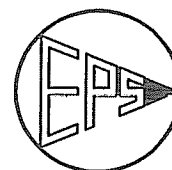

Civil Engineering  
Surveying  
C A D Drafting

52 Dugway Bridge Road West Kingston, Rhode Island 02892 (401) 789-3628



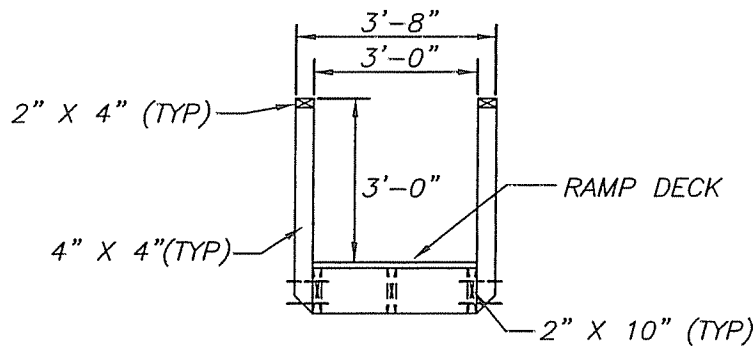
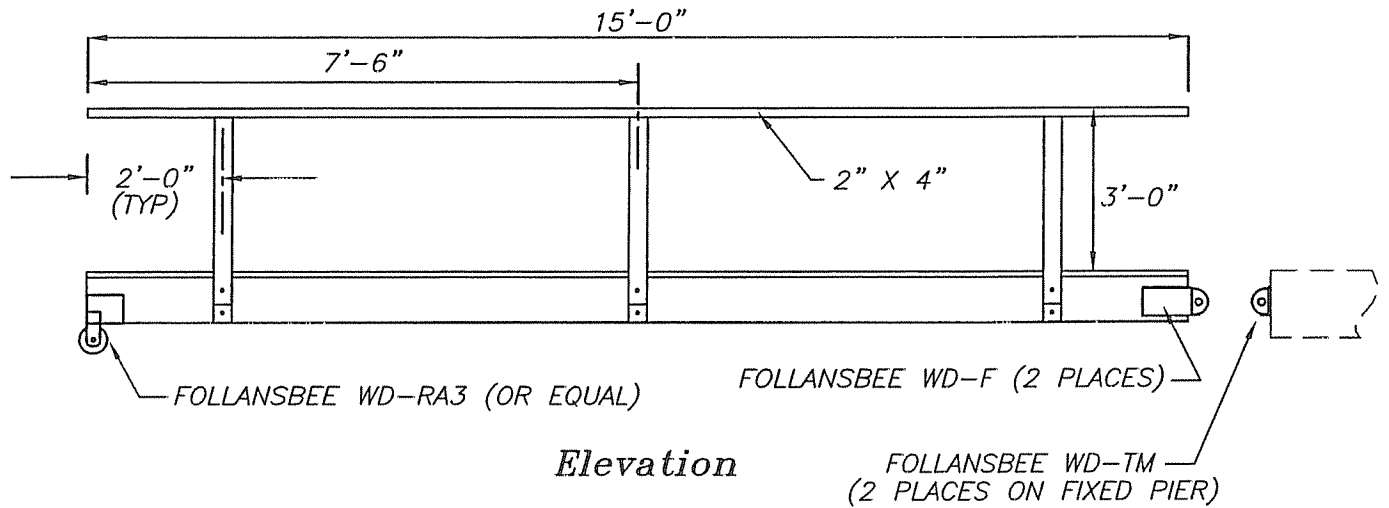
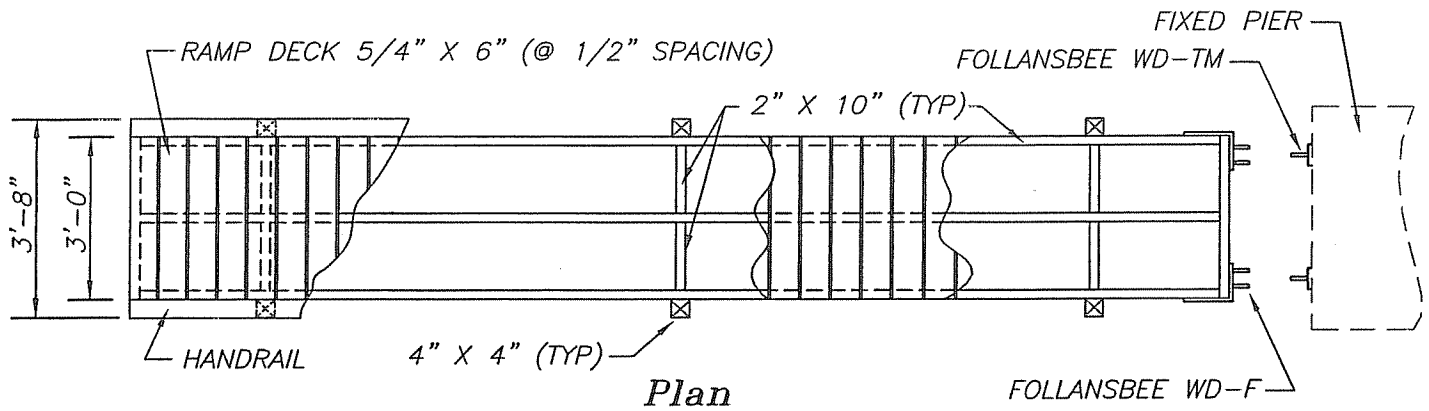

Section

## Ramp Details

NO SCALE

NOTE: HOT DIPPED GALVANIZED (OR STAINLESS STEEL) FASTENERS SHALL BE USED AS REQUIRED.

### Dock Modification

Prepared For:  
Doug Hollenbeck  
37 Avondale Road  
In The Town Of Westerly  
Map 136, Lot 1

3/20/08

Job Number: 7393.001

© 2008 ENVIRONMENTAL PLANNING & SURVEYING, INC.

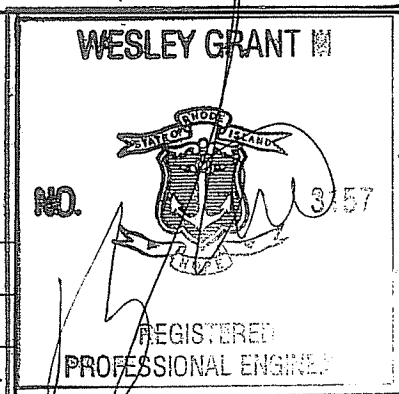

Environmental Planning & Surveying, Inc.

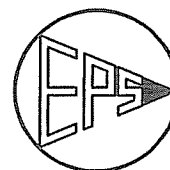

Civil Engineering  
Surveying  
C A D Drafting

52 Dugway Bridge Road West Kingston, Rhode Island 02892 (401) 789-3628

Page 8 of 12



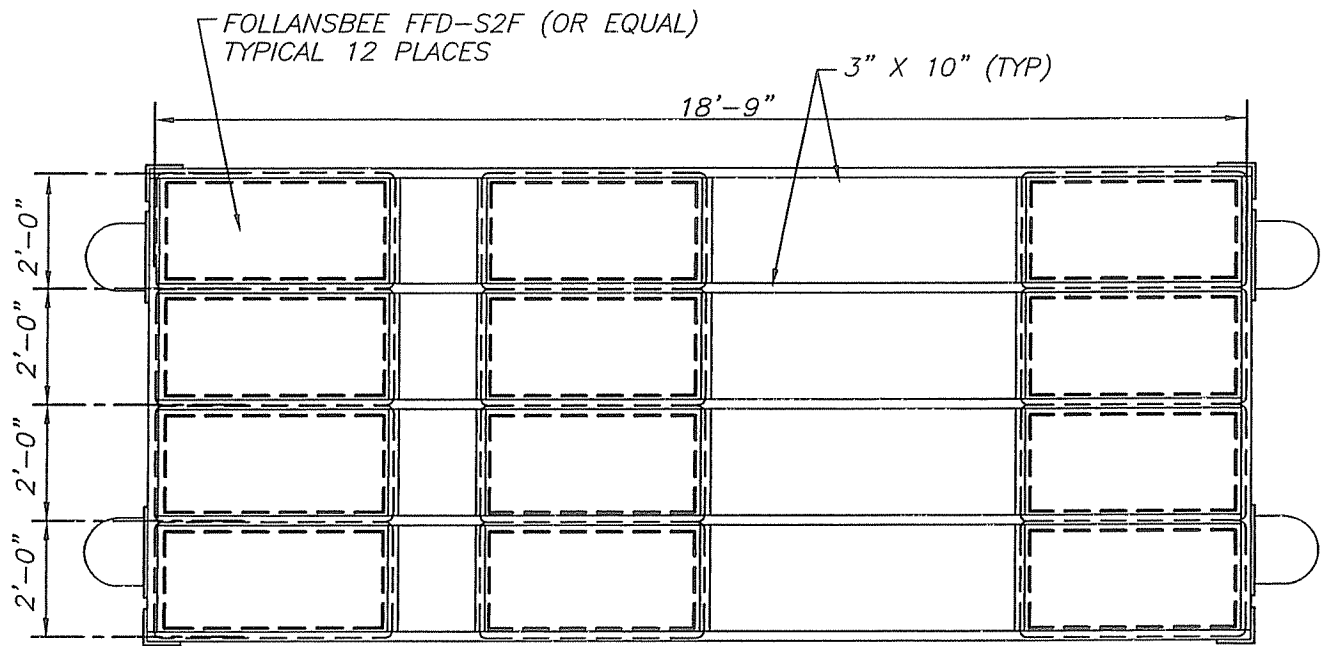

*Plan*

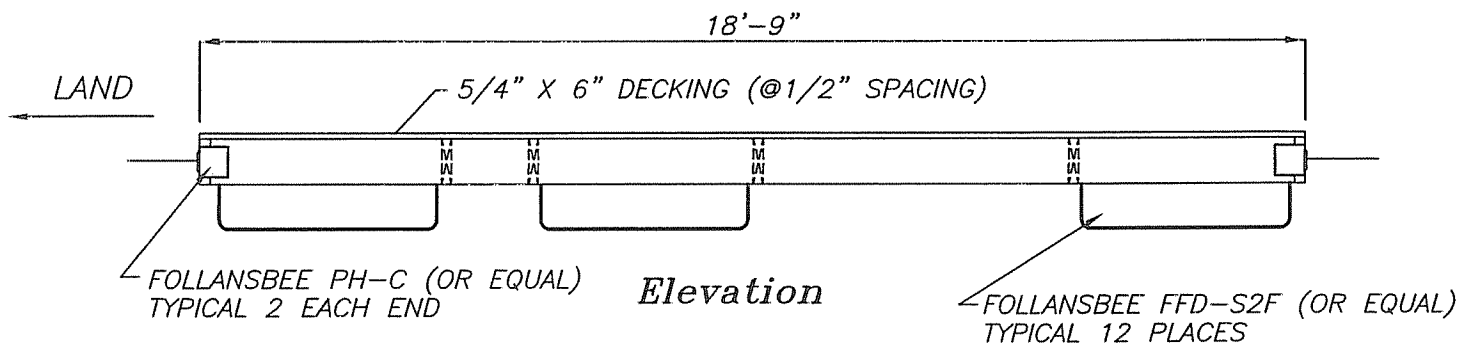

*Elevation*

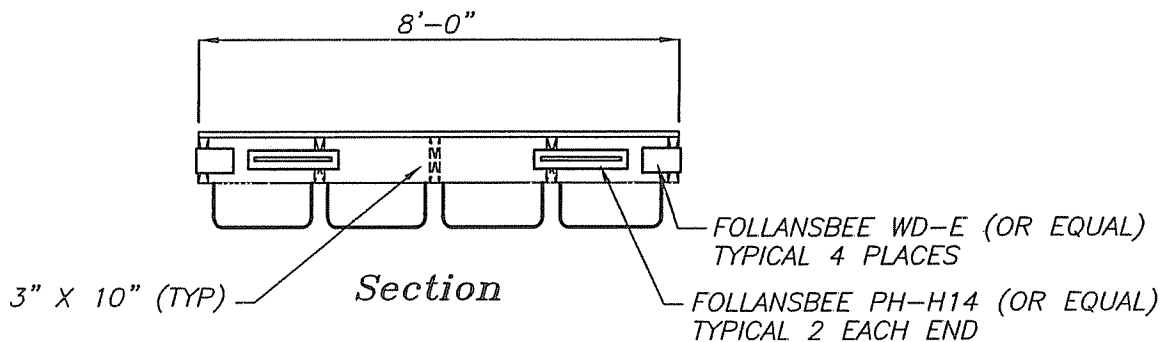

*Section*

***Float Details***

**NOTE:** HOT DIPPED GALVANIZED (OR STAINLESS STEEL) FASTENERS SHALL BE USED AS REQUIRED.

**Dock Modification**

Prepared For:  
Doug Hollenbeck  
37 Avondale Road  
In The Town Of Westerly  
Map 136, Lot 1

3/20/08

Job Number: 7393.001

©2008 ENVIRONMENTAL PLANNING & SURVEYING, INC.

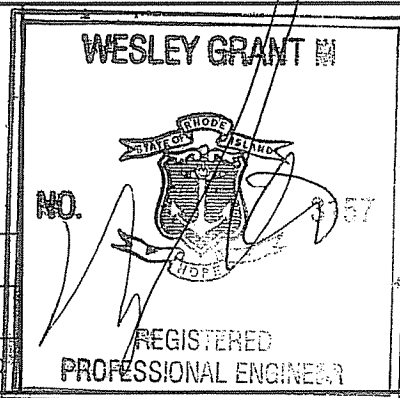

**Environmental Planning & Surveying, Inc.**

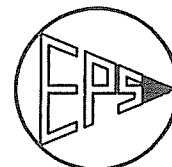

Civil Engineering  
Surveying  
C A D Drafting

52 Dugway Bridge Road West Kingston, Rhode Island 02892 (401) 789-3628

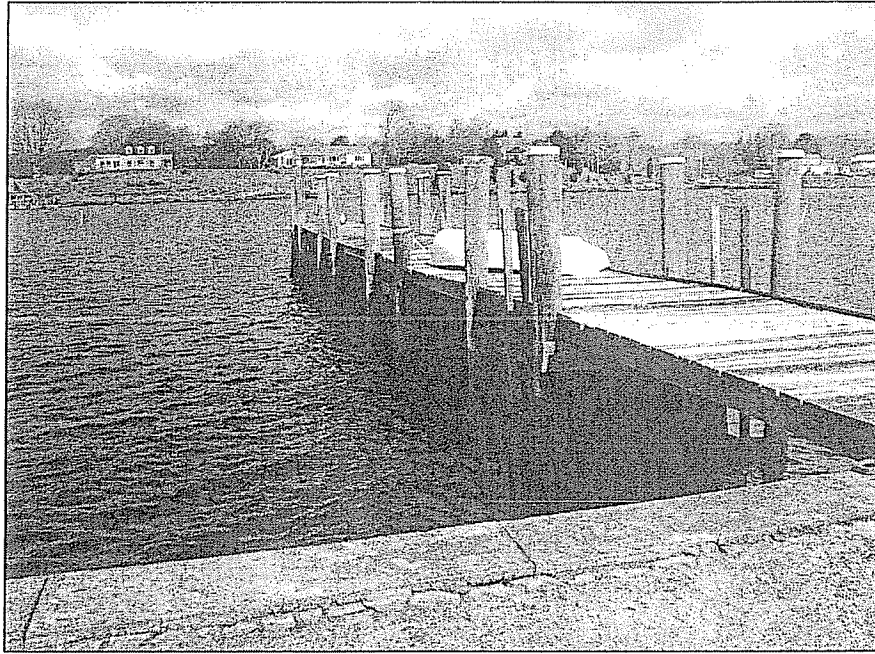

*View Looking West*

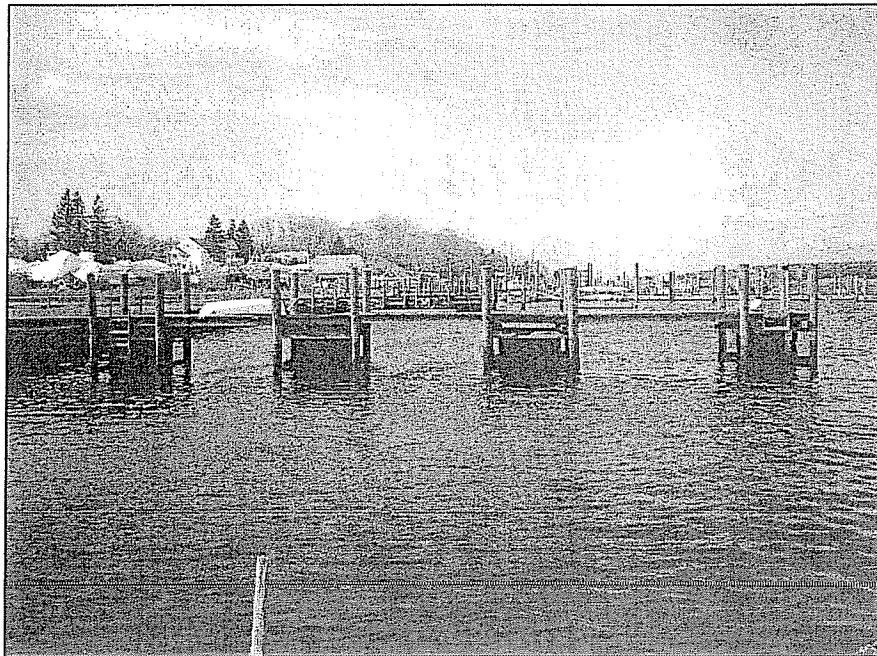

*View Looking South*

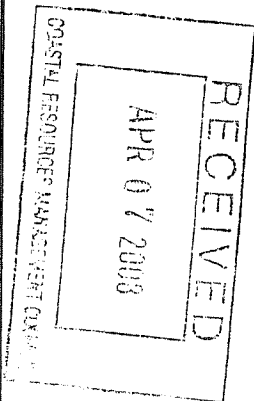

*Dock Modification*

*Prepared For:*  
*Doug Hollenbeck*  
*37 Avondale Road*  
*In The Town Of Westerly*  
*Map 136, Lot 1*

*3/20/08*

*Job Number: 7393.001*

©2008 ENVIRONMENTAL PLANNING & SURVEYING, INC.

*Environmental Planning & Surveying, Inc.*

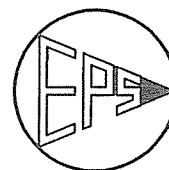

*Civil Engineering*  
*Surveying*  
*C A D Drafting*

52 Dugway Bridge Road West Kingston, Rhode Island 02892 (401) 789-3628

*Page 10 of 12*

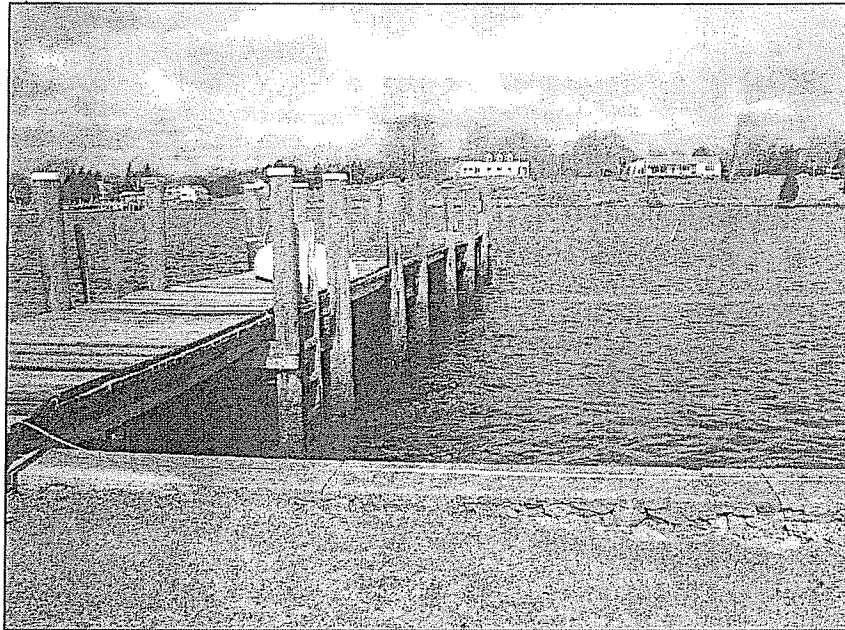

*View Looking West*

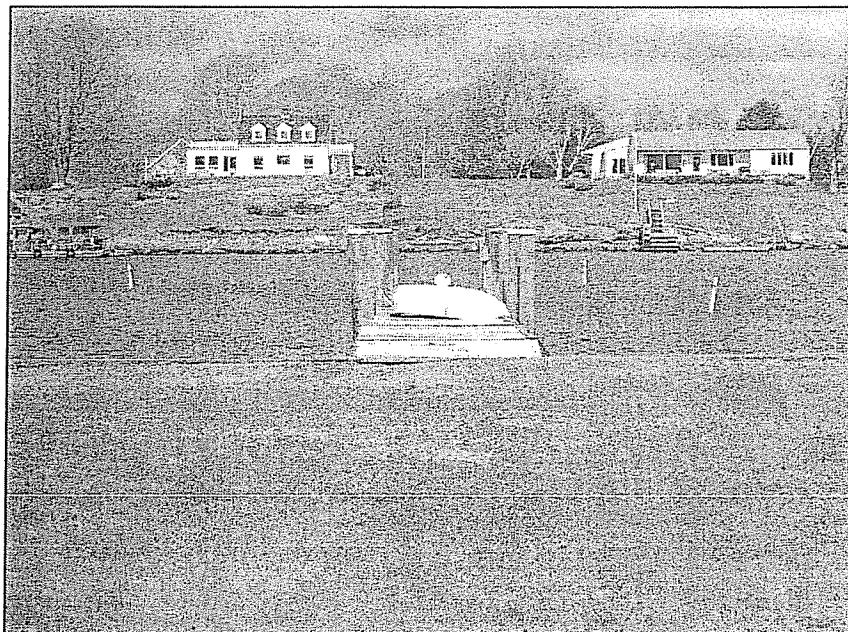

*View Looking West*

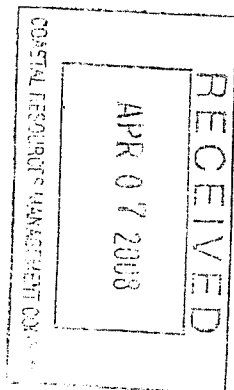

**Dock Modification**

Prepared For:  
**Doug Hollenbeck**  
 37 Avondale Road  
 In The Town Of Westerly  
 Map 136, Lot 1

**3/20/08**

**Job Number: 7393.001**

© 2008 ENVIRONMENTAL PLANNING & SURVEYING, INC.

*Environmental Planning & Surveying, Inc.*

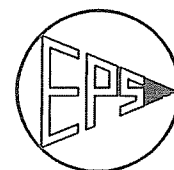

Civil Engineering  
 Surveying  
 C A D Drafting

52 Dugway Bridge Road West Kingston, Rhode Island 02892 (401) 789-3628

Page 11 of 12



*View Looking North*



*View Looking East*

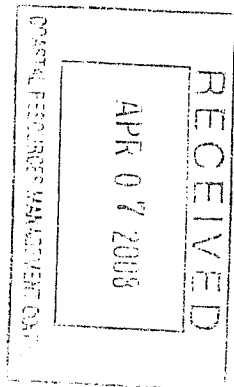

*Dock Modification*

*Prepared For:*  
*Doug Hollenbeck*  
*37 Avondale Road*  
*In The Town Of Westerly*  
*Map 136, Lot 1*

*3/20/08*

*Job Number: 7393.001*

©2008 ENVIRONMENTAL PLANNING & SURVEYING, INC.

*Environmental Planning & Surveying, Inc.*

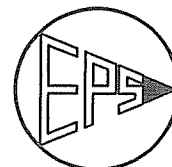

*Civil Engineering*  
*Surveying*  
*C A D Drafting*

52 Dugway Bridge Road West Kingston, Rhode Island 02892 (401) 789-3628

*Page 12 of 12*

CRMC Mailing List for Douglas W Hollenbeck and Susan L Lloyd  
CRMC File Number 1994-09-084  
May 2, 2008

Douglas W Hollenbeck and Susan L Lloyd  
37 Avondale Road  
Westerly, RI 02891

A. John & Judith M. Elliott  
41 Avondale Road  
Westerly, RI 02891

Ardis & Richard Holliday  
35 Avondale Road  
Westerly, RI 02891

CRMC (1994-09-084)  
O. S. Government Center  
4808 Tower Hill Road  
Wakefield, RI 02879

General List – Town of Westerly