



State of Rhode Island and Providence Plantations  
**Coastal Resources Management Council**  
 Oliver H. Stedman Government Center  
 4808 Tower Hill Road, Suite 3  
 Wakefield, RI 02879-1900

(401) 783-3370  
 Fax (401) 783-2069

**PUBLIC NOTICE**

File Number: 2001-05-133 Date: March 20, 2017

This office has under consideration the application of:

Rome Point LLC  
 c/o Russell Blank  
 48 Sheryl Circle  
 Warwick, RI 02818

for a State of Rhode Island Assent to modify an existing aquaculture site: to use floating cages on the offshore (eastern) part of the lease site from May 1 through October 31 in the location that the submerged sugar kelp lines are used from November 1 through April 30. CRMC will require lighted buoys for the two offshore corners of the lease site.

Project Location:	South of Rome Point
City/Town:	North Kingstown
Plat/Lot:	/
Waterway:	West Passage Narragansett Bay

Plans of the proposed work may be seen at the CRMC office in Wakefield.

In accordance with the Administrative Procedures Act (Chapter 42-35 of the Rhode Island General Laws) you may request a hearing on this matter.

You are advised that if you have good reason to enter protests against the proposed work it is your privilege to do so. It is expected that objectors will review the application and plans thoroughly, visit site of proposed work if necessary, to familiarize themselves with the conditions and cite what law or laws, if any, would in their opinion be violated by the work proposed.

If you desire to protest, you must attend the scheduled hearing and give sworn testimony. A notice of the time and place of such hearing will be furnished you as soon as possible after receipt of your request for hearing. If you desire to request a hearing, to receive consideration, it should be in writing (**with your correct mailing address, e-mail address and valid contact number**) and be received at this office on or before April 20, 2017.

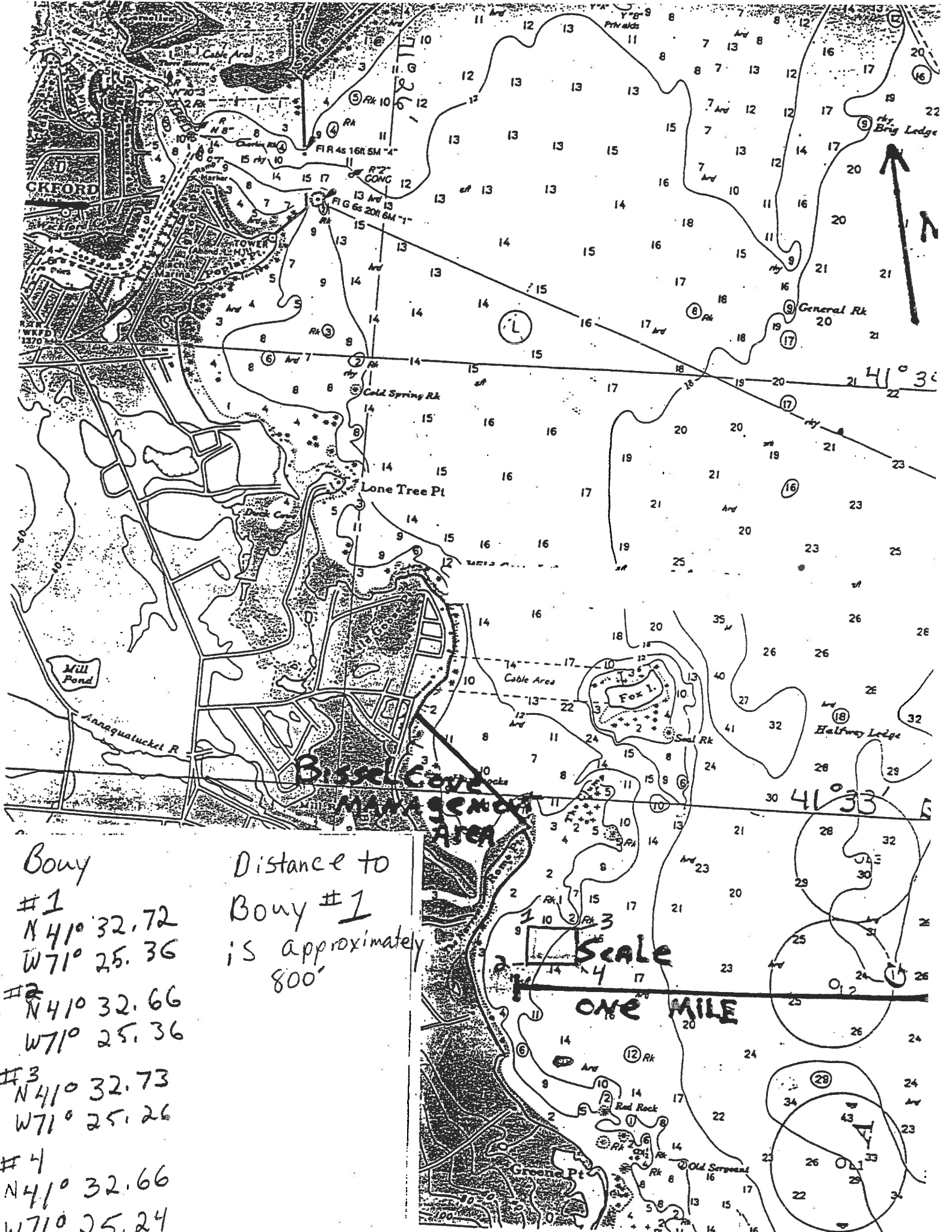

Bowy #1	N 41° 32.72
	W 71° 25.36
#2	N 41° 32.66
	W 71° 25.36
#3	N 41° 32.73
	W 71° 25.26
#4	N 41° 32.66
	W 71° 25.24

Distance to  
Bowy #1  
is approximately  
800'

SCALE  
ONE MILE