

STATE OF RHODE ISLAND AND PROVIDENCE PLANTATIONS
COASTAL RESOURCES MANAGEMENT COUNCIL

Oliver Stedman Government Center
4808 Tower Hill Road, Wakefield, RI 02879

PUBLIC NOTICE

File Number: 2008-10-024 Date: December 18, 2008

This office has under consideration the application of:

Watchemoket Realty Inc
9 Pier Road
East Providence, RI 02914

for a State of Rhode Island Assent to: replace/enlarge exterior deck over the Seekonk River, south and east of existing "East Providence Yacht Club" building. The new deck (360 sq ft +/-) will replace an existing deck (100 sq ft +/-).

Project Location:	9 Pier Road
City/Town:	East Providence
Plat/Lot:	016 / 22
Waterway:	Seekonk River

Plans of the proposed work may be seen at the CRMC office in Wakefield.

In accordance with the Administrative Procedures Act (Chapter 42-35 of the Rhode Island General Laws) you may request a hearing on this matter.

You are advised that if you have good reason to enter protests against the proposed work it is your privilege to do so. It is expected that objectors will review the application and plans thoroughly, visit site of proposed work if necessary, to familiarize themselves with the conditions and cite what law or laws, if any, would in their opinion be violated by the work proposed.

If you desire to protest, you must attend the scheduled hearing and give sworn testimony. A notice of the time and place of such hearing will be furnished you as soon as possible after receipt of your request for hearing. If you desire to request a hearing, to receive consideration, it should be in writing and be received at this office on or before January 18, 2009.

SOUNDINGS IN FEET

SITE

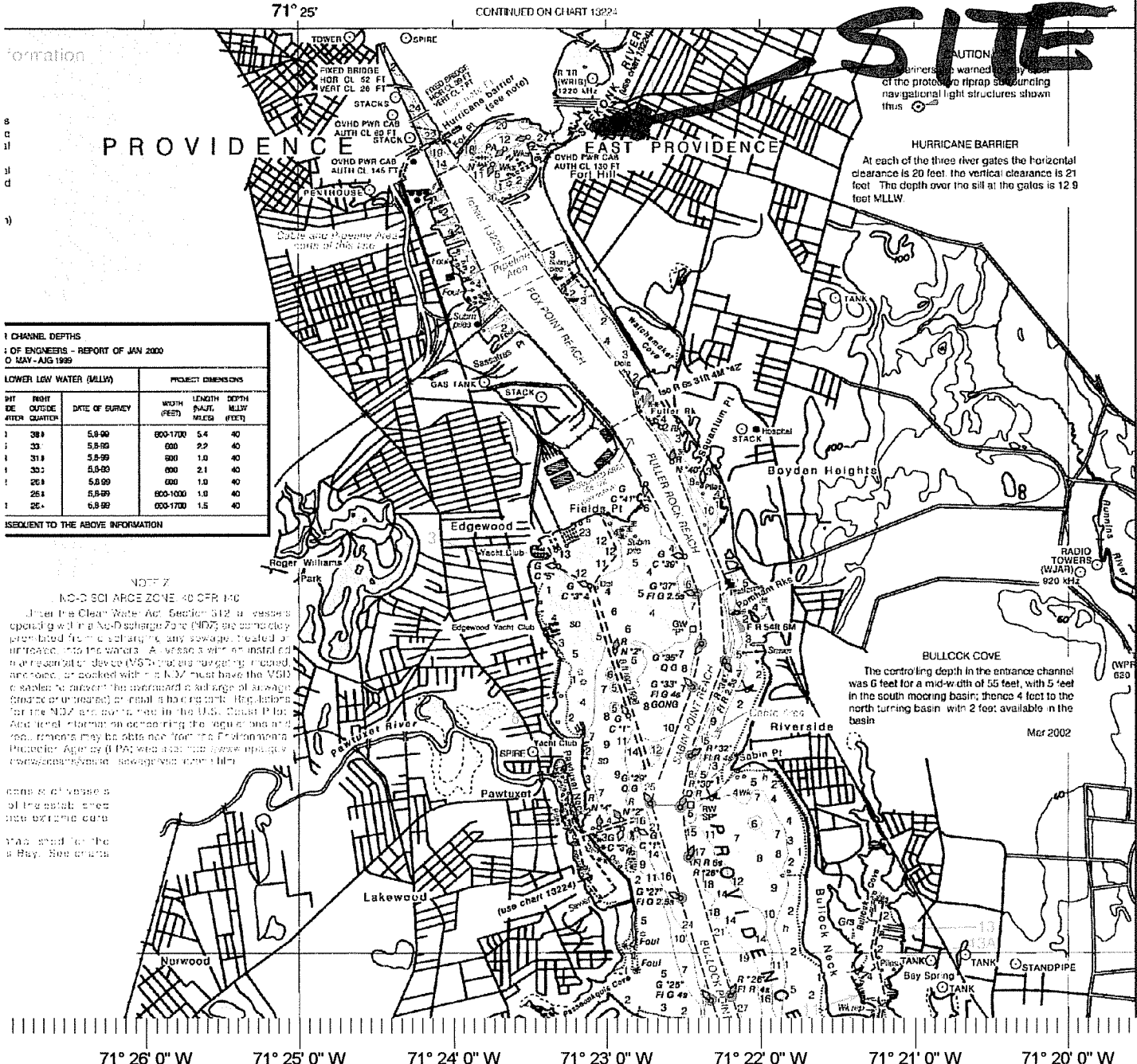

CHANNEL DEPTHS
OF ENGINEERS - REPORT OF JAN 2000
O MAY - AUG 1999

LOWER LOW WATER (MLLW)		PROJECT DIMENSIONS		
BIT DE ATEN QUANTER	RIGHT OUTSIDE DATE OF SURVEY	WIDTH (FEET)	LENGTH (FEET)	DEPTH (FEET)
1 38	5.8.99	800-1700	5.4	40
1 33	5.8.99	600	2.2	40
1 31	5.8.99	900	1.0	40
1 30	5.8.99	600	2.1	40
1 29	5.8.99	600	1.0	40
1 28	5.8.99	805-1000	1.0	40
1 25	6.8.99	600-1700	1.5	40

SEQUENT TO THE ABOVE INFORMATION

NOTE 7
NO-DISCHARGE ZONE FOR PRO

Under the Clean Water Act, Section 312, all vessels operating in a No-D discharge Zone (NDZ) are completely prohibited from discharging any sewage, treated or untreated, into the waters. A vessel with an installed in a No-D discharge device (NDD) that is not properly installed, maintained, or locked with the NDD must have the VSDI cables to prevent the inwardward end edge of sewage from being or treated) or retail is to be docked. Regulators for the NDZ are authorized by the U.S. Coast Pilot. Additional information concerning the regulations and procedures may be obtained from the Environmental Protection Agency (EPA) web site: <http://www.epa.gov/cwa/ndz/ndz.html>.

depth of vessels of the station and use bottom data.

YAC should be the Bay. See charts.

Chart Name: NARRAGANSETT BAY RI-MA
 Chart ID: 13221_1
 Top Left: 41° 51' 29" N 71° 26' 54" W
 Bottom Right: 41° 44' 40" N 71° 19' 33" W

APPROVED
CRM
MARINA
PERIMETER
LIMIT PLAN

PROPOSED
DECK

1998-11-27
Perry
Watchmaker
Healthy

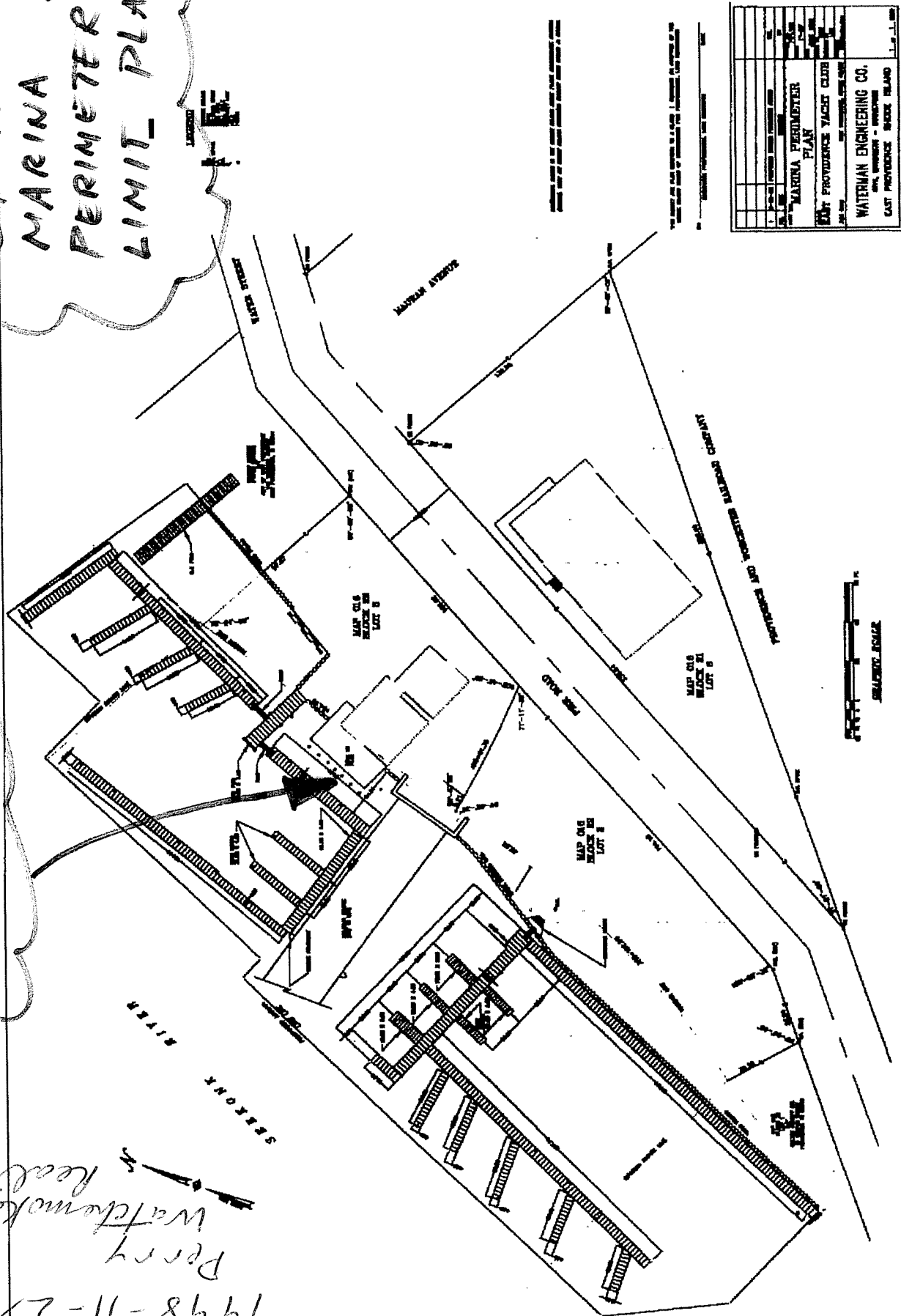

MARINA PERIMETER PLAN	
EAST PROVIDENCE YACHT CLUB	
WATERMAN ENGINEERING CO.	
401 W. WASHINGTON - PROVIDENCE	
EAST PROVIDENCE BRIDGE ISLAND	
DATE: 11-27-98	
SCALE: AS SHOWN	
DRAWN BY: [illegible]	
CHECKED BY: [illegible]	
APPROVED BY: [illegible]	
DATE: 11-27-98	

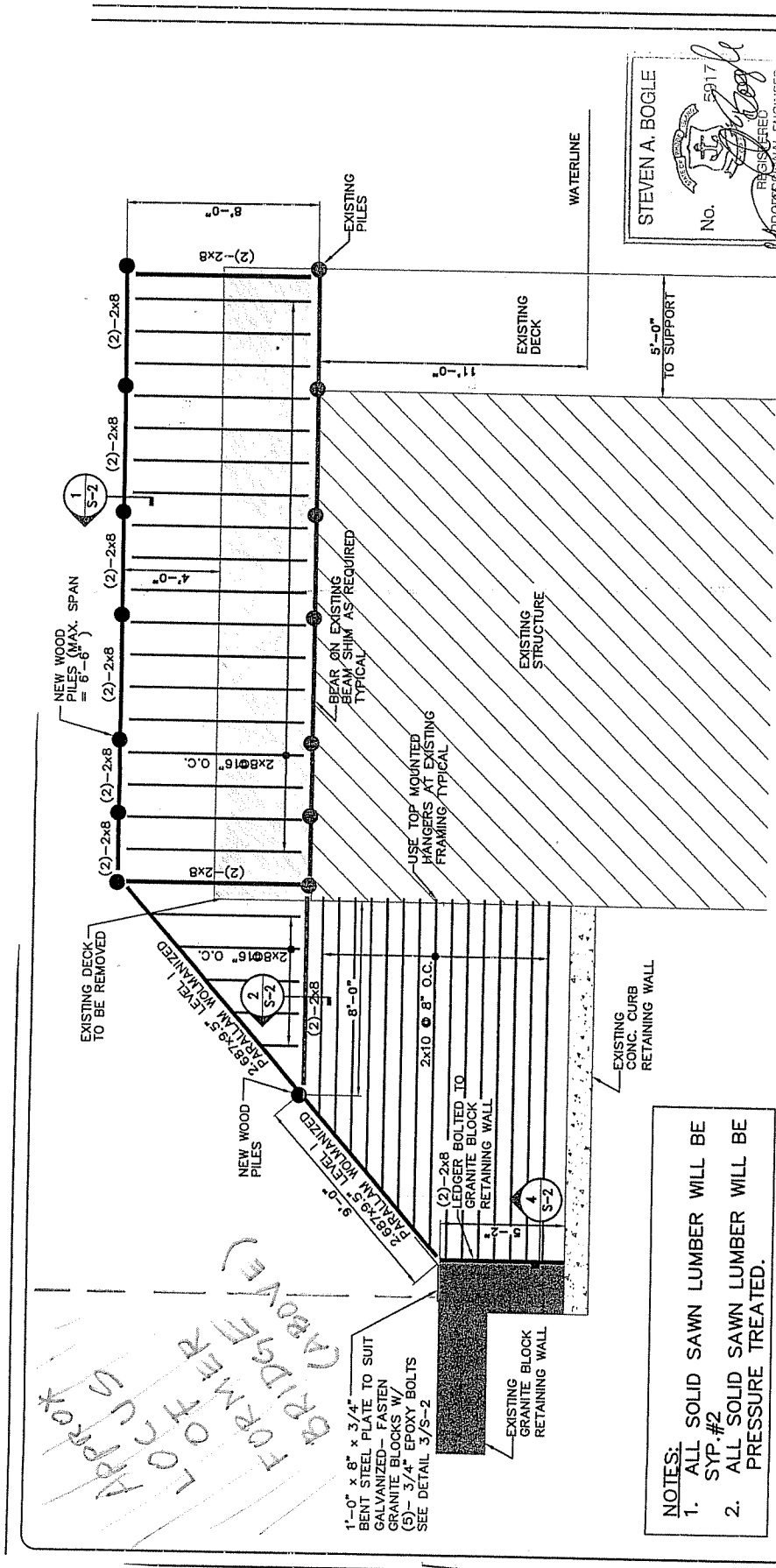

NOTES:
 1. ALL SOLID SAWN LUMBER WILL BE SYP.#2
 2. ALL SOLID SAWN LUMBER WILL BE PRESSURE TREATED.

EXISTING PIER / WALL LAYOUT
 1/4" = 1'-0"

CLIENT: EAST PROVIDENCE YACHT CLUB

CAD FILE:	GEISSER	SCALE:	VARIABLES
FILE NO.:	V-908	DATE:	01/02/2008
DRAWING NO.:	1 OF 1	DESIGNED BY:	SAB
		DRAWN BY:	KMR
		CHECKED BY:	SAB

NEW EXTERIOR DECKS
 9 PIER ROAD
 EAST PROVIDENCE, RI

GEISSER ENGINEERING CORP.
 CONSULTING ENGINEERS
 227 WAMPANOAG TRAIL
 RIVERSIDE, RHODE ISLAND 02915
 TEL: 401.438.7711 FAX: 401.438.0281

STEVEN A. BOGLE
 No. 5817
 REGISTERED PROFESSIONAL ENGINEER
 CIVIL 0-25-08

WWW.GEISSERENGINEERING.COM EMAIL: GEC@GEISSERENGINEERING.COM

REVISED

TOUGH APPROX (CARPENTER)
 FORMER

CRMC Mailing List for Watchemoket Realty Inc
CRMC File Number 2008-10-024
December 18, 2008

Watchemoket Realty Inc
9 Pier Road
East Providence, RI 02914

CRMC (2008-10-024)
O. S. Government Center
4808 Tower Hill Road
Wakefield, RI 02879

General List - City of East Providence