



Oliver Stedman Government Center
4808 Tower Hill Road; Suite 116
Wakefield, RI 02879
401-783-3370

PUBLIC NOTICE

File Number: 2012-04-090

Date: May 3, 2012

This office has under consideration the application of:

Donald Shore
71 Charlotte Drive
Warwick, RI 02818

for a State of Rhode Island Assent to construct and maintain: boat lift structure (10,000 lb. capacity) adjacent to existing approved residential boating facility.

Project Location:	71 Charlotte Drive
City/Town:	Warwick
Plat/Lot:	201 / 152
Waterway:	Greenwich Bay, Narragansett Bay

Plans of the proposed work may be seen at the CRMC office in Wakefield.

In accordance with the Administrative Procedures Act (Chapter 42-35 of the Rhode Island General Laws) you may request a hearing on this matter.

You are advised that if you have good reason to enter protests against the proposed work it is your privilege to do so. It is expected that objectors will review the application and plans thoroughly, visit site of proposed work if necessary, to familiarize themselves with the conditions and cite what law or laws, if any, would in their opinion be violated by the work proposed.

If you desire to protest, you must attend the scheduled hearing and give sworn testimony. A notice of the time and place of such hearing will be furnished you as soon as possible after receipt of your request for hearing. If you desire to request a hearing, to receive consideration, it should be in writing (**with your correct mailing address, e-mail address and valid contact number**) and be received at this office on or before **June 3, 2012**.

Locus Plan for DONATED SHORES
71 CHARLOTTE DRIVE Warwick, RI 02818

Topo USA® 6.0

DELORME

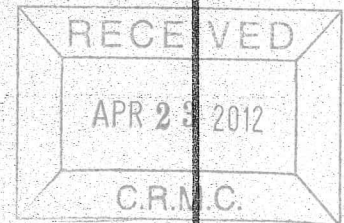
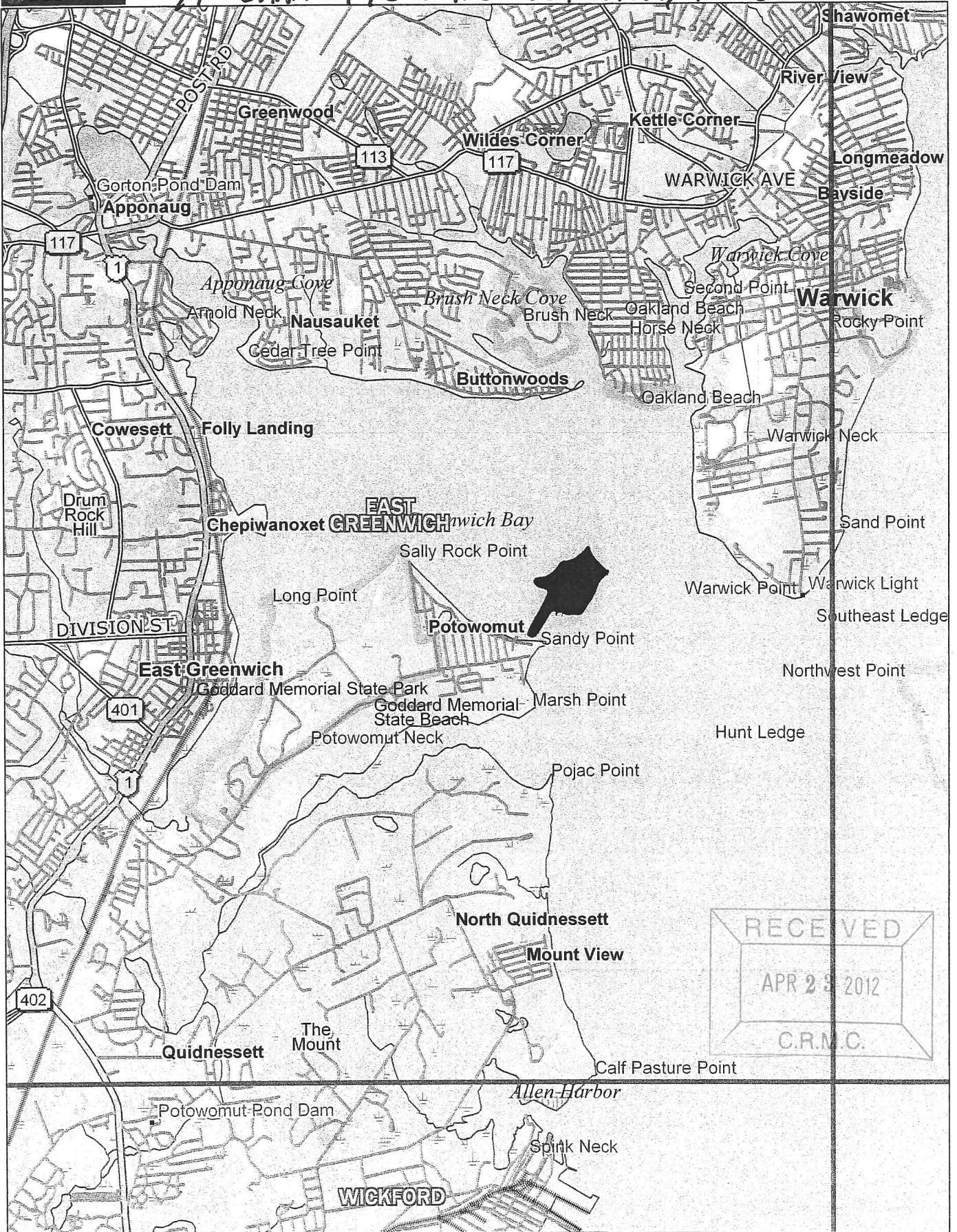

Data use subject to license.

© 2006 DeLorme. Topo USA® 6.0.

www.delorme.com

1N
14.5°W

Scale 1 : 50,000

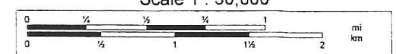

1" = 4,166.7 ft Data Zoom 11-3

Proposed 10,000 # Boat Lift
By: WRAH 4/17/12

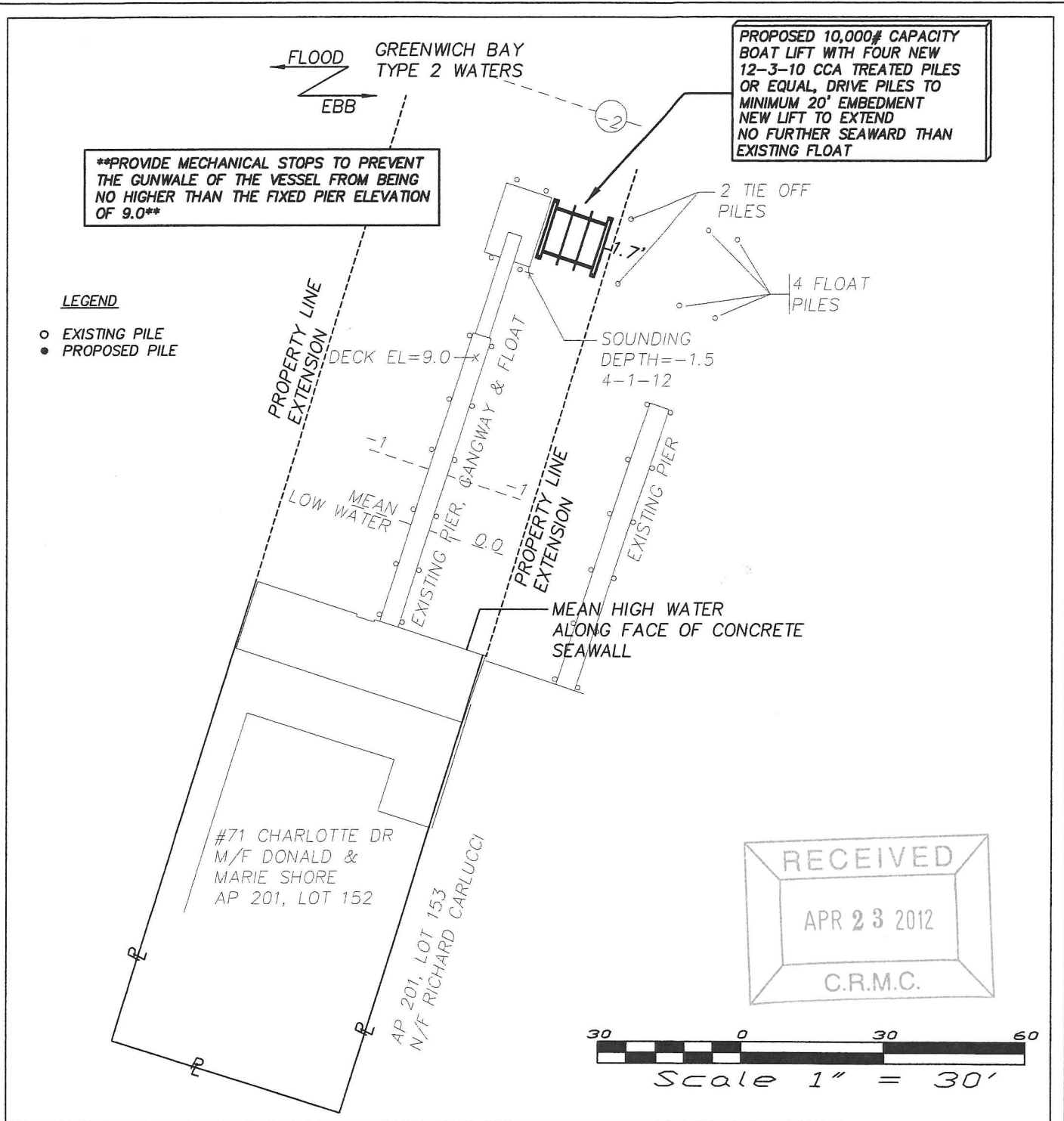

PLAN OF PROPOSED 10,000 POUND BOAT LIFT
FOR: DONALD & MARIE SHORE
71 CHARLOTTE DRIVE
WARWICK, RI 02818
AP 201, LOT 152

BY: WARREN HALL, CIVIL ENGINEER
APRIL 8, 2012 SHEET 1 OF 2

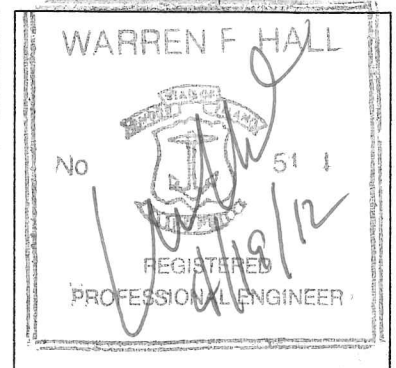

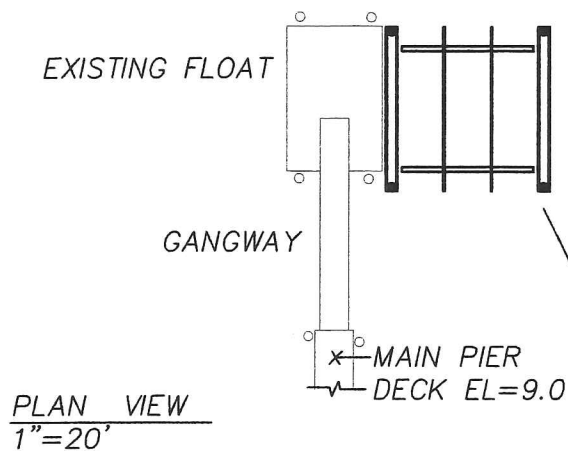

PROPOSED 10,000# CAPACITY
BOAT LIFT WITH FOUR NEW
12-3-10 CCA TREATED PILES
OR EQUAL, DRIVE PILES TO
MINIMUM 20' EMBEDMENT

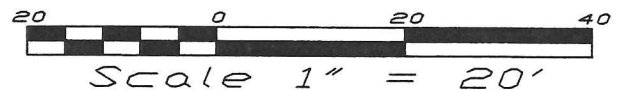
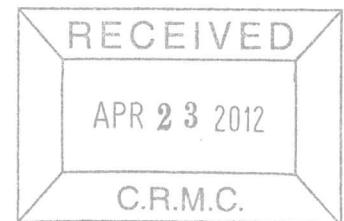
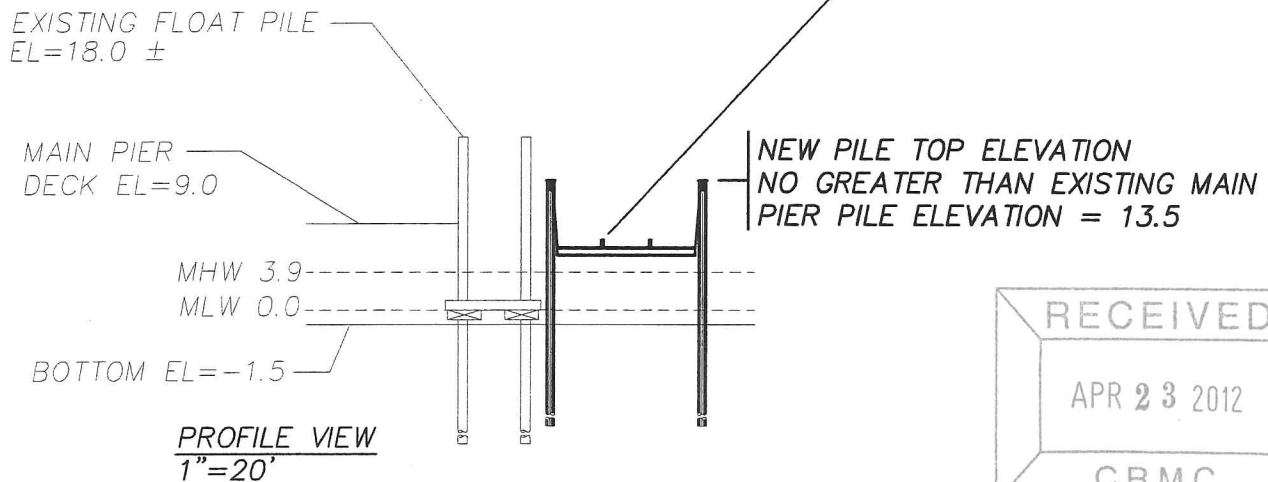

PLAN OF PROPOSED 10,000 POUND BOAT LIFT
FOR: DONALD & MARIE SHORE
71 CHARLOTTE DRIVE
WARWICK, RI 02818
AP 201, LOT 152

BY: WARREN HALL, CIVIL ENGINEER
APRIL 8, 2012 SHEET 2 OF 2

