

**State of Rhode Island
Coastal Resources Management Council
Oliver H. Stedman Government Center
4808 Tower Hill Road, Suite 3
Wakefield, RI 02879
(401)783-3370**

**State of Rhode Island
Department of Environmental Management
Office of Technical and Customer Asst.
235 Promenade Street
Providence, RI 02908-5767
(401)222-6822**

JOINT PUBLIC NOTICE

CRMC File No.: 2012-05-066 Date: June 8, 2012

These offices have under consideration the application of:

**Johnson & Wales University
8 Abbot Park Place
Providence, RI**

For a State of Rhode Island Assent to construct and maintain: athletic field complex consisting of four sports fields with amenities and landscaping (approximately 23 acres total). The project includes two "enlarged point source discharges" of collected (sub-surface) stormwater (rainfall) to the Providence River.

Project Location: Harbourside Boulevard
City/Town: Providence & Cranston
Plat/Lot: 56 & 2/4; 74, 347/3935, 3949
Waterway: Providence River

Plans of the proposed work may be seen at the CRMC office in Wakefield.

In accordance with the Administrative Procedures Act (Chapter 42-35 of the Rhode Island General Laws) you may request a hearing on this matter. You are advised that if you have good reason to enter protests against the proposed work it is your privilege to do so. It is expected that objectors will review the application and plans thoroughly, visit site of proposed work if necessary, to familiarize themselves with the conditions and cite what law or laws, if any, would in their opinion be violated by the work proposed.

This also serves as notice that the Rhode Island Department of Environmental Management, Office of Water Resources, Water Quality Certification Program has under consideration and review the same proposed activity as described above for compliance with the State's Water Quality Regulations (AUTHORITY: in accordance with Clean Water Act, as amended (33 U.S.C. 1251 et.seq.; Chapter 42-35 pursuant to Chapters 46-12 and 42-17.1 of the Rhode Island General Laws of 1956, as amended).

If you desire to protest, you must attend the scheduled hearing and give sworn testimony. A notice of the time and place of such hearing will be furnished you as soon as possible after receipt of your request for hearing. If you desire to request a hearing, to receive consideration, it should be in writing and be received at this office on or before **July 8, 2012.**

It is expected that objectors will review the application and associated plans thoroughly. Comments that pertain to this Joint Notice must be submitted in writing and must be addressed to Rhode Island Coastal Resources Management Council and Rhode Island Dept of Environmental Management at the above referenced addresses.



SOURCE: USGS TOPOGRAPHIC MAP

2000 0 2000 4000 Feet



35 Cedar Street | Suite 100
Providence, Rhode Island 02903
603.455.7007 | www.woodardcurran.com

COMMITMENT & INTEGRITY • DRIVEN RESULTS

SITE LOCUS

DESIGNED BY:
DRAWN BY:

CHECKED BY:
Aerial Map.dwg

JOHNSON & WALES UNIVERSITY
PROVIDENCE, RHODE ISLAND

ATHLETIC FIELDS
PROVIDENCE, RHODE ISLAND

JOB NO: 225037
DATE: MAY 2012
SCALE: AS SHOWN

Figure 1

NORTH

 <p>WOODWARD-CURRALL 95 Cedar Street Suite 100 Providence, Rhode Island 02903 800.955.7397 www.woodwardcurrall.com</p>	<p>COMMITMENT & INTEGRITY DRIVE RESULTS</p>	
	<p>DESIGNED BY: HCP CHECKED BY: JMG/JCS Watersheds (2012.05.11).dwg</p>	
<p>JOHNSON & WALES UNIVERSITY 8 ABBOTT PARK PLACE PROVIDENCE, RHODE ISLAND 02903</p>		
<p>JOHNSON & WALES ATHLETIC FIELDS HARBORSIDE BOULEVARD CRANSTON & PROVIDENCE, RI</p>		
<p>JOHNSON & WALES UNIVERSITY HARBORSIDE BOULEVARD CRANSTON & PROVIDENCE, RI</p>		

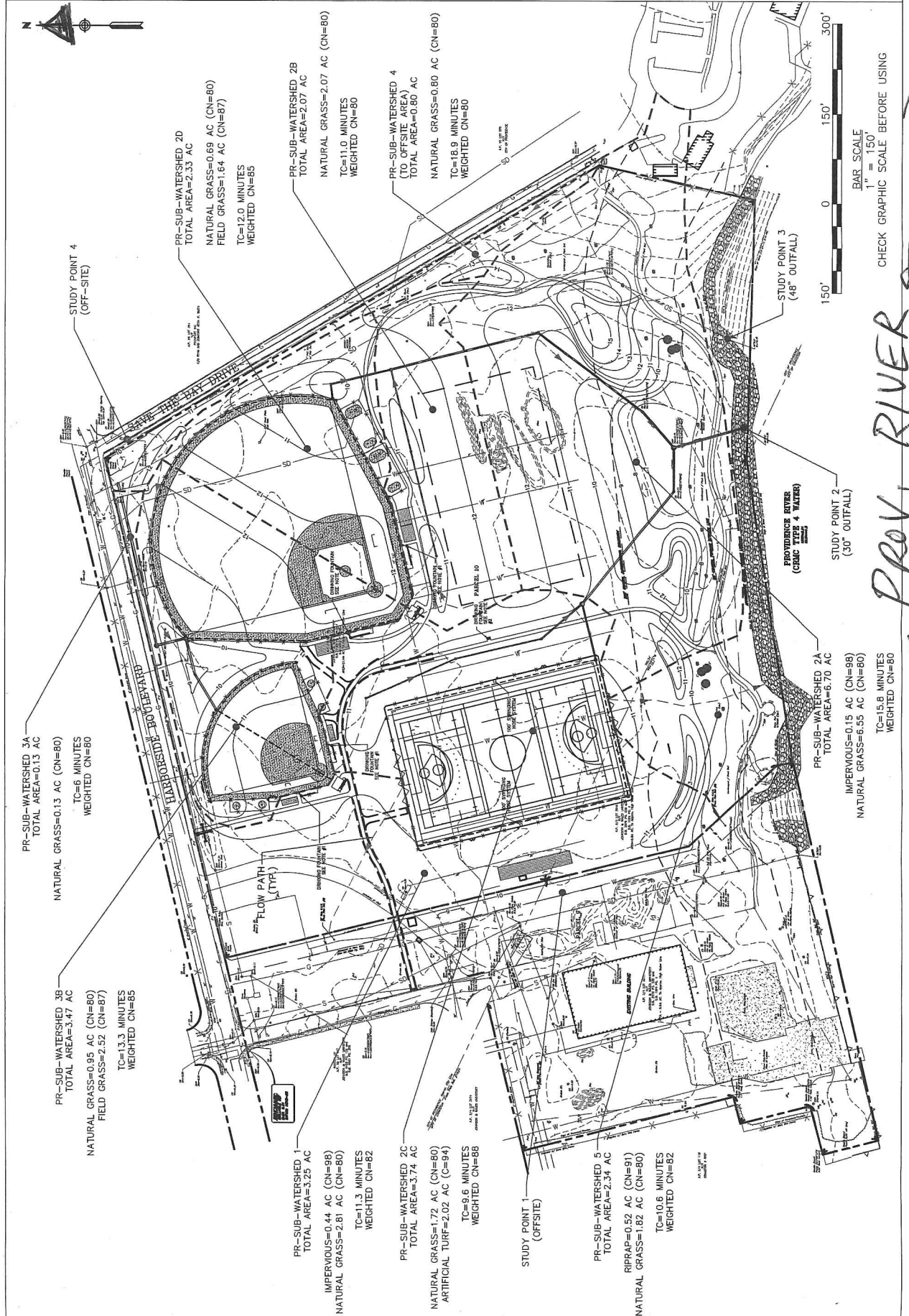

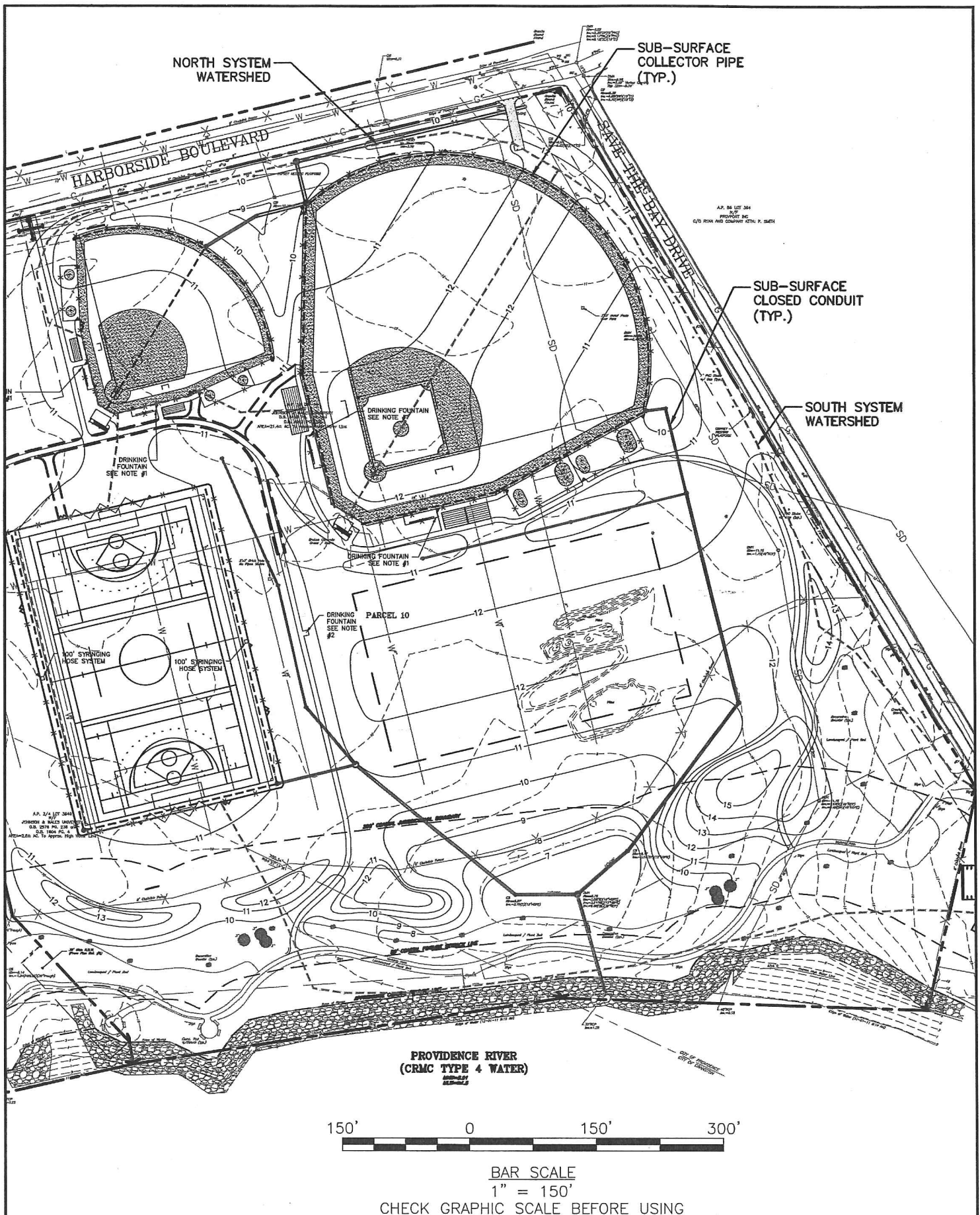

95 Cedar Street | Suite 100
Providence, Rhode Island 02903
800.955.7557 | www.woodardcurran.com

COMMITMENT & INTEGRITY DRIVE RESULTS

PROPOSED STORMWATER MANAGEMENT MEASURES

DESIGNED BY: HCP
DRAWN BY: HCP

CHECKED BY:
Watersheds (2012.05.11).dwg

JOHNSON & WALES UNIVERSITY
8 ABBOTT PARK PLACE
PROVIDENCE, RHODE ISLAND

JOHNSON & WALES UNIVERSITY
ATHLETIC FIELDS
CRANSTON & PROVIDENCE, RI

JOB NO: 225037
DATE: MAY 2012
SCALE: AS SHOWN

Figure 5

CRMC Mailing List for Johnson & Wales University
CRMC File Number 2012-05-066

Johnson & Wales University
8 Abbot Park Place
Providence, RI

Cranston A RIGP
c/o Patrick Conley
1445 Wampanoag Trail
Suite 203
E. Providence, RI 02915

City of Providence
25 Dorrance Street
Providence, RI 02903

Provport Inc.
35 Terminal Road
Suite 200
Providence, RI 02905

General List, Providence/Cranston

CRMC (2012-05-066)
O. S. Government Center
4808 Tower Hill Road
Wakefield, RI 02879



KA

Stedman Government Center; 4808 Tower Hill Road, Wakefield, RI 02879
(401)783-3370

Application for State Assent to perform work regulated by the provisions of Chapter 279 of the Public Laws of 1971 Amended.

		File No. <u>2012-05066</u>
Location No.	Street Harborside Boulevard	City/Town Providence & Cranston
Owner's Name Johnson & Wales University	Plat No. 56 & 2/4	Lot No. 74, 347/3935, 3949
Mailing Address 8 Abbott Park Place		Res. Tel. # _____
City/Town Providence & Cranston	State RI	Bus. Tel. # 401-598-4700
Contractor RI Lic. # _____	Address _____	Tel. No. _____
Designer Woodard & Curran	Address 95 Cedar St., Providence, RI 02903	Tel. No. 401-273-1007
Name of Waterway Providence River	Est. Project Cost \$ _____	Fee/Costs \$ 2,000.00

Have you or any previous owner filed an application for and/or received an assent for any activity on this property?
(If so please provide the file and/or assent numbers). M2008-09-623, A2006-07-012

APPLICANTS
IS THIS APPLICATION BEING SUBMITTED IN RESPONSE TO A COASTAL VIOLATION? ☐ YES ☒ NO
IF YES, YOU MUST INDICATE NOV OR C&D NUMBER _____

Name and Addresses of adjacent property owners whose property adjoins the project site. (Accurate addresses will ensure proper notification.)
- **Cranston A RIGP, c/o Patrick Conley, 1445 Wampanoag Trail, Suite 203, East Providence, RI 02915**
- **City of Providence, 25 Dorrance Street, Providence, RI 02903**
- **Provport Inc., #35 Terminal Road, Suite 200, Providence, RI 02905**

I hereby certify that the names and addresses of adjacent property owners whose property adjoins the project site are accurate and current as of the date of application. If said names and addresses are found to be not accurate and/or current, any subsequent Assent may become Null and Void.
Signed: _____

Describe accurately the work proposed. (A brief description must be provided below; however, additional sheets may be provided if necessary and attached to this form.)

Construction of an athletic field complex. The project includes four sports fields with amenities and landscaping. See Assent Application narrative.

Melvin G. DeCruz
Owner's Signature Sam V.P. Jacobus, Manager

NOTE: The applicant acknowledges by evidence of their signature that they have reviewed the Rhode Island Coastal Resources Management Program, and have, where possible, adhered to the policies and standards of the program. Where variances or special exceptions are requested by the applicant, the applicant will be prepared to meet and present testimony on the criteria and burdens of proof for each of these relief provisions. The applicant also acknowledges by evidence of their signature that to the best of their knowledge the information contained in the application is true and valid. If the information provided to the CRMC for this review is inaccurate or did not reveal all necessary information or data, then the permit granted under this application may be found to be null and void. Applicant requires that as a condition to the granting of this assent, members of the CRMC or its staff shall have access to the applicants property to make on-site inspections to insure compliance with the assent. This application is made under oath and subject to the penalties of perjury.

04/03