



Oliver Stedman Government Center
4808 Tower Hill Road; Suite 116
Wakefield, RI 02879
401-783-3370

PUBLIC NOTICE

File Number: 2013-03-216

Date: April 10, 2013

This office has under consideration the application of:

State of RI
Department of Environmental Management
Attn: James McGinn, P.E.
235 Promenade Street
Providence RI 02908

for a State of Rhode Island Assent to construct and maintain: a public boating access ramp. Work includes improvements to access road by widening to 24', placement of riprap on the side slopes, and an innovative living shoreline technique will be used on the north cove consisting of salt marsh plantings through a biodegradable erosion control blanket protected by a biodegradable coir log set at mean sea level. Approximately 6,000 square feet of salt marsh will be restored/created by this project. Project will require the dredging of 500 cubic yards of material. All suitable material will be used for roadway construction. The dredging will require a Special Exception (reference RICRMP Section 130) to a Prohibited Activity.

Project Location:	Gull Cove Fishing Area
City/Town:	Portsmouth
Plat/Lot:	8/3
Waterway:	Gull Cove Fishing Area

Plans of the proposed work may be seen at the CRMC office in Wakefield.

In accordance with the Administrative Procedures Act (Chapter 42-35 of the Rhode Island General Laws) you may request a hearing on this matter.

You are advised that if you have good reason to enter protests against the proposed work it is your privilege to do so. It is expected that objectors will review the application and plans thoroughly, visit site of proposed work if necessary, to familiarize themselves with the conditions and cite what law or laws, if any, would in their opinion be violated by the work proposed.

If you desire to protest, you must attend the scheduled hearing and give sworn testimony. A notice of the time and place of such hearing will be furnished you as soon as possible after receipt of your request for hearing. If you desire to request a hearing, to receive consideration, it should be in writing (**with your correct mailing address, e-mail address and valid contact number**) and be received at this office on or before May 10, 2013.

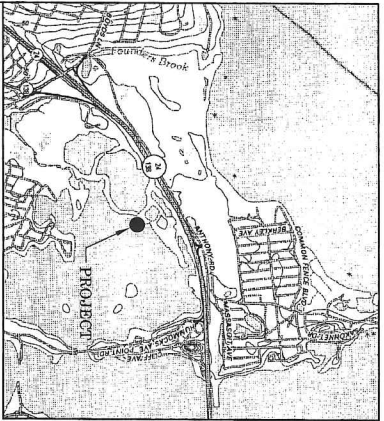

STATE OF RHODE ISLAND

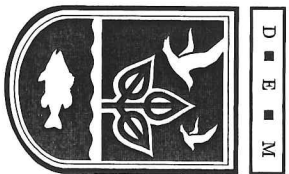

DEPARTMENT OF ENVIRONMENTAL MANAGEMENT

DIVISION OF PLANNING AND DEVELOPMENT

BOAT RAMP IMPROVEMENTS

GULL COVE FISHING AREA

PORTSMOUTH, RHODE ISLAND

P&D CONTRACT NUMBER 11-12

MARCH, 2013

- LIST OF DRAWINGS**
- C1 - EXISTING CONDITIONS AND DEMOLITION PLAN
 - C2 - PROPOSED SITE PLAN
 - C3 - BOAT RAMP PLAN
 - C4 - DREDGING PLAN
 - C5 - ACCESS ROAD AND MARSH PLANTING PLAN

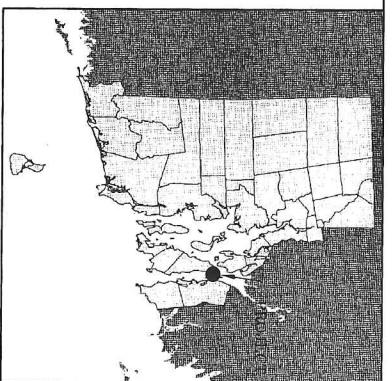

NOT FOR CONSTRUCTION

THIS SHEET IS PART OF THE CONTRACT DOCUMENTS WHICH INCLUDES
ALL DRAWINGS IN THE PLAN SET AND THE SPECIFICATIONS

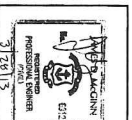

APPROVED BY: _____ RICKA CHIEF, DIVISION OF PLANNING & DEVELOPMENT	APPROVED BY: _____ RICKA CHIEF, OPERATING DIVISION
---	---



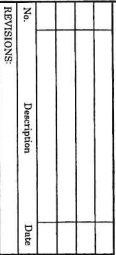

--

3/20/73

REGISTERED
PROFESSIONAL ENGINEER
(7242)

W.D. MACINN

6:10

GT
SHEET 2 OF 6



TIDE & FLOOD ELEVATIONS	
GULL COVE, PORTSMOUTH, RI	
HIGHW	4.62 FEET
HWY	3.75 FEET
NAVD88	2.07 FEET
MSL	1.73 FEET
MHW	0.0 FEET
MLLW	-1.9 FEET

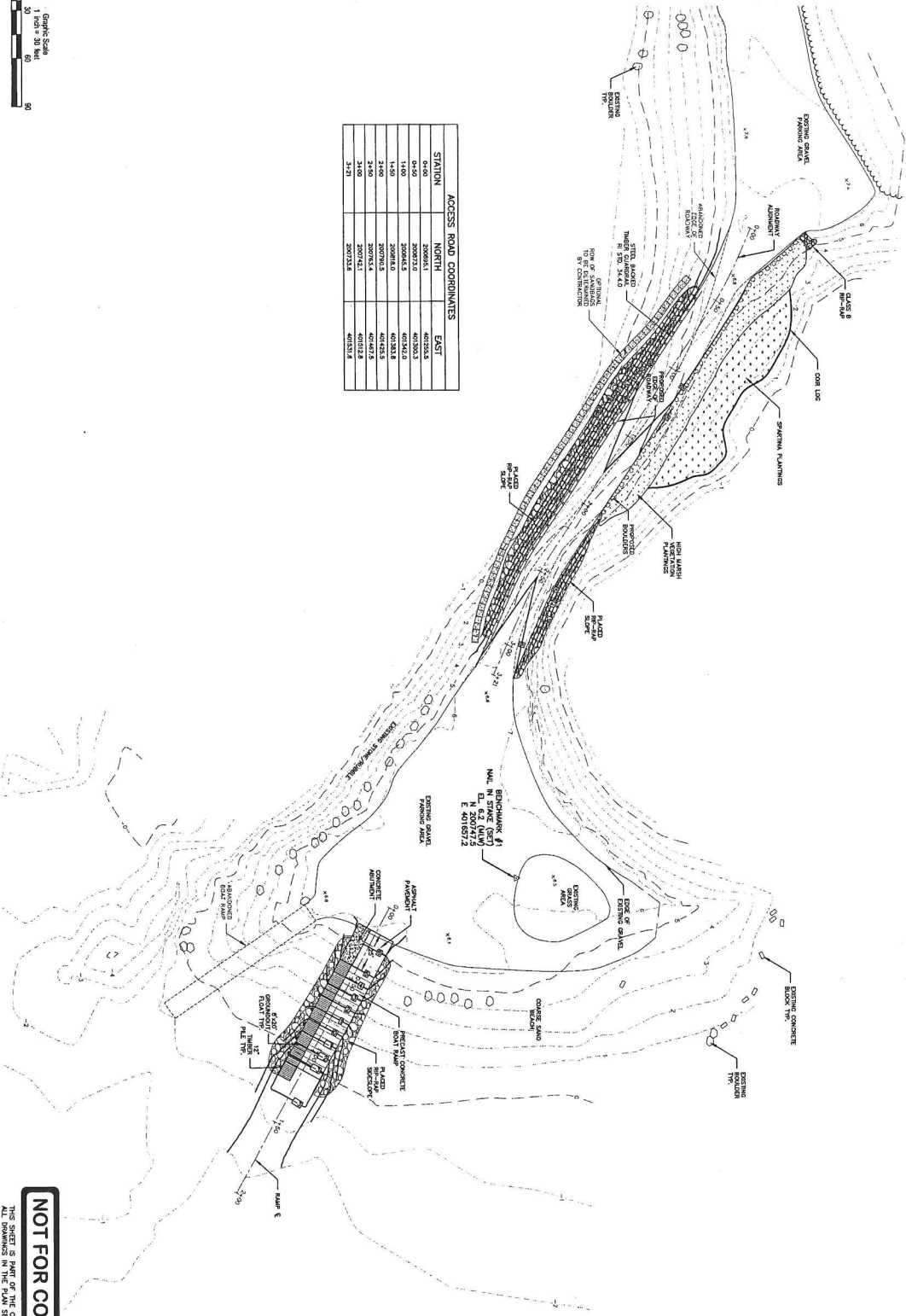

STATION	NORTH	EAST
0+00	200733.2	401303.3
1+00	200845.3	401343.0
2+00	200916.5	401383.8
3+00	200976.5	401424.5
4+00	201041.1	401465.2
5+00	201103.4	401505.9

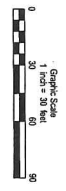

No.	Description	Date



STATE OF RHODE ISLAND
DEPARTMENT OF ENVIRONMENTAL MANAGEMENT
DIVISION OF PLANNING AND DEVELOPMENT

BOAT RAMP IMPROVEMENTS
GULL COVE FISHING AREA
PORTSMOUTH, RI

Drawn by: AFA
Checked by: JMD
Date: March, 2012
Scale: 1"=50'
Project No.: 11-12

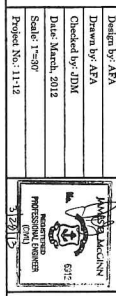

NOT FOR CONSTRUCTION
THIS SHEET IS PART OF THE CONTRACT DOCUMENTS WHICH INCLUDES ALL DRAWINGS IN THE PLAN SET AND THE SPECIFICATIONS



PROPOSED
SITE PLAN

C2
SHEET 3 OF 6

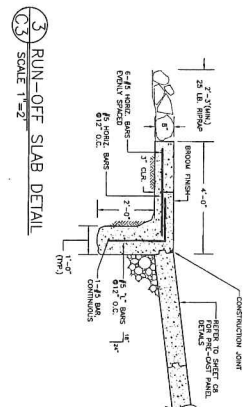
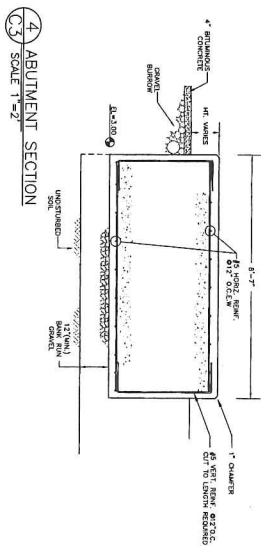
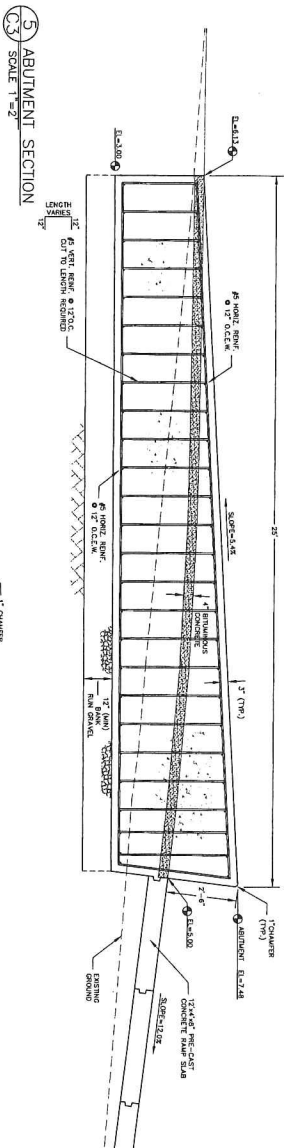
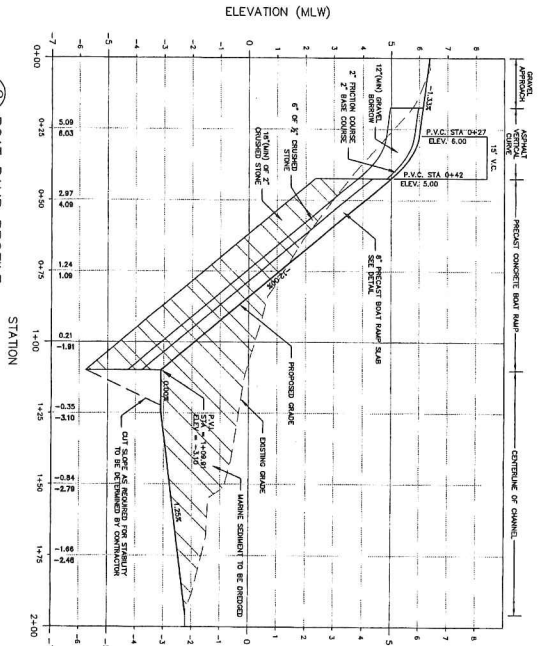
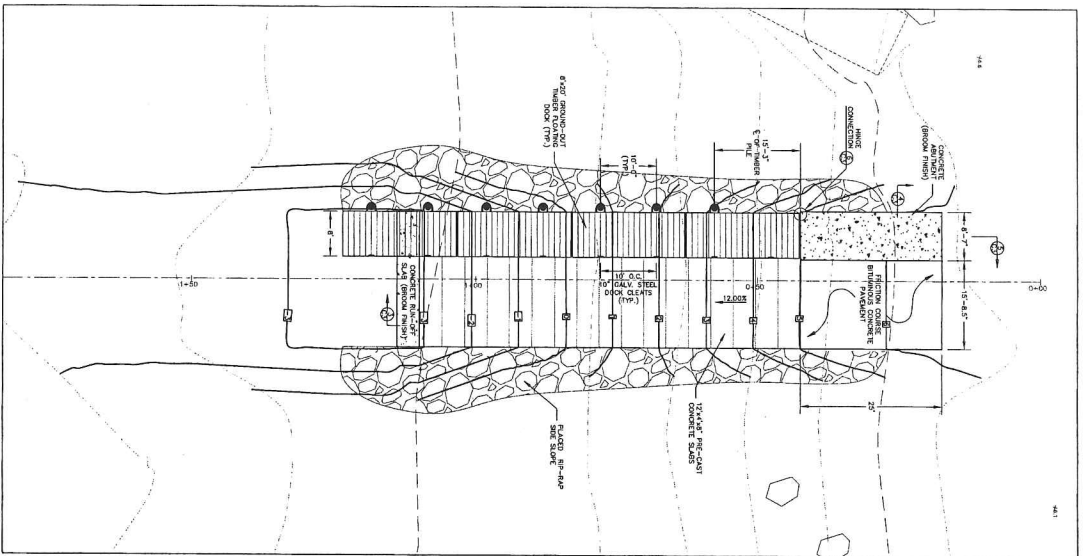

1 BOAT RAMP PLAN
SCALE 1"=10'

2 BOAT RAMP PROFILE
SCALE 1"=10' HORIZONTAL
1"=1' VERTICAL

3 ABUTMENT SECTION
SCALE 1"=2'

4 ABUTMENT SECTION
SCALE 1"=2'

5 RUN-OFF SLAB DETAIL
SCALE 1"=2'

6 HINGE CONNECTION DETAIL
SCALE 1"=1'

No.	Description	Date



STATE OF RHODE ISLAND
DEPARTMENT OF ENVIRONMENTAL MANAGEMENT
DIVISION OF PLANNING AND DEVELOPMENT

BOAT RAMP IMPROVEMENTS
GULL COVE FISHING AREA
PORTSMOUTH, RI

Designed by: ABA
Drawn by: ABA
Checked by: JDM
Date: March, 2013
Scale: As Noted
Project No.: 1112



BOAT RAMP PLAN

SHEET 4 OF 6

NOT FOR CONSTRUCTION

THIS SHEET IS PART OF THE CONTRACT DOCUMENTS WHICH INCLUDE
A. SPECIFICATIONS B. PLANS C. AND D. NOT TO SCALE





STATE OF RHODE ISLAND
DEPARTMENT OF ENVIRONMENTAL MANAGEMENT
DIVISION OF PLANNING AND DEVELOPMENT

BOAT RAMP IMPROVEMENTS
GULL COVE FISHING AREA
PORTSMOUTH, RI

Design by: AFA
Drawn by: AFA
Checked by: JDN
Date: March, 20
Scale: 1"=20'
Project No.: 11-1

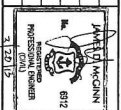

DREDGING PLAN

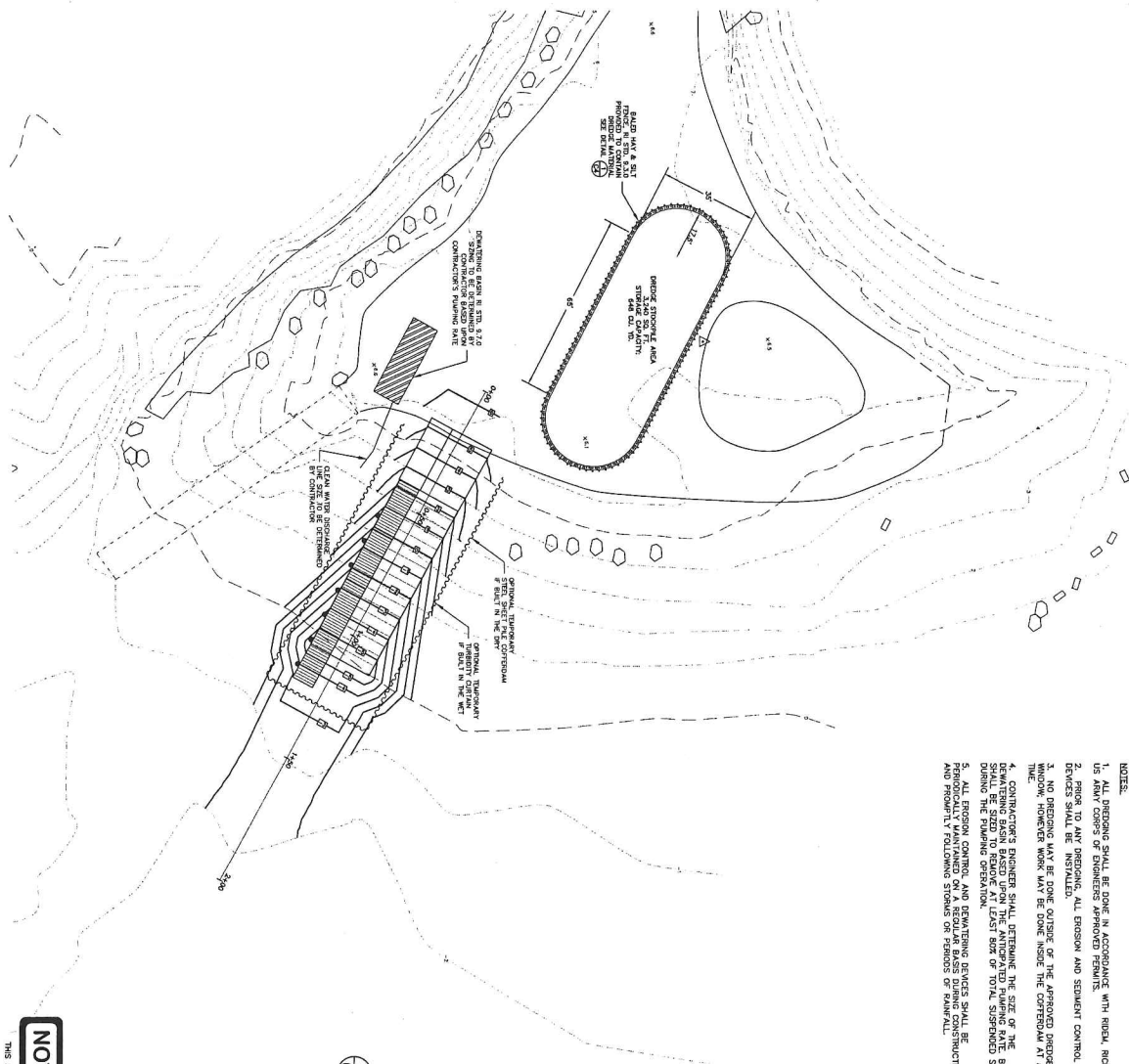
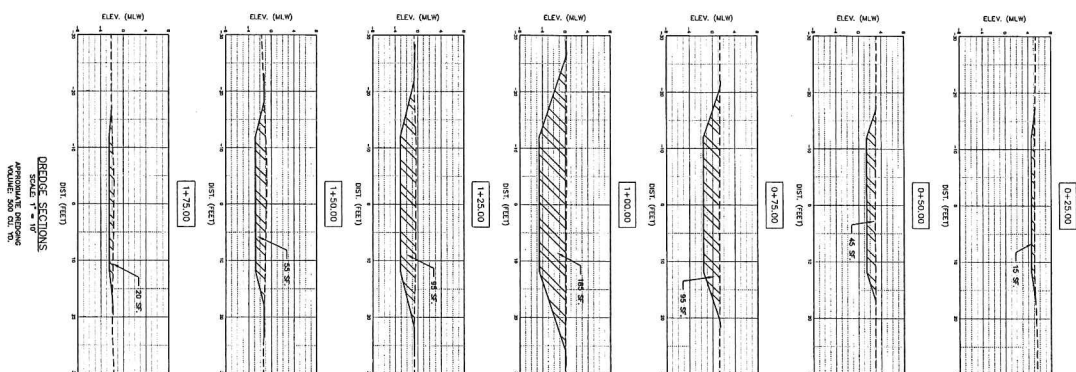
C4
SHEET 5 OF 6

1. ALL BREIDING SHALL BE DONE IN ACCORDANCE WITH RULES, REGULATIONS AND ORDINANCES OF THE GOVERNMENT OF INDIA.
2. PRIOR TO ANY BREIDING, ALL EROSION AND SEDIMENT CONTROL DEVICES SHALL BE INSTALLED.
3. NO BREIDING MAY BE DONE OUTSIDE OF THE APPROVED BREIDING ZONE. HOWEVER WORK MAY BE DONE INSIDE THE CORRIDOR AT ANY TIME.
4. CONTRACTOR'S ENGINEER SHALL DETERMINE THE SIZE OF THE BREIDING ZONE. THE BREIDING ZONE SHALL BE DESIGNED TO REDUCE AT LEAST 80% OF TOTAL SUFFICIENT DURING THE PLANNING OPERATION.
5. ALL EROSION CONTROL, AND DRAINAGE DEVICES SHALL BE PERIODICALLY MAINTAINED ON A REGULAR BASIS DURING CONSTRUCTION AND PROBABLY FOLLOWING STORMS OR PERIODS OF RAINFALL.

RECOMMENDED DREDGING SEQUENCE

- [illegible]

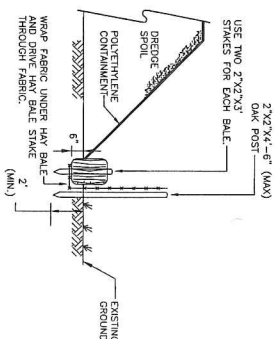

1 BALED HAY & SILT FENCE DETAIL
C4 NOT TO SCALE

NOT FOR CONSTRUCTION



THIS SHEET IS PART OF THE CONTRACT DOCUMENTS WHICH INCLUDES
ALL CONDITIONS OF BIDDING, SPECIFICATIONS, AND DRAWINGS.

- | QTY | BOTANICAL NAME | FORMING | |
|-------|-----------------------|----------------------|----------------------|
| | | COMMON NAME | SIZE |
| 2,000 | SPARTINA ALTERNIFLORA | SMOOTH COROPLAST | 2" PLUGS
12" O.C. |
| 1,000 | SPARTINA PATENS | SALICORN COROPLAST | 2" PLUGS
12" O.C. |
| 1,000 | SORGHUM ALLOPUS | SALICORN BLOUSE | 2" PLUGS
12" O.C. |
| 1,000 | DIPTERIS SPECIOSA | SEALANDER SALTPRILLS | 2" PLUGS
12" O.C. |