



Oliver Stedman Government Center  
4808 Tower Hill Road; Suite 116  
Wakefield, RI 02879  
401-783-3370

### PUBLIC NOTICE

File Number: 2013-04-107

Date: May 7, 2013

This office has under consideration the application of:

Antonio Pinheiro  
161 Beacon Ave  
Jamestown, RI 02835

for a State of Rhode Island Assent to construct and maintain: an oyster farm using submerged cages off of Heads Beach Jamestown; abridged information from the application is attached.

Project Location:	West Passage
City/Town:	Jamestown
Waterway:	West Passage Narragansett Bay

Plans of the proposed work may be seen at the CRMC office in Wakefield.

In accordance with the Administrative Procedures Act (Chapter 42-35 of the Rhode Island General Laws) you may request a hearing on this matter.

You are advised that if you have good reason to enter protests against the proposed work it is your privilege to do so. It is expected that objectors will review the application and plans thoroughly, visit site of proposed work if necessary, to familiarize themselves with the conditions and cite what law or laws, if any, would in their opinion be violated by the work proposed.

If you desire to protest, you must attend the scheduled hearing and give sworn testimony. A notice of the time and place of such hearing will be furnished you as soon as possible after receipt of your request for hearing. If you desire to request a hearing, to receive consideration, it should be in writing (**with your correct mailing address, e-mail address and valid contact number**) and be received at this office on or before June 7, 2013

### OPERATIONAL PLAN:

We plan to use a grow out system that is almost identical to any lobster, fish or conch pot trawl you would already find in the bay. There will be 9 total trawls of wire mesh holding cages the size of small lobster traps (3'x2'x15") as well as some lower profile traps 2'x20"x1' (LxWxH), set on the bottom and attached by sinking line. Inside the cages will be plastic mesh bags full of juvenile oysters. There will be small cement blocks, not exceeding the height of the traps (15"x15"x12"), on both ends of each trawl to help keep the cages stationary.

All juvenile oysters, including seed will be purchased in accordance with CRMC health and safety guidelines. We will be purchasing a variety of sizes of oysters from seed up to 2 1/2". We will keep records of every seed and juvenile oyster we buy as well as keep track of where they are in the farm. Once the farm is started, we expect to have oysters ready for distribution after approximately 6 months.

We will be accessing the sight using a 24', shallow draft, center console boat as well as by wading in the water to haul, inspect, clean and organize the gear/oysters. Once the oysters have reached market size they will be offered for sale to the shellfish distributors. We will also apply for a shellfish dealers license so we can sell at local events as well as to the public in general and restaurants.

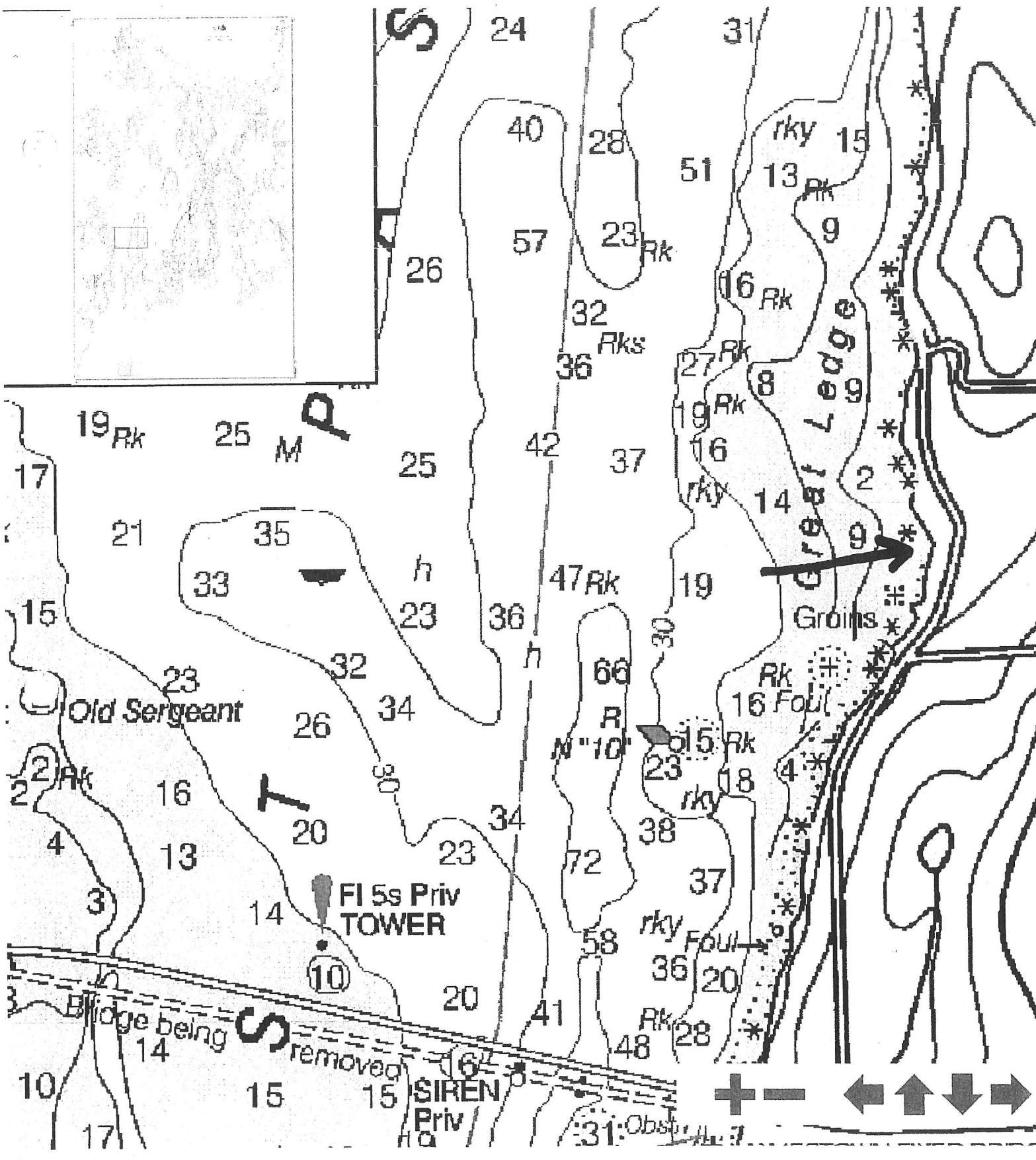

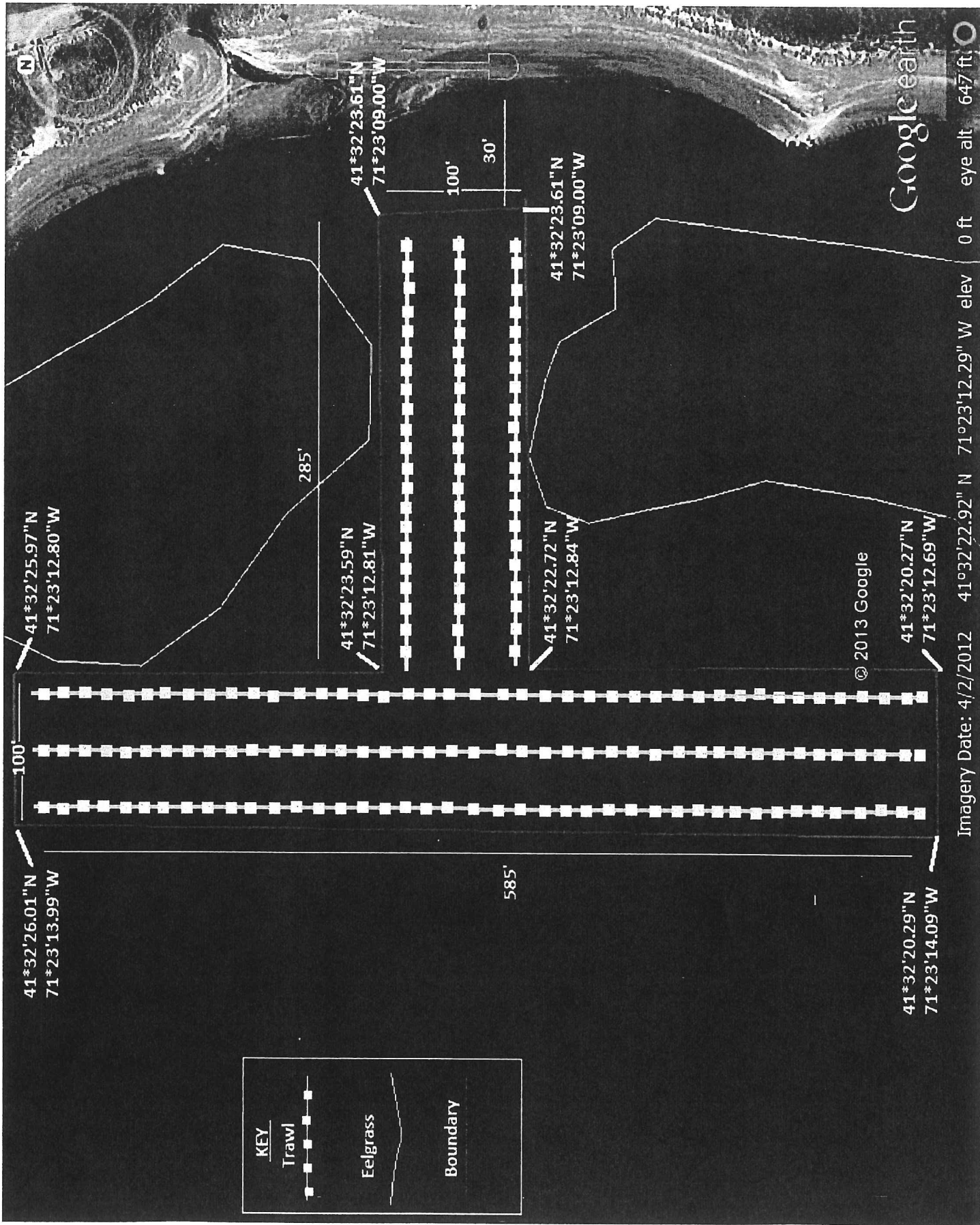



3'

2'

4" Deep

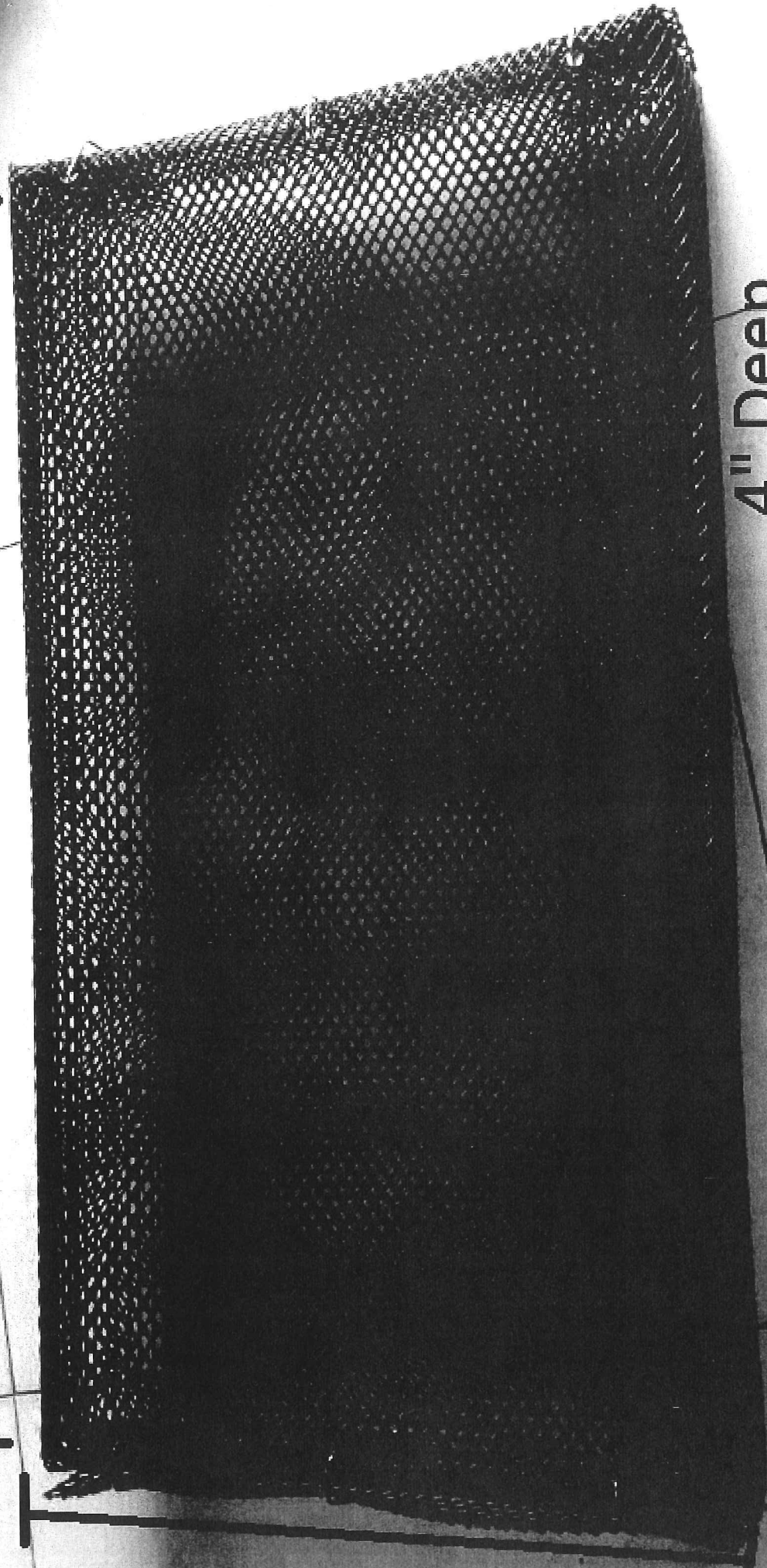

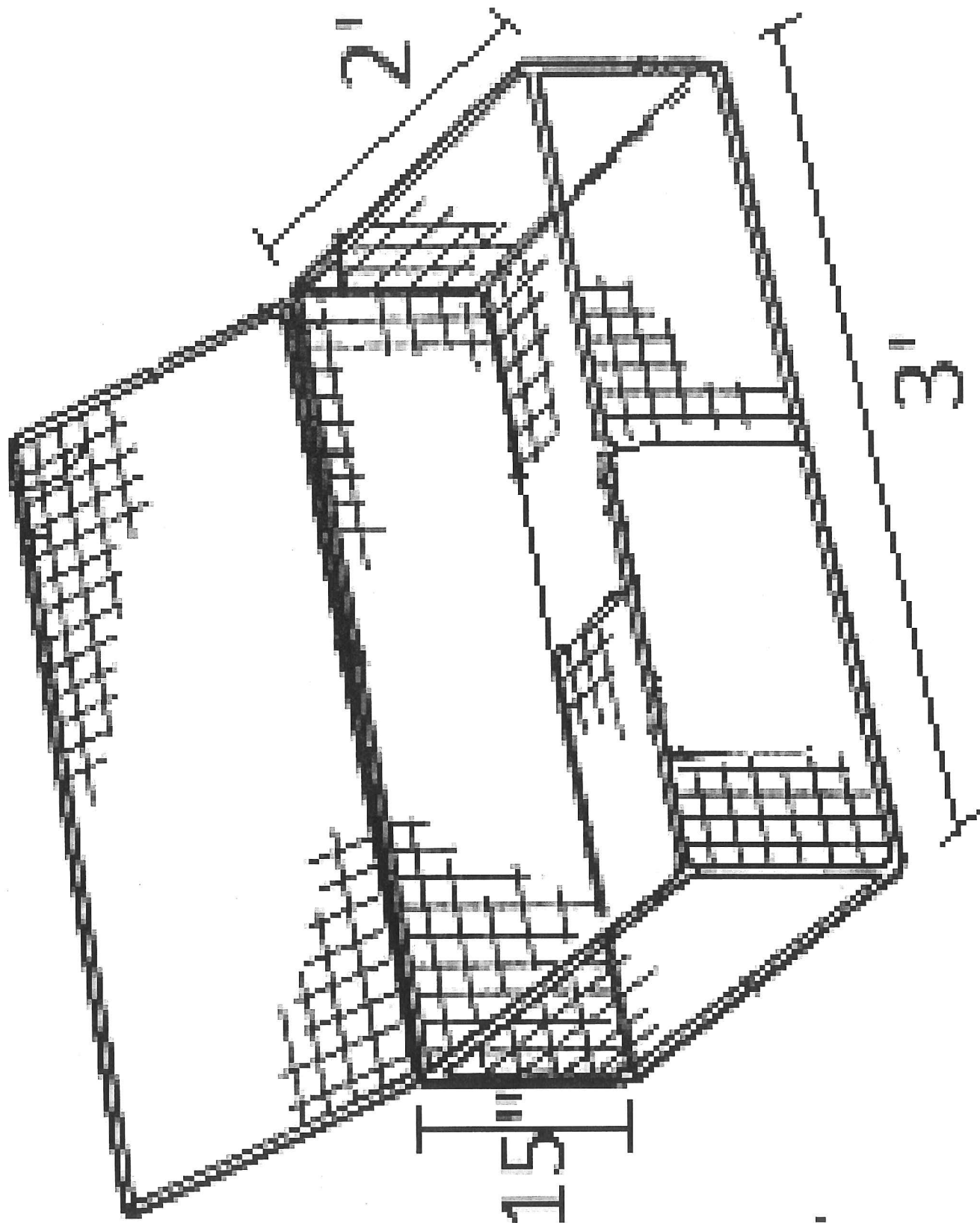

**Section 300.**  
**In Tidal and Coastal Pond Waters, on Shoreline Features,**  
**and Their Contiguous Areas**  
**Section 300.1**  
**Category B Requirements**

**ANSWERS:**

1. Aquaculture can be very beneficially when done right. Not only are we growing oysters to distribute as food but the farm also has the potential for creating jobs in this weak economy.
2. Not Applicable
3. The lease will be located in Jamestown, RI. It will be a minimum of 30 feet from shore. There is one house in the vicinity but impact will be minimal as this is a mainly, underwater operation. We have accessed the site countless numbers of times for over 21 years and it is not a spot known for any type of fishing, shell fishing, swimming or any boating activities.
4. This type of operation is not known to cause erosion. No shellfish discards will be left on the site.
5. The farm should help bring back the Oyster population in the area giving people the chance to harvest on their own.
6. We have accessed the site countless numbers of times for over 21 years. It is not a spot known for fishing, shellfishing, swimming or boating activities.
7. The traps are very low profile leaving more than adequate room for proper circulation. They will be stationary so sediment should not be a factor.
8. Not applicable to Oyster growing
9. Not applicable
10. We have accessed the site countless numbers of times for over 21 years. It is not a spot known for any type of fishing, shell fishing, swimming or any boating activities
11. All cages, rope, and blocks will be underwater minimizing visual impact significantly