



Oliver Stedman Government Center
4808 Tower Hill Road; Suite 116
Wakefield, RI 02879
401-783-3370

PUBLIC NOTICE

File Number: 2013-11-092

Date: January 23, 2014

This office has under consideration the application of:

Richard Button
74 Willow Creek Lane
Newark, DE 19711

for a State of Rhode Island Assent to construct and maintain: A residential boating facility consisting of a fixed 4' x 12' timber pier leading to a ramp and 6' x 20' (120sf) terminal float. The entire facility is proposed to extend ~30' seaward of the cited MLW mark and is proposed in the former location of a previous dock.

Project Location:	93 Riverside Drive
City/Town:	South Kingstown
Plat/Lot:	35-1 / 23
Waterway:	Narrow River

Plans of the proposed work may be seen at the CRMC office in Wakefield.

In accordance with the Administrative Procedures Act (Chapter 42-35 of the Rhode Island General Laws) you may request a hearing on this matter.

You are advised that if you have good reason to enter protests against the proposed work it is your privilege to do so. It is expected that objectors will review the application and plans thoroughly, visit site of proposed work if necessary, to familiarize themselves with the conditions and cite what law or laws, if any, would in their opinion be violated by the work proposed.

If you desire to protest, you must attend the scheduled hearing and give sworn testimony. A notice of the time and place of such hearing will be furnished you as soon as possible after receipt of your request for hearing. If you desire to request a hearing, to receive consideration, it should be in writing (**with your correct mailing address, e-mail address and valid contact number**) and be received at this office on or before February 23, 2014.

CRMC Mailing List for RichardButton
CRMC File Number 2013-11-092

Richard Button
74 Willow Creek Lane
Newark, DE 19711

Timothy Conley
87 Riverside Dr
S. Kingstown, RI 02879

Stephen & Patricia Gentile
99 Riverside Dr
S. Kingstown, RI 02879

Town List, South Kingstown

CRMC (2013-11-092)
O. S. Government Center
4808 Tower Hill Road
Wakefield, RI 02879

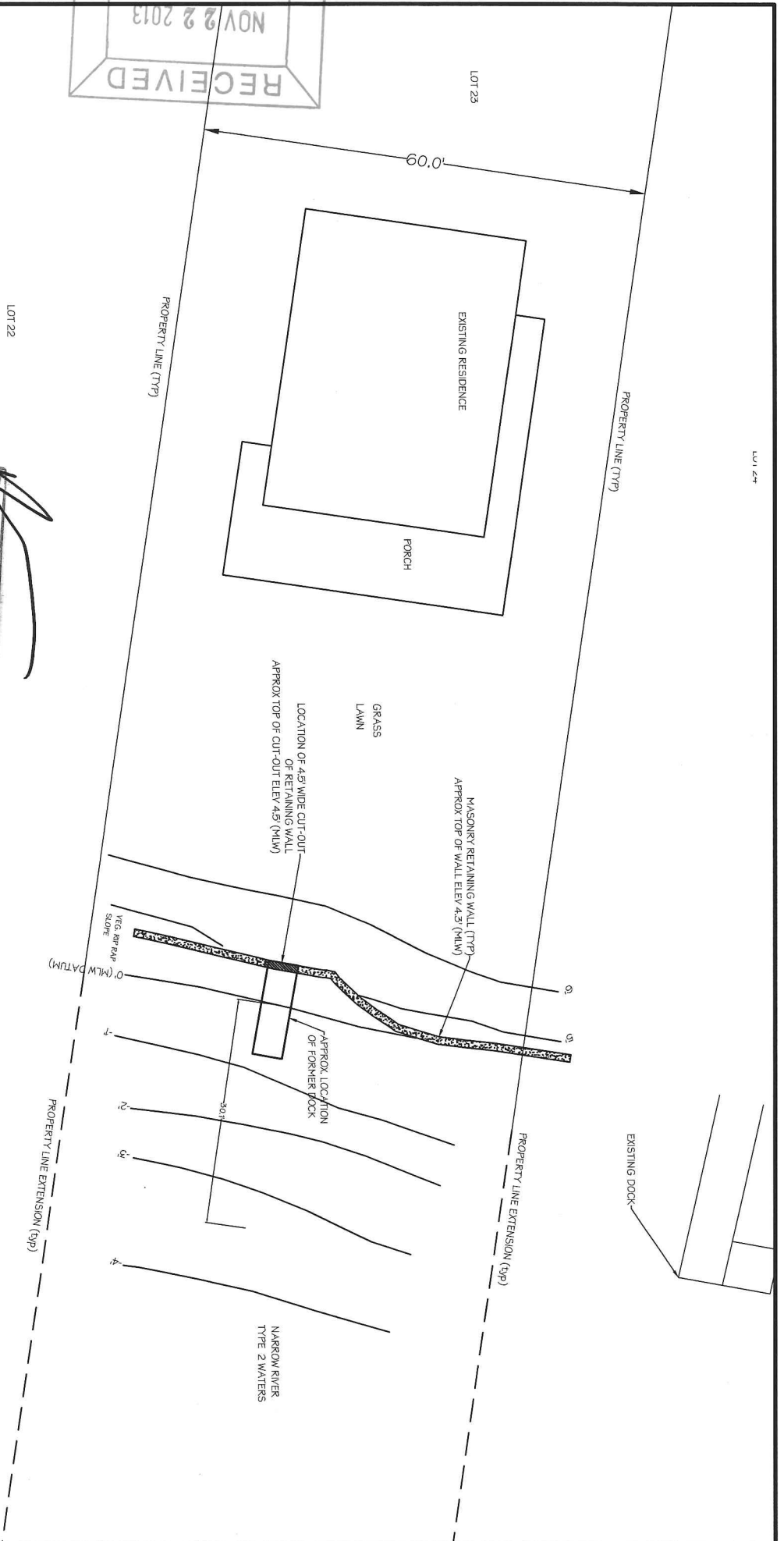
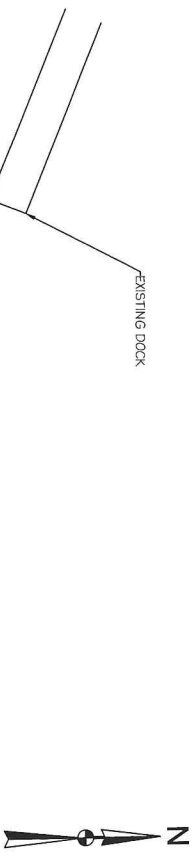
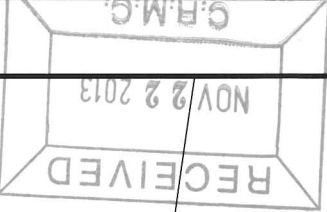

PREPARED BY: **RUSSELL MORGAN P.E.**
49 POND STREET
WAKEFIELD, RHODE ISLAND 02879
(401) 474-8550

PREPARED FOR:
ELITE CONST & REMODELING

PROPOSED REPLACEMENT DOCK
93 RIVERSIDE DRIVE

NARRAGANSETT, RI 02882

EXISTING CONDITIONS

NO.		ISSUE/DESCRIPTION		BY	DATE

PROJ. NO.	DATE	FIGURE
DESIGNED BY: RJM	OCT 2013	2
REVIEWED BY:	PROJECT NO. 13-001	
DRAWN BY:	REVISION NO.	
CHECKED BY:		
SCALE: 1" = 20'		SHEET NO.

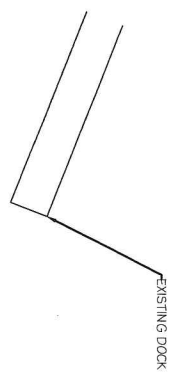
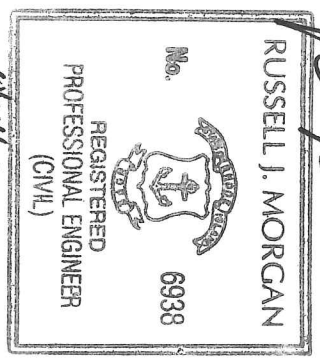
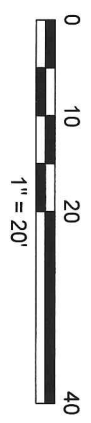
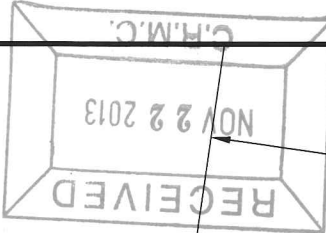

LOT 22

LOT 23

PROPERTY LINE (TYP)

PROPERTY LINE (TYP)

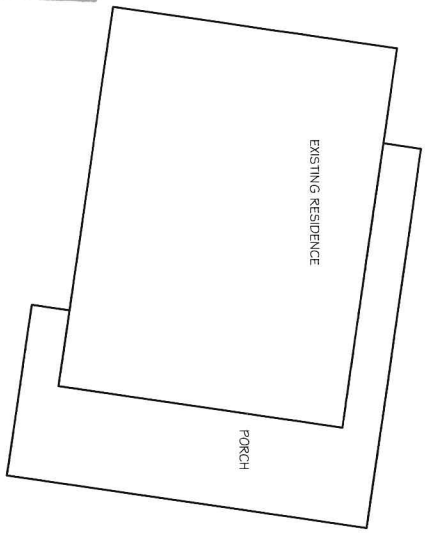

EXISTING RESIDENCE

PORCH

GRASS
LAWN

LOCATION OF 4.5' WIDE CUT-OUT
OF RETAINING WALL
APPROX TOP OF CUT-OUT ELEV 4.5' (MLW)

MASONRY RETAINING WALL (TYP)
APPROX TOP OF WALL ELEV 4.5' (MLW)

VEG RIP RAP
SLOPE

3' WIDE BY
7' LONG RAMP

4' WIDE BY
12' FIXED PIER

6' X 20' FLOAT

NARROW RIVER
TYPE 2 WATERS

PROPERTY LINE EXTENSION (TYP)

PROPERTY LINE EXTENSION (TYP)

EXISTING DOCK

NO.		ISSUE/DESCRIPTION		BY	DATE

PREPARED BY: **RUSSELL MORGAN P.E.**
49 POND STREET
WAKEFIELD, RHODE ISLAND 02879
(401) 474-9550

PREPARED FOR: **ELITE CONST. & REMODELING**

PROPOSED DOCK REPLACEMENT
93 RIVERSIDE DRIVE
SOUTH KINGTOWN, RI

PROPOSED DOCK LAYOUT		FIGURE	

PROJ. MGR:	DATE	BY	DATE
DESIGNED BY: RAM	OCT 2013		
REVIEWED BY:	PROJECT NO.		
DRAWN BY:	13-001		
CHECKED BY:	REVISION NO.		
SCALE: 1" = 30'			

RECEIVED
NOV 22 2013

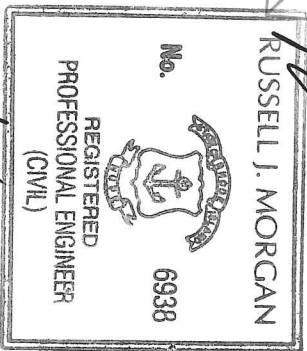

10/24/13

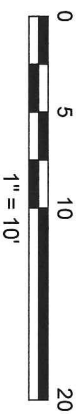
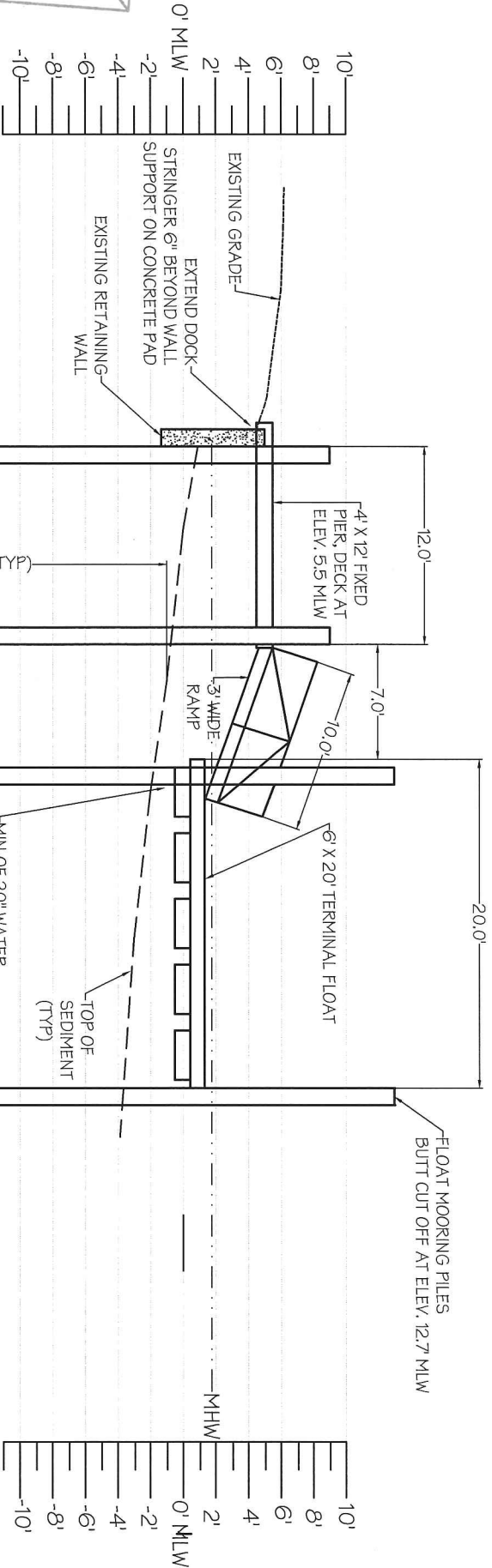

PREPARED BY: RUSSELL MORGAN P.E.

49 POND STREET
WAKEFIELD, RHODE ISLAND 02879
(401) 474-9850

PREPARED FOR:
ELITE CONST. & REMODELING

PROPOSED REPLACEMENT DOCK 93 RIVERSIDE DRIVE SOUTH KINGSTOWN, RI

PROPOSED DOCK SECTION

NO.		ISSUE/DESCRIPTION		BY	DATE

PROJ. MGR:	DATE	FIGURE
DESIGNED BY: RJM	OCT 2013	4
REVIEWED BY:	PROJECT NO. 13-002	
DRAWN BY:	REVISION NO.	
CHECKED BY:		
SCALE: 1" = 10'		SHEET NO.