



Oliver Stedman Government Center
4808 Tower Hill Road; Suite 116
Wakefield, RI 02879
401-783-3370

PUBLIC NOTICE

File Number: 2013-12-025

Date: March 27, 2014

This office has under consideration the application of:

Laurie Byrnes Bosman, Trustee
152 Beacon Avenue
Warwick, RI 02889

for a State of Rhode Island Assent to: add an extension to an existing dock. The terminus end will consist of an "L" platform with tie off piles. The facility will extend 61' beyond mean low water; also install a boat lift on the north side of the fixed pier. A variance to RICRMP 300.4.E.3(L) is required (standard beyond MLW is 50'; 61' proposed).

Project Location:	152 Beacon Ave
City/Town:	Warwick
Plat/Lot:	385 / 61
Waterway:	Narragansett Bay

Plans of the proposed work may be seen at the CRMC office in Wakefield.

In accordance with the Administrative Procedures Act (Chapter 42-35 of the Rhode Island General Laws) you may request a hearing on this matter.

You are advised that if you have good reason to enter protests against the proposed work it is your privilege to do so. It is expected that objectors will review the application and plans thoroughly, visit site of proposed work if necessary, to familiarize themselves with the conditions and cite what law or laws, if any, would in their opinion be violated by the work proposed.

If you desire to protest, you must attend the scheduled hearing and give sworn testimony. A notice of the time and place of such hearing will be furnished you as soon as possible after receipt of your request for hearing. If you desire to request a hearing, to receive consideration, it should be in writing (**with your correct mailing address, e-mail address and valid contact number**) and be received at this office on or before April 27, 2014.

RECEIVED

DEC 10 2013

C.R.M.C.

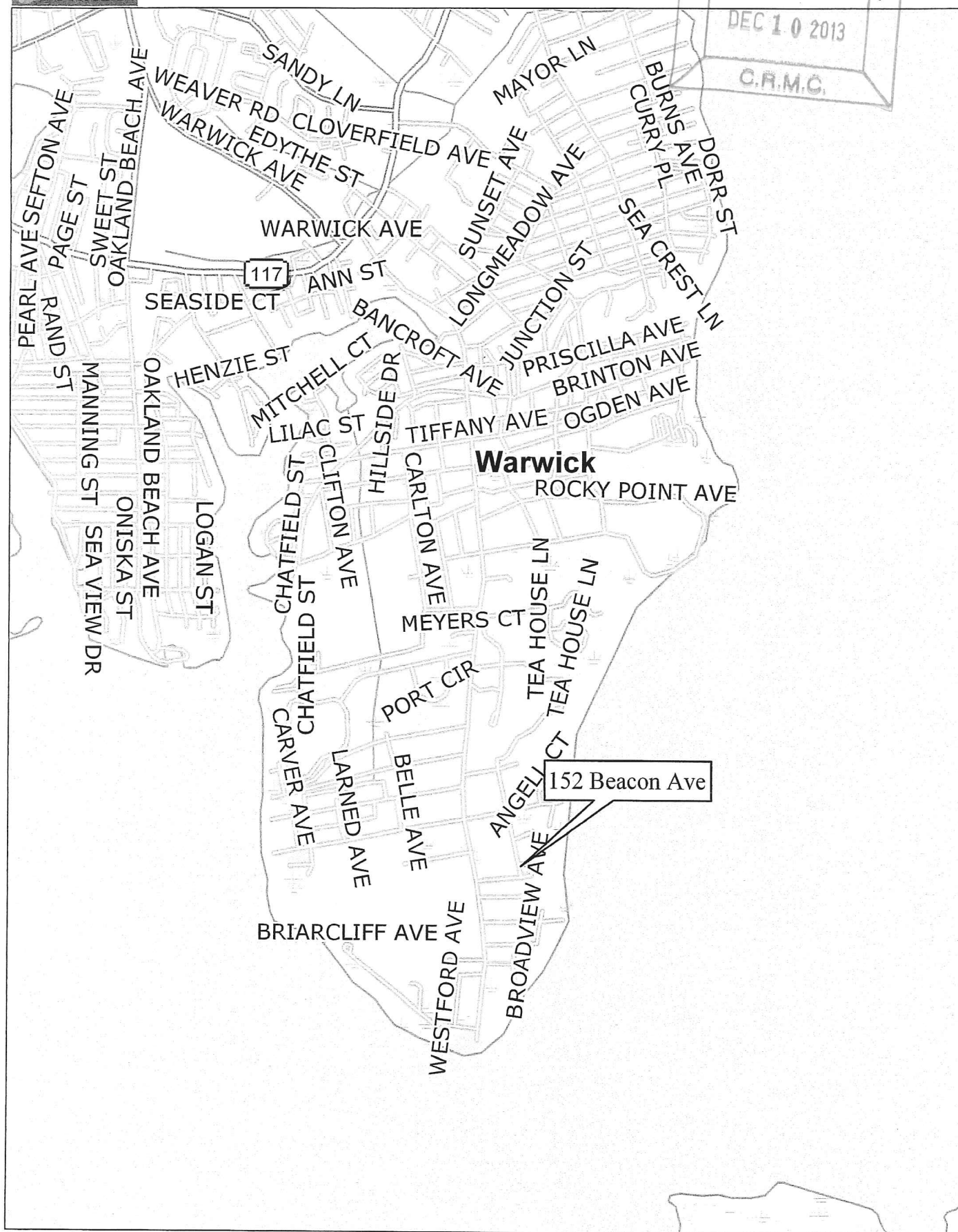

Data use subject to license.

© 2006 DeLorme. Topo USA® 6.0.

www.delorme.com

Scale 1 : 25,000

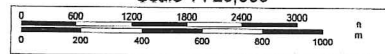
$$1'' = 2,083.3 \text{ ft}$$

Data Zoom 12-0

Locus Map
Kend Bosman

152 Beacon Ave
Warwick, RI

By: WFA

RECEIVED
DEC 10 2013
C.R.M.C.

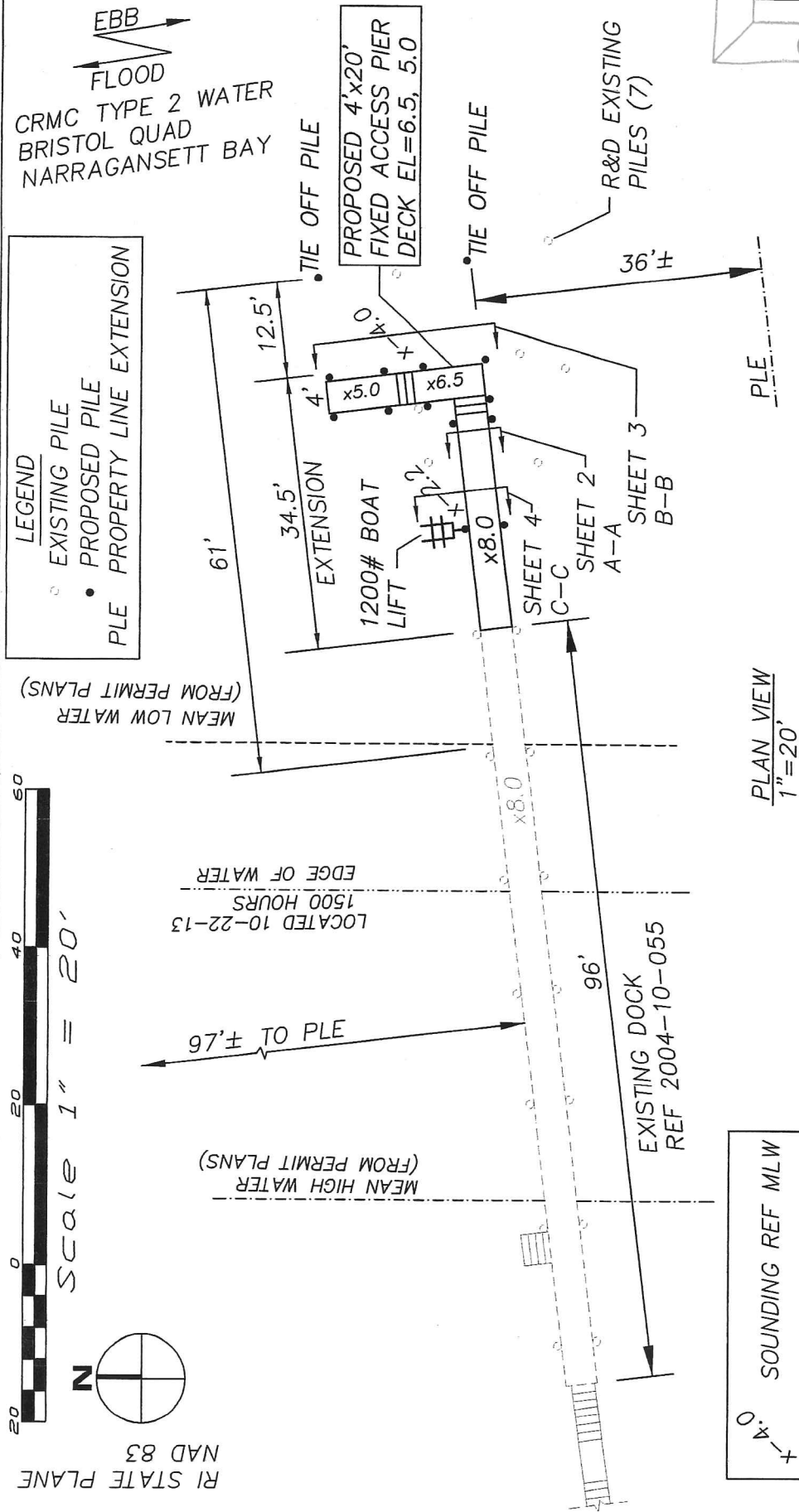

PLAN TO ACCOMPANY CRMC MODIFICATION APPLICATION
RUUD BOSMAN (LAURIE BYRNES BOSMAN TRUSTEE)
152 BEACON AVE., WARWICK, RI 02889
AP 385, LOT 61
BY: WARREN HALL, CIVIL ENGINEER
DECEMBER 5, 2013 SHEET 1 OF 4

WARREN F HALL
No. 13
REGISTERED
PROFESSIONAL ENGINEER

RECEIVED

DEC 10 2013

C.R.M.C.

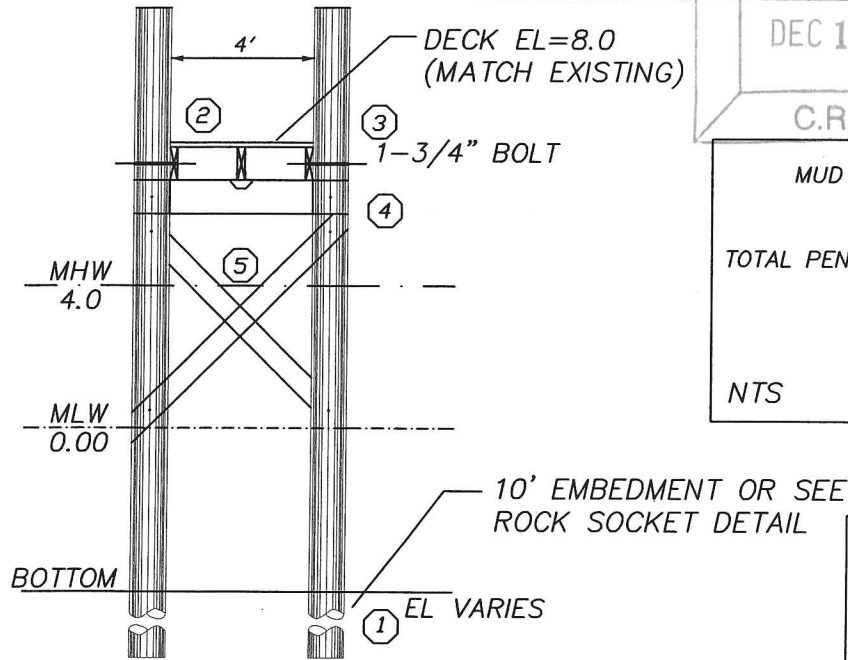

SECTION A-A THRU MAIN DOCK
3/16"=1'-0"

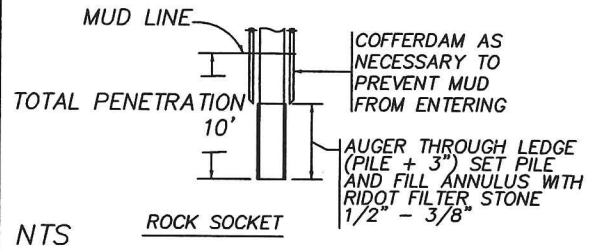

- ① 10" TIP CCA TREATED WOOD PILES
TREAT TO 2.5 PCF (1.0 ALLOWED WITH
OWNER CONSENT)
- ② 2x6 DECKING ACQ TREATED TO .6 PCF
FASTEN TO STRINGERS WITH 2 16d
SPIRAL SHANK NAIL
- ③ 3x12 STRINGER, THRU BOLT AT PILE
FASTEN MIDDLE STRINGER WITH SIMPSON
H-1 HURRICANE ANCHOR
- ④ 2-3x12 CAP BEAM, ACQ TREATED TO
.6 PCF
- ⑤ 3x10 CROSS BRACE, ACQ TREATED TO
.8 PCF

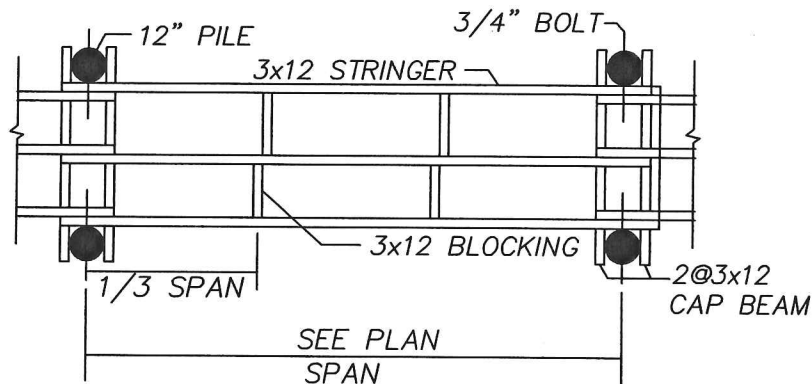

PLAN VIEW TYPICAL FRAMING

CROSS SECTIONS AND DETAILS

PLAN TO ACCOMPANY CRMC MODIFICATION APPLICATION
RUUD BOSMAN (LAURIE BYRNES BOSMAN TRUSTEE)
152 BEACON AVE., WARWICK, RI 02889
AP 385, LOT 61
BY: WARREN HALL, CIVIL ENGINEER
DECEMBER 5, 2013 SHEET 2 OF 4

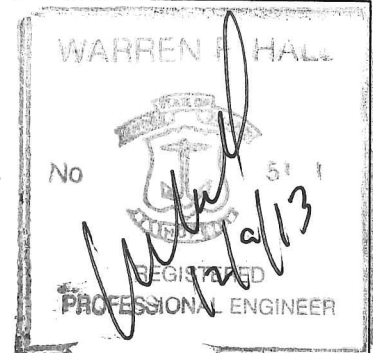

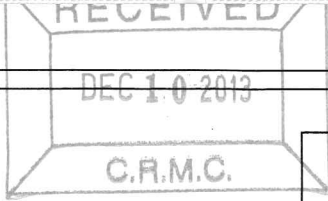

PROPOSED
1200 POUND
BOAT LIFT

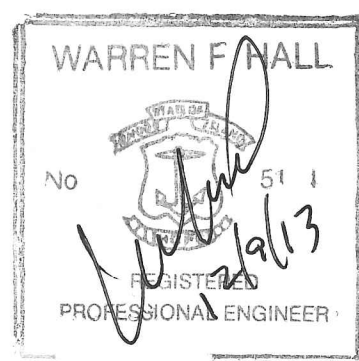

SECTION B-B

PLAN TO ACCOMPANY CRMC MODIFICATION APPLICATION
RUUD BOSMAN (LAURIE BYRNES BOSMAN TRUSTEE)
152 BEACON AVE., WARWICK, RI 02889
AP 385, LOT 61
BY: WARREN HALL, CIVIL ENGINEER
DECEMBER 5, 2013 SHEET 3 OF 4

N: 215744.8
E: 362580.3

5/4x6 DECK

OPEN GRATE
DECK

N: 215764.6
E: 362577.9

CROSS BRACE FIXED ACCESS
PILES IN ALL DIRECTIONS

PLAN VIEW
3/16"=1'-0"

5/4x6 WOOD DECK EL=6.5

TOP PLATFORM
PILE EL=9.5

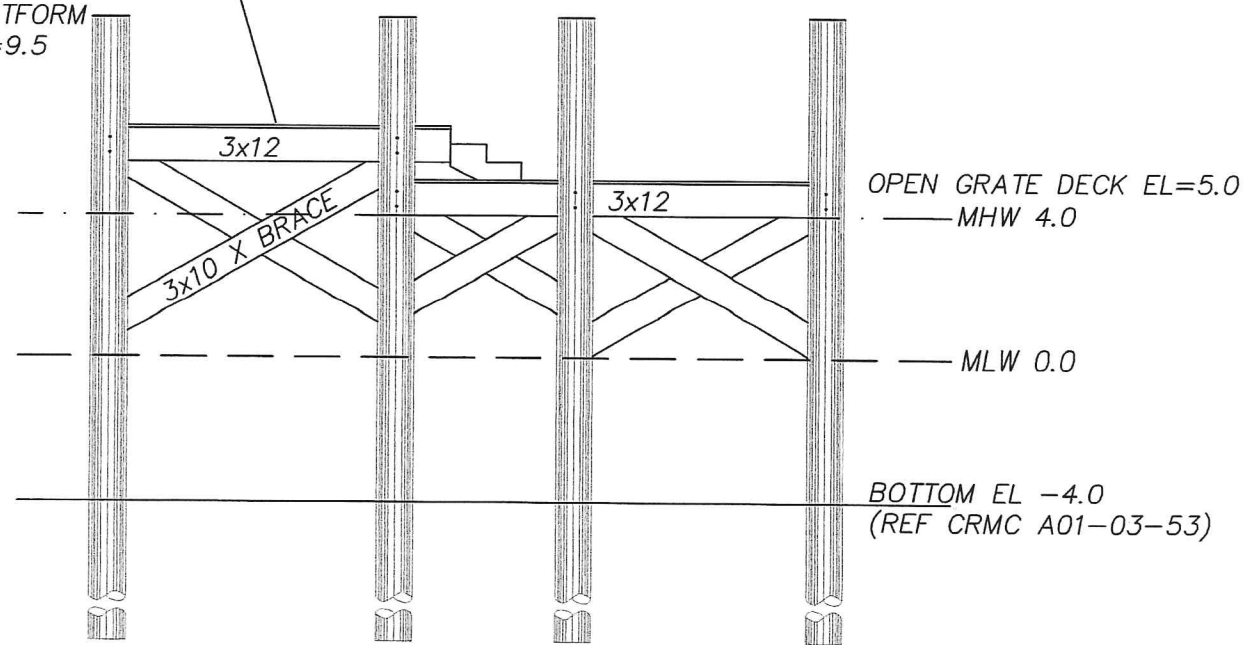

PROFILE VIEW SECTION B-B
3/16"=1'-0"

NEW PILES TOP ELEVATION
MATCH EXISTING PILE TOP
= 11.8

DECK EL=8.0
(MATCH EXISTING)

MHW
4.0

MLW
0.00

BOTTOM

TOP OF LIFT MOTOR NO HIGHER
THAN TOP OF PILE, EL = 11.8

C.R.M.C.

PROPOSED 1200# BOAT LIFT

EL VARIES

SECTION C-C THRU BOAT LIFT

3/16"=1'-0"

CONTRACTOR SHALL PROVIDE STOPS TO
PREVENT BOTTOM OF VESSEL FROM BEING
NO HIGHER THAN 3' ABOVE MHW AND
PREVENTING GUNWALE FROM BEING HIGHER
THAN THE EXISTING DECK EL OF 8.0

- ① 10" TIP CCA TREATED WOOD PILES
TREAT TO 2.5 PCF (1.0 ALLOWED WITH
OWNER CONSENT)
- ② 2x6 DECKING ACQ TREATED TO .6 PCF
FASTEN TO STRINGERS WITH 2 16d
SPIRAL SHANK NAIL
- ③ 3x12 STRINGER, THRU BOLT AT PILE
FASTEN MIDDLE STRINGER WITH SIMPSON
H-1 HURRICANE ANCHOR
- ④ 2-3x12 CAP BEAM, ACQ TREATED TO
.6 PCF
- ⑤ 3x10 CROSS BRACE, ACQ TREATED TO
.8 PCF

GENERAL NOTES:

- 1) ALL BOLTS, CONNECTORS, WASHERS, NAILS, ECT
SHALL BE HOT DIPPED GALVANIZED
- 2) CONTRACTOR SHALL ADHERE TO ALL OSHA RULES
AND REGULATIONS THROUGHOUT ALL PHASES OF
CONSTRUCTION
- 3) CONTRACTOR SHALL BE AWARE THAT THE STRATA INTO WHICH
THE PILES ARE TO BE DRIVEN MAY VARY FROM THE ASSUMPTION
THAT THESE PILES WILL PENETRATE 10' INTO SUITABLE MATERIAL

CROSS SECTION THRU BOAT LIFT

PLAN TO ACCOMPANY CRMC MODIFICATION APPLICATION
RUUD BOSMAN (LAURIE BYRNES BOSMAN TRUSTEE)
152 BEACON AVE., WARWICK, RI 02889
AP 385, LOT 61
BY: WARREN HALL, CIVIL ENGINEER
DECEMBER 5, 2013 SHEET 4 OF 4

WARREN F. HALL

No

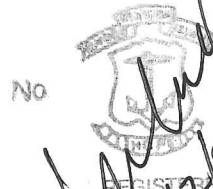

REGISTERED
PROFESSIONAL ENGINEER

GENERAL NOTE:

1. FOR LIST OF MATERIALS RELATED TO PART NUMBERS, SEE PARTS LIST 1200E OR 1200M. FIND NUMBERS 4, 5, AND 7, AS SHOWN ON THIS ILLUSTRATION, ARE SPECIFIC TO 1200E; HOWEVER, FOR MANUAL OPERATION, REFER TO 1200M, FIND NUMBERS 4, 5, AND 7.

NOTE:

**MOTOR NO HIGHER THAN
TOP OF PILE
EL = 11.8 OR LESS**

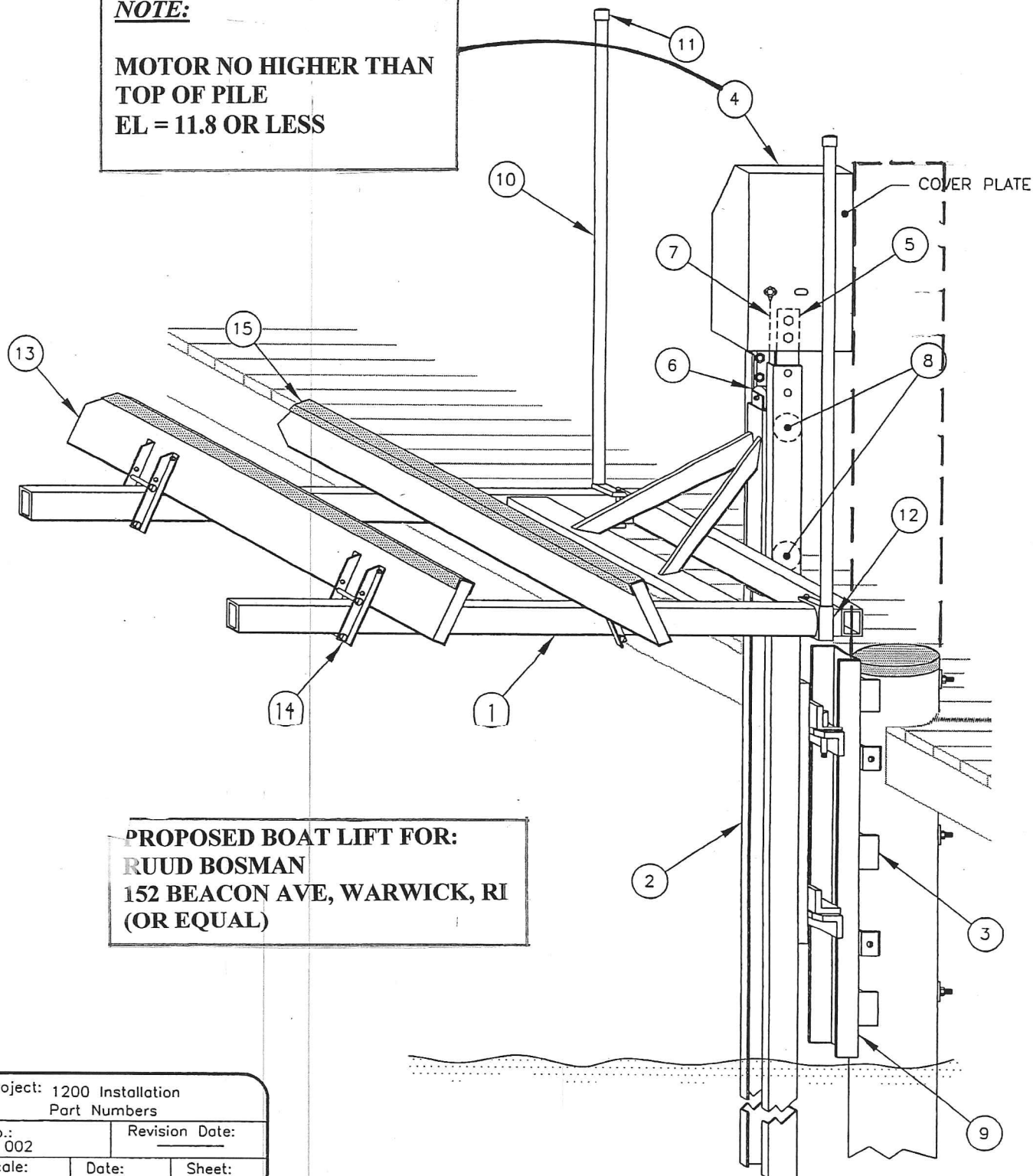

PROPOSED BOAT LIFT FOR:
RUUD BOSMAN
152 BEACON AVE, WARWICK, RI
(OR EQUAL)

Project: 1200 Installation
Part Numbers

No.:
002

Revision Date:

Scale:
None

Date:
03-07-02

Sheet:
1 of 1