



Oliver Stedman Government Center
4808 Tower Hill Road; Suite 116
Wakefield, RI 02879
401-783-3370

PUBLIC NOTICE

File Number: 2014-05-072

Date: May 27, 2014

This office has under consideration the application of:

Whilden Unlimited
1026 Ten Rod Road
North Kingstown, RI 02852

for a State of Rhode Island Assent to construct and maintain: a three acre oyster farm 500+ feet east of Fox Island. Bottom cages on trawl lines is the grow out method proposed.

Project Location:	Narragansett Bay
City/Town:	North Kingstown
Waterway:	West Passage Narragansett Bay

Plans of the proposed work may be seen at the CRMC office in Wakefield.

In accordance with the Administrative Procedures Act (Chapter 42-35 of the Rhode Island General Laws) you may request a hearing on this matter.

You are advised that if you have good reason to enter protests against the proposed work it is your privilege to do so. It is expected that objectors will review the application and plans thoroughly, visit site of proposed work if necessary, to familiarize themselves with the conditions and cite what law or laws, if any, would in their opinion be violated by the work proposed.

If you desire to protest, you must attend the scheduled hearing and give sworn testimony. A notice of the time and place of such hearing will be furnished you as soon as possible after receipt of your request for hearing. If you desire to request a hearing, to receive consideration, it should be in writing (**with your correct mailing address, e-mail address and valid contact number**) and be received at this office on or before June 27, 2014.

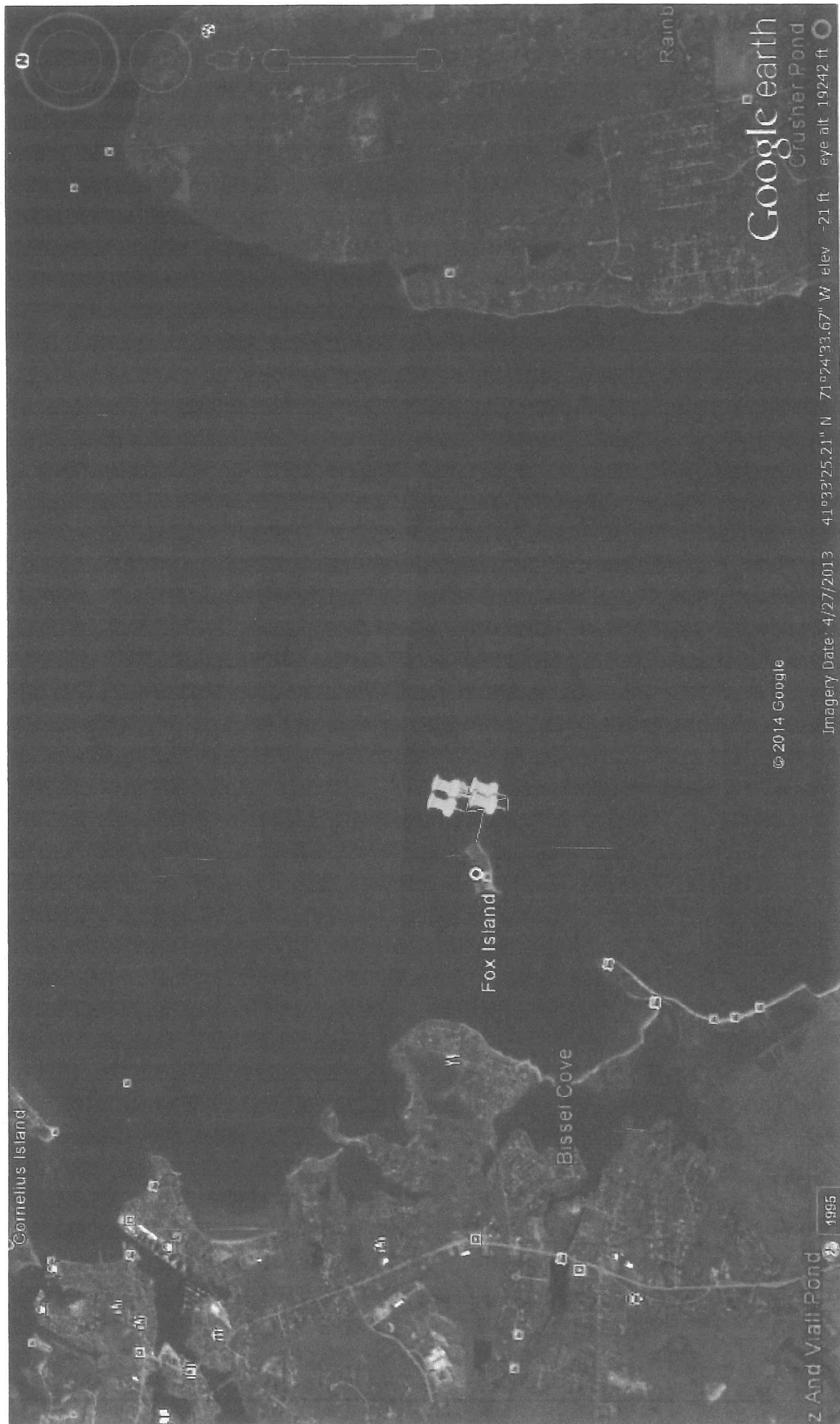

Google earth
Crusher Pond
eye alt 19242 ft

© 2014 Google

Imagery Date: 4/27/2013

41°33'25.21" N 71°24'33.67" W

elev -21 ft

z And Viall Pond

1955

MAY 14 2014

C.R.M.C.

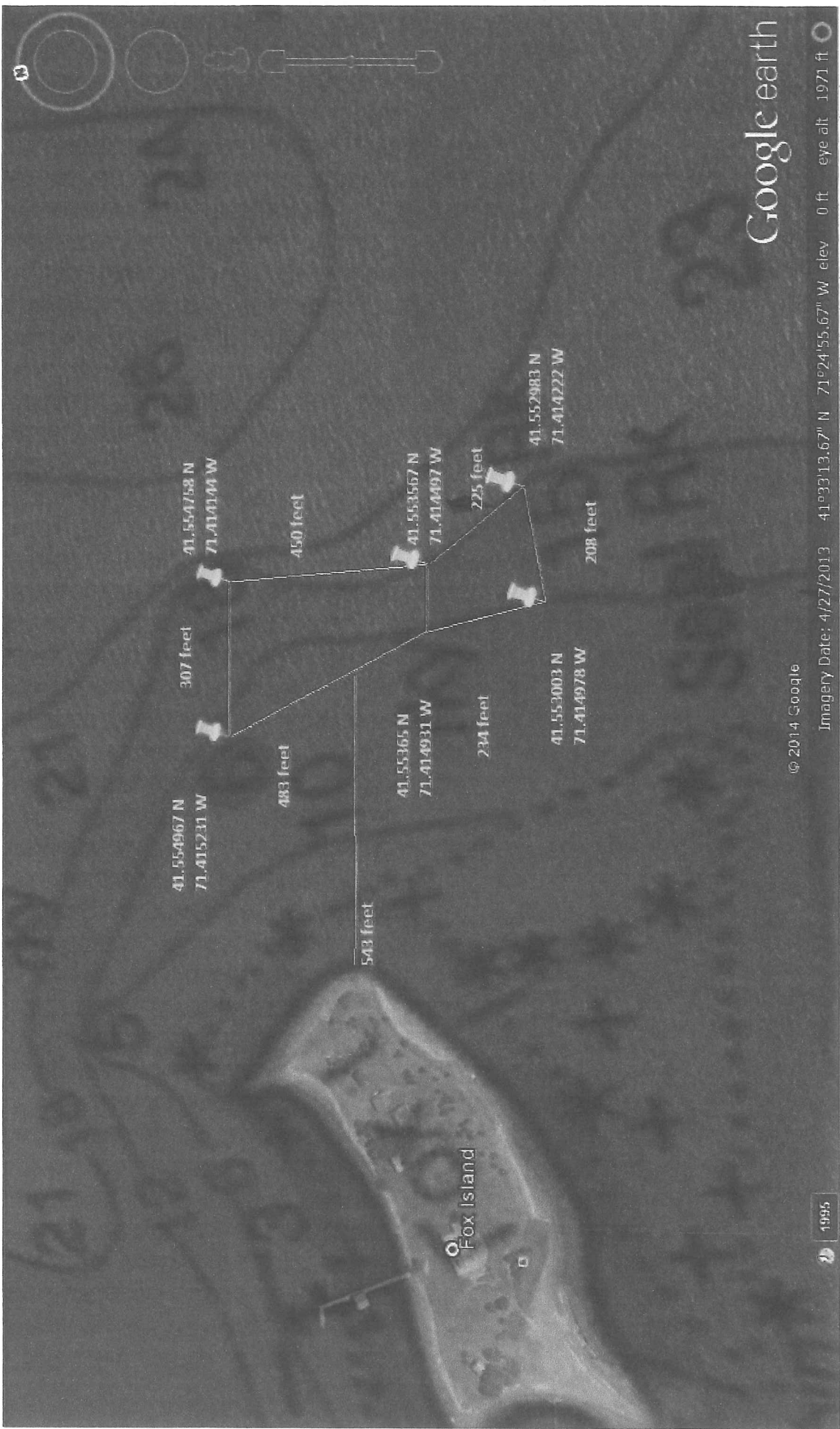

Google earth

© 2014 Google

Imagery Date: 4/27/2013 41°33'13.67" N 71°24'55.67" W elev 0 ft eye alt 1971 ft

1995

MAY 19 2014
C.R.M.C.