



Oliver Stedman Government Center  
4808 Tower Hill Road; Suite 116  
Wakefield, RI 02879  
401-783-3370

### **PUBLIC RE-NOTICE**

File Number: 2014-06-076

Date: July 21, 2014

This office has under consideration the application of:

Russell Sousa  
355 Riverside Street  
Portsmouth, RI 02871

for a State of Rhode Island Assent to construct and maintain: a 1.4 acre shellfish farm just north of Spectacle Island in Island Park Cove. The applicant has modified the coordinates and moved the location farther off of Spectacle Island. The operation plan remains the same of the previous notice.

Project Location:	Island Park Cove
City/Town:	Portsmouth
Waterway:	Island Park Cove

Plans of the proposed work may be seen at the CRMC office in Wakefield.

In accordance with the Administrative Procedures Act (Chapter 42-35 of the Rhode Island General Laws) you may request a hearing on this matter.

You are advised that if you have good reason to enter protests against the proposed work it is your privilege to do so. It is expected that objectors will review the application and plans thoroughly, visit site of proposed work if necessary, to familiarize themselves with the conditions and cite what law or laws, if any, would in their opinion be violated by the work proposed.

If you desire to protest, you must attend the scheduled hearing and give sworn testimony. A notice of the time and place of such hearing will be furnished you as soon as possible after receipt of your request for hearing. If you desire to request a hearing, to receive consideration, it should be in writing (**with your correct mailing address, e-mail address and valid contact number**) and be received at this office on or before August 20, 2014.



Google earth

feet 400  
meters 100



4-1-14

RUSSELL SOUSA  
355 RIVERSIDE ST  
PORTSMOUTH RI 02811  
401-662-9741

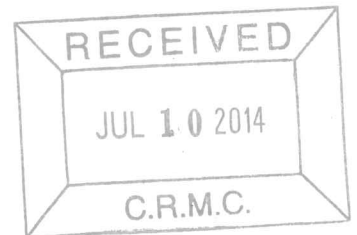

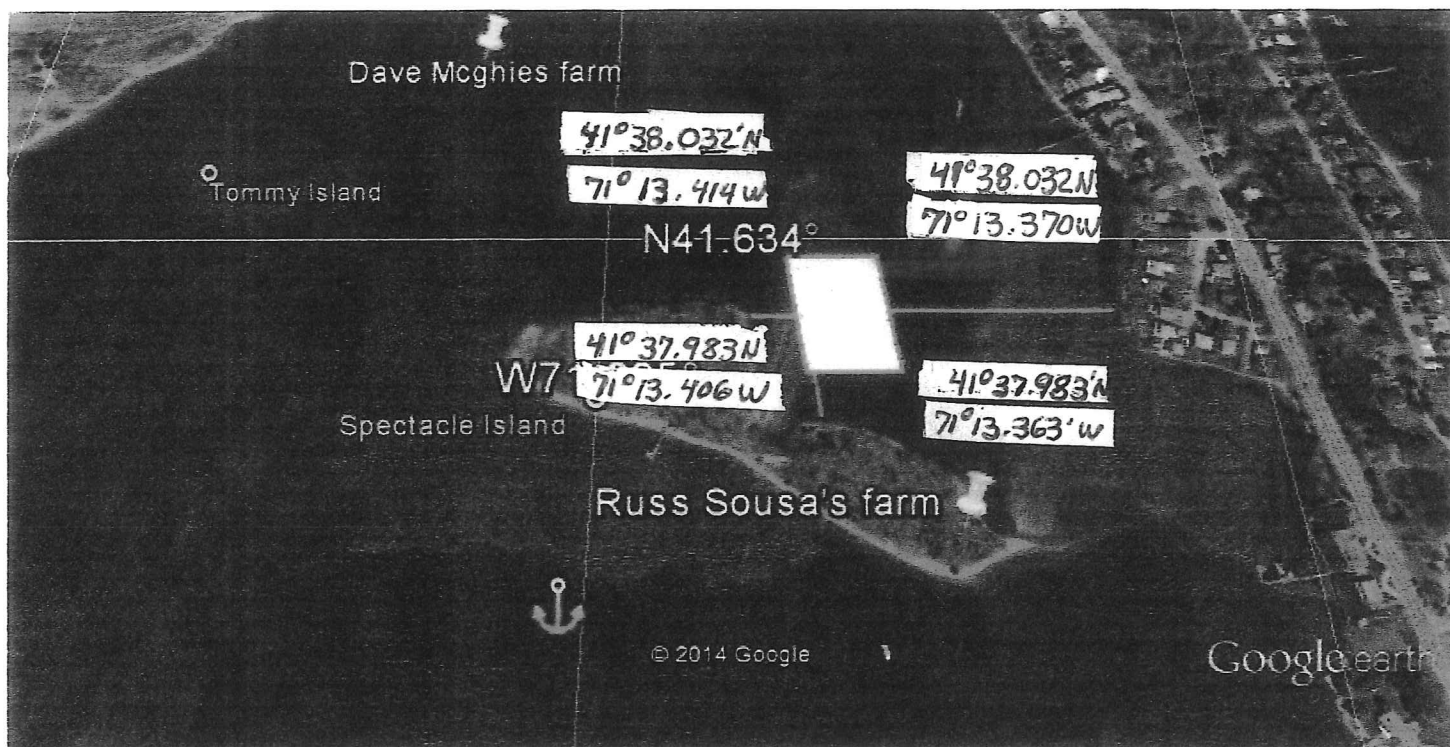

Google earth

feet 1000  
meters 300



200'x300' = 60,000 SQ FT

1.4 ACRES

13 ROWS OF 8 CAGES

#### KEY POINTS

- 1) 100' OFF THE SHORELINE OF SPECTACLE ISLAND
- 2) 470' OFF THE SHORELINE OF THE HUMMOCKS
- 3) 700' FROM DAVE MCGHIE'S FARM
- 4) FARM IS TUCKED IN OUT OF BOAT TRAFFIC
- 5) ON THE SIDE LEAST TRAVELED BY RECREATIONAL USERS
- 6) PROTECTED FROM STORMS

RECEIVED

JUL 10 2014

C.R.M.C.

4-1-14

RUSSELL SOUSA  
355 RIVERSIDE ST  
PORTSMOUTH RI 028  
401-662-9741

NE  
41° 38.032' N / 71° 13.370' W

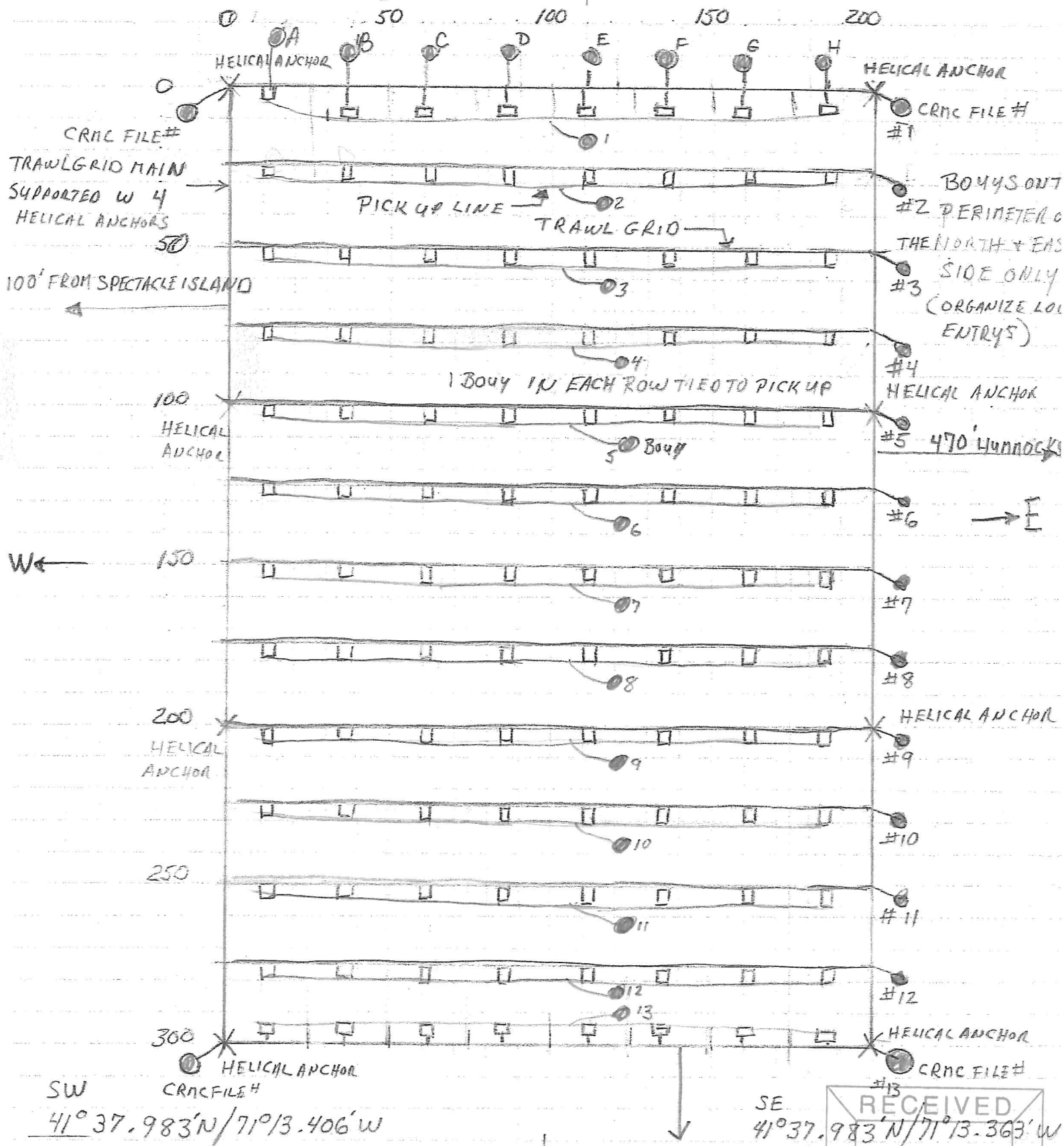

RUSSELL SOUSA 401-662-9741  
355 RIVERSIDE ST PORTSMOUTH RI 02871

4-1-14

SE  
41°37.983'N/71°13.363'W  
SPECTACLE ISLAND  
11/10/2014  
C.R.M.C.