



Oliver Stedman Government Center  
4808 Tower Hill Road; Suite 116  
Wakefield, RI 02879  
401-783-3370

## PUBLIC NOTICE

File Number: 2015-01-043

Date: February 3, 2015

This office has under consideration the application of:

Matthew Behan  
59 Maxson Hill Road  
Ashaway, RI 02804

for a State of Rhode Island Assent to construct and maintain: a three acre aquaculture farm expansion (please see the attached map)

Project Location:	Ninigret Pond
City/Town:	Charlestown
Waterway:	Ninigret Pond

Plans of the proposed work may be seen at the CRMC office in Wakefield.

In accordance with the Administrative Procedures Act (Chapter 42-35 of the Rhode Island General Laws) you may request a hearing on this matter.

You are advised that if you have good reason to enter protests against the proposed work it is your privilege to do so. It is expected that objectors will review the application and plans thoroughly, visit site of proposed work if necessary, to familiarize themselves with the conditions and cite what law or laws, if any, would in their opinion be violated by the work proposed.

If you desire to protest, you must attend the scheduled hearing and give sworn testimony. A notice of the time and place of such hearing will be furnished you as soon as possible after receipt of your request for hearing. If you desire to request a hearing, to receive consideration, it should be in writing (**with your correct mailing address, e-mail address and valid contact number**) and be received at this office on or before March 3, 2015.

**AQUACULTURE LEASE  
PROPOSED EXPANSION  
MATT BEHAN**

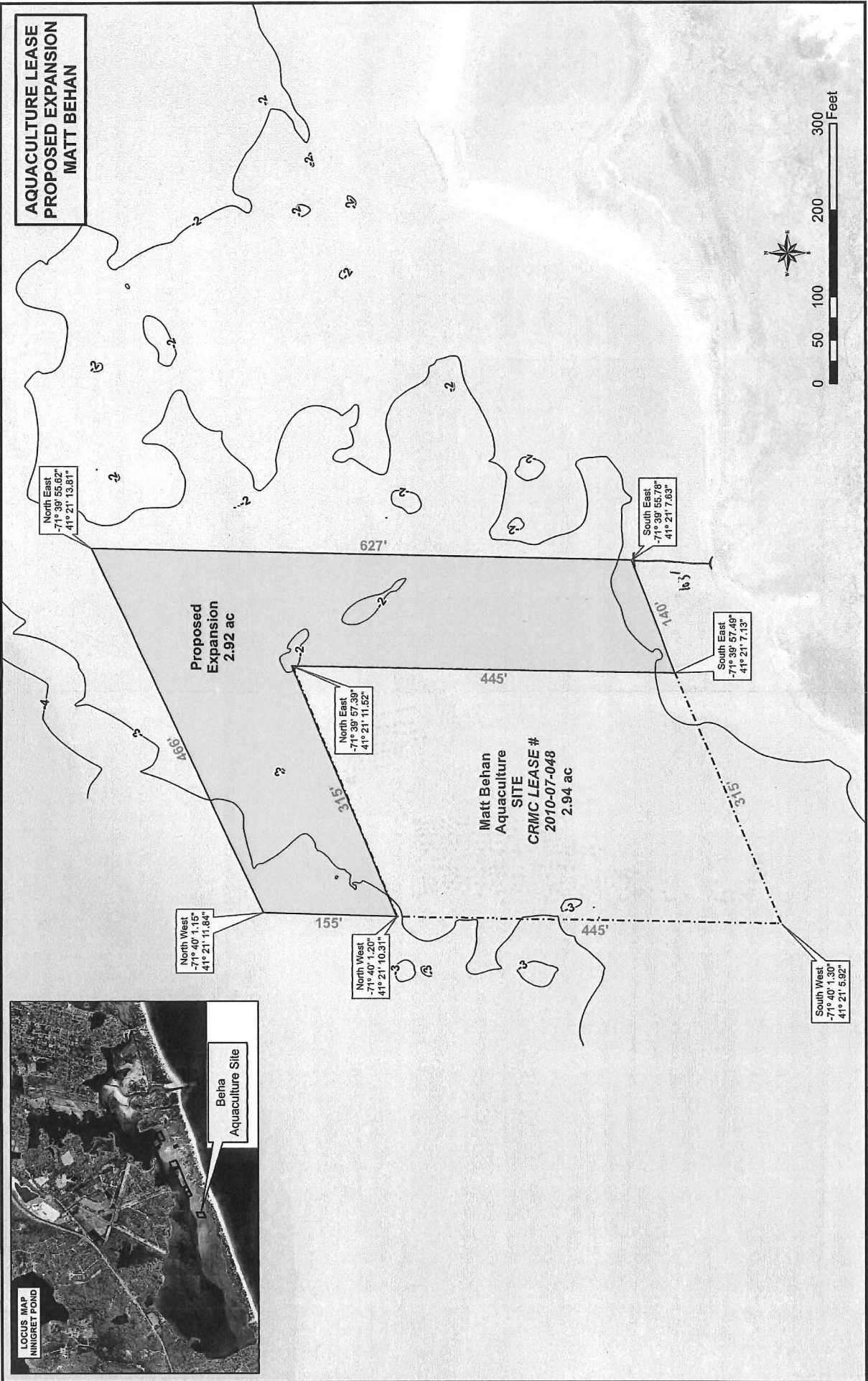

North West  
-71° 40' 1.15"  
41° 21' 11.94"

North West  
-71° 40' 1.20"  
41° 21' 10.31"

North East  
-71° 39' 57.36"  
41° 21' 11.62"

North East  
-71° 39' 55.62"  
41° 21' 13.81"

South East  
-71° 39' 57.48"  
41° 21' 7.15"

South East  
-71° 39' 55.78"  
41° 21' 7.63"

South West  
-71° 40' 1.30"  
41° 21' 5.92"

Proposed  
Expansion  
2.92 ac

Matt Behan  
Aquaculture  
SITE  
CRM LEASE #  
2010-07-048  
2.94 ac

LOCUS MAP  
NINIGRET POND

Beha  
Aquaculture Site