



Oliver Stedman Government Center
4808 Tower Hill Road; Suite 116
Wakefield, RI 02879
401-783-3370

PUBLIC NOTICE

File Number: 2015-02-065

Date: March 16, 2015

This office has under consideration the application of:

Wakamo Park, Shoreline Realty, Inc.
c/o Miriam C Walka
36 Sherwood Lane
Norwich, CT 06360

for a State of Rhode Island Assent to construct and maintain: a community On-site Wastewater Treatment System to replace existing cesspool systems currently servicing existing cottages. This system is Phase 2 of a replacement program and includes the installation of three STEP tanks, a recirculation tank, a processor tank and a sanitary manhole leading to a low pressure pipe drain field with concrete flow diffusers. The proposed enhanced treatment train design for 3105 gallons/day will remove nitrogen and mitigate impacts to water quality. The project is being reviewed as a Watershed Activity pursuant to Chapter 9 regulations of the RI Salt Pond Region Special Area Management Plan and also includes replacement of existing water lines.

Project Location:	Succotash Road/Wakamo Park
City/Town:	South Kingstown
Plat/Lot:	87-3 / 5
Waterway:	Potter Pond

Plans of the proposed work may be seen at the CRMC office in Wakefield.

In accordance with the Administrative Procedures Act (Chapter 42-35 of the Rhode Island General Laws) you may request a hearing on this matter.

You are advised that if you have good reason to enter protests against the proposed work it is your privilege to do so. It is expected that objectors will review the application and plans thoroughly, visit site of proposed work if necessary, to familiarize themselves with the conditions and cite what law or laws, if any, would in their opinion be violated by the work proposed.

If you desire to protest, you must attend the scheduled hearing and give sworn testimony. A notice of the time and place of such hearing will be furnished you as soon as possible after receipt of your request for hearing. If you desire to request a hearing, to receive consideration, it should be in writing (with your correct mailing address, e-mail address and valid contact number) and be received at this office on or before April 16, 2015.

MIRIAM WALKA SHORELINE REALTY CO., INC.

PLAN TO ACCOMPANY CRMC MAINTENANCE CERTIFICATION REQUEST JANUARY 8, 2015

PHASE II OWTS PLANS ISSUED FOR PERMITTING

SUCCOTASH ROAD
SOUTH KINGSTOWN, RHODE ISLAND
MAP 87-3 LOT 5
OCTOBER 2, 2014
REVISED: NOVEMBER 19, 2014

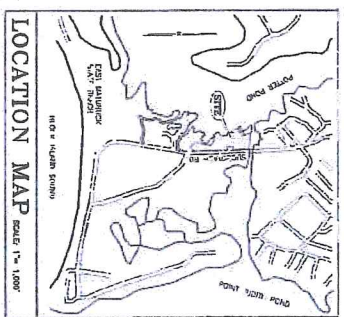
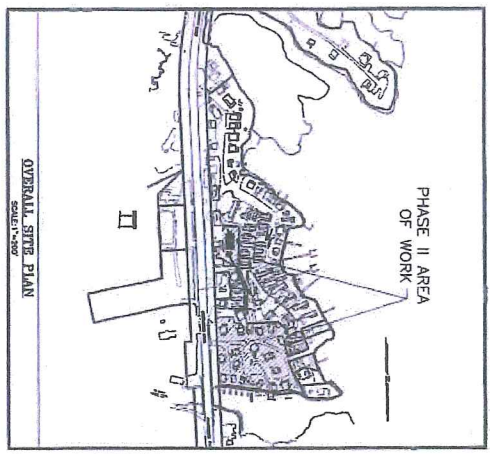

INDEX TO SHEETS	
TITLE/COVER SHEET	
KEY SHEET	C-0
PHASE II OWTS PLAN	C-1
PHASE II OWTS PLAN	C-2
PHASE II DETAIL PLAN 1	C-3
PHASE II DETAIL PLAN 2	C-4
PHASE II DETAIL PLAN 3	C-5
	C-6

Applicant:
Miriam Walka
Shoreline Realty Co., Inc.
135 Norwich Avenue
Norwich, CT 06360

Owner:
Miriam Walka
Shoreline Realty Co., Inc.
135 Norwich Avenue
Norwich, CT 06360



PLAN TO ACCOMPANY CRMC
MAINTENANCE CERTIFICATION REQUEST
JANUARY 8, 2015
OWTS PLAN
PREPARED FOR
MIRIAM WALKA
SHORELINE REALTY CO., INC.
SUCCOTASH ROAD
PLOT 87-3 LOT 5
SOUTH KINGSTOWN, RHODE ISLAND
PROJECT NO.: 207004

THIS PROPERTY IS LOCATED IN A
CRITICAL RESOURCE ZONE.

GENERAL RESOURCE AREA NOTES:

1. THERE ARE NO SUBMERGED TREES ASSOCIATED WITH A DRAINAGE BASIN WITHIN 100' OF THE PROPOSED OWS.
2. THERE ARE NO SUBMERGED TREES ASSOCIATED WITH A DRAINAGE BASIN WITHIN 100' OF THE PROPOSED OWS.
3. THERE ARE NO SUBMERGED TREES ASSOCIATED WITH A DRAINAGE BASIN WITHIN 100' OF THE PROPOSED OWS.
4. THERE ARE NO SUBMERGED TREES ASSOCIATED WITH A DRAINAGE BASIN WITHIN 100' OF THE PROPOSED OWS.
5. THERE ARE NO SUBMERGED TREES ASSOCIATED WITH A DRAINAGE BASIN WITHIN 100' OF THE PROPOSED OWS.

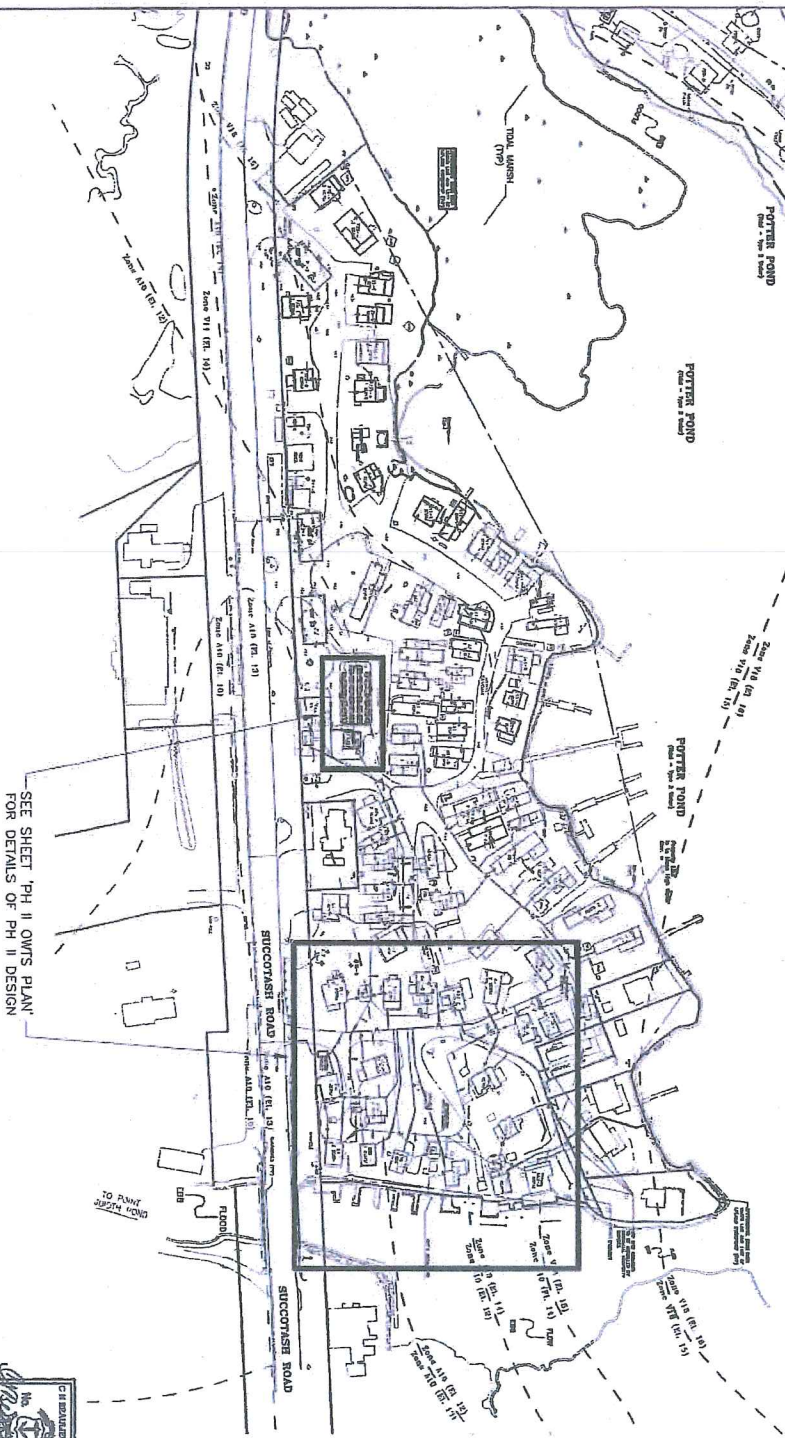

SEE SHEET 'PH II OWS PLAN'
FOR DETAILS OF PH II DESIGN

DATE	DESCRIPTION	BY	CHKD	APP'D
11/11/14	1. PREPARED FOR SUBMITTAL	CHERENZIA		
11/11/14	2. PREPARED FOR SUBMITTAL	CHERENZIA		
11/11/14	3. PREPARED FOR SUBMITTAL	CHERENZIA		
11/11/14	4. PREPARED FOR SUBMITTAL	CHERENZIA		
11/11/14	5. PREPARED FOR SUBMITTAL	CHERENZIA		
11/11/14	6. PREPARED FOR SUBMITTAL	CHERENZIA		
11/11/14	7. PREPARED FOR SUBMITTAL	CHERENZIA		
11/11/14	8. PREPARED FOR SUBMITTAL	CHERENZIA		
11/11/14	9. PREPARED FOR SUBMITTAL	CHERENZIA		
11/11/14	10. PREPARED FOR SUBMITTAL	CHERENZIA		



PLAN TO ACCOMPANY CRMC
MAINTENANCE CERTIFICATION REQUEST
JANUARY 8, 2015

KEY SHEET

PREPARED FOR
MIRIAM VALIKA
SHORELINE REALTY CO., INC.

PLAT B7-3, LOT 5
SOUTH KINGSTOWN, BRIDGE ISLAND
SCALE 1"=40'
OCTOBER 2, 2014
CHECK BY: SFC

SHEET: C-1 JOB NO.: 207004

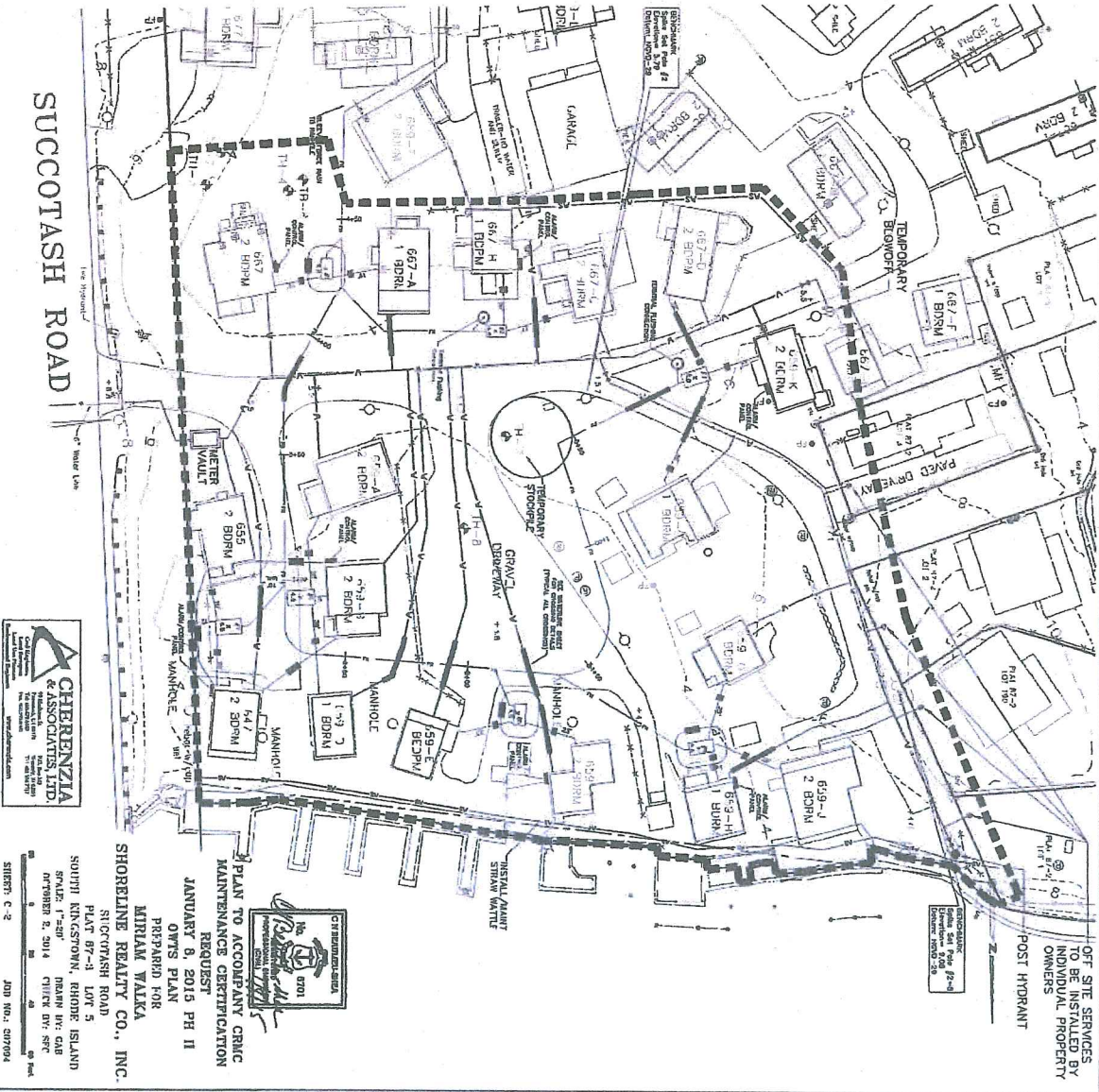
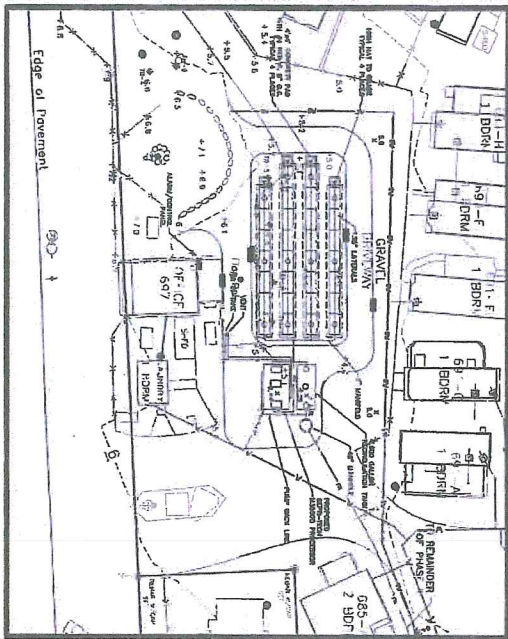

PAIN REVISION		DATE
1	10/1/01	10/1/01
2	10/1/01	10/1/01
3	10/1/01	10/1/01
4	10/1/01	10/1/01
5	10/1/01	10/1/01
6	10/1/01	10/1/01
7	10/1/01	10/1/01
8	10/1/01	10/1/01
9	10/1/01	10/1/01
10	10/1/01	10/1/01
11	10/1/01	10/1/01
12	10/1/01	10/1/01
13	10/1/01	10/1/01
14	10/1/01	10/1/01
15	10/1/01	10/1/01
16	10/1/01	10/1/01
17	10/1/01	10/1/01
18	10/1/01	10/1/01
19	10/1/01	10/1/01
20	10/1/01	10/1/01
21	10/1/01	10/1/01
22	10/1/01	10/1/01
23	10/1/01	10/1/01
24	10/1/01	10/1/01
25	10/1/01	10/1/01
26	10/1/01	10/1/01
27	10/1/01	10/1/01
28	10/1/01	10/1/01
29	10/1/01	10/1/01
30	10/1/01	10/1/01
31	10/1/01	10/1/01
32	10/1/01	10/1/01
33	10/1/01	10/1/01
34	10/1/01	10/1/01
35	10/1/01	10/1/01
36	10/1/01	10/1/01
37	10/1/01	10/1/01
38	10/1/01	10/1/01
39	10/1/01	10/1/01
40	10/1/01	10/1/01
41	10/1/01	10/1/01
42	10/1/01	10/1/01
43	10/1/01	10/1/01
44	10/1/01	10/1/01
45	10/1/01	10/1/01
46	10/1/01	10/1/01
47	10/1/01	10/1/01
48	10/1/01	10/1/01
49	10/1/01	10/1/01
50	10/1/01	10/1/01
51	10/1/01	10/1/01
52	10/1/01	10/1/01
53	10/1/01	10/1/01
54	10/1/01	10/1/01
55	10/1/01	10/1/01
56	10/1/01	10/1/01
57	10/1/01	10/1/01
58	10/1/01	10/1/01
59	10/1/01	10/1/01
60	10/1/01	10/1/01
61	10/1/01	10/1/01
62	10/1/01	10/1/01
63	10/1/01	10/1/01
64	10/1/01	10/1/01
65	10/1/01	10/1/01
66	10/1/01	10/1/01
67	10/1/01	10/1/01
68	10/1/01	10/1/01
69	10/1/01	10/1/01
70	10/1/01	10/1/01
71	10/1/01	10/1/01
72	10/1/01	10/1/01
73	10/1/01	10/1/01
74	10/1/01	10/1/01
75	10/1/01	10/1/01
76	10/1/01	10/1/01
77	10/1/01	10/1/01
78	10/1/01	10/1/01
79	10/1/01	10/1/01
80	10/1/01	10/1/01
81	10/1/01	10/1/01
82	10/1/01	10/1/01
83	10/1/01	10/1/01
84	10/1/01	10/1/01
85	10/1/01	10/1/01
86	10/1/01	10/1/01
87	10/1/01	10/1/01
88	10/1/01	10/1/01
89	10/1/01	10/1/01
90	10/1/01	10/1/01
91	10/1/01	10/1/01
92	10/1/01	10/1/01
93	10/1/01	10/1/01
94	10/1/01	10/1/01
95	10/1/01	10/1/01
96	10/1/01	10/1/01
97	10/1/01	10/1/01
98	10/1/01	10/1/01
99	10/1/01	10/1/01

- | SYMBOL | DESCRIPTION |
|--------|-----------------------|
| — | COMMON CONTINUOUS |
| 4-3 | DRIVING SHORT PILE |
| Y | DRIVING PILE |
| — | COMMON REFUSING WALL |
| 105 | LOCATION OF TO BE 217 |
| 107 | NON PER PILE |
| 108 | PILE BEING PILED |
| 109 | PILE BEING PILED |
| 110 | COMMON REFUSING PILE |
| 111 | PILE BEING PILED |
| 112 | PILE BEING PILED |
| 113 | PILE BEING PILED |
| 114 | PILE BEING PILED |
| 115 | PILE BEING PILED |
| 116 | PILE BEING PILED |
| 117 | PILE BEING PILED |
| 118 | PILE BEING PILED |
| 119 | PILE BEING PILED |
| 120 | PILE BEING PILED |
| 121 | PILE BEING PILED |
| 122 | PILE BEING PILED |
| 123 | PILE BEING PILED |
| 124 | PILE BEING PILED |
| 125 | PILE BEING PILED |
| 126 | PILE BEING PILED |
| 127 | PILE BEING PILED |
| 128 | PILE BEING PILED |
| 129 | PILE BEING PILED |
| 130 | PILE BEING PILED |
| 131 | PILE BEING PILED |
| 132 | PILE BEING PILED |
| 133 | PILE BEING PILED |
| 134 | PILE BEING PILED |
| 135 | PILE BEING PILED |
| 136 | PILE BEING PILED |
| 137 | PILE BEING PILED |
| 138 | PILE BEING PILED |
| 139 | PILE BEING PILED |
| 140 | PILE BEING PILED |
| 141 | PILE BEING PILED |
| 142 | PILE BEING PILED |
| 143 | PILE BEING PILED |
| 144 | PILE BEING PILED |
| 145 | PILE BEING PILED |
| 146 | PILE BEING PILED |
| 147 | PILE BEING PILED |
| 148 | PILE BEING PILED |
| 149 | PILE BEING PILED |
| 150 | PILE BEING PILED |
| 151 | PILE BEING PILED |
| 152 | PILE BEING PILED |
| 153 | PILE BEING PILED |
| 154 | PILE BEING PILED |
| 155 | PILE BEING PILED |
| 156 | PILE BEING PILED |
| 157 | PILE BEING PILED |
| 158 | PILE BEING PILED |
| 159 | PILE BEING PILED |
| 160 | PILE BEING PILED |
| 161 | PILE BEING PILED |
| 162 | PILE BEING PILED |
| 163 | PILE BEING PILED |
| 164 | PILE BEING PILED |
| 165 | PILE BEING PILED |
| 166 | PILE BEING PILED |
| 167 | PILE BEING PILED |
| 168 | PILE BEING PILED |
| 169 | PILE BEING PILED |
| 170 | PILE BEING PILED |
| 171 | PILE BEING PILED |
| 172 | PILE BEING PILED |
| 173 | PILE BEING PILED |
| 174 | PILE BEING PILED |
| 175 | PILE BEING PILED |
| 176 | PILE BEING PILED |
| 177 | PILE BEING PILED |
| 178 | PILE BEING PILED |
| 179 | PILE BEING PILED |
| 180 | PILE BEING PILED |
| 181 | PILE BEING PILED |
| 182 | PILE BEING PILED |
| 183 | PILE BEING PILED |
| 184 | PILE BEING PILED |
| 185 | PILE BEING PILED |
| 186 | PILE BEING PILED |
| 187 | PILE BEING PILED |
| 188 | PILE BEING PILED |
| 189 | PILE BEING PILED |
| 190 | PILE BEING PILED |
| 191 | PILE BEING PILED |
| 192 | PILE BEING PILED |
| 193 | PILE BEING PILED |
| 194 | PILE BEING PILED |
| 195 | PILE BEING PILED |
| 196 | PILE BEING PILED |
| 197 | PILE BEING PILED |
| 198 | PILE BEING PILED |
| 199 | PILE BEING PILED |
| 200 | PILE BEING PILED |

