

**State of Rhode Island  
Coastal Resources Management Council  
Oliver H. Stedman Government Center  
4808 Tower Hill Road, Suite 3  
Wakefield, RI 02879  
(401)783-3370**

**State of Rhode Island  
Department of Environmental Management  
Office of Technical and Customer Asst.  
235 Promenade Street  
Providence, RI 02908-5767  
(401)222-6822**

## **JOINT PUBLIC NOTICE**

CRMC File No.: 2015-12-072

February 22, 2016

RIDEM Water Quality Certification Number: 15-044

These offices have under consideration the application of:

Washington County Community Development Corp.  
400 Tower Hill Road  
North Kingstown, RI 02852

for State of Rhode Island Assent (in accordance with the Coastal Resources Management Program), and State of Rhode Island Water Quality Certification (in accordance with Chapter 42-35 pursuant to Chapters 46-12 and 42-17.1 of the RIGL, as amended).

The project will include: construct "Churchwoods" a 24-unit affordable senior housing for low and moderate incomes. Proposed improvements include new stormwater management and treatment systems. Wastewater will be treated by five RIDEM approved denitrifying On-site Wastewater Treatment Systems.

Project Location: 4130 Old Post Road

Street & Number: 4130 Old Post Road

City/Town: Charlestown

Plat Number:	<u>13</u>	Lot	
		Number:	<u>43</u>

Plans of the proposed work may be seen at the CRMC office in Wakefield.

In accordance with the Administrative Procedures Act (Chapter 42-35 of the Rhode Island General Laws) you may request a hearing on this matter. You are advised that if you have good reason to enter protests against the proposed work it is your privilege to do so. It is expected that objectors will review the application and plans thoroughly, visit site of proposed work if necessary, to familiarize themselves with the conditions and cite what law or laws, if any, would in their opinion be violated by the work proposed.

RICRMC/RIDEM Joint Public Notice  
CRMC File No. 2015-12-072  
February 22, 2016  
Page Two

This also serves as notice that the Rhode Island Department of Environmental Management, Office of Water Resources, Water Quality Certification Program has under consideration and review the same proposed activity as described above for compliance with the State's Water Quality Regulations (AUTHORITY: in accordance with Clean Water Act, as amended (33 U.S.C. 1251 et.seq.; Chapter 42-35 pursuant to Chapters 46-12 and 42-17.1 of the Rhode Island General Laws of 1956, as amended).

If you desire to protest, you must attend the scheduled hearing and give sworn testimony. A notice of the time and place of such hearing will be furnished you as soon as possible after receipt of your request for hearing. If you desire to request a hearing, to receive consideration, it should be in writing and be received at this office on or before March 22, 2016.

It is expected that objectors will review the application and associates plans thoroughly. Comments that pertain to this Joint Notice must be submitted in writing and must be addressed to Rhode Island Coastal Resources Management Council and Rhode Island Department of Environmental Management at the above referenced addresses.

/kc

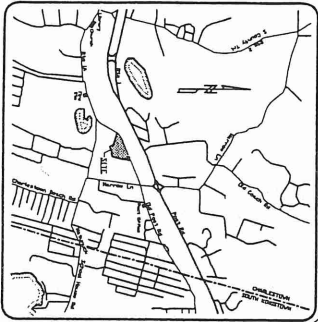

LOCATION MAP  
SCALE: 1" = 2000'

**CERTIFICATION:**  
THIS SURVEY AND PLAN CONFORM TO A CLASS  
BOARD OF REGISTRATION FOR PROFESSIONAL LAND  
SURVEYORS, AND IS SUBSTANTIALLY CORRECT.

REGISTERED PROFESSIONAL LAND SURVEYOR DATE

BROWNING  
DRIVE

A.M. 13/LOT 50-4  
N/F DANIEL J. &  
GENEVIÈVE J. MCALLOUGHIN

A.M. 13/LOT 40-1  
N/F MERVIN H. BROWNING

A.M. 13/LOT 40-2  
N/F EUGENE A. &  
SUSAN E. PICCA

A.M. 13/LOT 50-5  
N/F WILLIAM C. & LESLIE M. OLIVER

A.M. 13/LOT 40-3  
N/F WAYNE J. CALDWELL

A.M. 13/LOT 40  
N/F JOHN E. &  
CHRISTINE M. WARD

A.M. 13/LOT 41  
N/F JOYCE M. MACINNES

A.M. 13/LOT 50  
N/F CLEVELAND ASSOCIATES

A.M. 13/LOT 44  
DIOCESE OF RHODE ISLAND

A.M. 13/LOT 50-6  
N/F RICHARD J. &  
CLAIRE DALDOMITZ

A.M. 13/LOT 49  
N/F JAMES B. &  
NANCY A. HARTNEY

A.M. 12/LOT 137  
N/F WASHINGTON  
TRUST CO.

A.M. 13/LOT 1  
N/F JAMES L.  
FALCONE, TR.

A.M. 13/LOT 2  
N/F SOUTH SHORE  
PHYSICIANS INC.

A.M. 13/LOT 3  
N/F JAMES L.  
FALCONE, TR.

A.M. 13/LOT 4  
N/F JAMES L.  
FALCONE, TR.

A.M. 13/LOT 5-2  
N/F CHATM INC.

A.M. 13/LOT 5-1  
N/F CHATM INC.

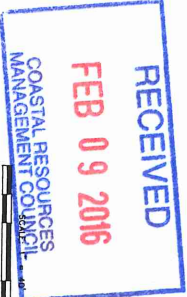
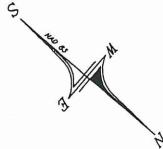

GRAPHIC SCALE  
0 20' 40' 80' 120'



DOWDELL ENGINEERING, INC.  
CIVIL & ENVIRONMENTAL ENGINEERS  
SURVEYORS & LAND PLANNERS

P.O. BOX 1684 • 3944 OLD POST ROAD  
CHARLESTOWN, RHODE ISLAND 02813  
(401) 364-1027

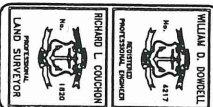

NO.	REVISION	DATE

PROPOSED DEVELOPMENT PLAN  
"CHURCHWOODS"  
PRELIMINARY PLAN  
ASSESSOR'S MAP 13 LOT 43  
PREPARED FOR  
WASHINGTON COUNTY  
COMMUNITY DEVELOPMENT  
SITUATED IN THE TOWN OF  
CHARLESTOWN, RHODE ISLAND