

State of Rhode Island
Coastal Resources Management Council
Oliver H. Stedman Government Center
4808 Tower Hill Road, Suite 3
Wakefield, RI 02879
(401)783-3370

State of Rhode Island
Department of Environmental Management
Office of Technical and Customer Asst.
235 Promenade Street
Providence, RI 02908-5767
(401)222-6822

JOINT PUBLIC NOTICE

CRMC File No.: 2016-02-048 Date: March 2, 2016

RIDEM Water Quality Certification Number: 16-024

These offices have under consideration the application of:

City of Pawtucket
137 Roosevelt Avenue
Pawtucket, RI 02860

for State of Rhode Island Assent (in accordance with the Coastal Resources Management Program), and State of Rhode Island Water Quality Certification (in accordance with Chapter 42-35 pursuant to Chapters 46-12 and 42-17.1 of the RIGL, as amended).

The project will include: Constructing a new track, synthetic turf field and associated site improvements at Max W. Read Field.

Project Location: Max Read Field, Pleasant Street, Pawtucket
Street & Number: Pleasant Street
City/Town: Pawtucket
Plat Number: 65|67 Lot Number: 594,646,647,648|11,17
Waterway: Seekonk River

Plans of the proposed work may be seen at the CRMC office in Wakefield.

In accordance with the Administrative Procedures Act (Chapter 42-35 of the Rhode Island General Laws) you may request a hearing on this matter. You are advised that if you have good reason to enter protests against the proposed work it is your privilege to do so. It is expected that objectors will review the application and plans thoroughly, visit site of proposed work if necessary, to familiarize themselves with the conditions and cite what law or laws, if any, would in their opinion be violated by the work proposed.

This also serves as notice that the Rhode Island Department of Environmental Management, Office of Water Resources, Water Quality Certification Program has under consideration and review the same proposed activity as described above for compliance with the State's Water Quality Regulations (AUTHORITY: in accordance with Clean Water Act, as amended (33 U.S.C. 1251 et.seq.; Chapter 42-35 pursuant to Chapters 46-12 and 42-17.1 of the Rhode Island General Laws of 1956, as amended).

If you desire to protest, you must attend the scheduled hearing and give sworn testimony. A notice of the time and place of such hearing will be furnished you as soon as possible after receipt of your request for hearing. If you desire to request a hearing, to receive consideration, it should be in writing and be received at this office on or before April 2, 2016.

It is expected that objectors will review the application and associates plans thoroughly. Comments that pertain to this Joint Notice must be submitted in writing and must be addressed to Rhode Island Coastal Resources Management Council and Rhode Island Dept of Environmental Management at the above referenced addresses.

Lat

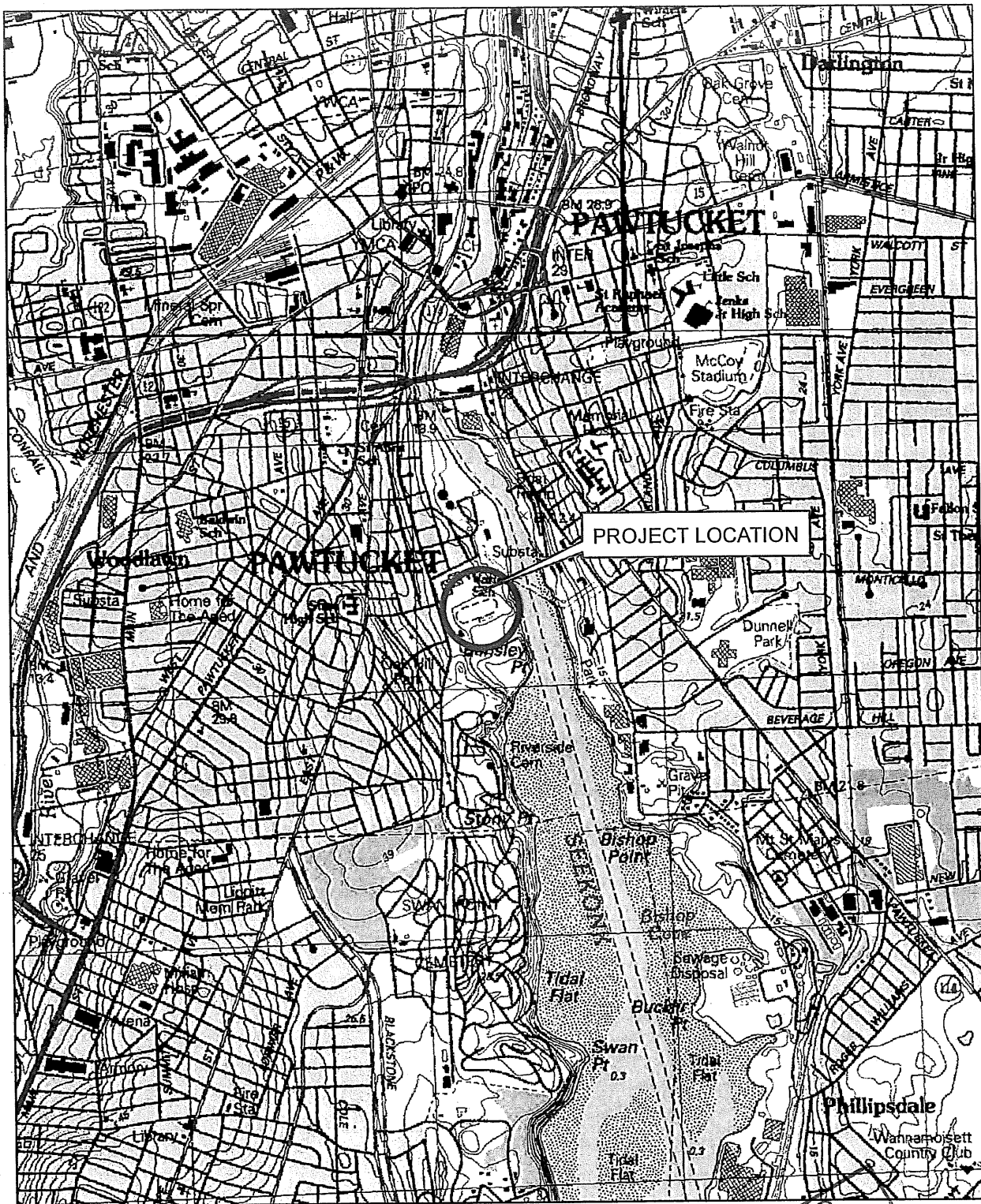

RIGIS

SITE LOCATION MAP

SCALE: 1"=2000'

RECEIVED
FEB 15 2016
PLANNING & ZONING DEPARTMENT
CITY OF PAWTUCKET



PARE CORPORATION
8 BLACKSTONE VALLEY PLACE
LINCOLN, RI 02865
(401) 334-4100

FIGURE 1

MAX READ FIELD
PAWTUCKET, RHODE ISLAND



RIGIS

ANNOTATED AERIAL PHOTOGRAPH

SCALE: 1"=200'



PARE CORPORATION
8 BLACKSTONE VALLEY PLACE
LINCOLN, RI 02865
(401) 334-4100

FIGURE 2
MAX READ FIELD
PAWTUCKET, RHODE ISLAND

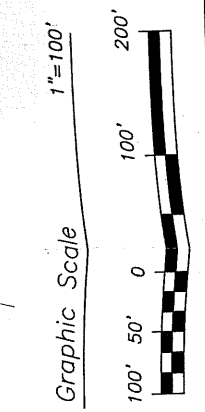
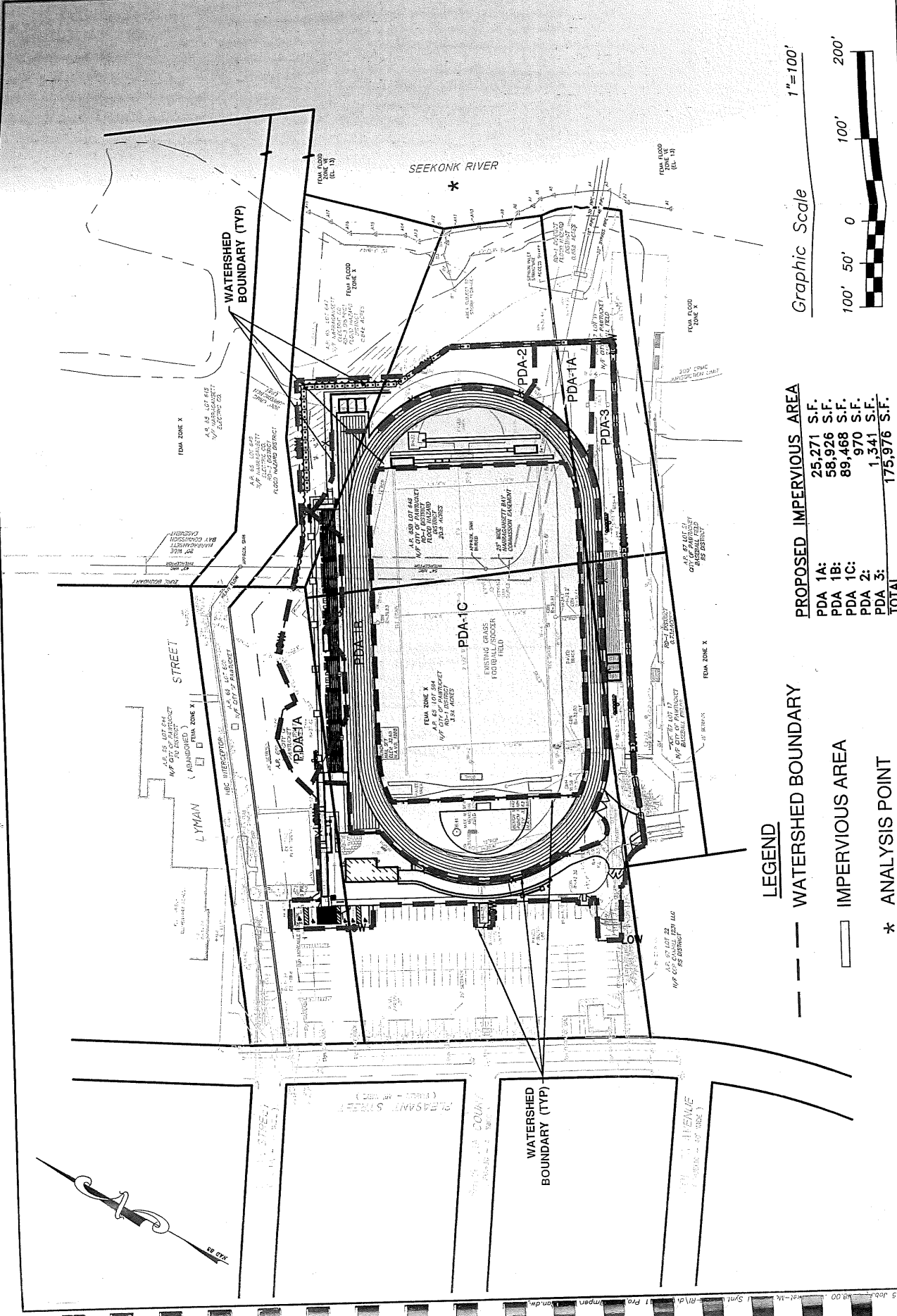

PROPOSED IMPERVIOUS AREA

PDA 1A:	25,271 S.F.
PDA 1B:	58,926 S.F.
PDA 1C:	89,468 S.F.
PDA 2:	970 S.F.
PDA 3:	1,341 S.F.
TOTAL	175,976 S.F.

- LEGEND
- WATERSHED BOUNDARY
 - IMPERVIOUS AREA
 - * ANALYSIS POINT