



State of Rhode Island and Providence Plantations
Coastal Resources Management Council
 Oliver H. Stedman Government Center
 4808 Tower Hill Road, Suite 3
 Wakefield, RI 02879-1900

(401) 783-3370
 Fax (401) 783-2069

PUBLIC NOTICE

File Number: 2017-07-021

Date: July 18, 2017

This office has under consideration the application of:

**Graham Watson
 161 Riverdell Drive
 Saunderstown, RI 02874**

for a State of Rhode Island Assent to create and maintain: a three acre oyster and kelp farm using both bottom cages and floating cages for the oysters; and suspended longlines for the kelp. Please see the attached map that shows the adjacent lease. A copy of the entire application can be sent via e-mail upon request to the CRMC aquaculture coordinator.

| | |
|-------------------|-----------------------------|
| Project Location: | Narragansett Bay |
| City/Town: | North Kingstown |
| Waterway: | Narragansett Bay Rome Point |

Plans of the proposed work may be seen at the CRMC office in Wakefield.

In accordance with the Administrative Procedures Act (Chapter 42-35 of the Rhode Island General Laws) you may request a hearing on this matter.

You are advised that if you have good reason to enter protests against the proposed work it is your privilege to do so. It is expected that objectors will review the application and plans thoroughly, visit site of proposed work if necessary, to familiarize themselves with the conditions and cite what law or laws, if any, would in their opinion be violated by the work proposed.

If you desire to protest, you must attend the scheduled hearing and give sworn testimony. A notice of the time and place of such hearing will be furnished you as soon as possible after receipt of your request for hearing. If you desire to request a hearing, to receive consideration, it should be in writing (**with your correct mailing address, e-mail address and valid contact number**) and be received at this office on or before August 17, 2017.

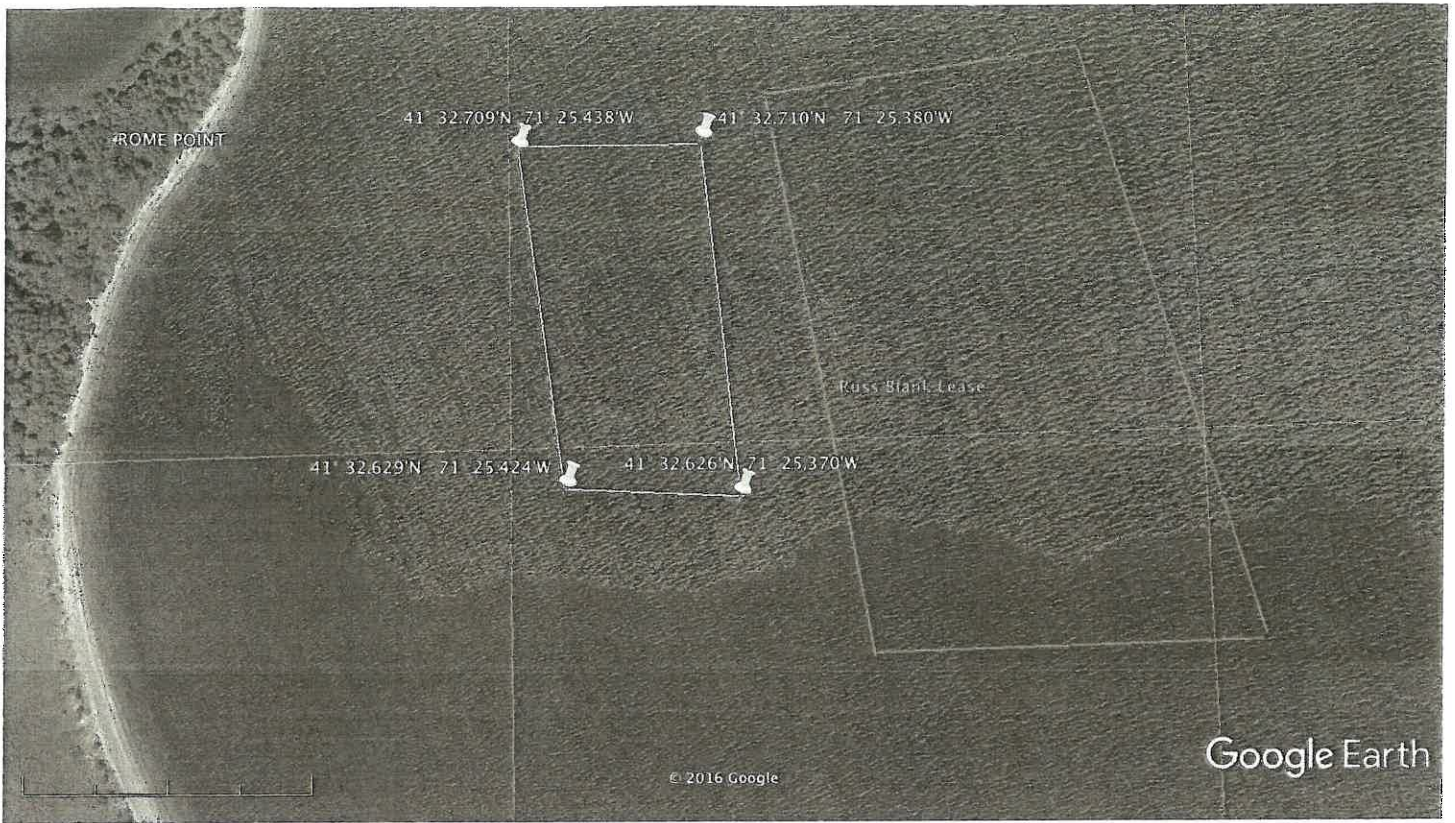

Google Earth



RECEIVED
JUL 11 2017
COASTAL RESOURCES
MANAGEMENT COUNCIL