



Oliver Stedman Government Center  
4808 Tower Hill Road; Suite 116  
Wakefield, RI 02879  
401-783-3370

## PUBLIC NOTICE

File Number: 2017-07-050 Date: September 17, 2018

This office has under consideration the application of:

**Nunzio DiMarco  
167 Shore Road  
Westerly, RI 02891**

for a State of Rhode Island Assent to construct and maintain:

**A residential boating facility to consist of a 32' long aluminum ramp for access onto the fixed pier, a 50' long x 4' wide fixed timber pier, a 21'- 10" long aluminum ramp for float access and a 8' x 18' float. The facility will extend 50' beyond MLW and obtain a water depth of approximately 1.5' at mean low water. Access to the facility will be provided through an easement to provide foot access over property of the Winnapaug Inn.**

Project Location:	18 Via Roma Road
City/Town:	Westerly
Plat/Lot:	140 / 17A
Waterway:	Winnapaug Pond

Plans of the proposed work may be seen at the CRMC office in Wakefield.

In accordance with the Administrative Procedures Act (Chapter 42-35 of the Rhode Island General Laws) you may request a hearing on this matter.

You are advised that if you have good reason to enter protests against the proposed work it is your privilege to do so. It is expected that objectors will review the application and plans thoroughly, visit site of proposed work if necessary, to familiarize themselves with the conditions and cite what law or laws, if any, would in their opinion be violated by the work proposed.

If you desire to protest, you must attend the scheduled hearing and give sworn testimony. A notice of the time and place of such hearing will be furnished you as soon as possible after receipt of your request for hearing. If you desire to request a hearing, to receive consideration, it should be in writing (**with your correct mailing address, e-mail address and valid contact number**) and be received at this office on or before October 17, 2018.

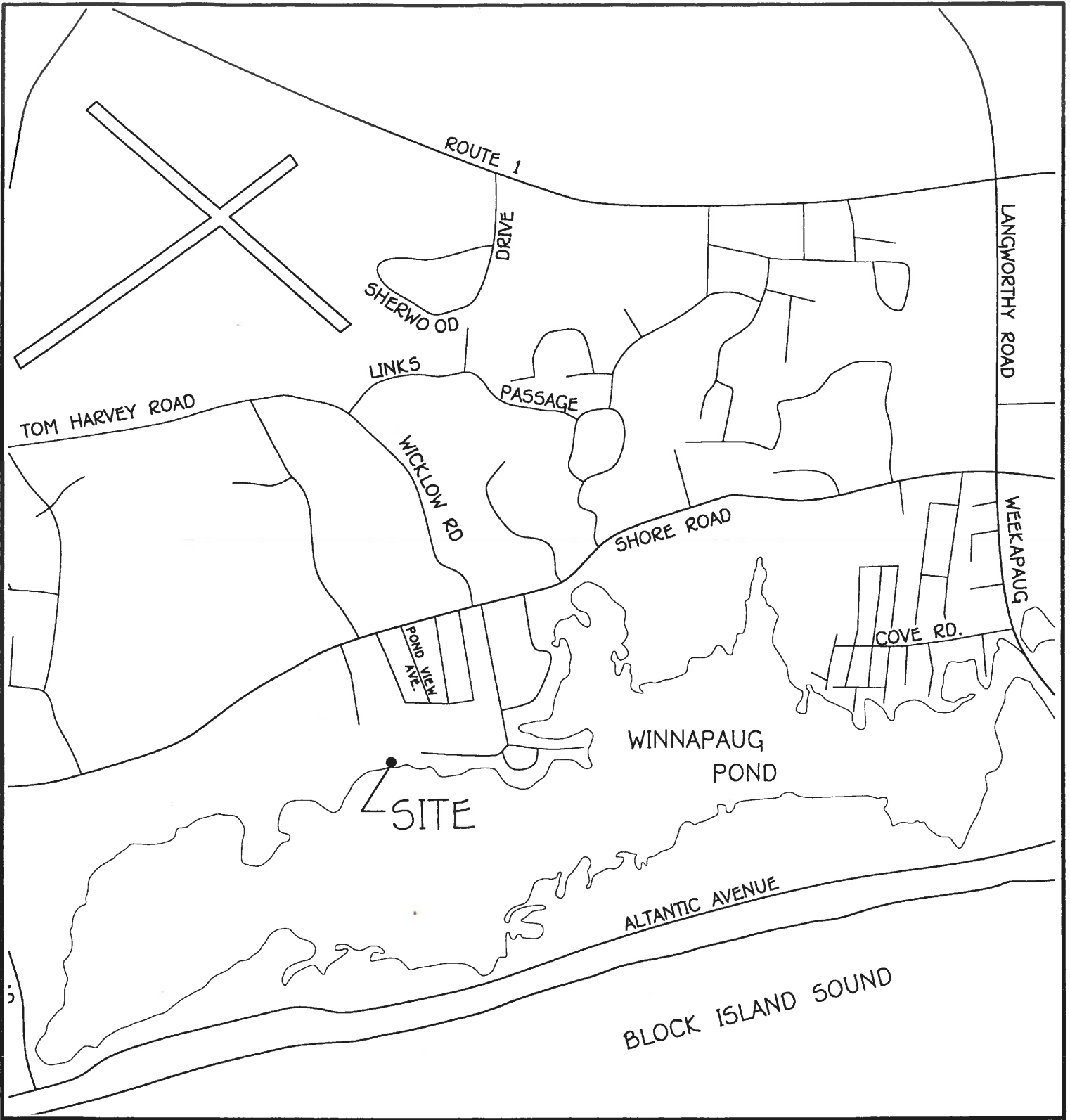

ANTHONY A. NENNA



No. 7240

REGISTERED  
PROFESSIONAL ENGINEER  
CIVIL

APPLICANT: NUNZIO DIMARCO  
 LOCATION: 18 VIA ROMA ROAD, WESTERLY RI  
 WATERWAY: WINNAPAUG POND  
 PREPARED BY:

DATE: JUNE 16, 2017  
 PLAT 140, LOT 17A



-Site Engineering, INC  
 Civil & Environmental Engineering

85 Beach Street, Unit B  
 Westerly, Rhode Island 02891  
 401-348-6831

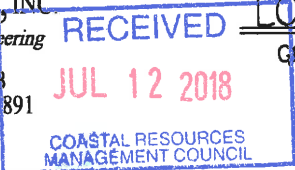

LOCATION MAP

GRAPHIC SCALE: NONE

*[Handwritten signature]*  
 2-19-18

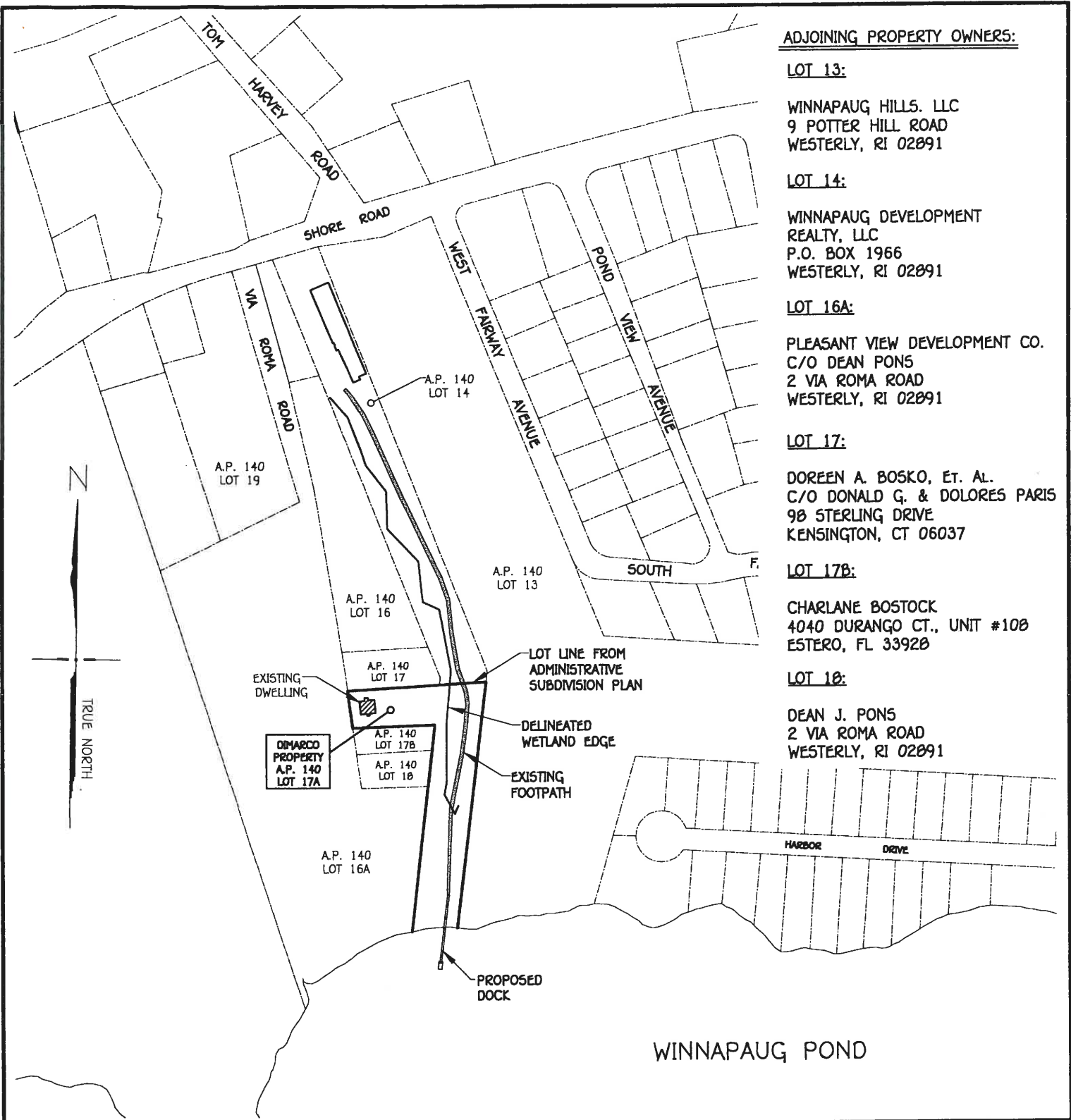

ADJOINING PROPERTY OWNERS:

LOT 13:

WINNAPAU G HILLS. LLC  
9 POTTER HILL ROAD  
WESTERLY, RI 02091

LOT 14:

WINNAPAU G DEVELOPMENT  
REALTY, LLC  
P.O. BOX 1966  
WESTERLY, RI 02091

LOT 16A:

PLEASANT VIEW DEVELOPMENT CO.  
C/O DEAN PONS  
2 VIA ROMA ROAD  
WESTERLY, RI 02091

LOT 17:

DOREEN A. BOSKO, ET. AL.  
C/O DONALD G. & DOLORES PARIS  
98 STERLING DRIVE  
KENSINGTON, CT 06037

LOT 17B:

CHARLANE BOSTOCK  
4040 DURANGO CT., UNIT #10B  
ESTERO, FL 33920

LOT 18:

DEAN J. PONS  
2 VIA ROMA ROAD  
WESTERLY, RI 02091

WINNAPAU G POND

ANTHONY A. NENNA

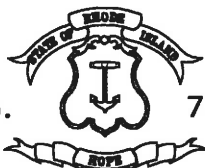

REGISTERED  
PROFESSIONAL ENGINEER

APPLICANT: NUNZIO DIMARCO  
LOCATION: 18 VIA ROMA ROAD, WESTERLY RI  
WATERWAY: WINNAPAU G POND  
PREPARED BY:

DATE: JUNE 16, 2017  
REVISED: FEBRUARY 12, 2018  
PLAT 140, LOT 17A



**-Site Engineering, INC.**  
Civil & Environmental Engineering  
85 Beach Street, Unit B  
Westerly, Rhode Island 02891  
401-348-6831

RECEIVED  
JUL 12 2018

COASTAL RESOURCES  
MANAGEMENT COUNCIL

OVERALL MAP

GRAPHIC SCALE: 1"=300'

SHEET 2 OF 12

*[Signature]*  
7-19-18

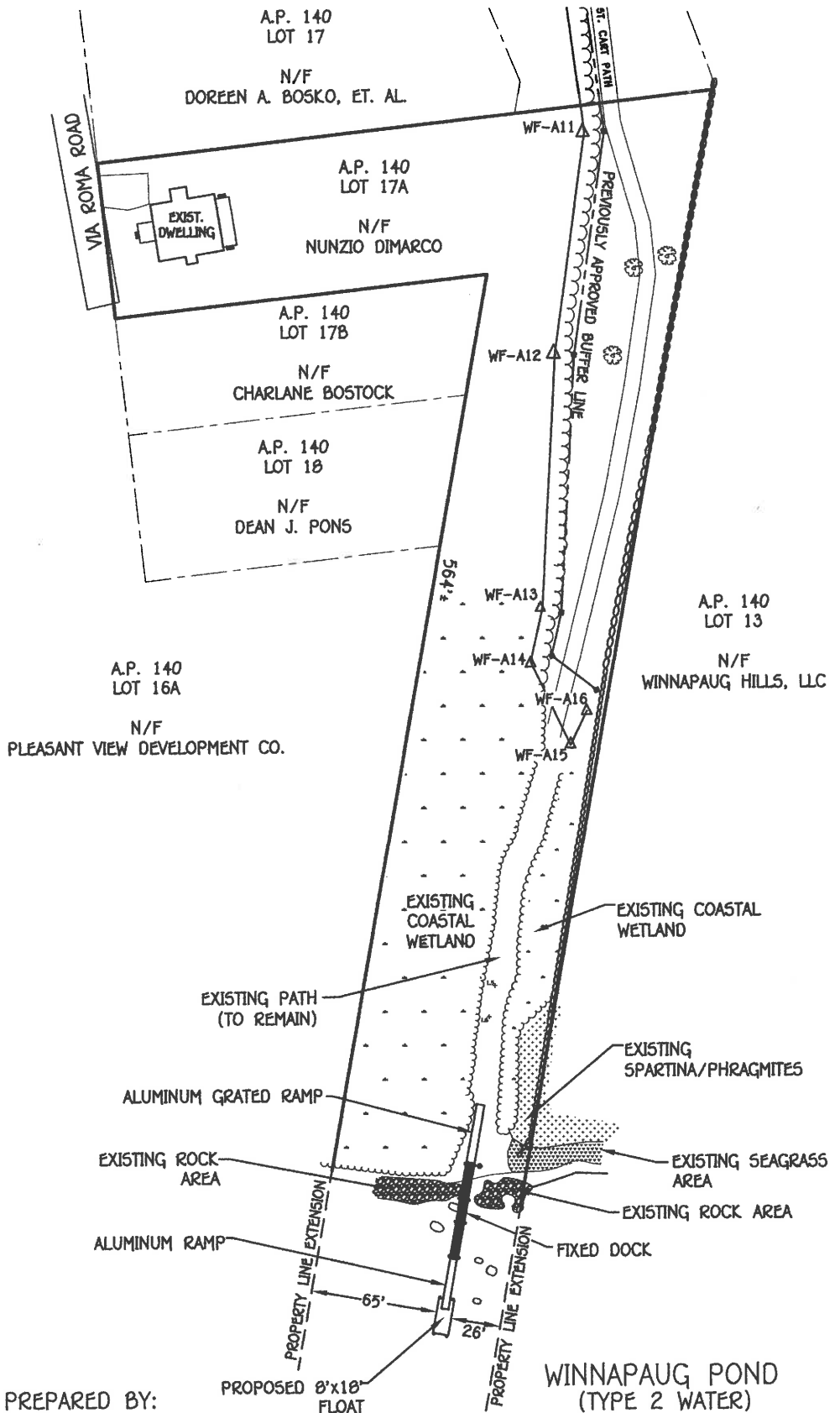

APPLICANT: NUNZIO DIMARCO  
 LOCATION: 18 VIA ROMA ROAD  
 WESTERLY RI  
 PLAT 140, LOT 17A  
 WATERWAY: WINNAPAUG POND  
 DATE: JUNE 16, 2017  
 REVISED: SEPTEMBER 12, 2018

**ANTHONY A. NENNA**  
  
**REGISTERED PROFESSIONAL ENGINEER CIVIL**

PREPARED BY:  
**-Site Engineering, INC.**  
 Civil & Environmental Engineering  
 85 Beach Street, Unit B  
 Westerly, Rhode Island 02891  
 401-348-6831

WINNAPAUG POND  
 (TYPE 2 WATER)  
**PROPOSED DOCK  
 (OVERALL PLAN)**  
 GRAPHIC SCALE: 1"=80'

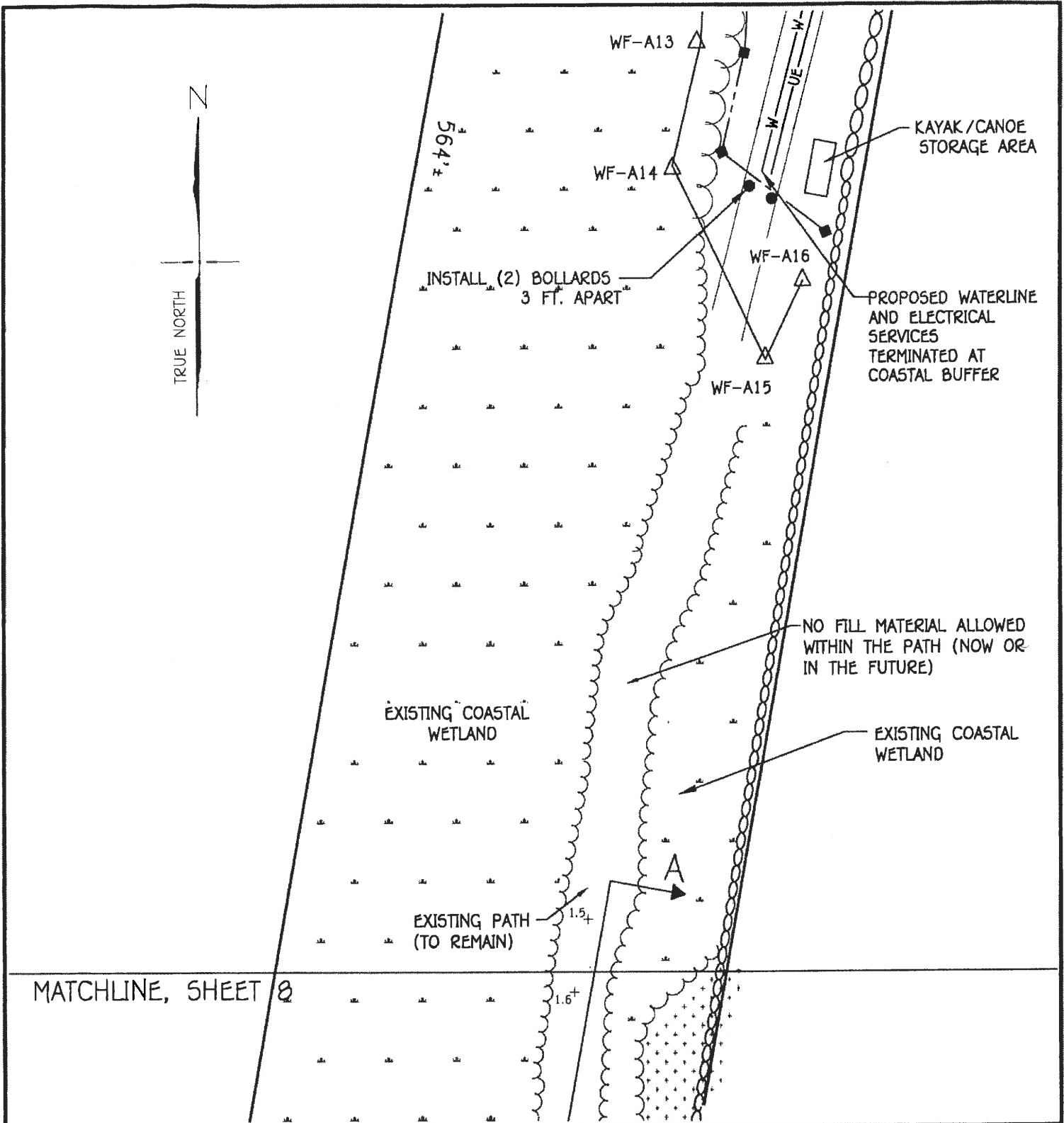

ANTHONY A. NENNA

No. 7240

REGISTERED  
PROFESSIONAL ENGINEER  
CIVIL

APPLICANT: NUNZIO DIMARCO  
 LOCATION: 10 VIA ROMA ROAD, WESTERLY RI  
 WATERWAY: WINNAPaug POND  
 PREPARED BY:

DATE: JUNE 16, 2017  
 REVISED: FEBRUARY 12, 2018  
 PLAT 140, LOT 17A

**-Site Engineering, INC.**  
 Civil & Environmental Engineering  
 85 Beach Street, Unit B  
 Westerly, Rhode Island 02891  
 401-348-6831

RECEIVED  
 JUL 12 2018  
 COASTAL RESOURCES  
 MANAGEMENT COUNCIL

SITE PLAN SHOWING  
 PROPOSED DOCK

GRAPHIC SCALE: 1"=30'

GPS DESIG. NO.	DESCRIPTION OF POINT	NORTHING	EASTING
GPS PT. #1	CENTERLINE, BEGINNING OF FIXED DOCK	90942.3244	247013.5204
GPS PT. #2	CENTERLINE, END OF FLOATING DOCK	90954.0230	246997.7911

NOTE: THE COORDINATES OF THE MOST LANDWARD AND SEAWARD PORTIONS OF THE DOCK FACILITY ARE BASED ON STATE PLANE COORDINATES DATUM NAD83 AND MEETS THE MINIMUM REQUIRES OF THE CRMC.

MATCHLINE, SHEET 7

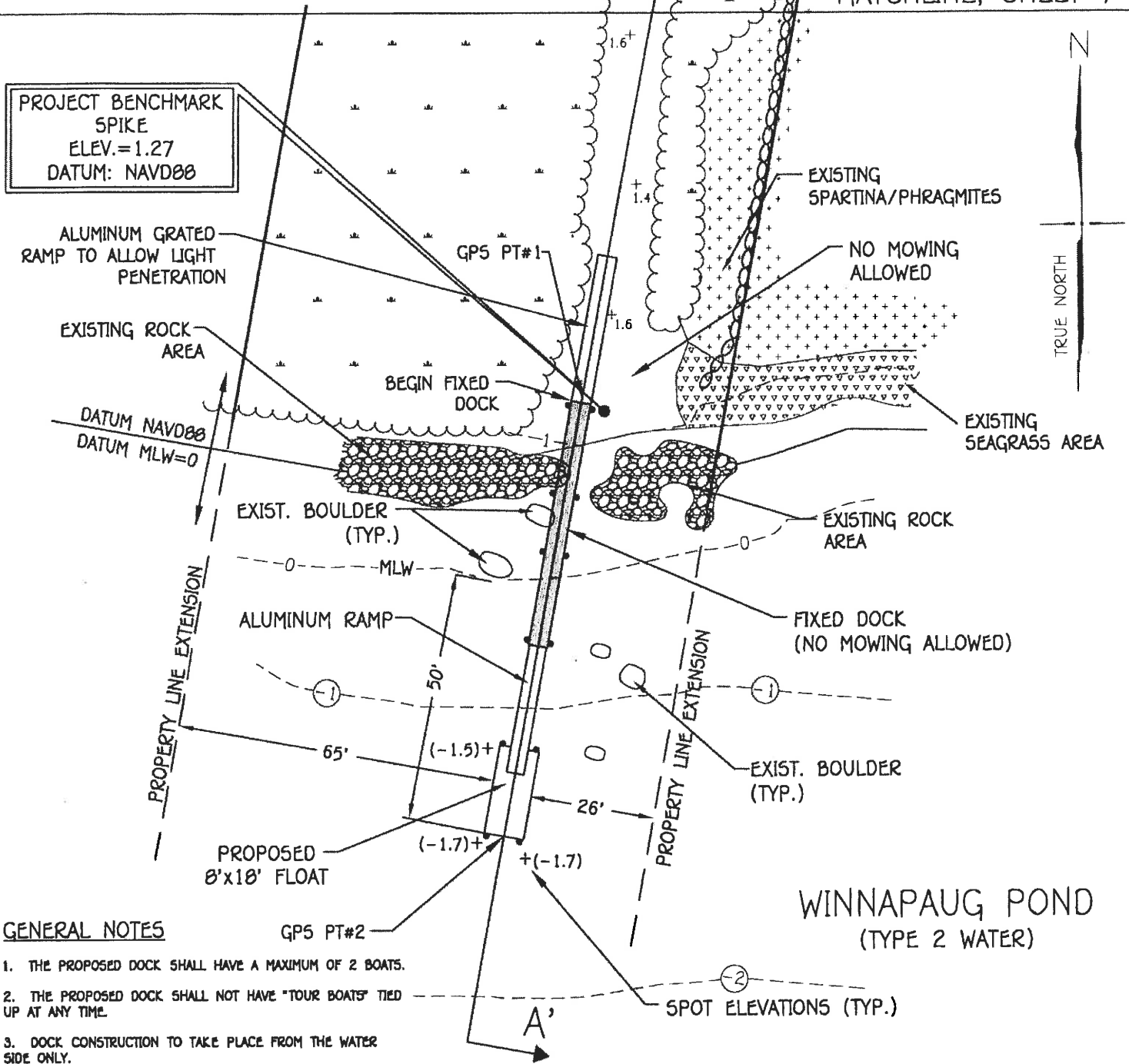

**GENERAL NOTES**

1. THE PROPOSED DOCK SHALL HAVE A MAXIMUM OF 2 BOATS.
2. THE PROPOSED DOCK SHALL NOT HAVE "TOUR BOATS" TIED UP AT ANY TIME.
3. DOCK CONSTRUCTION TO TAKE PLACE FROM THE WATER SIDE ONLY.

**ANTHONY A. NENNA**

REGISTERED PROFESSIONAL ENGINEER CIVIL

APPLICANT: NUNZIO DIMARCO  
 LOCATION: 10 VIA ROMA ROAD, WESTERLY RI  
 WATERWAY: WINNAPAUG POND  
 PREPARED BY:

DATE: JUNE 16, 2017  
 REVISED: FEBRUARY 12, 2018  
 PLAT 140, LOT 17A

**-Site Engineering, Inc**  
 Civil & Environmental Engineering  
 85 Beach Street, Unit B  
 Westerly, Rhode Island 02891  
 401-348-6831

**RECEIVED**  
**JUL 12 2018**  
 COASTAL RESOURCES MANAGEMENT COUNCIL

**SITE PLAN SHOWING PROPOSED DOCK**  
 GRAPHIC SCALE: 1"=30'

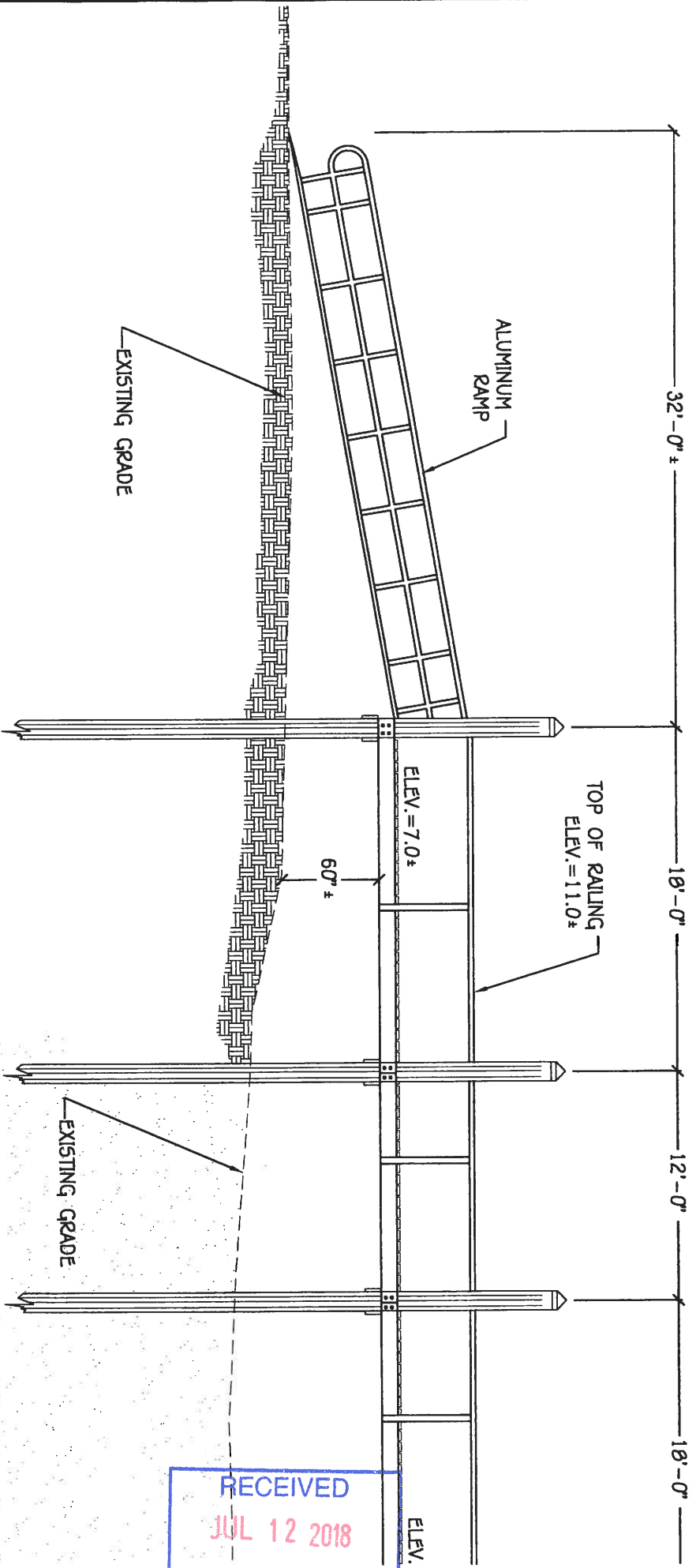

RECEIVED  
 JUL 12 2018  
 COASTAL RESOURCES  
 MANAGEMENT

ANTHONY A. NENNA  
 No. 72240  
 REGISTERED PROFESSIONAL ENGINEER

APPLICANT: NUNZIO DIMARCO  
 LOCATION: 18 VIA ROMA ROAD, WESTERLY, RI  
 WATERWAY: WINNAPAUG POND  
 PREPARED BY:

**i-Site Engineering, INC.**  
*Civil & Environmental Engineering*  
 85 Beach Street, Unit B  
 Westerly, Rhode Island 02891  
 401-348-6831

SECTION OF PROPOSED DOCK

SECTION A-A'

GRAPHIC SCALE: 1/8" = 1'

DATE: JUNE 16, 2017  
 REVISED: FEBRUARY 12, 2018  
 PLAT 140, LOT 17A

MATCHLINE (TO SHEET 9)

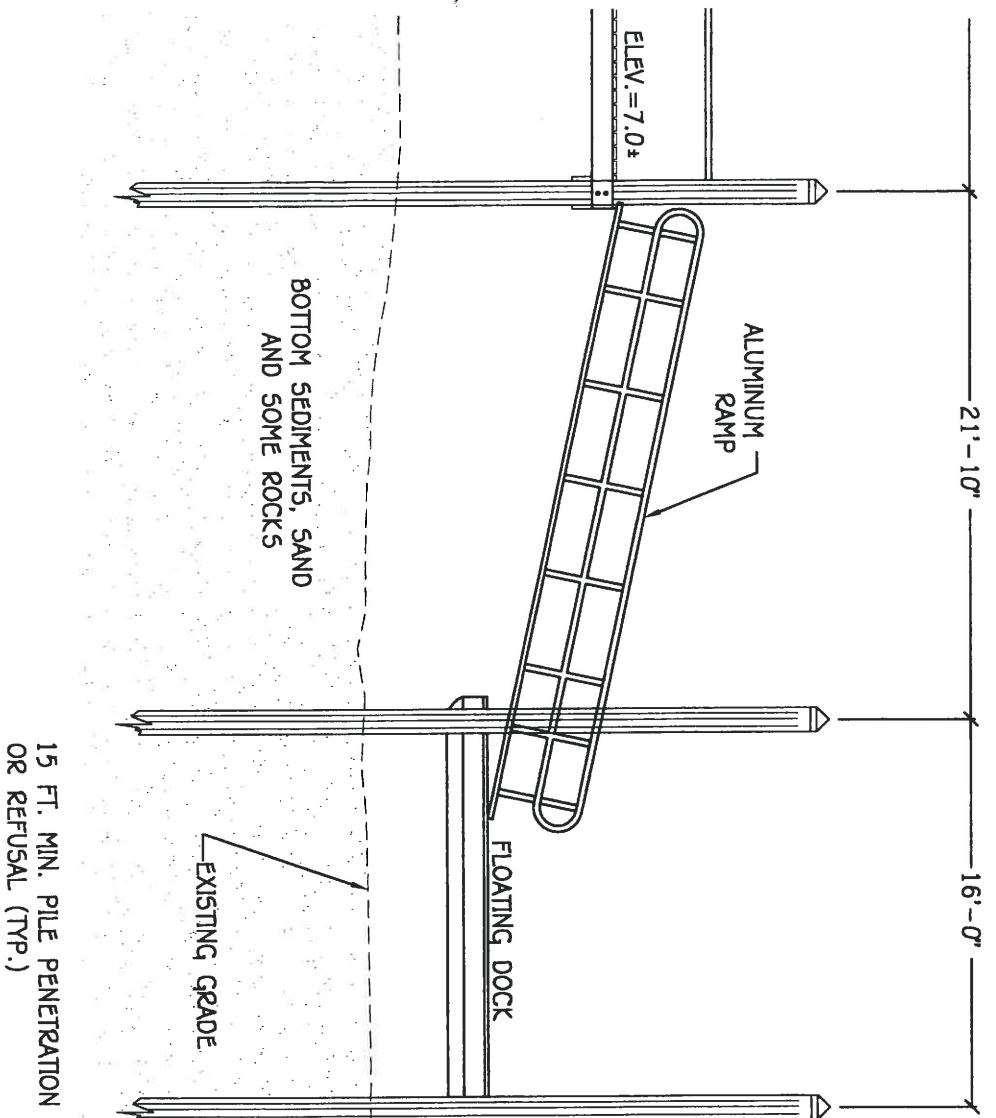

21'-10"

16'-0"

ELEV. = 7.0±

ALUMINUM RAMP

FLOATING DOCK

BOTTOM SEDIMENTS, SAND AND SOME ROCKS

EXISTING GRADE

15 FT. MIN. PILE PENETRATION OR REFUSAL (TYP.)

TOP OF PILE = 15.0±

MLW = 0

MHW = 1.6±

RECEIVED  
 JUL 12 2018  
 COASTAL RESOURCES  
 MANAGEMENT COUNCIL

ANTHONY A. NENNA

No. 7240



REGISTERED PROFESSIONAL ENGINEER

APPLICANT: NUNZIO DIMARCO  
 LOCATION: 18 VIA ROMA ROAD, WESTERLY, RI  
 WATERWAY: WINNAPAUG POND  
 PREPARED BY:

-Site Engineering, INC.

Civil & Environmental Engineering

85 Beach Street, Unit B  
 Westerly, Rhode Island 02891

401-348-6831

SECTION OF PROPOSED DOCK

SECTION A-A'

GRAPHIC SCALE: 1/8" = 1'

DATE: JUNE 16, 2017  
 REVISED: FEBRUARY 12, 2018  
 PLAT 140, LOT 17A

SHEET 10 OF 12



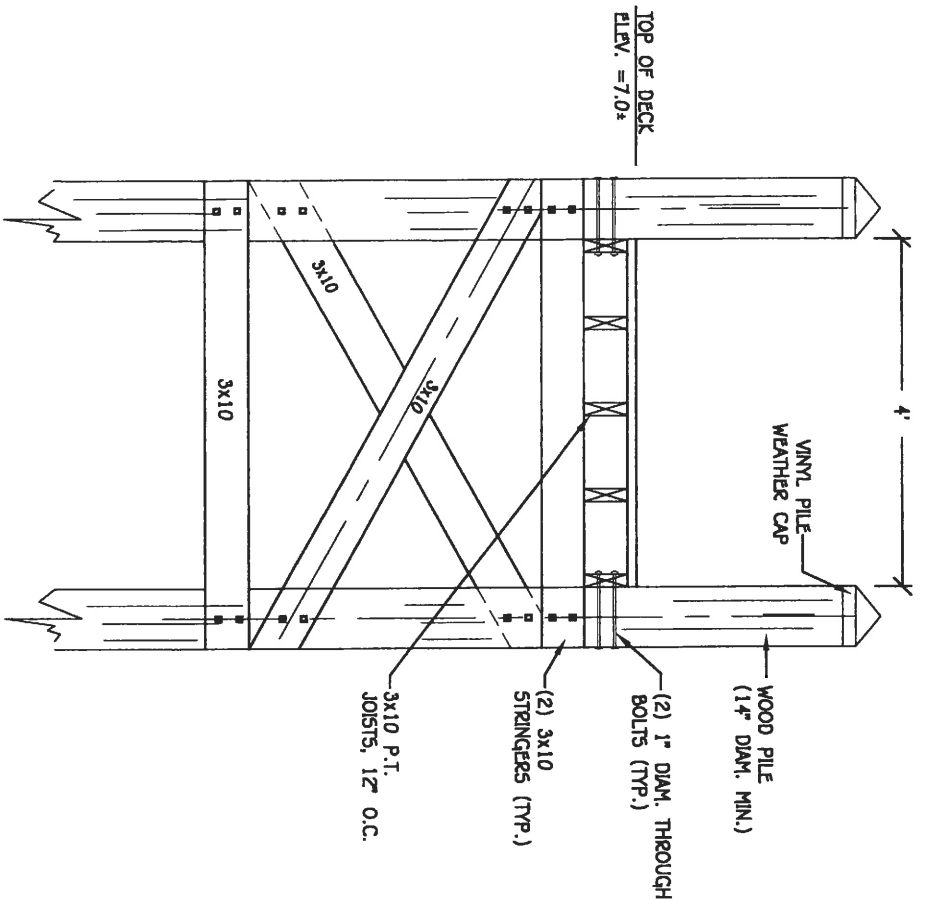

MINIMUM PILE PENETRATION 15 FT. OR REFUSAL

**FIXED DOCK - CROSS SECTION AT RAMP**

SCALE: NONE

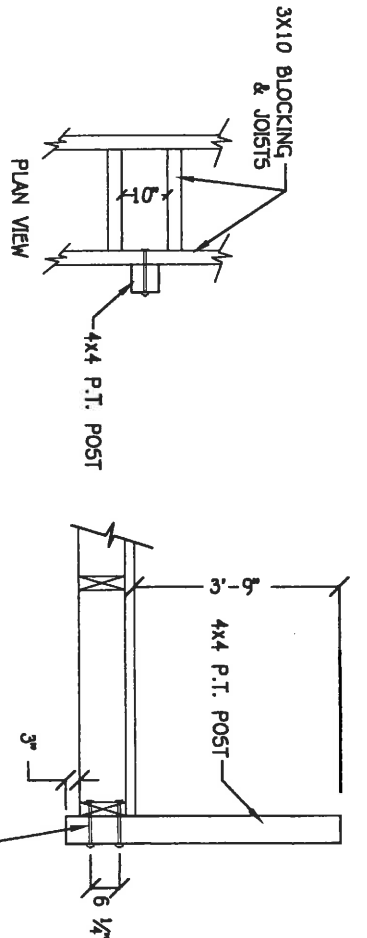

**TYPICAL POST DETAIL**

SCALE: NONE

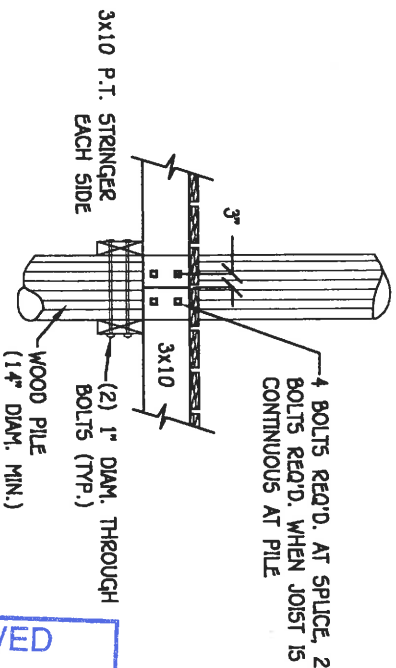

**JOIST/PILE CONNECTION**

SCALE: NONE

RECEIVED  
JUL 12 2018  
COASTAL RESOURCES  
MANAGEMENT COUNCIL

APPLICANT: NUNZIO DIMARCO  
LOCATION: 18 VIA ROMA ROAD, WESTERLY, RI  
WATERWAY: WINNAPAUG POND  
PREPARED BY:

**-Site Engineering, INC.**  
Civil & Environmental Engineering

85 Beach Street, Unit B  
Westery, Rhode Island 02891

401-348-6831

**DOCK DETAIL SHEET**

GRAPHIC SCALE: NONE

DATE: JUNE 16, 2017  
REVISED: FEBRUARY 12, 2018  
PLAT 140, LOT 17A

ANTHONY A. NENNA

No. 7240



REGISTERED  
PROFESSIONAL ENGINEER  
C.M.I.I.