



State of Rhode Island and Providence Plantations
Coastal Resources Management Council
Oliver H. Stedman Government Center
4808 Tower Hill Road, Suite 3
Wakefield, RI 02879-1900

(401) 783-3370
Fax (401) 783-2069

PUBLIC NOTICE

File Number: 2018-04-021

Date: May 4, 2018

This office has under consideration the application of:

Luciano Canova
800 Washington Street
Wrentham, MA 02093

for a State of Rhode Island Assent to construct and maintain:

Residential boating facility consisting of a 4'x94' fixed pier to a 3'x20' ramp and 150ft² float, to extend 100' beyond Mean Low Water (MLW), requiring a 75' Variance to Section 1.3.1(D).11.(I)

Project Location:	1 Riverside Drive
City/Town:	Tiverton
Plat/Lot:	304 / 170
Waterway:	Sakonnet River

Plans of the proposed work may be seen at the CRMC office in Wakefield.

In accordance with the Administrative Procedures Act (Chapter 42-35 of the Rhode Island General Laws) you may request a hearing on this matter.

You are advised that if you have good reason to enter protests against the proposed work it is your privilege to do so. It is expected that objectors will review the application and plans thoroughly, visit site of proposed work if necessary, to familiarize themselves with the conditions and cite what law or laws, if any, would in their opinion be violated by the work proposed.

If you desire to protest, you must attend the scheduled hearing and give sworn testimony. A notice of the time and place of such hearing will be furnished you as soon as possible after receipt of your request for hearing. If you desire to request a hearing, to receive consideration, it should be in writing (**with your correct mailing address, e-mail address and valid contact number**) and be received at this office on or before June 4, 2018.

/lat

RIVERSIDE DRIVE
(Public R.O.W.)

MAIN ROAD
(P.O.T. STATE ROAD)

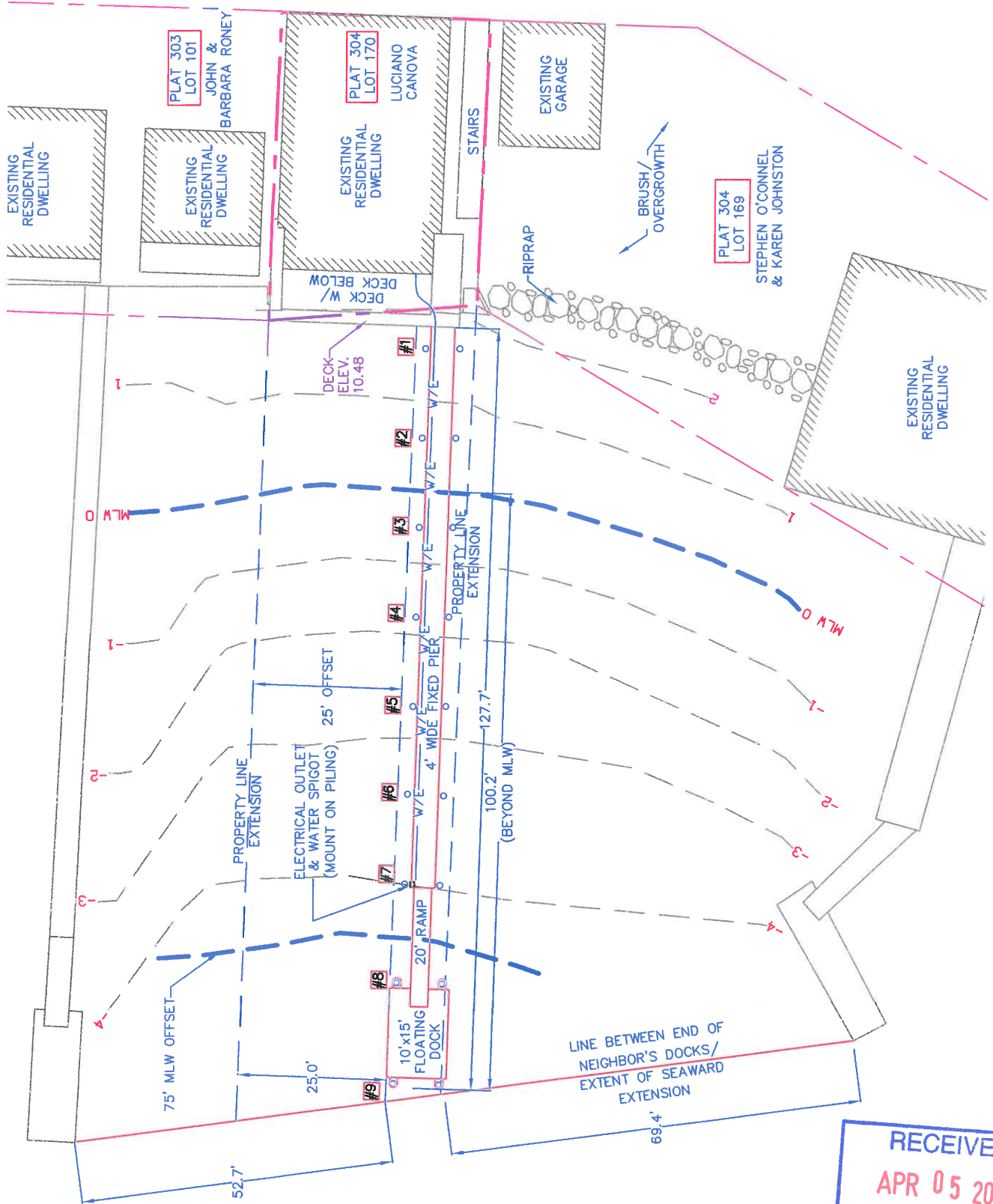

PLAT 303
LOT 101
JOHN &
BARBARA RONEY

PLAT 304
LOT 170
LUCIANO
CANOVA

PLAT 304
LOT 169
STEPHEN O'CONNEL
& KAREN JOHNSTON

RECEIVED
APR 05 2018
COASTAL RESOURCES
MANAGEMENT COUNCIL



FILE COPY

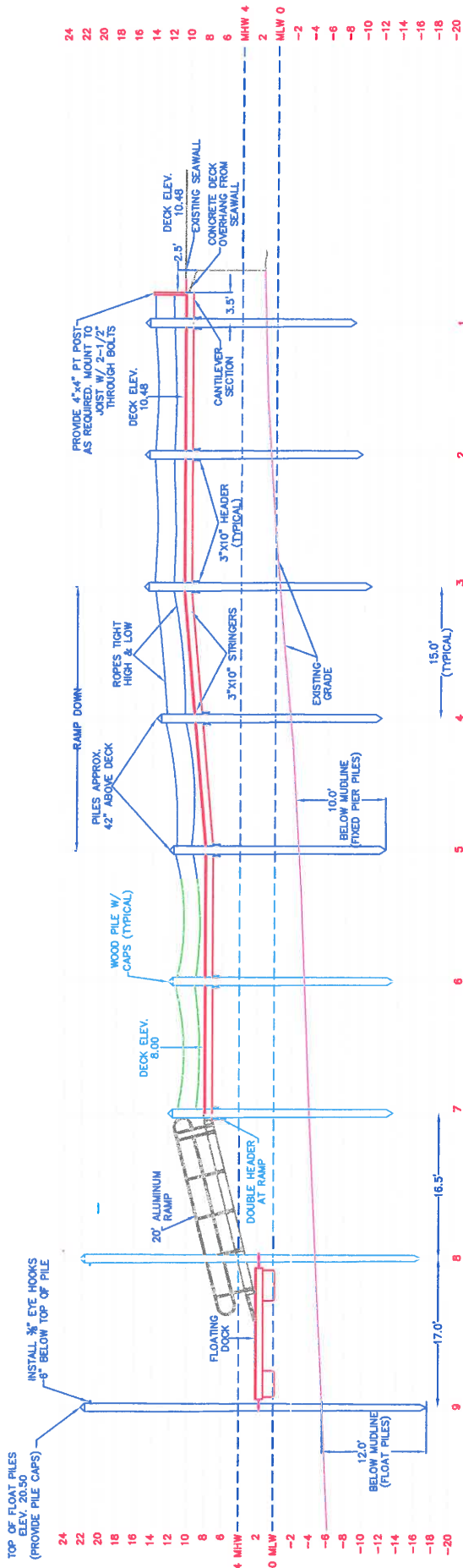

ALL FIXED PIER PILES SHALL BE DRIVEN 10' BELOW MUDLINE.
 ALL FLOAT PILES SHALL BE DRIVEN 12' BELOW MUDLINE.

DOCK PROFILE

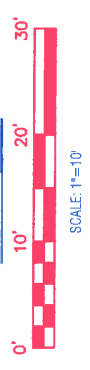

FLOOD ZONE IS VE (EL. 16) MSL.
 HEIGHT OF FLOAT PILES=16+2'(MLW TO MSL)+1.5'(FREEBOARD)+1=20.50

SITE ADDRESS:
 1 RIVERSIDE DRIVE
 TIVERTON, RI 028



FILE COPY

RECEIVED
APR 05 2018
 COASTAL RESOURCES
 MANAGEMENT COUNCIL