



State of Rhode Island and Providence Plantations
Coastal Resources Management Council
 Oliver H. Stedman Government Center
 4808 Tower Hill Road, Suite 3
 Wakefield, RI 02879-1900

(401) 783-3370
 Fax (401) 783-2069

PUBLIC NOTICE

File Number: 2018-05-124 Date: January 24, 2019

This office has under consideration the application of:

**602 East Shore Road Trust
 c/o Steve Tilley
 117 Mourning Dove Drive
 Saunderstown, RI 02874-2205**

for a State of Rhode Island Assent to construct and maintain:

Restack existing stones, add stones to provide toe protection and install 12” diameter coir logs, stabilize bank with *Rosa rugosa*, bay berry and arrowwood shrubs, install 6” x 6” treads (wood) for access over bank to shoreline.

Project Location:	602 East Shore Road
City/Town:	Jamestown
Plat/Lot:	2 / 83
Waterway:	Narraganset Bay/East Passage

Plans of the proposed work may be seen at the CRMC office in Wakefield.

In accordance with the Administrative Procedures Act (Chapter 42-35 of the Rhode Island General Laws) you may request a hearing on this matter.

You are advised that if you have good reason to enter protests against the proposed work it is your privilege to do so. It is expected that objectors will review the application and plans thoroughly, visit site of proposed work if necessary, to familiarize themselves with the conditions and cite what law or laws, if any, would in their opinion be violated by the work proposed.

If you desire to protest, you must attend the scheduled hearing and give sworn testimony. A notice of the time and place of such hearing will be furnished you as soon as possible after receipt of your request for hearing. If you desire to request a hearing, to receive consideration, it should be in writing (**with your correct mailing address, e-mail address and valid contact number**) and be received at this office on or before February 24, 2019.

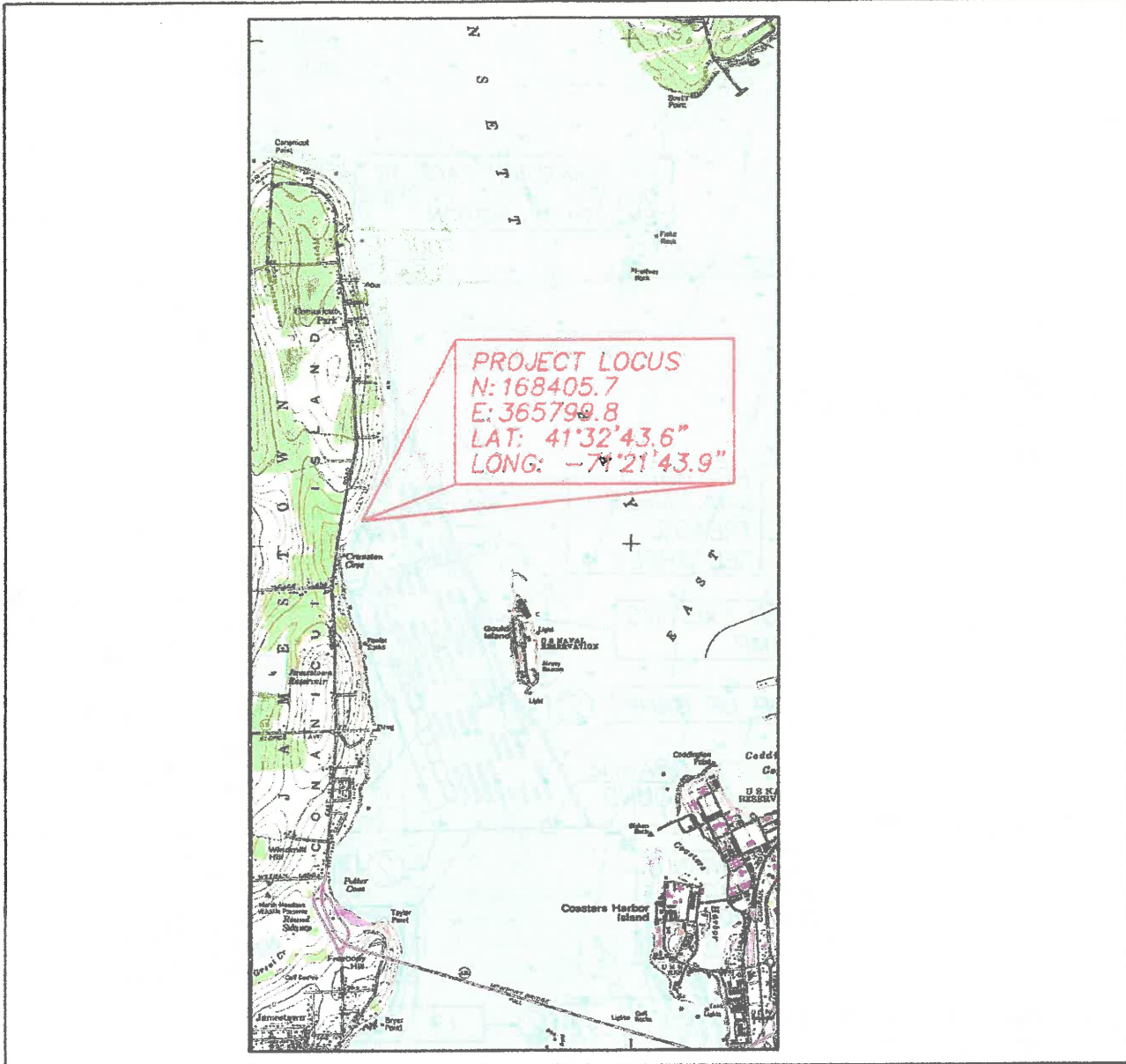

LOCUS PLAN
1" = 1 MILE

BANK STABILIZATION LOCUS PLAN

602 EAST SHORE ROAD TRUST
602 EAST SHORE ROAD
AP 2, LOT 83
JAMESTOWN, RI 02835

BY: WARREN HALL, CIVIL ENGINEER
9-29-18 SHEET 1 OF 4

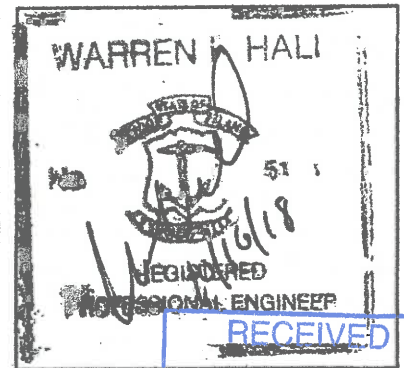

RECEIVED
OCT 17 2018
COASTAL RESOURCES
MANAGEMENT COUNCIL



Scale 1" = 60'



LEGEND
 PL PROPERTY LINE
 MHW MEAN HIGH WATER
 MLW MEAN LOW WATER

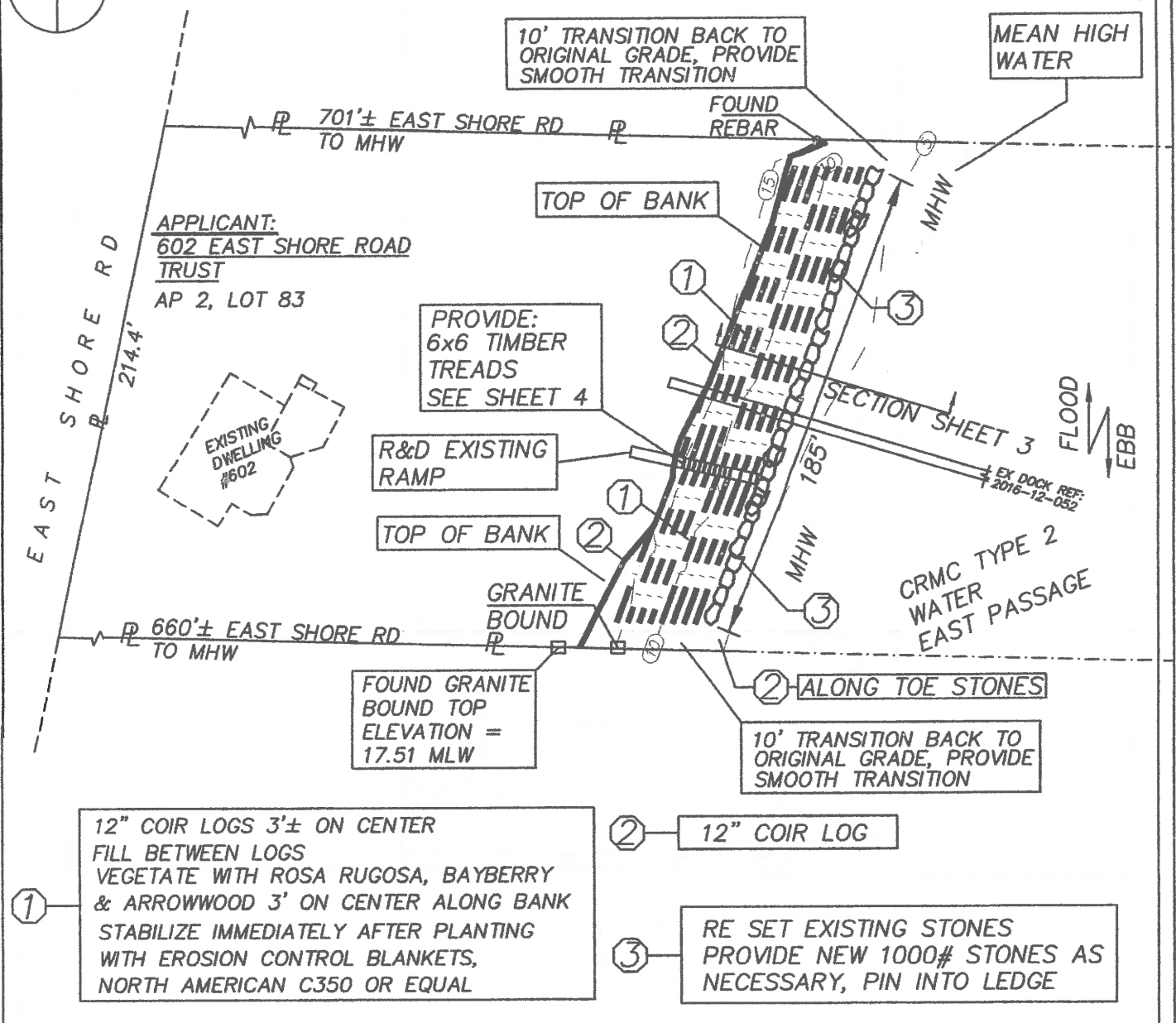

① 12" COIR LOGS 3'± ON CENTER
 FILL BETWEEN LOGS
 VEGETATE WITH ROSA RUGOSA, BAYBERRY
 & ARROWWOOD 3' ON CENTER ALONG BANK
 STABILIZE IMMEDIATELY AFTER PLANTING
 WITH EROSION CONTROL BLANKETS,
 NORTH AMERICAN C350 OR EQUAL

② 12" COIR LOG

③ RE SET EXISTING STONES
 PROVIDE NEW 1000# STONES AS
 NECESSARY, PIN INTO LEDGE

PROPOSED BANK STABILIZATION
 602 EAST SHORE ROAD TRUST
 602 EAST SHORE ROAD
 AP 2, LOT 83
 JAMESTOWN, RI 02835
 BY: WARREN HALL, CIVIL ENGINEER
 9-29-18 1"=60' SHEET 2 OF 4

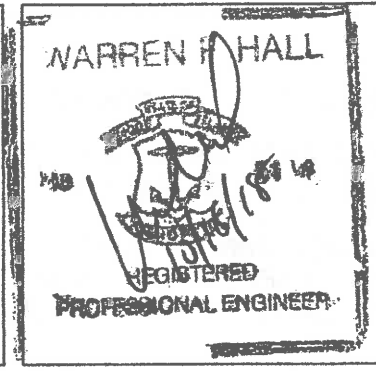



12" COIR LOGS 3'± ON CENTER
 FILL BETWEEN LOGS
 VEGETATE WITH ROSA RUGOSA, BAYBERRY
 & ARROWWOOD 3' ON CENTER ALONG BANK
 ALL PLANTS TO BE MINIMUM 5 GALLON CONTAINER SIZE
 STABILIZE IMMEDIATELY AFTER PLANTING
 WITH EROSION CONTROL BLANKETS,
 NORTH AMERICAN C350 OR EQUAL

NOTE: IF LEDGE IS ENCOUNTERED
 REMOVE MECHANICALLY TO
 GRADE OR DRILL & PIN

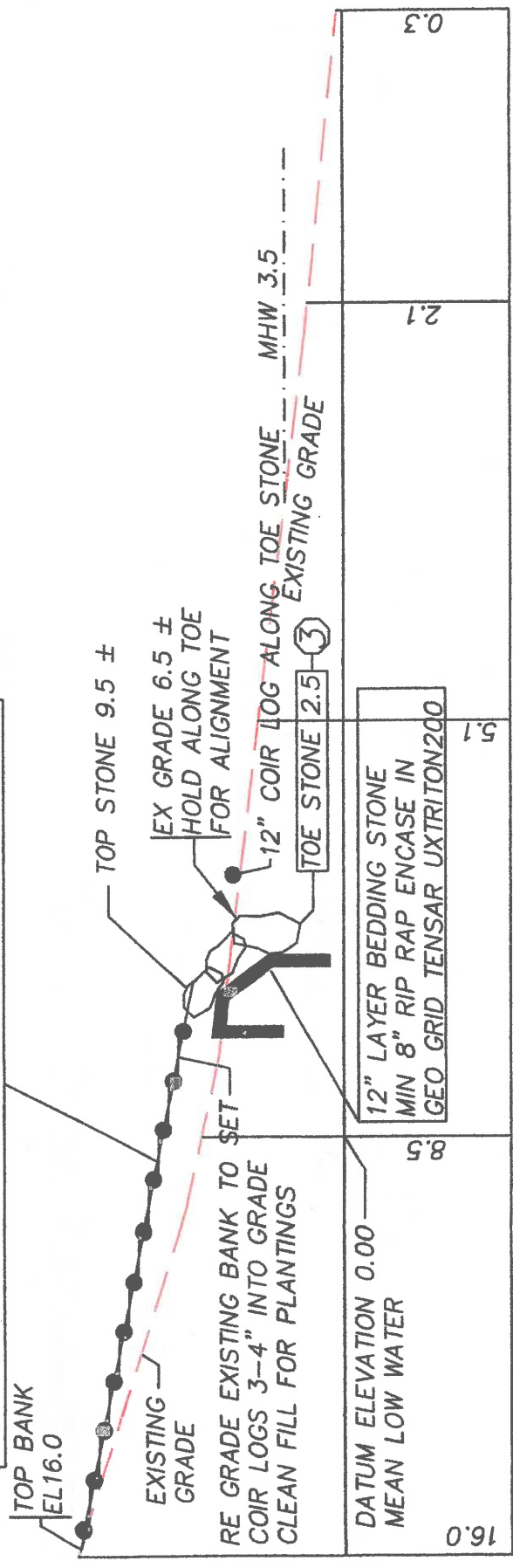

SECTION THRU BANK (TYPICAL) 0+50
 1"=10'

PROPOSED BANK STABILIZATION
 602 EAST SHORE ROAD TRUST
 602 EAST SHORE ROAD
 MAP 2, LOT 83
 JAMESTOWN, RI 02835
 BY: WARREN HALL, CIVIL ENGINEER
 9-29-18 1"=60' SHEET 3 OF 4



RECEIVED
 OCT 17 2018
 COASTAL RESOURCES
 MANAGEMENT COUNCIL

TOP BANK
EL16.0

6x6 PT TIMBER x 4'
SET 2"± INT GRADE
FILL TO PROVIDE 1'
LEVEL TREAD AREA
SATBILIZE WITH NETTING

HAND PICK STONES TO PROVIDE
SMOOTH TREAD FOR ACCESS
AT BOTTOM OF PATH

NOTE: IF LEDGE IS ENCOUNTERED
REMOVE MECHANICALLY TO
GRADE OR DRILL & PIN

EX GRADE 6.5 ±
HOLD ALONG TOE
FOR ALIGNMENT

12" COIR LOG ALONG TOE STONE

EXISTING GRADE

TOE STONE 2.5

DATUM ELEVATION 0.00
MEAN LOW WATER

12" LAYER BEDDING STONE
MIN 8" RIP RAP ENCASE IN
GEO GRID TENSAR UXTRITON200

16.0

15.0

15.1

2.1

0.3

0+00

0+50

SECTION THRU 4' WALKWAY
1"=10'

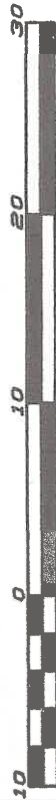

Scale 1" = 10'

PROPOSED BANK STABILIZATION
602 EAST SHORE ROAD TRUST
602 EAST SHORE ROAD
AP 2, LOT 83
JAMESTOWN, RI 02835
BY: WARREN HALL, CIVIL ENGINEER
9-29-18 1"=60' SHEET 4 OF 4

