



State of Rhode Island and Providence Plantations  
**Coastal Resources Management Council**  
 Oliver H. Stedman Government Center  
 4808 Tower Hill Road, Suite 3  
 Wakefield, RI 02879-1900

(401) 783-3370  
 Fax (401) 783-2069

**PUBLIC NOTICE**

File Number: 2018-05-125 Date: June 14, 2018

This office has under consideration the application of:

New Ref Horizon, LLC  
 2 Alger Ave.  
 Warwick, RI 02818

for a State of Rhode Island Assent to construct and maintain a residential boating facility consisting of a 143'x4' fixed pier, a 24' ramp, and a 9.5'x15.78' terminal float. The facility is proposed to extend 75' past mean low water to achieve a water depth of 2.7' at its terminus. In addition, a 10,000# boat lift is proposed. Variance is required from 1.3.1.D.11, (k) and 1.3.1.D.11.(l) as the facility is proposed to extend greater than 50' beyond mean low water, and be located 0' and 10' from the property line extensions where 25' is required.

Project Location:	2 Alger Avenue
City/Town:	Warwick
Plat/Lot:	221 / 112
Waterway:	Greenwich Bay

Plans of the proposed work may be seen at the CRMC office in Wakefield.

In accordance with the Administrative Procedures Act (Chapter 42-35 of the Rhode Island General Laws) you may request a hearing on this matter.

You are advised that if you have good reason to enter protests against the proposed work it is your privilege to do so. It is expected that objectors will review the application and plans thoroughly, visit site of proposed work if necessary, to familiarize themselves with the conditions and cite what law or laws, if any, would in their opinion be violated by the work proposed.

If you desire to protest, you must attend the scheduled hearing and give sworn testimony. A notice of the time and place of such hearing will be furnished you as soon as possible after receipt of your request for hearing. If you desire to request a hearing, to receive consideration, it should be in writing (**with your correct mailing address, e-mail address and valid contact number**) and be received at this office on or before July 14, 2018.

/lat

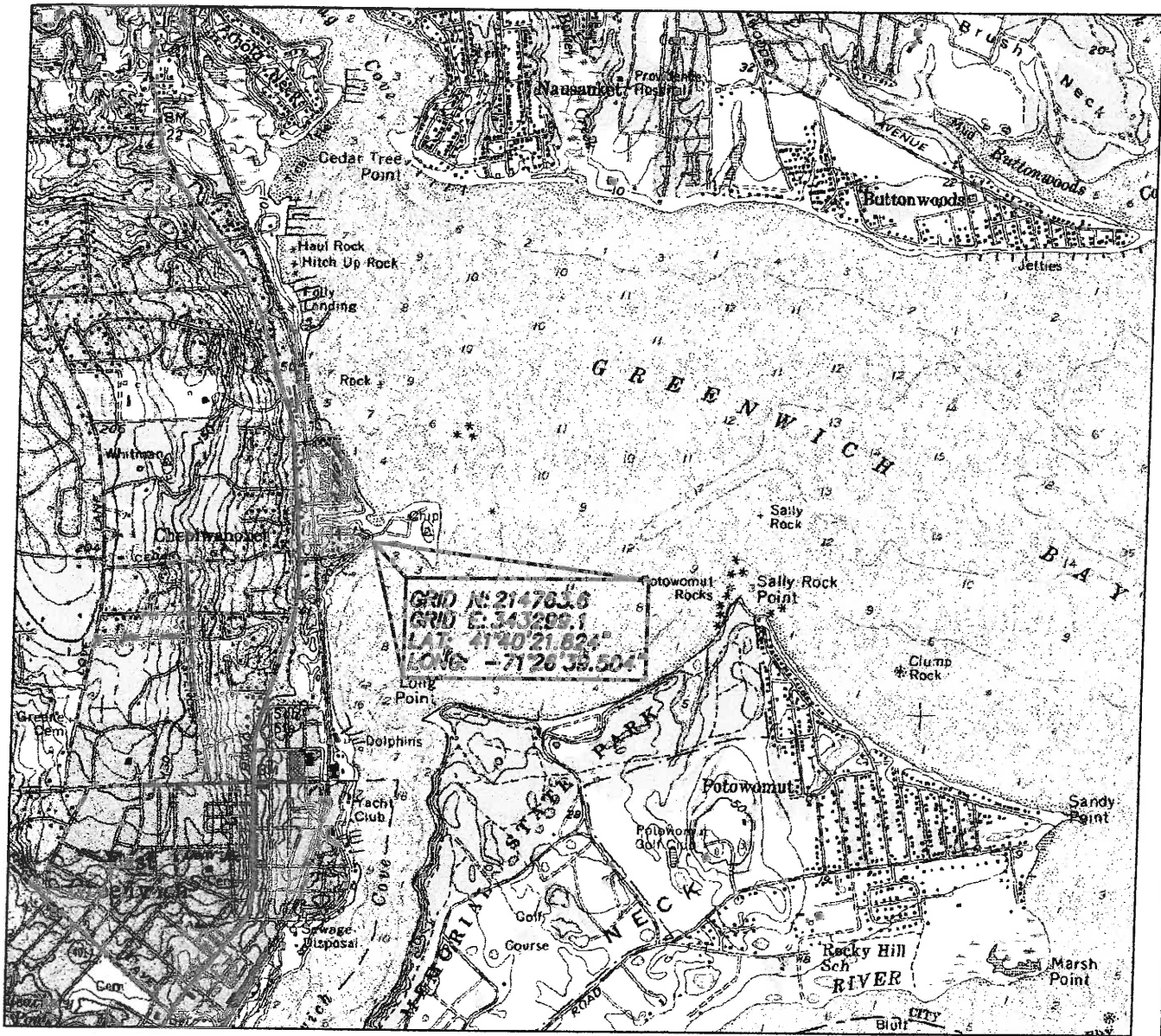

PROJECT LOCUS



PROPOSED RESIDENTIAL PIER & BOAT LIFT FOR:  
 NEW REF HORIZON LLC, c/o RALPH FONTAINE  
 2 ALGER AVE.,  
 AP 221, LOT 112  
 WARWICK, RI 02818  
 BY: WARREN HALL, CIVIL ENGINEER  
 DECEMBER 21, 2017 SHEET 1 OF 5

RECEIVED  
 MAY 23 2018  
 COASTAL RESOURCES  
 MANAGEMENT COUNCIL

WARREN F. HALL

REGISTERED  
 PROFESSIONAL ENGINEER

40 0 40 80 120

Scale 1" = 40'

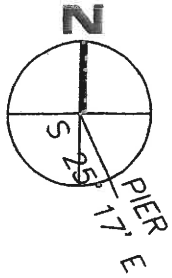

APPLICANT:  
RALPH FONTAIN  
AP 221, LOT 112

AP 221, LOT 94  
N/F CITY OF WARWICK

AP 221, LOT 59  
N/F KEVIN MORAN

ALGER AVE

#2 ALGER

MEAN HIGH  
WATER 4.1

GREENWICH COVE  
CRMC TYPE 1  
WATER

SHORELINE

PROPERTY LINE  
EXTENSION

PROPOSED PIER

PROPERTY LINE  
EXTENSION

MEAN LOW WATER

EXISTING PIER

142.7'

75.0'

- 1 10,000# BOAT LIFT
- 2 9.5'x15.78' FLOAT  
150 SQUARE FEET

3 TEST PILE TO DETERMINE  
15' EMBEDMENT IS ADEQUATE  
TO RESIST FORCES, ENGINEER  
TO WITNESS

-2

-3

GREENWICH COVE  
CRMC TYPE 2  
WATER

FLOOD  
EBB

PROPERTY LINE WORK REFERENCE  
SURVEY BY WATERMAN ENGINEERING

PROPOSED RESIDENTIAL PIER & BOAT LIFT FOR:  
NEW REF HORIZON LLC, c/o RALPH FONTAINE  
2 ALGER AVE.,  
AP 221, LOT 112  
WARWICK, RI 02818  
BY: WARREN HALL, CIVIL ENGINEER  
DECEMBER 21, 2017 SHEET 2 OF 5

WARREN F HALL

5/12/17

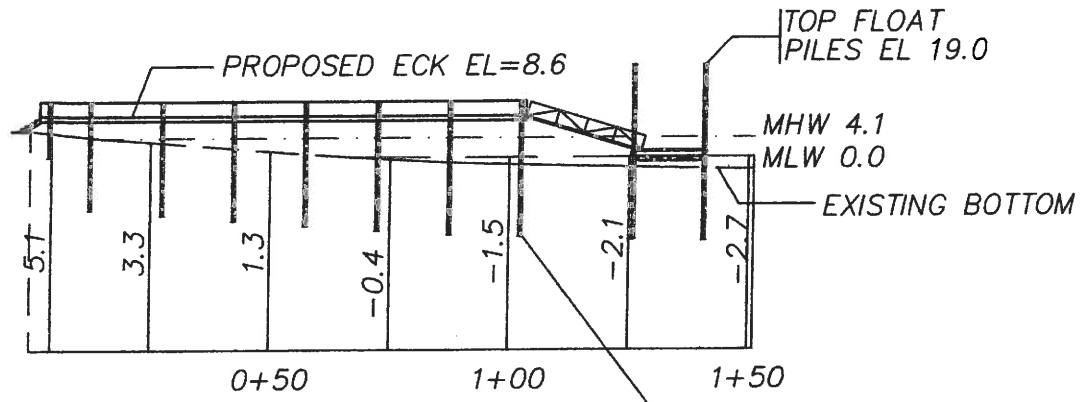
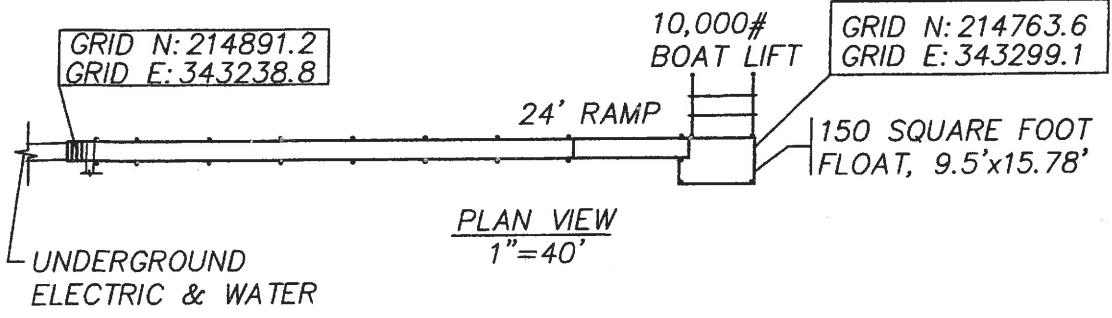
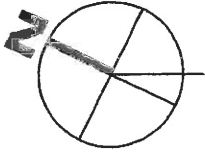

DRIVE ALL PILES  
TO MINIMUM 15' EMBEDMENT  
CONTRACTOR TO KEEP RECORD OF ALL  
PILE LENGTHS, CUT OFF LENGTHS  
AND LOCATION, SUBMIT TO OWNER &  
ENGINEER

PROPOSED RESIDENTIAL PIER & BOAT LIFT FOR:  
NEW REF HORIZON LLC, c/o RALPH FONTAINE  
2 ALGER AVE.,  
AP 221, LOT 112  
WARWICK, RI 02818  
BY: WARREN HALL, CIVIL ENGINEER  
DECEMBER 21, 2017 SHEET 3 OF 5

RECEIVED  
MAY 23 2018  
COASTAL RESOURCES  
MANAGEMENT COUNCIL

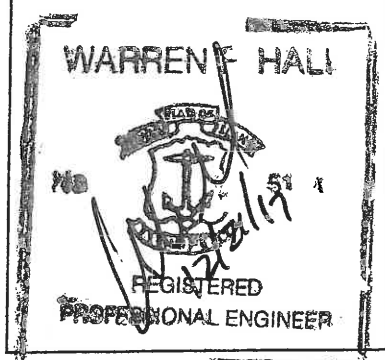

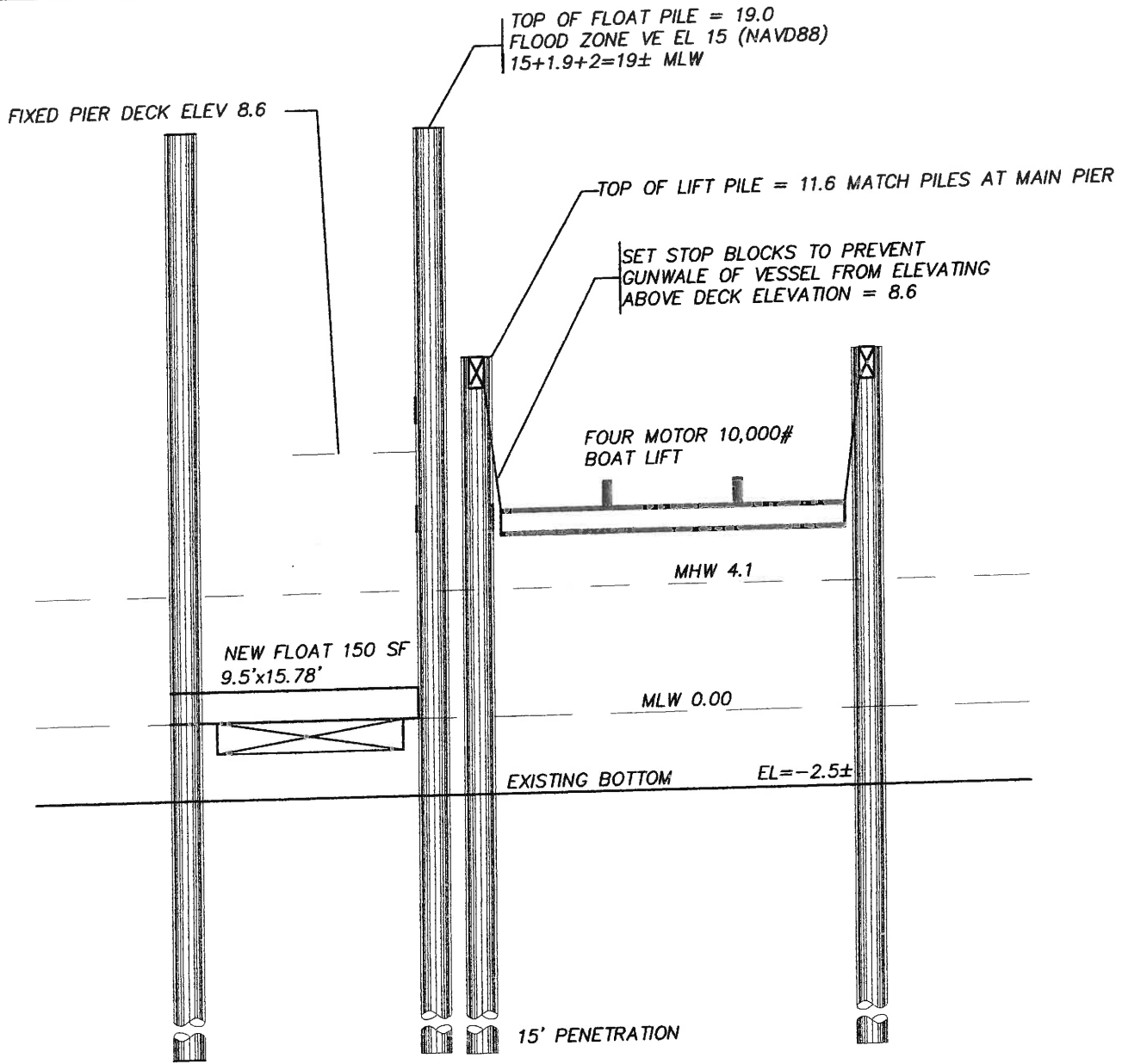

SECTION THRU FLOAT & BOAT LIFT  
 $\frac{3}{16}'' = 1' - 0''$

PROPOSED RESIDENTIAL PIER & BOAT LIFT FOR:  
 NEW REF HORIZON LLC, c/o RALPH FONTAINE  
 2 ALGER AVE.,  
 AP 221, LOT 112  
 WARWICK, RI 02818  
 BY: WARREN HALL, CIVIL ENGINEER  
 DECEMBER 21, 2017 SHEET 4 OF 5

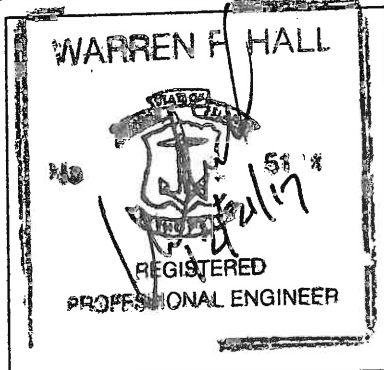

- ① 10" TIP CCA TREATED WOOD PILES  
TREAT TO 2.5 PCF, 15' EMBEDMENT
- ② 2x6 DECKING ACQ TREATED TO .6 PCF  
FASTEN TO STRINGERS WITH 2 16d  
SPIRAL SHANK NAIL
- ③ 3x12 STRINGER, THRU BOLT AT PILE  
FASTEN MIDDLE STRINGER WITH SIMPSON  
H-1 HURRICANE ANCHOR
- ④ 2-3x12 CAP BEAM, ACQ TREATED TO  
.6 PCF
- ⑤ 3x10 CROSS BRACE, ACQ TREATED TO  
.8 PCF

GENERAL NOTES:

- 1) ALL BOLTS, CONNECTORS, WASHERS, NAILS, ECT  
SHALL BE HOT DIPPED GALVANIZED
- 2) CONTRACTOR SHALL ADHERE TO ALL OSHA RULES  
AND REGULATIONS THROUGHOUT ALL PHASES OF  
CONSTRUCTION
- 3) CONTRACTOR SHALL BE AWARE THAT THE STRATA INTO WHICH  
THE PILES ARE TO BE DRIVEN MAY VARY FROM THE ASSUMPTION  
THAT THESE PILES WILL PENETRATE 15' INTO SUITABLE MATERIAL

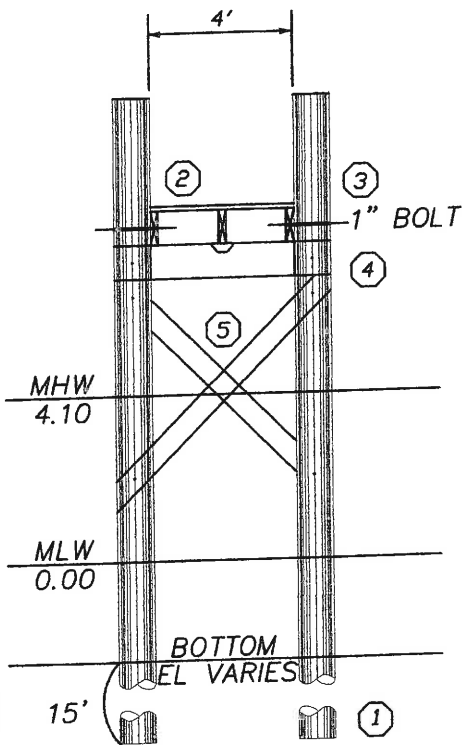

TRANSVERSE SECTION @ PILE BENT

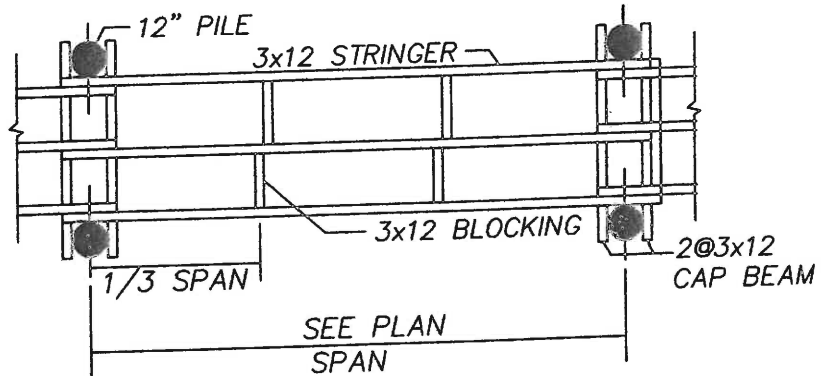

PLAN VIEW TYPICAL FRAMING

PROPOSED RESIDENTIAL PIER & BOAT LIFT FOR:  
 NEW REF HORIZON LLC, c/o RALPH FONTAINE  
 2 ALGER AVE.,  
 AP 221, LOT 112  
 WARWICK, RI 02818  
 BY: WARREN HALL, CIVIL ENGINEER  
 DECEMBER 21, 2017 SHEET 5 OF 5

RECEIVED  
 MAY 23 2018  
 COASTAL RESOURCES  
 MANAGEMENT COUNCIL

WARREN F. HALL

REGISTERED  
 PROFESSIONAL ENGINEER