



State of Rhode Island and Providence Plantations  
**Coastal Resources Management Council**  
 Oliver H. Stedman Government Center  
 4808 Tower Hill Road, Suite 3  
 Wakefield, RI 02879-1900

(401) 783-3370  
 Fax (401) 783-2069

**PUBLIC NOTICE**

File Number: 2018-06-009 Date: June 12, 2018

This office has under consideration the application of:

Joan Tokarz  
 11 Seal Island Road  
 Bristol, RI 02809

for a State of Rhode Island Assent to construct and maintain: a residential boating facility consisting of 4'x62' fixed pier, a 3'x20' ramp and a 10'x15' float. Facility will extend to 75' beyond Mean Low Water (MLW) requiring a Variance to Section 1.3.1(D).11.1.

Project Location:	327 Riverside Street
City/Town:	Portsmouth
Plat/Lot:	15 / 41
Waterway:	BlueBell Cove

Plans of the proposed work may be seen at the CRMC office in Wakefield.

In accordance with the Administrative Procedures Act (Chapter 42-35 of the Rhode Island General Laws) you may request a hearing on this matter.

You are advised that if you have good reason to enter protests against the proposed work it is your privilege to do so. It is expected that objectors will review the application and plans thoroughly, visit site of proposed work if necessary, to familiarize themselves with the conditions and cite what law or laws, if any, would in their opinion be violated by the work proposed.

If you desire to protest, you must attend the scheduled hearing and give sworn testimony. A notice of the time and place of such hearing will be furnished you as soon as possible after receipt of your request for hearing. If you desire to request a hearing, to receive consideration, it should be in writing (**with your correct mailing address, e-mail address and valid contact number**) and be received at this office on or before July 12, 2018.

/lat

**DK-1**



OWNER:  
JOAN TOKARZ  
11 SEAL ISLAND RD.  
BRISTOL, RI 02809

DATE: 8/17/17

BY: MARGANSETT ENGINEERING, INC.

LEGEND:  
PROPERTY LINE EXTENSION  
PROPERTY LINE  
EXISTING CONCRETE  
EXISTING CONCRETE  
EXISTING CONCRETE  
EXISTING CONCRETE  
EXISTING CONCRETE

DATUM:  
REFERENCE DATUM IS MEAN  
LOW WATER

SCALE: 1"=40'

NOTES:  
CORNER FOUND WITHIN 50' OF END OF PROPOSED DOCK HAVE  
BEEN SHOWN ON PLAN

**SITE PLAN AND SPECIFICATIONS**  
RESIDENTIAL BOATING FACILITY  
PLAT 15, LOT 41  
PORTSMOUTH, RHODE ISLAND

**SEI**  
SITE ENGINEERING INC.  
CIVIL, ELECTRICAL, MECHANICAL  
PHYSICAL (P) AND (M) ENGINEERS  
1000 WEST MAIN STREET  
PROVIDENCE, RI 02903  
(401) 421-0311

DATE	BY	DESCRIPTION
5/8/18	RB	DATE
	VS	CHK
	RB	CSM
		DATE
		DATE
		DATE
		DATE
		DATE

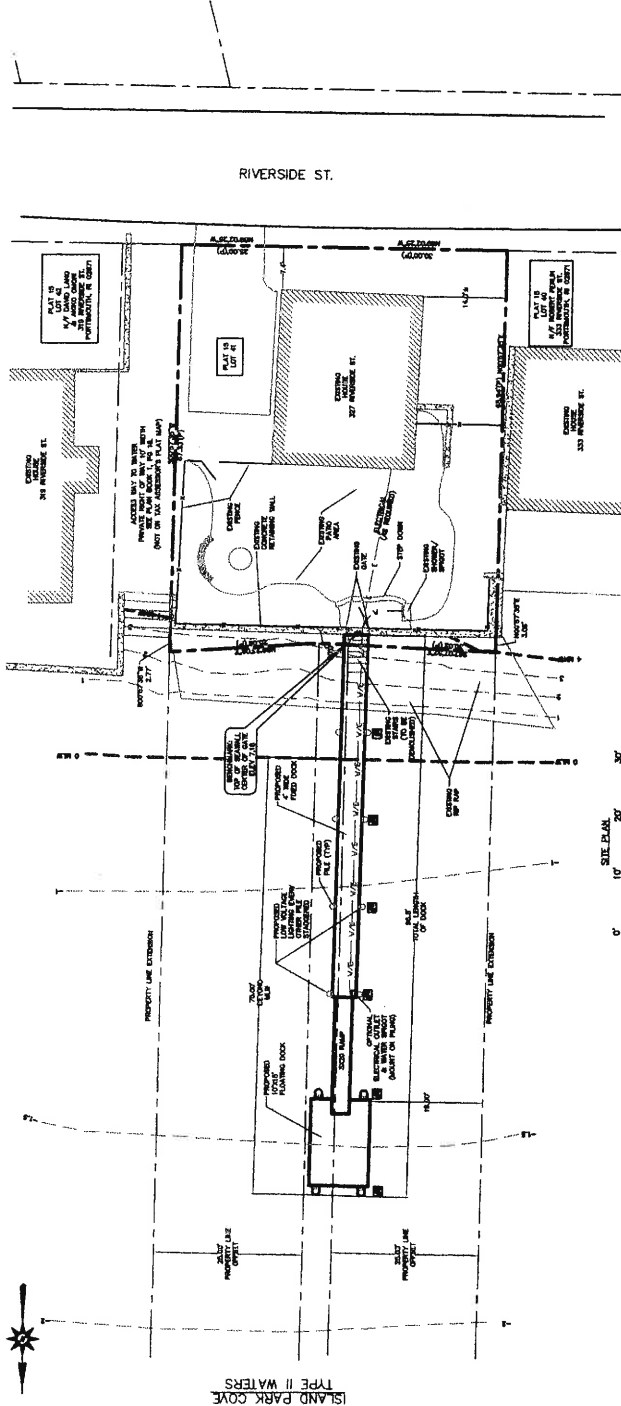
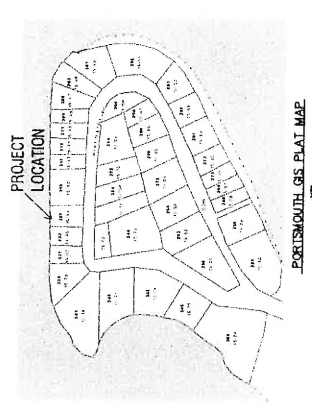
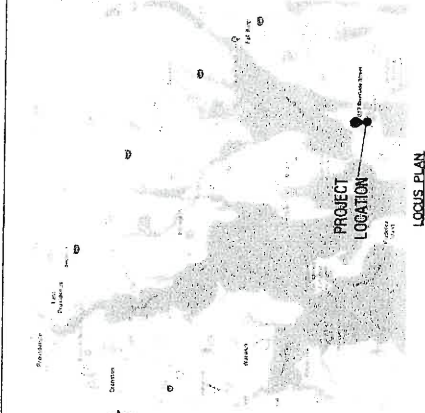

**GENERAL SPECIFICATIONS:**

THE CONTRACTOR SHALL CONTACT THE DESIGN ENGINEER TO REVIEW THE PROJECT. THE INSTALLATION SHALL BE FIELD SUPERVISED BY THE DESIGN ENGINEER. THE CONTRACTOR SHALL BE RESPONSIBLE FOR OBTAINING ALL NECESSARY PERMITS AND APPROVALS FROM THE LOCAL AUTHORITIES. THE CONTRACTOR SHALL BE RESPONSIBLE FOR OBTAINING ALL NECESSARY PERMITS AND APPROVALS FROM THE LOCAL AUTHORITIES. THE CONTRACTOR SHALL BE RESPONSIBLE FOR OBTAINING ALL NECESSARY PERMITS AND APPROVALS FROM THE LOCAL AUTHORITIES.

**DOCK STRUCTURE:**

ALL DOCK STRUCTURE SHALL BE 12' WIDE BY 12' DEEP. THE DOCK SHALL BE CONSTRUCTED OF 4" X 6" LUMBER. THE DOCK SHALL BE ANCHORED TO THE BOTTOM OF THE WATER. THE DOCK SHALL BE CONSTRUCTED OF 4" X 6" LUMBER. THE DOCK SHALL BE ANCHORED TO THE BOTTOM OF THE WATER. THE DOCK SHALL BE CONSTRUCTED OF 4" X 6" LUMBER. THE DOCK SHALL BE ANCHORED TO THE BOTTOM OF THE WATER.

**DOCK FLOORING:**

THE DOCK FLOORING SHALL BE 1/2" ALUMINUM PLATE. THE FLOORING SHALL BE ANCHORED TO THE DOCK STRUCTURE. THE FLOORING SHALL BE ANCHORED TO THE DOCK STRUCTURE. THE FLOORING SHALL BE ANCHORED TO THE DOCK STRUCTURE. THE FLOORING SHALL BE ANCHORED TO THE DOCK STRUCTURE.

**DOCK DOOR:**

THE DOCK DOOR SHALL BE 12' WIDE BY 12' HIGH. THE DOOR SHALL BE CONSTRUCTED OF 4" X 6" LUMBER. THE DOOR SHALL BE ANCHORED TO THE DOCK STRUCTURE. THE DOOR SHALL BE ANCHORED TO THE DOCK STRUCTURE. THE DOOR SHALL BE ANCHORED TO THE DOCK STRUCTURE. THE DOOR SHALL BE ANCHORED TO THE DOCK STRUCTURE.

**DOCK LIGHTING:**

THE DOCK SHALL BE EQUIPPED WITH 12VDC LED LIGHTING. THE LIGHTING SHALL BE ANCHORED TO THE DOCK STRUCTURE. THE LIGHTING SHALL BE ANCHORED TO THE DOCK STRUCTURE. THE LIGHTING SHALL BE ANCHORED TO THE DOCK STRUCTURE. THE LIGHTING SHALL BE ANCHORED TO THE DOCK STRUCTURE.

**DOCK UTILITY:**

THE DOCK SHALL BE EQUIPPED WITH 12VDC UTILITY. THE UTILITY SHALL BE ANCHORED TO THE DOCK STRUCTURE. THE UTILITY SHALL BE ANCHORED TO THE DOCK STRUCTURE. THE UTILITY SHALL BE ANCHORED TO THE DOCK STRUCTURE. THE UTILITY SHALL BE ANCHORED TO THE DOCK STRUCTURE.

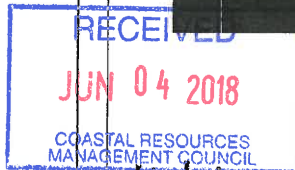



OWNER: JOAN TOKARZ  
SITE ADDRESS: 327 RIVERSIDE ST.  
PORTSMOUTH, RI 02809

DOCK PROFILE & DETAILS

PLAT 16, LOT 41

RHODE ISLAND

SEI

SITE ENGINEERING INC.

CITY - COASTAL - FRENCHVILLE

DATE: 5/18/18

DR: VS  
CHK: RB  
DATE: 5/18/18

Table with 4 columns: REVISIONS, DATE, BY, CHECKED BY. Includes revision notes for layout and detail changes.

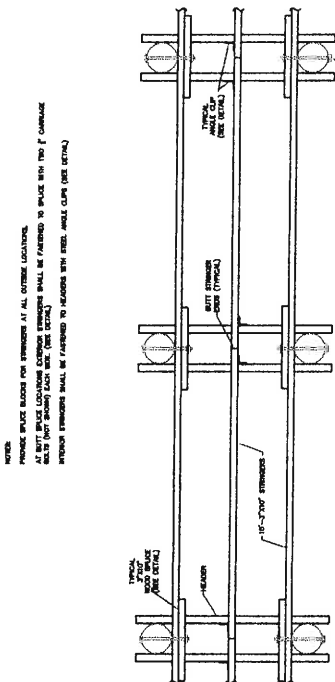
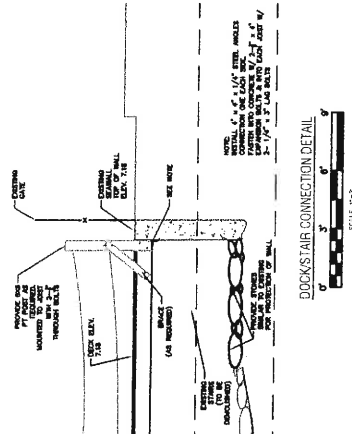
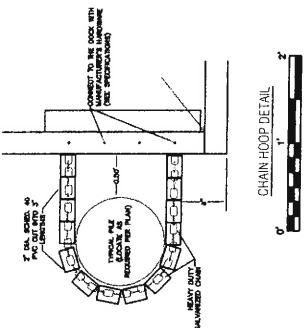
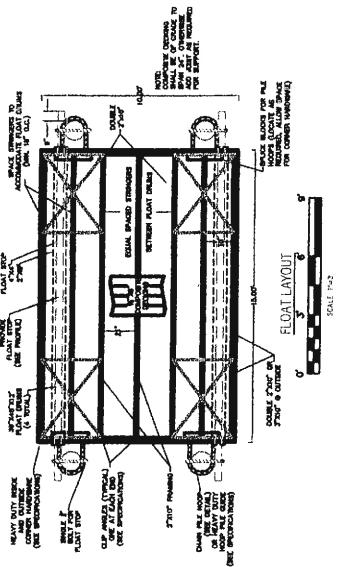

TYPICAL STRINGER LAYOUT

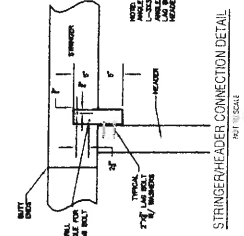

STRINGER/HEADER CONNECTION DETAIL

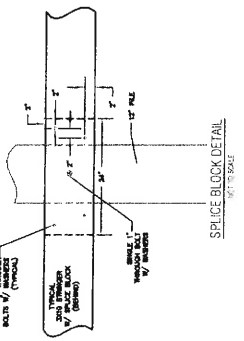

SPLICE BLOCK DETAIL

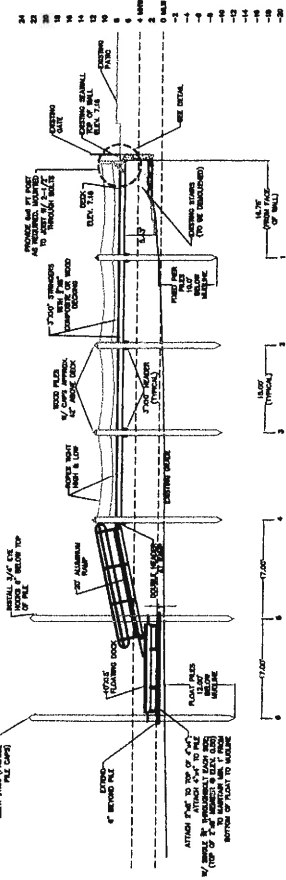

DOCK PROFILE

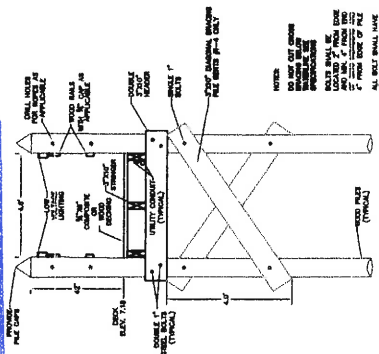

TYPICAL CROSS SECTION

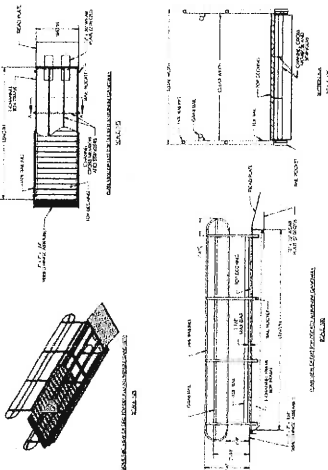

PROPOSED ALUMINUM RAMP

RECEIVED  
JUN 04 2018  
COASTAL RESOURCES  
MANAGEMENT COUNCIL

RECEIVED  
 JUN 04 2018  
 COASTAL RESOURCES  
 MANAGEMENT COUNCIL

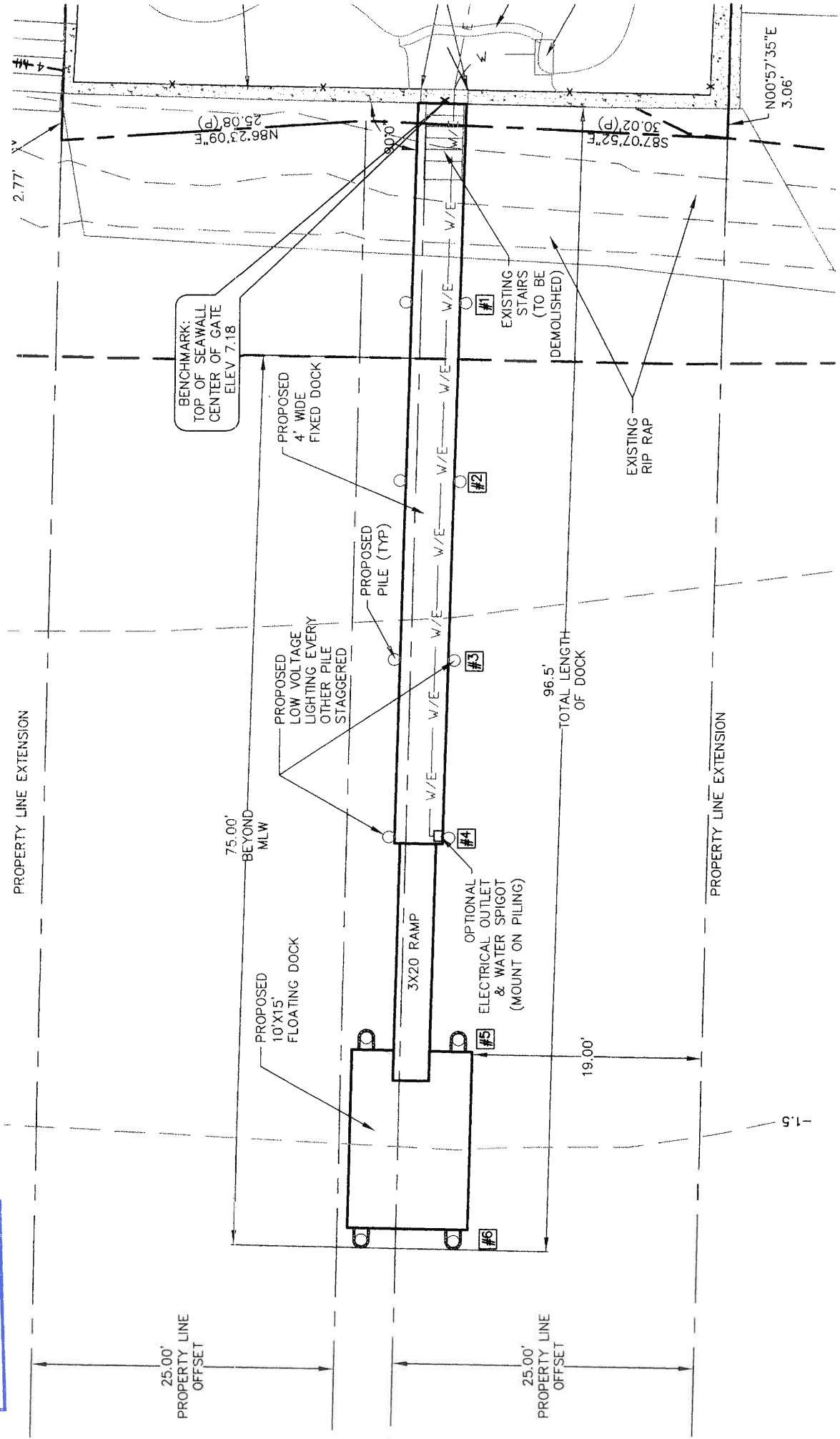

RECEIVED  
 JUN 04 2018  
 COASTAL RESOURCES  
 MANAGEMENT COUNCIL

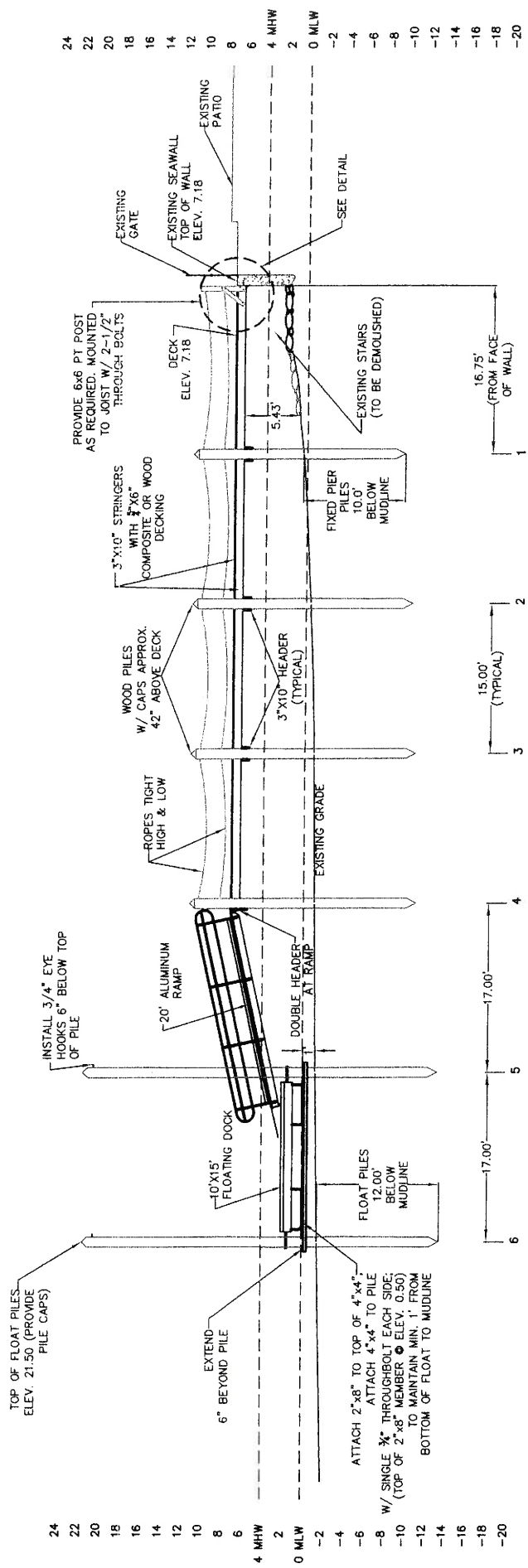

NOTE:  
 FLOOD ZONE IS VE (EL 17) MSL.  
 HEIGHT OF FLOAT PILES =  $17 + 2 \times (\text{MLW TO MSL}) + 1.5 \times (\text{FREEBOARD}) + 1 = 21.50$

NOTE:  
 ALL FIXED PIER PILES SHALL BE  
 DRIVEN 10' BELOW MUDLINE.  
 ALL FLOAT PILES SHALL BE DRIVEN  
 12' BELOW MUDLINE.

DOCK PROFILE



SCALE: 1"=10'