



State of Rhode Island and Providence Plantations  
**Coastal Resources Management Council**  
 Oliver H. Stedman Government Center  
 4808 Tower Hill Road, Suite 3  
 Wakefield, RI 02879-1900

(401) 783-3370  
 Fax (401) 783-2069

**PUBLIC NOTICE**

File Number: 2018-10-099 Date: January 2, 2019

This office has under consideration the application of:

Jamie & Maryanne Aluzzo  
 45 2<sup>nd</sup> Street  
 Westerly, RI 02891

for a State of Rhode Island Assent to construct and maintain:

a residential boating facility consisting of a ramp to a fixed, pier to a ramp to a 10' x 15' float extending 62' beyond mean low water (MLW).

Project Location:	1 Rabbit Run
City/Town:	Westerly
Plat/Lot:	165 / 268
Waterway:	Winnapaug Pond

Plans of the proposed work may be seen at the CRMC office in Wakefield.

In accordance with the Administrative Procedures Act (Chapter 42-35 of the Rhode Island General Laws) you may request a hearing on this matter.

You are advised that if you have good reason to enter protests against the proposed work it is your privilege to do so. It is expected that objectors will review the application and plans thoroughly, visit site of proposed work if necessary, to familiarize themselves with the conditions and cite what law or laws, if any, would in their opinion be violated by the work proposed.

If you desire to protest, you must attend the scheduled hearing and give sworn testimony. A notice of the time and place of such hearing will be furnished you as soon as possible after receipt of your request for hearing. If you desire to request a hearing, to receive consideration, it should be in writing (**with your correct mailing address, e-mail address and valid contact number**) and be received at this office on or before February 2, 2019.

/lat

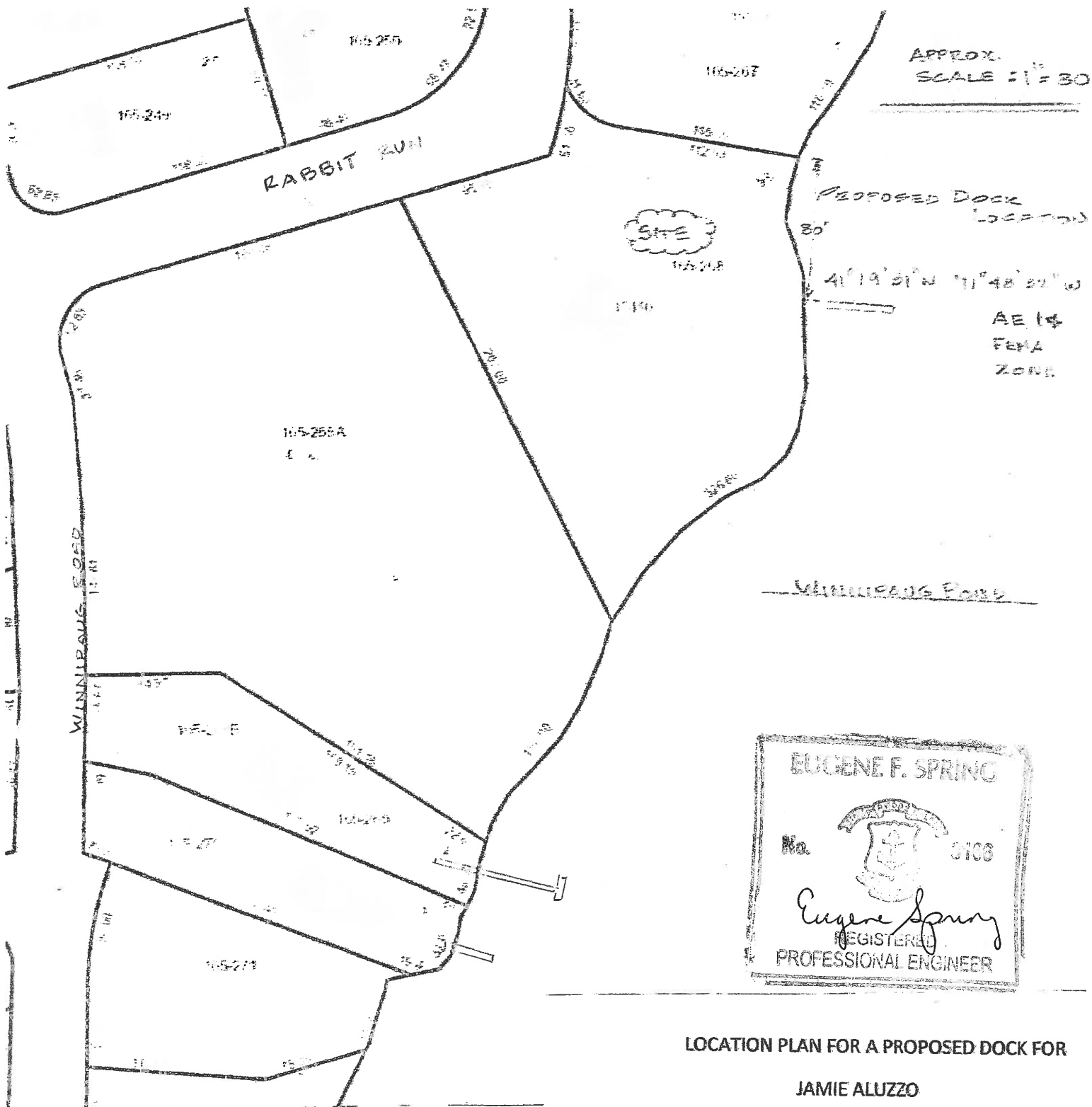

APPROX.  
SCALE = 1" = 30'

PROPOSED DOCK  
LOCATION

41°19'51"N 71°48'22"W

AE 14  
FEMA  
ZONE

WINNIPAUG POND

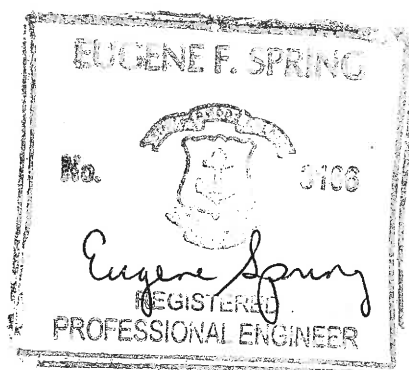

**LOCATION PLAN FOR A PROPOSED DOCK FOR**

**JAMIE ALUZZO**

**1 RABBIT RUN, WESTERLY, R.I.**

**NOVEMEBR, 2018**

ELEVATION DATA FOR WINNIPAUG POND  
(AS CORRECTED FOR SEA LEVEL RISE FROM  
2007 AND CONVERTED TO NAVD 1988 AND  
ADJUSTED FOR A MEAN LOW WATER OF 0.0)

MEAN HIGH WATER: 1.69  
MEAN SEA LEVEL: .845  
MEAN LOW WATER 0.0

Prepared by; Eugene Spring, PE

142 Hampton Way

Wakefield, R.I. 02879

401-284-1323

Cell; 401-226-3246

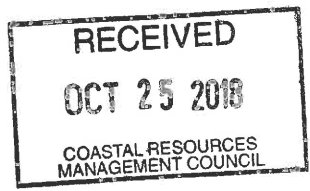

+ 3.9

+ 3.4

+ 6.1

+ 9.0

+ 4.4

3  
MLW

+ 2.9

P.C

# WINNAPAUG

APPROXIMATE  
SAV STUDY  
AREA #1

+ 2.7

3' x 12' ALUMINUM MONORAIL BRIDGE

15' FLOAT

TERMINAL 12" FLOAT PILES (2)

2' x 8 DOCK  
2' x 8 CROSS BRACES BOLTED TO PILES - (SEE SECTION DETAIL)

1/2" x 2' x 8 BEAMS (SEE DETAIL)

+ 1.50

2  
BRUSH

+ 2.6

2' x 2 MLW FROM 18' MLW

+ 1.30

WF A106

EDGE OF WE1

+ 0.3

2' x 2 MSL

RAMP 8

WF A107

+ 3.00

2  
MLW

+ 1.50

ALL ELEVATIONS ARE MSL 1988  
ALL ELEVATIONS OF 0.0 MLW ARE

## NAILING SCHEDULE

QUANTITY	TYPE	NAIL SIZE	ITEM
3 PER JOIST	FACE	S.S. SCREW	2x8 DOCK FLANKING
1 EA. SIDE	TOE NAIL	30D - 4GA.	DOCK JOIST TO GIRDER
3 EA. SIDE	FACE NAIL	30D - 4GA.	SOLID BLOCKING
4 EA. OVERLAP	FACE NAIL	30D - 4GA.	DOCK JOIST OVERLAP

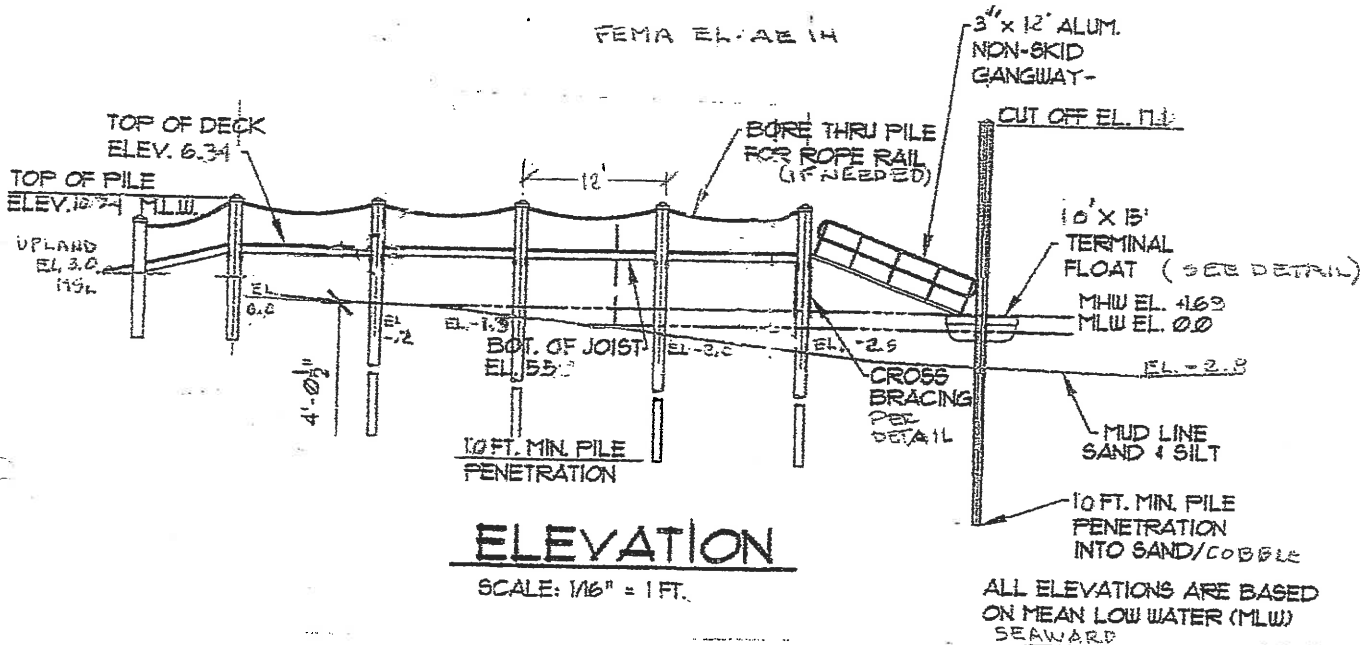

NOTE: Refer to the Revised Submerged Aquatic Vegetation Evaluation of findings by Ecotones, Inc. dated Sept. 3, 2018 for additional data.

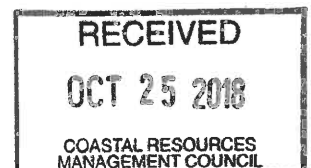
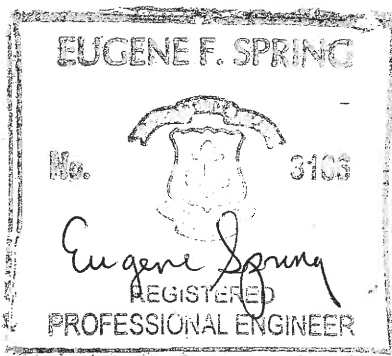

Fixed pier & float elevation plan  
For Jamie Aluzzo  
1 Rabbit Run, Westerly  
Sheet 1 of 2