



State of Rhode Island and Providence Plantations
Coastal Resources Management Council
 Oliver H. Stedman Government Center
 4808 Tower Hill Road, Suite 3
 Wakefield, RI 02879-1900

(401) 783-3370
 Fax (401) 783-2069

PUBLIC NOTICE
 (*Corrected 11-20-2018)

File Number: 2018-10-118 Date: 11/19/2018

This office has under consideration the application of:

Department of Environmental Management
235 Promenade Street
Providence, RI 02908

for a State of Rhode Island Assent to construct and maintain:

the installation of a concrete abutment with a premanufactured floating dock system and timber piles along the northern edge of an existing boat launch reconstruction project. The existing boat launch reconstruction project has had a Maintenance Certification Application submitted and accepted by the Coastal Resources Management Council (M2018-08-094).

Project Location:	West Beach Road
City/Town:	*Charlestown
Plat/Lot:	1 / 83
Waterway:	Quonochontaug Pond and Breachway

Plans of the proposed work may be seen at the CRMC office in Wakefield.

In accordance with the Administrative Procedures Act (Chapter 42-35 of the Rhode Island General Laws) you may request a hearing on this matter.

You are advised that if you have good reason to enter protests against the proposed work it is your privilege to do so. It is expected that objectors will review the application and plans thoroughly, visit site of proposed work if necessary, to familiarize themselves with the conditions and cite what law or laws, if any, would in their opinion be violated by the work proposed.

If you desire to protest, you must attend the scheduled hearing and give sworn testimony. A notice of the time and place of such hearing will be furnished you as soon as possible after receipt of your request for hearing. If you desire to request a hearing, to receive consideration, it should be in writing (**with your correct mailing address, e-mail address and valid contact number**) and be received at this office on or before 12/19/2018.

/lat

PROJ. No.: 20141224.C10
DATE: OCTOBER 2018

CS-101

THE NATURE CONSERVENCY - RHODE ISLAND

EXISTING CONDITIONS PLAN

QUONOCHTAUG BOAT LAUNCH REPLACEMENT

RHODE ISLAND

CHARLESTOWN

FUSS & O'NEILL

317 IRON HORSE WAY, SUITE 204
PROVIDENCE, RI 02908
401.861.3070
www.fandoc.com



SCALE:	HORIZ.: 1" = 50'
	VERT.: 1" = 5'
DATUM:	HORIZ.: NAD83
	VERT.: NAVD88
0 25 50 GRAPHIC SCALE	

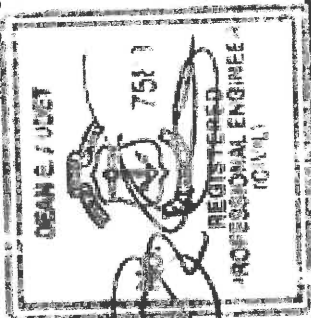

WORK PERMITTED
UNDER MAINTENANCE
CERTIFICATION
M2018-08-094

PROPOSED CRMC
DREDGE LIMITS

QUONOCHTAUG
BREACHWAY
ONE 1/2" x 3" BRASS

APPROXIMATE MEAN
LOW WATER ELEVATION
-1.39' (EL. -0.85')

APPROXIMATE MEAN
HIGH WATER ELEVATION
(EL. 0.90')

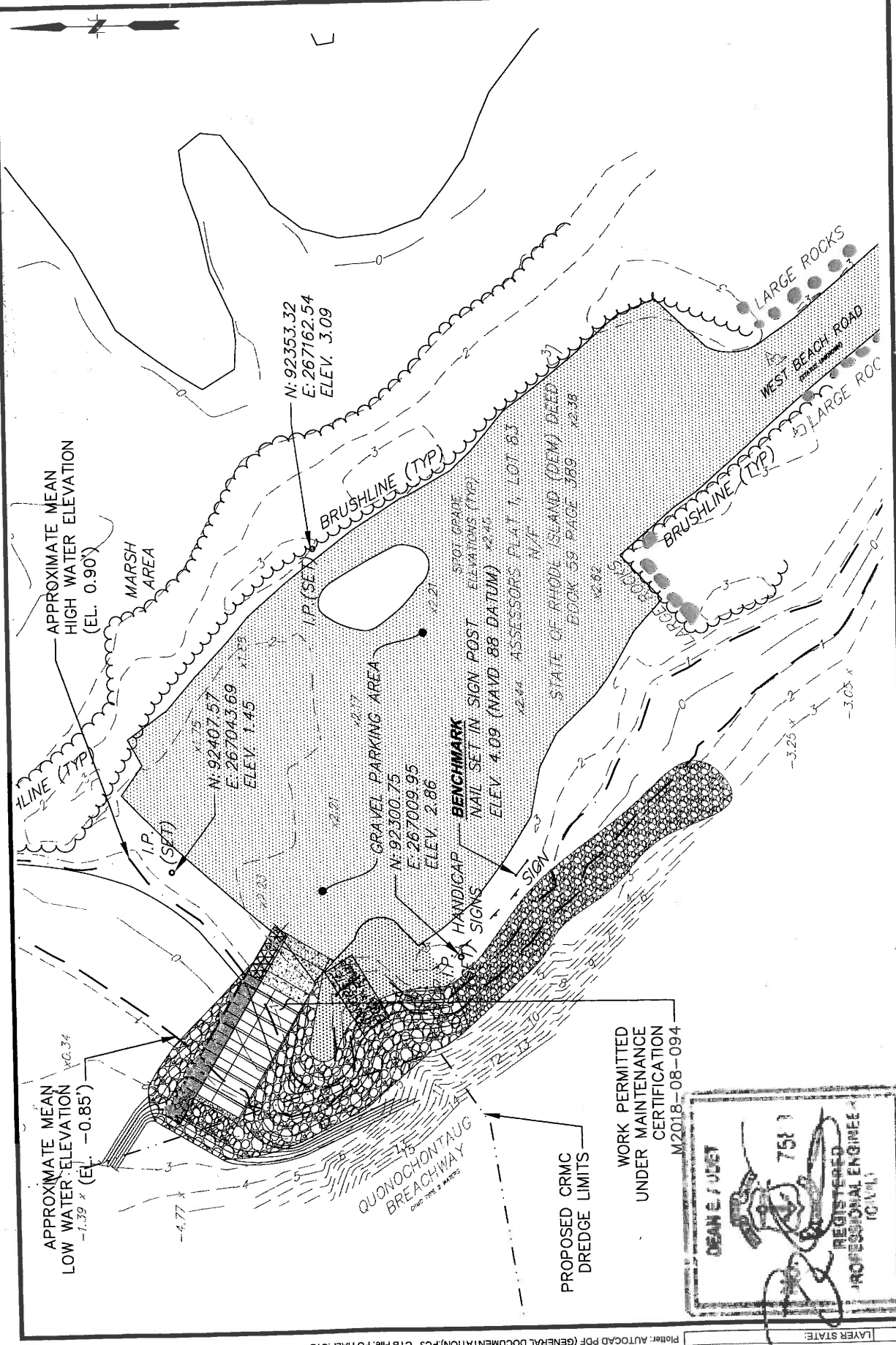

NOTES

1. BASE PLAN: EXISTING FEATURES AND TOPOGRAPHICAL INFORMATION REFLECTED WITHIN ARE BASED UPON A CLASS III SURVEY PERFORMED BY NATIONAL LAND SURVEYORS - DEVELOPERS, INC. (NLS) OF WOONSOCKET, RHODE ISLAND IN OCTOBER 2017 AND JANUARY 2018. BENCHMARK GRADE STAKE MEASURING POINTS AND EXISTING MONITORING LOCATIONS WERE MEASURED AND INSTALLED BY NLS IN 2017.
2. HORIZONTAL COORDINATES ARE BASED ON NAD 1983, RHODE ISLAND STATE PLANE, US FOOT.
3. VERTICAL COORDINATES ARE BASED ON NAVD88.
4. CRMC WATER TYPE DESIGNATION IS TYPE 2.
5. THE CONTRACTOR SHALL NOTIFY DIG SAFE 1-888-DIG-SAFE AT LEAST 48 HOURS PRIOR TO ANY ON-SITE EXCAVATION.
6. THE CONTRACTOR SHALL INSTALL AND MAINTAIN ANY EROSION AND SEDIMENTATION CONTROLS DEPLOYED IN ACCORDANCE WITH THE RHODE ISLAND EROSION AND SEDIMENTATION CONTROL MANUAL AND THE PERMITS ISSUED.
7. CONTRACTOR SHALL BLOCK PUBLIC ACCESS TO THE SITE FOR THE DURATION OF THE WORK AND DEPLOY SIGNS THAT READ "BOAT RAMP CLOSED" AT ALL ENTRANCES.

TIDAL DATA

1. DETAILED TIDE DATA FOR QUONOCHONTAUG POND FROM 2010 TO 2011 OBSERVED AND ADJUSTED BY RECONSTRUCTED TIDE CONSTITUENTS ARE PROVIDED HEREON.

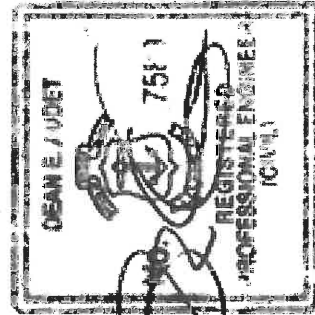

Tidal Datum	Quonochoaug East (Elevation feet NAVD 88)
MHHW	1.07
MHW	0.90
MTL	0.02
MLW	-0.85
MLLW	-0.91

CRMC DESIGN REQUIREMENTS	
CRITERIA	REQUIREMENT
MIN. PILE TIP DIAMETER	10"
MIN. PILE BUTT DIAMETER	12"
RESIDENTIAL MINIMUM PILE EMBEDMENT	10 FEET
MIN FLOAT FREEBOARD	12"
DESIGN WIND LOADS	WIND GUST BASED ON 50 YR RETURN AND NATURAL PERIOD OF 60 SEC.
WAVE CONDITIONS (MIN)	ALL FIXED AND FLOATING STRUCTURE SHALL BE DESIGNED FOR A 3' MIN.
MIN PILE CUT OFF	V ZONE ELEVATION + FLOAT FREEBOARD+ 1'
MIN/MAX FLOAT FREEBOARD	8"/30"
MAXIMUM FETCH FOR RESIDENTIAL DOCKS	4 MILES
MINIMUM STRINGER/JOIST	3" X 10"
MINIMUM THROUGH BOLT HARDWARE DIAMETER - HOT DIPPED GALVANIZED	3/4"
MINIMUM CROSS BRACING	3" X 10"
MINIMUM LAG BOLT DIAMETER	1/2"
MINIMUM WATER DEPTH AT THE TERMINUS OF RECREATIONAL BOATING FACILITIES	18" MLW
FLOAT LOADS	LL: 20 IB/SF CL: 400 IB

DESIGN NOTE:

1. FINAL PIER AND DOCK DESIGN WILL MEET OR EXCEED CRMC DESIGN REQUIREMENTS LISTED ABOVE.

SCALE: HORIZ.: NOT TO SCALE
VERT.:
DATUM:
HORIZ.: NAD83
VERT.: NAVD88

GRAPHIC SCALE

FUSS & O'NEILL
317 IRON HORSE WAY, SUITE 204
PROVIDENCE, RI 02908
401.861.3070
www.fandoc.com

THE NATURE CONSERVENCY - RHODE ISLAND
EXISTING CONDITIONS NOTES RECEIVED
QUONOCHONTAUG BOAT LAUNCH REPLACEMENT 2018
RHODE ISLAND COASTAL RESOURCE MANAGEMENT COUNCIL

PROJ. No.: 20141224.C10
DATE: OCTOBER 2018
CS-102

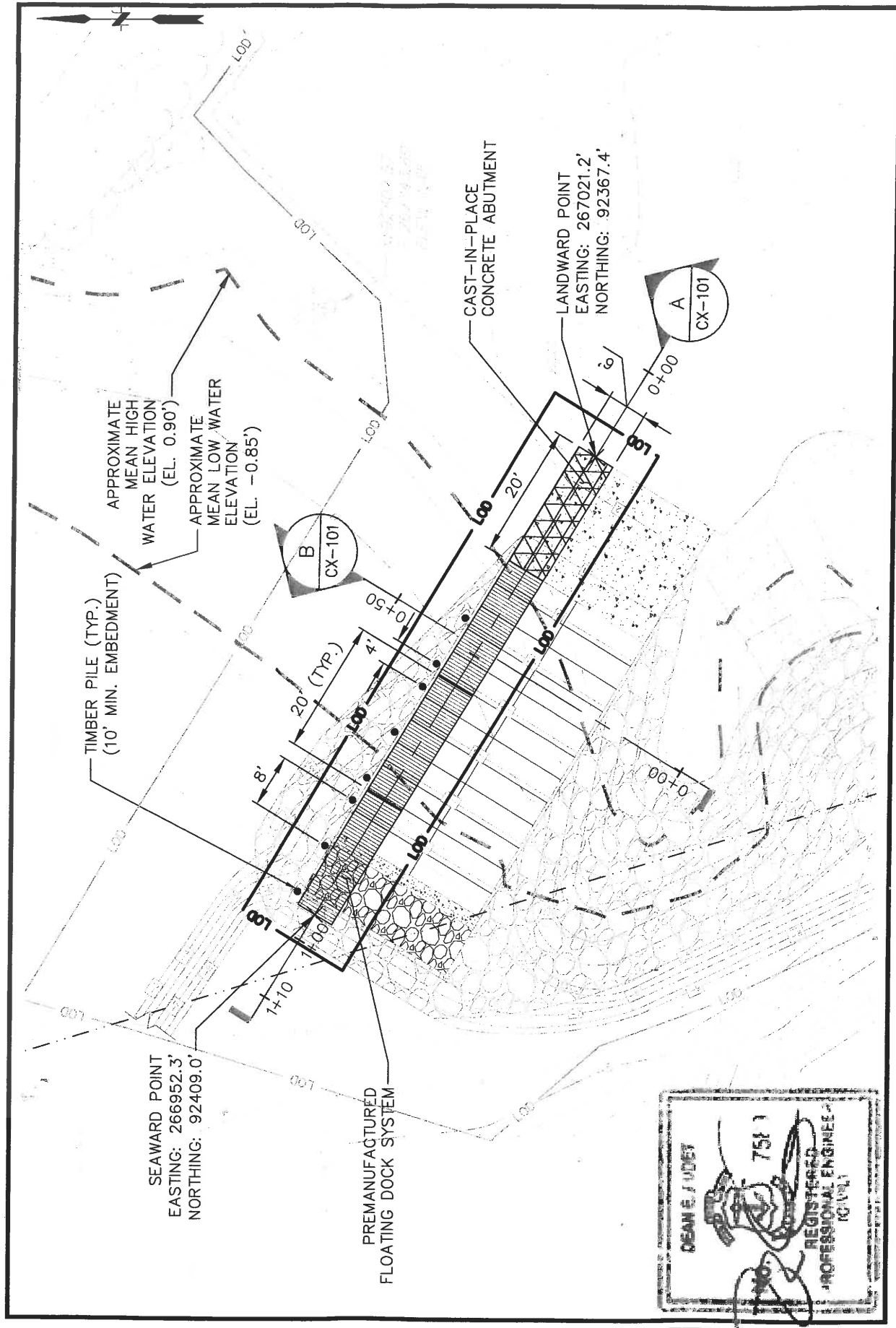

PROJ. No.: 20141224.C10
 DATE: OCTOBER 2018

CS-103

THE NATURE CONSERVENCY - RHODE ISLAND

PROPOSED CONDITIONS PLAN

QUONONCHTAUG BOAT LAUNCH REPLACEMENT

CHARLESTOWN

RHODE ISLAND

FUSS & O'NEILL

317 IRON HORSE WAY, SUITE 204
 PROVIDENCE, RI 02908
 401.861.3070
 www.fussdo.com

SCALE: HORIZ.: 1" = 30'
 VERT.: 1" = 15'

DATUM: HORIZ.: NAD83
 VERT.: NAVD88

GRAPHIC SCALE

0 15 30

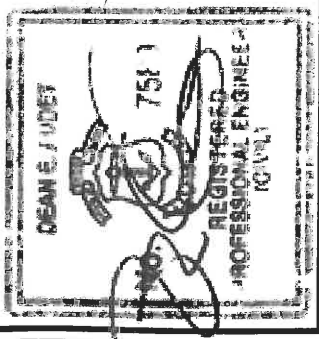

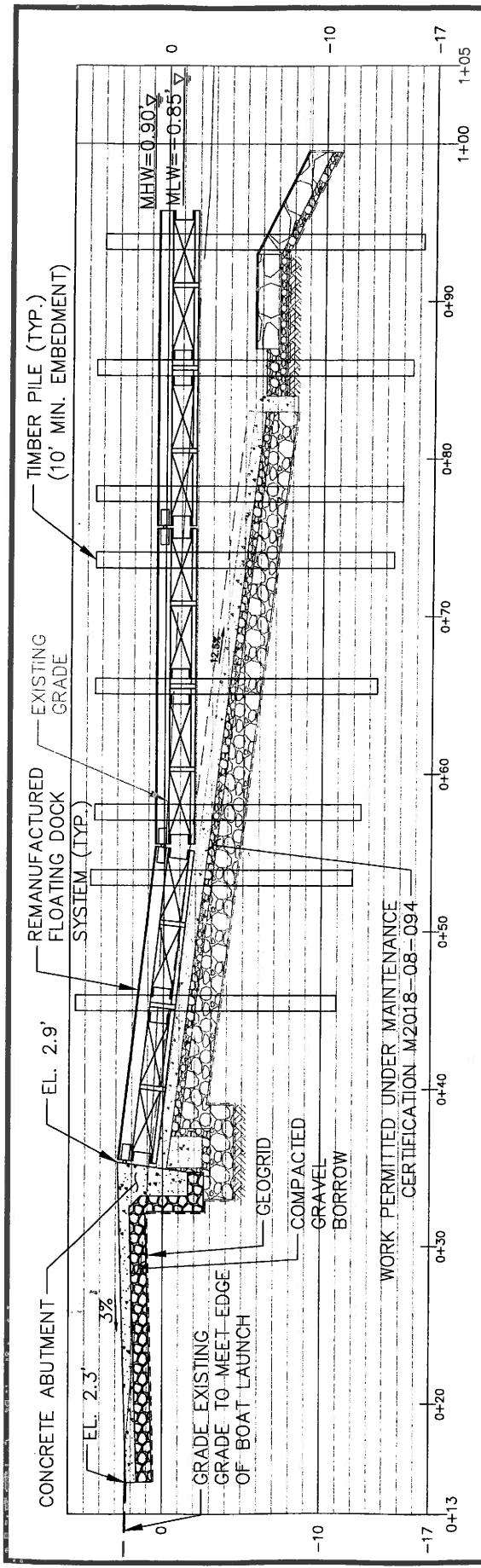

SECTION A
SCALE: 1" = 10'

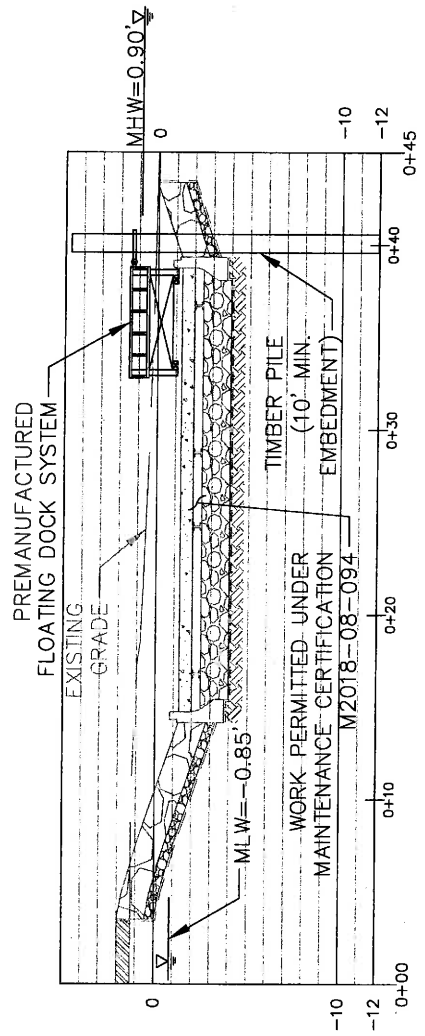

SECTION B
SCALE: 1" = 10'

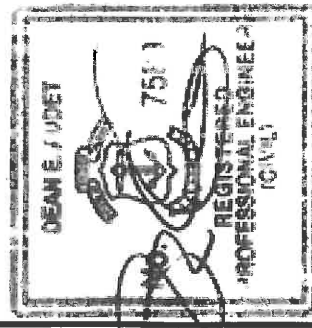

SCALE:	HORIZ.: 1" = 30'
VERT.:	
DATUM:	
HORIZ.: NAD83	
VERT.: NAVD88	
GRAPHIC SCALE	
0	15
30	

FUSS & O'NEILL
 317 IRON HORSE WAY, SUITE 204
 PROVIDENCE, RI 02908
 401.861.3070
 www.fandoo.com

THE NATURE CONSERVENCY - RHODE ISLAND
 BOAT RAMP PROFILE AND SECTION
 QUONONCHONTAUG BOAT LAUNCH REPLACEMENT
 RECEIVED
 OCT 30 2018
 COASTAL RESOURCE ISLAND
 MANAGEMENT COUNCIL

PROJ. NO.: 20141224.C10
 DATE: OCTOBER 2018
 CX-101

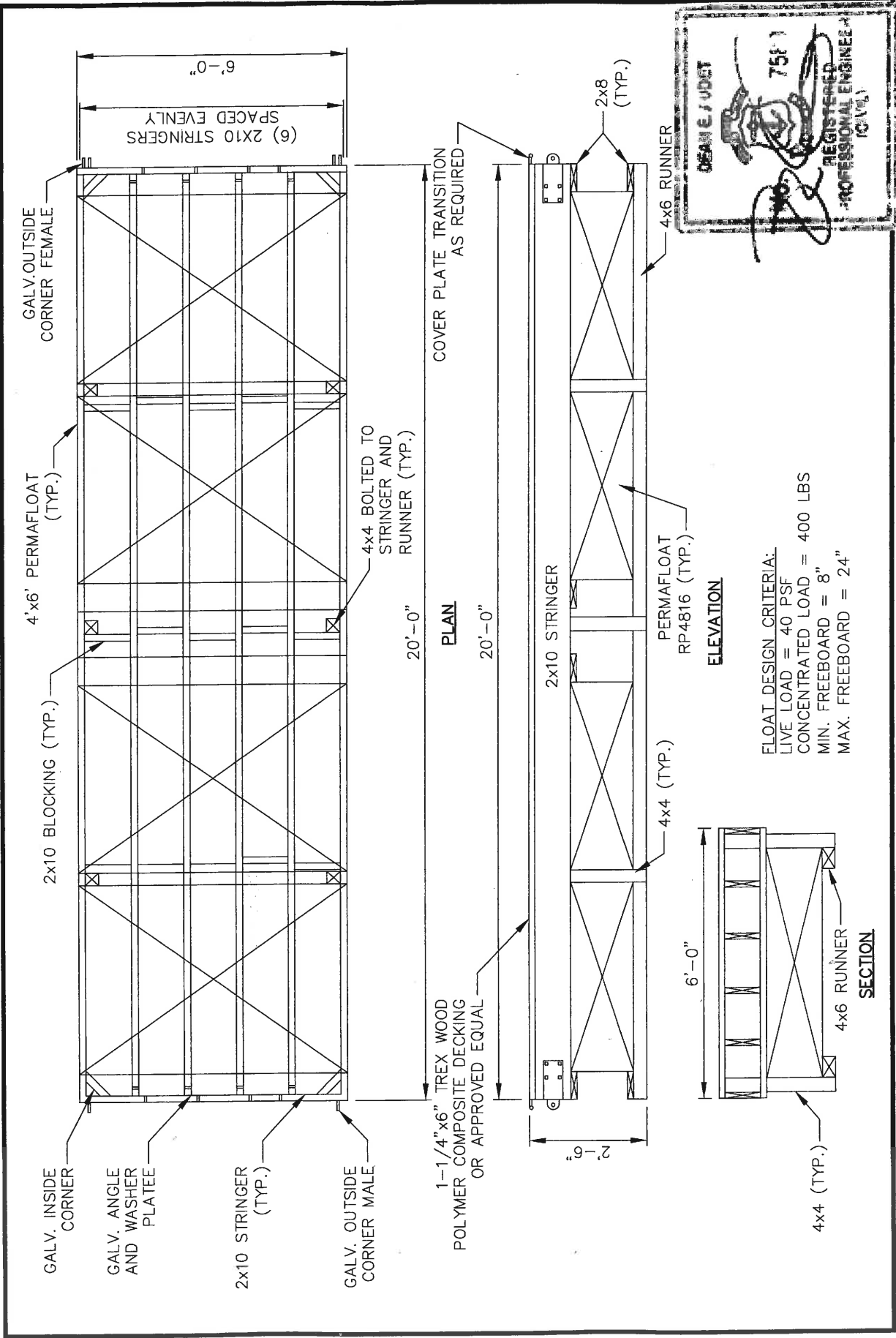

PLAN
 20'-0"
 20'-0"
ELEVATION
 6'-0"
SECTION

COVER PLATE TRANSITION AS REQUIRED

1-1/4" x 6" TREX WOOD POLYMER COMPOSITE DECKING OR APPROVED EQUAL

2x10 STRINGER

4x6 RUNNER

4x4 (TYP.)

PERMAFLOAT RP4816 (TYP.)

2x8 (TYP.)

4'x6' PERMAFLOAT (TYP.)

2x10 BLOCKING (TYP.)

(6) 2X10 STRINGERS SPACED EVENLY

6'-0"

GALV. INSIDE CORNER

GALV. ANGLE AND WASHER AND PLATE

2x10 STRINGER (TYP.)

GALV. OUTSIDE CORNER MALE

1-1/4" x 6" TREX WOOD POLYMER COMPOSITE DECKING OR APPROVED EQUAL

20'-0"

2'-0"

COVER PLATE TRANSITION AS REQUIRED

2x10 STRINGER

4x6 RUNNER

4x4 (TYP.)

PERMAFLOAT RP4816 (TYP.)

2x8 (TYP.)

4'x6' PERMAFLOAT (TYP.)

2x10 BLOCKING (TYP.)

(6) 2X10 STRINGERS SPACED EVENLY

6'-0"

GALV. INSIDE CORNER

GALV. ANGLE AND WASHER AND PLATE

2x10 STRINGER (TYP.)

GALV. OUTSIDE CORNER MALE



SCALE:	HORIZ.: NOT TO SCALE
	VERT.:
DATUM:	
	HORIZ.: NAD83
	VERT.: NAVD88

FUSS & O'NEILL
 317 IRON HORSE WAY, SUITE 304
 PROVIDENCE, RI 02908
 401.861.3070

THE NATURE CONSERVENCY - RHODE ISLAND
 TIMBER DOCK SECTION DETAIL
 QUONOCONTAUG BOAT LAUNCH REPLACEMENT

PROJ. No.: 20141224.C10
 DATE: OCTOBER 2018
 CD-501