



State of Rhode Island and Providence Plantations
Coastal Resources Management Council
Oliver H. Stedman Government Center
4808 Tower Hill Road, Suite 3
Wakefield, RI 02879-1900

(401) 783-3370
Fax (401) 783-2069

PUBLIC NOTICE

File Number: 2018-11-092

Date: January 2, 2019

This office has under consideration the application of:

Paul & Tara Santa Barbara
489 West Street
Guilford, CT 06437

for a State of Rhode Island Assent to construct and maintain: A residential boating facility consisting of a 4' x 67' fixed timber pier, 3' x 20' access ramp and 8' x 18' (144sf) terminal float. The facility is to extend ~37' seaward of the cited MLW mark and requires a ~19' property line setback variance to RICRMP Section 1.3.1(D).

Project Location:	10 Sea Crest Drive
City/Town:	Narragansett
Plat/Lot:	R-2 / 229,230,231
Waterway:	Pt Judith Pond

Plans of the proposed work may be seen at the CRMC office in Wakefield.

In accordance with the Administrative Procedures Act (Chapter 42-35 of the Rhode Island General Laws) you may request a hearing on this matter.

You are advised that if you have good reason to enter protests against the proposed work it is your privilege to do so. It is expected that objectors will review the application and plans thoroughly, visit site of proposed work if necessary, to familiarize themselves with the conditions and cite what law or laws, if any, would in their opinion be violated by the work proposed.

If you desire to protest, you must attend the scheduled hearing and give sworn testimony. A notice of the time and place of such hearing will be furnished you as soon as possible after receipt of your request for hearing. If you desire to request a hearing, to receive consideration, it should be in writing (**with your correct mailing address, e-mail address and valid contact number**) and be received at this office on or before February 2, 2019.

/lat

RECEIVED
 NOV 29 2018
 COASTAL RESOURCES
 MANAGEMENT COUNCIL

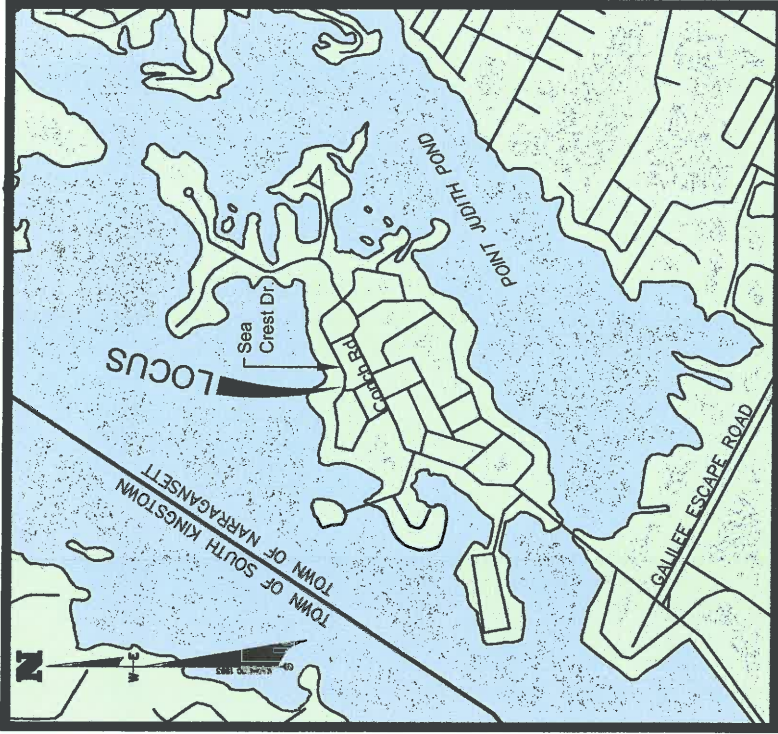

LOCATION PLAN
SCALE: 1" = 2000'

DRAWING TITLED:
**PROPOSED RESIDENTIAL BOATING
 FACILITY**
 LOCATED ON:
LOTS: 229, 230 & 231 OF ASSESSOR'S MAP: R-2
 OWNED BY:
PAUL & TARA SANTA BARBARA
 ADDRESS:
10 SEA CREST DRIVE, NARRAGANSETT, RI

DATE: OCTOBER 26, 2018

**FRISELLA-BALCH
 & ASSOCIATES**

LAND SURVEYING
 33 NORTH ROAD, SUITE C-201
 PEACE DALE, RI
 PHONE (401) 783-5949
 FAX (401) 783-5997
 www.friseλλα.com

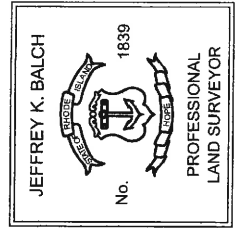

CJ DOYLE, P.E.
 CIVIL ENGINEERING

MAILING ADDRESS
 P.O. BOX 1161, HOPE VALLEY, RI
 OFFICE LOCATION
 1122 MAIN STREET
 WYOMING, RI
 PHONE (401) 491-9530
 cjengine@cox.net

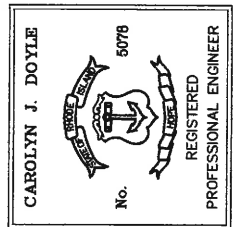



RECEIVED
NOV 29 2018
 COASTAL RESOURCES
 MANAGEMENT COUNCIL

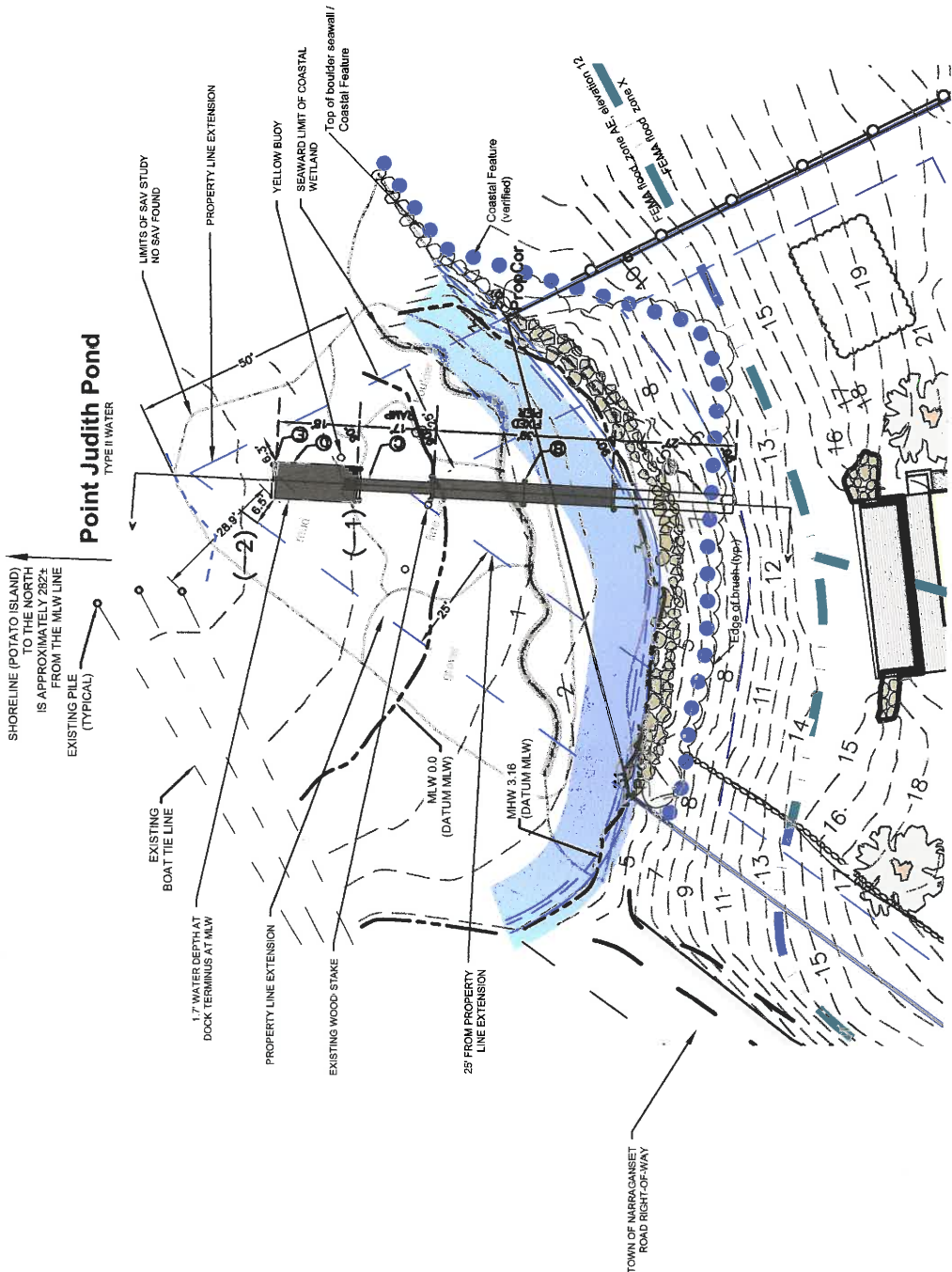

CJ DOYLE, P.E.
 CIVIL ENGINEERING

MAILING ADDRESS
 P.O. BOX 1161, HOPE VALLEY, RI
 OFFICE LOCATION
 1122 MAIN STREET
 WYOMING, RI
 PHONE (401) 491-9630
 cjengine@cox.net

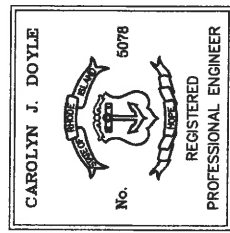

FRISELLA-BALCH & ASSOCIATES
 LAND SURVEYING

33 NORTH ROAD, SUITE C-201
 PEACE DALE, RI
 PHONE (401) 783-5949
 FAX (401) 783-5997
 www.friseλλα.com

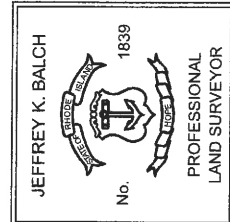

DRAWING TITLED:
PROPOSED RESIDENTIAL BOATING FACILITY

LOCATED ON:
LOTS: 229, 230 & 231 OF ASSESSOR'S MAP: R-2
 OWNED BY:

PAUL & TARA SANTA BARBARA
 ADDRESS:
10 SEA CREST DRIVE, NARRAGANSETT, RI
 DATE: **OCTOBER 26, 2018**
 SCALE: **1" = 40'**

PROPOSED DOCK COMPONENTS:

- **A** PROPOSED 4' WIDE x 39' LONG FIXED-PIER SECTION. SEE SEPARATE DETAILS.
- **B** PROPOSED 12" DIA. TIMBER PILE (MINIMUM).
- **C** PROPOSED 30" WIDE X 20' LONG PREFABRICATED RAMP. SEE SEPARATE DETAILS.
- **D** PROPOSED 8' X 18' FLOAT. CHOCK 18" ABOVE BOTTOM. SEE SEPARATE DETAILS.
- **E** PROPOSED TIE OFF PILES, 12" DIA. TIMBER PILE (MINIMUM), SET 19' ON CENTER.

RECEIVED
 NOV 29 2018
 COASTAL RESOURCES
 MANAGEMENT COUNCIL

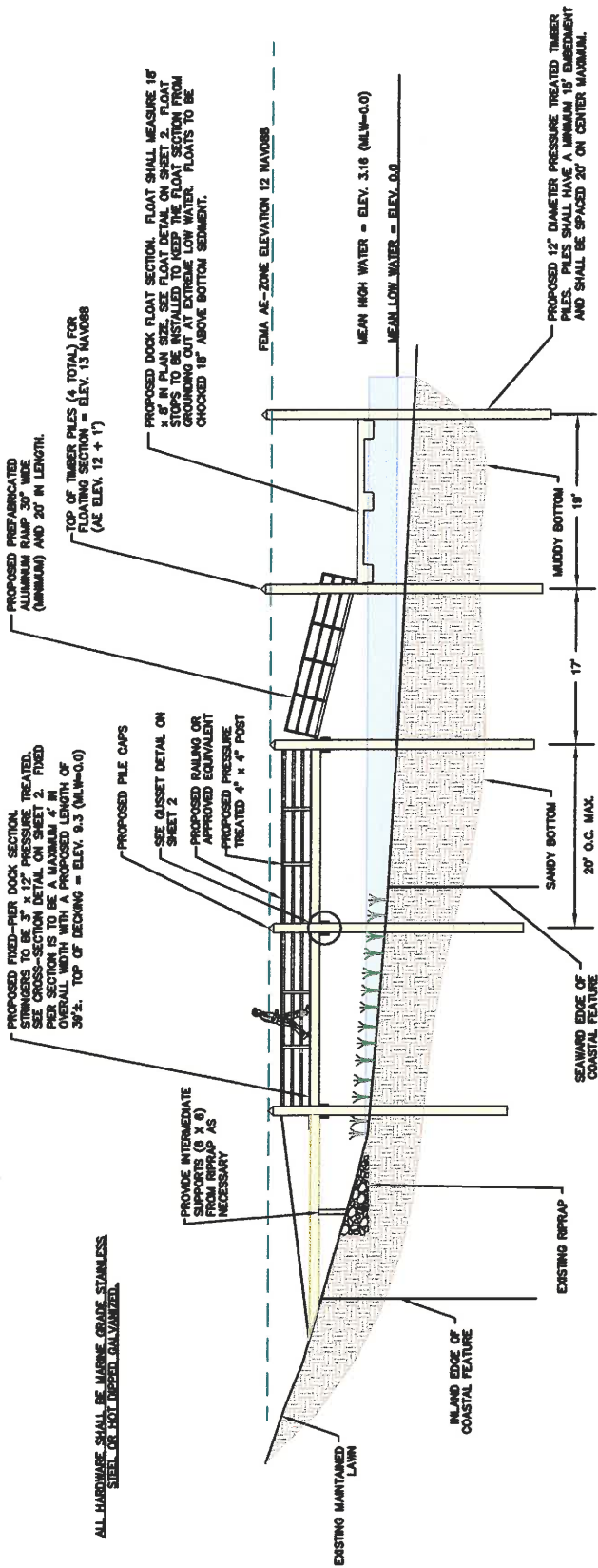

CJ DOYLE, P.E.
 CIVIL ENGINEERING

MAILING ADDRESS
 P.O. BOX 1161, HOPE VALLEY, RI
 OFFICE LOCATION
 1122 MAIN STREET
 WYOMING, RI
 PHONE (401) 491-9630
 cjenigne@cox.net

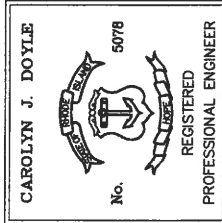

FRISELLA-BALCH & ASSOCIATES
 LAND SURVEYING

33 NORTH ROAD, SUITE C-201
 PEACE DALE, RI
 PHONE (401) 783-5949
 FAX (401) 783-5987
 www.frisella.com

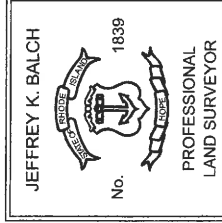

DRAWING TITLED:
PROPOSED RESIDENTIAL BOATING FACILITY

LOCATED ON:
LOTS: 229, 230 & 231 OF ASSESSOR'S MAP: R-2
 OWNED BY:
PAUL & TARA SANTA BARBARA

ADDRESS:
10 SEA CREST DRIVE, NARRAGANSETT, RI
 DATE: **OCTOBER 26, 2018**

SCALE: **1" = 20'**

**WATER DEPTH BELOW
 FLOATING DOCK**

	LANDWARD	SEAWARD
HIGH TIDE	4.0' ± LANDWARD	4.8' ± SEAWARD
LOW TIDE	0.9' ± LANDWARD	1.7' ± SEAWARD