



State of Rhode Island and Providence Plantations
Coastal Resources Management Council
 Oliver H. Stedman Government Center
 4808 Tower Hill Road, Suite 3
 Wakefield, RI 02879-1900

(401) 783-3370
 Fax (401) 783-2069

PUBLIC NOTICE

File Number: 2018-11-095 Date: January 2, 2019

This office has under consideration the application of:

Barbara Shaughnessy Trust
 8 Spruce Street; Apt. 53C
 New York, NY 10038

for a State of Rhode Island Assent to construct and maintain: A residential boating facility consisting of a fixed 4' x 120' timber pier and 4' x 20' fixed "L" terminus, extending ~60' seaward of the cited MLW mark. Due to high fetch conditions, the facility also proposed two (2) boat lifts, with terminal piles extending an additional ~14' seaward of the "L" section. The total facility extends ~73' seaward of the cited MLW mark, requiring a 23' length variance from RICRMP Section 1.3.1(D).

Project Location:	375 Rumstick Road
City/Town:	Barrington
Plat/Lot:	11 / 017
Waterway:	Narragansett Bay

Plans of the proposed work may be seen at the CRMC office in Wakefield.

In accordance with the Administrative Procedures Act (Chapter 42-35 of the Rhode Island General Laws) you may request a hearing on this matter.

You are advised that if you have good reason to enter protests against the proposed work it is your privilege to do so. It is expected that objectors will review the application and plans thoroughly, visit site of proposed work if necessary, to familiarize themselves with the conditions and cite what law or laws, if any, would in their opinion be violated by the work proposed.

If you desire to protest, you must attend the scheduled hearing and give sworn testimony. A notice of the time and place of such hearing will be furnished you as soon as possible after receipt of your request for hearing. If you desire to request a hearing, to receive consideration, it should be in writing (**with your correct mailing address, e-mail address and valid contact number**) and be received at this office on or before February 2, 2019.

/lat

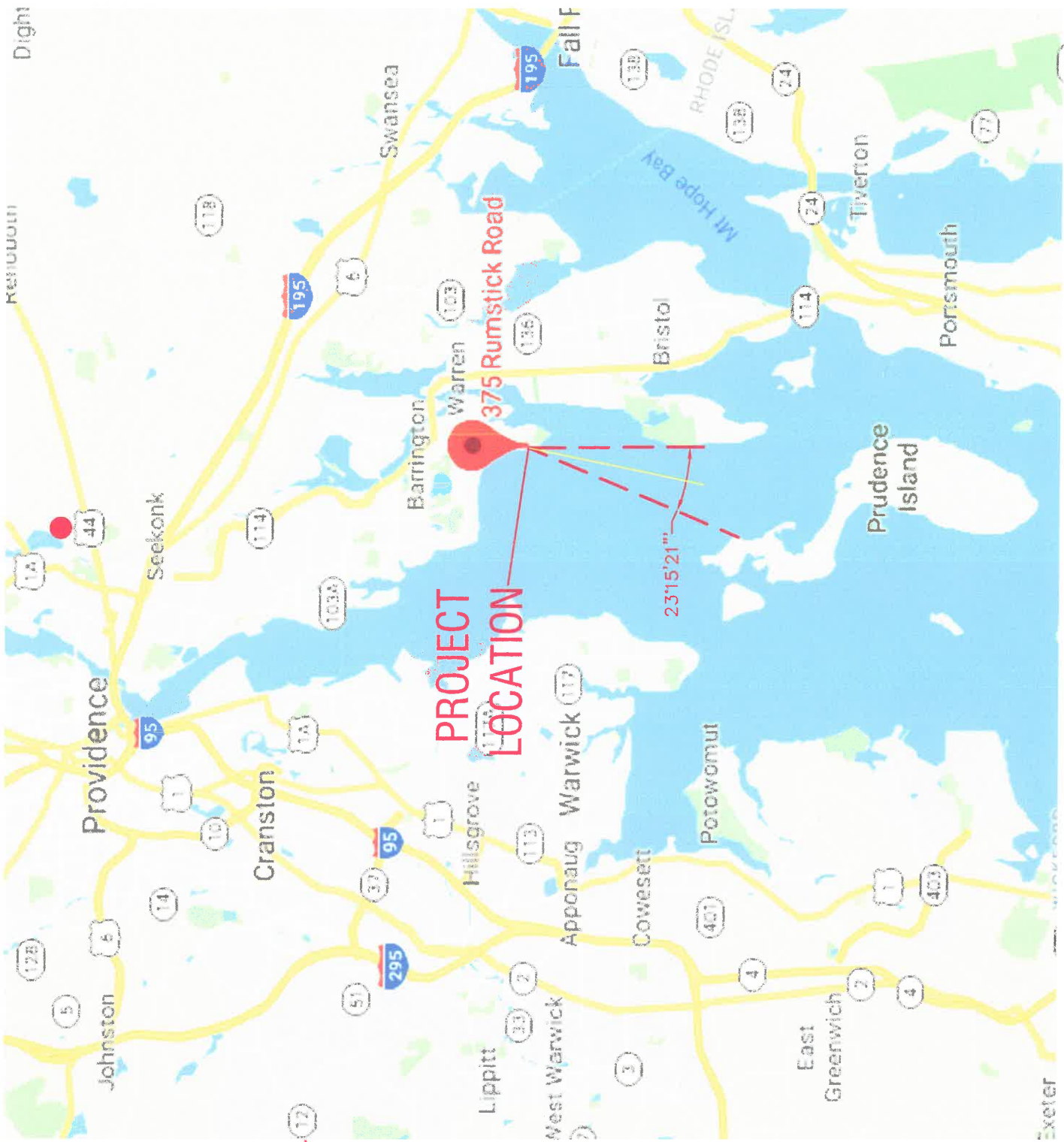

RECEIVED
 NOV 29 2018
 COASTAL RESOURCES
 MANAGEMENT COUNCIL

LOCUS PLAN
 NTS

GENERAL SPECIFICATIONS:

ALL CONSTRUCTION SHALL BE IN ACCORDANCE WITH THE BUILDING CODES AND REGULATIONS OF THE STATE OF RHODE ISLAND. THE CONTRACTOR SHALL BE RESPONSIBLE FOR OBTAINING ALL NECESSARY PERMITS FROM THE APPROPRIATE AGENCIES. THE CONTRACTOR SHALL BE RESPONSIBLE FOR OBTAINING ALL NECESSARY PERMITS FROM THE APPROPRIATE AGENCIES. THE CONTRACTOR SHALL BE RESPONSIBLE FOR OBTAINING ALL NECESSARY PERMITS FROM THE APPROPRIATE AGENCIES.

NOTES:

- 1. SITE IS IN ALONG FETCH AREA. DOCK SPECIFICATIONS AND DETAILS CONTAIN NOTATIONS AND DIMENSIONS UPON COMPLETION OF CONSTRUCTION. VERIFY STRUCTURE.
- 2. ALL DOCK PILING SHALL BE CLASSED "A" 12" DIAMETER SOUTHERN PINE WITH A MINIMUM TOP CIRCUMFERENCE OF 11.5" AT THE TOP AND 10.5" AT THE BOTTOM. ALL PILING SHALL BE SET IN A MINIMUM OF 6" OF CONCRETE. ALL PILING SHALL BE SET IN A MINIMUM OF 6" OF CONCRETE.
- 3. ALL DOCK PILING SHALL BE SET IN A MINIMUM OF 6" OF CONCRETE. ALL PILING SHALL BE SET IN A MINIMUM OF 6" OF CONCRETE.
- 4. ALL DOCK PILING SHALL BE SET IN A MINIMUM OF 6" OF CONCRETE. ALL PILING SHALL BE SET IN A MINIMUM OF 6" OF CONCRETE.
- 5. ALL DOCK PILING SHALL BE SET IN A MINIMUM OF 6" OF CONCRETE. ALL PILING SHALL BE SET IN A MINIMUM OF 6" OF CONCRETE.
- 6. ALL DOCK PILING SHALL BE SET IN A MINIMUM OF 6" OF CONCRETE. ALL PILING SHALL BE SET IN A MINIMUM OF 6" OF CONCRETE.
- 7. ALL DOCK PILING SHALL BE SET IN A MINIMUM OF 6" OF CONCRETE. ALL PILING SHALL BE SET IN A MINIMUM OF 6" OF CONCRETE.
- 8. ALL DOCK PILING SHALL BE SET IN A MINIMUM OF 6" OF CONCRETE. ALL PILING SHALL BE SET IN A MINIMUM OF 6" OF CONCRETE.
- 9. ALL DOCK PILING SHALL BE SET IN A MINIMUM OF 6" OF CONCRETE. ALL PILING SHALL BE SET IN A MINIMUM OF 6" OF CONCRETE.
- 10. ALL DOCK PILING SHALL BE SET IN A MINIMUM OF 6" OF CONCRETE. ALL PILING SHALL BE SET IN A MINIMUM OF 6" OF CONCRETE.

UTILITY SPECIFICATIONS:

ALL UTILITY WORK SHALL BE PERFORMED BY LICENSED CONTRACTORS IN THEIR RESPECTIVE TRADES. ALL WORK SHALL MEET REQUIREMENTS OF THE CURRENT STATE BUILDING CODE. THE CONTRACTOR SHALL BE RESPONSIBLE FOR OBTAINING ALL NECESSARY PERMITS FROM THE APPROPRIATE AGENCIES. THE CONTRACTOR SHALL BE RESPONSIBLE FOR OBTAINING ALL NECESSARY PERMITS FROM THE APPROPRIATE AGENCIES.

NOTES:

- 1. ALL UTILITY WORK SHALL BE PERFORMED BY LICENSED CONTRACTORS IN THEIR RESPECTIVE TRADES.
- 2. ALL UTILITY WORK SHALL MEET REQUIREMENTS OF THE CURRENT STATE BUILDING CODE.
- 3. THE CONTRACTOR SHALL BE RESPONSIBLE FOR OBTAINING ALL NECESSARY PERMITS FROM THE APPROPRIATE AGENCIES.
- 4. THE CONTRACTOR SHALL BE RESPONSIBLE FOR OBTAINING ALL NECESSARY PERMITS FROM THE APPROPRIATE AGENCIES.
- 5. THE CONTRACTOR SHALL BE RESPONSIBLE FOR OBTAINING ALL NECESSARY PERMITS FROM THE APPROPRIATE AGENCIES.
- 6. THE CONTRACTOR SHALL BE RESPONSIBLE FOR OBTAINING ALL NECESSARY PERMITS FROM THE APPROPRIATE AGENCIES.
- 7. THE CONTRACTOR SHALL BE RESPONSIBLE FOR OBTAINING ALL NECESSARY PERMITS FROM THE APPROPRIATE AGENCIES.
- 8. THE CONTRACTOR SHALL BE RESPONSIBLE FOR OBTAINING ALL NECESSARY PERMITS FROM THE APPROPRIATE AGENCIES.
- 9. THE CONTRACTOR SHALL BE RESPONSIBLE FOR OBTAINING ALL NECESSARY PERMITS FROM THE APPROPRIATE AGENCIES.
- 10. THE CONTRACTOR SHALL BE RESPONSIBLE FOR OBTAINING ALL NECESSARY PERMITS FROM THE APPROPRIATE AGENCIES.

CONCRETE SPECIFICATIONS:

ALL CONCRETE SHALL BE PLACED AND CURED IN ACCORDANCE WITH THE BUILDING CODES AND REGULATIONS OF THE STATE OF RHODE ISLAND. THE CONTRACTOR SHALL BE RESPONSIBLE FOR OBTAINING ALL NECESSARY PERMITS FROM THE APPROPRIATE AGENCIES. THE CONTRACTOR SHALL BE RESPONSIBLE FOR OBTAINING ALL NECESSARY PERMITS FROM THE APPROPRIATE AGENCIES.

NOTES:

- 1. ALL CONCRETE SHALL BE PLACED AND CURED IN ACCORDANCE WITH THE BUILDING CODES AND REGULATIONS OF THE STATE OF RHODE ISLAND.
- 2. ALL CONCRETE SHALL BE PLACED AND CURED IN ACCORDANCE WITH THE BUILDING CODES AND REGULATIONS OF THE STATE OF RHODE ISLAND.
- 3. ALL CONCRETE SHALL BE PLACED AND CURED IN ACCORDANCE WITH THE BUILDING CODES AND REGULATIONS OF THE STATE OF RHODE ISLAND.
- 4. ALL CONCRETE SHALL BE PLACED AND CURED IN ACCORDANCE WITH THE BUILDING CODES AND REGULATIONS OF THE STATE OF RHODE ISLAND.
- 5. ALL CONCRETE SHALL BE PLACED AND CURED IN ACCORDANCE WITH THE BUILDING CODES AND REGULATIONS OF THE STATE OF RHODE ISLAND.
- 6. ALL CONCRETE SHALL BE PLACED AND CURED IN ACCORDANCE WITH THE BUILDING CODES AND REGULATIONS OF THE STATE OF RHODE ISLAND.
- 7. ALL CONCRETE SHALL BE PLACED AND CURED IN ACCORDANCE WITH THE BUILDING CODES AND REGULATIONS OF THE STATE OF RHODE ISLAND.
- 8. ALL CONCRETE SHALL BE PLACED AND CURED IN ACCORDANCE WITH THE BUILDING CODES AND REGULATIONS OF THE STATE OF RHODE ISLAND.
- 9. ALL CONCRETE SHALL BE PLACED AND CURED IN ACCORDANCE WITH THE BUILDING CODES AND REGULATIONS OF THE STATE OF RHODE ISLAND.
- 10. ALL CONCRETE SHALL BE PLACED AND CURED IN ACCORDANCE WITH THE BUILDING CODES AND REGULATIONS OF THE STATE OF RHODE ISLAND.

FINISHES SPECIFICATIONS:

ALL FINISHES SHALL BE IN ACCORDANCE WITH THE BUILDING CODES AND REGULATIONS OF THE STATE OF RHODE ISLAND. THE CONTRACTOR SHALL BE RESPONSIBLE FOR OBTAINING ALL NECESSARY PERMITS FROM THE APPROPRIATE AGENCIES. THE CONTRACTOR SHALL BE RESPONSIBLE FOR OBTAINING ALL NECESSARY PERMITS FROM THE APPROPRIATE AGENCIES.

NOTES:

- 1. ALL FINISHES SHALL BE IN ACCORDANCE WITH THE BUILDING CODES AND REGULATIONS OF THE STATE OF RHODE ISLAND.
- 2. ALL FINISHES SHALL BE IN ACCORDANCE WITH THE BUILDING CODES AND REGULATIONS OF THE STATE OF RHODE ISLAND.
- 3. ALL FINISHES SHALL BE IN ACCORDANCE WITH THE BUILDING CODES AND REGULATIONS OF THE STATE OF RHODE ISLAND.
- 4. ALL FINISHES SHALL BE IN ACCORDANCE WITH THE BUILDING CODES AND REGULATIONS OF THE STATE OF RHODE ISLAND.
- 5. ALL FINISHES SHALL BE IN ACCORDANCE WITH THE BUILDING CODES AND REGULATIONS OF THE STATE OF RHODE ISLAND.
- 6. ALL FINISHES SHALL BE IN ACCORDANCE WITH THE BUILDING CODES AND REGULATIONS OF THE STATE OF RHODE ISLAND.
- 7. ALL FINISHES SHALL BE IN ACCORDANCE WITH THE BUILDING CODES AND REGULATIONS OF THE STATE OF RHODE ISLAND.
- 8. ALL FINISHES SHALL BE IN ACCORDANCE WITH THE BUILDING CODES AND REGULATIONS OF THE STATE OF RHODE ISLAND.
- 9. ALL FINISHES SHALL BE IN ACCORDANCE WITH THE BUILDING CODES AND REGULATIONS OF THE STATE OF RHODE ISLAND.
- 10. ALL FINISHES SHALL BE IN ACCORDANCE WITH THE BUILDING CODES AND REGULATIONS OF THE STATE OF RHODE ISLAND.



AERIAL PHOTO

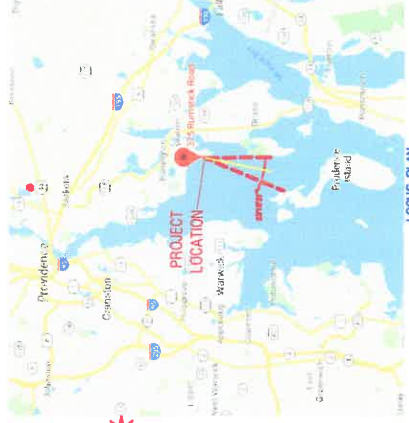

LOCUS PLAN

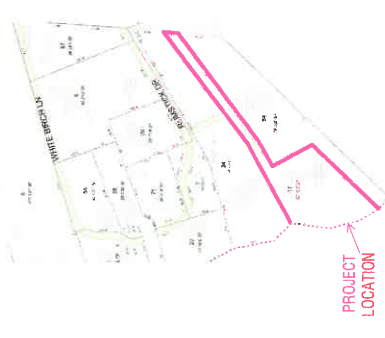

PLAT MAP

OWNER: BARBARA J. SHAUGHNESSY (TRUST)
 C/O SPRUCE STREET
 BARRINGTON, RI 02809
 NEW YORK, NY 10038

DATE: 10/4/18
 CHK: RB
 DR: VS
 DSCR: RB

REVISIONS

NO.	DESCRIPTION	DATE	BY

DATE: 10/4/18
 CHK: RB
 DR: VS
 DSCR: RB

DATE: 10/4/18
 CHK: RB
 DR: VS
 DSCR: RB

DATE: 10/4/18
 CHK: RB
 DR: VS
 DSCR: RB

DATE: 10/4/18
 CHK: RB
 DR: VS
 DSCR: RB

SCALE: AS SHOWN
DK-1
 PROJECT NO.:
 SHEET NO.:

COASTAL RESOURCES
 MANAGEMENT COUNCIL

RECEIVED
 NOV 29 2018
 NOT TO BE CONSIDERED VALID WITHIN 50' OF END OF PROPOSED DOCK HAVE
 BARRINGTON PLAT MAP

NO.	DATE	DESCRIPTION	BY	CHK.
1	10/4/18	ISSUED FOR PERMIT	RB	RB
2			VS	VS
3			RB	RB
4				
5				
6				
7				
8				
9				
10				

DATE: 10/4/18
 CHK: RB
 DR: VS
 DSQR: RB

SEI
 SITE ENGINEERING INC.
 CIVIL, GEOTECH - STRUCTURAL
 75 BOAT STREET
 BARRINGTON, RI 02806
 PHONE: (401) 863-8831

BARRINGTON, RHODE ISLAND
 PLAT 11, LOT 17
DOCK PROFILE & DETAILS
 RESIDENTIAL BOATING FACILITY

DK-3
 SCALE: AS SHOWN
 RVT T. BLANCHARD
 P.E.
 0014
 PROFESSIONAL ENGINEER

OWNER: J. SHALICNESSY (TRUST)
 375 RUMSTOCK RD.
 BARRINGTON, RI 02806

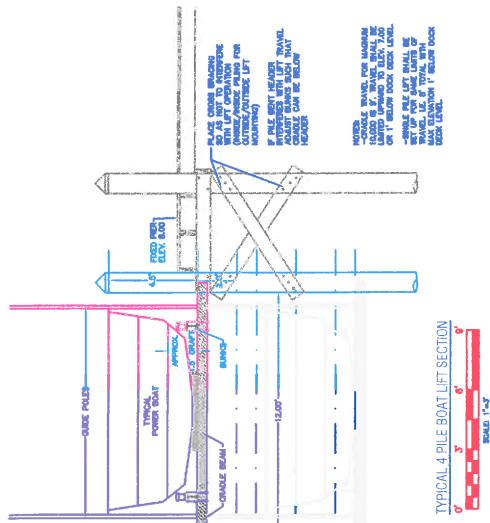
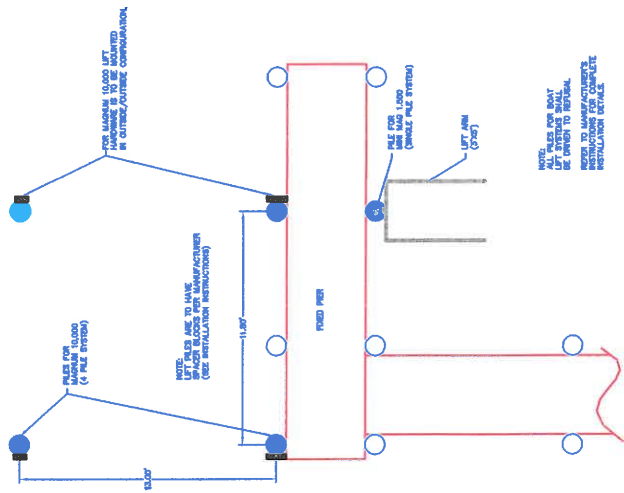

NOTE: BOAT LIFTS ARE:
 MIN MAG 1,500 & MAGNUM 10,000
 (1,500 LB. & 10,000 LB. CAPACITIES)

MANUFACTURER IS:
 BOAT LIFTS UNLIMITED LTD
 1000 W. 10TH ST.
 OGDON, MO 64653
 1-800-288-5911
 www.boatliftdock.com

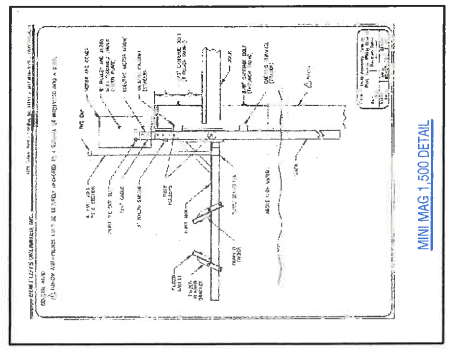
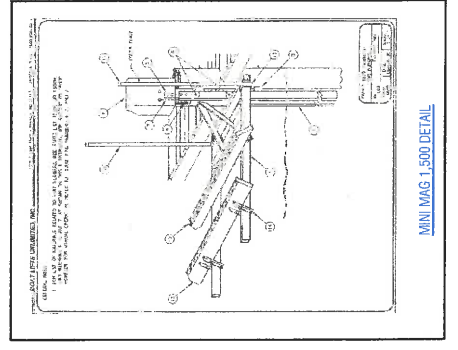
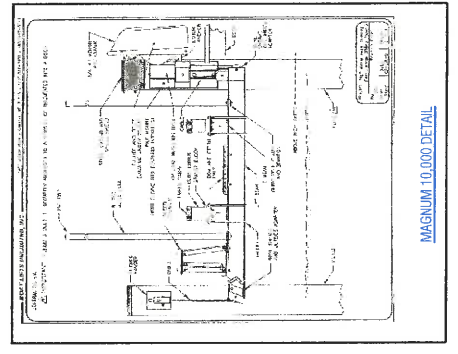
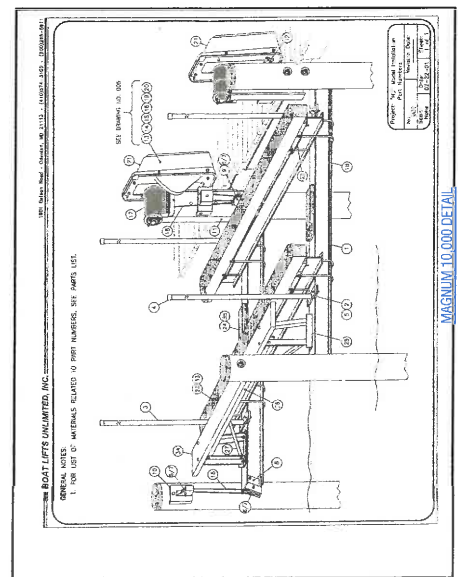
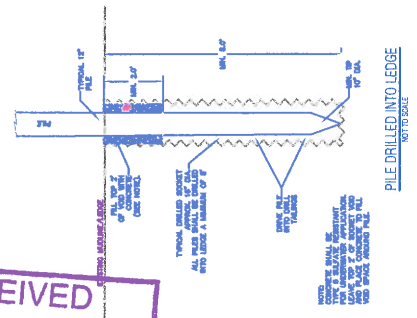

RECEIVED
NOV 29 2018
 COASTAL RESOURCES
 MANAGEMENT COUNCIL

RECEIVED
 NOV 29 2018
 COASTAL RESOURCES
 MANAGEMENT COUNCIL

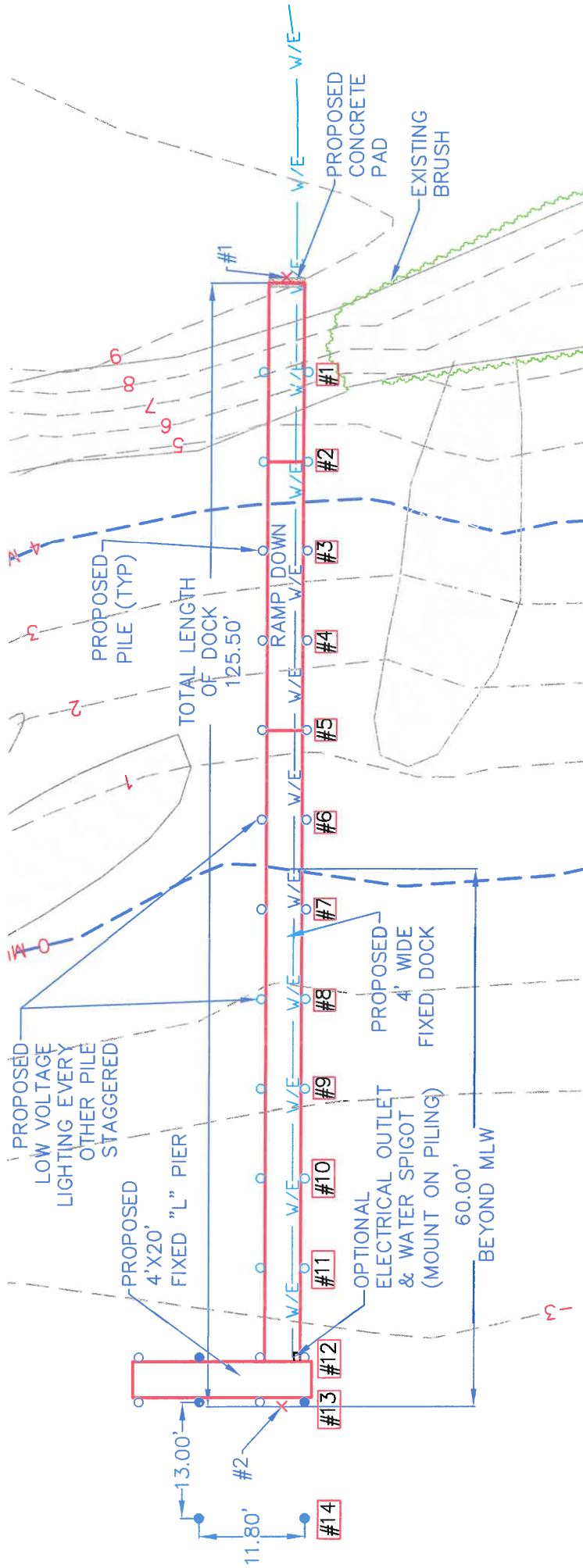

RECEIVED
 NOV 29 2018
 COASTAL RESOURCES
 MANAGEMENT COUNCIL

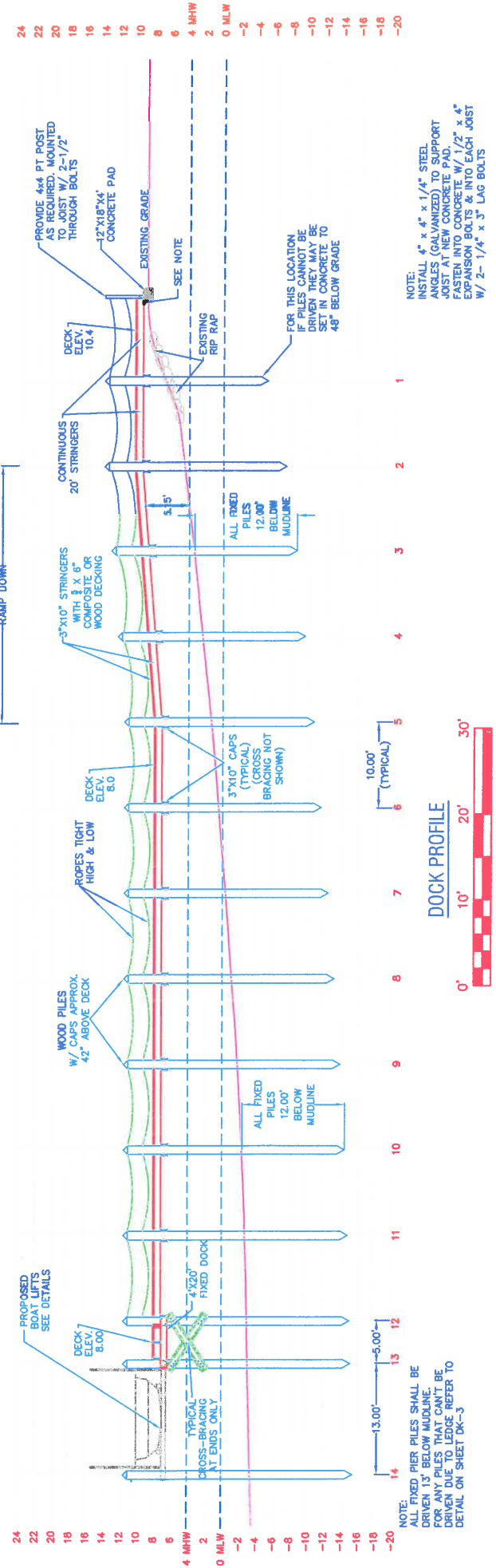

RECEIVED
 NOV 29 2018
 COASTAL RESOURCES
 MANAGEMENT COUNCIL

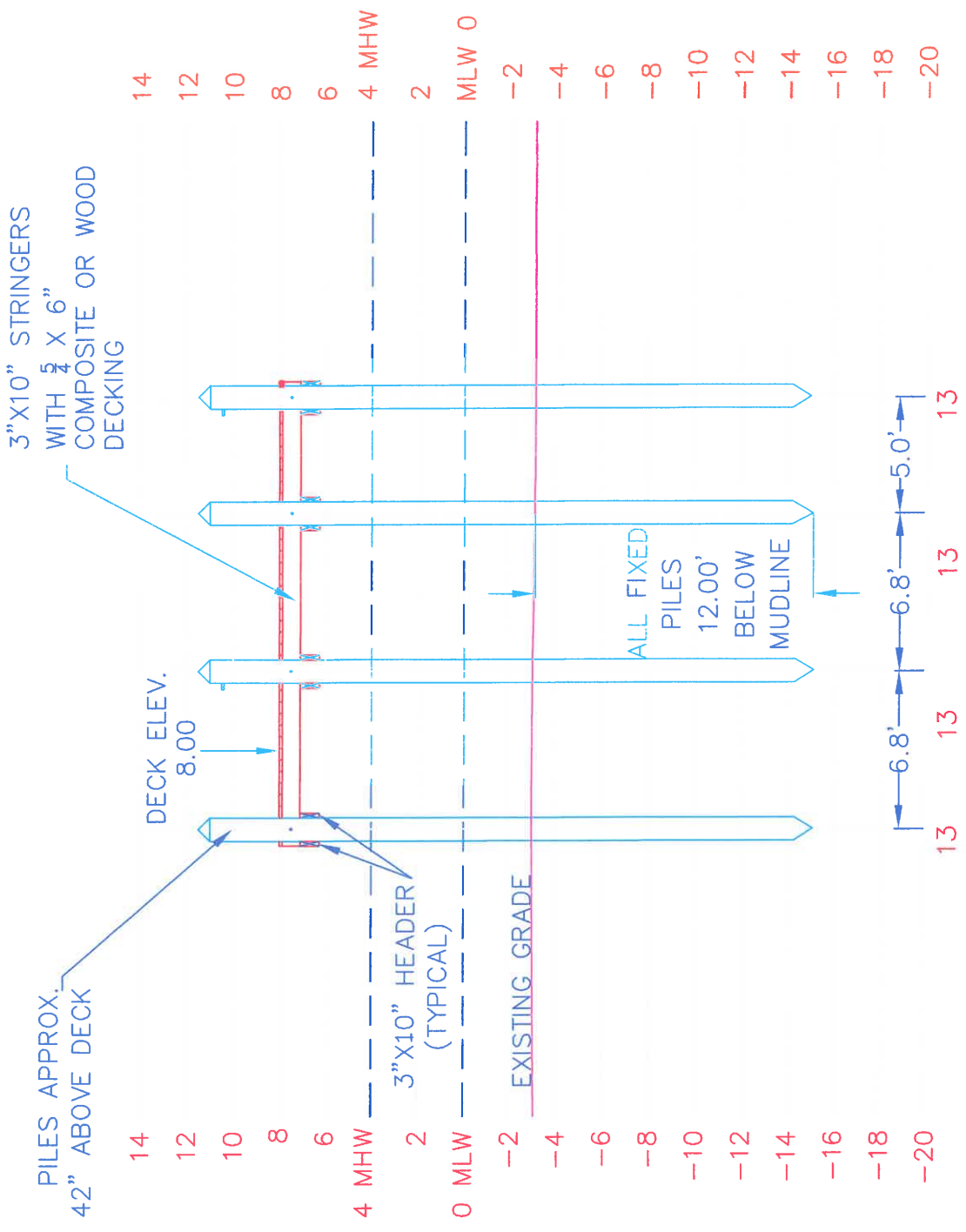

END PROFILE

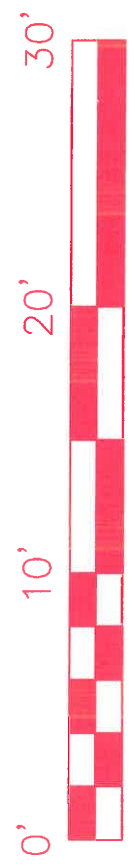

SCALE: 1"=10'