



State of Rhode Island  
**Coastal Resources Management Council**  
Oliver H. Stedman Government Center  
4808 Tower Hill Road, Suite 3  
Wakefield, RI 02879-1900

(401) 783-3370  
Fax (401) 783-2069

### **PUBLIC NOTICE**

File Number: 2021-08-102 Date: September 21, 2021

This office has under consideration the application of:

**Bristol County Water Authority**  
**450 Child Street**  
**Warren, RI 02885**

for a State of Rhode Island Assent to remove the Lower Kickemuit Reservoir Dam and restore the Upper Kickemuit estuary. The project consists of the removal of the dam structure, shoreline stabilization, sediment management, and wetland restoration. Special Exceptions are required for dredging in Type 2 waters §1.3.1(I)(3)(b), filling in Type 2 waters §1.3.1(J)(3)(a) and alterations to coastal wetlands §1.3.1(L)(3)(b)

Project Location:	Lower Kickemuit Reservoir Dam
City/Town:	Warren
Plat/Lot:	13B 21 / 28 182
Waterway:	Kickemuit River

Plans of the proposed work may be seen at the CRMC office in Wakefield.

In accordance with the Administrative Procedures Act (Chapter 42-35 of the Rhode Island General Laws) you may request a hearing on this matter.

You are advised that if you have good reason to enter protests against the proposed work it is your privilege to do so. It is expected that objectors will review the application and plans thoroughly, visit site of proposed work if necessary, to familiarize themselves with the conditions and cite what law or laws, if any, would in their opinion be violated by the work proposed.

If you desire to protest, you must attend the scheduled hearing and give sworn testimony. A notice of the time and place of such hearing will be furnished you as soon as possible after receipt of your request for hearing. If you desire to request a hearing, to receive consideration, it should be in writing (**with your correct mailing address, e-mail address and valid contact number**) and be received at this office on or before October 21, 2021.

PERMIT SUBMISSION  
NOT FOR CONSTRUCTION

*Prepared for The:*  
**BRISTOL COUNTY WATER AUTHORITY**  
**LOWER KICKEMUTT RESERVOIR DAM REMOVAL**  
**(WARREN RESERVOIR LOWER DAM)**

**RI / 479**  
**WARREN, RHODE ISLAND**  
**AUGUST 2021**

Drawing Index

0.0	COVER SHEET
1.0	GENERAL NOTES AND LEGEND
2.0	OVERVIEW OF LOWER KICKEMUTT RESERVOIR
2.1	EXISTING CONDITIONS PLAN
2.2	EXISTING SPILLWAY PLAN
2.3	SITE ACCESS PLAN
2.4	CONTROL OF WATER PLAN
3.0	DEMOLITION PLAN
4.0	PROPOSED SITE PLAN
4.1	PROPOSED BREACH SECTION
5.0	EXISTING WETLAND PLAN
5.1	PROPOSED WETLAND CONDITIONS
5.2	PROPOSED WETLAND CONDITIONS IMPOUNDMENT SECTIONS
6.0	IMPACTED SOIL REMOVAL PLAN
6.1	SEDIMENT MANAGEMENT PLAN
6.2	SEDIMENT Dewatering PLAN
7.0	SERPENTINE ROAD IMPROVEMENTS
8.0	PLANTING PLAN
9.0	MISCELLANEOUS DETAILS

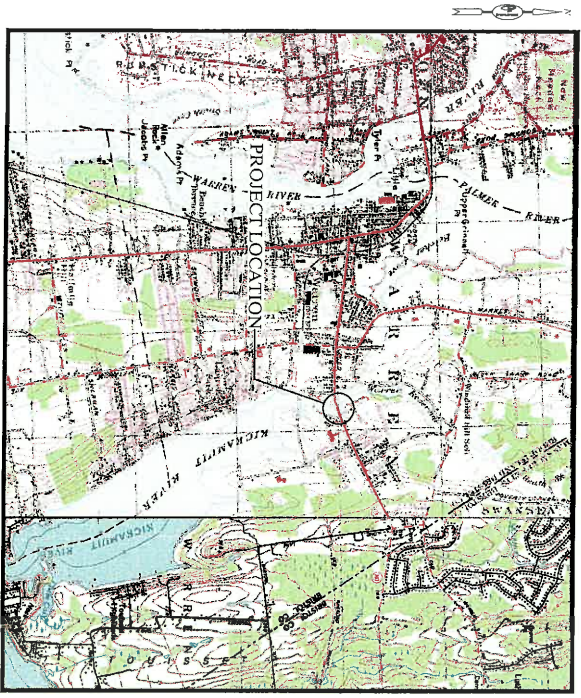

**LOCUS PLAN**  
SCALE: 1" = 200'



**AERIAL PLAN**  
SCALE: 1" = 400'

*Prepared by:*  
**PARÉ CORPORATION**  
Foxboro, Massachusetts







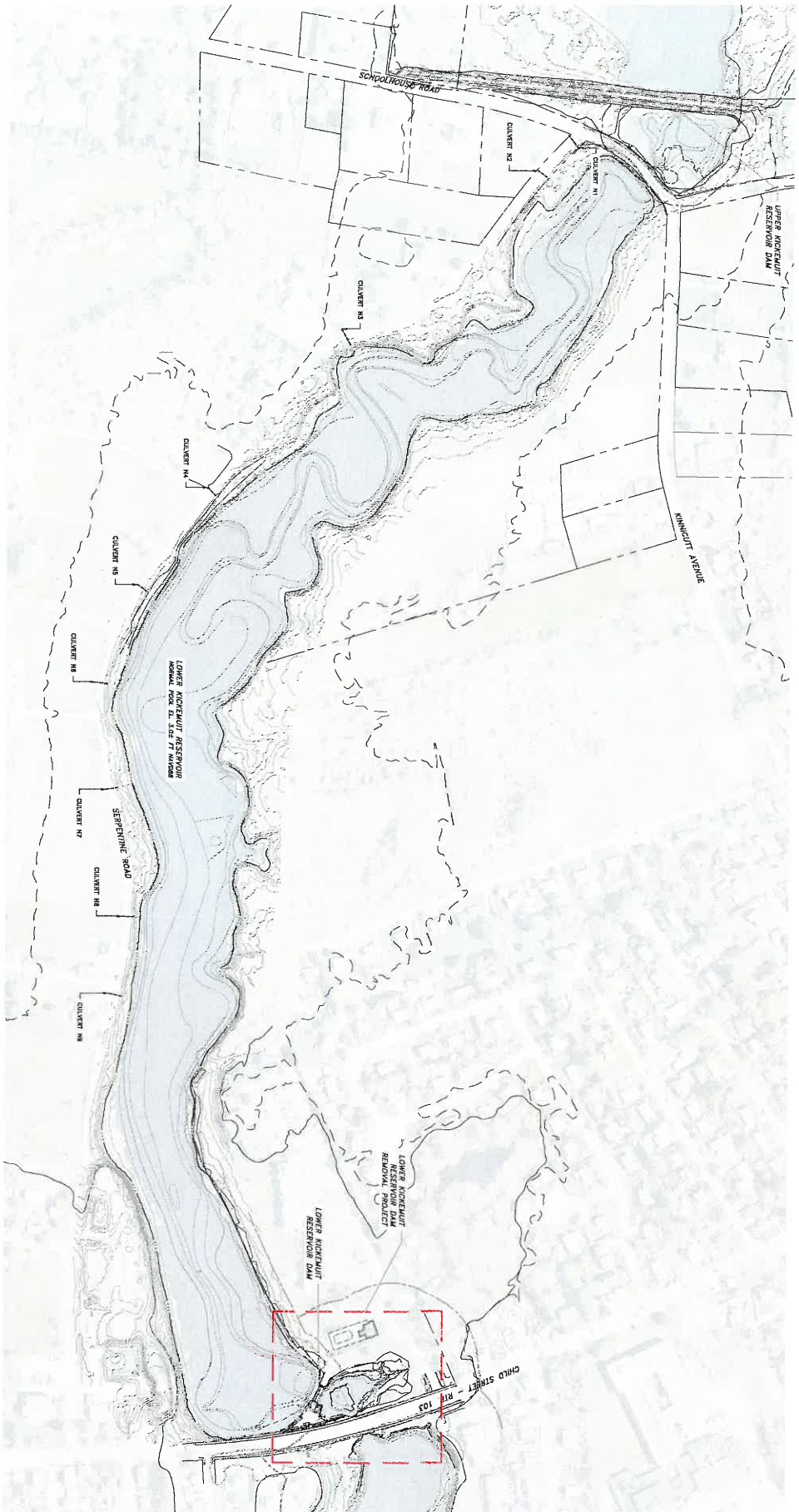

OVERVIEW OF LOWER KICKEMUIT RESERVOIR  
EXISTING CONDITIONS

SCALE: 1" = 100'

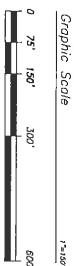

PERMIT SUBMISSION  
NOT FOR CONSTRUCTION



PARE CORPORATION  
1000 ROUTE 1  
PO BOX 200  
00000-0000



LOWER KICKEMUIT RESERVOIR DAM REMOVAL  
RI / 479  
WARREN, RHODE ISLAND  
OWNER: BRISTOL COUNTY WATER AUTHORITY



REVISIONS	
PROJECT NO.	100120
DATE	MARCH 200
SCALE	AS NOTED
DESIGNED BY	PHD
CHECKED BY	JMB
DRAWN BY	LAC
APPROVED BY	JMB
OVERVIEW OF LOWER KICKEMUIT RESERVOIR	
SHEET NO.	2.0
	1 OF 1

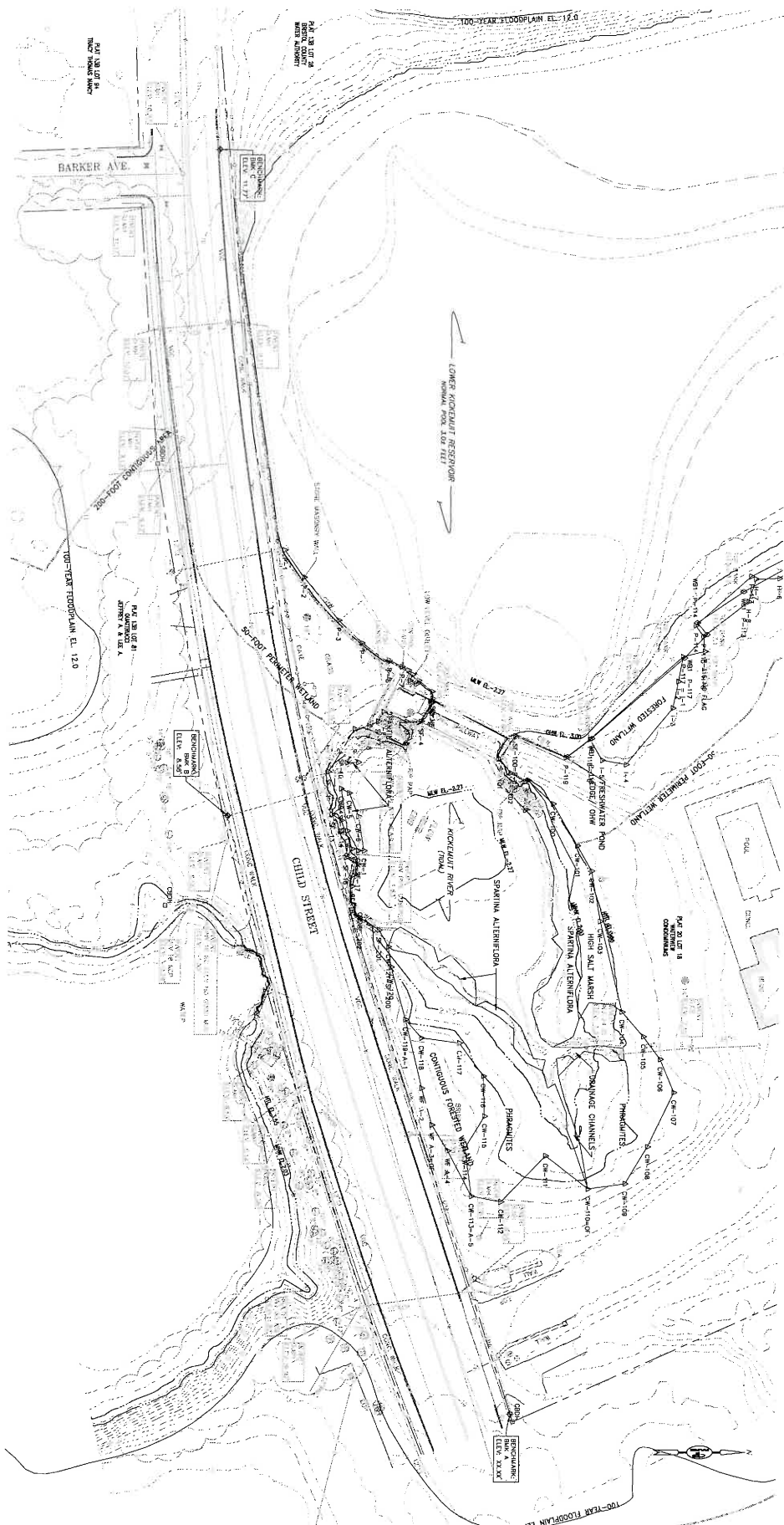

EXISTING CONDITIONS PLAN  
SCALE: 1"=10'

SCALE: 1"=30'±

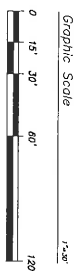

### EXISTING CONDITIONS PLAN

## PERMIT SUBMISSION



LOWER KICKEMUIT RESERVOIR DAM REMOVAL  
RI / 479  
WARREN, RHODE ISLAND  
OWNER: BRISTOL COUNTY WATER AUTHORITY



REVISIONS:					
PROJECT NO.:	14217				
DATE:	AUGUST 2011				
SCALE:	AS NOTED				
DESIGNED BY:	BR				
CHECKED BY:	JH				
DRAWN BY:	TH				
APPROVED BY:	JH				







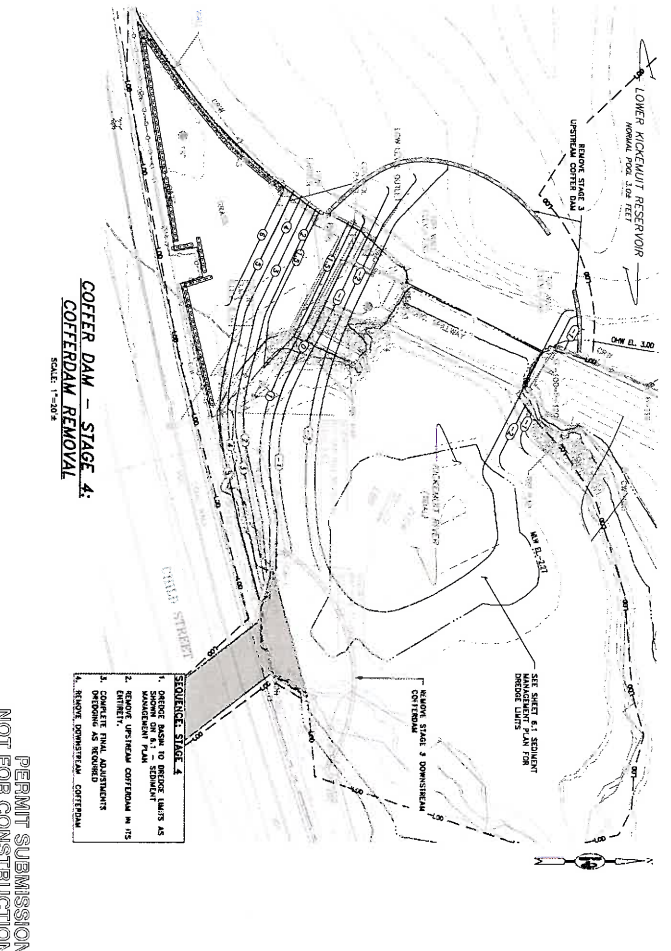
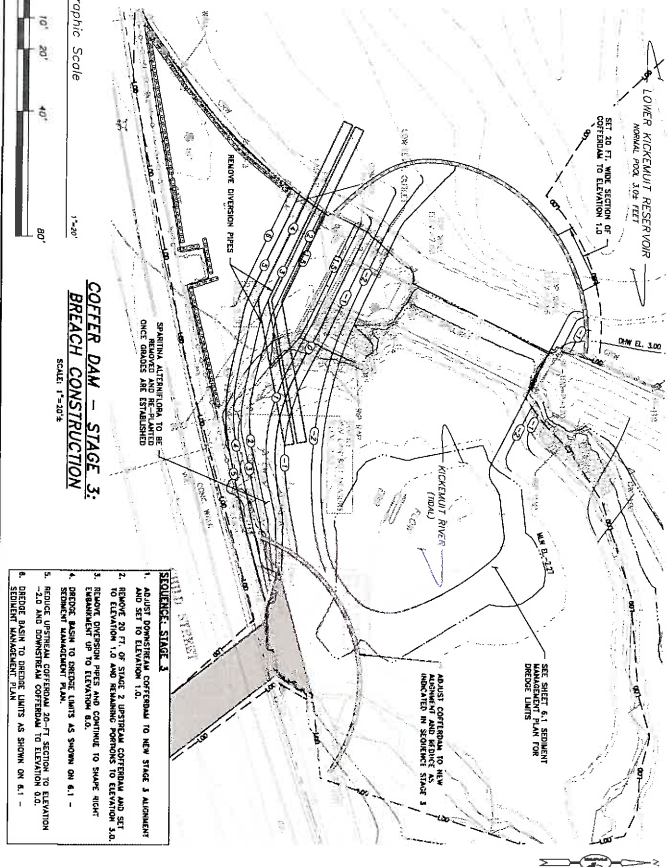
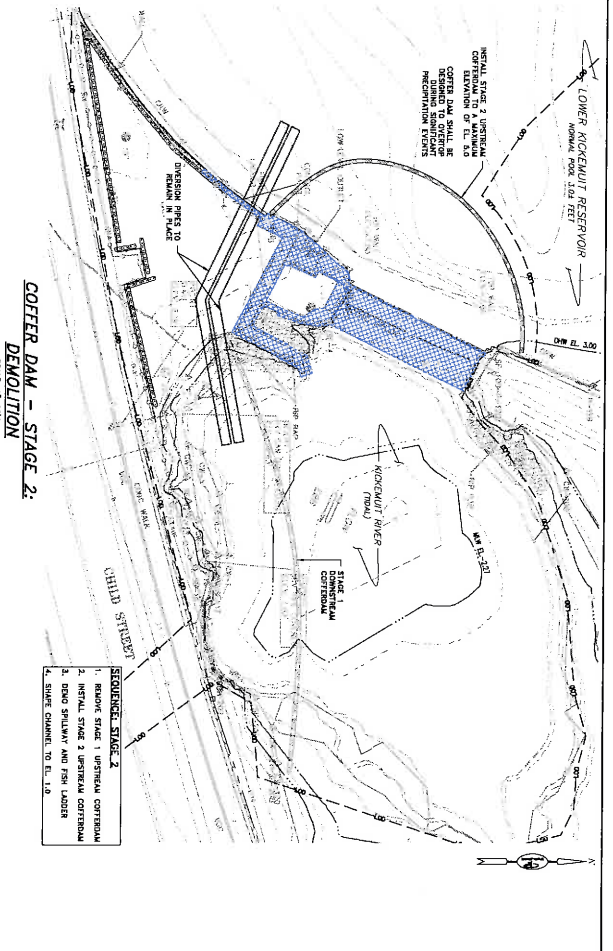
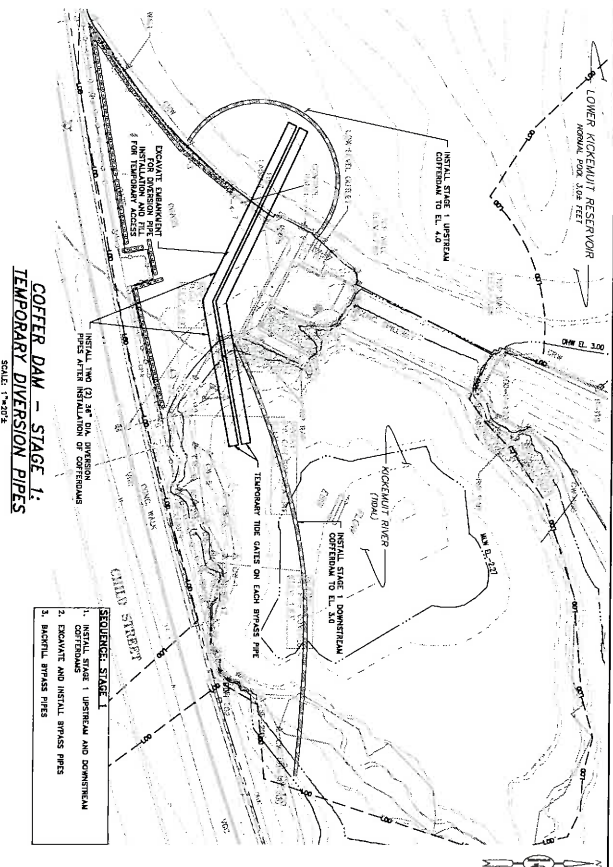



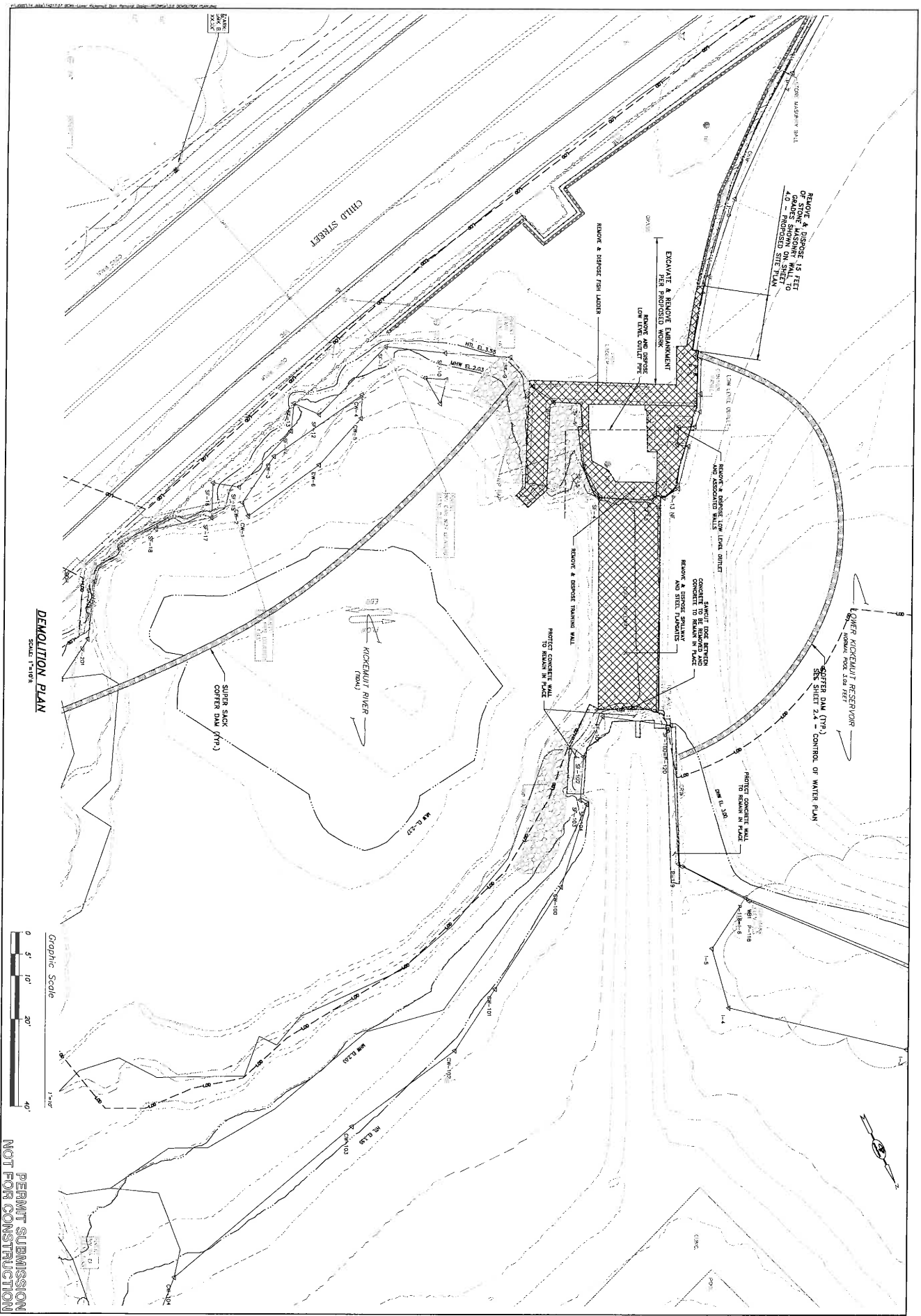

DEMOLITION PLAN  
SCALE: 1"=100'

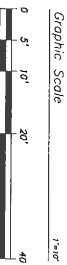

PERMIT SUBMISSION  
NOT FOR CONSTRUCTION

 PARE CORPORATION 31000 ROUTE 1A WARREN, RHODE ISLAND 02886 401-253-7255		<b>LOWER KICKEMUIT RESERVOIR DAM REMOVAL</b> RI / 479 WARREN, RHODE ISLAND OWNER: BRISTOL COUNTY WATER AUTHORITY		SCALE ADJUSTMENT 1" = 100' 1" = 100' ON ORIGINAL DRAWING	
SHEET NO.: 3.0 OF 3.0				DEMOLITION PLAN	
PROJECT NO.: 1021727 DATE: 10/1/17 SCALE: AS NOTED DESIGNED BY: BMD CHECKED BY: JMB DRAWN BY: LAC APPROVED BY: JMB		REG. SIGN:			



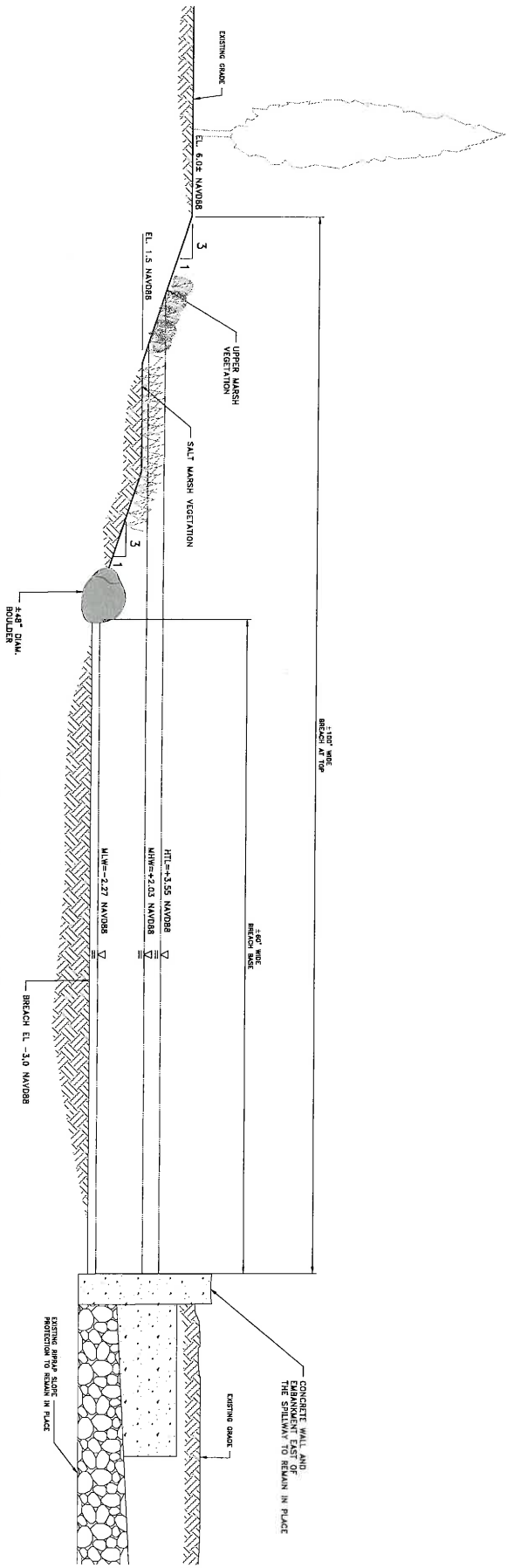

SECTION A - BREACH PROFILE  
SCALE: 1" = 4.0'

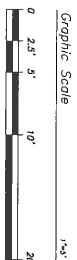

PERMIT SUBMISSION  
NOT FOR CONSTRUCTION



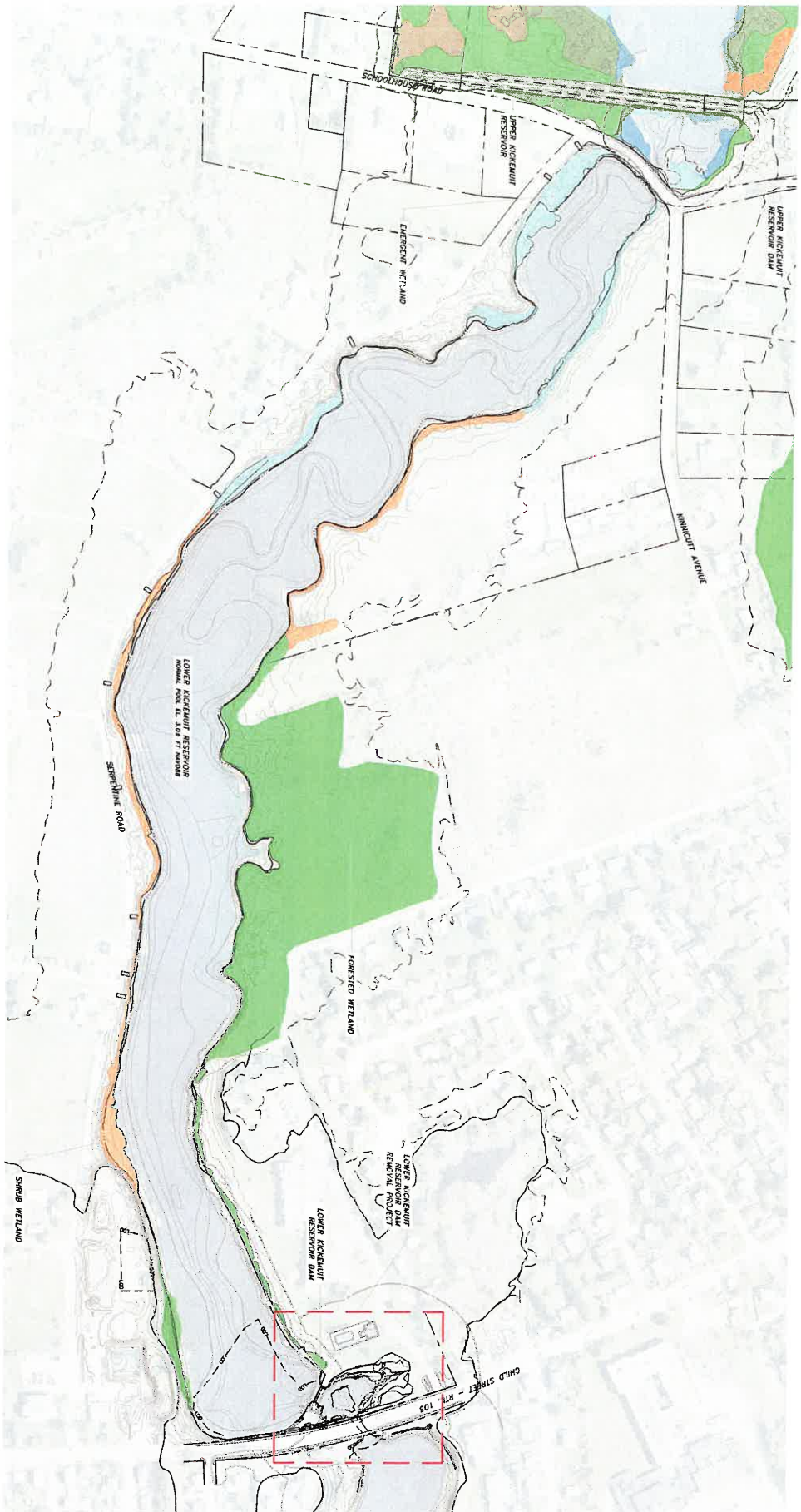

- OPEN WATER WETLANDS**  
PBBB - LOWER KICKEMUIT RESERVOIR
- VEGETATED WETLANDS**  
PFAITH - EMERGENT FRESHWATER WETLANDS  
PFAKE - PHRAGMITES  
PFOIB - FORESTED SWAMP, SATURATED  
PFOIE - FORESTED SWAMP, SEASONALLY FLOODED  
PFAIB - SHRUB WETLAND  
PFAIR - BUTTERNUT

**EXISTING WETLAND PLAN**  
SCALE: 1" = 500'



PERMIT SUBMISSION  
NOT FOR CONSTRUCTION



**LOWER KICKEMUIT RESERVOIR DAM REMOVAL**  
RI / 479  
WARREN, RHODE ISLAND  
OWNER: BRISTOL COUNTY WATER AUTHORITY



REVISIONS	
PROJECT NO.	1017-07
DATE	MARCH 2011
SCALE	AS NOTED
DESIGNED BY	BND
CHECKED BY	JMB
DRAWN BY	LAC
APPROVED BY	NMB

EXISTING WETLAND PLAN  
SHEET NO. 5.0  
11 OF 18

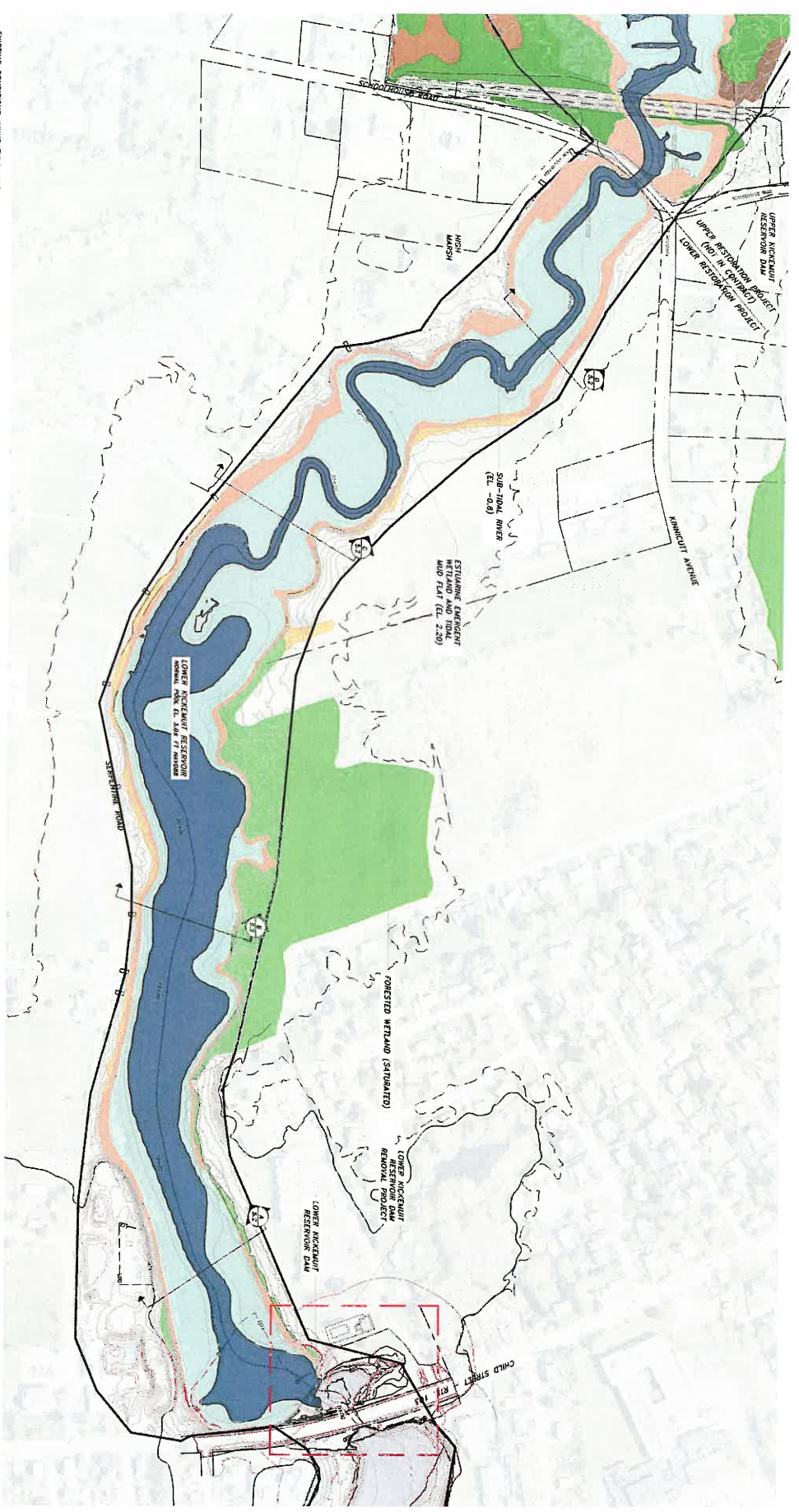

**PROPOSED WETLAND PLAN**

SCALE: 1" = 100'

- EXISTING CONDITIONS INUNDATION LIMITS**
- PROPOSED WETLANDS**
- COMPARISON CLASSIFICATION**
- PFO1B - FORESTED SWAMP, SEASONALLY FLOODED
  - PFO1E - FORESTED SWAMP, OCCASIONALLY FLOODED
  - PFO1C - SHRUB WETLAND
  - PFO1D - EMERGENT CATTAIL MARSH
  - PFO1A - EMERGENT TIDAL
  - PFO1F - ESTUARINE EMERGENT/ TIDAL FLAT

**NOTES**

1. REFERENCE TO NATURAL RESOURCES CODE, TITLE 11, CHAPTER 11-2, SECTION 11-2-1, IS INCORPORATED BY REFERENCE INTO THIS SHEET. SEE SHEET 1.0 - PLANNING PLAN FOR PROPOSED PLANNING.

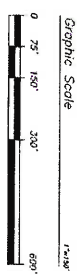

**PERMIT STATEMENTS**  
**NOT FOR CONSTRUCTION**



**LOWER KICKEMUIT RESERVOIR DAM REMOVAL**  
RI / 479  
WARREN, RHODE ISLAND  
OWNER: BRISTOL COUNTY WATER AUTHORITY



DESIGNED BY	DATE
CHECKED BY	DATE
DRAWN BY	DATE
APPROVED BY	DATE
PROJECT NO.	1012.20
SCALE	AS SHOWN
DESIGNED BY	PHD
CHECKED BY	JMB
DRAWN BY	JMB
APPROVED BY	JMB
PROPOSED WETLAND CONDITIONS	
SHEET NO.	5.1
1A OF 2A	







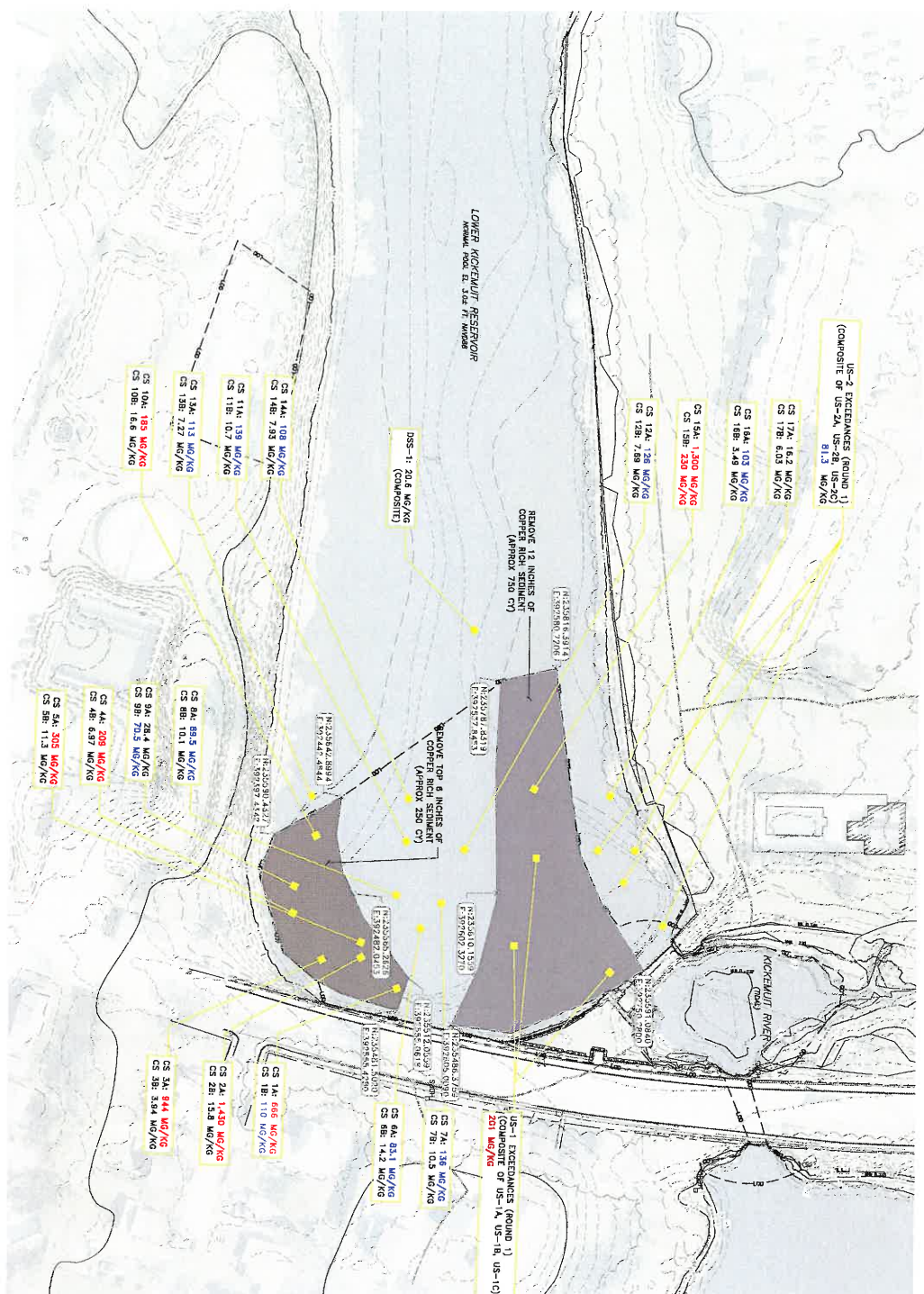
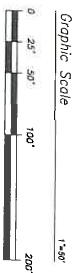

# IMPACTED SOIL REMOVAL PLAN

SCALE: 1"=50'

PERMIT SUBMISSION  
NOT FOR CONSTRUCTION

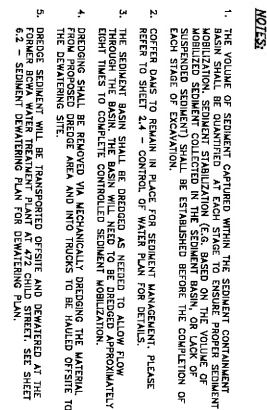

6.1



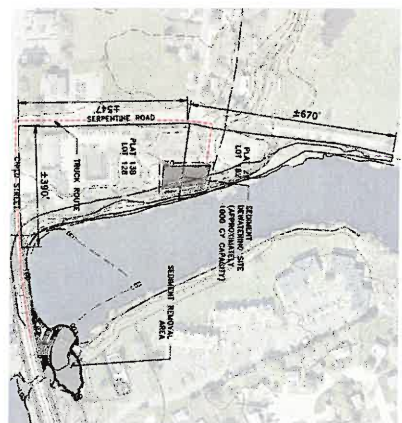
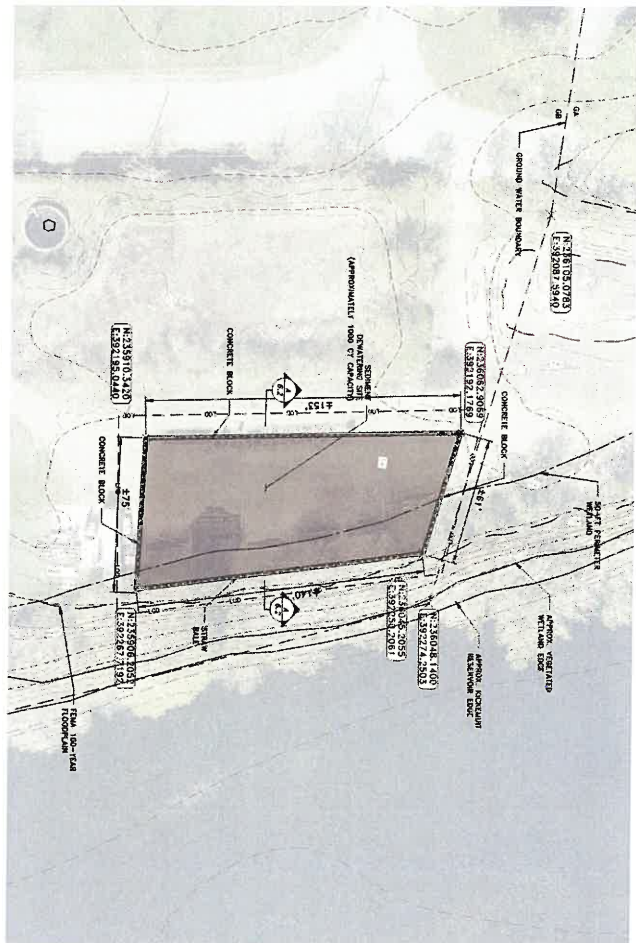

1. THE VOLUME OF SEDIMENT CAPTURED WITHIN THE SEDIMENT CONTAINMENT BARRIER SHALL BE DETERMINED BY THE FOLLOWING: (A) THE VOLUME OF SEDIMENT MOBILIZATION, SEDIMENT STABILIZATION (E.G. BASED ON THE VOLUME OF MOBILIZED SEDIMENT COLLECTED IN THE SEDIMENT BASIN, OR LACK OF EACH STAGE OF COLLECTION).
2. AFTER DATA TO REMAIN IN PLACE FOR SEDIMENT MANAGEMENT PLEASE REFER TO SHEET 2-2 - A FACTOR OF WATER PLUM FOR DETAILS.
3. THE SEDIMENT BASIN SHALL BE DESIGNED AS NEEDED TO ALLOW FLOW FROM THE BASIN. THE BASIN WILL NEED TO BE DESIGNED APPROXIMATELY FOUR TIMES TO COMPLETE CONTROLLED SEDIMENT MOBILIZATION.
4. DREDGE SEDIMENTS WILL BE TRANSPORTED OFFSITE AND STOCKPILED AT THE OFFSITE DREDGING PLANT. DREDGE SEDIMENT MAY BE USED FOR OFFSITE MITIGATION.

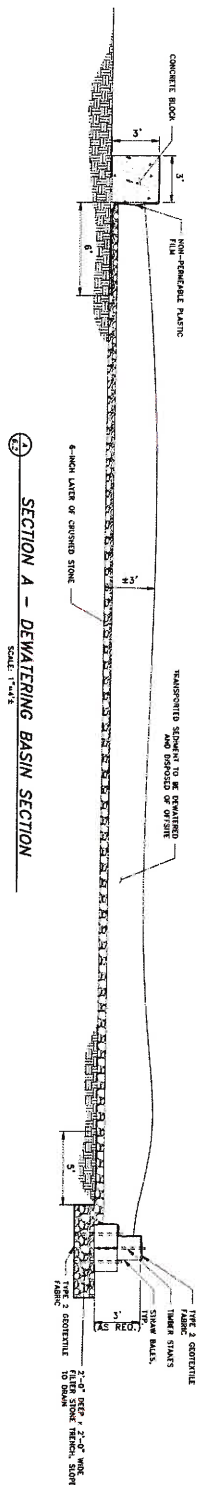

**PERMIT SUBMISSION  
NOT FOR CONSTRUCTION**





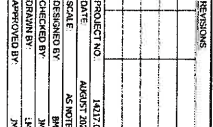
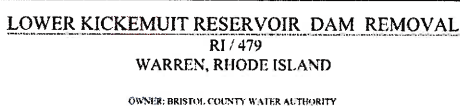
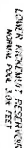
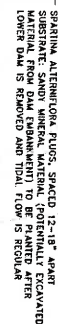
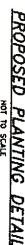

9.0