



State of Rhode Island  
**Coastal Resources Management Council**  
Oliver H. Stedman Government Center  
4808 Tower Hill Road, Suite 3  
Wakefield, RI 02879-1900

(401) 783-3370  
Fax (401) 783-2069

## **PUBLIC NOTICE**

File Number: 2021-08-107 Date: October 21, 2021

This office has under consideration the application of:

**Town of New Shoreham**  
**c/o Maryann Crawford, Town Manager**  
**P.O. Box 220**  
**New Shoreham, RI 02807**

for a State of Rhode Island Assent to construct and maintain: The project will rehabilitate and expand the existing US Coast Guard dock. The work consists of widening the pier from 6-ft to 12-ft wide to accommodate emergency vehicles. The overall pier length remain the same. The project will also reconfigure the existing floating dock from 10-ft wide and 35-ft long to 8-ft wide and 40-ft long. The project also contains a new floating dock to accommodate the new Coast Guard response boat. This new pier will be located 12-ft landward of the pier terminus and will be 6-ft wide and 60-ft long. This work is proposed in Type 2 waters and will require a special exception to the prohibition of commercial docks in tidal waters Redbook Section 1.3.1(C)3.

Project Location:	121 Champlin Road
City/Town:	New Shoreham
Plat/Lot:	20 / 12
Waterway:	Great Salt Pond (Entrance Channel)

Plans of the proposed work may be seen at the CRMC office in Wakefield.

In accordance with the Administrative Procedures Act (Chapter 42-35 of the Rhode Island General Laws) you may request a hearing on this matter.

You are advised that if you have good reason to enter protests against the proposed work it is your privilege to do so. It is expected that objectors will review the application and plans thoroughly, visit site of proposed work if necessary, to familiarize themselves with the conditions and cite what law or laws, if any, would in their opinion be violated by the work proposed.

If you desire to protest, you must attend the scheduled hearing and give sworn testimony. A notice of the time and place of such hearing will be furnished you as soon as possible after receipt of your request for hearing. If you desire to request a hearing, to receive consideration, it should be in writing (**with your correct mailing address, e-mail address and valid contact number**) and be received at this office on or before November 22, 2021.

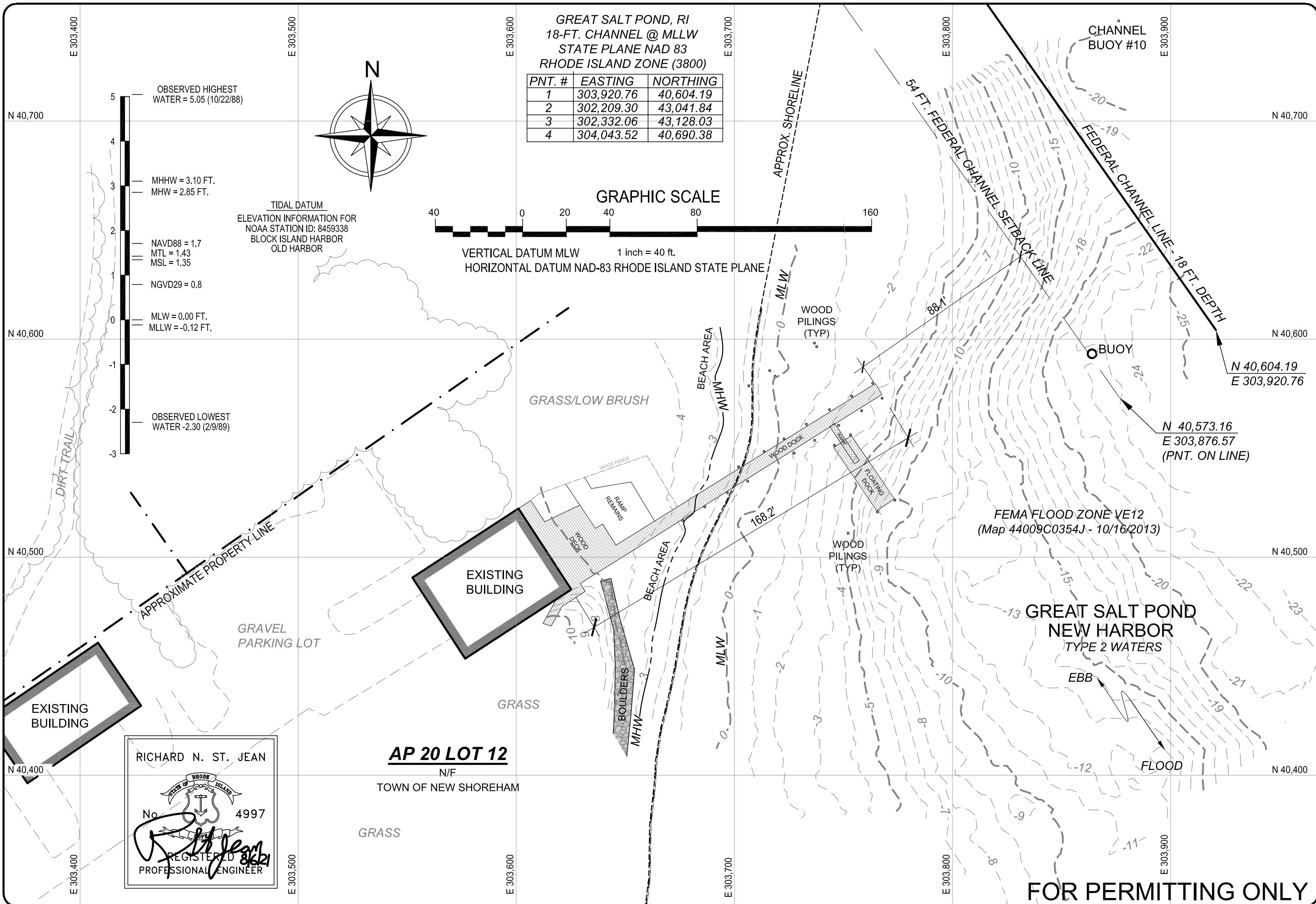

**RECEIVED**  
Drawn By: [Signature]  
Checked: 8/25/202  
Scale: COASTAL RESOURCES  
Date: MAINTENANCE COUNCIL

Prepared for Applicant:  
**Town of New Shoreham**  
P.O. Drawer 220, Block Island, Rhode Island  
U.S. Coast Guard Docking Facility - New Harbor  
Existing Conditions

**ST. JEAN ENGINEERING, LLC**  
CIVIL, MARINE AND STRUCTURAL  
CONSULTING ENGINEERING  
Phone: 401.398.0999  
209 Arnold Neck Drive  
Warwick, RI 02886  
email: st.jean.engineering@verizon.net

SHT NO.  
**C4**  
OF 11

N 40,600

E 303,600

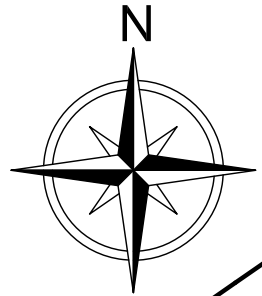

APPROX. PROPERTY LINE

DOCK CL COORDINATES				
PNT.	STA.	DESC.	NORTHING	EASTING
A	0+00	ALIGN START	40,455.5	303,615.3
B	0+16.87	DOCK START	40,469.8	303,626.2
C	0+57.09	TURN PNT.	40501.0	303,649.8
D	1+96.07	DOCK END	40574.5	303,767.7
E	2+00	ALIGN END	40,576.6	303,771.1

### AP 20 LOT 12

N/F  
TOWN OF NEW SHOREHAM

GRAVEL  
PARKING LOT

N 40,500

N 40,500

EXISTING  
BUILDING

WOOD  
DECK

RAMP  
REMAINS

GRASS/LOW BRUSH

WOOD FENCE

EMERGENCY  
VEHICLE  
ACCESS

GRASS

BOULDERS

BEACH AREA

BEACH AREA

MLW

MLW

MLW

RICHARD N. ST. JEAN

No. 4997

REGISTERED  
PROFESSIONAL ENGINEER

GREAT SALT POND  
NEW HARBOR  
TYPE 2 WATERS

EBB

FLOOD

## FOR PERMITTING ONLY



VERTICAL DATUM MLW 1 inch = 20 ft.  
HORIZONTAL DATUM NAD-83 RHODE ISLAND STATE PLANE

RECEIVED

8/25/2022

COASTAL RESOURCES  
MANAGEMENT COUNCIL

Drawn By: [Redacted]  
Checked: [Redacted]  
Scale: [Redacted]  
Date: [Redacted]

Prepared for Applicant:  
**Town of New Shoreham**  
P.O. Drawer 220, Block Island, Rhode Island  
U.S. Coast Guard Docking Facility - New Harbor  
Proposed ReConstruction of Docking Facility

**ST. JEAN ENGINEERING, LLC**  
CIVIL, MARINE AND STRUCTURAL  
CONSULTING ENGINEERING  
Phone: 401.398.0999  
209 Arnold Neck Drive  
Warwick, RI 02886  
email: st.jean.engineering@verizon.net

SHT NO.  
**C5**  
OF 11