



State of Rhode Island
Coastal Resources Management Council
 Oliver H. Stedman Government Center
 4808 Tower Hill Road, Suite 3
 Wakefield, RI 02879-1900

(401) 783-3370
 Fax (401) 783-2069

PUBLIC NOTICE

File Number: 2022-02-020 Date: February 21, 2022

This office has under consideration the application of:

**Sameh & Nancy Said
 14 Honeysuckle Lane
 Portsmouth, RI 02871**

for a State of Rhode Island Assent to construct and maintain:

- an additional boat lift and float lift to an existing residential dock facility

Project Location:	14 Honeysuckle Lane
City/Town:	Portsmouth
Plat/Lot:	29 / 127A
Waterway:	Sakonnet River

Plans of the proposed work may be seen at the CRMC office in Wakefield.

In accordance with the Administrative Procedures Act (Chapter 42-35 of the Rhode Island General Laws) you may request a hearing on this matter.

You are advised that if you have good reason to enter protests against the proposed work it is your privilege to do so. It is expected that objectors will review the application and plans thoroughly, visit site of proposed work if necessary, to familiarize themselves with the conditions and cite what law or laws, if any, would in their opinion be violated by the work proposed.

If you desire to protest, you must attend the scheduled hearing and give sworn testimony. A notice of the time and place of such hearing will be furnished you as soon as possible after receipt of your request for hearing. If you desire to request a hearing, to receive consideration, it should be in writing (**with your correct mailing address, e-mail address and valid contact number**) and be received at this office on or before March 21, 2022.

/lat

HONEYSUCKLE LANE

MAP 29
LOT 127A

EXISTING DWELLING

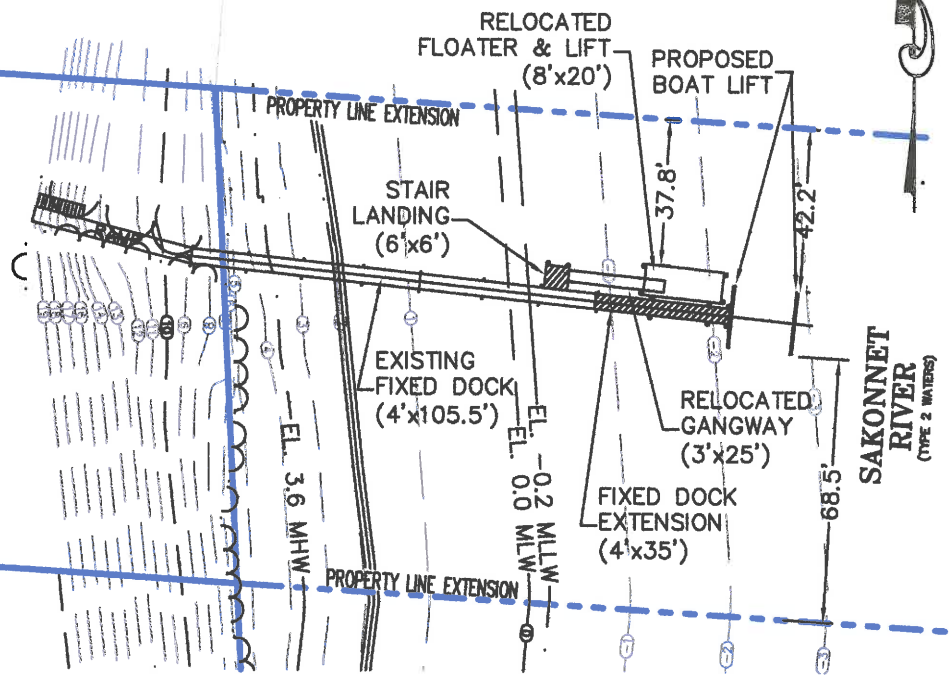

(IN FEET)
1 inch = 50 ft.

SHEET 5 OF 9

PURPOSE: CONSTRUCTION OF
A DOCK EXTENSION & BOAT LIFT

IN: SAKONNET RIVER, PORTSMOUTH
14 HONEYSUCKLE LANE

DATUM: MHW = 3.6
MLW = 0.0

DATE: 01/17/2022

REVISED:



PROPOSED PLAN VIEW

APPLICATION FOR:
SAMEH SAID
14 HONEYSUCKLE LANE
PORTSMOUTH, RI 02871
BY: MOUNT HOPE ENGINEERING, INC.
1788 G.A.R. HIGHWAY
SWANSEA, MA. 02777

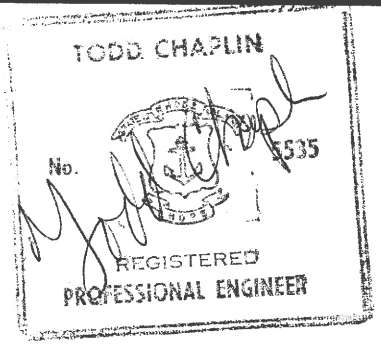

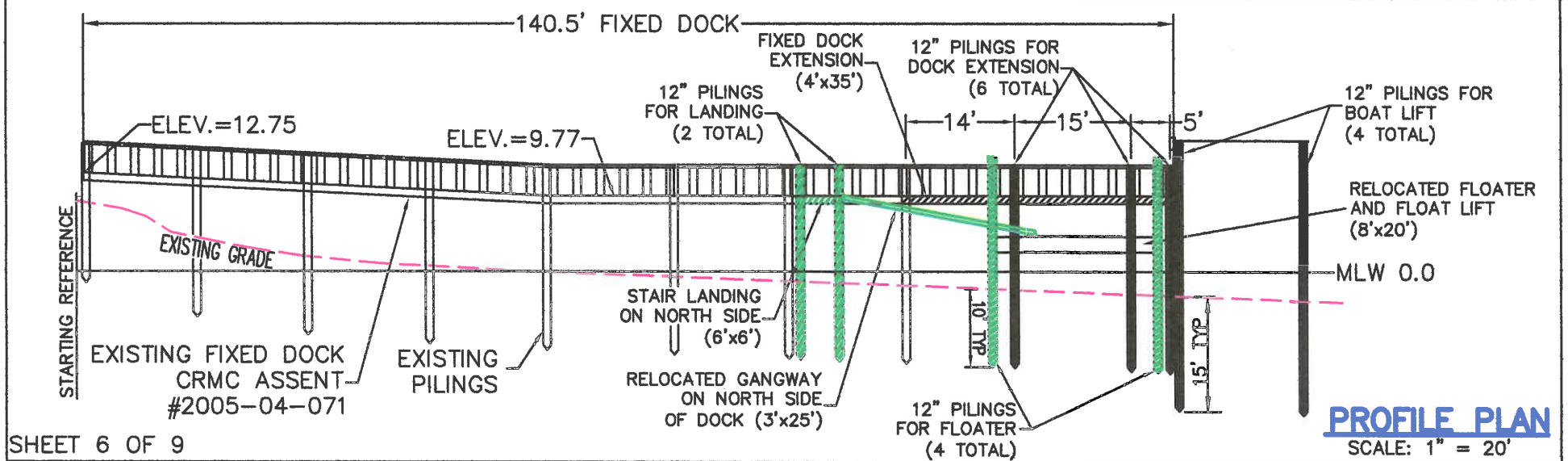
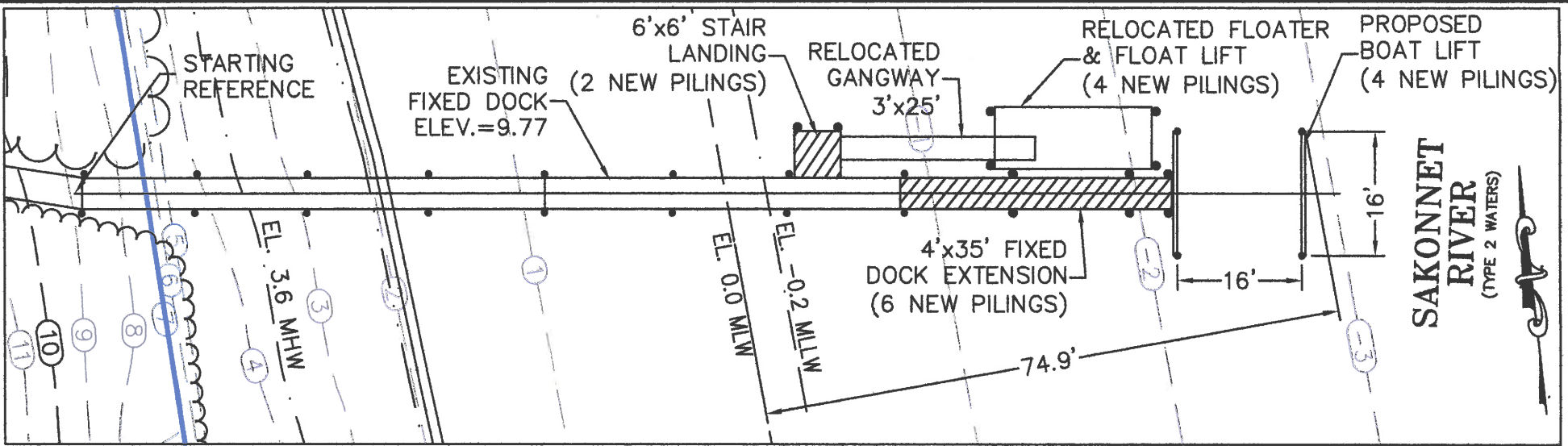

SHEET 6 OF 9

PURPOSE: CONSTRUCTION OF
a DOCK EXTENSION AND BOAT LIFT

IN: SAKONNET RIVER, PORTSMOUTH
14 HONEYSUCKLE LANE

DATUM: MHW = 3.6
MLW = 0.0

DATE: 01/17/2022
REVISED:

RECEIVED
FEB 02 2022
COASTAL RESOURCES
MANAGEMENT COUNCIL

DOCK PROFILE

APPLICATION FOR:
SAMEH SAID
14 HONEYSUCKLE LANE
PORTSMOUTH, RI 02871
BY: MOUNT HOPE ENGINEERING, INC.
1788 G.A.R. HIGHWAY
SWANSEA, MA. 02777

TODD CHAZIN
No. 5535
REGISTERED
PROFESSIONAL ENGINEER

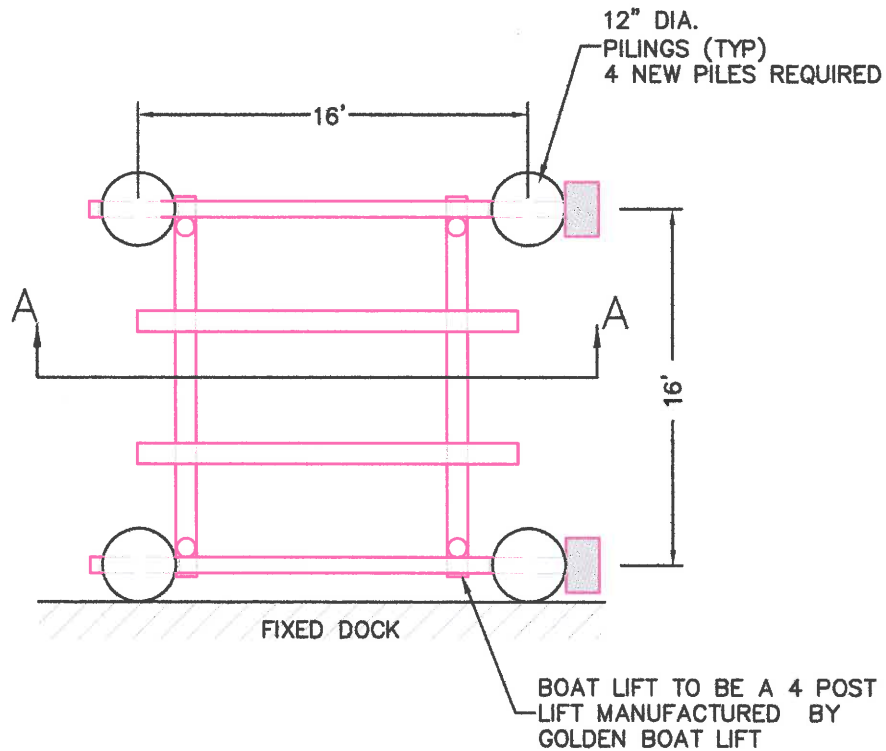

TOP VIEW
NOT TO SCALE

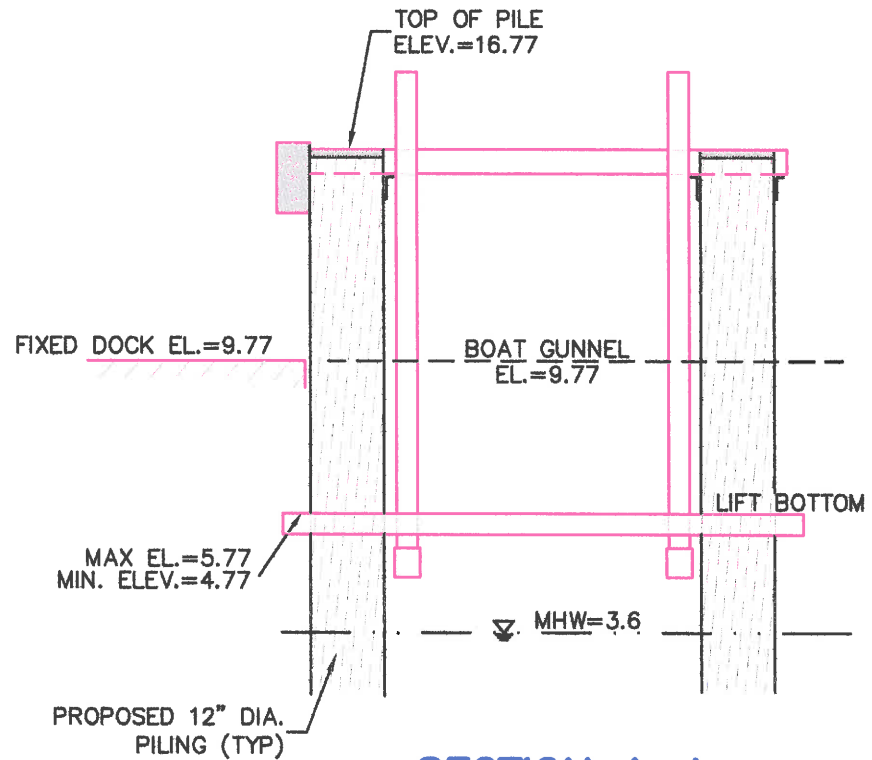

SECTION A-A
NOT TO SCALE

SHEET 7 OF 9

PURPOSE: CONSTRUCTION OF
A DOCK EXTENSION & BOAT LIFT

IN: SAKONNET RIVER, PORTSMOUTH
14 HONEYSUCKLE LANE

DATUM: MHW = 3.6
MLW = 0.0

DATE: 01/17/2022
REVISED:



BOAT LIFT DETAILS

APPLICATION FOR:
SAMEH SAID

14 HONEYSUCKLE LANE
PORTSMOUTH, RI 02871

BY: MOUNT HOPE ENGINEERING, INC.
1788 G.A.R. HIGHWAY
SWANSEA, MA. 02777

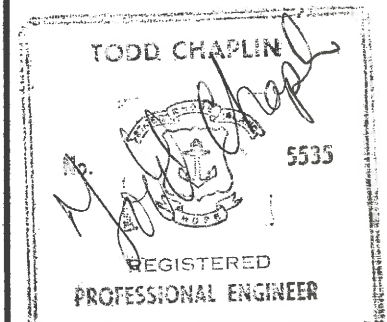

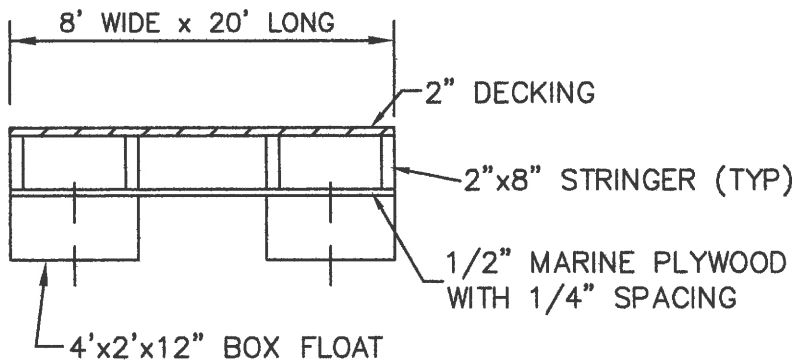

**EXISTING
TIMBER FLOAT SECTION**

NTS

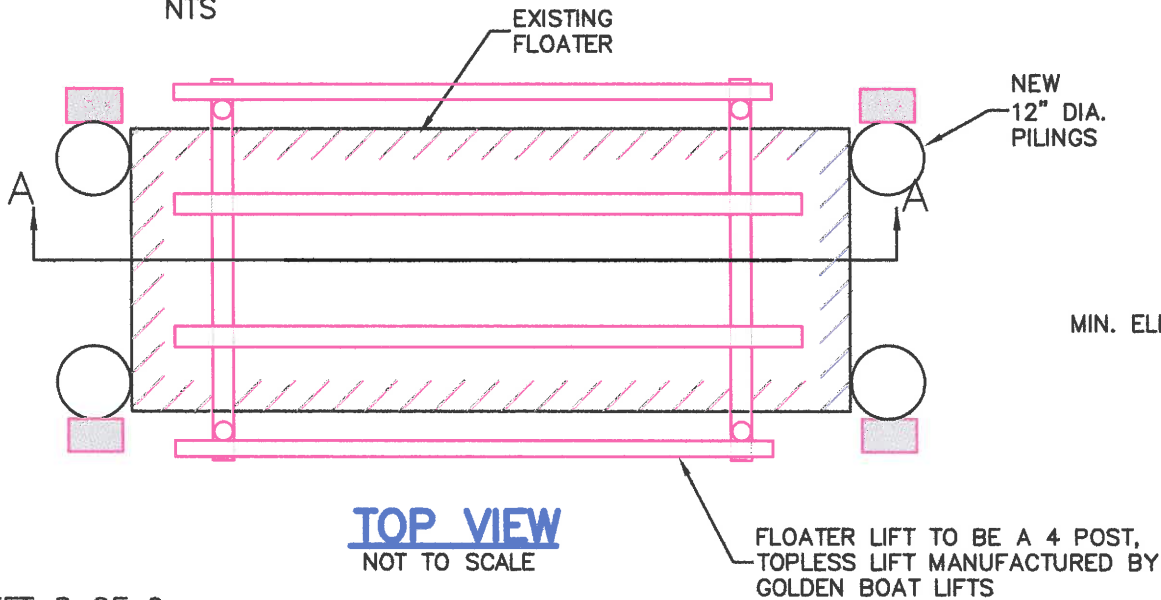

TOP VIEW

NOT TO SCALE

FLOATER LIFT TO BE A 4 POST,
TOPLESS LIFT MANUFACTURED BY
GOLDEN BOAT LIFTS

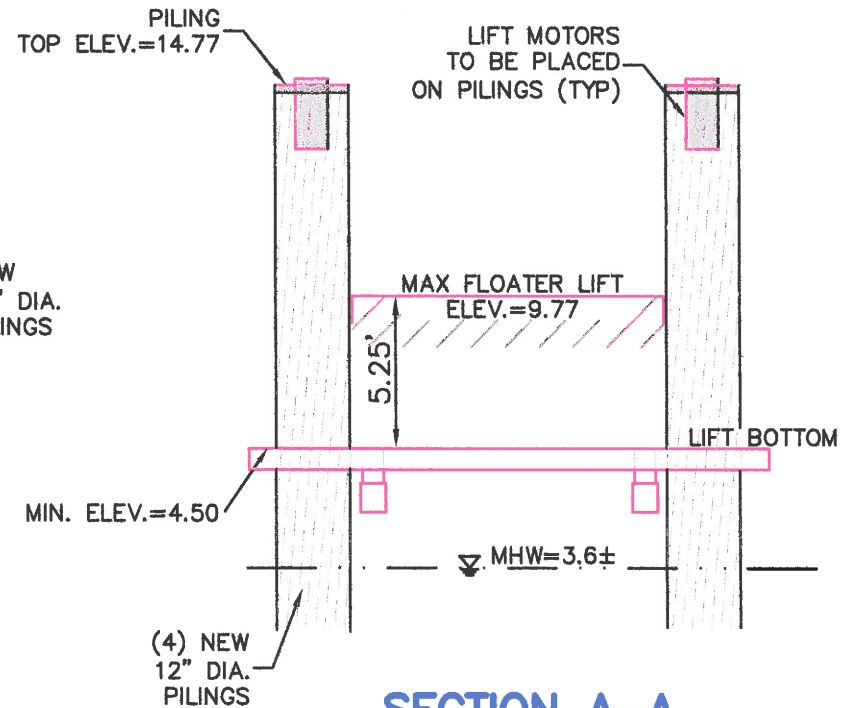

SECTION A-A

NOT TO SCALE

SHEET 8 OF 9

PURPOSE: CONSTRUCTION OF
A DOCK EXTENSION & BOAT LIFT

IN: SAKONNET RIVER, PORTSMOUTH
14 HONEYSUCKLE LANE

DATUM: MHW = 3.6
MLW = 0.0

DATE: 01/17/2022

REVISED:

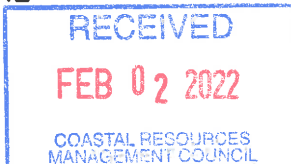

FLOATER LIFT DETAILS

APPLICATION FOR:

SAMEH SAID

14 HONEYSUCKLE LANE
PORTSMOUTH, RI 02871

BY: MOUNT HOPE ENGINEERING, INC.

1788 G.A.R. HIGHWAY
SWANSEA, MA. 02777

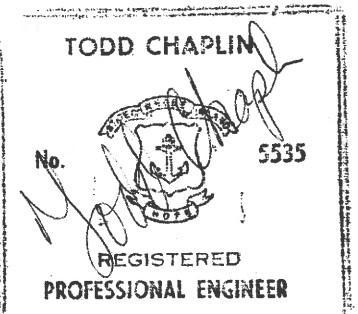

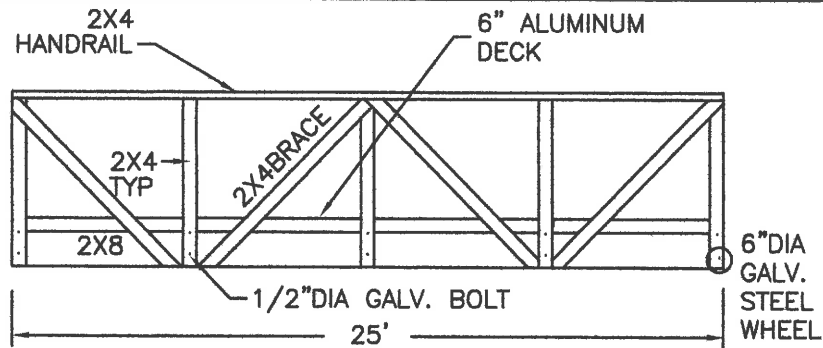

EXISTING LONGITUDINAL GANGWAY SECTION

NTS

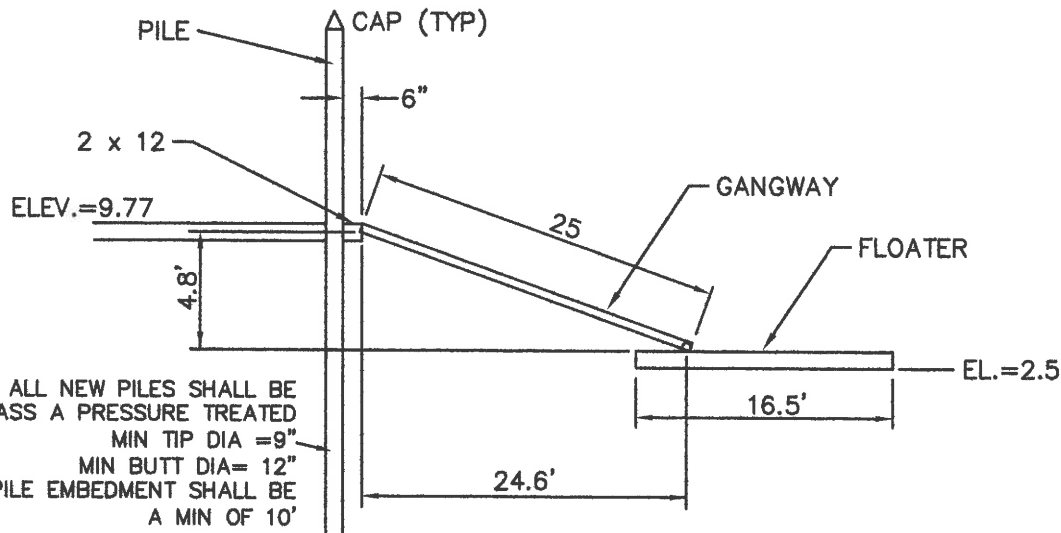

GANGWAY PROFILE

NTS

DESIGN LIVE LOAD = 40 PSF
OR 400# CONCENTRATED

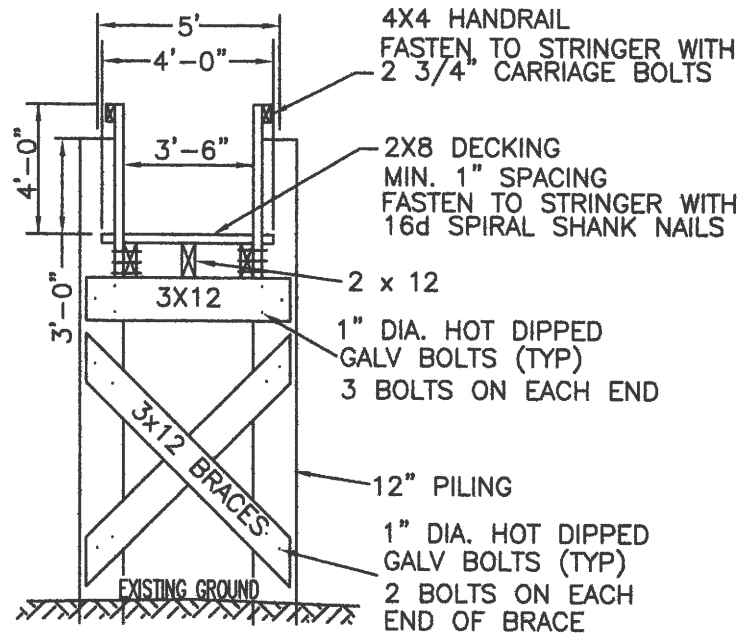

TYPICAL BENT SECTION

NTS

SHEET 9 OF 9

PURPOSE: CONSTRUCTION OF
A DOCK EXTENSION & BOAT LIFT

IN: SAKONNET RIVER, PORTSMOUTH
14 HONEYSUCKLE LANE

DATUM: MHW = 3.6
MLW = 0.0

DATE: 01/17/2022

REVISED:

RECEIVED

FEB 02 2022

COASTAL RESOURCES
MANAGEMENT COUNCIL

GANGWAY & DOCK DETAILS

APPLICATION FOR:

SAMEH SAID

14 HONEYSUCKLE LANE
PORTSMOUTH, RI 02871

BY: MOUNT HOPE ENGINEERING, INC.
1788 G.A.R. HIGHWAY
SWANSEA, MA. 02777

TODD CHAPLIN

No.

5535

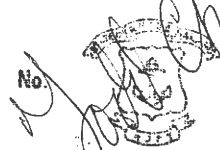

REGISTERED
PROFESSIONAL ENGINEER