



State of Rhode Island
Coastal Resources Management Council
Oliver H. Stedman Government Center
4808 Tower Hill Road, Suite 3
Wakefield, RI 02879-1900

(401) 783-3370
Fax (401) 783-2069

PUBLIC NOTICE

File Number: 2023-02-014 Date: March 14, 2023

This office has under consideration the application of:

Richard & Courtney Renault
40 Point Road
Portsmouth, RI 02871

for a State of Rhode Island Assent to construct and maintain: A residential Boating Facility consisting of a 4x67' fixed pier, 3x25' ramp and 8x18.75' float, extending to 50' beyond Mean Low Water (MLW). Total facility length 110 feet. Existing ramp and stairs will be removed.

Project Location:	40 Point Road
City/Town:	Portsmouth
Plat/Lot:	21 / 88
Waterway:	Bluebell Cove

Plans of the proposed work can be requested at Cstaff1@crmc.ri.gov.

In accordance with the Administrative Procedures Act (Chapter 42-35 of the Rhode Island General Laws) you may request a hearing on this matter.

You are advised that if you have good reason to enter protests against the proposed work it is your privilege to do so. It is expected that objectors will review the application and plans thoroughly, visit site of proposed work if necessary, to familiarize themselves with the conditions and cite what law or laws, if any, would in their opinion be violated by the work proposed.

If you desire to protest, you must attend the scheduled hearing and give sworn testimony. A notice of the time and place of such hearing will be furnished you as soon as possible after receipt of your request for hearing. If you desire to request a hearing, to receive consideration, it should be in writing (**with your correct mailing address, e-mail address and valid contact number**) and be received at this office on or before April 14, 2023.

Please email your comments/hearing requests to: cstaff1@crmc.ri.gov; or mail via USPS to: Coastal Resources Management Council; O. S. Government Center, 4808 Tower Hill Road, Rm 116; Wakefield, RI 02879.

/lat

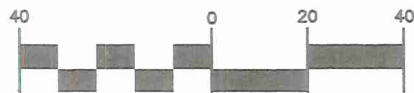
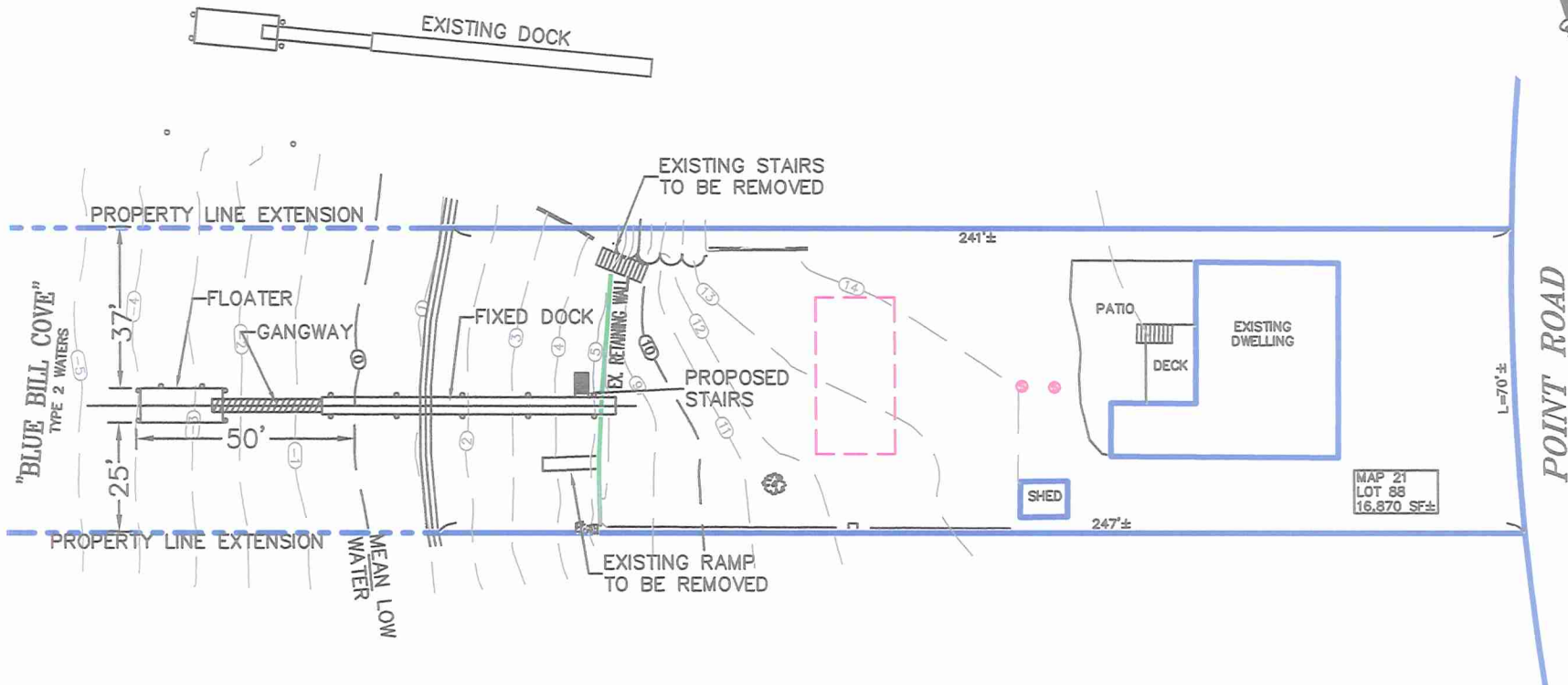

(IN FEET)
1 inch = 40 ft.

SHEET 4 OF 7

NOTES:

1. PROPERTY LINE INFORMATION TAKEN FROM AN ACTUAL PROPERTY LINE SURVEY.

PURPOSE: CONSTRUCTION OF
TIMBER DOCK, FLOAT, GANGWAY & PILES
IN: BLUE BILL COVE, PORTSMOUTH
40 POINT ROAD, PORTSMOUTH, RI

DATUM: MHW = 4.2
MLW = 0.0

1/16/23

PLAN VIEW

APPLICATION FOR:
RICHARD RENAULT
40 POINT ROAD
PORTSMOUTH, RI 02871

BY: MOUNT HOPE ENGINEERING, INC.
1788 G.A.R. HIGHWAY
SWANSEA, MA. 02777

TODD CHAPLIN



RECEIVED
2/1/2023
COASTAL RESOURCES
MANAGEMENT COUNCIL

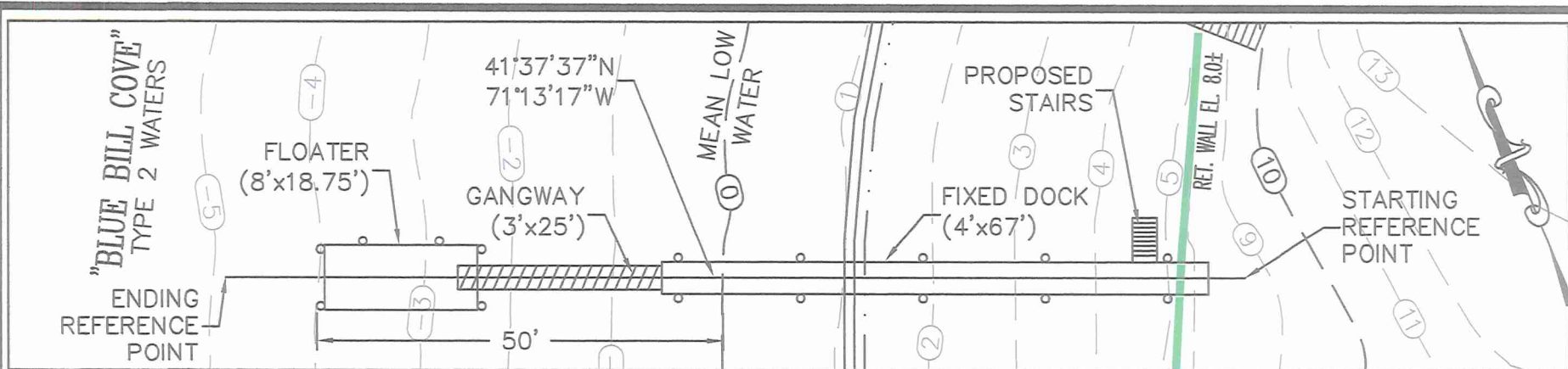

PLAN VIEW
SCALE: 1" = 20'

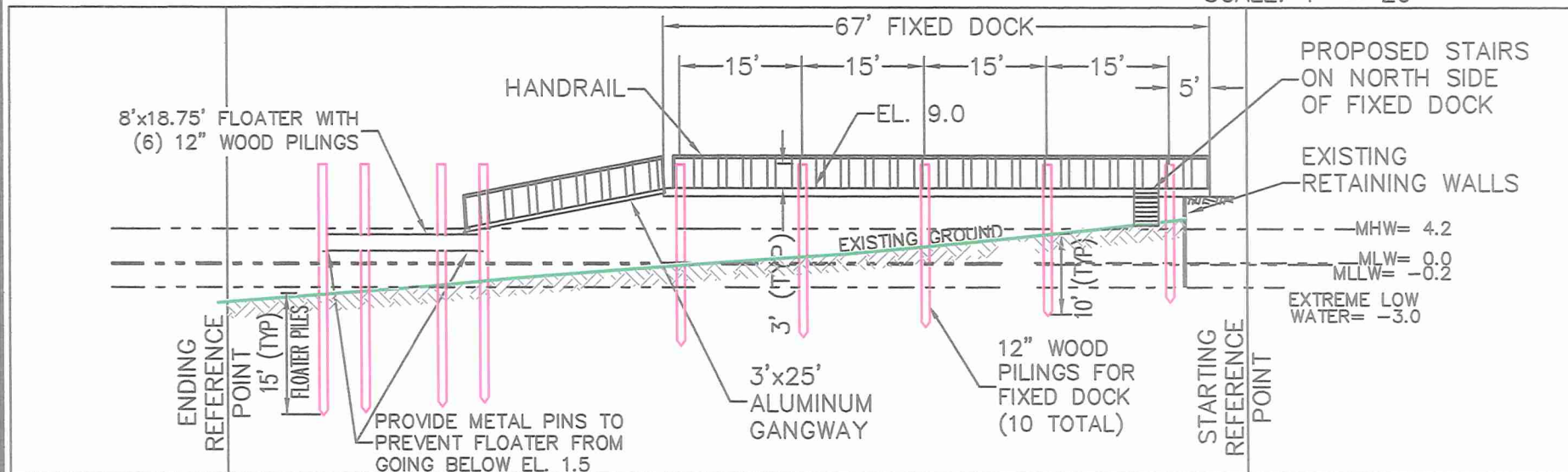

PROFILE VIEW
SCALE: 1" = 20'

SHEET 5 OF 7

PURPOSE: CONSTRUCTION OF
TIMBER DOCK, FLOAT, GANGWAY & PILES
IN: BLUE BILL COVE, PORTSMOUTH
40 POINT ROAD, PORTSMOUTH, RI

DATUM: MHW = 4.2
MLW = 0.0

DOCK PROFILE

APPLICATION FOR:
RICHARD RENAULT
40 POINT ROAD
PORTSMOUTH, RI 02871
BY: MOUNT HOPE ENGINEERING, INC.
1788 G.A.R. HIGHWAY
SWANSEA, MA. 02777

