

# WALKER FARM RECREATION AND RESILIENCE IMPROVEMENTS

513 COUNTY ROAD · BARRINGTON · RHODE ISLAND

FEBRUARY 23, 2021

PREPARED FOR  
**TOWN OF BARRINGTON**  
283 COUNTY ROAD  
BARRINGTON, RI 02806



PREPARED BY

**FUSS & O'NEILL**

317 IRON HORSE WAY, SUITE 204  
PROVIDENCE, RI 02908  
401.861.3070  
www.fando.com

## SHEET INDEX

SHEET No.	SHEET TITLE
GI-001	COVER SHEET
CN-001	GENERAL NOTES AND LEGEND
SU1	PARTIAL BOUNDARY AND TOPOGRAPHIC SURVEY
CP-101	SITE PREPARATION PLAN
CS-101	SITE PLAN
LP-101	LANDSCAPE PLAN
CD-501 - CD-503	DETAILS
S-001	VIEWING PLATFORM GENERAL NOTES AND TYPICAL DETAILS
S-100	VIEWING PLATFORM CONCEPT PLAN

## PROJECT TEAM

**SURVEYOR**  
WATERMAN ENGINEERING  
COMPANY  
46 SUTTON AVENUE  
EAST PROVIDENCE, RI



LOCATION MAP

SCALE: 1" = 800'

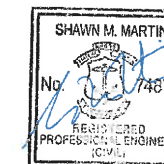

PROJ. No.: 20170585A20  
DATE: FEBRUARY 23, 2021

GI-001



**RECEIVED**  
**JULY 19, 2021**  
**COASTAL RESOURCES**  
**MANAGEMENT COUNCIL**

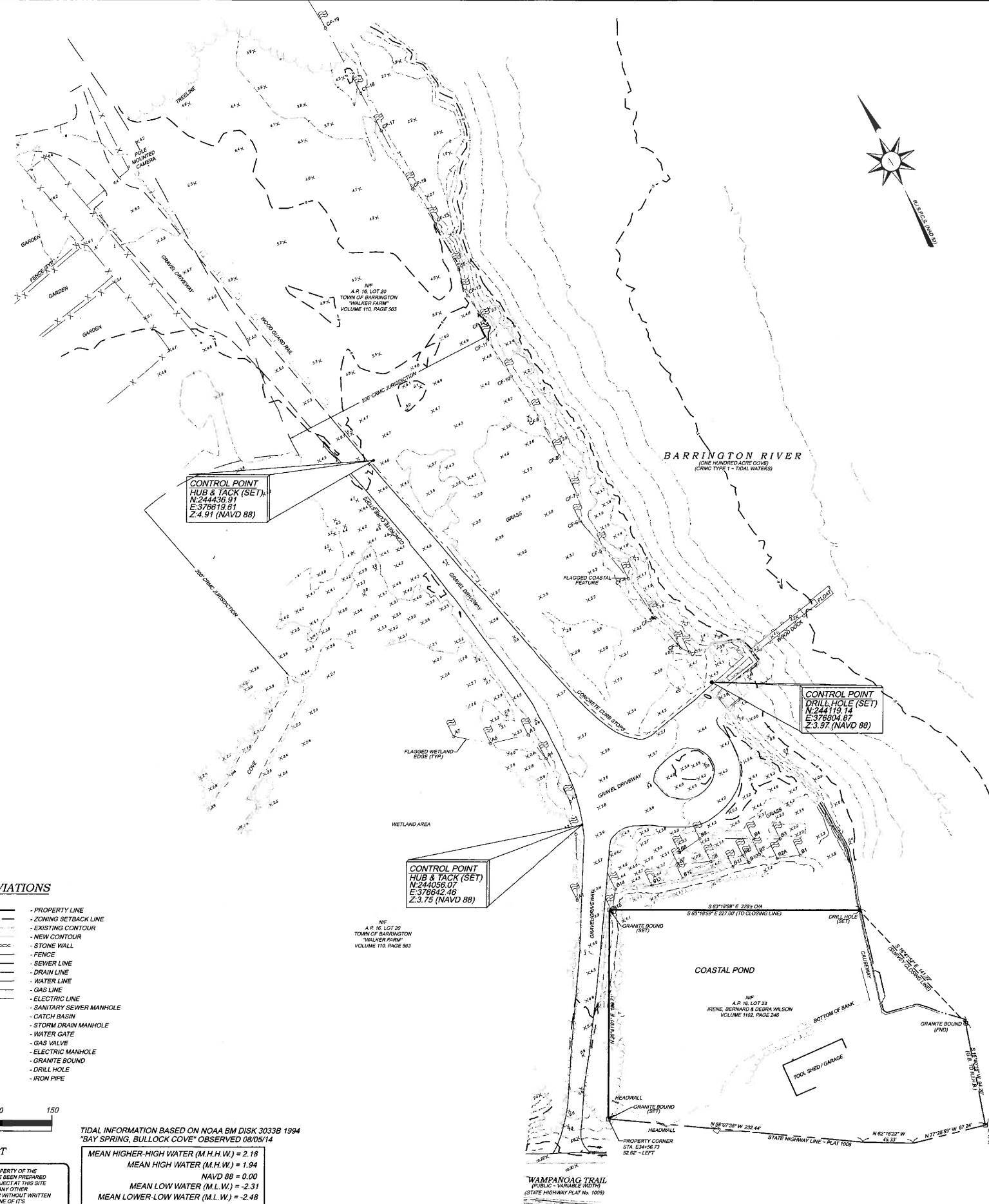
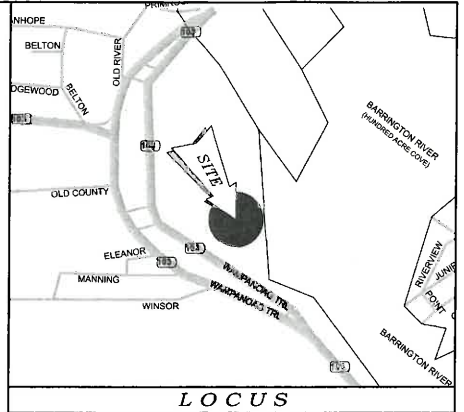

**NOTES / REFERENCES**

- REFERENCE IS MADE TO THE FOLLOWING MAPS AND PLANS OF RECORD:
  - R.I. HIGHWAY PLAT No. 1005, 2016 & 2016A.
  - PLAN ENTITLED "PLAN OF SURVEY FOR DONALD R. JONES IN BARRINGTON, R.I. BY E.V. STANLEY, ENGR., SCALE: 1"=20', MAY, 1955."
  - PLAN ENTITLED "PLAN SHOWING PORTION OF PROPERTY OF ALICE W. BATES ESTATE, BARRINGTON, R.I. BY E.V. STANLEY, ENGR., SCALE: 1"=20', JUNE, 1955."
- REFERENCE IS MADE TO THE FOLLOWING TOWN OF BARRINGTON LAND EVIDENCE RECORDS REGARDING RECORDED TITLE TO THE PREMISES SURVEYED:
  - A.P. 16, LOT 22 - TOWN OF BARRINGTON - VOLUME 110, PAGE 563
- THESE PREMISES MAY BE SUBJECT TO THE FOLLOWING EASEMENTS, RIGHTS OF WAY OR AGREEMENTS OF RECORD:
  - NONE FOUND RECORDED
- THESE PREMISES ARE SITUATED IN AN "OS-P ZONE":
 

**DIMENSIONAL REQUIREMENTS**

MIN. LOT AREA	= NA
MIN. FRONTAGE WIDTH	= 180 FT.
MIN. S/B FRONT YARD	= 50 FT.
MIN. S/B REAR YARD	= 30 FT.
MIN. S/B SIDE YARD	= 18 FT. OR 10% OF THE FRONTAGE (THE GREATER OF)
MAX. STRUCTURE HEIGHT	= 35 FT.
MAX. BUILDING LOT COVERAGE	= 10%

NOTE - ZONING INFORMATION IS FROM CURRENT ZONING AND MAY NOT REFLECT THE CONDITIONS AT THE TIME OF CONSTRUCTION OR ANY VARIANCES GRANTED.
- THESE PREMISES ARE SITUATED IN A ZONE "AE" (EL. 12) AS DESIGNATED ON THE "NATIONAL FLOOD INSURANCE PROGRAM, FIRM FLOOD INSURANCE RATE MAP BRISTOL COUNTY, RHODE ISLAND (ALL JURISDICTIONS) PANEL 2 OF 18 TOWN OF BARRINGTON MAP NUMBER 44001C002H EFFECTIVE DATE: JULY 7, 2014. FEDERAL EMERGENCY MANAGEMENT AGENCY."
- ANY UTILITIES SHOWN ON THIS PLAN HAVE BEEN LOCATED FROM FIELD SURVEY INFORMATION AND EXISTING PLANS. THE SURVEYOR MAKES NO GUARANTEE THAT THE UTILITIES SHOWN COMPRISE ALL SUCH OR ABANDONED. THE SURVEYOR DOES NOT WARRANT THAT THE UTILITIES SHOWN ARE IN THE EXACT LOCATION INDICATED ALTHOUGH THEY ARE LOCATED AS ACCURATELY AS POSSIBLE FROM ALL AVAILABLE INFORMATION. (PLEASE CONTACT DIG SAFE 72 HOURS PRIOR TO CONSTRUCTION AT PHONE NO. 1-888-DIG-SAFE AND/OR ALL LOCAL UTILITY COMPANIES.)
- THE HORIZONTAL DATUM FOR THIS PROJECT IS THE R.I.S.P.C.S. (NAD 83) AND THE VERTICAL DATUM FOR THIS PROJECT IS NAVD 88. THE PROJECT DATUMS WERE ESTABLISHED FROM DATA TRANSMITTED FROM MTS REFERENCE STATIONS USING THE MTS RTK NETWORK VIA CARLSON BRX GNSS ANTENNAS / RECEIVERS.
- PER THE TOWN OF BARRINGTON ZONING ORDINANCE, SECTION 186-32, NO BUILDING, STRUCTURE OR SIGN MAY BE LOCATED WITHIN 100 FEET OF ANY WETLAND, WATER BODY OR STREAM, OR WITHIN 200 FEET IN THE CASE OF FLOWING WATER BODIES IN EXCESS OF 10 FEET IN WIDTH AS PROVIDED BY THE STATE FRESHWATER WETLANDS ACT, EXCEPT BOAT SHEDS, PIERS AND SIMILAR STRUCTURES ACCESSORY TO A PERMITTED USE, OR DOCKS, FLOATS, MARINE RAILWAYS AND OTHER FACILITIES NORMALLY REQUIRING A LOCATION ON OR ADJACENT TO THE SHORE WITHIN THE WATERFRONT BUSINESS DISTRICT.
- COASTAL FEATURE AND WETLAND FLAGS DELINEATED BY NATURAL RESOURCE SERVICES, INC., P.O. BOX 311 HARRISVILLE, RI 02830 ON FEBRUARY 27, 2020 AND FIELD LOCATED BY WATERMAN ENGINEERING COMPANY ON MARCH 9, 2020.
- ANY AND ALL DISTURBANCE AND/OR CONSTRUCTION ON THE SUBJECT PROPERTY IS SUBJECT TO REVIEW AND PERMITTING BY THE CRMC, AS APPLICABLE.
- TOPOGRAPHY FROM AERIAL TOPOGRAPHIC MAPPING, SUPPLEMENTED WITH FIELD EDITS, AS FLOWN MARCH 8, 2020 AND ADDITIONAL TOPOGRAPHY AS FIELD SURVEYED APRIL 18, 2020. AERIAL GROUND CONTROL BY WATERMAN ENGINEERING COMPANY.
- TOPOGRAPHY WITHIN THE BARRINGTON RIVER BASED UPON SOUNDINGS TAKEN ON OCTOBER 6, 2020 USING A SEA-FLOOR SYSTEMS, INC. SONAR/TECH ECHO SOUNDER WITH CARLSON BRX GNSS ANTENNAS / RECEIVERS. THE TOPOGRAPHY SHOWN MAY NOT NECESSARILY REPRESENT ANY SOULERS, HOLES, DEBRIS, ETC. THAT COULD NOT BE OBSERVED DURING THE COURSE OF THE SURVEY. THE VERTICAL DATUM FOR THE SOUNDINGS SHOWN IS NAVD 88.

**LEGEND & ABBREVIATIONS**

- |                                |                          |
|--------------------------------|--------------------------|
| NF - NOW OR FORMERLY           | - PROPERTY LINE          |
| A.P. - ASSESSORS PLAT          | - ZONING SETBACK LINE    |
| S.F. - SQUARE FEET             | - EXISTING CONTOUR       |
| AC. - ACRES                    | - NEW CONTOUR            |
| + - PLUS OR MINUS              | - STONE WALL             |
| STY - STORY                    | - FENCE                  |
| WF - WOOD FRAMED               | - SEWER LINE             |
| SHP - STATE HIGHWAY PLAT       | - DRAIN LINE             |
| RET. - RETAINING WALL          | - WATER LINE             |
| PED. - PEDESTRIAN              | - GAS LINE               |
| (FND.) - FOUND                 | - ELECTRIC LINE          |
| RHB - RI HIGHWAY BOUND         | - SANITARY SEWER MANHOLE |
| PK NAIL - MASONRY NAIL         | - CATCH BASIN            |
| FE - FLARED END                | - STORM DRAIN MANHOLE    |
| RCP - REINFORCED CONCRETE PIPE | - WATER GATE             |
| CLF - CHAIN LINK FENCE         | - GAS VALVE              |
| INV. - INVERT                  | - ELECTRIC MANHOLE       |
| X 10.80 - EXISTING SPOT GRADE  | - GRANITE BOUND          |
| - NEW SPOT GRADE               | - DRILL HOLE             |
|                                | - IRON PIPE              |

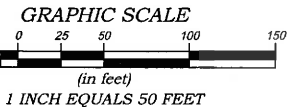

TIDAL INFORMATION BASED ON NOAA BM DISK 3033B 1994 "BAY SPRING, BULLOCK COVE" OBSERVED 08/05/14

MEAN HIGHER-HIGH WATER (M.H.W.) = 2.18
MEAN HIGH WATER (M.H.W.) = 1.94
NAVD 88 = 0.00
MEAN LOW WATER (M.L.W.) = -2.31
MEAN LOWER-LOW WATER (M.L.W.) = -2.48

**RICHARD S. LIPSITZ**  
 No. 1837  
 PROFESSIONAL  
 LAND SURVEYOR

\*\* SIGNATURES MUST BE IN BLUE INK TO CONSTITUTE AN ORIGINAL PLAN

**CERTIFICATION**

THIS SURVEY HAS BEEN CONDUCTED AND THE PLAN HAS BEEN PREPARED PURSUANT TO 435-RICR-04041-1 OF THE RULES AND REGULATIONS ADOPTED BY THE RHODE ISLAND STATE BOARD OF REGISTRATION FOR PROFESSIONAL LAND SURVEYORS ON APRIL 28, 2018, AS FOLLOWS:

TYPE OF BOUNDARY SURVEY: LIMITED CONTENT BOUNDARY SURVEY  
 MEASUREMENT/ACCURACY SPECIFICATION: 1 (LIMITED CONTENT AS SHOWN)

OTHER TYPE OF SURVEY: DATA ACCUMULATION  
 TOPOGRAPHIC SURVEY III T-3

THE PURPOSE FOR CONDUCTING THIS SURVEY AND FOR THE PREPARATION OF THE PLAN IS AS FOLLOWS:  
 LIMITED CONTENT BOUNDARY SURVEY & TOPOGRAPHIC SURVEY FOR THE FUTURE DEVELOPMENT OF THE SUBJECT PARCEL.

BY: *[Signature]* 1837 11/17/2020  
 RICHARD S. LIPSITZ, P.L.S. REG. NO.  
 WATERMAN ENGINEERING COMPANY (COA No. LS.0004483) DATE

NO.	DATE	REVISION	CHECKED BY
3	11/17/2020	ADDED TIDAL CONVERSION CHART	RSL
2	10/29/2020	ADDED SOUNDINGS & SOUTHERLY BOUNDARY LINE	RSL
1	4/22/2020	ADDITIONAL TOPOGRAPHY ADDED	RSL

**PARTIAL BOUNDARY & TOPOGRAPHIC SURVEY**  
 SCALE: 1" = 50'  
 DATE: 3/19/2020  
 DRAWN BY: MS/BJT  
 CHECKED BY: RSL  
 FILENAME: 20-024\_SUI\_REV  
 1 of 1 SHEETS  
 DRAWING # SU1

**FUSS & O'NEILL**  
 317 IRON HORSE WAY, SUITE 204  
 PROVIDENCE, RHODE ISLAND 02908

**Waterman ENGINEERING COMPANY**  
 Engineers & Surveyors - Est. 1891

46 Sutton Avenue  
 East Providence, RI  
 Phone: (401) 438-5775  
 Fax: (401) 438-5772  
 www.watermanengineering.com

COPYRIGHT © THESE DRAWINGS ARE THE PROPERTY OF THE ENGINEER/SURVEYOR AND HAVE BEEN PREPARED FOR THE OWNER FOR THIS PROJECT AT THIS SITE AND ARE NOT TO BE USED FOR ANY OTHER PURPOSE, LOCATION OR OWNER WITHOUT WRITTEN CONSENT OF THIS OWNER OR ONE OF ITS DIRECTORS.

File Path: J:\DWG\2017\0585A10\CP-101.dwg Layout: CP-101 Plotted: Thu, July 01, 2021 - 3:14 PM User: overa  
 LMS VIEW: Plotter: NONE CTB File: FO.STB  
 LAYER STATE:

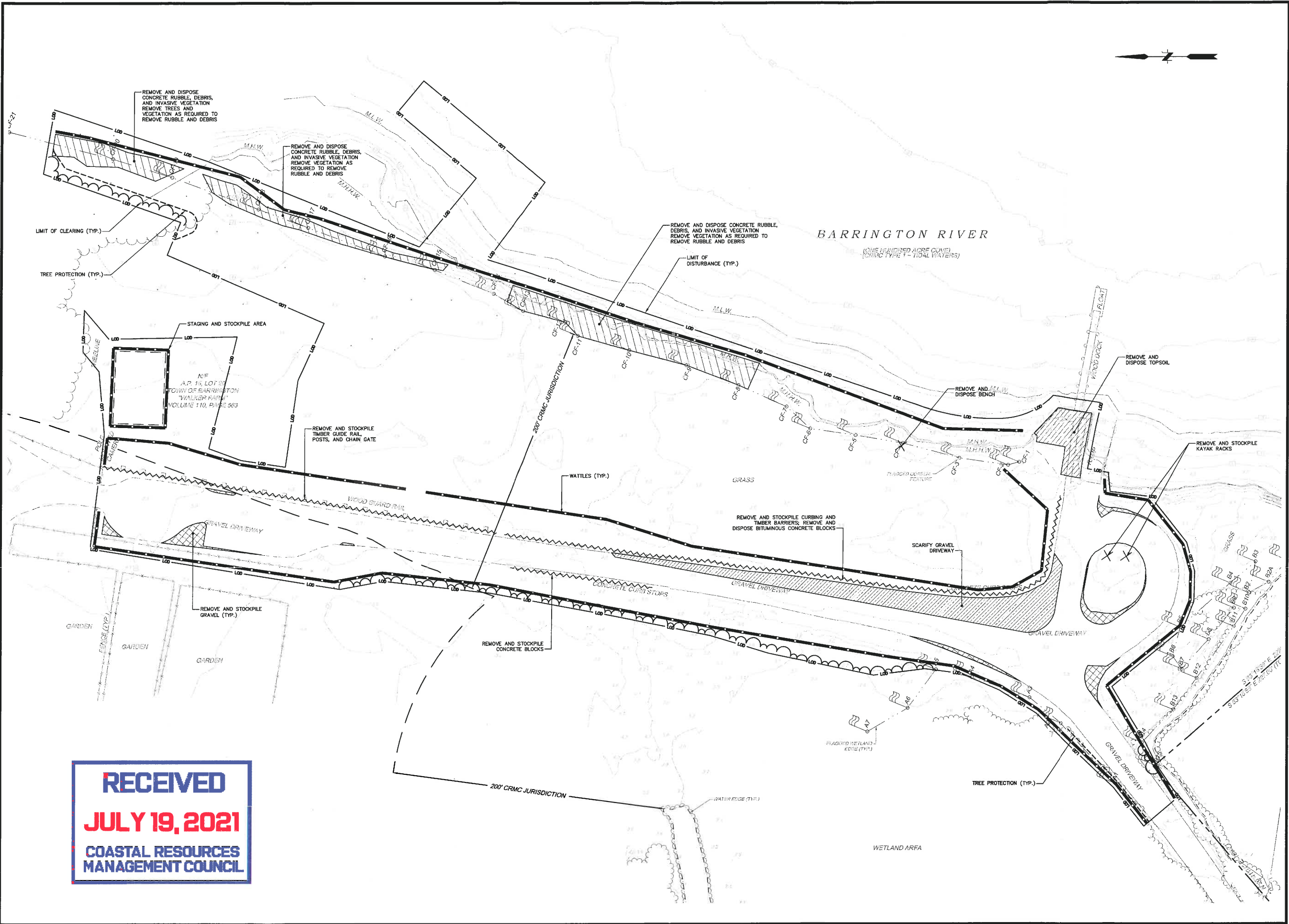

**RECEIVED**  
**JULY 19, 2021**  
 COASTAL RESOURCES  
 MANAGEMENT COUNCIL

DESIGNER	REVIEWER
CEV	SMW
DATE	7/1/2021
DESCRIPTION	ACCE PERMITTING
No.	1.
No.	2.
<p>SHAWN M. MARTIN          No. 7457          REGISTERED PROFESSIONAL ENGINEER</p>	
SCALE:	HORIZ.: 1" = 30'
	VERT.: 1" = 10'
DATUM:	NAD83
	VERT.: NAVD88
	30 15 0 30
	GRAPHIC SCALE
<p><b>FUSS &amp; O'NEILL</b>          317 IRON HORSE WAY, SUITE 204          PROVIDENCE, RI 02908          401.861.3070          www.fandoo.com</p>	
<p>TOWN OF BARRINGTON          SITE PREPARATION PLAN          WALKER FARM RECREATION AND          RESILIENCE IMPROVEMENTS          BARRINGTON, RHODE ISLAND          513 COUNTY ROAD</p>	
<p>PROJ. No.: 20170585A10          DATE: FEBRUARY 23, 2021</p>	
<p><b>CP-101</b></p>	

PARKING TABLE	
TRAILER SPACES	6
VEHICLE SPACES	53
ADA SPACES	3
OVERFLOW SPACES	10

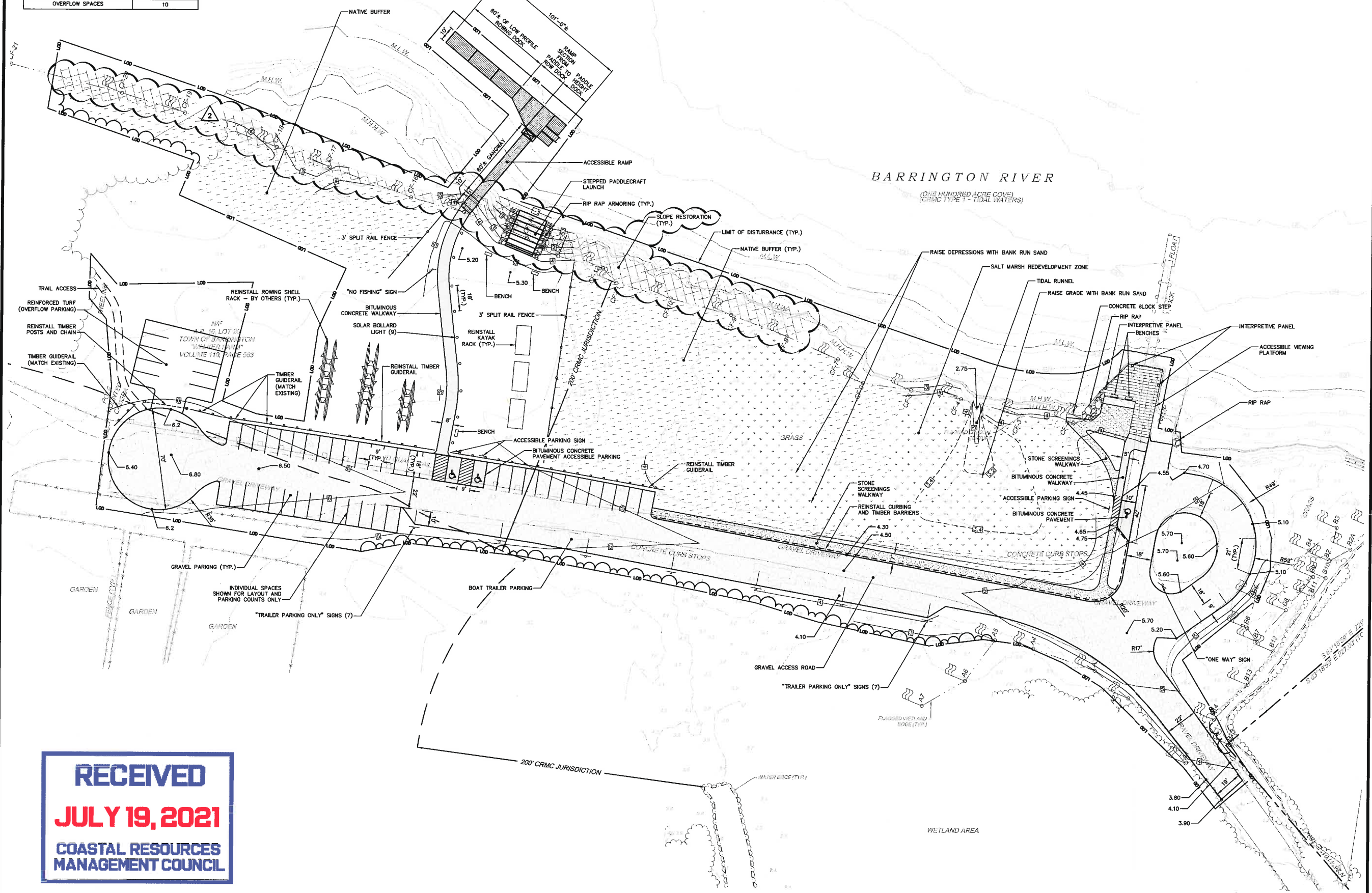

No.	DATE	DESCRIPTION	DESIGNER	REVIEWER
1.	6/17/2021	ACOE PERMITTING	CEV	SHM
2.	7/7/2021	RDEN RESPONSE TO COMMENTS	CEV	SHM

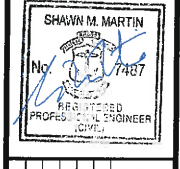

SCALE:	HORIZ.:	1" = 30'
	VERT.:	1" = 3'
	DATUM:	NA83
	HORIZ.:	NA83
	VERT.:	NAVD88
	GRAPHIC SCALE	

**FUSS & O'NEILL**  
 117 HOON HORSE WAY, SUITE 204  
 PROVIDENCE, RI 02908  
 401.861.3070  
 www.fuss.com

TOWN OF BARRINGTON  
 SITE PLAN  
 WALKER FARM RECREATION AND  
 RESILIENCE IMPROVEMENTS  
 BARRINGTON, RHODE ISLAND  
 513 COUNTY ROAD

PROJ. No: 20170585.A10  
 DATE: FEBRUARY 23, 2021

CS-101

File Path: I:\DWG\20170585\20170585\_020\_STP01.DWG Layout: CS-101 Plotted: Thu, July 01, 2021, 3:08 PM User: celera  
 Plotter: AUTOCAD PDF (GENERAL DOCUMENTATION).PC3 CTB File: FO STB  
 LAYER STATE:



**RECEIVED**  
**JULY 19, 2021**  
**COASTAL RESOURCES**  
**MANAGEMENT COUNCIL**

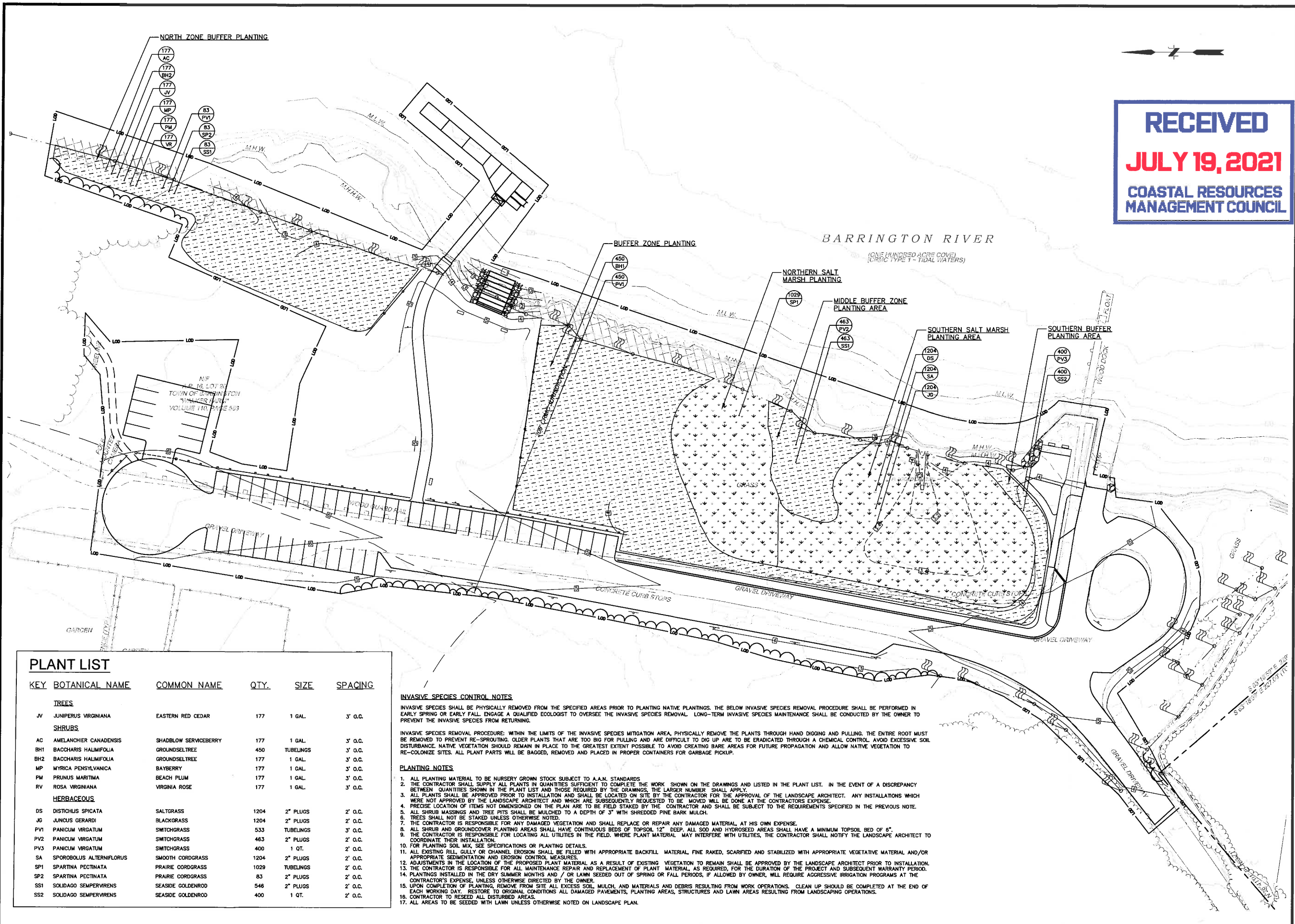

**PLANT LIST**

KEY	BOTANICAL NAME	COMMON NAME	QTY.	SIZE	SPACING
<b>TREES</b>					
JV	JUNIPERUS VIRGINIANA	EASTERN RED CEDAR	177	1 GAL.	3' O.C.
<b>SHRUBS</b>					
AC	AMELANCHIER CANADENSIS	SHADBLOW SERVICEBERRY	177	1 GAL.	3' O.C.
BH1	BACCHARIS HALIMIFOLIA	GROUNDSELTREE	450	TUBELINGS	3' O.C.
BH2	BACCHARIS HALIMIFOLIA	GROUNDSELTREE	177	1 GAL.	3' O.C.
MP	MYRICA PENNSYLVANICA	BAYBERRY	177	1 GAL.	3' O.C.
PM	PRUNUS MARIANA	BEACH PLUM	177	1 GAL.	3' O.C.
RV	ROSA VIRGINIANA	VIRGINIA ROSE	177	1 GAL.	3' O.C.
<b>HERBACEOUS</b>					
DS	DISTICHIS SPICATA	SALTGRASS	1204	2" PLUGS	2' O.C.
JG	JUNCOUS GERARDI	BLACKGRASS	1204	2" PLUGS	2' O.C.
PV1	PANICUM VIRGATUM	SWITCHGRASS	533	TUBELINGS	3' O.C.
PV2	PANICUM VIRGATUM	SWITCHGRASS	463	2" PLUGS	2' O.C.
PV3	PANICUM VIRGATUM	SWITCHGRASS	400	1 QT.	2' O.C.
SA	SPOROBOLUS ALTERNIFLORUS	SMOOTH CORDGRASS	1204	2" PLUGS	2' O.C.
SP1	SPARTINA PECTINATA	PRAIRIE CORDGRASS	1029	TUBELINGS	2' O.C.
SP2	SPARTINA PECTINATA	PRAIRIE CORDGRASS	83	2" PLUGS	2' O.C.
SS1	SOLIDAGO SEMPERVIRENS	SEASIDE GOLDENROD	546	2" PLUGS	2' O.C.
SS2	SOLIDAGO SEMPERVIRENS	SEASIDE GOLDENROD	400	1 QT.	2' O.C.

**INVASIVE SPECIES CONTROL NOTES**  
 INVASIVE SPECIES SHALL BE PHYSICALLY REMOVED FROM THE SPECIFIED AREAS PRIOR TO PLANTING NATIVE PLANTINGS. THE BELOW INVASIVE SPECIES REMOVAL PROCEDURE SHALL BE PERFORMED IN EARLY SPRING OR EARLY FALL. ENGAGE A QUALIFIED ECOLOGIST TO OVERSEE THE INVASIVE SPECIES REMOVAL. LONG-TERM INVASIVE SPECIES MAINTENANCE SHALL BE CONDUCTED BY THE OWNER TO PREVENT THE INVASIVE SPECIES FROM RETURNING.

**INVASIVE SPECIES REMOVAL PROCEDURE:** WITHIN THE LIMITS OF THE INVASIVE SPECIES MITIGATION AREA, PHYSICALLY REMOVE THE PLANTS THROUGH HAND DIGGING AND PULLING. THE ENTIRE ROOT MUST BE REMOVED TO PREVENT RE-SPROUTING. OLDER PLANTS THAT ARE TOO BIG FOR PULLING AND ARE DIFFICULT TO DIG UP ARE TO BE ERADICATED THROUGH A CHEMICAL CONTROL. AVOID EXCESSIVE SOIL DISTURBANCE. NATIVE VEGETATION SHOULD REMAIN IN PLACE TO THE GREATEST EXTENT POSSIBLE TO AVOID CREATING BARE AREAS FOR FUTURE PROPAGATION AND ALLOW NATIVE VEGETATION TO RE-COLOONIZE SITES. ALL PLANT PARTS WILL BE BAGGED, REMOVED AND PLACED IN PROPER CONTAINERS FOR GARBAGE PICKUP.

**PLANTING NOTES**  
 1. ALL PLANTING MATERIAL TO BE NURSERY GROWN STOCK SUBJECT TO A.A.N. STANDARDS.  
 2. THE CONTRACTOR SHALL SUPPLY ALL PLANTS IN QUANTITIES SUFFICIENT TO COMPLETE THE WORK SHOWN ON THE DRAWINGS AND LISTED IN THE PLANT LIST. IN THE EVENT OF A DISCREPANCY BETWEEN QUANTITIES SHOWN IN THE PLANT LIST AND THOSE REQUIRED BY THE DRAWINGS, THE LARGER NUMBER SHALL APPLY.  
 3. ALL PLANTS SHALL BE APPROVED PRIOR TO INSTALLATION AND SHALL BE LOCATED ON SITE BY THE CONTRACTOR FOR THE APPROVAL OF THE LANDSCAPE ARCHITECT. ANY INSTALLATIONS WHICH WERE NOT APPROVED BY THE LANDSCAPE ARCHITECT AND WHICH ARE SUBSEQUENTLY REQUESTED TO BE MOVED WILL BE DONE AT THE CONTRACTOR'S EXPENSE.  
 4. PRECISE LOCATION OF ITEMS NOT DIMENSIONED ON THE PLAN ARE TO BE FIELD STAKED BY THE CONTRACTOR AND SHALL BE SUBJECT TO THE REQUIREMENTS SPECIFIED IN THE PREVIOUS NOTE.  
 5. ALL SHRUB MASSINGS AND TREE PITS SHALL BE MULCHED TO A DEPTH OF 3" WITH SHREDDED PINE BARK MULCH.  
 6. TREES SHALL NOT BE STAKED UNLESS OTHERWISE NOTED.  
 7. THE CONTRACTOR IS RESPONSIBLE FOR ANY DAMAGED VEGETATION AND SHALL REPLACE OR REPAIR ANY DAMAGED MATERIAL, AT HIS OWN EXPENSE.  
 8. ALL SHRUB AND GROUNDCOVER PLANTING AREAS SHALL HAVE CONTINUOUS BEDS OF TOPSOIL 12" DEEP. ALL SOO AND HYDROSEED AREAS SHALL HAVE A MINIMUM TOPSOIL BED OF 6".  
 9. THE CONTRACTOR IS RESPONSIBLE FOR LOCATING ALL UTILITIES IN THE FIELD, WHERE PLANT MATERIAL MAY INTERFERE WITH UTILITIES, THE CONTRACTOR SHALL NOTIFY THE LANDSCAPE ARCHITECT TO COORDINATE THEIR INSTALLATION.  
 10. FOR PLANTING SOIL MIX, SEE SPECIFICATIONS OR PLANTING DETAILS.  
 11. ALL EXISTING RILL, GULLY OR CHANNEL EROSION SHALL BE FILLED WITH APPROPRIATE BACKFILL MATERIAL, FINE RAKED, SCARIFIED AND STABILIZED WITH APPROPRIATE VEGETATIVE MATERIAL AND/OR APPROPRIATE SEDIMENTATION AND EROSION CONTROL MEASURES.  
 12. ADJUSTMENTS IN THE LOCATION OF THE PROPOSED PLANT MATERIAL AS A RESULT OF EXISTING VEGETATION TO REMAIN SHALL BE APPROVED BY THE LANDSCAPE ARCHITECT PRIOR TO INSTALLATION.  
 13. THE CONTRACTOR IS RESPONSIBLE FOR ALL MAINTENANCE REPAIR AND REPLACEMENT OF PLANT MATERIAL, AS REQUIRED, FOR THE DURATION OF THE PROJECT AND SUBSEQUENT WARRANTY PERIOD.  
 14. PLANTINGS INSTALLED IN THE DRY SUMMER MONTHS AND / OR LAWN SEEDING OUT OF SPRING OR FALL PERIODS, IF ALLOWED BY OWNER, WILL REQUIRE AGGRESSIVE IRRIGATION PROGRAMS AT THE CONTRACTOR'S EXPENSE, UNLESS OTHERWISE DIRECTED BY THE OWNER.  
 15. UPON COMPLETION OF PLANTING, REMOVE FROM SITE ALL EXCESS SOIL, MULCH, AND MATERIALS AND DEBRIS RESULTING FROM WORK OPERATIONS. CLEAN UP SHOULD BE COMPLETED AT THE END OF EACH WORKING DAY. RESTORE TO ORIGINAL CONDITIONS ALL DAMAGED PAVEMENTS, PLANTING AREAS, STRUCTURES AND LAWN AREAS RESULTING FROM LANDSCAPING OPERATIONS.  
 16. CONTRACTOR TO RESEED ALL DISTURBED AREAS.  
 17. ALL AREAS TO BE SEEDDED WITH LAWN UNLESS OTHERWISE NOTED ON LANDSCAPE PLAN.

No.	DATE	DESCRIPTION	DESIGNER	REVIEWER
1.	6/17/2021	ACOE PERMITTING	CEY	SAM
2.	7/1/2021	RIEM RESPONSE TO COMMENTS	CEY	SAM



SCALE: HORIZ.: 1"=30'  
 VERT.: 1"=10'  
 DATUM: NAVD83  
 HORIZ.: NAVD83  
 VERT.: NAVD83  
 GRAPHIC SCALE

**FUSS & O'NEILL**  
 317 IRON HORSE WAY, SUITE 204  
 BARRINGTON, RI 02808  
 401.861.3070  
 www.fussandoneill.com

TOWN OF BARRINGTON  
**LANDSCAPE PLAN**  
 WALKER FARM RECREATION AND  
 RESILIENCE IMPROVEMENTS  
 BARRINGTON, RHODE ISLAND  
 513 COUNTY ROAD

PROJ. No.: 20170585.A10  
 DATE: FEBRUARY 23, 2021

**LP-101**

File Path: J:\DWG\2021\70585A10\Civil\2021\70585A10\_LAND1.dwg Layout: LP-101 Plotted: Thu, July 01, 2021 - 3:08 PM User: cvlerra  
 LAYER STATE: AUTOCAD PDF (GENERAL DOCUMENTATION).PC3 CTB File: FO.STB  
 PLOTTER:

File Path: I:\DWG\20170585\20170585\20170585.dwg Layout: CD-501 Plotter: AutoCAD PDF (General Documentation).pc3 CTB File: FO\_STB  
 User: cviera  
 Date: Thu, 7/1/2021 3:09 PM  
 Layer State:

**RECEIVED**  
**JULY 19, 2021**  
 COASTAL RESOURCES  
 MANAGEMENT COUNCIL

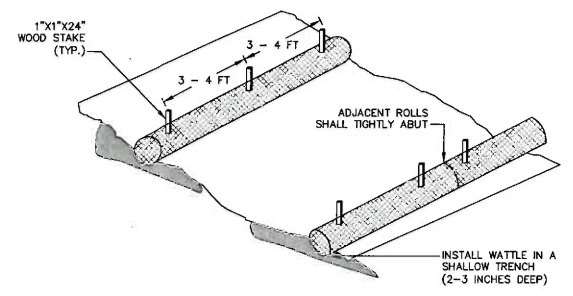

TYPICAL WATTLE INSTALLATION GUIDE

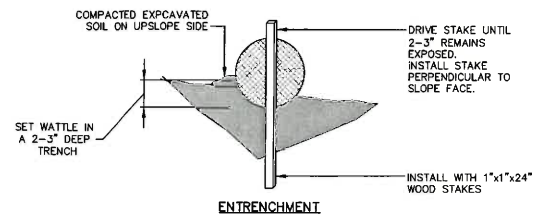

ENTRENCHMENT

- NOTES:
1. WATTLES SHALL BE INSTALLED AT LOCATIONS AS INDICATED ON THE DRAWINGS.
  2. WATTLES SHALL BE TRENCHED APPROXIMATE 2-3 INCHES AND STAKED SUCH THAT WATTLES DIRECTLY CONTACT SOIL AND PRECLUDE UNDERMINING OR BLOWOUTS. THE TRENCH SHALL BE APPROXIMATELY 9 INCHES WIDE. STAKES SHALL BE DRIVEN THROUGH THE CENTER OF THE WATTLE AT A SPACING OF 3-4 FEET ON CENTER AND NO GREATER THAN 6\"/>

**WATTLES**  
NOT TO SCALE

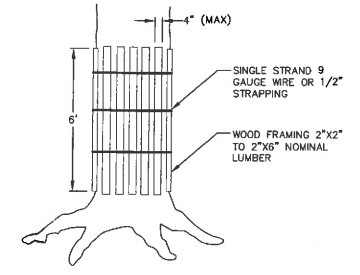

INDIVIDUAL TREE

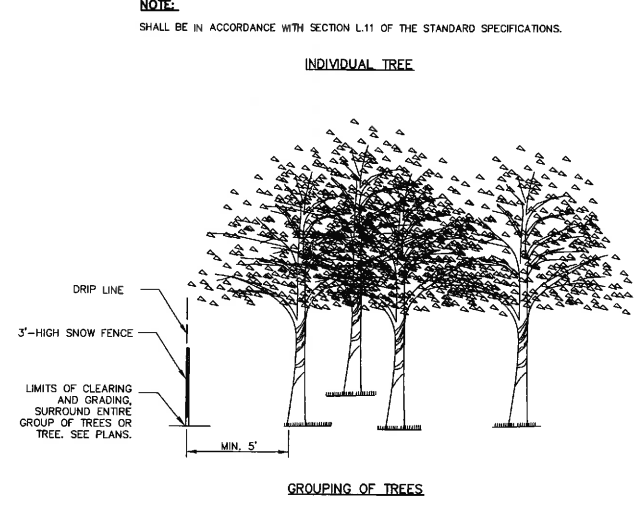

GROUPING OF TREES

**TREE PROTECTION**  
NOT TO SCALE

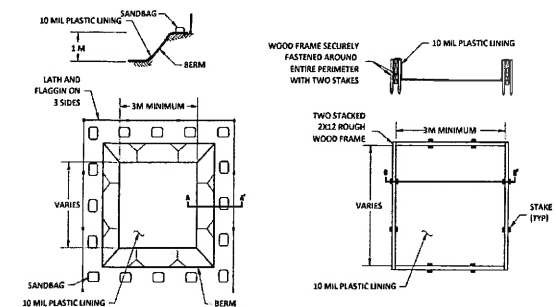

BASE NOT TO SCALE  
SECTION A - TYPE "BELOW GRADE" NOT TO SCALE  
BASE NOT TO SCALE  
SECTION B - TYPE "ABOVE GRADE" WITH WOOD PLANS NOT TO SCALE

- NOTES:
1. ACTUAL LAYOUT DETERMINED IN THE FIELD.
  2. FOR REFERENCE PURPOSES ONLY. NOT FOR CONSTRUCTION PURPOSES.
- REFERENCE:  
RHODE ISLAND SOIL EROSION AND SEDIMENT CONTROL HANDBOOK, ISSUED 1989 (REVISED 2014)

**TEMPORARY CONCRETE WASHOUT FACILITY**  
NOT TO SCALE

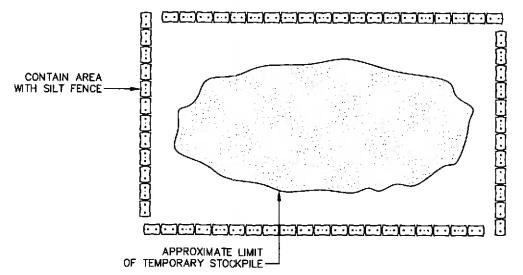

**TEMPORARY SOIL STOCKPILE**  
NOT TO SCALE

No.	DATE	REVISIONS TO COMMENTS	DESIGNER	REVIEWER
1.	6/17/2021	ACOE PERMITTING	CEV	SHM
2.	7/1/2021	RDEN RESPONSE TO COMMENTS	CEV	SHM

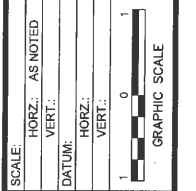
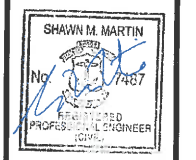

**FUSS & O'NEILL**  
 17 IRON HORSE WAY, SUITE 204  
 BARRINGTON, RI 02808  
 401.861.3070  
 www.fusdo.com

TOWN OF BARRINGTON  
**DETAILS**  
 WALKER FARM RECREATION AND  
 RESILIENCE IMPROVEMENTS  
 BARRINGTON, RHODE ISLAND  
 513 COUNTY ROAD

PROJ. No.: 20170585.A10  
 DATE: FEBRUARY 23, 2021

CD-501

File Path: J:\DWG\20170585A10\CD-502\Plotter: AutoCAD PDF (General Documentation).PC3 CTB File: TO STB  
 Plotter: AutoCAD PDF (General Documentation).PC3 CTB File: TO STB  
 User: celena

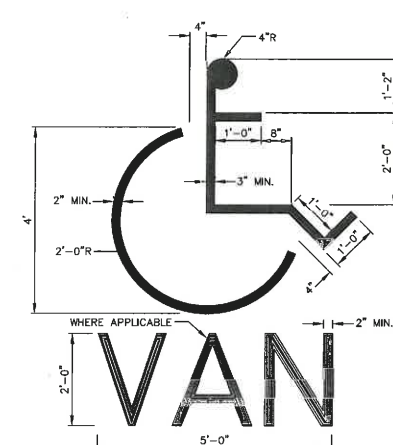

- NOTES:**
1. SYMBOL SHALL BE CENTERED IN THE PARKING STALL.
  2. SYMBOL SHALL BE SOLID WHITE FAST-DRYING WATERBORNE PAINT AND BE CENTERED IN THE PARKING STALL. FOR VAN ACCESSIBLE SPACES, THE WORD "VAN" SHALL BE PAINTED ADJACENT TO HANDICAPPED SYMBOL.

**ADA PARKING STALL SYMBOL**  
NOT TO SCALE

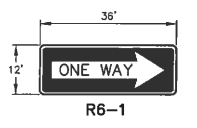

**"ONEWAY" SIGN**

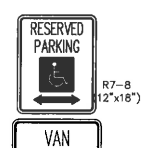

R7-8 (12"x18") - SEE SITE PLAN FOR LOCATIONS

**HANDICAP PARKING SIGN**

**SIGNS**  
NOT TO SCALE

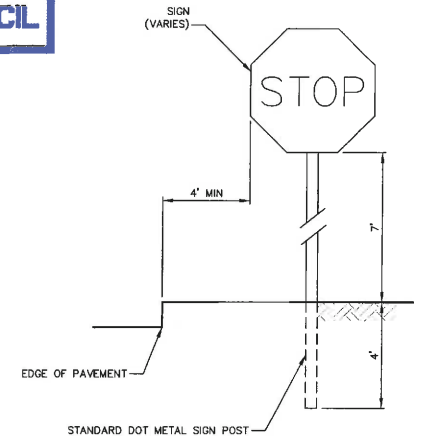

**SIGN POST**  
(R.I. STD. 24.2.0)  
NOT TO SCALE

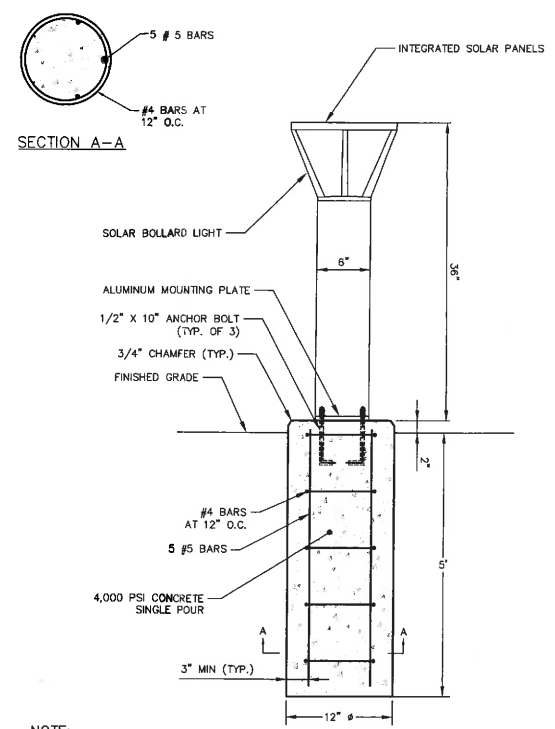

- NOTE:**
1. SOLAR BOLLARD LIGHT SHALL BE PLB-102 SOLAR POWERED LED BOLLARD WITH TYPE 3 PHOTOMETRICS AND BLACK POWDER COAT FINISH, MANUFACTURED BY FIRST LIGHT TECHNOLOGIES; OR APPROVED EQUAL.
  2. INSTALL PER MANUFACTURER'S INSTRUCTIONS.

**SOLAR BOLLARD LIGHT**  
NOT TO SCALE

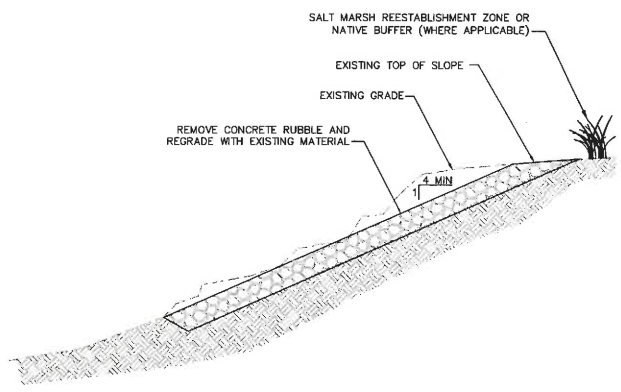

- NOTES:**
1. SEE SITE PLAN FOR PROPOSED ELEVATIONS. WHERE PROPOSED GRADES ARE NOT INDICATED, MATCH EXISTING ELEVATIONS.
  2. SUPPLEMENT WITH ADDITIONAL STONE AS REQUIRED TO MEET PROPOSED GRADES.

**SLOPE RESTORATION**  
NOT TO SCALE

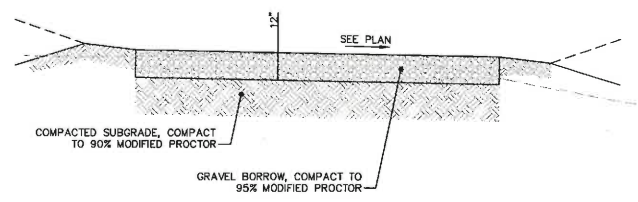

- NOTES:**
1. GRAVEL BORROW SHALL BE IN ACCORDANCE WITH SECTION M.01.09, TABLE 1, COLUMN 1 OF THE STANDARD SPECIFICATIONS.
  1. WHERE APPLICABLE, REMOVE EXISTING TOPSOIL AND SUBSOIL, GRADE, AND COMPACT SUBGRADE.
  2. WHERE EXISTING GRADE IS AT OR BELOW PROPOSED FINISHED GRADES, THE EXISTING GRAVEL BORROW SHALL REMAIN IN PLACE AND BE SUPPLEMENTED WITH ADDITIONAL GRAVEL BORROW TO MEET FINISHED GRADE.
  3. ROAD CROSS-SLOPE SHALL BE 2% AND SHALL MAINTAIN SHEET FLOW TO ADJACENT VEGETATED AREAS.

**GRAVEL ACCESS ROAD AND PARKING**  
NOT TO SCALE

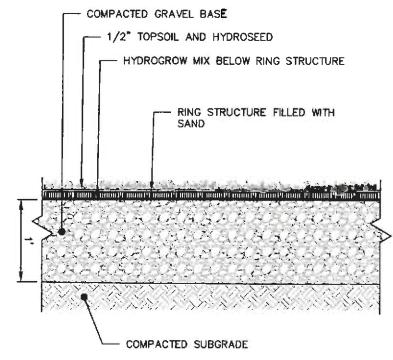

NOTE: RING STRUCTURE SHALL BE GRASSPAVE2 BY INVISIBLE STRUCTURES, OR APPROVED EQUAL.

**REINFORCED TURF**  
NOT TO SCALE

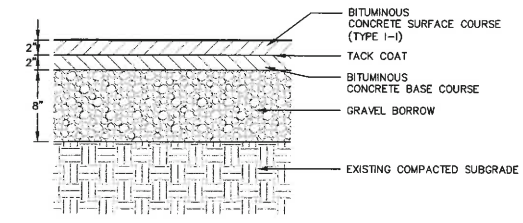

**BITUMINOUS CONCRETE PAVEMENT**  
NOT TO SCALE

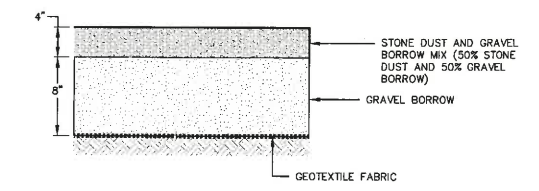

**STONE SCREENINGS WALKWAY**  
NOT TO SCALE

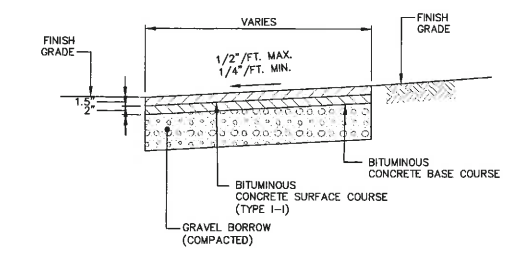

**BITUMINOUS CONCRETE SIDEWALK**  
NOT TO SCALE

NO.	DATE	DESCRIPTION	DESIGNER	REVIEWER
1.	7/7/2021	ISSUE RESPONSE TO COMMENTS	CEY	SAM
2.	8/17/2021	ACCE PERMITTING	CEY	SAM

SHAWN M. MARTIN  
No. 17457  
REGISTERED PROFESSIONAL ENGINEER  
STATE OF RHODE ISLAND

SCALE: AS NOTED  
HORIZ.: AS NOTED  
VERT.: AS NOTED  
DATE: 7/7/2021  
HORIZ.: 1" = 10'  
VERT.: 1" = 2'  
GRAPHIC SCALE

**FUSS & O'NEILL**  
311 BRON LICHSE WALK, SUITE 204  
PROVIDENCE, RI 02908  
401.861.3070  
www.fandob.com

TOWN OF BARRINGTON  
**DETAILS**  
WALKER FARM RECREATION AND  
RESILIENCE IMPROVEMENTS  
BARRINGTON, RHODE ISLAND  
513 COUNTRY ROAD

PROJ. No.: 20170585.A10  
DATE: FEBRUARY 23, 2021

**CD-502**



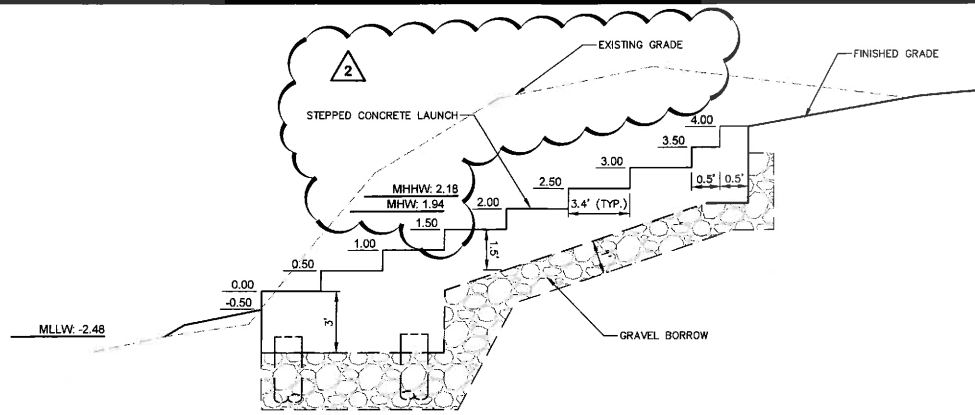

**STEPPED PADDLECRRAFT LAUNCH**  
NOT TO SCALE

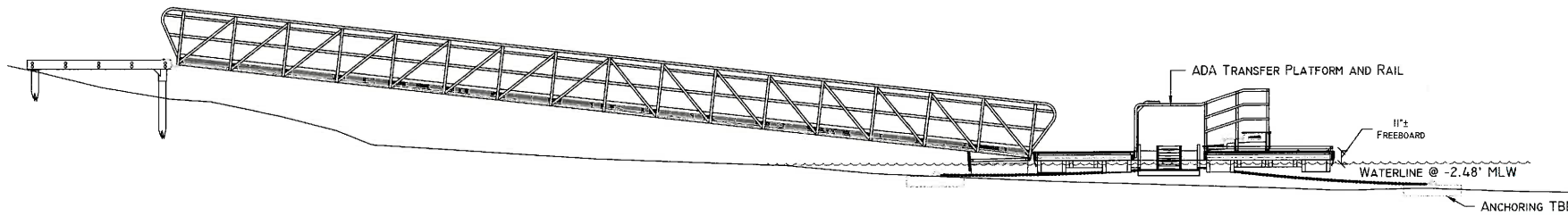

**LOW PROFILE FLOATING DOCK - ELEVATION**  
NOT TO SCALE

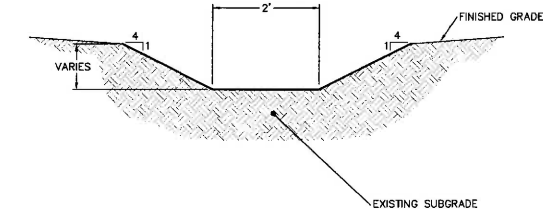

**TIDAL RUNNEL**  
NOT TO SCALE

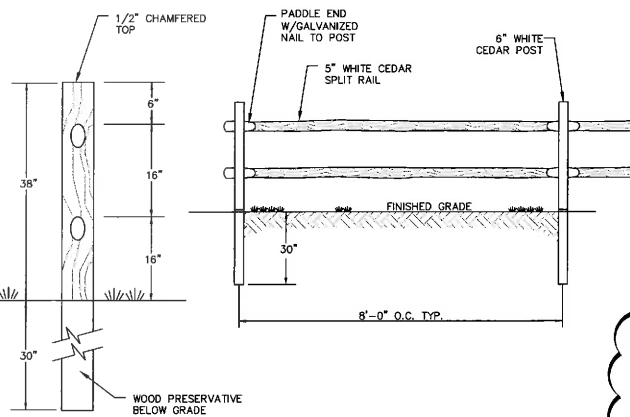

**SPLIT RAIL FENCE**  
SCALE: NOT TO SCALE

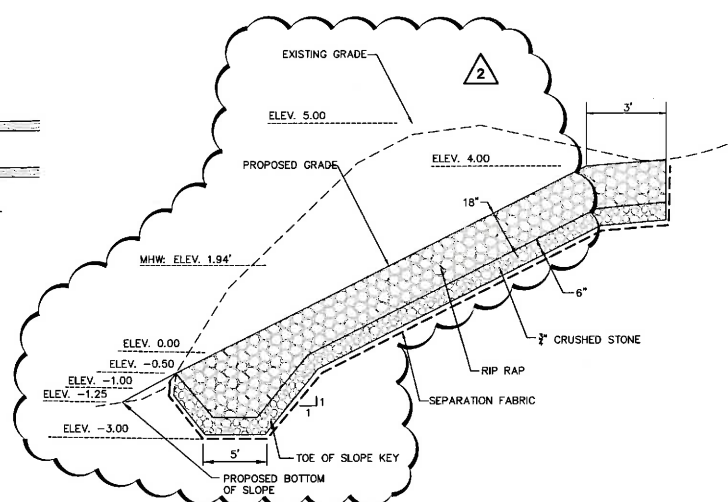

**RIP RAP ARMORING**  
NOT TO SCALE

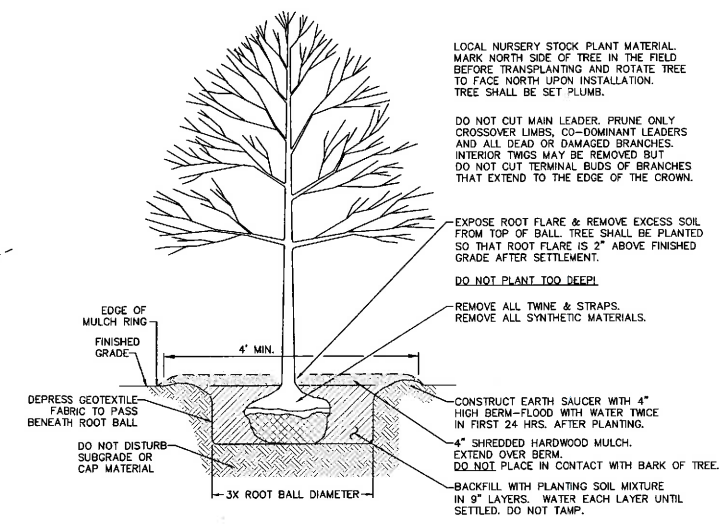

- NOTES**
1. STAKES & GUYS SHALL NOT BE USED.
  2. SPRAY WITH ANTIDESSICANT IN ACCORDANCE WITH MFG'S INSTRUCTIONS IF FOLIGAE IS PRESENT.

**TREE PLANTING**  
NOT TO SCALE

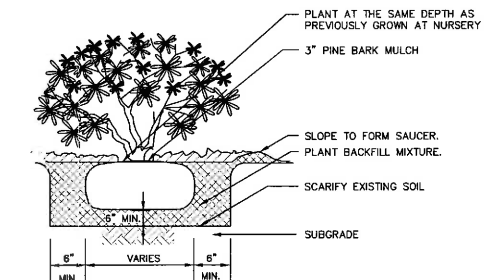

**SHRUB PLANTING**  
NOT TO SCALE

**RECEIVED**  
**JULY 19, 2021**  
**COASTAL RESOURCES**  
**MANAGEMENT COUNCIL**

No.	DATE	DESCRIPTION	DESIGNER	REVIEWER
1.	6/17/2021	ACCE PERMITTING	CEV	SMW
2.	7/1/2021	RIDEM RESPONSE TO COMMENTS	CEV	SMW



SCALE:	HORIZ.: AS NOTED
	VERT.: 1" = 0'
DATUM:	HORIZ.: 0
	VERT.: 0

**FUSS & O'NEILL**  
117 IRON HORSE WAY, SUITE 204  
PROVIDENCE, RI 02908  
401.861.3070  
www.fandoc.com



TOWN OF BARRINGTON  
**DETAILS**  
WALKER FARM RECREATION AND  
RESILIENCE IMPROVEMENTS  
BARRINGTON, RHODE ISLAND  
513 COUNTY ROAD

PROJ. No.: 20170585-A10  
DATE: FEBRUARY 23, 2021

**CD-503**

File Path: J:\DWG\2017\0585A10\CD-503.dwg Layer: CD-503 Plotted: Thu, July 01, 2021 - 3:09 PM User: cvalera  
PLOTTER: AUTOCAD PDF (GENERAL DOCUMENTATION).PC3 CTB File: FO.STB  
LAYER STATE: [MS VIEW]