

Amy Silva

From: Hannah Pfeiffer <hpfeiffer@millerscott.com>
Sent: Tuesday, May 07, 2019 11:28 AM
To: 'Amy Silva'
Cc: tscott@millerscott.com
Subject: FW: 7 Touisset Rd.
Attachments: CRMC File 2017-12-046 SK-1.pdf

Hi Amy,

Please see below the email I received from Ed Cabral, the Warren Harbormaster, regarding the moorings shown on the attached plan. You had asked about whether the plan showed either of the moorings belonging to the individuals who wrote letters of support for Mr. Barber's application. Mr. Cabral used Mr. Hall's coordinates to identify the moorings.

"MRG" on the plan is Mooring #217 (Belonging to Karl Senn)
"SPAR" on the plan is Mooring #351
"M11" on the plan is Mooring #111
"M91" on the plan is Mooring #91

If you need any further information, please just let me know.

Thank you,

Hannah

Hannah R. Pfeiffer
Miller Scott Holbrook & Jackson
122 Touro Street
Newport, RI 02840
hpfeiffer@millerscott.com
401-847-7500 Ext. 13

The preceding e-mail message (including any attachments) contains information that may be confidential, be protected by the attorney-client or other applicable privileges, or constitute non-public information. It is intended to be conveyed only to the designated recipient(s). If you are not an intended recipient of this message, please notify the sender by replying to this message and then delete it from your system. Use, dissemination, distribution, or reproduction of this message by unintended recipients is not authorized and may be unlawful.

From: Ed Cabral [<mailto:ECabral@TownOfWarren-RI.gov>]
Sent: Saturday, May 04, 2019 12:10 PM
To: Hannah Pfeiffer <hpfeiffer@millerscott.com>
Subject: RE: 7 Touisset Rd.

Hannah,

I went over the info you provided and based on proximity I believe the following mooring numbers are connected to Warren Hall's plan. Starting at the southern (bottom) location on his plan and moving north. Start at Mooring #91, the

next line north "MRG" I believe is Mooring #217, then north to "SPAR" which I believe is connected to Mooring #351, then north to the last location which Warren has listed as Mooring #11 but should actually be Mooring # 111. The positions and distances are close to these numbers provided so I believe these are the actual moorings in question. Please let me know if there is anything else you will need.

Sincerely,
Ed

Ed Cabral
Warren Harbormaster
514 Main St
Warren, RI 02885
401-245-6341
ecabral@townofwarren-ri.gov



Virus-free. www.avg.com

Amy Silva

From: Warren Hall <warrenhall@cox.net>
Sent: Wednesday, February 06, 2019 4:49 PM
To: Hannah Pfeiffer; Amy Silva
Cc: tscott@millerscott.com
Subject: RE: CRMC # 2017-12-046

Amy,

Spar = winter spar used to delineate something on bottom, not sure what it is in this case, water is less than 3' at location, I would assume the Mooring field is policed of miscellaneous objects, but, rather a question for PD, showed on plan as to be cautious

MRG = mooring, could not see lettering

M91=mooring ball with M91 painted on it

M11= mooring ball with M11 painted on it

Please let me know if you need any more info,

Thank You,

Warren

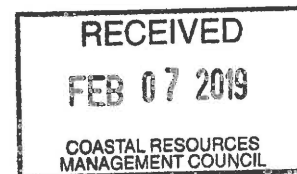

On February 6, 2019 at 11:30 AM Hannah Pfeiffer <hpfeiffer@millerscott.com> wrote:

Hi Amy,

I've copied Warren here. I've also reached out to the Harbor Commission for an update, but have not yet heard back. I will follow-up this week.

Warren, would you please provide a Amy with definitions of the plan notations listed below?

Thank you both,

Hannah



Scale 1" = 80'



RECEIVED
 FEB 07 2019
 COASTAL RESOURCES
 MANAGEMENT COUNCIL

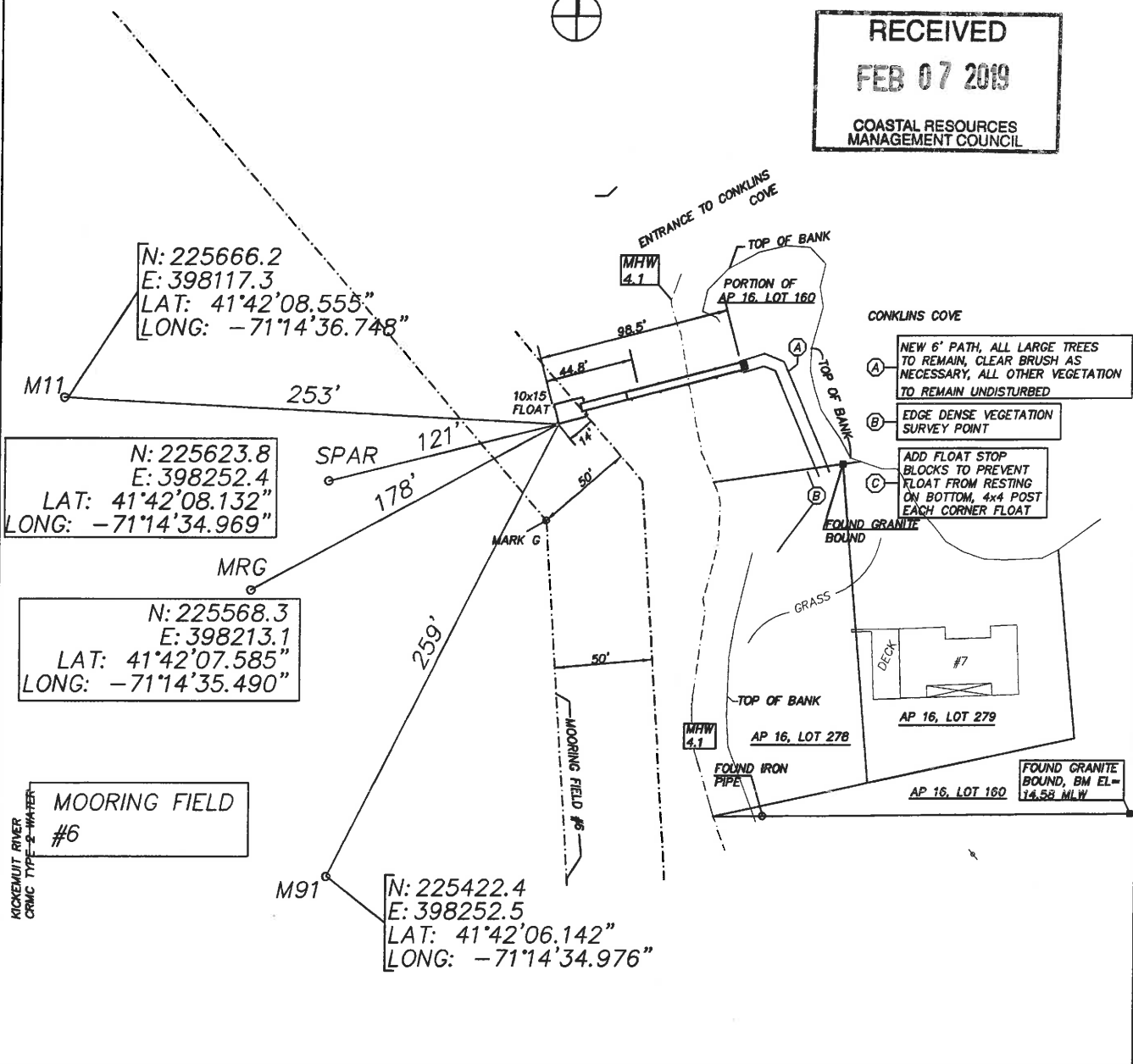

MOORING FIELD #6

KOCKENUT RIVER
 CRIMC TYPE 2 WATER

N: 225623.8
 E: 398252.4
 LAT: 41°42'08.132"
 LONG: -71°14'34.969"

N: 225666.2
 E: 398117.3
 LAT: 41°42'08.555"
 LONG: -71°14'36.748"

N: 225568.3
 E: 398213.1
 LAT: 41°42'07.585"
 LONG: -71°14'35.490"

N: 225422.4
 E: 398252.5
 LAT: 41°42'06.142"
 LONG: -71°14'34.976"

PROPOSED RESIDENTIAL PIER
 JAMES BARBER, 7 TOUISSET RD
 WARREN, RI
 AP 16, LOT 160
 BY: WARREN HALL, CIVIL ENGINEER
 1"=80' FEB. 6, 2017 SHEET 1 OF 1

SK → ↗

Amy Silva

From: tscott@millerscott.com
Sent: Thursday, December 06, 2018 6:44 AM
To: asilva@crmc.ri.gov
Cc: craigl@cox.net; jjbarber@alum.mit.edu; warrenhall@cox.net; hpfeiffer@millerscott.com
Subject: Application of James Barber CRMC 2017-12-046

Amy, Please accept this message as an update to the pending application of James Barber (CRMC 2017-12-046) for a residential dock in the Town of Warren. The Harbor Commission held a hearing last night on the application. The matter was contnued until 1/2/19. I will keep you up to date.

Turner C. Scott
Miller Scott Holbrook & Jackson
122 Touro Street
Newport, RI 02840
tscott@millerscott.com
401 847 7500 office
401 848 5854 fax
401 862 5003 cell

This email has been checked for viruses by AVG.
<https://www.avg.com>

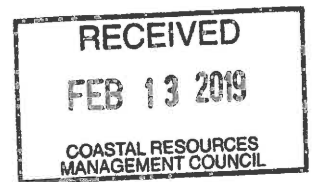

WARREN HARBOR COMMISSION

January 3, 2019

William J Hunt Jr
7 Beechwood Court
Warren, RI 02885
(f) 401-741-2255
(e) williamjhuntjr@yahoo.com

Coastal Resources Management Council
4808 Tower Hill Road, Suite 3
Wakefield, RI 02879-1900

To whom it may concern:

I am writing the Council regarding file number: 2017-12-046, the application of James Barber of 7 Touisset Road, Warren, RI 02885, for a State of Rhode Island Assent to construct and maintain: a Residential Boating Facility on Plat 16 Lot 160 in the Kickemuit River.

In accordance with the Administrative Procedures Act, I am following-up on my previous request from January 26, 2018 for a hearing on this matter on behalf of myself and my fellow members of the Town of Warren Harbor Commission.

At our December 5, 2018 meeting Mr. Barber, his legal counsel and engineers met with the Warren Harbor Management Commission (WHMC) to review the proposal received by the CRMC on December 13, 2017. Additional documentation was provided that has been submitted to CRMC by the applicant on August 22, 2018.

Mr. Barber appeared with legal counsel for a second time at the January 2, 2019 WHMC meeting seeking a decision from the Commission on the revised proposal. While the new information provided in the revised proposal did not cause the Commission to revise our September 6, 2017 motion to disapprove the application, the Commission did make a motion to submit this follow-up letter to the CRMC to better outline our objections and concerns.

Public access to our shoreline and the proliferation of residential docks remain significant general concerns to this Commission. These concerns are outlined in section 2.3 of our pending December 2017 revision to our Harbor Management Plan and demonstrated by our extensive work with the CRMC to identifying and ensure access to all existing rights of way in town.

The specific objection to Mr. Barber's application is the encroachment of the proposed dock into the established mooring field. The consensus of the WHMC is that any variance granted for new dock construction would create precedence for future development and exacerbate the above stated

concerns of the WHMC limiting this Commission's ability to properly manage our anchorages and moorings as outlined in § 46-4-6.16 of the General Laws of Rhode Island.

The WHMC remains opposed to application 2017-12-046 as originally submitted on December 13, 2017 or as revised on August 22, 2018.

My contact information is listed above. I am again requesting notification once a hearing has been scheduled so I can forward that information to the remaining members of the Warren Harbor Commission so we may formally express our concerns to the Council.

Sincerely,



William J Hunt Jr

Town of Warren Representative to the CRMC

Town of Warren Harbor Commission