



State of Rhode Island
Coastal Resources Management Council
Oliver H. Stedman Government Center
4808 Tower Hill Road, Suite 3
Wakefield, RI 02879-1900

(401) 783-3370
Fax (401) 783-2069

PUBLIC NOTICE

File Number: 2020-07-031 Date: August 6, 2020

This office has under consideration the application of:

Paul & Christine Grady
2 Shell Road
Warren, RI 02885

for a State of Rhode Island Assent to construct and maintain: a shared residential boating facility consisting of a 4ft x 121ft fixed pier, a 3ft x 30ft aluminum gangway, and a 10ft x 20ft terminal float. The facility is proposed to extend 108 ft past mean low water to achieve water depth of 2.5ft. This design requires a 58ft length variance to RICRMP Section 1.3.1(D)(11)(I)

| | |
|-------------------|------------------|
| Project Location: | 2 & 4 Shell Road |
| City/Town: | Warren |
| Plat/Lot: | 16 / 195,196 |
| Waterway: | Mount Hope Bay |

Plans of the proposed work may be seen at the CRMC office in Wakefield.

In accordance with the Administrative Procedures Act (Chapter 42-35 of the Rhode Island General Laws) you may request a hearing on this matter.

You are advised that if you have good reason to enter protests against the proposed work it is your privilege to do so. It is expected that objectors will review the application and plans thoroughly, visit site of proposed work if necessary, to familiarize themselves with the conditions and cite what law or laws, if any, would in their opinion be violated by the work proposed.

If you desire to protest, you must attend the scheduled hearing and give sworn testimony. A notice of the time and place of such hearing will be furnished you as soon as possible after receipt of your request for hearing. If you desire to request a hearing, to receive consideration, it should be in writing (**with your correct mailing address, e-mail address and valid contact number**) and be received at this office on or before September 6, 2020.

SITE PLAN NOTES:

1. PLAN INFORMATION PRESENTED HEREIN IS BASED ON THE SITE PLAN PREPARED BY SOUTH COUNTY SURVEY COMPANY TITLED "EXISTING CONDITIONS SITE PLAN INCLUDING TOPOGRAPHY & BATHYMETRY IN THE TOWN OF WARREN, RHODE ISLAND A.P. 16 LOTS 195 & 196 ~ 2 & 4 SHELL ROAD" DATED APRIL 3, 2020 AND CAN ONLY REFLECT THE CONDITIONS OF THE SITE AT THAT TIME.
2. NO PROPERTY SURVEY WAS CONDUCTED. THE PROPERTY LINE EXTENSIONS WERE APPROXIMATED BASED ON THE EXISTING FENCE LOCATIONS FOR EACH PROPERTY.
3. THE SURVEY VERTICAL DATUM REFERS TO MEAN LOWER LOW WATER (MLLW) DATUM, 2.4 FEET BELOW NORTH AMERICAN VERTICAL DATUM 1988 (NAVDB88).
4. BATHYMETRIC CONTOURS ARE NEGATIVE UNLESS DENOTED WITH A PLUS (+).



MOUNT HOPE BAY
RICRMC TYPE 2

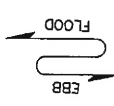

FEMA VE_ZONE
EL+22.0 NAVDB88
EL+24.2 MLLW

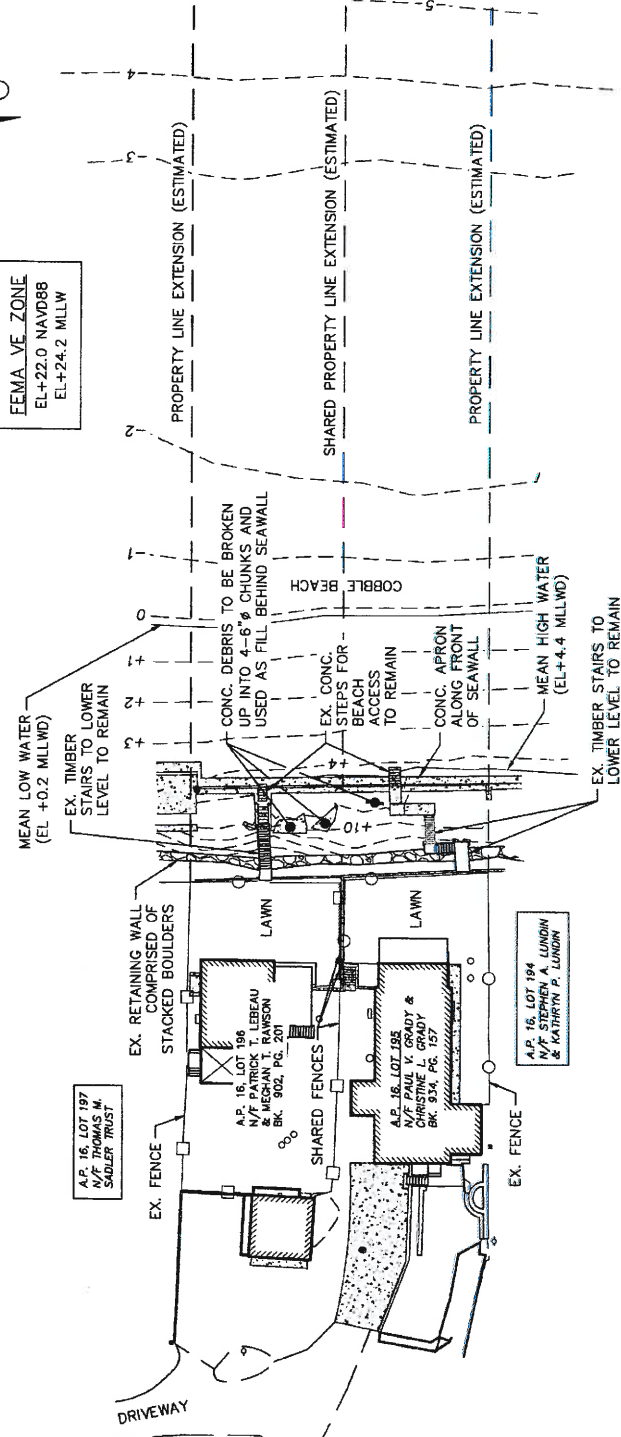

EXISTING CONDITIONS

HARBOR ENGINEERING, LLC
26 BOSWORTH STREET
BARRINGTON, RI 02806
(401) 829-4870
harboreng.com

| No. | Revision | Date | App. |
|-----|----------|------|------|
| | | | |
| | | | |
| | | | |
| | | | |



Client/Owner: PAUL & CHRISTINE GRADY
2 SHELL ROAD
WARREN, RI 02885
PATRICK LEBEAU & MEGHAN RAWSON
4 SHELL ROAD
WARREN, RI 02885

Issued for: REGULATORY REVIEW & CONSTRUCTION

Drawing Title: SHARED RESIDENTIAL DOCK
EXISTING SITE PLAN
MLLWD

Date: 5/26/2020
Scale: 1"=40FT
Designed By: AJ/KMNG
Drawn by: AAK
Checked by: [Signature]
Project Number: 2021003
Sheet: 2 of 7
Drawing Number: EXB1
JUL 08 2020
AUGUST J. KREUTKAMP, III
REGISTERED PROFESSIONAL ENGINEER
CIVIL 6/5/90



HARBOR ENGINEERING, LLC
 26 BOSWORTH STREET
 BARRINGTON, RI 02806
 (401) 829-4870
 harboreng.com

| No. | Revision | Date | App. |
|-----|----------|------|------|
| | | | |
| | | | |
| | | | |
| | | | |
| | | | |
| | | | |
| | | | |
| | | | |
| | | | |
| | | | |

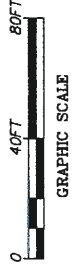

Client/Owner: **PAUL & CHRISTINE GRADY**
 2 SHELL ROAD
 WARREN, RI 02885

PATRICK LEBEAU & MEGHAN RAWSON
 4 SHELL ROAD
 WARREN, RI 02885

Issued for: **REGULATORY REVIEW & CONSTRUCTION**

Drawing Title: **SHARED RESIDENTIAL DOCK PROPOSED SITE PLAN**
 MILLWD

Date: 5/28/2020
 Scale: 1"=40FT

Designed By: AJK
 Drawn by: [Signature]
 Checked by: [Signature]
 Project Number: 2020-033

Sheet 3 of 7
 Drawing Number: 111
 Project: PR1

AUGUST J. KREUZKAMP III
 No. 7949
 REGISTERED PROFESSIONAL ENGINEER
 CIVIL 6/5/90

MOUNT HOPE BAY
 RICRMC TYPE 2

FLOOD
 FBR

FEMA VE_ZONE
 EL+22.0 NAVD88
 EL+24.2 MLLW

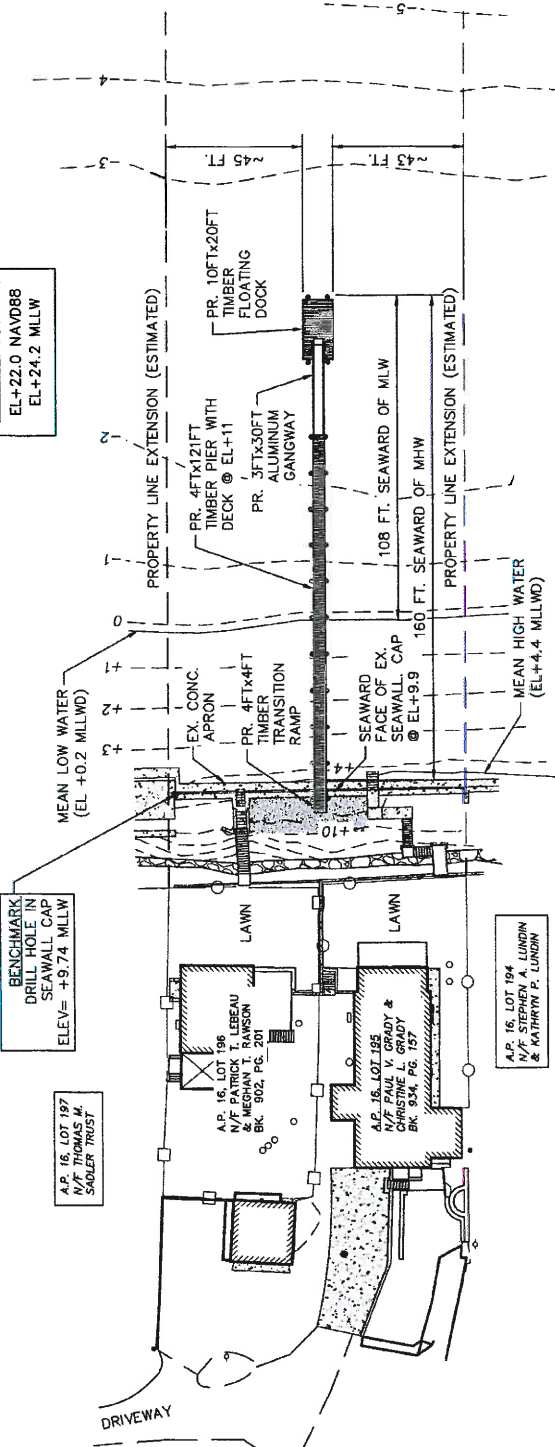

PROPOSED CONDITIONS

NOTES:
 1. FOR SITE PLAN INFORMATION, SEE SHEET EX-1.



HARBOR ENGINEERING, LLC
 26 BOSWORTH STREET
 BARRINGTON, RI 02806
 (401) 829-4870
 harboreng.com

| No. | Revision | Date | App. |
|-----|----------|------|------|
| | | | |
| | | | |
| | | | |
| | | | |
| | | | |



Client/Owner: **PAUL & CHRISTINE GRADY**
 2 SHELL ROAD
 WARREN, RI 02885

PATRICK LEBEAU & MEGHAN RAWSON
 4 SHELL ROAD
 WARREN, RI 02885

Issued for: **REGULATORY REVIEW & CONSTRUCTION**

Drawing Title: **SHARED RESIDENTIAL DOCK PROPOSED PIER PLAN & PROFILE**

Date: 5/26/2020
 Scale: VARIES
 Designed By: AUK
 Drawn by: AUK
 Checked by: AUK
 Project Number: 2020-03
 Sheet 5 of 7
 Drawing Number: PR3

AUGUST J. KREUZKAMP III
 REGISTERED PROFESSIONAL ENGINEER
 CIVIL 6/5/90

7949

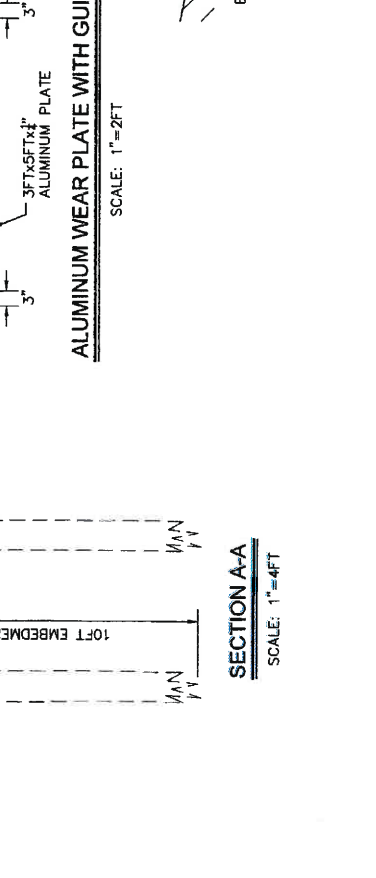
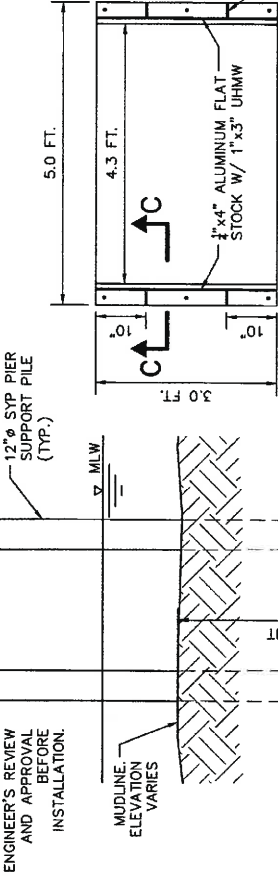
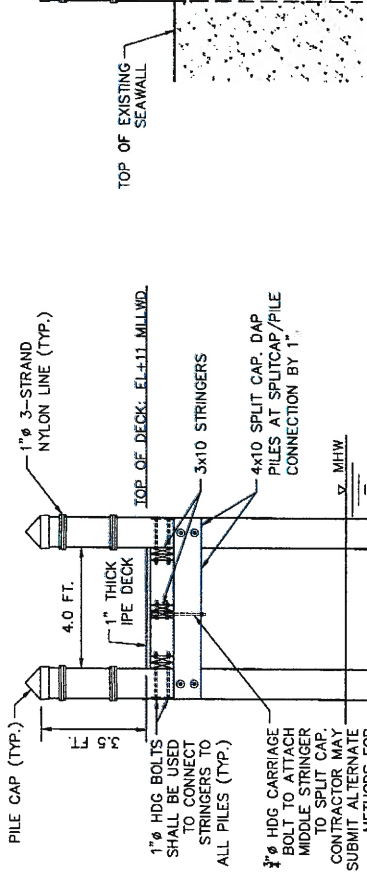
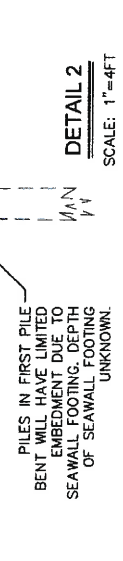
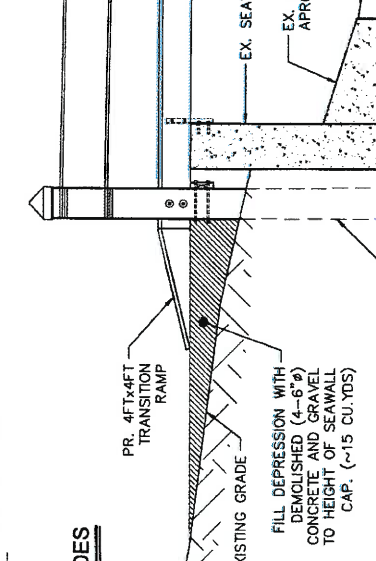
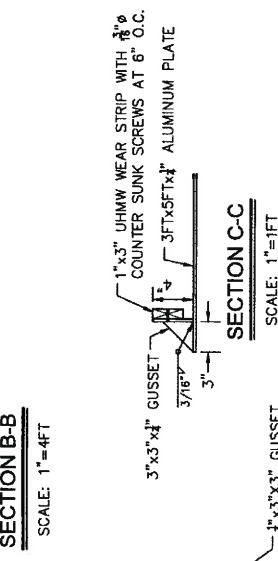
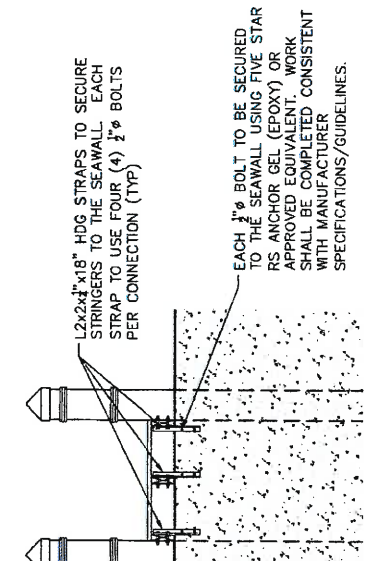

PILE CAP (TYP.)

1" HDG BOLTS SHALL BE USED TO CONNECT STRINGERS TO ALL PILES (TYP.)

3" HDG CARRIAGE BOLT TO ATTACH MIDDLE STRINGER TO SPLIT CAP. CONTRACTOR MAY SUBMIT ALTERNATE METHODS FOR ENGINEER'S REVIEW AND APPROVAL BEFORE INSTALLATION.

MUDLINE ELEVATION VARIES

10FT EMBEDMENT

EXISTING GRADE

PR, 4FTx4FT TRANSITION RAMP

EX. SEAWALL

EX. CONC. APRON

FILL DEPRESSION WITH DEMOLISHED (4-6") CONCRETE AND GRAVEL TO HEIGHT OF SEAWALL CAP. (~15 CU.YDS)

PILES IN FIRST PILE BENT WILL HAVE LIMITED EMBEDMENT DUE TO SEAWALL FOOTING. DEPTH OF SEAWALL FOOTING UNKNOWN.



HARBOR ENGINEERING, LLC
 26 BOSWORTH STREET
 BARRINGTON, RI 02806
 (401) 829-4870
 harboreng.com

| No. | Revision | Date | App. |
|-----|----------|------|------|
| | | | |
| | | | |
| | | | |
| | | | |

Client/Owner: **PAUL & CHRISTINE GRADY**
 2 SHELL ROAD
 WARREN, RI 02885
PATRICK LEBEAU & MEGHAN RAWSON
 4 SHELL ROAD
 WARREN, RI 02885

Issued for: **REGULATORY REVIEW & CONSTRUCTION**

Drawing Title: **SHARED RESIDENTIAL DOCK**
 PROJECT NOTES

Date: 5/26/2020
 Scale:
 Designed By: AJK
 Drawn by: AJK
 Checked by: [Signature]
 Project Number: 2020-05
 Sheet 6 of 7
 Drawing Number: N-1

7949
 AUGUST J. KREUZKAMP, III
 REGISTERED PROFESSIONAL ENGINEER
 CIVIL 61579

GENERAL NOTES:

- DRAWING AND SPECIFICATIONS, AS INSTRUMENTS OF PROFESSIONAL SERVICE, ARE AND SHALL REMAIN THE PROPERTY OF HARBOR ENGINEERING, LLC. DOCUMENTS ARE NOT TO BE USED, IN WHOLE OR IN PART, FOR OTHER PROJECTS OR PURPOSES OR BY ANY OTHER PARTIES THAN THOSE AUTHORIZED BY CONTRACT WITHOUT THE SPECIFIC WRITTEN AUTHORIZATION OF HARBOR ENGINEERING, LLC. THE USE OF THIS DOCUMENT IS CONTINGENT UPON PAYMENT TO HARBOR ENGINEERING, LLC. FOR SERVICES RENDERED. NON-PAYMENT SHALL GIVE HARBOR ENGINEERING, LLC. THE AUTHORITY TO BAR DOCUMENT USE BY ANY AND ALL PARTIES.

GENERAL CONSTRUCTION NOTES:

- ALL WORK SHALL CONFORM TO THE STANDARDS AND REQUIREMENTS AS SHOWN IN THESE PLANS AND SPECIFICATIONS.
- PRIOR TO CONSTRUCTION, THE CONTRACTOR SHALL VERIFY THE CONDITIONS SHOWN HEREIN AND NOTIFY THE ENGINEER IN WRITING OF ANY DISCREPANCIES IN DIMENSIONS AND/OR SITE CONDITIONS PRIOR TO THE FABRICATION AND/OR ORDERING OF ANY CONSTRUCTION MATERIALS. THE CONTRACTOR SHALL NOT BEGIN CONSTRUCTION IN ANY SUCH AFFECTED AREA UNTIL THE DISCREPANCY HAS BEEN RESOLVED BY THE CONTRACTOR AND APPROVED BY THE ENGINEER.
- THE CONTRACTOR SHALL BE RESPONSIBLE FOR BRINGING ALL ELEMENTS OF THE PROJECT IN CONFORMANCE WITH THESE PLANS AND SPECIFICATIONS. IF ANY MODIFICATIONS ARE REQUIRED IN ANY ELEMENT, THE CONTRACTOR SHALL SUBMIT PROPOSED CHANGES IN WRITING TO THE ENGINEER FOR REVIEW.
- ALL SAFETY REGULATIONS ARE TO BE STRICTLY FOLLOWED. METHODS OF CONSTRUCTION AND ERECTION OF STRUCTURAL MATERIAL ARE THE RESPONSIBILITY OF THE CONTRACTOR.
- ALL WORK SHALL COMPLY WITH FEDERAL LAWS, STATE REGULATIONS, AND LOCAL LAWS AND STATUTES AND THE REQUIREMENTS AND CONDITIONS OF ALL REGULATORY PERMITS ISSUED FOR THE WORK.
- ALL WORK SHALL CONFORM TO THE LATEST EDITION OF THE OSHA CODE, THE RHODE ISLAND STATE BUILDING CODE, AND THE REFERENCED STANDARDS INCLUDED THEREIN THAT ARE APPLICABLE TO THIS PROJECT.
- IT SHALL BE CONTRACTOR'S RESPONSIBILITY TO OBTAIN THE SURVEY SUPPORT NEEDED TO COMPLETE THE WORK, INCLUDING STAKEOUT, TO ENSURE THE WORK IS COMPLETED CONSISTENT WITH PROJECT PLANS AND ASSOCIATED REGULATORY APPROVALS.
- ALL MATERIAL STORAGE SHALL BE DONE VIA BARGE.
- DAMAGE TO ANY PROPERTY, PRIVATE OR OF PUBLIC TRUST, OCCURRING DURING THE CONSTRUCTION BY THE CONTRACTOR, SHALL BE THE RESPONSIBILITY OF THE CONTRACTOR AND SHALL BE REPAIRED TO THE SATISFACTION OF THE OWNER AT THE EXPENSE OF THE CONTRACTOR.

PILE DRIVING:

- THE CONTRACTOR SHALL USE EQUIPMENT ADEQUATE IN SIZE, CAPACITY, AND NUMBERS, AND MAINTAINED TO THE REQUIREMENTS OF ALL FEDERAL, STATE, AND LOCAL LAWS AND REGULATIONS TO ACCOMPLISH THE WORK.
- PILE SHALL BE DRIVEN AS SPECIFIED ON THE PRECEDING SHEETS. CONTRACTOR SHALL POINT PILES AND BE PREPARED TO USE STEEL PILE TIPS OR SOCKET PILES TO ACHIEVE THE REQUIRED EMBEDMENT.
- THE CONTRACTOR SHALL KEEP AN ACCURATE SET OF PILE INSTALLATION/DRIVING LOGS. ALL PILES BEING INSTALLED SHALL BE CLEARLY MARKED IN 1 FOOT INCREMENTS PRIOR TO INSTALLATION TO SUPPORT MONITORING/RECORDING EFFORTS. ALL LOGS SHALL BE CERTIFIED BY THE CONTRACTOR AND SUBMITTED TO THE OWNER PRIOR TO PAYMENT. PILE LOGS SHALL INCLUDE: PILE ID, LOCATION, DEPTH TO MUDLINE (INCLUDING DATE & TIME RECORDED) AND TOTAL EMBEDMENT.

PILE CAPS:

- PILE CAPS SHALL BE WHITE, ROUND CONE, LOW DENSITY POLYETHYLENE CAPS.
- PILE CAPS SHALL BE SIZED APPROPRIATELY TO ACCOMMODATE THE UNIQUE SIZE OF EACH PILE BUTT.
- PILE CAPS SHALL BE ATTACHED USING FOUR (4) STAINLESS STEEL SCREWS.

TIMBER NOTES:

- DESIGN LIVE LOAD FOR FIXED PIER: 40PSF UNIFORM DISTRIBUTED LOAD.
- DECKING ON PIER AND FLOATING DOCK SHALL BE 1" NOM. IPE FASTENED TO STRINGERS USING STAINLESS STEEL SCREWS.
- PIER SUPPORT PILES SHALL BE 12" SOUTHERN YELLOW PINE (SYP) WITH 10FT EMBEDMENT INTO COMPETENT MATERIAL.
- FLOAT ANCHOR PILES SHALL BE 12" GREENHEART WITH 15FT EMBEDMENT INTO COMPETENT MATERIAL. GREENHEART PILES SHALL BE BANDED USING ONE 1" STAINLESS STEEL BAND AT EACH PILE BUTT TO PREVENT FUTURE BROODING.
- UNLESS NOTED OTHERWISE, ALL TIMBER MATERIAL (INCLUDING STRINGERS, SPLIT CAPS AND OTHER FRAMING) SHALL BE SOLID SAWN LUMBER (S4S) SOUTHERN YELLOW PINE (SYP) GRADE NO. 2 OR BETTER IN ACCORDANCE WITH EITHER THE SOUTHERN PINE INSPECTION BUREAU OR THE TIMBER PRODUCTS INSPECTION BUREAU GRADING RULES. UNLESS NOTED OTHERWISE, SYP TIMBER MATERIALS SHALL BE TREATED WITH CCA PRESERVATIVE SUFFICIENT FOR MARINE CONSTRUCTION WITH THE FOLLOWING MINIMUM RETENTIONS:
 - SYP TIMBER PILES: 2.5 LBS PER CUBIC FOOT
 - SYP TIMBER FRAMING: 0.6 LBS PER CUBIC FOOT.
- BRUSH APPLY TWO (2) COATS OF WOOD PRESERVATIVE TO SURFACE OF PRESERVATIVE TREATED MATERIALS WHICH HAVE BEEN FIELD CUT, DRESSED OR DRILLED.
- SPLICING OF STRINGERS SHOULD OCCUR EXCLUSIVELY OVER THE CENTER OF A PILE BENT (OVER THE SPLIT CAP) WITH A 3FT BUTT SPLICE. EACH SPLICE SHALL INCLUDE A 3FT LONG 3X10 SCAB AND 18-INCH OVERLAP WITH THE BUTTING STRINGERS.
- TIMBER BLOCKING IS REQUIRED BETWEEN ALL STRINGERS AT MID-SPAN USING 3X10 TIMBERS AND 1/2" HDG LAG BOLTS.

HARDWARE:

- ALL BOLTS SHALL BE ASTM A307 OR BETTER SIZED NO LESS THAN 1", UNLESS NOTED OTHERWISE, ACCOMPANIED BY APPROPRIATELY SIZED NUTS AND WASHERS.
- ALL HARDWARE INCLUDING NAILS, SCREWS, BOLTS, NUTS AND WASHERS SHALL BE HOT-DIPPED GALVANIZED (HDG) STEEL, UNLESS NOTED OTHERWISE.
- COUNTER SINK AREAS WHERE HARDWARE INTERFERES WITH CONSTRUCTION OR VESSEL BERTHING AREAS.
- CONNECTION TO SUBMIT DETAILS OF THE FLEXIBLE (GALLOW-STYLE) GANGWAY CONNECTION TO ENGINEER FOR REVIEW AND APPROVAL BEFORE FABRICATING.

ELOATING DOCK:

- FLOATING DOCKS SHALL BE CONSTRUCTED USING CCA TREATED TIMBER FRAMING, ENCAPSULATED PERMAFLOAT FLOATION OR APPROVED EQUAL TUBS AND CCA SYP TIMBER DECKING.
- FLOAT FRAMING SHALL BE CONSTRUCTED SUCH THAT IT CAN ADEQUATELY MANAGE BEING LIFTED USING CHAINS CONNECTED TO THE BUTTS OF THE FLOAT ANCHOR PILES EACH WINTER FOR SEASONAL STORAGE.
- CONTRACTOR TO INSTALL A TOTAL OF SIX (6) HOT-DIPPED GALVANIZED STEEL CLEATS ON THE FLOATING DOCK, ATTACHED TO THE FRAMING OF THE FLOATING DOCK USING THROUGH BOLTS. CLEATS SHALL BE NO LESS THAN 10 INCHES IN LENGTH.
- DOCK FENDER SHALL BE EXTRUDED, NON-WARRING, MARINE GRADE VINYL, CONSISTENT SHADE OF GRAY IN COLOR INCLUDING BUMPER STRIP ALONG THE TWO (2) BERTHING SIDES OF THE FLOAT AND FOUR (4) CORNER BUMPERS.
- MODIFY FLOAT ANCHOR PILE GUIDES TO INCLUDE 1-INCH THICK UHMW PAD ATTACHED TO FACE OF DOCK/GUIDE IN ADDITION TO STANDARD GUIDE ROLLER.
- FLOAT DESIGN CRITERIA:
 - LIVE LOAD=40 PSF
 - DEAD LOAD FREEBOARD=20"



HARBOR ENGINEERING, LLC
 28 BOSWORTH STREET
 BARRINGTON, RI 02806
 (401) 829-4870
 harboreng.com

| No. | Revision | Date | App. |
|-----|----------|------|------|
| | | | |
| | | | |
| | | | |
| | | | |
| | | | |
| | | | |
| | | | |
| | | | |
| | | | |
| | | | |



Client/Owner: **PAUL & CHRISTINE GRADY**
 2 SHELL ROAD
 WARREN, RI 02885

PATRICK LEBEAU & MEGHAN RAWSON
 4 SHELL ROAD
 WARREN, RI 02885

Issued for: **REGULATORY REVIEW & CONSTRUCTION**

Drawing Title: **SHARED RESIDENTIAL DOCK**
AREA RESIDENTIAL BOATING FACILITIES SUMMARY

Date: 5/28/2020
 Scale: 1"=250FT
 Designed By: AJK/MMG
 Drawn by: A.I.K.
 Checked by: [Signature]
 Project Number: 20200503
 Sheet: 7 of 7
 Drawing Number: 7949
 Act: [Stamp]

AUGUST J. KREUZKAMP III
 REGISTERED PROFESSIONAL ENGINEER
 CIVIL 6/5/90



- NOTES:**
1. THE ORTHOPHOTOGRAPH PRESENTED HEREIN WAS OBTAINED FROM GOOGLE EARTH. PHOTOGRAPH WAS TAKEN FEBRUARY 26, 2018.
 2. THE INFORMATION INCLUDED IN TABLE 3 WAS OBTAINED FROM REGULATORY FILES ASSOCIATED WITH EACH LOCATION. MEASUREMENTS THAT WERE NOT INCLUDED IN THE REGULATORY DOCUMENTS WERE MEASURED USING GOOGLE EARTH AND SHOULD BE CONSIDERED APPROXIMATE.
 3. LINENWORK ASSOCIATED WITH 1 NORTH STREET IS BASED ON THE PROPOSED PLAN INFORMATION AND NOT THE RESULT OF A POST-CONSTRUCTION SURVEY.

TABLE 3: NEARBY RESIDENTIAL BOATING FACILITIES

| ADDRESS | A | B | C | D | E | F |
|--|------------------------------|--|--|-------------------------------|---|--|
| RICRMC FILE # | 4 BROWNELL ST 1995-07-098 | 8 BROWNELL ST 2001-07-090 | 26 BROWNELL ST 2005-08-051 | 40 BROWNELL ST 1998-06-073 | 2 & 4 SHELL RD PROPOSED | 1 NORTH ST 2017-03-063 |
| DESCRIPTION OF FACILITY | 4FTx200FT PIER | 4FTx121FT PIER, 3FTx38FT RAMP & 8FTx18.5FT FLOAT | 4FTx121FT PIER, 3FTx38FT RAMP & 8FTx18.5FT FLOAT | 6-8FTx280FT PIER | 4FTx121FT PIER, 3FTx25FT RAMP & 10FTx20FT FLOAT | 4FTx140FT PIER, 3FTx25FT RAMP & 6FTx25FT FLOAT WITH FLOAT LIFT & MOORING PILES |
| LENGTH OF TOTAL STRUCTURE SEAWARD OF MLW | 96 FEET (ESTIMATED) | 66 FEET | 68 FEET | 21.4 FEET (ESTIMATED) | 108 FEET (PROPOSED) | 137 FEET |
| LENGTH OF TOTAL STRUCTURE SEAWARD OF MHW | 160 FEET (ESTIMATED) | 129 FEET | 135 FEET | 248 FEET (ESTIMATED) | 160 FEET (PROPOSED) | 193 FEET |