



State of Rhode Island  
Coastal Resources Management Council  
Oliver H. Stedman Government Center  
4808 Tower Hill Road, Suite 3  
Wakefield, RI 02879-1900

(401) 783-3370  
Fax (401) 783-2069

## **PUBLIC NOTICE**

File Number: 2021-02-004 Date: April 8, 2021

This office has under consideration the application of:

Edward Martin & Linda Joy Resnick  
12 Sefton Drive  
Cranston, RI 02905

for a State of Rhode Island Assent to construct and maintain: a residential boating facility consisting of a 4' x 40' fixed pier, a 3' x 12' ramp and an 8' x 18.75' float. The structure will extend 50' beyond mean low water.

Project Location:	12 Sefton Drive
City/Town:	Cranston
Plat/Lot:	2 / 3069
Waterway:	Providence River

Plans of the proposed work may be seen at the CRMC office in Wakefield.

In accordance with the Administrative Procedures Act (Chapter 42-35 of the Rhode Island General Laws) you may request a hearing on this matter.

You are advised that if you have good reason to enter protests against the proposed work it is your privilege to do so. It is expected that objectors will review the application and plans thoroughly, visit site of proposed work if necessary, to familiarize themselves with the conditions and cite what law or laws, if any, would in their opinion be violated by the work proposed.

If you desire to protest, you must attend the scheduled hearing and give sworn testimony. A notice of the time and place of such hearing will be furnished you as soon as possible after receipt of your request for hearing. If you desire to request a hearing, to receive consideration, it should be in writing (**with your correct mailing address, e-mail address and valid contact number**) and be received at this office on or before May 8, 2021.

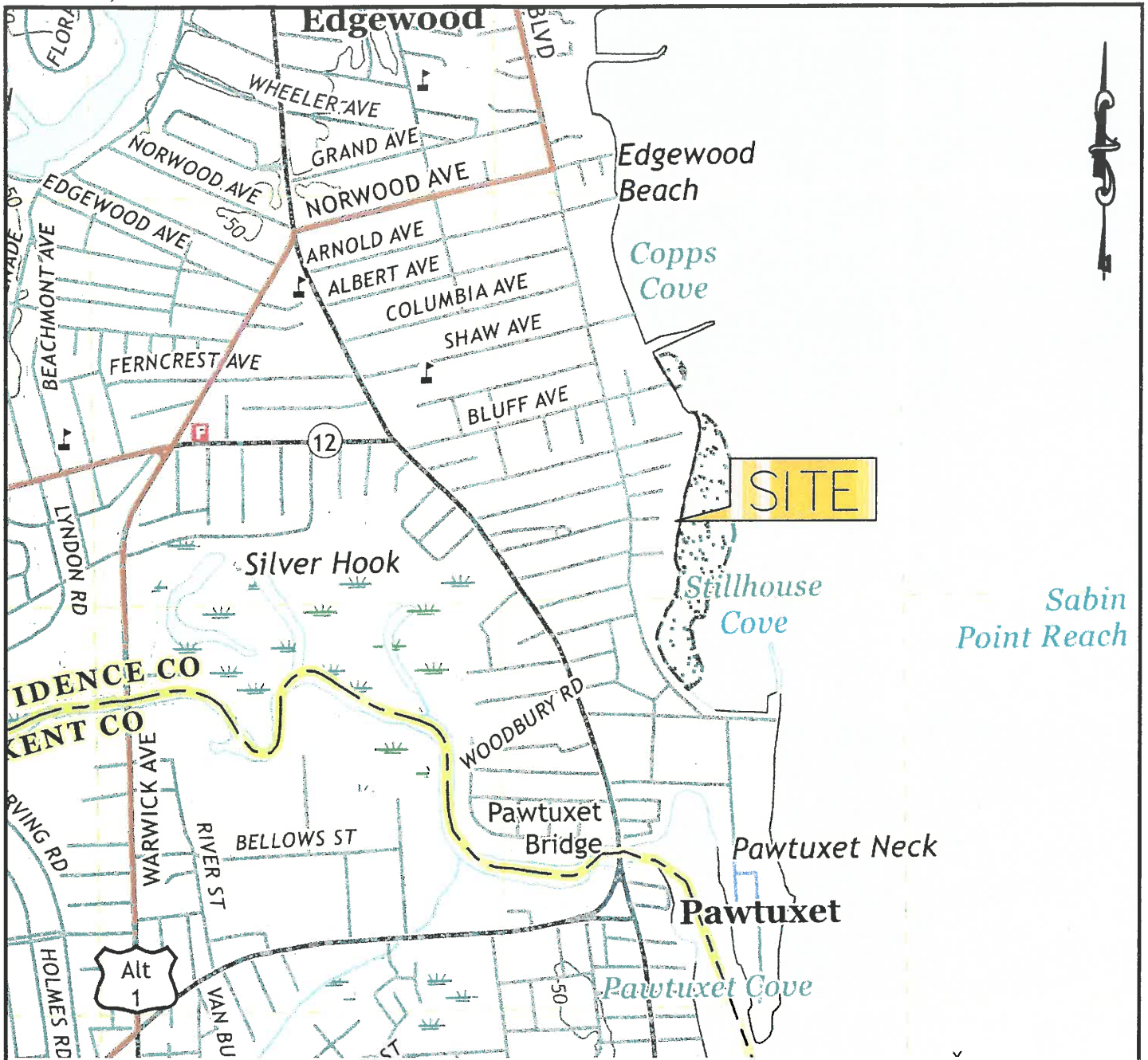

## LOCUS MAP

### DOCK APPLICATION

PREPARED FOR:

EDWARD W. MARTIN  
& LINDA JOY RESNICH

12 SEFTON DRIVE  
IN THE CITY OF CRANSTON  
MAP 2, LOT 3069

1/5/2021

JOB NUMBER: 8337.001

© 2021 ENVIRONMENTAL PLANNING & SURVEYING, INC.

WESLEY GRANT III

No. 3157

3157

REGISTERED  
PROFESSIONAL ENGINEER  
CIVIL

Environmental Planning & Surveying, Inc.

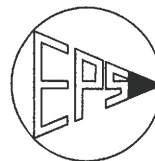

Civil Engineering  
Surveying  
C A D Drafting

52 Dugway Bridge Road West Kingston, Rhode Island 02892 (401) 789-3628

Page 1 of 9

JAN 28 2021

COASTAL RESOURCES  
MANAGEMENT COUNCIL



# **AERIAL MAP**

SCALE 1"=100'

## **DOCK APPLICATION**

PREPARED FOR:  
EDWARD W. MARTIN  
& LINDA JOY RESNICH  
12 SEFTON DRIVE  
IN THE CITY OF CRANSTON  
MAP 2, LOT 3069

1/5/2021

JOB NUMBER: 8337.001

**WESLEY GRANT III**

REGISTERED  
PROFESSIONAL ENGINEER  
CIVIL

Environmental Planning & Surveying, Inc.



Civil Engineering  
Surveying  
C A D Drafting

52 Dugway Bridge Road West Kingston, Rhode Island 02892 (401) 789-3628

© 2021 ENVIRONMENTAL PLANNING & SURVEYING, INC.

Page 3 of 9

**JAN 28 2021**

COASTAL RESOURCES  
MANAGEMENT COUNCIL

## GENERAL SPECIFICATIONS

1. THE PROPOSED DOCK IS LOCATED IN TYPE 2 WATERS AS DESIGNATED BY THE RHODE ISLAND COASTAL RESOURCES MANAGEMENT COUNCIL.
2. NO MORE THAN FOUR BOATS ARE PERMITTED TO USE THE PROPOSED DOCK AT ONCE. NO UNLOADING OF COMMERCIAL FISHING CATCHES IS PROPOSED.
3. THE CONTRACTOR SHALL PROVIDE THE ENGINEER AND OWNER WITH AS-BUILT DRAWINGS SHOWING THE ACTUAL LOCATION OF ANY UTILITIES INSTALLED UNDER THIS CONTRACT. IN ADDITION TO AS-BUILT DRAWINGS, THE CONTRACTOR SHALL SUPPLY POLE DRIVING NOTING; TYPE OF PILING USED, LENGTH OF PILING USED, PRESSURE TREATMENT, DEPTH OF DRIVING, CUT OFF LENGTH, AND IF ANY OBSTRUCTION WERE ENCOUNTERED LIMITING DRIVING DEPTH. IN ADDITION TO PILING INFORMATION, THE CONTRACTOR SHALL SUPPLY THE ENGINEER AND OWNER WITH FRAMING LUMBER SIZES, LUMBER GRADES, PRESSURE TREATMENT STANDARDS AND TYPES OF BOLTING MATERIAL AND HARDWARE USED FOR THE TIMBER FRAMING OF THE FIXED PIER AND FLOATING DOCKS.
4. IT IS THE RESPONSIBILITY OF THE CONTRACTOR TO VERIFY ALL EXISTING CONDITIONS AND DIMENSIONS AS THEY RELATE TO NEW CONSTRUCTION. REPORT TO THE ENGINEER ALL OBSERVATIONS AND DISCREPANCIES BEFORE PROCEEDING WITH ANY WORK.
5. TIDE LINE ARE OBSERVED.
6. AN AIR DIFFUSION (BUBBLER) SYSTEM SHALL BE INSTALLED TO PREVENT ICE DAMAGE AND PILING LIFTING DURING WINTER PERIODS.

### STRUCTURAL

DESIGNED PEDESTRIAN LIVE LOAD:

FIXED PIER = 40 P.S.F. (10 PSF DEAD LOAD)

FLOATS = 20 P.S.F. OR 400 LBS. CONCENTRATED.

### MATERIALS

#### WOOD

ALL WOOD IS TO BE SOUTHERN YELLOW PINE, PRESSURE TREATED WITH TYPE III CHROMATED COPPER ARSENATE (CCA) TO THE FOLLOWING DENSITIES:

DECKING: .4 POUNDS PER CUBIC FOOT (PCF)

PILES: 1.0 - 1.5 PCF

ALL OTHERS: .6 PCF

### HARDWARE

ALL HARDWARE IS TO BE HOT DIPPED GALVANIZED OR STAINLESS STEEL.

### PILINGS

PILINGS SHALL BE 10" TIP DIAMETER, DRIVEN TO A MINIMUM DEPTH OF 10' BELOW BOTTOM SEDIMENTS. IF REFUSAL IS ENCOUNTERED BEFORE THE PILING IS DRIVEN TO A 10' DEPTH, THE CONTRACTOR IS TO DETERMINE IF THE PILING IS ADEQUATELY SUPPORTED OR SHOULD BE RELOCATED TO ACHIEVE A DEEPER PENETRATION.

#### DOCK APPLICATION

PREPARED FOR:

EDWARD W. MARTIN  
& LINDA JOY RESNICH

12 SEFTON DRIVE  
IN THE CITY OF CRANSTON  
MAP 2, LOT 3069

1/5/2021

JOB NUMBER: 8337.001

© 2021 ENVIRONMENTAL PLANNING & SURVEYING, INC.

WESLEY GRANT III



REGISTERED  
PROFESSIONAL ENGINEER  
CIVIL

Environmental Planning & Surveying, Inc.



Civil Engineering  
Surveying  
C A D Drafting

52 Dugway Bridge Road West Kingston, Rhode Island 02892 (401) 789-3628

Page 2 of 10

JAN 28 2021

COASTAL RESOURCES  
MANAGEMENT COUNCIL

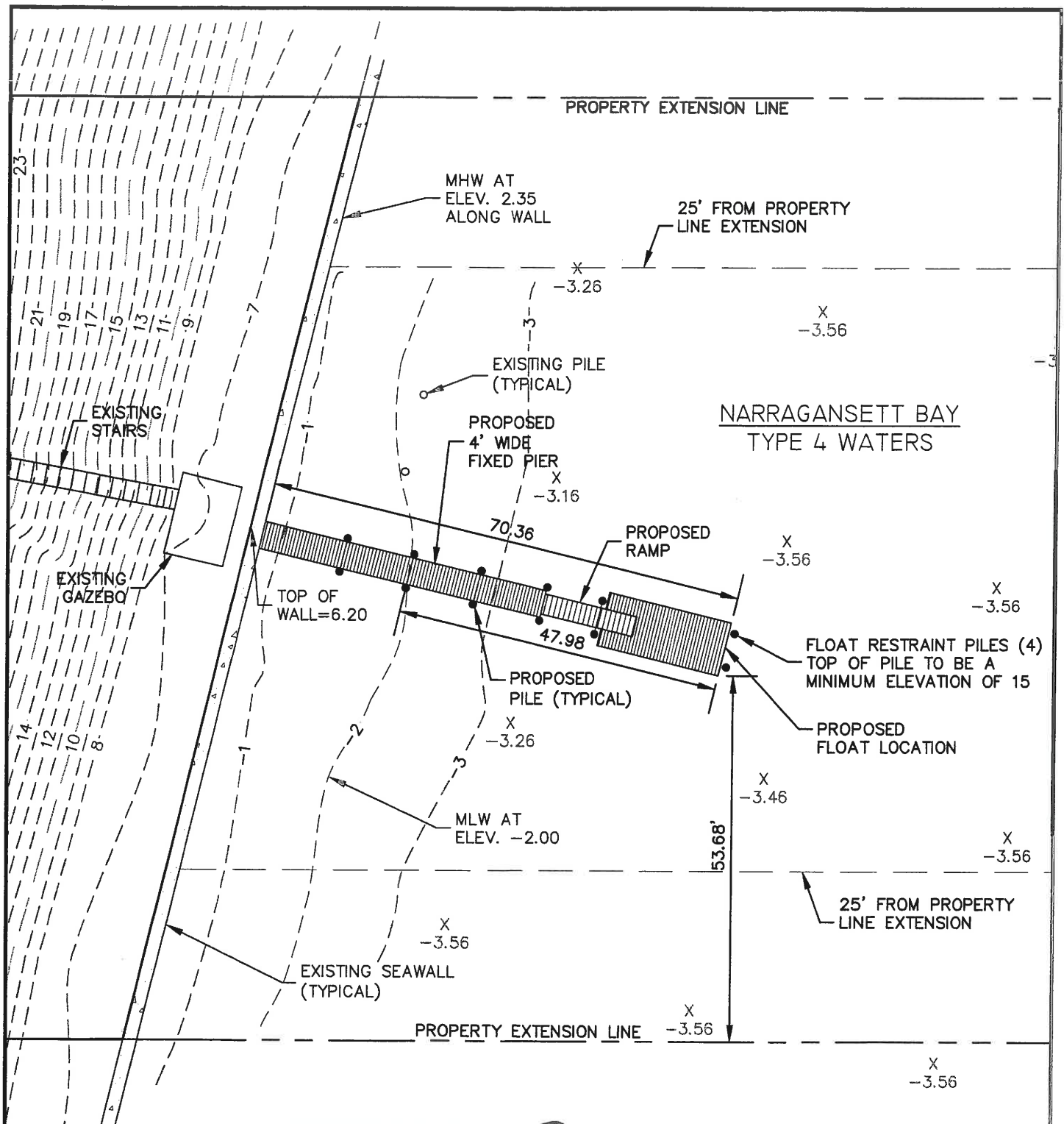

# **DOCK APPLICATION**

PREPARED FOR:

EDWARD W. MARTIN  
& LINDA JOY RESNICH

12 SEFTON DRIVE  
IN THE CITY OF CRANSTON  
MAP 2, LOT 3069

1/5/2021

JOB NUMBER: 8337.001

© 2021 ENVIRONMENTAL PLANNING & SURVEYING, INC.

WESLEY GRANT III



REGISTERED  
PROFESSIONAL ENGINEER  
CIVIL

*Environmental Planning & Surveying, Inc.*



Civil Engineering  
Surveying  
C A D Drafting

52 Dugway Bridge Road West Kingston, Rhode Island 02892 (401) 789-3628

Page 4 of 9

JAN 28 2021

COASTAL RESOURCES  
MANAGEMENT COUNCIL

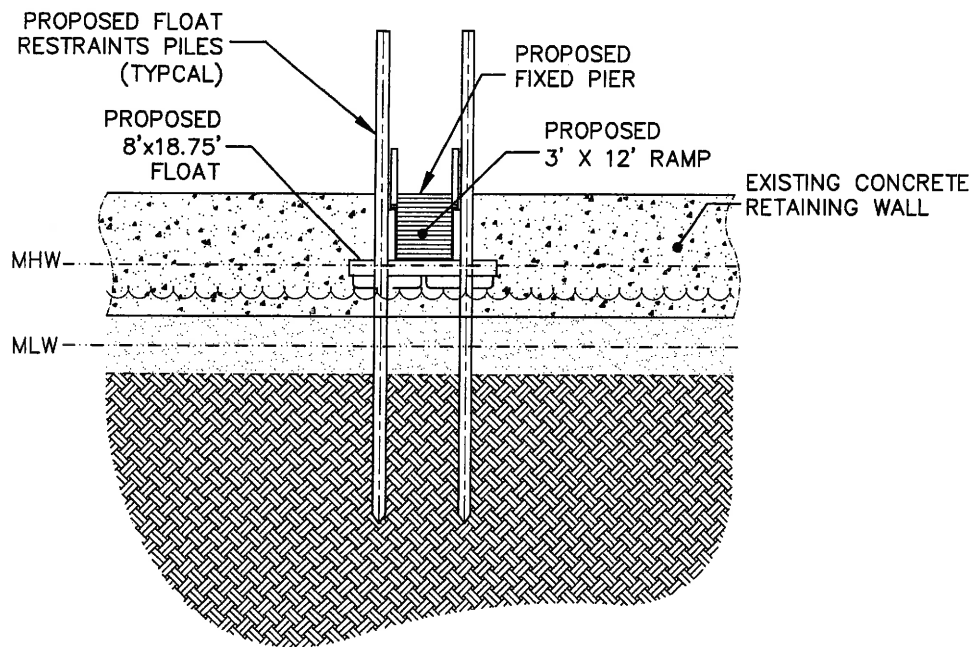

ELEVATION LOOKING WEST  
SCALE: 1"=10'

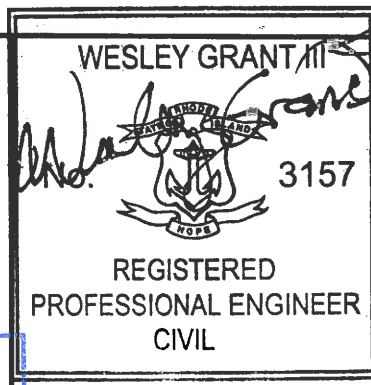

Environmental Planning & Surveying, Inc.



Civil Engineering  
Surveying  
C A D Drafting

52 Dugway Bridge Road West Kingston, Rhode Island 02892 (401) 789-3628

RECEIVED

JAN 28 2021

COASTAL RESOURCES  
MANAGEMENT COUNCIL

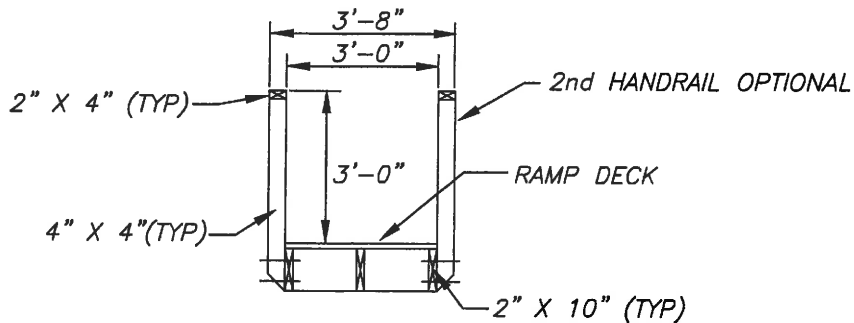
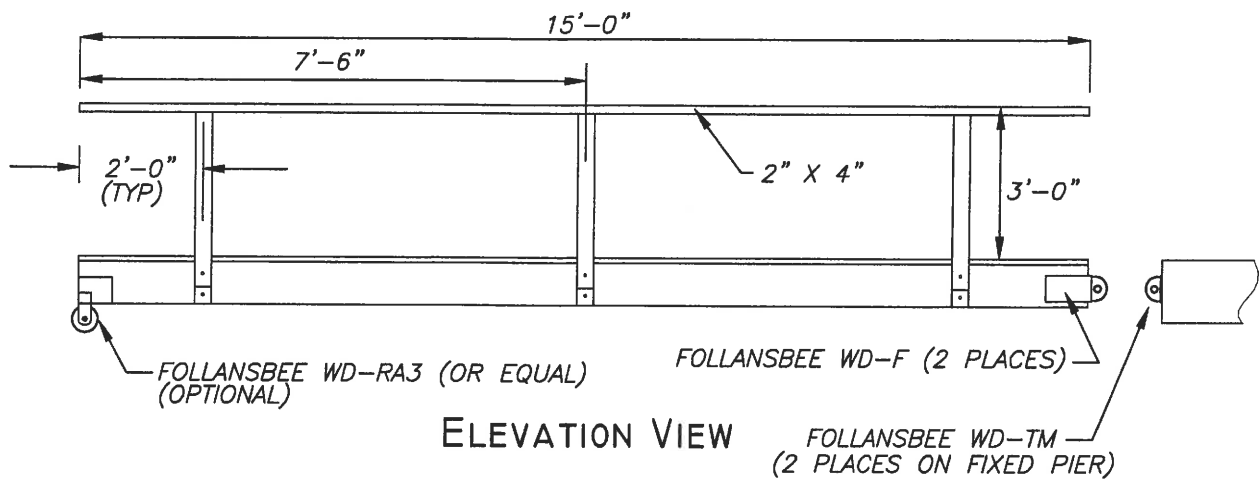
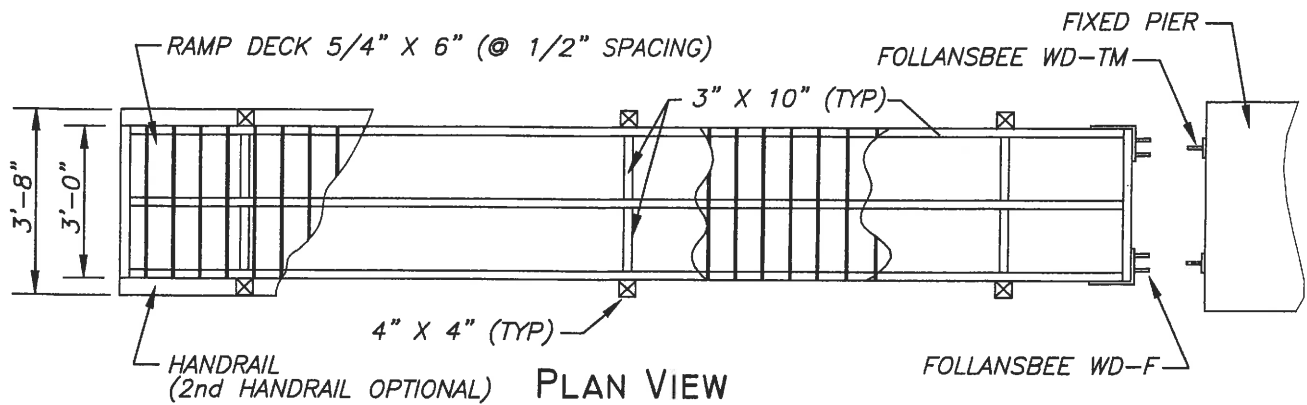

### RAMP DETAILS

NO SCALE

**NOTE:** HOT DIPPED GALVANIZED (OR STAINLESS STEEL) FASTENERS SHALL BE USED AS REQUIRED.

#### DOCK APPLICATION

PREPARED FOR:  
EDWARD W. MARTIN  
& LINDA JOY RESNICH  
12 SEFTON DRIVE  
IN THE CITY OF CRANSTON  
MAP 2, LOT 3069

1/5/2021

JOB NUMBER: 8337.001

© 2021 ENVIRONMENTAL PLANNING & SURVEYING, INC.

WESLEY GRANT III



3157

REGISTERED  
PROFESSIONAL ENGINEER  
CIVIL

Environmental Planning & Surveying, Inc.



Civil Engineering  
Surveying  
C A D Drafting

52 Dugway Bridge Road West Kingston, Rhode Island 02892 (401) 789-3628

Page 7 of 9

JAN 28 2021

COASTAL RESOURCES  
MANAGEMENT COUNCIL

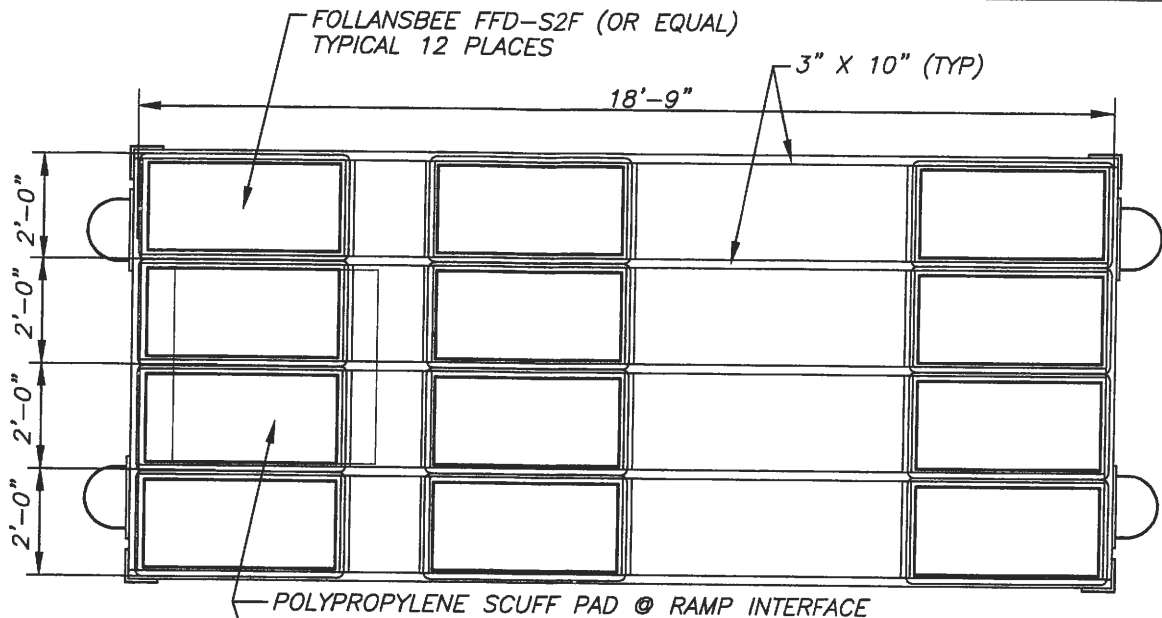

PLAN VIEW

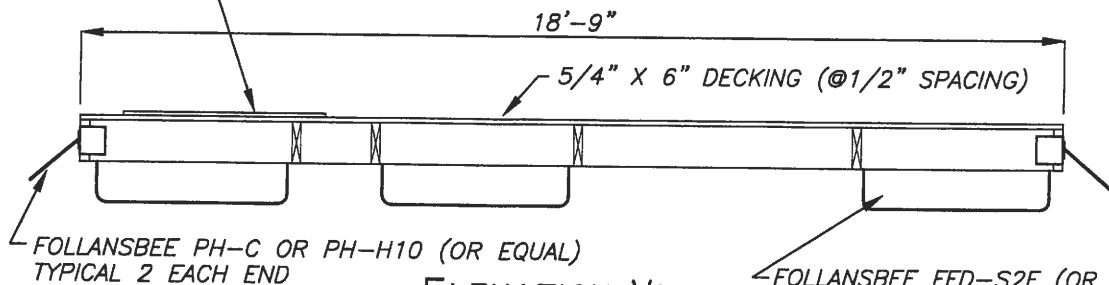

ELEVATION VIEW

**NOTE:** USE PVC PIPE AS ROLLERS WITH CHAIN TYPE PILE HOLDERS TO MINIMIZE ABRASION.

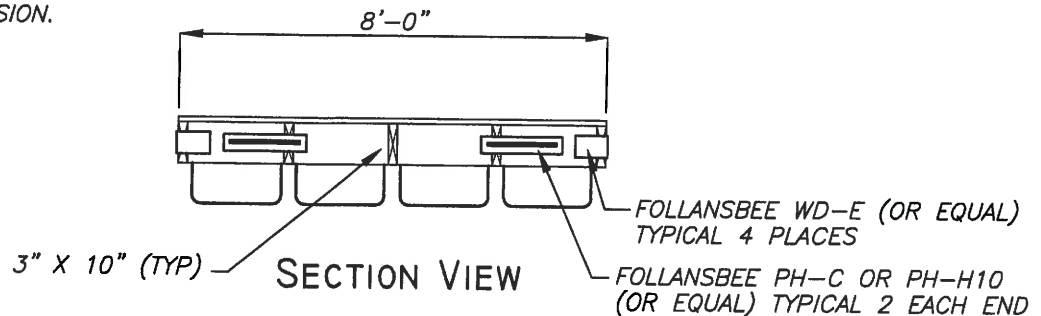

SECTION VIEW

**NOTE:** HOT DIPPED GALVANIZED (OR STAINLESS STEEL) FASTENERS SHALL BE USED AS REQUIRED.

### FLOAT DETAIL

NO SCALE

#### DOCK APPLICATION

PREPARED FOR:

EDWARD W. MARTIN  
& LINDA JOY RESNICH

12 SEFTON DRIVE  
IN THE CITY OF CRANSTON  
MAP 2, LOT 3069

1/5/2021

JOB NUMBER: 8337.001

© 2021 ENVIRONMENTAL PLANNING & SURVEYING, INC.

WESLEY GRANT III



3157

REGISTERED  
PROFESSIONAL ENGINEER  
CIVIL

Environmental Planning & Surveying, Inc.



Civil Engineering  
Surveying  
C A D Drafting

52 Dugway Bridge Road West Kingston, Rhode Island 02892 (401) 789-3628

Page 8 of 9

JAN 28 2021

COASTAL RESOURCES

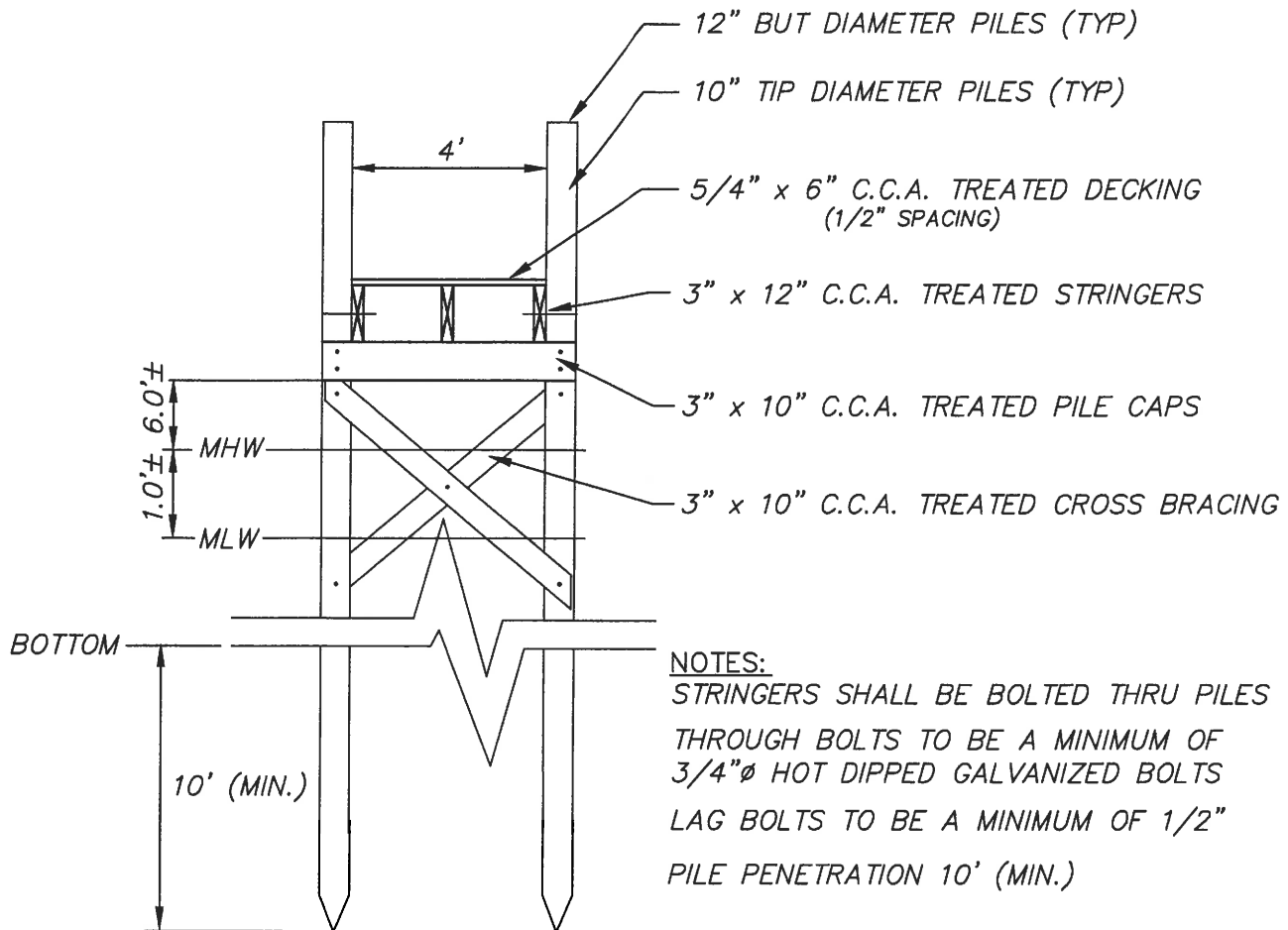

NOTE: HOT DIPPED GALVANIZED (OR STAINLESS STEEL) FASTENERS SHALL BE USED AS REQUIRED.

### DOCK SECTION NOT TO SCALE

#### DOCK APPLICATION

PREPARED FOR:  
 EDWARD W. MARTIN  
 & LINDA JOY RESNICH  
 12 SEFTON DRIVE  
 IN THE CITY OF CRANSTON  
 MAP 2, LOT 3069

1/5/2021

JOB NUMBER: 8337.001

© 2021 ENVIRONMENTAL PLANNING & SURVEYING, INC.

WESLEY GRANT III



3157

REGISTERED  
 PROFESSIONAL ENGINEER  
 CIVIL

Environmental Planning & Surveying, Inc.



Civil Engineering  
 Surveying  
 C A D Drafting

52 Dugway Bridge Road West Kingston, Rhode Island 02892 (401) 789-3628

Page 9 of 9

JAN 28 2021

COASTAL RESOURCES  
 MANAGEMENT COUNCIL