



State of Rhode Island
Coastal Resources Management Council
Oliver H. Stedman Government Center
4808 Tower Hill Road, Suite 3
Wakefield, RI 02879-1900

(401) 783-3370
Fax (401) 783-2069

PUBLIC RE-NOTICE

File Number: 2021-08-006

Date: December 22, 2021

This office has under consideration the application of:

**Andrew Dixon & Sarah Cassells
64 Turning Mill Road
Lexington, MA 02420**

for a State of Rhode Island Assent to construct and maintain: A high fetch residential boating facility consisting of a 4ft x 110ft fixed pier, 3ft x 20ft ramp, and a 10ft x 20ft terminal float. The facility is proposed to extend 50ft beyond mean low water achieving a depth of 4ft at its terminus. Piles above mean high water are proposed to be installed with concrete filled rock sockets requiring a variance to Redbook section 1.3.1(D) (11)(r) ; (geological site conditions shall exist which are appropriate for driven pile structural support), and section 1.3.1(D) (11)(p) (materials used for construction shall not include steel or concrete piles)

Project Location:	484 Poppasquash Road
City/Town:	Bristol
Plat/Lot:	173 / 51
Waterway:	Narragansett Bay

Plans of the proposed work may be seen at the CRMC office in Wakefield.

In accordance with the Administrative Procedures Act (Chapter 42-35 of the Rhode Island General Laws) you may request a hearing on this matter.

You are advised that if you have good reason to enter protests against the proposed work it is your privilege to do so. It is expected that objectors will review the application and plans thoroughly, visit site of proposed work if necessary, to familiarize themselves with the conditions and cite what law or laws, if any, would in their opinion be violated by the work proposed.

If you desire to protest, you must attend the scheduled hearing and give sworn testimony. A notice of the time and place of such hearing will be furnished you as soon as possible after receipt of your request for hearing. If you desire to request a hearing, to receive consideration, it should be in writing (**with your correct mailing address, e-mail address and valid contact number**) and be received at this office on or before January 22, 2022.

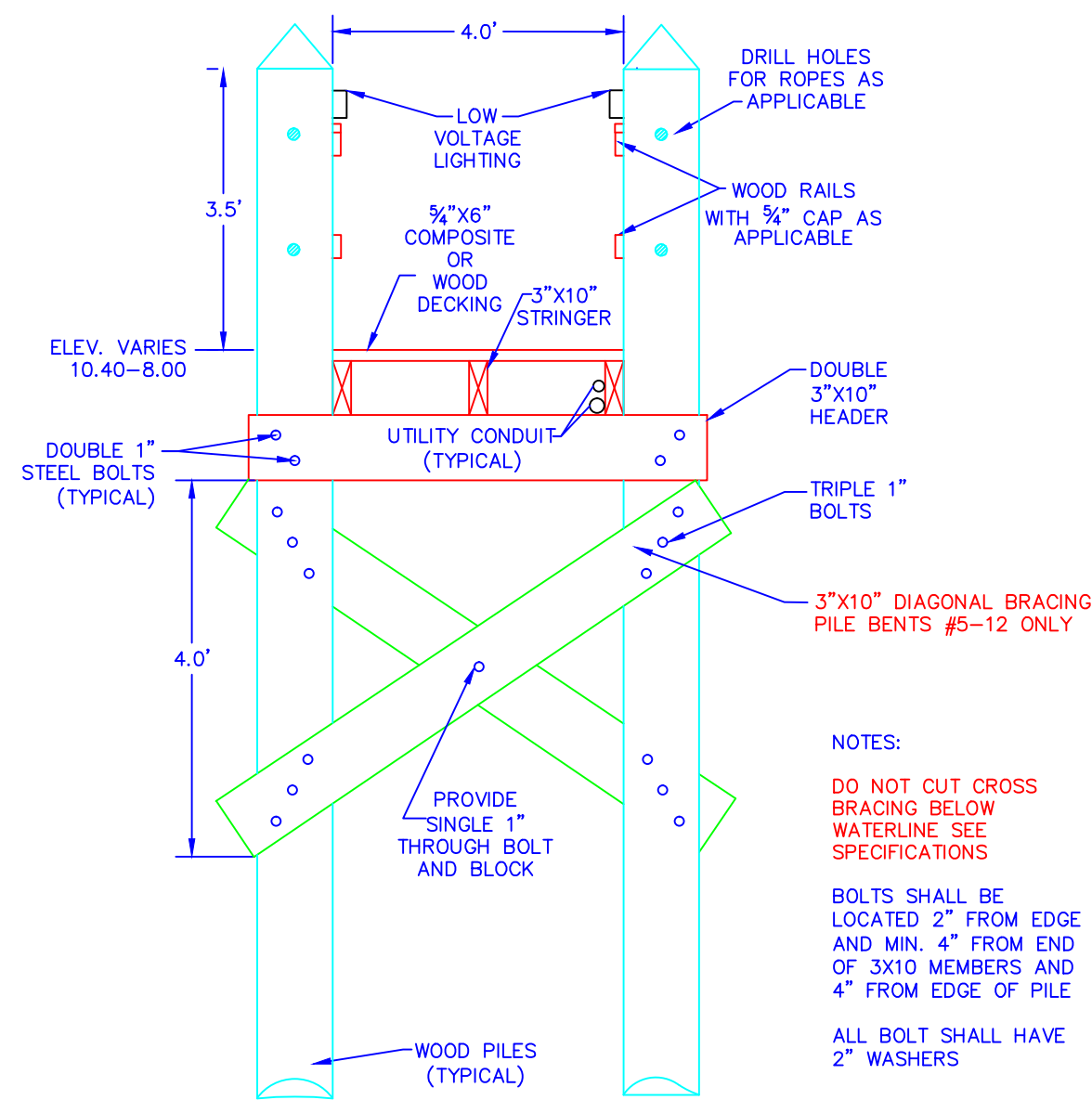

TYPICAL CROSS SECTION
NOT TO SCALE

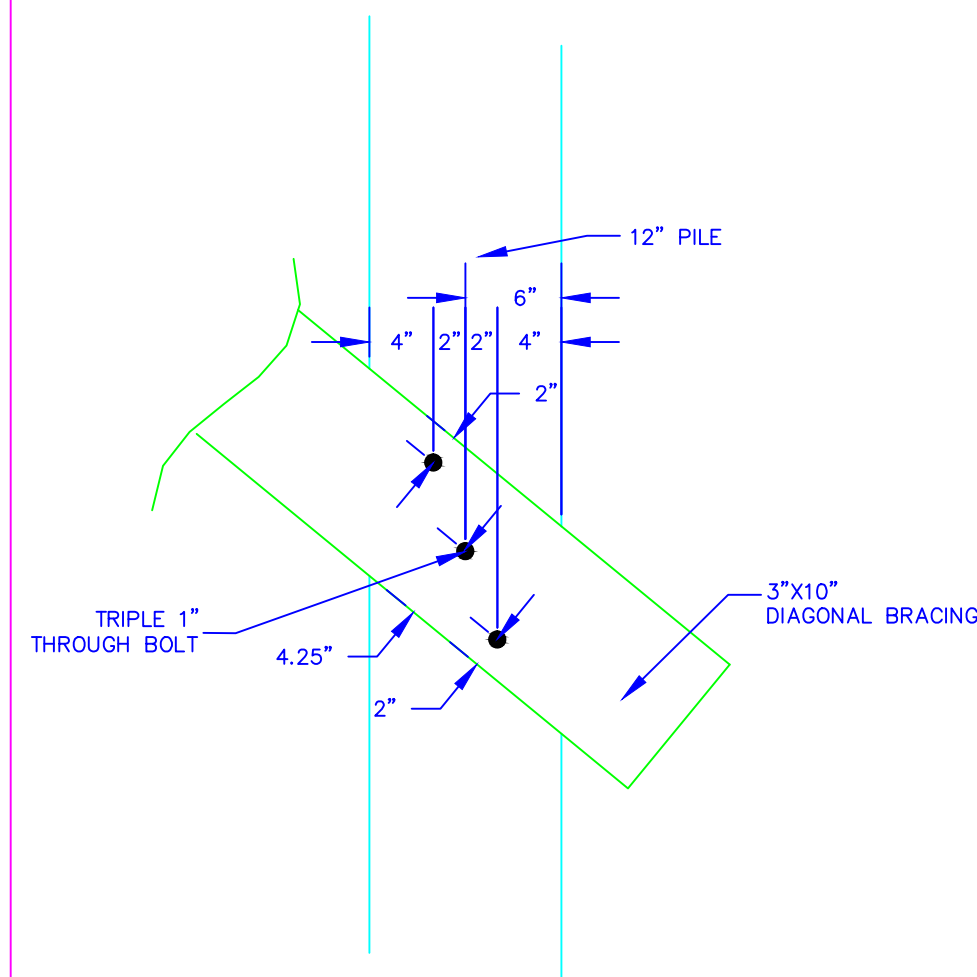

BOLT CONNECTION DETAIL
NOT TO SCALE

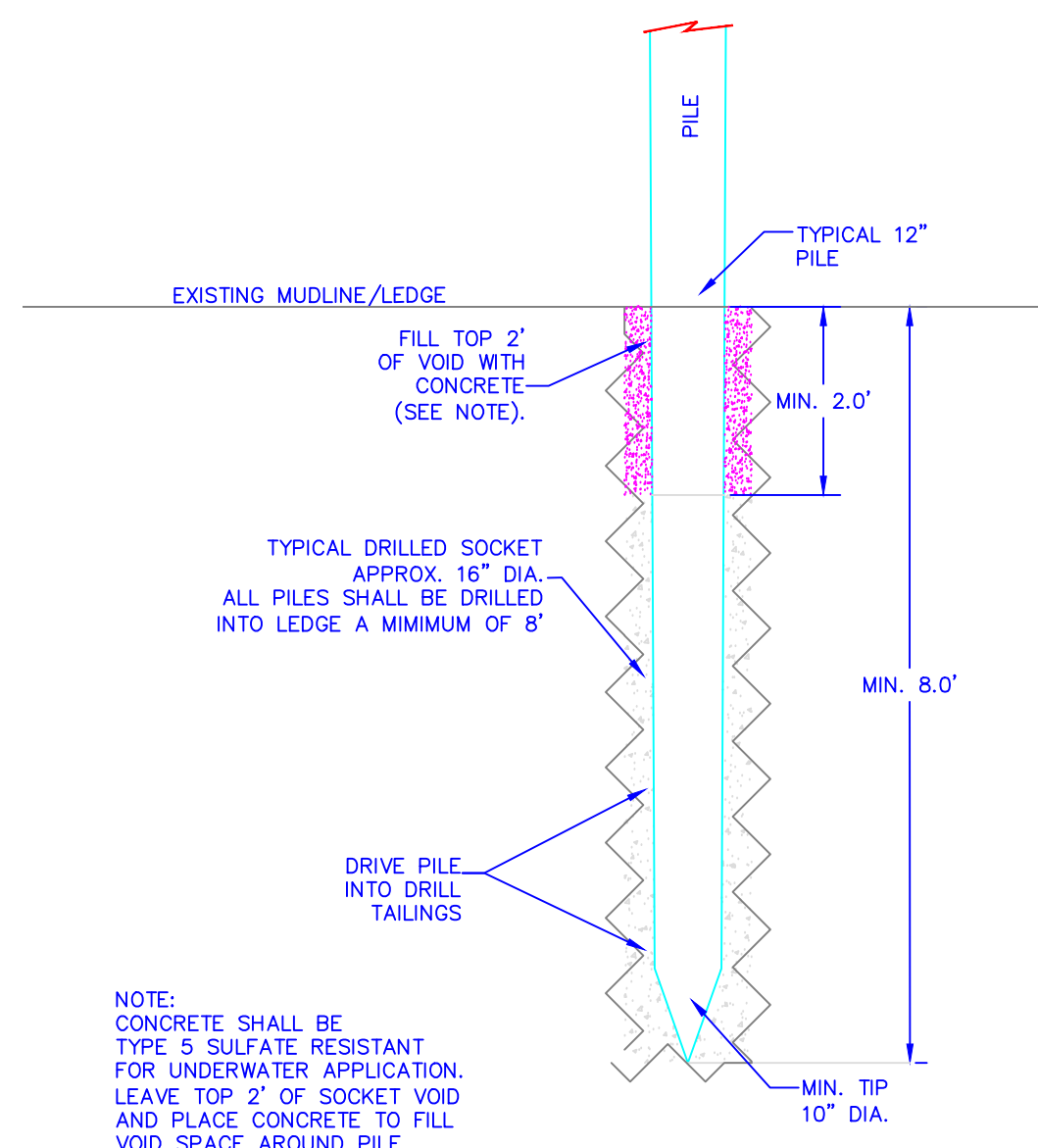

PILE DRILLED INTO LEDGE
NOT TO SCALE

IF LEDGE IS ENCOUNTERED
PILES SHALL BE INSTALLED
IN ACCORDANCE WITH THIS
DETAIL.

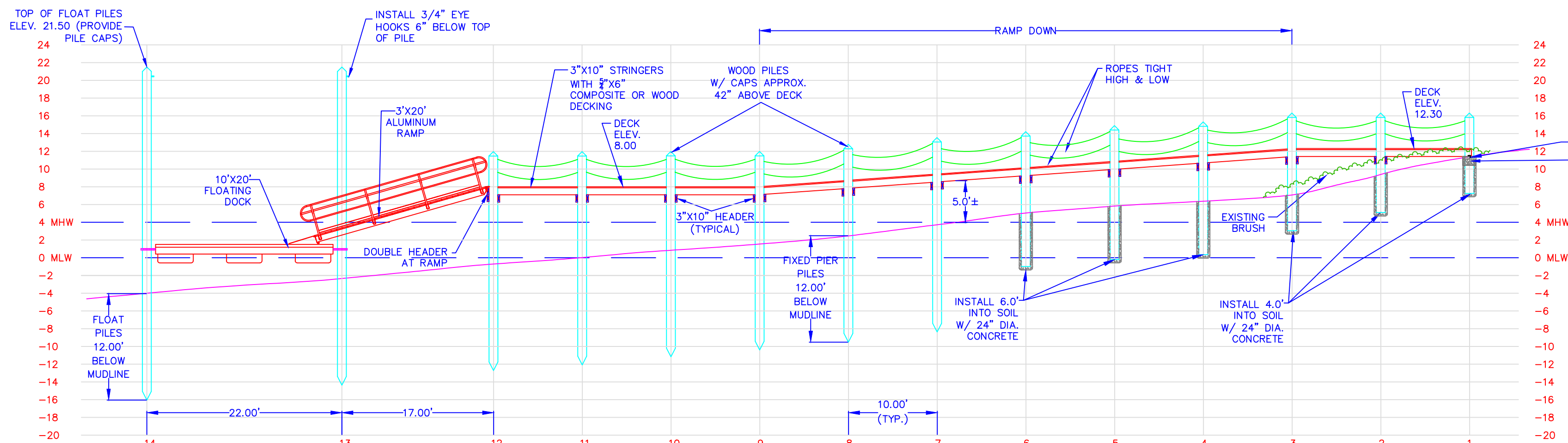

NOTE:
FLOOD ZONE IS VE (EL 17) MSL
HEIGHT OF FLOAT PILES=17+2*(MLW to MSL)+1.5*(FREEBOARD)+1=21.50

DOCK PROFILE

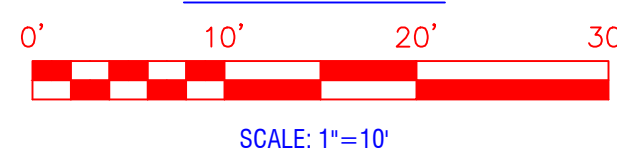

SCALE: 1"=10'

NOTE:
ALL FIXED PIER PILES SHALL BE CLASS A 14\"/>

NOTE:
INSTALL 4\"/>

NOTES:

EXTERIOR STRINGERS SHALL BE FASTENED TO PILES WITH SPLICE BLOCKS (SEE DETAIL) AT ALL BUTT SPLICE LOCATIONS.
INTERIOR STRINGERS SHALL BE FASTENED TO HEADERS WITH STEEL ANGLE CLIPS (SEE DETAIL) ONE AT EACH HEADER LOCATION.

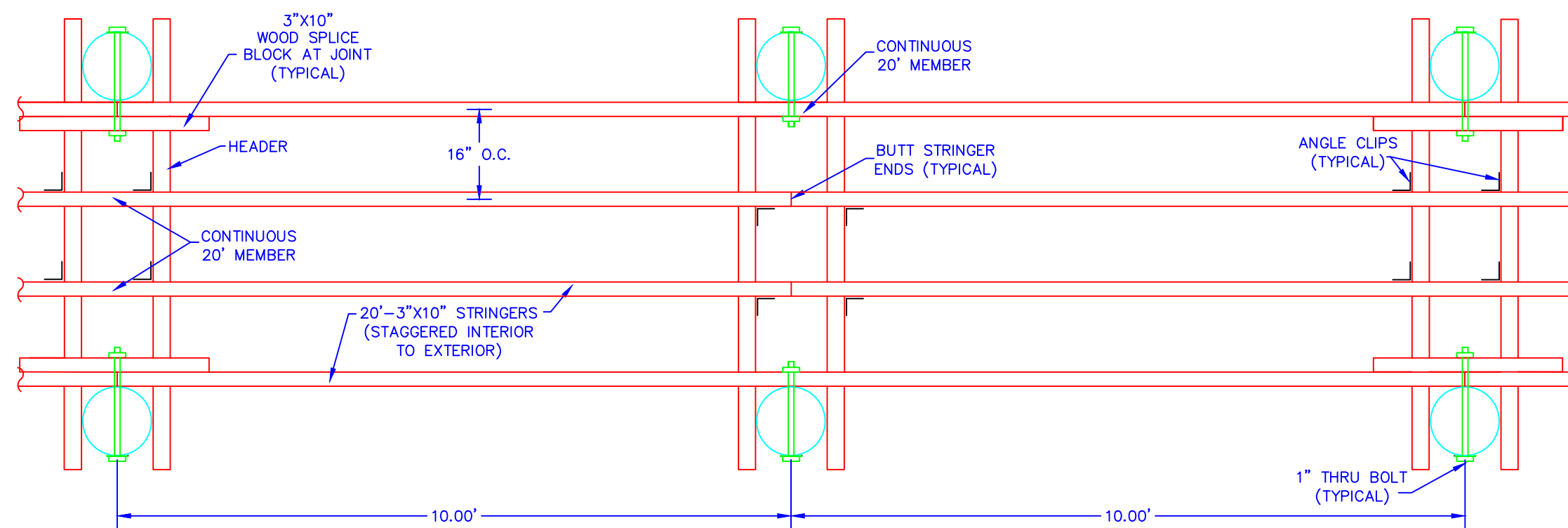

TYPICAL STRINGER LAYOUT
NOT TO SCALE

NOTE:
PROVIDE STRINGERS @ 16\"/>

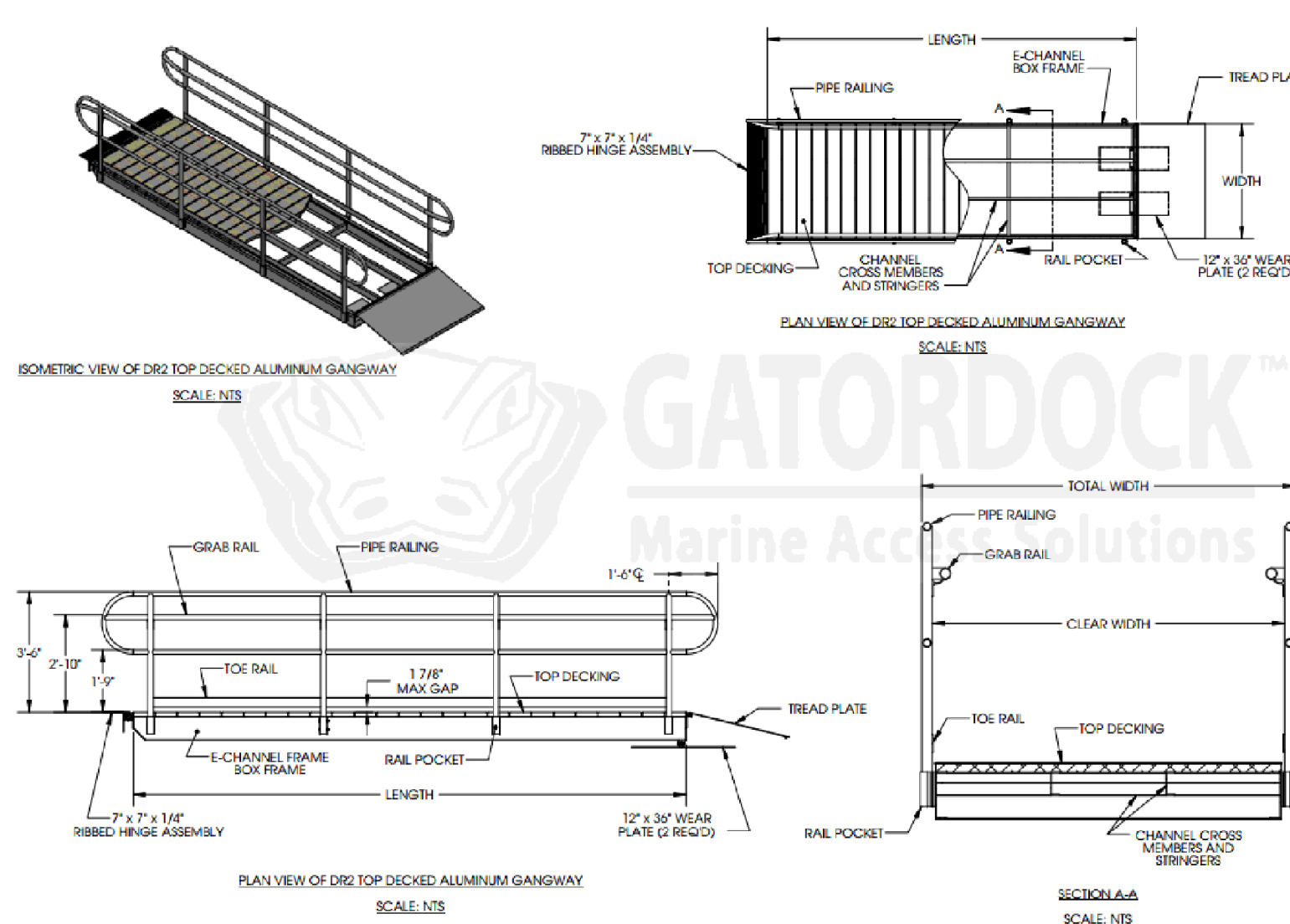

PROPOSED ALUMINUM RAMP
NOT TO SCALE

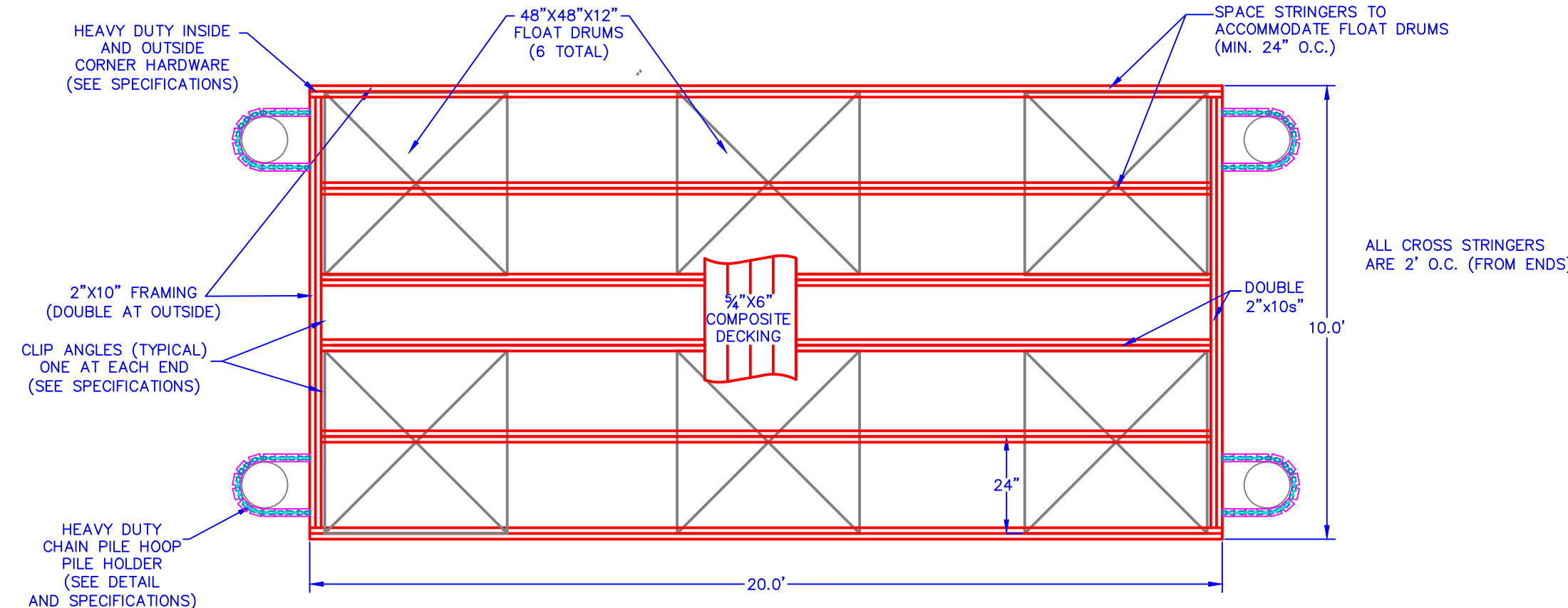

SCALE: 1"=3'

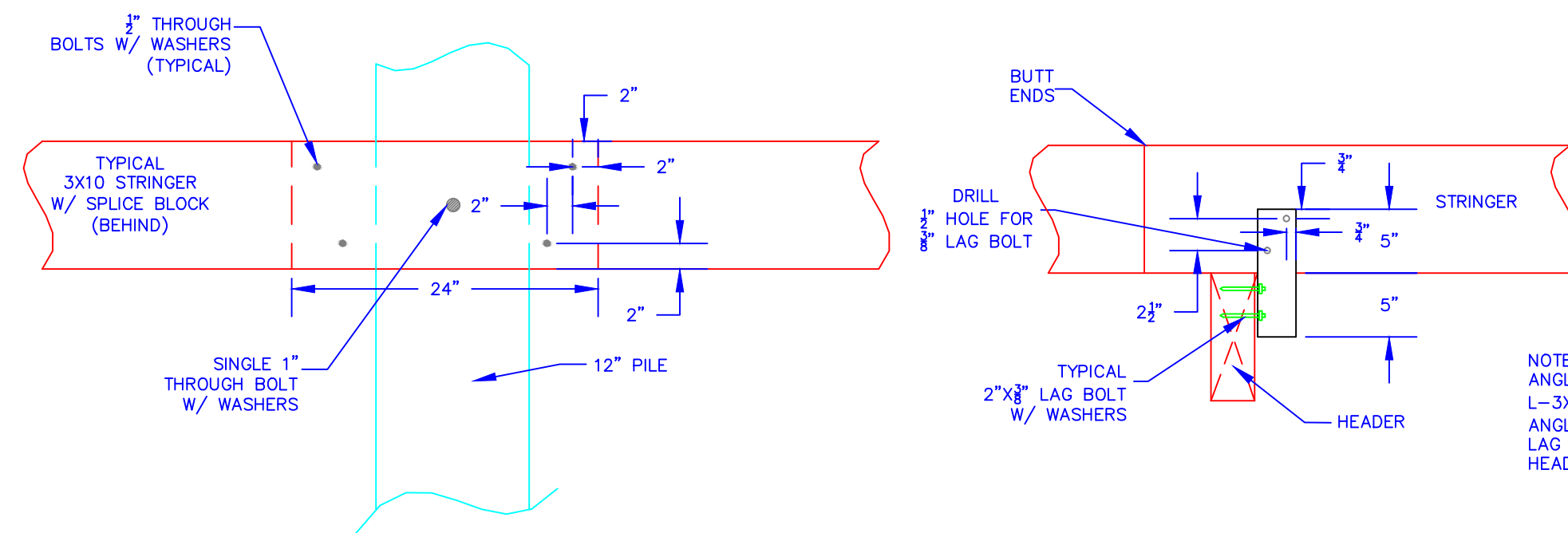

SPLICE BLOCK DETAIL
NOT TO SCALE

STRINGER HEADER CONNECTION DETAIL
NOT TO SCALE

NOTE:
ANGLE CLIPS SHALL BE L=3X3X $\frac{3}{8}$ X 10\"/>

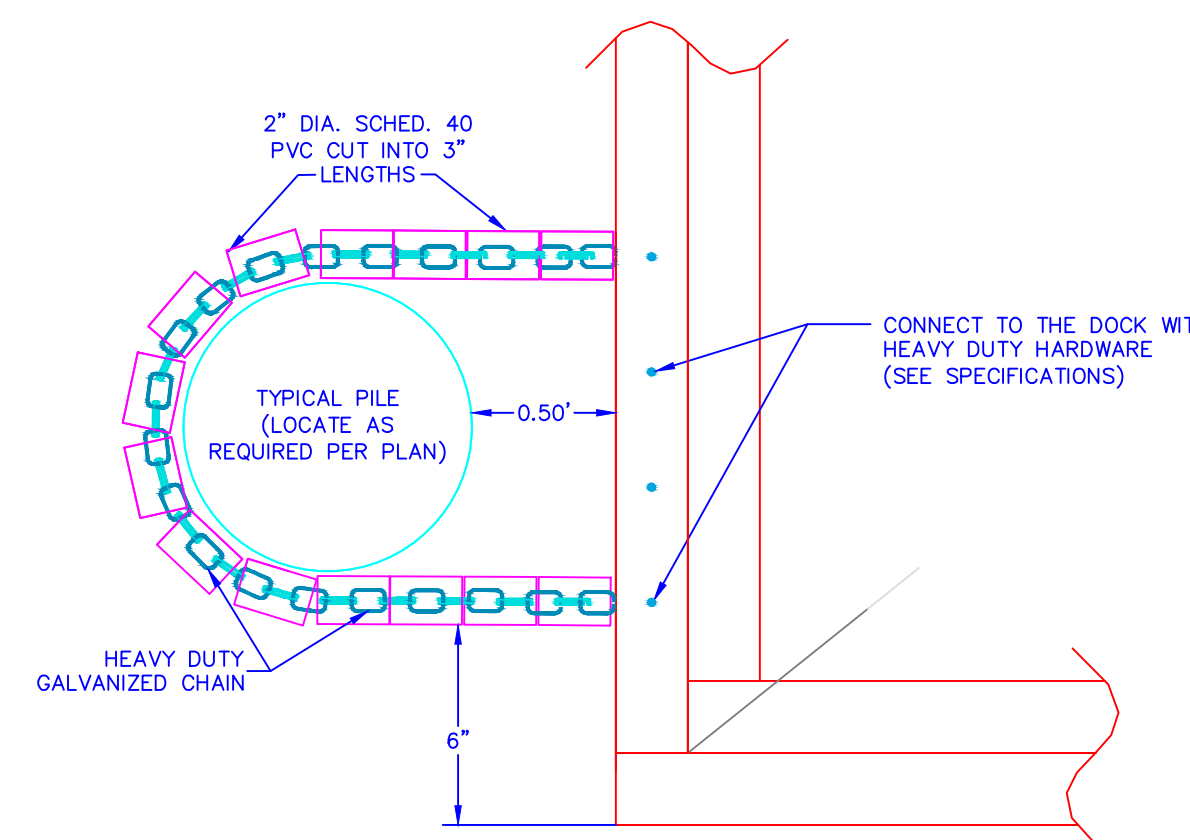

CHAIN HOOP DETAIL

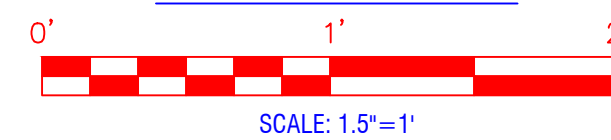

SCALE: 1.5"=1'

OWNER/SITE LOCATION:
ANDREW TAFT DIXON &
JENNIFER SARAH CASSELLS TE
484 POPPASQUASH RD.
BRISTOL, RI 02809

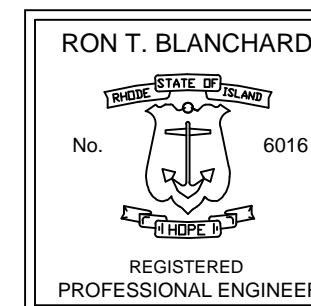

DOCK PROFILE & DETAILS
RESIDENTIAL BOATING FACILITY

PLAT 173, LOT 51

484 POPPASQUASH RD.

RHODE ISLAND.

BRISTOL, RI 02809

PHONE: (401) 253-8231

SITE ENGINEERING INC. SEI
CIVIL • COASTAL • STRUCTURAL

DSGN. RB
DR. VS
CHK. RB
DATE: 5/25/21

REVISIONS PER CRC & CLIENT COMMENTS	DATE	DESCRIPTION	REVISIONS
001	6/30/21		APP'VD
002	11/2/21	REVISED TO ELIMINATE BOAT LIFT	

SCALE: AS NOTED
(SHEET 2 OF 2)

DK-2