



State of Rhode Island
Coastal Resources Management Council
Oliver H. Stedman Government Center
4808 Tower Hill Road, Suite 3
Wakefield, RI 02879-1900

(401) 783-3370
Fax (401) 783-2069

PUBLIC NOTICE

File Number: 2022-04-098 Date: August 18, 2022

This office has under consideration the application of:

Equity Investment Group LLC
845 Main Street
East Greenwich, RI 02818

for a State of Rhode Island Assent to construct and maintain: a 4' x 159' fixed timber pier residential boating facility. Variance is requested from 650-RICR-20-00-1.3.1.D.11.k (3) (pier is within 25' of both abutting property lines) and 650-RICR-20-00-1.3.1.D.11.l.(2) , standard length is 50' beyond Mean Low Water (pier is to extend 115 feet beyond mean low water).

Project Location:	32 Bayside Avenue
City/Town:	Newport
Plat/Lot:	9 / 299
Waterway:	Narragansett Bay, East Passage

Plans of the proposed work can be requested at Cstaff1@crmc.ri.gov.

In accordance with the Administrative Procedures Act (Chapter 42-35 of the Rhode Island General Laws) you may request a hearing on this matter.

You are advised that if you have good reason to enter protests against the proposed work it is your privilege to do so. It is expected that objectors will review the application and plans thoroughly, visit site of proposed work if necessary, to familiarize themselves with the conditions and cite what law or laws, if any, would in their opinion be violated by the work proposed.

If you desire to protest, you must attend the scheduled hearing and give sworn testimony. A notice of the time and place of such hearing will be furnished you as soon as possible after receipt of your request for hearing. If you desire to request a hearing, to receive consideration, it should be in writing (**with your correct mailing address, e-mail address and valid contact number**) and be received at this office on or before September 18, 2022.

Please email your comments/hearing requests to: cstaff1@crmc.ri.gov; or mail via USPS to: Coastal Resources Management Council; O. S. Government Center, 4808 Tower Hill Road, Rm 116; Wakefield, RI 02879.

/lat



NEWPORT NATURAL STATION

CYPRESS

STREET

260

354 181

BAYSIDE

196

151

152

300

299

198

177

298

297

199

413

Proposed Pier
32 Bayside

PELL Bridge

413

146 383 2

SYCAMORE

ST

279

214

185

145

288

267

266

215

147

144

280

232

207

148

131

287

262

201

192

143

124

220

128

99

182

101

98

119

VAN

Z ANDT

352

334

333

186

113

120

286

191

336

210

132

103

353

347

339

205

127

107

109

WASHINGTON

ST.

AVENUE

STREET

BAYSIDE

Portion of Assessors Plat 9
Newport, RI

4/9/22

RECEIVED
APR 21 2022
COASTAL RESOURCES
MANAGEMENT COUNCIL

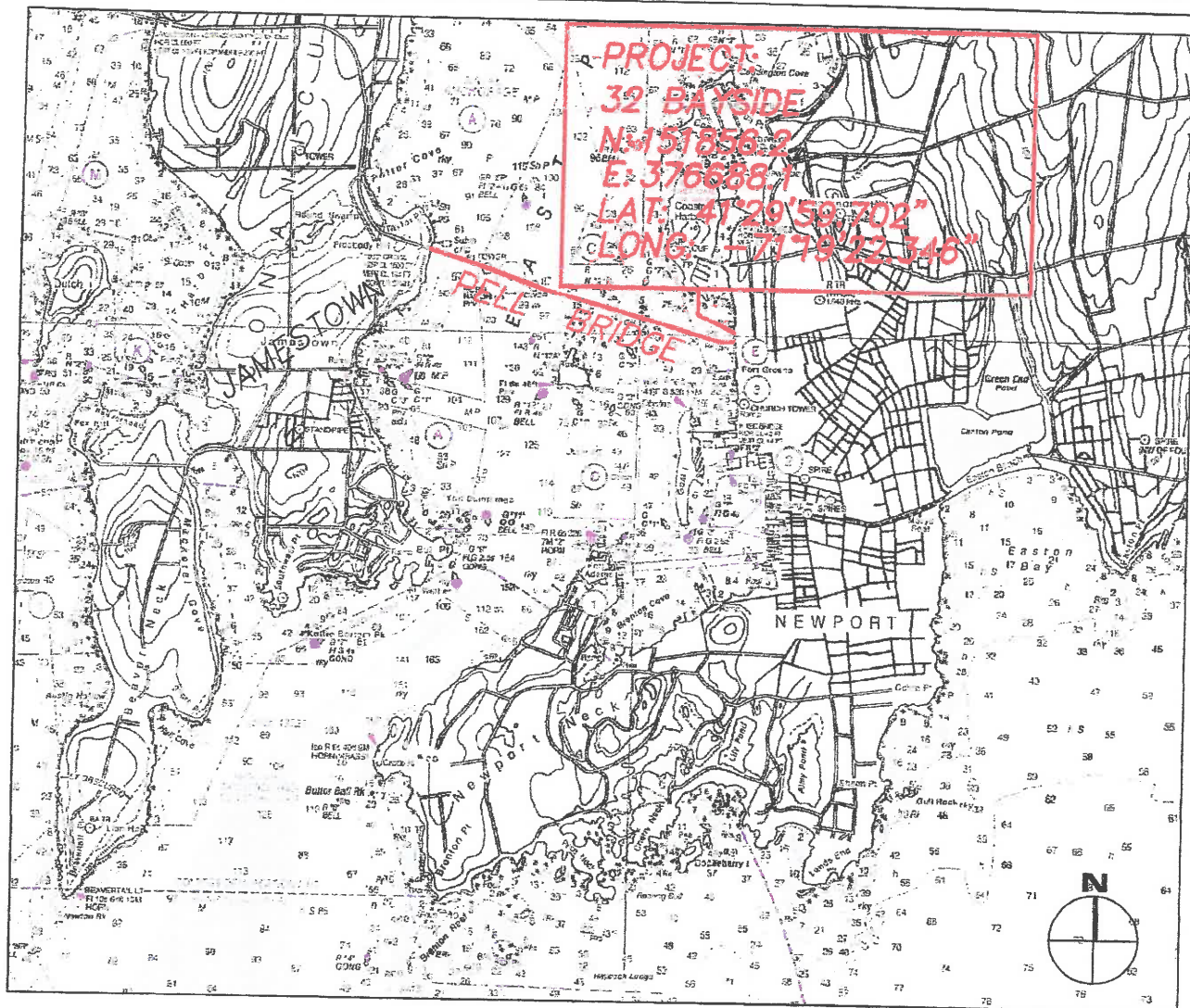

INDEX TO SHEETS:

SHEET 1: LOCUS
SHEET 2: PLAN VIEW
SHEET 3: PLAN & PROFILE
SHEET 4: TYP SECTION

RECEIVED

APR 21 2022

COASTAL RESOURCES
MANAGEMENT COUNCIL

PROPOSED RESIDENTIAL SAV PIER
EQUITY INVESTMENT GROUP, LLC
AP 9, LOTS 299 & 300
32 BAYSIDE AVE., NEWPORT, RI
BY: WARREN HALL, CIVIL ENGINEER
SHEET 1 OF 4 4-9-22

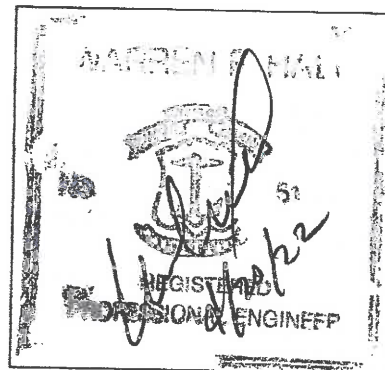

NOTE: LOT A & LOT B DESIGNATION
FOR CRMC REQUIRED DECLARATION
OF RESTRICTIVE COVENANTS

BM = BENCHMARK: SET 60D SPIKE
EL=14.22 MLW

PLAN REFERENCE:

- 1) "PLAT OF WASHINGTON STREET
EXTENSION ... 1"=100'... 9-13-1915"
- 2) "PLAT OF A PORTION OF
WASHINGTON STREET BOULEVARD
DATED 8-6-1917 ..."
- 3) RIDOT PLAT 1515
- 4) BOUNDARY SURVEY "EQUITY
INVESTMENT GROUP LLC ASSESSORS
PLAT 9 LOTS 299 & 300 ... BY
NATIONAL SURVEYORS ... DATED
DECEMBER 2021

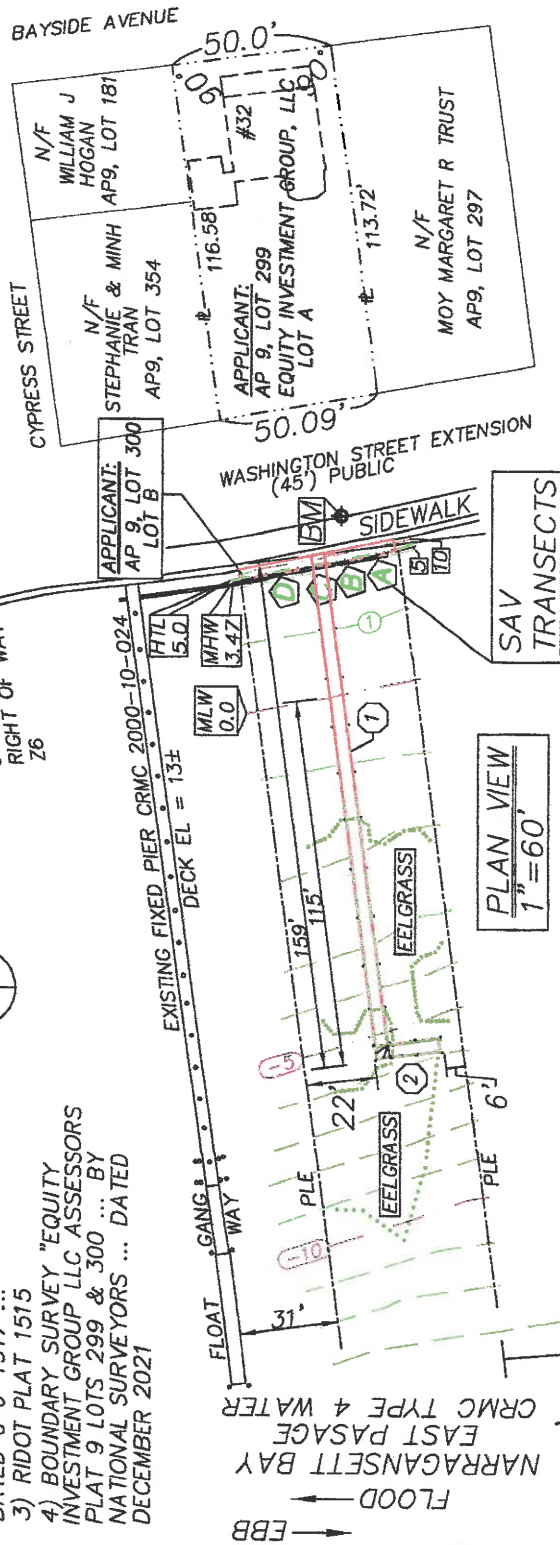

PLAN VIEW
1"=60'

LEGEND

- HTL HIGH TIDE LINE 5.0
 MHW MEAN HIGH WATER 3.47
 MLW MEAN LOW WATER 0.0
 PL PROPERTY LINE
 FND FOUND
 SAV SUBMERGED AQUATIC
 VEGETATION
 SAV TRANSECT

CERTIFICATION
THIS SURVEY HAS BEEN CONDUCTED AND THE PLAN HAS BEEN PREPARED
PURSUANT TO 435-RICR--00-00-1.9 OF THE RULES AND REGULATIONS
ADOPTED BY THE RHODE ISLAND STATE BOARD OF REGISTRATION FOR
PROFESSIONAL LAND SURVEYORS ON APRIL 28, 2018, AS FOLLOWS:

LIMITED CONTENT BOUNDARY SURVEY CLASS 1
 TOPOGRAPHIC SURVEY CLASS T-1

THE PURPOSE FOR THE CONDUCT OF THE SURVEY AND FOR PREPARATION OF THE PLAN IS AS FOLLOWS:

SHOW THE RELATIVE LOCATION OF A PROPOSED PIER WITH RESPECT TO THE PROPERTY LINE EXTENSION; PER CRMC 1.3.1.D.11.k

BY: W. L. L. 4/20/22
WARREN HALL, PLS #1917
LS. 000A291-COA

RECEIVED

APR 21 2022

COASTAL RESOURCES
MANAGEMENT COUNCIL

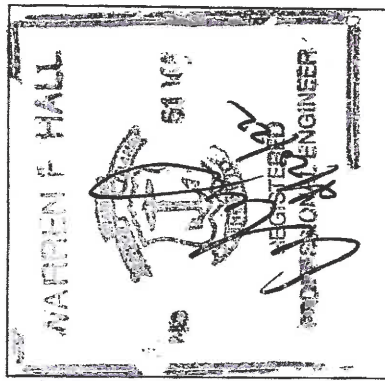

PROPOSED RESIDENTIAL SAV PIER
EQUITY INVESTMENT GROUP, LLC
AP 9, LOTS 299 & 300
32 BAYSIDE AVE., NEWPORT, RI
BY: WARREN HALL, CIVIL ENGINEER
SHEET 2 OF 4 4-9-22

SHEET 2 OF 4 4-9-22

BURDICK & SHORT
 $H = 3m + 2m(X) + 2m(Y), Y = .4$ (4' PIER)
 $H = 3 + 2(7.2) + .08 = 4.52m = 14.83'$
 $H = 3 + 2(0) + .08 = 4.52m = 10.1'$ (ACCESS)

NARRAGANSETT BAY
 EAST PASSAGE
 CRMC TYPE 4 WATER
 FLOOD

PROPOSED DECK ELEVATION
 SCALE 1" = 50'

AREA BELOW HIGH
 TIDE LINE = 28 x .785 =
 21 SQUARE FEET

RECEIVED
 APR 21 2022

HTL 5.0
 MHW 3.47
 MLW 0.00

FIXED ACCESS
 DECK EL = 7.1

4'x154' FIXED PIER
 4'x20' FIXED ACCESS
 PIER, DECK EL = 7.1

CONTRACTOR SHALL KEEP RECORD OF
 ALL PILE LENGTHS, LOCATION AND CUT OFF
 LENGTHS, RECORD TO BE SUBMITTED TO
 OWNER FOR VERIFICATION OF EMBEDMENT

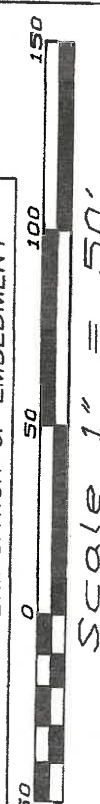

WASHINGTON STREET
 EXTENSION (45')

GRASS AREA

CONCRETE SIDEWALK

CHAIN LINK FENCE

CONCRETE SEAWALL

MHW

AP9, LOT 300 LOT B

PROPOSED 5' GATE

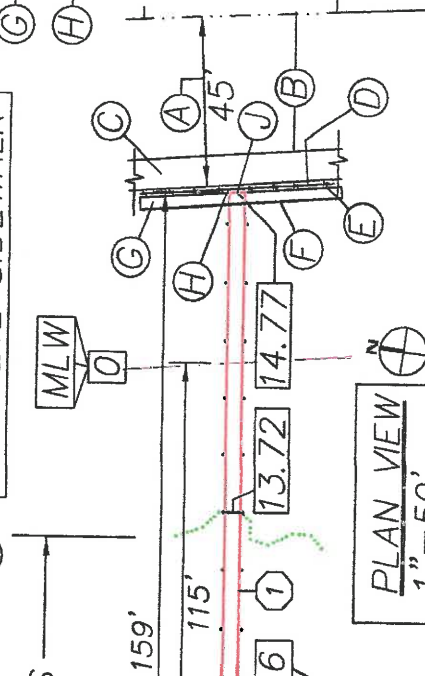

PLAN VIEW
 1" = 50'

RI STATE PLANE

J N: 151875.2
 E: 376844.6

K N: 151856.2
 E: 376688.1

L N: 151836.4
 E: 376690.8

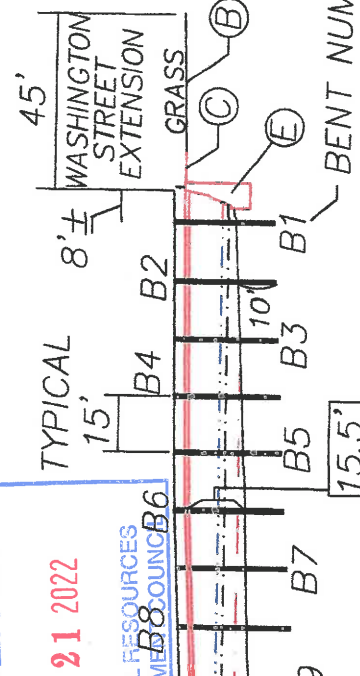

PROFILE VIEW
 1" = 50'

EXISTING BOTTOM
 PROFILE, HARD PACK
 SAND AND LEDGE

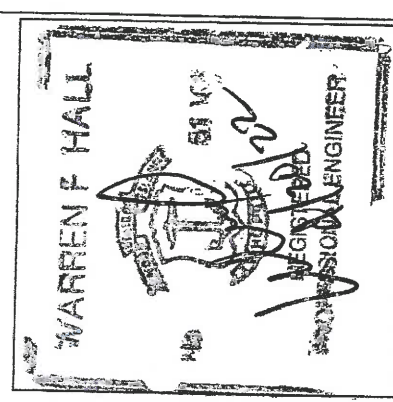

PROPOSED RESIDENTIAL SAV PIER
 EQUITY INVESTMENT GROUP, LLC
 AP 9, LOTS 299 & 300
 32 BAYSIDE AVE., NEWPORT, RI
 BY: WARREN HALL, CIVIL ENGINEER
 SHEET 3 OF 4 4-9-22

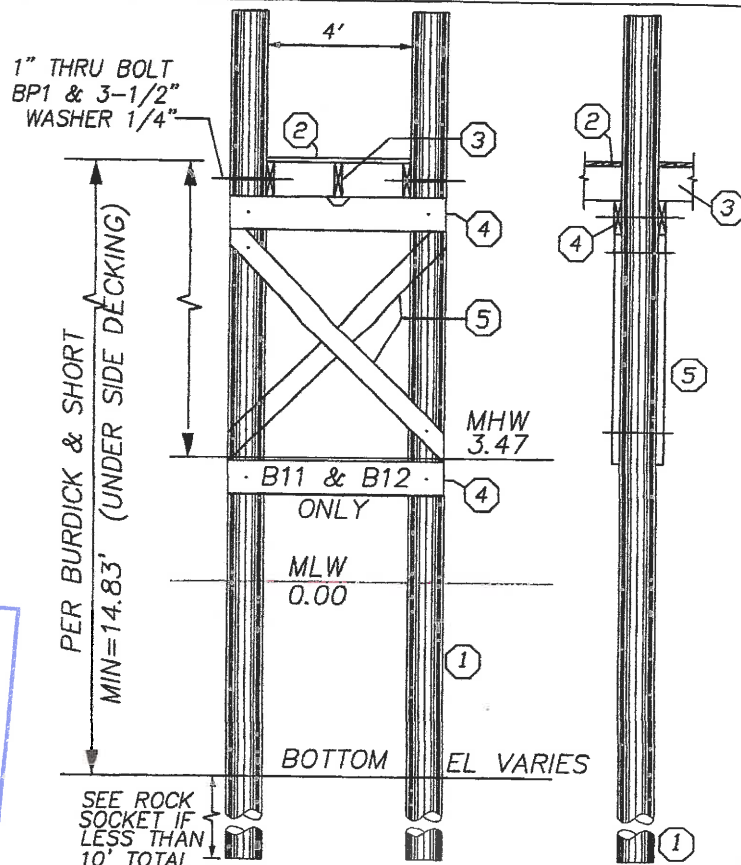

TYPICAL PILE SECTIONS
3/16"=1'-0"

**** CONTRACTOR SHALL DRIVE TEST PILES TO DETERMINE DEPTH OF EMBEDMENT PRIOR TO BEGINNING WORK****
EACH PILE SHALL BE MARKED AT 1' INTERVALS TO DETERMINE EMBEDMENT

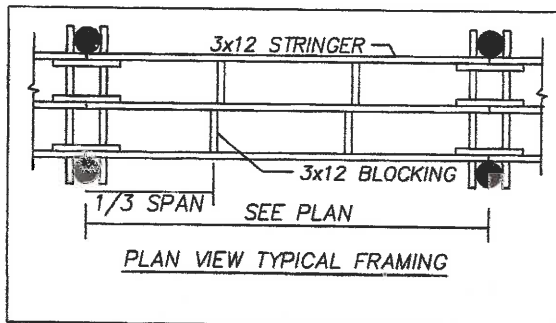

- ① 12-3-10" TIP CCA TREATED WOOD PILES TREAT TO 2.5 PCF
- ② 2x8 DECKING ACQ TREATED TO .6 PCF FASTEN TO STRINGERS WITH 3 @ 3-1/2" NO. 10 316 STAINLESS STEEL SCREWS
- ③ 3x12 STRINGER, ACQ TREATED THRU BOLT AT PILE FASTEN MIDDLE STRINGER WITH SIMPSON H-1 HURRICANE ANCHOR
- ④ 2-3x12 CAP BEAM, ACQ TREATED TO .6 PCF
- ⑤ 3x10 CROSS BRACE, ACQ TREATED TO 2.5 PCF

GENERAL NOTES:

- 1) ALL BOLTS, CONNECTORS, WASHERS, NAILS, ECT SHALL BE HOT DIPPED GALVANIZED
- 2) CONTRACTOR SHALL ADHERE TO ALL OSHA RULES AND REGULATIONS THROUGHOUT ALL PHASES OF CONSTRUCTION
- 3) CONTRACTOR SHALL BE AWARE THAT THE STRATA INTO WHICH THESE PILES ARE TO BE DRIVEN MAY REQUIRE DRILLING TO ENSURE A MINIMUM 10' PENETRATION BELOW EXISTING GRADE

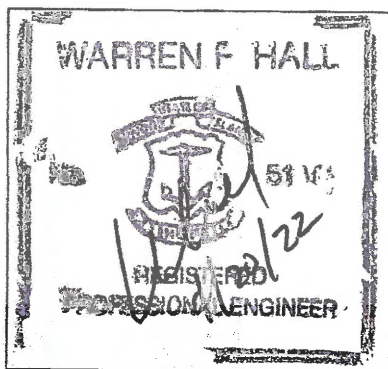

PILE DRIVING NOTE:

A "soft start" is required to allow animals an opportunity to leave the project vicinity before sound pressure levels increase. In addition to using a soft start at the beginning of the work day for pile driving, one must also be used at any time following cessation of pile driving for a period of 30 minutes or longer. For impact pile driving: pile driving will commence with an initial set of three strikes by the hammer at 40% energy, followed by a one minute wait period, then two subsequent 3-strike sets at 40% with one minute waiting periods, before initiating continuous impact driving.

PROPOSED RESIDENTIAL SAV PIER
EQUITY INVESTMENT GROUP, LLC
AP 9, LOTS 299 & 300
32 BAYSIDE AVE., NEWPORT, RI
BY: WARREN HALL, CIVIL ENGINEER
SHEET 4 OF 4 4-9-22