State of Rhode Island
Coastal Resources Management Council
Oliver H. Stedman Government Center
4808 Tower Hill Road, Suite 3
Wakefield, RI 02879
(401)783-3370

State of Rhode Island
Department of Environmental Management
Office of Technical and Customer Asst.
235 Promenade Street
Providence, RI 02908-5767
(401)222-6822

15-Day JOINT PUBLIC NOTICE

CRMC File No.: 2024-11-050
Date: 12/18/2024

RIDEM Water Quality Certification Number: WQC 24-183; DP24-204

These offices have under consideration the application of:

Town of Portsmouth
2200 East Main Road
Portsmouth, RI 02871

for State of Rhode Island Assent (in accordance with the Coastal Resources Management Program), and State of Rhode Island Water Quality Certification (in accordance with Chapter 42-35 pursuant to Chapters 46-12 and 42-17.1 of the RIGL, as amended).

To conduct dredging at the town's emergency services dock located on Prudence Island in order to restore its use. The dredge area will approximately be 360 cy yards from a 40-foot-long, 3-foot-wide, 3-foot-deep segment at mean low tide. The disposal of the material will be reused on Prudence Island above the high tide line on the adjacent beach, Prudence Island Beach.

Project Location: Town of Portsmouth - Prudence Island
Street & Number: Landing Lane - Prudence Island
City/Town: Portsmouth
Plat Number: 82 Lot Number: A

Plans of the proposed work may be seen at the CRMC office in Wakefield.

In accordance with the Administrative Procedures Act (Chapter 42-35 of the Rhode Island General Laws) you may request a hearing on this matter. You are advised that if you have good reason to enter protests against the proposed work it is your privilege to do so. It is expected that objectors will review the application and plans thoroughly, visit site of proposed work if necessary, to familiarize themselves with the conditions and cite what law or laws, if any, would in their opinion be violated by the work proposed.

This also serves as notice that the Rhode Island Department of Environmental Management, Office of Water Resources, Water Quality Certification Program has under consideration and review the same proposed activity as described above for compliance with the State's Water Quality Regulations (AUTHORITY: in accordance with Clean Water Act, as amended (33 U.S.C. 1251 et.seq.; Chapter 42-35 pursuant to Chapters 46-12 and 42-17.1 of the Rhode Island General Laws of 1956, as amended).

If you desire to protest, you must attend the scheduled hearing and give sworn testimony. A notice of the time and place of such hearing will be furnished you as soon as possible after receipt of your request for hearing. If you desire to request a hearing, to receive consideration, it should be in writing and be received at this office on or before **January 05, 2025**. Please provide comments via email at cstaffl@crmc.ri.gov or via USPS to Coastal Resources Management Council, O. S. Government Center, 4808 Tower Hill Road, Rm 116; Wakefield, RI 02879.

It is expected that objectors will review the application and associates plans thoroughly. Comments that pertain to this Joint Notice must be submitted in writing and must be addressed to Rhode Island Coastal Resources Management Council and Rhode Island Department of Environmental Management at the above referenced addresses.



RECEIVED

11/15/2024

COASTAL RESOURCES
MANAGEMENT COUNCIL

STANDARD SPECIFICATIONS AND JOB SPECIFIC SPECIFICATIONS

PROPOSAL NO. P21-001
2020-2021 SAND POINT EMERGENCY OPERATION DOCK

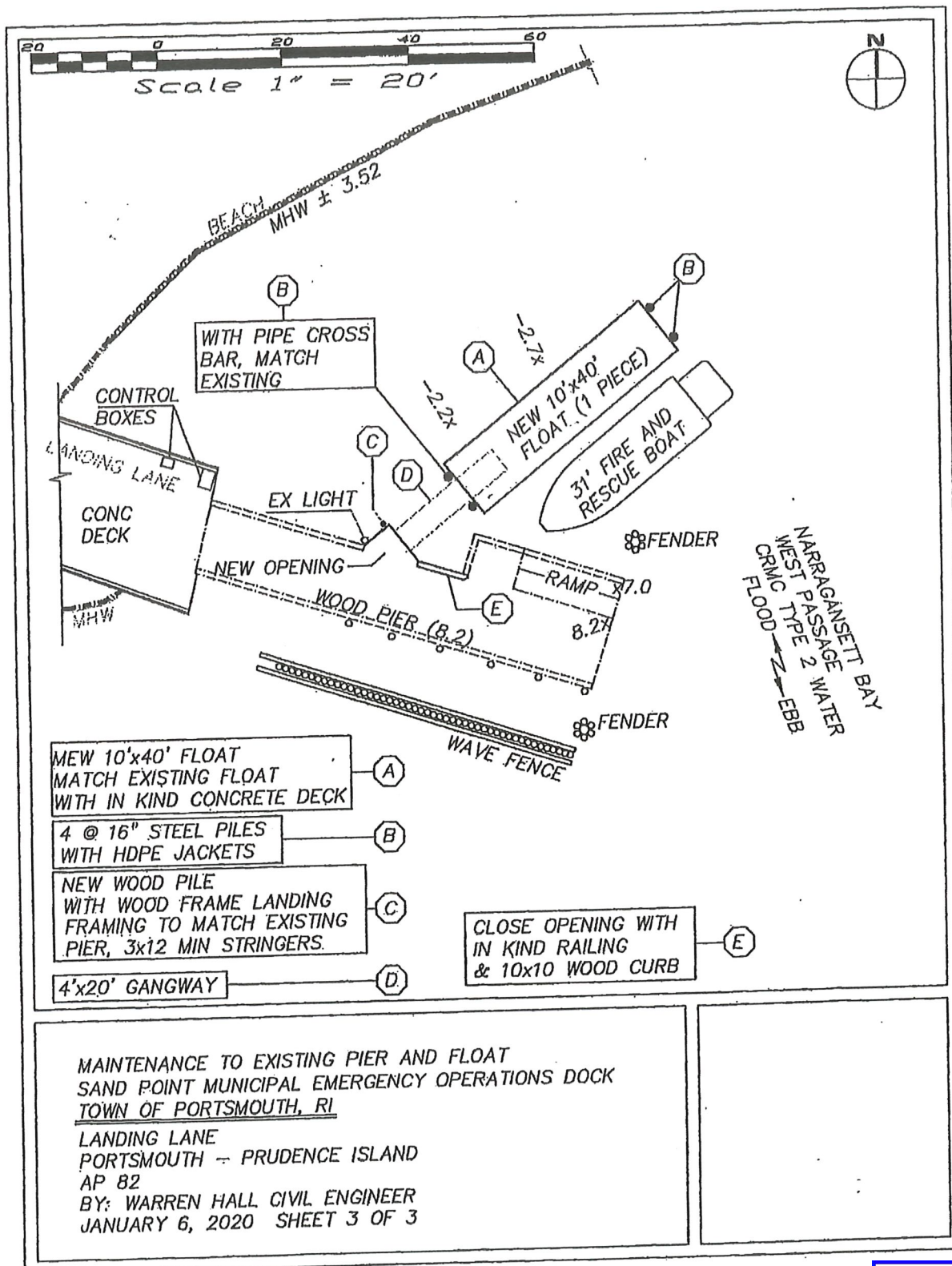

RECEIVED

11/15/2024

COASTAL RESOURCES
MANAGEMENT COUNCIL