



State of Rhode Island
Coastal Resources Management Council
Oliver H. Stedman Government Center
4808 Tower Hill Road, Suite 3
Wakefield, RI 02879-1900

(401) 783-3370
Fax (401) 783-2069

PUBLIC NOTICE

File Number: 2025-02-058 Date: March 31, 2025

This office has under consideration the application of:

Timothy Shea
129 Charlotte Drive
East Greenwich, RI 02818

for a State of Rhode Island Assent to construct and maintain:

A modification to an approved residential boating facility is proposed to consist of a 4'x95' residential pier terminating with an 8'x18.75' float. Pier will extend an additional 9' to 75' beyond mean low water where 50' is allowed. A variance is requested to Section 1.3.1(D)(6)(f)(3) of the RI CRMP. In addition a boat lift and personal water craft boat lift are proposed. The facility will be located 10.8' from the property line extension where 25' is required. A letter of no objection has been submitted by the affected abutting neighbor

Project Location:	129 Charlotte Drive
City/Town:	Warwick
Plat/Lot:	Plat 201, lot 113
Waterway:	Greenwich Bay

Plans of the proposed work can be requested at Cstaff1@crmc.ri.gov.

In accordance with the Administrative Procedures Act (Chapter 42-35 of the Rhode Island General Laws) you may request a hearing on this matter.

You are advised that if you have good reason to enter protests against the proposed work it is your privilege to do so. It is expected that objectors will review the application and plans thoroughly, visit site of proposed work if necessary, to familiarize themselves with the conditions and cite what law or laws, if any, would in their opinion be violated by the work proposed.

If you desire to protest, you must attend the scheduled hearing and give sworn testimony. A notice of the time and place of such hearing will be furnished you as soon as possible after receipt of your request for hearing. If you desire to request a hearing, to receive consideration, it should be in writing (**with your correct mailing address, e-mail address and valid contact number**) and be received at this office on or before April 30, 2025.

Please email your comments/hearing requests to: cstaff1@crmc.ri.gov; or mail via USPS to: Coastal Resources Management Council; O. S. Government Center, 4808 Tower Hill Road, Rm 116; Wakefield, RI 02879.

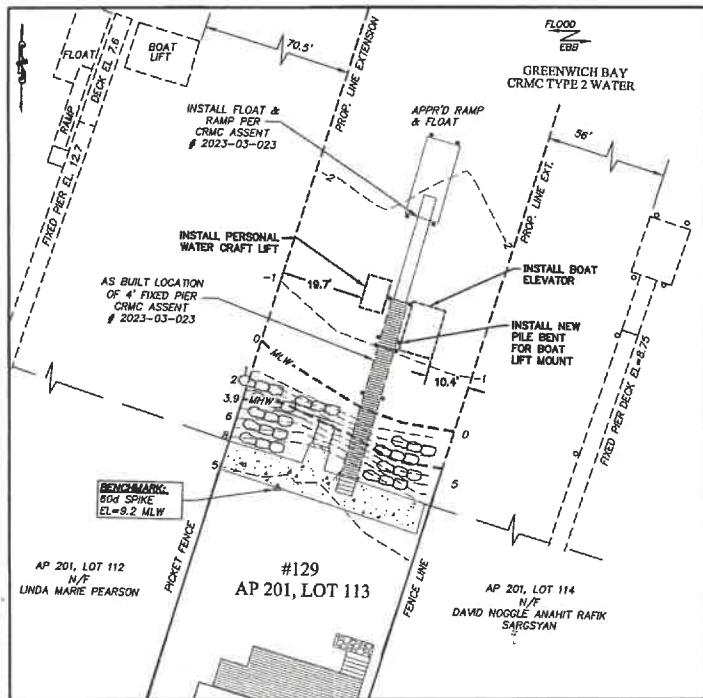

SCALE 1" = 20'

SITE PLAN

SCALE 1" = 20'



AERIAL PLAN

NTS

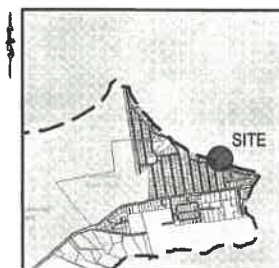

LOCATION MAP
NOT TO SCALE

CONSTRUCTION NOTES:

1. ALL CONSTRUCTION METHODS SHALL MEET APPLICABLE BUILDING CODES.
2. PIER CONSTRUCTION SHALL MATCH EXISTING WHERE APPLICABLE OTHERWISE SEE BELOW.
3. ALL PILES TO BE GLASS "1" SYP-2.5 CCA. W/ STEEL DRIVING TIPS.
4. CROSS BRACES ON FIXED PIER SHALL BE SYP-2.5 CCA.
5. ALL FIXED PIER STRINGERS, CLAMP HEADERS, AND DOCKING SHALL BE SYP #2 SYP-1.0 CCA.
6. ALL HARDWARE TO BE A307 HDG STEEL.
7. WOODEN PILES SHALL BE DRIVEN A MIN. OF 10' EMBEDMENT, IF REFUSAL IS ENCOUNTERED W/ LESS THAN 10' OF EMBEDMENT PILE SOCKETS SHALL BE USED (SEE DETAIL).
8. VERTICAL DATING: MLW
9. CONTRACTOR TO RUN WATER AND ELECTRIC TO END OF FIXED PIER

NOAA / NOS TIDAL DATUMS:

WARWICK PT = NOAA TIDAL STATION 8453572

MHW = 3.9 MHW = 2.0
MVD88 = 1.9 MVD88 = 0.0
MLW = 0.0 MLW = -1.9
MLW = -0.2 MLW = -2.1

OWNER:

TIMOTHY PATRICK SHEA
129 CHARLOTTE DRIVE
WARWICK, RI 02886

NOTES:

1. EXISTING CONDITIONS AS-BUILT BY MILLSTONE LLC IN OCTOBER 2024.
2. VERTICAL DATUM IS MLW

VARIANCE REQUESTS:

1. CLOSER THAN 25' TO REPAIRAN RIGHT LINES:
EAST ABUTMENT: 10.4' WHERE 25' IS REQUIRED +
WEST ABUTMENT: 19.7' WHERE 25' IS REQUIRED +

+ LETTER OF NO OBJECTION PROVIDED FOR BOTH ABUTMENTS

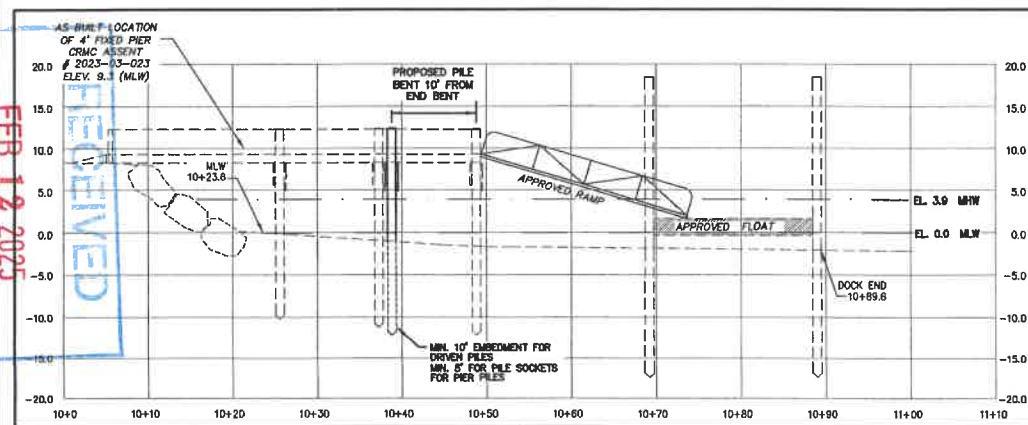

SCALE 1" = 10'

DOCK PROFILE

SCALE: HORIZ. 1" = 10'
VERT. 1" = 10'

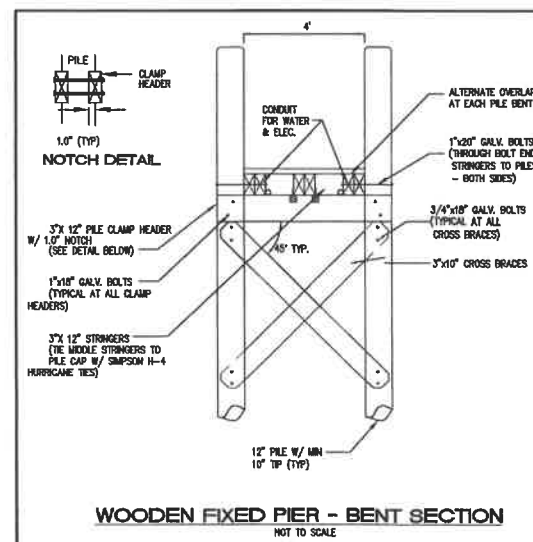

WOODEN FIXED PIER - BENT SECTION

NOT TO SCALE

NO.	DATE	REVISION	BY
1	1/12/25	CRMC	MMJ

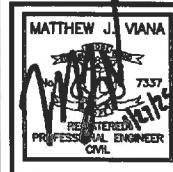

Millstone LLC
ENGINEERING • SURVEYING • PERMITTING
280 Cranville Road, Building E-12 | 790 Aqueduct Avenue, Building B
Warwick, RI 02886
www.MillstoneEng.com
P: (401) 921-3344 F: (401) 921-3303

DOCK MODIFICATION PLAN
SHEA RESIDENCE
AP 201 LOT 113
129 CHARLOTTE DR
WARWICK, RI
Prepared for:
TIMOTHY SHEA SCALE AS NOTED
OCTOBER 2024

Drawn By: MMJ
Checked By: JCH
Sheet
1
1 of 1
FILE NO.: 24.606.937

COPYRIGHT 2024
MILLSTONE LLC AND
CONTRACTORS
SHALL NOT BE USED OR
REPRODUCED WITHOUT THE
WRITTEN CONSENT OF
MILLSTONE LLC.

COASTAL RESOURCES
MANAGEMENT COUNCIL

RECEIVED
FEB 12 2025