



State of Rhode Island  
**Coastal Resources Management Council**  
Oliver H. Stedman Government Center  
4808 Tower Hill Road, Suite 3  
Wakefield, RI 02879-1900

(401) 783-3370  
Fax (401) 783-2069

## **PUBLIC NOTICE**

File Number: 2025-06-026

Date: August 19, 2025

This office has under consideration the application of:

**Department Environmental Management**  
235 Promenade St.,  
Providence, RI 02908

for a State of Rhode Island Assent to:

Repair existing infrastructure at the former Chase Marina and establish a commercial marina facility. As part of this application new docks and piles would be installed within an existing Marina Perimeter Limit (MPL). Additional work to be included: installation of a sheet pile bulkhead, repairs to rip rap slopes, raising grades to match existing conditions in parking area, construct timber walkways and docks, and reinforcement of existing granite block walls.

Project Location:	169 Riverside Drive
City/Town:	Tiverton
Plat/Lot:	Plat 303; Lots 126, 127, 128
Waterway:	Sakonnet River

Plans of the proposed work can be requested at [Cstaff1@crmc.ri.gov](mailto:Cstaff1@crmc.ri.gov).

In accordance with the Administrative Procedures Act (Chapter 42-35 of the Rhode Island General Laws) you may request a hearing on this matter.

You are advised that if you have good reason to enter protests against the proposed work it is your privilege to do so. It is expected that objectors will review the application and plans thoroughly, visit site of proposed work if necessary, to familiarize themselves with the conditions and cite what law or laws, if any, would in their opinion be violated by the work proposed.

If you desire to protest, you must attend the scheduled hearing and give sworn testimony. A notice of the time and place of such hearing will be furnished you as soon as possible after receipt of your request for hearing. If you desire to request a hearing, to receive consideration, it should be in writing (**with your correct mailing address, e-mail address and valid contact number**) and be received at this office on or before **September 19, 2025**.

Please email your comments/hearing requests to: [cstaff1@crmc.ri.gov](mailto:cstaff1@crmc.ri.gov); or mail via USPS to: Coastal Resources Management Council; O. S. Government Center, 4808 Tower Hill Road, Rm 116; Wakefield, RI 02879.



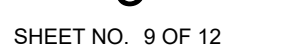



© 2025 - GZA GeoEnvironmental, Inc. GZA-J\GEO\35429.TWS\FIGURES\CAD\DWGS\CURRENT\PLANS\PERMIT SET\35429.00\_11\_PR CONDITIONS PLAN\_PHASE 2.DWG 11 April 23, 2025 GARY BASTIEN

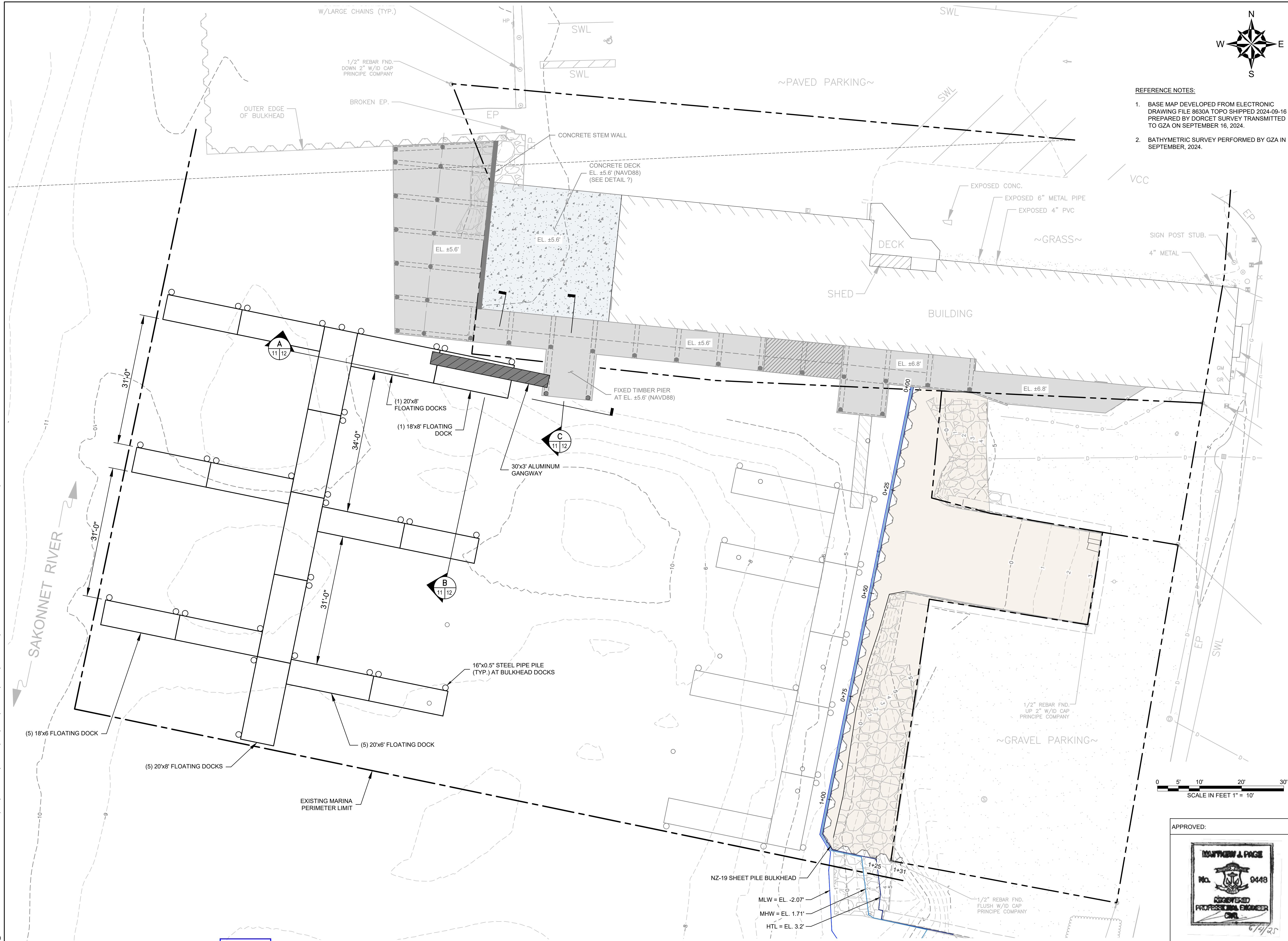

REFERENCE NOTES:

1. BASE MAP DEVELOPED FROM ELECTRONIC DRAWING FILE 8630A TOPO SHIPPED 2024-09-16 PREPARED BY DORCET SURVEY TRANSMITTED TO GZA ON SEPTEMBER 16, 2024.
2. BATHYMETRIC SURVEY PERFORMED BY GZA IN SEPTEMBER, 2024.

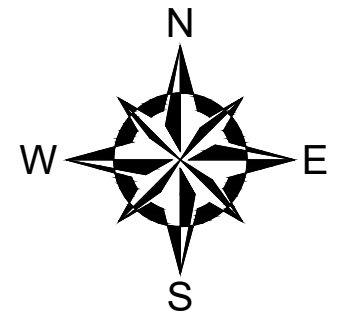

Known for excellence.  
Built on trust

PREPARED FOR:



UNLESS SPECIFICALLY STATED BY WRITTEN AGREEMENT, THIS DRAWING IS THE SOLE PROPERTY OF GZA GEOSCIENCE, INC. (GZA). THE INFORMATION SHOWN ON THE DRAWING IS SOLELY FOR USE BY GZA'S CLIENT OR THE CLIENT'S DESIGNATED REPRESENTATIVE FOR THE SPECIFIC PROJECT AND LOCATION IDENTIFIED ON THE DRAWING. THE DRAWING SHALL NOT BE TRANSFERRED, REPRODUCED, COPIED, OR ALTERED IN ANY MANNER FOR USE AT ANY OTHER LOCATION OR FOR ANY OTHER PURPOSE WITHOUT THE PRIOR WRITTEN CONSENT OF GZA. ANY TRANSFER, REUSE, OR MODIFICATION TO THE DRAWING BY THE CLIENT OR OTHERS, WITHOUT THE PRIOR WRITTEN EXPRESS CONSENT OF GZA, WILL BE AT THE USER'S SOLE RISK AND WITHOUT ANY RISK OR LIABILITY TO GZA.

PERMITTING ONLY  
NOT FOR CONSTRUCTION

REV DESCRIPTION DATE BY

PROJECT NO: 35429.00  
DATE: APRIL, 2025  
PROJECT MGR: TWS  
DESIGNED BY: JTF  
DRAWN BY: GRB  
CHECKED BY: TWS  
REVIEWED BY: MJP  
SCALE: AS NOTED  
REVISION NO.

CHASE MARINA  
169 RIVERSIDE DRIVE  
TIVERTON, RHODE ISLAND

PROPOSED CONDITIONS PLAN  
PHASE 2

DRAWING  
11  
SHEET NO. 11 OF 12



APPROVED:

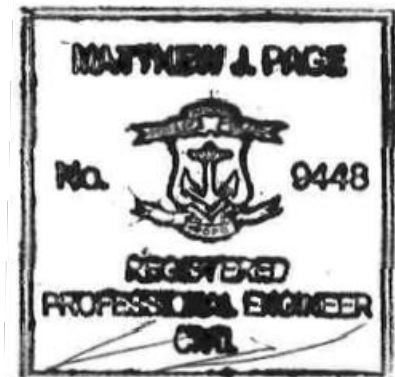



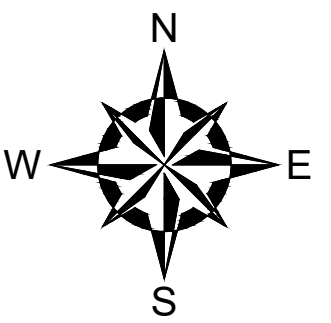

REFERENCE NOTES:

1. BASE MAP DEVELOPED FROM ELECTRONIC DRAWING FILE 8630A TOPO SHIPPED 2024-09-16 PREPARED BY DORCET SURVEY TRANSMITTED TO GZA ON SEPTEMBER 16, 2024.
2. BATHYMETRIC SURVEY PERFORMED BY GZA IN SEPTEMBER, 2024.



Known for excellence.  
Built on trust

PREPARED FOR:



UNLESS SPECIFICALLY STATED BY WRITTEN AGREEMENT, THIS DRAWING IS THE SOLE PROPERTY OF GZA GEOENVIRONMENTAL, INC. (GZA). THE INFORMATION SHOWN ON THE DRAWING IS SOLELY FOR USE BY GZA'S CLIENT OR THE CLIENT'S DESIGNATED REPRESENTATIVE FOR THE SPECIFIC PROJECT AND LOCATION IDENTIFIED ON THE DRAWING. THE DRAWING SHALL NOT BE TRANSFERRED, REPRODUCED, COPIED, OR ALTERED IN ANY MANNER FOR USE AT ANY OTHER LOCATION OR FOR ANY OTHER PURPOSE WITHOUT THE PRIOR WRITTEN CONSENT OF GZA. ANY TRANSFER, REUSE, OR MODIFICATION TO THE DRAWING BY THE CLIENT OR OTHERS, WITHOUT THE PRIOR WRITTEN EXPRESS CONSENT OF GZA, WILL BE AT THE USER'S SOLE RISK AND WITHOUT ANY RISK OR LIABILITY TO GZA.

60% DESIGN DRAWINGS  
NOT FOR CONSTRUCTION

REV	DESCRIPTION	DATE	BY

PROJECT NO: 35429.00  
DATE: JUNE, 2025  
PROJECT MGR: TWS  
DESIGNED BY: JTF  
DRAWN BY: GRB  
CHECKED BY: TWS  
REVIEWED BY: MJP  
SCALE: AS NOTED  
REVISION NO.

CHASE MARINA  
169 RIVERSIDE DRIVE  
TIVERTON, RHODE ISLAND

PROPOSED CONDITIONS PLAN - PHASE 2  
AND FINAL CONDITIONS / PUBLIC ACCESS  
PLAN

DRAWING

13

SHEET NO. 13 OF 14