



State of Rhode Island
Coastal Resources Management Council
Oliver H. Stedman Government Center
4808 Tower Hill Road, Suite 3
Wakefield, RI 02879-1900

(401) 783-3370
Fax (401) 783-2069

PUBLIC NOTICE

File Number: 2025-11-023 Date: November 25, 2025

This office has under consideration the application of:

Department of Transportation
Attn: Alisa Richardson
360 Lincoln Avenue
Warwick, RI 02888

for a State of Rhode Island Assent to construct and maintain: The proposed project includes replacement of the Washington Bridge North and Gano Street Off-Ramp; relocating Gano Street and a segment of the Blackstone River Bikeway; completing construction of the Waterfront Drive off-ramp and associated improvements; widening, full depth pavement, and mill and overlay of portions of I-195; construction of stormwater treatment units; and associated grading. a variance from the Setback standard under CRMP Section 1.1.9(E) for work activities occurring within the 50-foot Setback, including portions of the relocation of Gano Street and the Bikeway.

Project Location:	I-195 Washington Bridge (Westbound)
City/Town:	Providence
Plat/Lot:	NA
Waterway:	Seekonk River

Plans of the proposed work can be requested at Cstaff1@crmc.ri.gov.

In accordance with the Administrative Procedures Act (Chapter 42-35 of the Rhode Island General Laws) you may request a hearing on this matter.

You are advised that if you have good reason to enter protests against the proposed work it is your privilege to do so. It is expected that objectors will review the application and plans thoroughly, visit site of proposed work if necessary, to familiarize themselves with the conditions and cite what law or laws, if any, would in their opinion be violated by the work proposed.

If you desire to protest, you must attend the scheduled hearing and give sworn testimony. A notice of the time and place of such hearing will be furnished you as soon as possible after receipt of your request for hearing. If you desire to request a hearing, to receive consideration, it should be in writing (**with your correct mailing address, e-mail address and valid contact number**) and be received at this office on or before **December 25, 2025**.

Please email your comments/hearing requests to: cstaff1@crmc.ri.gov; or mail via USPS to: Coastal Resources Management Council; O. S. Government Center, 4808 Tower Hill Road, Rm 116; Wakefield, RI 02879.

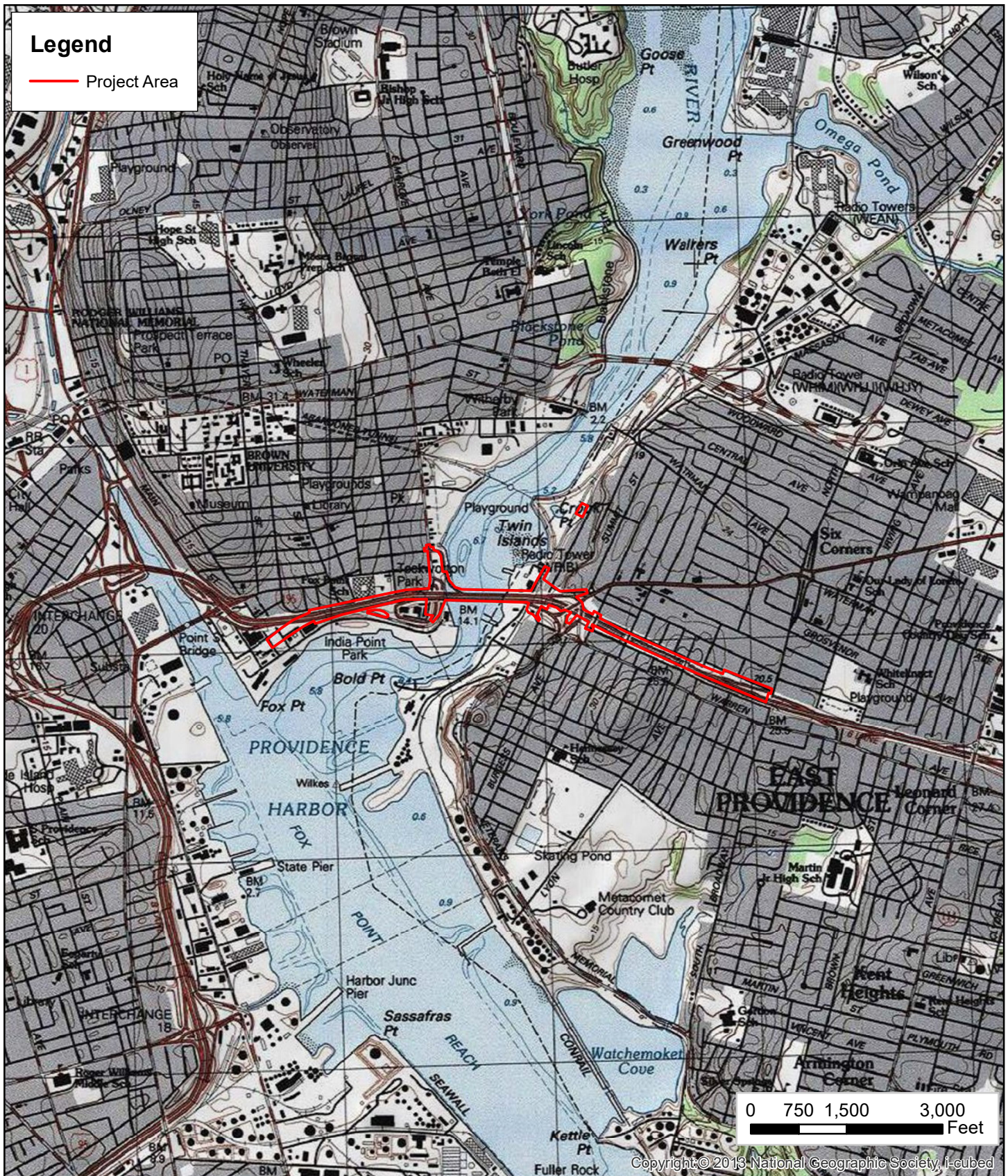

East Providence
 401.685.3109
 www.lecenvironmental.com

Figure 1: USGS Topographic Map
 Washington Bridge Replacement Project
 Providence and East Providence, Rhode Island



September 26, 2025

RECEIVED
 11/7/2025

**COASTAL RESOURCES
 MANAGEMENT COUNCIL**



STATE OF RHODE ISLAND

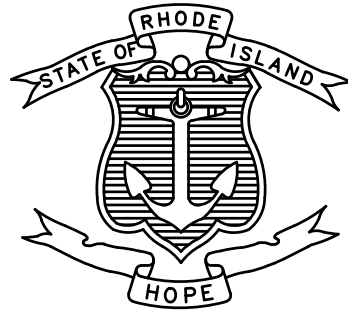

DEPARTMENT OF TRANSPORTATION

PLAN, PROFILE AND SECTIONS OF PROPOSED

INTERSTATE 195

WASHINGTON BRIDGE #700 REPLACEMENT

VOLUME 04 - BRIDGE NO. 700

CITIES OF PROVIDENCE & EAST PROVIDENCE

COUNTY OF PROVIDENCE

R.I. CONTRACT NO. 2025-DB-003 F.A. PROJECT NO. BRO-0700(012)

WASHINGTON BRIDGE I-195 WB: BEGIN STA. 315+30.00 END STA. 329+70.11

GANO STREET OFF-RAMP: BEGIN STA. 75+44.38 END STA. 78+44.38

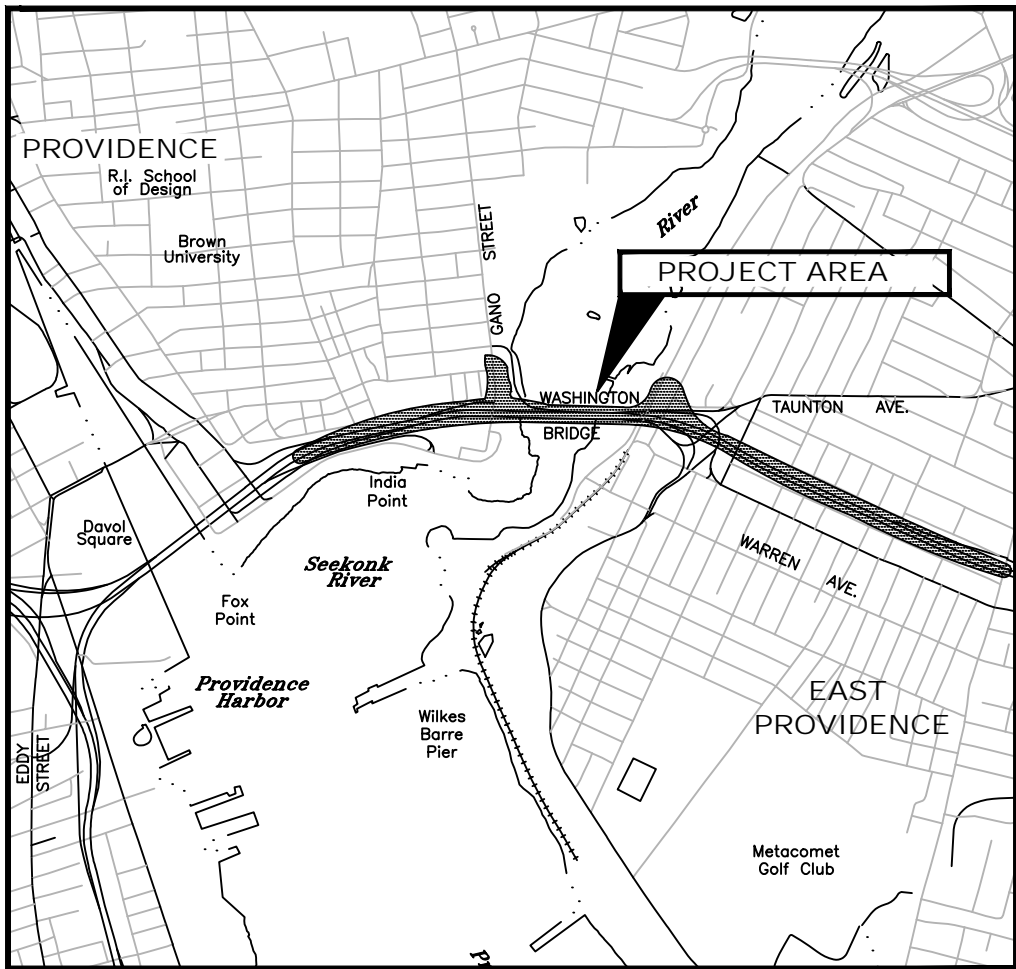

LOCATION MAP
SCALE : 1" = 2000'

BRIDGE NO. 700		GANO ST. OFF-RAMP	
AADT (2019)	96,500 V.P.D.	AADT (2019)	3,400 V.P.D.
AADT (2045)	108,300 V.P.D.	AADT (2045)	4,800 V.P.D.
D	100%/WB	D	100%/WB
K	8.1%	K	7.9%
T	5%	T	2.1%
DDHV	8,770 V.P.H.	DDHV	380
DHV	8,770 V.P.H.	DHV	380
DESIGN SPEED	50 M.P.H.	DESIGN SPEED	30 M.P.H.

HURRICANE EVACUATION ROUTE

This project includes work on a designated Hurricane Evacuation and Diversionary Route as follows:
- Interstate 195
- Ramp M
- Ramp DR-2
Refer to Note 18 on Sheet 3

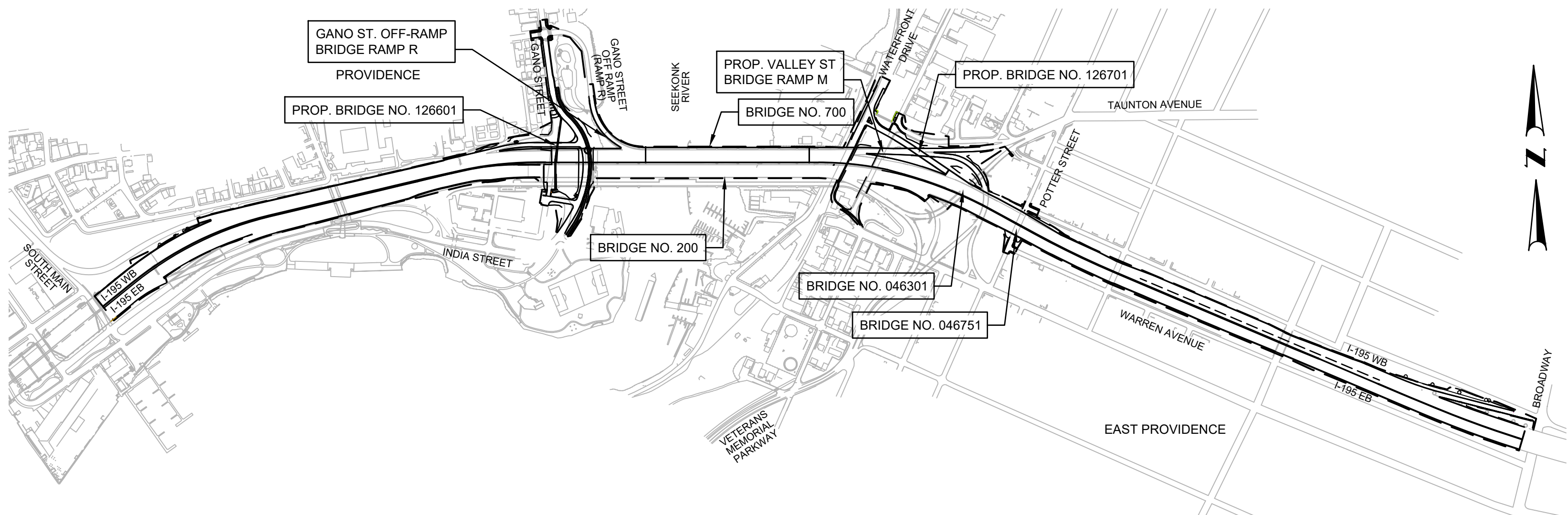

LAYOUT PLAN
SCALE: 1"=500'

BASE OF LEVELS
VERTICAL DATUM: NAVD 88
HORIZONTAL DATUM: R.I. STATE PLANE, NAD 83

LIST OF VOLUMES

- VOLUME 1 - WASHINGTON BRIDGE #700 REPLACEMENT HIGHWAY DRAWINGS
- VOLUME 2 - WASHINGTON BRIDGE #700 REPLACEMENT HIGHWAY CROSS SECTIONS
- VOLUME 3 - WASHINGTON BRIDGE #700 REPLACEMENT WATERFRONT DRIVE OFF-RAMP BRIDGE NO. 126701
- VOLUME 4 - WASHINGTON BRIDGE #700 REPLACEMENT

SHEET NO.	DESCRIPTION
1	COVER SHEET
2	LIST OF ABBREVIATIONS
3	BRIDGE NOTES 1 OF 4
4	BRIDGE NOTES 2 OF 4
5	BRIDGE NOTES 3 OF 4
6	BRIDGE NOTES 4 OF 4
7 - 10	BRIDGE PLANS AND LONGITUDINAL SECTIONS
11 - 12	BRIDGE TYPICAL SECTIONS
13 - 16	PROPOSED BRIDGE PROFILES
17 - 18	TEMPORARY TRESTLE LAYOUTS
19 - 22	FOUNDATION PLANS
23 - 29	DRILLED SHAFT DETAILS
30	ABUTMENT R DEMOLITION
31	WEST ABUTMENT FOUNDATION PLAN
32	WEST ABUTMENT PLAN AND ELEVATION
33	EAST ABUTMENT FOUNDATION PLAN
34	EAST ABUTMENT PLAN AND ELEVATION
35	ABUTMENT R FOUNDATION PLAN
36	ABUTMENT R PLAN AND ELEVATION
37 - 40	ABUTMENT DETAILS
41 - 42	WEST ABUTMENT RETURN WALL ELEVATIONS
43 - 44	WEST ABUTMENT RETURN WALL DETAILS
45	PIER 1 PLAN AND ELEVATION
46	PIER 2 PLAN AND ELEVATION
47	PIER 3 PLAN AND ELEVATION
48	PIER 4 PLAN AND ELEVATION
49	PIER 5 PLAN AND ELEVATION
50	PIER 6 PLAN AND ELEVATION
51	PIER 1R PLAN AND ELEVATION
52	PIER 2R PLAN AND ELEVATION
53 - 57	PIER DETAILS
58 - 66	FRAMING PLANS AND GIRDER ELEVATIONS
67 - 77	STEEL DETAILS
78 - 83	CAMBER TABLES AND DIAGRAMMS
84 - 86	GIRDER DISC BEARING DETAILS
87 - 88	ELASTOMERIC BEARING DETAILS
89 - 92	TOP OF DECK ELEVATIONS TABLES
93 - 96	TOP OF FORM ELEVATIONS TABLES
97 - 107	DECK PLANS
108 - 110	DECK DETAILS
111 - 112	LIGHT STANDARD ANCHORAGES AND ELECTRICAL DETAILS
113	SNOW FENCE DETAILS
114 - 115	ENDPOST DETAILS
116 - 119	EXPANSION JOINT DETAILS
120 - 122	DRAINAGE DETAILS
123 - 125	MISCELLANEOUS DETAILS
126	DOLPHIN LAYOUT
127	DOLPHIN DETAILS
128 - 131	BORING LOGS

- VOLUME 5 - WASHINGTON BRIDGE #700 REPLACEMENT BRIDGE NO. 700 WEST APPROACH
- VOLUME 6 - WASHINGTON BRIDGE #700 REPLACEMENT BRIDGE NO. 700 EAST APPROACH
- VOLUME 7 - WASHINGTON BRIDGE #700 REPLACEMENT POTTER STREET BRIDGE REPLACEMENT NO. 046751
- VOLUME 8 - WASHINGTON BRIDGE #700 REPLACEMENT TAUNTON AVENUE RAMP BRIDGE NO. 046301

R.I. STANDARD SPECIFICATIONS AND STANDARD DETAILS

SPECIFICATIONS TO GOVERN THIS PROJECT ARE THE R.I. STANDARD SPECIFICATIONS FOR ROAD AND BRIDGE CONSTRUCTION, FEBRUARY 2025, WITH ALL REVISIONS AND THE STATE AND FEDERAL SPECIAL PROVISIONS INCLUDED IN THE CONTRACT DOCUMENTS.

STANDARD DETAILS FOR THIS PROJECT ARE R.I. STANDARD DETAILS, 1998 EDITION, WITH ALL REVISIONS.



Contract Number 2025-DB-003
Number of Sheet 1
Total Sheets 131



11-5-2025

PERMIT PLANS
NOVEMBER 7, 2025

NOT FOR CONSTRUCTION

R.I. DEPARTMENT OF TRANSPORTATION	
APPROVED	
DIRECTOR, DIVISION OF PROJECT MANAGEMENT	DATE
APPROVED	
CHIEF ENGINEER OF INFRASTRUCTURE	DATE
APPROVED	
DIRECTOR	DATE
DEPARTMENT OF TRANSPORTATION FEDERAL HIGHWAY ADMINISTRATION	
APPROVED	
DIVISION ADMINISTRATOR	DATE

LIST OF VOLUMES

VOLUME 1 - WASHINGTON BRIDGE #700 REPLACEMENT
HIGHWAY DRAWINGS

INDEX

SHEET NO.	DESCRIPTION
1	COVER SHEET
2	STANDARD PLAN SYMBOLS & STANDARD LEGEND
3 - 4	STANDARD NOTES
5	JOB SPECIFIC PLAN SYMBOLS & LEGEND
6	JOB SPECIFIC NOTES
7	KEY PLAN
8	ALIGNMENT PLANS
9 - 18	GENERAL DETAILS
19 - 21	ADA RAMP DETAILS
22 - 23	DRIVEWAY DETAILS
8 - 21	TYPICAL SECTIONS
22 - 43	GENERAL PLANS
44 - 65	DRAINAGE PLANS
83 - 85	UTILITY PLANS (WATER/SEWER/GAS)
84 - 86	UTILITY PLANS (ELECTRICAL)
94 - 98	UTILITY DETAILS
99 - 103	DRAINAGE DETAILS
66 - 72	STORMWATER TREATMENT PLANS & DETAILS
87 - 108	LOCATION PLANS
109- 123	PROFILE - I-195 WB
124- 130	PROFILE INDIA STREET/ GANO STREET
127 - 128	GANO STREET OFF-RAMP
129 - 130	GANO STREET ON-RAMP
131	PROFILE HILTON DRIVEWAY
132	PROFILE WATERFRONT DRIVE
133 - 134	PROFILE WATERFRONT DRIVE OFF-RAMP
135 - 136	PROFILE RAMP M
137	PROFILE RAMP DR-2
138	PROFILE POTTER STREET
139 - 140	PROFILE BROADWAY ON-RAMP
141 - 142	PROFILE SHARED USE PATH
73- 94	GRADING PLANS
180 - 182	LANDSCAPE PLANS AND DETAILS
168 - 189	LIGHTING PLANS
190 - 192	LIGHTING DETAILS
213 - 218	ITS PLANS AND DETAILS
223 - 243	SIGNING AND STRIPING PLANS
244 - 248	SIGN PANEL DETAILS
249 - 251	GUIDESIGN PLACEMENT
252 - 254	TRAFFIC SIGNAL PLANS AND DETAILS
255 - 264	TRAFFIC CONTROL PLANS (MPT)
265 - 279	PHASING/SEQUENCING PLANS
280 - 283	DETOUR PLANS

VOLUME 2 -	WASHINGTON BRIDGE #700 REPLACEMENT HIGHWAY CROSS SECTIONS
VOLUME 3 -	WASHINGTON BRIDGE #700 REPLACEMENT WATERFRONT DRIVE OFF-RAMP BRIDGE NO. 126701
VOLUME 4 -	WASHINGTON BRIDGE #700 REPLACEMENT
VOLUME 5 -	WASHINGTON BRIDGE #700 REPLACEMENT GANO STREET ON-RAMP BRIDGE NO. 126601
VOLUME 6 -	WASHINGTON BRIDGE #700 REPLACEMENT INFILL AND ARCHES
VOLUME 7 -	WASHINGTON BRIDGE #700 REPLACEMENT POTTER STREET BRIDGE REPLACEMENT NO. 046751
VOLUME 8 -	WASHINGTON BRIDGE #700 REPLACEMENT TAUNTON AVENUE RAMP BRIDGE NO. 046301

HURRICANE EVACUATION ROUTE

This project includes work on a designated Hurricane
Evacuation and Diversionary Route as follows:
- Interstate 195
- Ramp M
- Ramp DR-2
Refer to Note 18 on Sheet 3

R.I. STANDARD SPECIFICATIONS AND STANDARD DETAILS

SPECIFICATIONS TO GOVERN THIS PROJECT ARE THE R.I. STANDARD SPECIFICATIONS FOR ROAD AND BRIDGE
CONSTRUCTION, FEBRUARY 2025, WITH ALL REVISIONS AND THE STATE AND FEDERAL SPECIAL PROVISIONS
INCLUDED IN THE CONTRACT DOCUMENTS.

STANDARD DETAILS FOR THIS PROJECT ARE R.I. STANDARD DETAILS, 1998 EDITION, WITH ALL REVISIONS.

STATE OF RHODE ISLAND

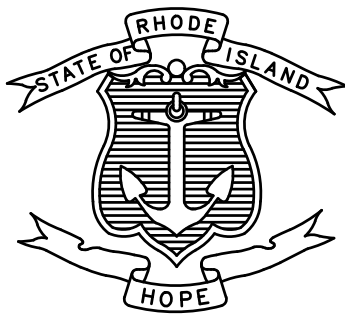

DEPARTMENT OF TRANSPORTATION

PLAN, PROFILE AND SECTIONS OF PROPOSED

INTERSTATE 195

WASHINGTON BRIDGE
#700 REPLACEMENT
HIGHWAY DRAWINGS
VOLUME 1

SOUTH MAIN STREET TO BROADWAY

CITIES OF PROVIDENCE & EAST PROVIDENCE

COUNTY OF PROVIDENCE

R.I. CONTRACT NO.: 2025-DB-003 F.A. PROJECT NO.: BRO-0700(012)

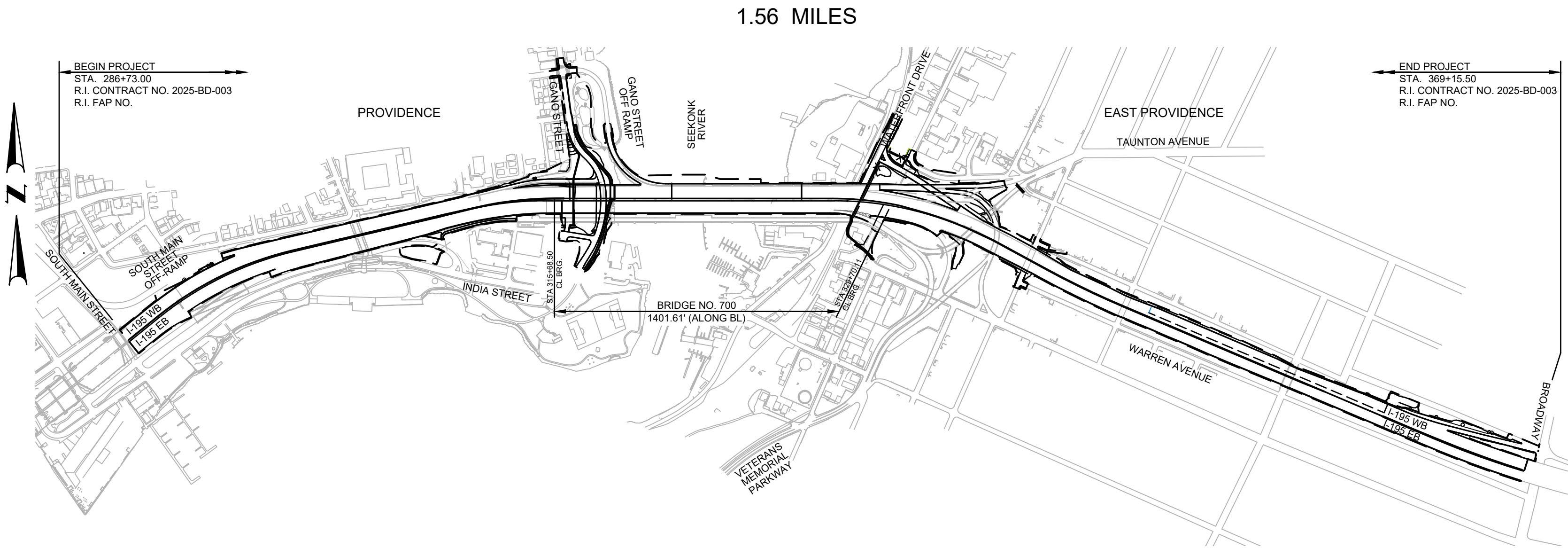

LAYOUT PLAN

SCALE: 1"=500'

SCALES OF DRAWINGS

Plans	1 inch = 20 feet
Profiles	1 inch = 20 feet Horizontal
Profiles	1 inch = 4 feet Vertical
Cross Sections	1 inch = 4 feet Horizontal
Cross Sections	1 inch = 4 feet Vertical

BASE OF LEVELS

VERTICAL DATUM: NAVD 88

HORIZONTAL DATUM: R.I. STATE PLANE, NAD 83



Contract Number 2025-DB-003

Number of Sheet 1

Total Sheets 249

RI CONTRACT NO.	FISCAL YEAR	SHEET NO.	TOTAL SHEETS
2025-DB-003	2025	1	94

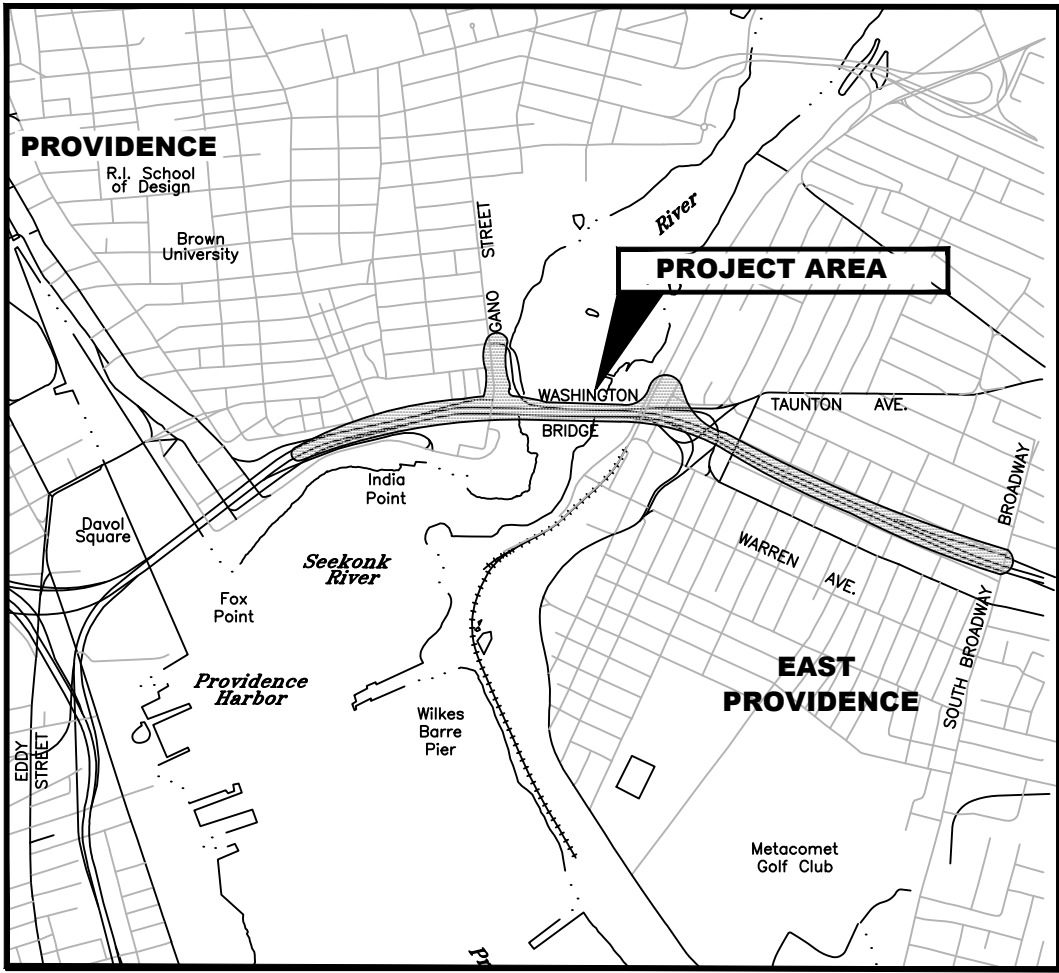

LOCATION MAP

SCALE : 1" = 2000'

DESIGN DESIGNATION

	I-195 WB EAST OF POTTER	I-195 WB WEST OF POTTER	GANO ST ON-RAMP	GANO ST OFF-RAMP	GANO STREET	POTTER STREET	M ON-RAMP	DR-2 ON-RAMP	BROADWAY ON-RAMP	WATERFRONT DRIVE	WATERFRONT DRIVE OFF-RAMP
ADT (2019)	63,300 VPD	96,500 VPD	10,300 VPD	3,400 VPD	9,900 VPD	1,600 VPD	10,000 VPD	11,700 VPD	5,100 VPD	5,600 VPD	N/A
ADT (2045)	76,800 VPD	108,300 VPD	14,000 VPD	4,800 VPD	11,600 VPD	2,800 VPD	13,700 VPD	13,000 VPD	3,800 VPD	22,700 VPD	3,700 VPD
D	100% WB	100%/WB	100%/WB	100% WB	67% NB	54% NB	100% WB	100% WB	100% WB	53% SB	100%/WB
K	8.1	8.1%	4.2%	7.9	9	9	10.9	9.9	9.1	9	4.2%
T	5.0%	5%	4%	2.1%	1.3%	3.8%	2.9%	3.1%	2.5%	9.3%	4%
DDHV	6,220 VPH	8,770 VPH	590 VPH	380 VPH	700 VPH	140 VPH	1,490 VPH	1,280 VPH	340 VPH	1,090 VPH	155 VPH
DHV	6,220 VPH	8,770 VPH	590 VPH	380 VPH	1,040 VPH	260 VPH	1,490 VPH	1,280 VPH	340 VPH	2,040 VPH	155 VPH
DESIGN SPEED	50 M.P.H.	50 M.P.H.	40 M.P.H.	30 M.P.H.	30 M.P.H.	30 M.P.H.	30 M.P.H.	30 M.P.H.	30 M.P.H.	30 M.P.H.	30 M.P.H.

MICROMILLING AND PAVEMENT OVERLAY

(I-195 & RAMPS)

1.5" PAVEMENT MICROMILLING
1.5" FRICTION COURSE OVERLAY

MICROMILLING AND PAVEMENT OVERLAY

(GANO STREET, WATERFRONT DRIVE &

POTTER STREET)

2" PAVEMENT MICROMILLING
2" MODIFIED CLASS 12.5 HMA OVERLAY

MICROMILLING AND PAVEMENT OVERLAY

WITH LEVELING COURSE (I-195)

2" PAVEMENT MICROMILLING
2" MODIFIED CLASS 9.5 HMA OVERLAY - WEDGE COURSE
2" MODIFIED CLASS 12.5 HMA OVERLAY

FULL DEPTH PAVEMENT STRUCTURE (I-195

WIDENING)

1.5" FRICTION COURSE
1.5" MODIFIED CLASS 9.5 HMA
10" CLASS 19 HMA BASE COURSE
12" GRAVEL BORROW SUBBASE COURSE

FULL DEPTH PAVEMENT STRUCTURE

(RAMPS)

1.5" FRICTION COURSE
1.5" MODIFIED CLASS 9.5 HMA
8.5" CLASS 19 HMA BASE COURSE
12" GRAVEL BORROW SUBBASE

FULL DEPTH PAVEMENT STRUCTURE

(I-195)

1.5" FRICTION COURSE
1.5" MODIFIED CLASS 9.5 HMA FOR MISCELLANEOUS
WORK
7" CLASS XX CONCRETE
12" GRAVEL BORROW SUBBASE

FULL DEPTH PAVEMENT STRUCTURE (I-195

AT CONCRETE MEDIAN BARRIER)

3" CLASS 12.5 HMA FOR MISCELLANEOUS WORK
7" CLASS XX CONCRETE
12" GRAVEL BORROW SUBBASE
FULL DEPTH PAVEMENT STRUCTURE (GANO
STREET, WATERFRONT DRIVE, CONNECTOR
ROAD & POTTER STREET)
2" MODIFIED CLASS 12.5 HMA SURFACE COURSE
6" CLASS 19.0 HMA SURFACE
12" GRAVEL BORROW SUBBASE

PERMIT PLANS

NOVEMBER 7, 2025

NOT FOR CONSTRUCTION

R.I. DEPARTMENT OF TRANSPORTATION

APPROVED

DIRECTOR, DIVISION OF PROJECT MANAGEMENT DATE

APPROVED

CHIEF ENGINEER OF INFRASTRUCTURE DATE

APPROVED

DIRECTOR DATE

DEPARTMENT OF TRANSPORTATION
FEDERAL HIGHWAY ADMINISTRATION

APPROVED

DIVISION ADMINISTRATOR DATE

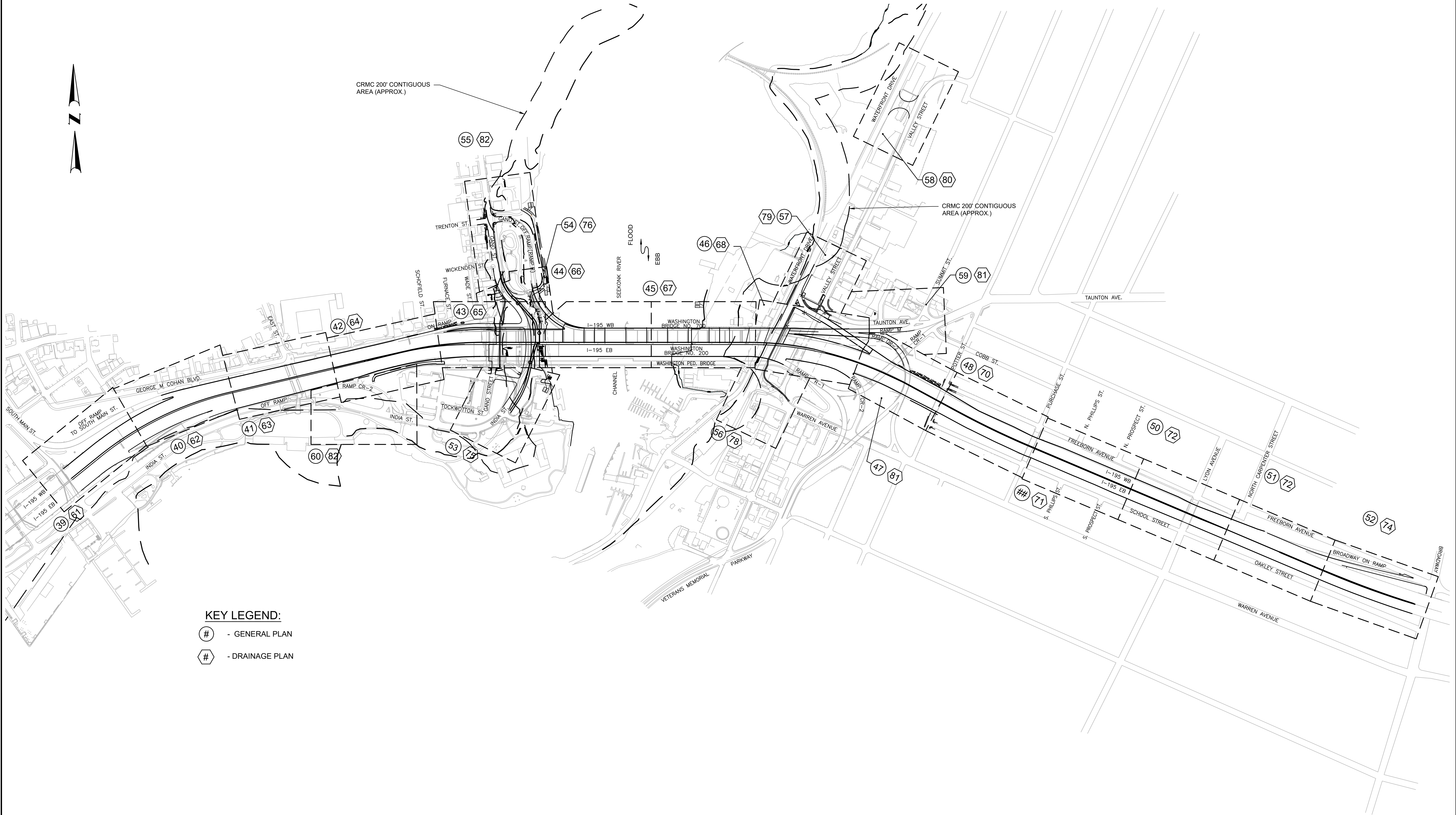

KEY LEGEND:

- # - GENERAL PLAN
- # - DRAINAGE PLAN



RHODE ISLAND
DEPARTMENT OF TRANSPORTATION

DESIGNED BY: ZH
CHECKED BY: RL
DATE: 11/07/2025
SHEET: 7
OF: 94

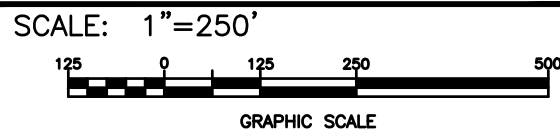

REVISIONS			REVISIONS		
NO.	DATE	BY	NO.	DATE	BY

WASHINGTON BRIDGE #700 REPLACEMENT
HIGHWAY DRAWINGS
VOLUME 1
PROV/EAST PROV. RHODE ISLAND

KEY PLAN