



State of Rhode Island
Coastal Resources Management Council
Oliver H. Stedman Government Center
4808 Tower Hill Road, Suite 3
Wakefield, RI 02879-1900

(401) 783-3370
Fax (401) 783-2069

PUBLIC NOTICE

File Number: 2025-11-047 Date: December 15, 2025

This office has under consideration the application of:

Kristin Miller
10 Fairgreen Lane
Old Greenwich, CT 06870

for a State of Rhode Island Assent to construct and maintain: A Residential Boating Facility consisting of a fixed pier approximately 4' x 7', a 3' x 20' ramp and a 6.5' x 23' float, extending 50' beyond Mean Low Water and 1.8' water depth.

Project Location:	34 Aquidneck Avenue
City/Town:	Portsmouth
Plat/Lot:	24 / 166
Waterway:	Sakonnet River

Plans of the proposed work can be requested at Cstaff1@crmc.ri.gov.

In accordance with the Administrative Procedures Act (Chapter 42-35 of the Rhode Island General Laws) you may request a hearing on this matter.

You are advised that if you have good reason to enter protests against the proposed work it is your privilege to do so. It is expected that objectors will review the application and plans thoroughly, visit site of proposed work if necessary, to familiarize themselves with the conditions and cite what law or laws, if any, would in their opinion be violated by the work proposed.

If you desire to protest, you must attend the scheduled hearing and give sworn testimony. A notice of the time and place of such hearing will be furnished you as soon as possible after receipt of your request for hearing. If you desire to request a hearing, to receive consideration, it should be in writing (**with your correct mailing address, e-mail address and valid contact number**) and be received at this office on or before January 14, 2026.

Please email your comments/hearing requests to: cstaff1@crmc.ri.gov; or mail via USPS to: Coastal Resources Management Council; O. S. Government Center, 4808 Tower Hill Road, Rm 116; Wakefield, RI 02879.

/bms

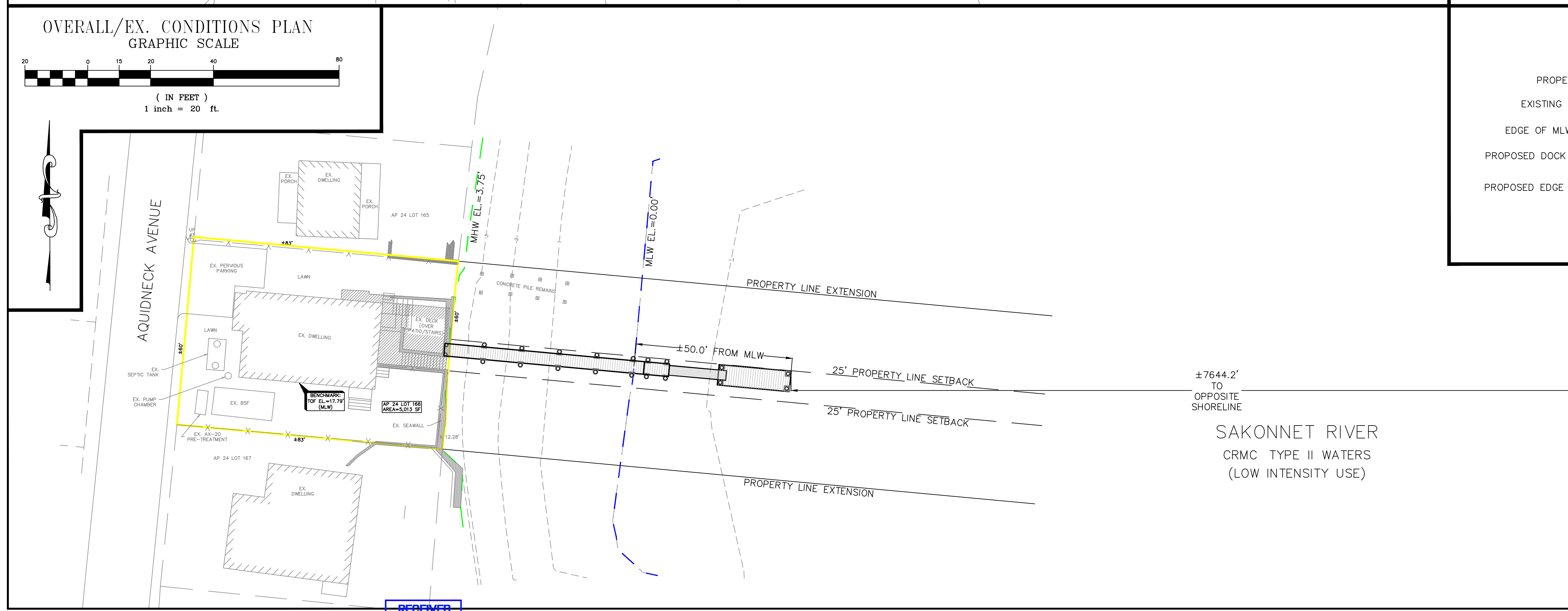

DOCK COVERAGE:

PROPOSED FIXED DOCK:	±284 S.F.
PROPOSED GANGWAY:	±60 S.F.
PROPOSED FLOATING DOCK:	±150 S.F.

SURVEY NOTE:
1.) EXISTING CONDITIONS TAKEN FROM PLAN
ENTITLED:
"PROPOSED SITE PLAN - ALTERNATE FOR KRISTEN
MILLER AP 24 LOT 166 - 34 AQUIDNECK AVENUE
IN PORTSMOUTH, RI"
PREPARED BY: CIVIL ENGINEERING CONCEPTS, INC.
DATE: 11.09.2020

PLAN NOTE:

ALL CONSTRUCTION ACCESS WILL COME FROM THE WATER SIDE OF THE SITE. NO STOCKPILES WILL BE LOCATED ON LAND.

OWNER/APPLICANT
KRISTIN MILLER

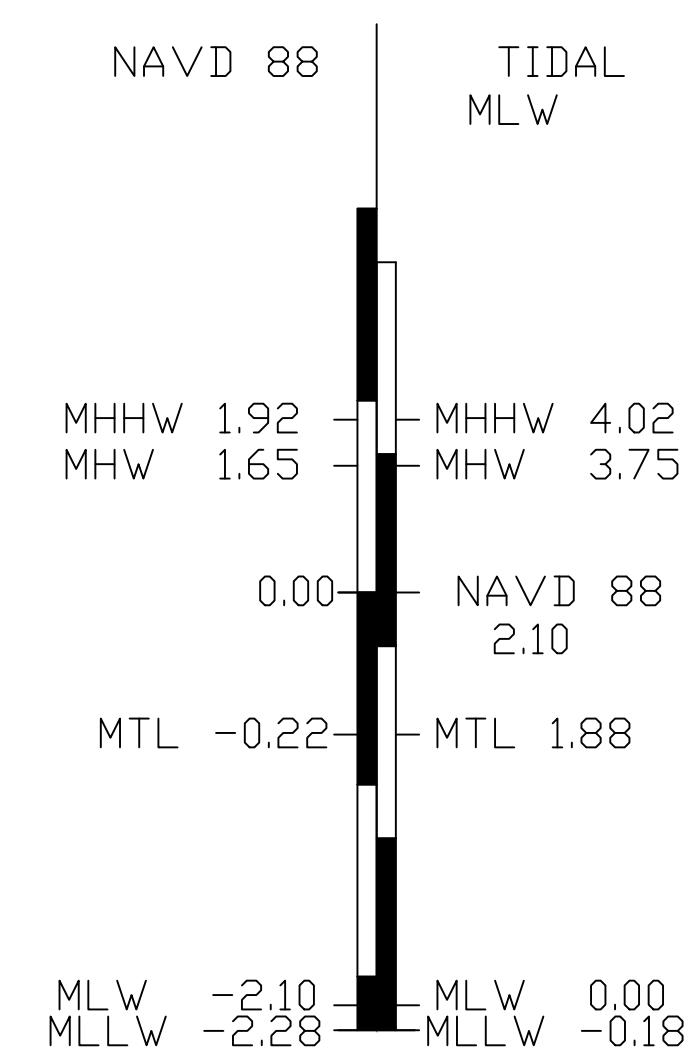

DATUM INFORMATION
ANTHONY POINT 8450948

LEGEND

- PROPERTY LINE —————
- EXISTING CONTOUR - - - 8 - - -
- EDGE OF MLW / MHW ■■■■■■■■■■
- PROPOSED DOCK DECKING [RECTANGLE WITH VERTICAL LINES]
- PROPOSED EDGE OF DOCK —————

DRAWING ISSUE:

☐ CONCEPT

☐ CUSTOMER APPROVAL

☒ PERMITTING

☐ CONSTRUCTION

☐ AS-BUILT

☐ OTHER:

ONLY PLANS ISSUED FOR CONSTRUCTION
SHALL BE USED FOR CONSTRUCTION

PLAN VIEW

Thomas J. Principe, III



REGISTERED
PROFESSIONAL ENGINEER



PRINCO ENGINEERING COMPANY, INC.
ENGINEERING DIVISION

27 SAKONNET RIDGE DRIVE
TIVERTON, RI 02878
401.816.5385

ESTABLISHED IN 1981

WWW.PRINCOENGINEERING.COM

[illegible]

NEW DOCK PLANS
for
AP 24 LOT 166
34 AQUIDNECK AVENUE
in
PORTSMOUTH, RHODE ISLAND

SCALE: AS NOTED		SHEET NO: 1 OF 3	
DRAWN BY: CH/AMI	DESIGN BY: AMI	CHECKED BY: TJP	
DATE: 11/10/2025		PROJECT NO.: 21010.00	

RECEIVED
11/17/2025
COASTAL RESOURCES
MANAGEMENT COUNCIL

