



State of Rhode Island
Coastal Resources Management Council
Oliver H. Stedman Government Center
4808 Tower Hill Road, Suite 3
Wakefield, RI 02879-1900

(401) 783-3370
Fax (401) 783-2069

PUBLIC NOTICE

File Number: 2025-12-033

Date: January 6, 2026

This office has under consideration the application of:

BDPS, LLC
c/o Charles E. Booth III
100 Water Street.
East Providence, RI 02914

for a State of Rhode Island Assent to:

As part of a previously issued CRMC assent, temporary improvements were approved to an existing work trestle in conjunction with the Washington Bridge Demolition Project. In this application under consideration, the applicant is proposing no additional work but is seeking assent to retain these temporary improvements to the trestle and establish a structural perimeter limit (SPL) around the structure.

Project Location:	100 Water Street
City/Town:	East Providence
Plat/Lot:	Plat 16; Lots 1-1
Waterway:	Seekonk River

Plans of the proposed work can be requested at Cstaff1@crmc.ri.gov.

In accordance with the Administrative Procedures Act (Chapter 42-35 of the Rhode Island General Laws) you may request a hearing on this matter.

You are advised that if you have good reason to enter protests against the proposed work it is your privilege to do so. It is expected that objectors will review the application and plans thoroughly, visit site of proposed work if necessary, to familiarize themselves with the conditions and cite what law or laws, if any, would in their opinion be violated by the work proposed.

If you desire to protest, you must attend the scheduled hearing and give sworn testimony. A notice of the time and place of such hearing will be furnished you as soon as possible after receipt of your request for hearing. If you desire to request a hearing, to receive consideration, it should be in writing (**with your correct mailing address, e-mail address and valid contact number**) and be received at this office on or before **February 6, 2025**.

Please email your comments/hearing requests to: cstaff1@crmc.ri.gov; or mail via USPS to: Coastal Resources Management Council; O. S. Government Center, 4808 Tower Hill Road, Rm 116; Wakefield, RI 02879.

PROPERTY OF BDPS, LLC
EXISTING CONDITIONS
TRESTLE PERMIT

CITY OF EAST PROVIDENCE
COUNTY OF PROVIDENCE

SHEET NO.	DESCRIPTION
1	COVER SHEET AND GENERAL NOTES
2	SURVEY PLAN AND EXISTING LAYOUT
3	TRESTLE PLAN
4	TRESTLE PROFILE
5	TRESTLE FRAMING PLAN
6	SECTION AND DETAILS

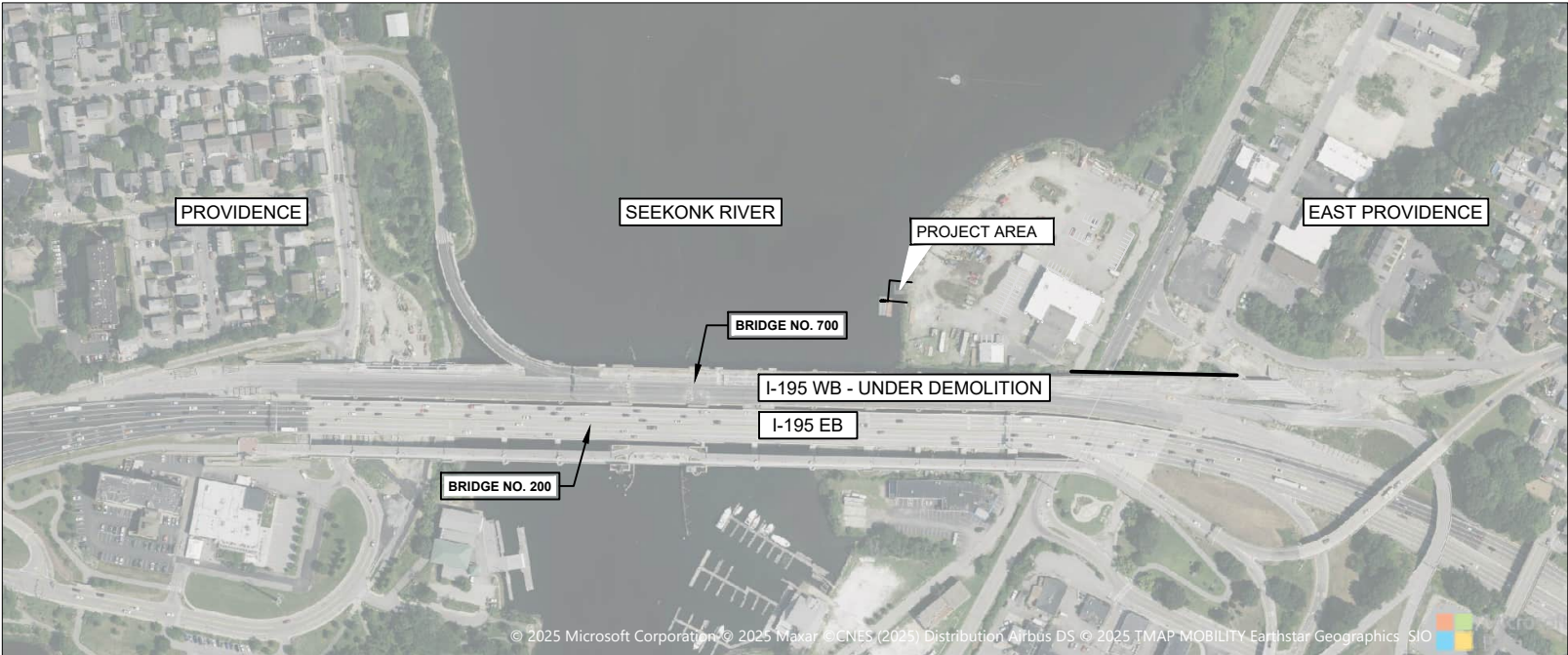

LAYOUT PLAN
SCALE: 1"=200'

- GENERAL NOTES
1. LANDSIDE TOPOGRAPHY AND EXISTING CONDITIONS PLAN INFORMATION FOR THE PROPOSED AREA IS DEVELOPED FROM THE SURVEY PERFORMED, PREPARED AND PROVIDED BY NARRAGANSETT ENGINEERING INC., DATED 11/05/2025. REFER TO DRAWING SHEET 2 FOR SURVEY PLAN. ALL DIMENSIONS ARE IN FEET AND DECIMAL FEET. ELEVATIONS ARE REFERENCED TO THE NORTH AMERICAN VERTICAL DATUM OF 1988 (NAVD 88).
 2. CRMC WATER TYPE CLASSIFICATION AT THE PROPOSED SITE IS TYPE 4 PER RHODE ISLAND CRMC.
 3. WORK TRESTLE IMPROVEMENT TO THE DECK AND LANDSIDE FOOTING WERE AUTHORIZED AS TEMPORARY IMPROVEMENTS PER CRMC ASSENT A2025-02-013 ISSUED FEBRUARY 2025 AND USACE FILE NUMBER NAE-2020-01204 ISSUED IN JUNE 2025. CRMC ASSENT 1987-12-037 ISSUED IN DECEMBER OF 1987 AUTHORIZED THE EXISTING SHORELINE IMPROVEMENTS, INCLUDING THE EXISTING RIPRAP REVETMENT BORDERING THE SEEKONK RIVER.
 4. AS-BUILT DIMENSIONS AND MATERIALS IDENTIFIED ON THESE SHEETS FOR THE TRESTLE ARE FROM DRAWINGS AND CALCULATIONS DEVELOPED BY TRANSITION ENGINEERING INC., DATED 9/26/2024 TO AETNA BRIDGE COMPANY. THE DESIGN LOADS ARE BASED ON A CAT 390 EXCAVATOR.
 5. LOCATION OF WORK TRESTLE IS NOT IN A HIGH FETCH AREA PER REQUIREMENTS IN CRMC § 1.3.1.D.12

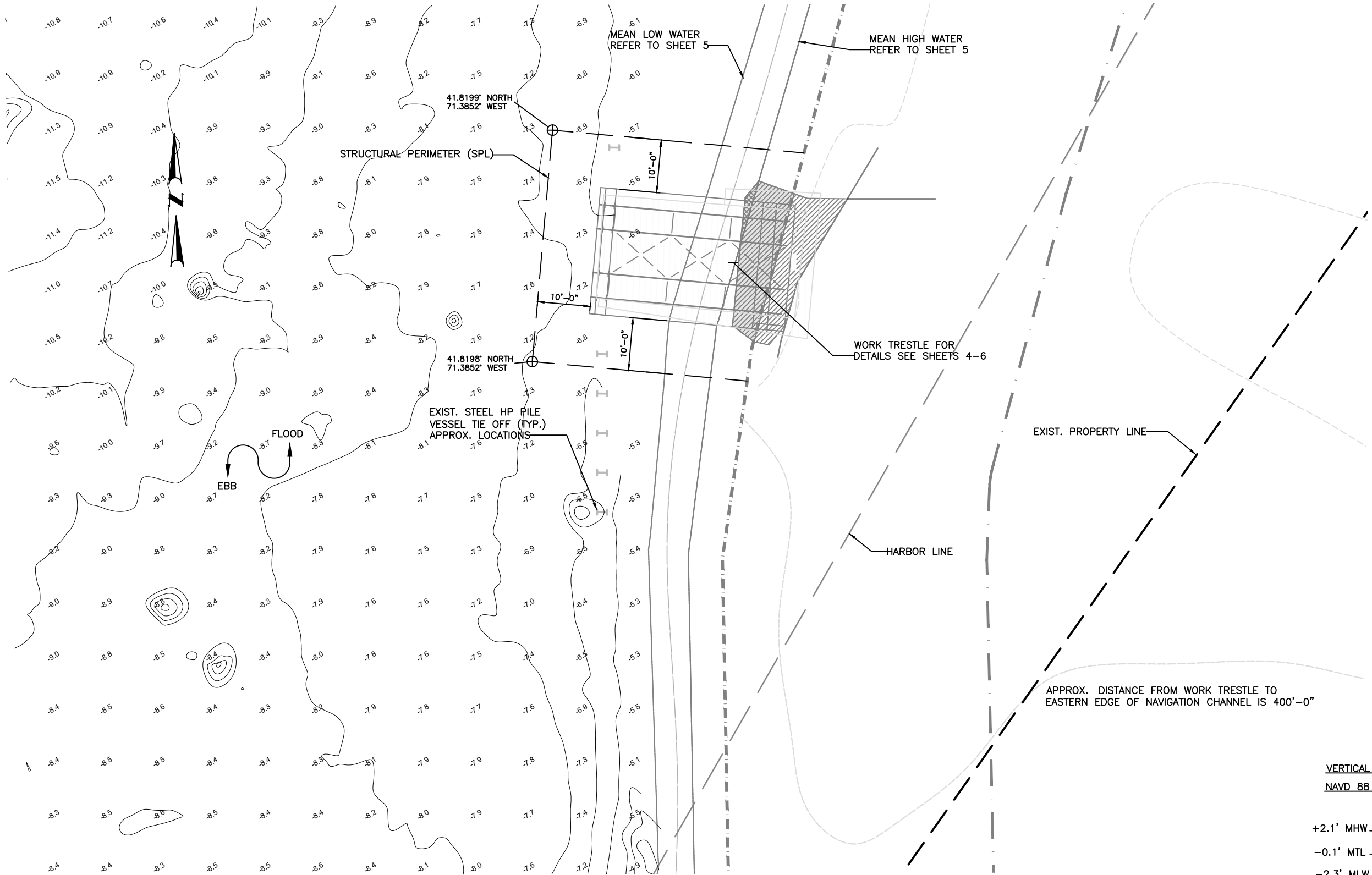

NOTES

1. TOPOGRAPHY AND EXISTING CONDITIONS INFORMATION ARE BASED ON THE FIELD SURVEY DRAWING DEVELOPED BY NARRAGANSETT ENGINEERING INC. DATED NOVEMBER 5, 2025.

Jacobs

100 Great Meadow Road, Suite 707
Wethersfield, CT 06109

DESIGNED BY: MAA
CHECKED BY: MDA
DATE: NOVEMBER 2025
SHEET: 3
OF: 6

SCALE AS NOTED

REVISIONS			REVISIONS		
NO.	DATE	BY	NO.	DATE	BY

PROPERTY OF BDPS, LLC

EAST PROVIDENCE EXISTING CONDITIONS RHODE ISLAND

TRESTLE PLAN

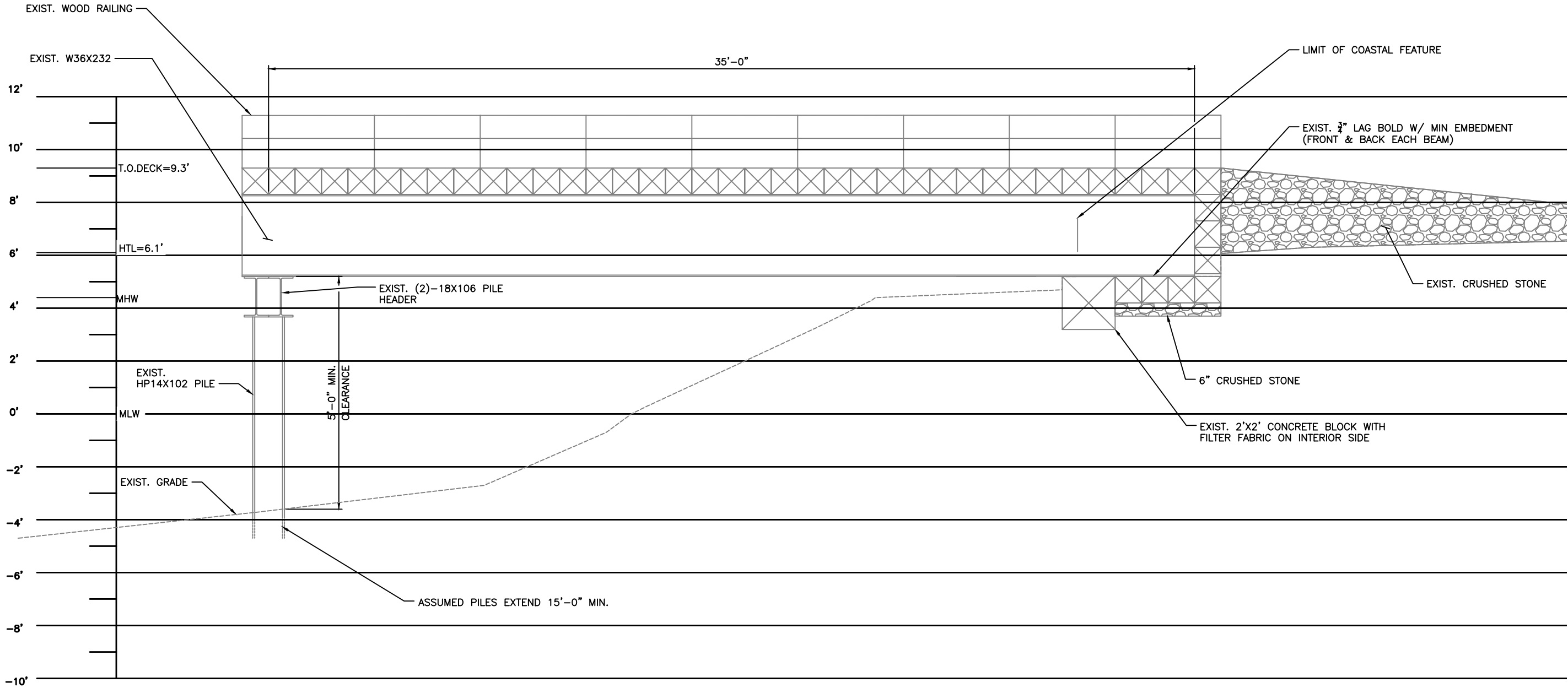

TRESTLE PROFILE



*ORIGINAL SHEET SIZE IS 22"X34"

- NOTES:
1. TRESTLE WORK IMPROVEMENTS ARE MODELED BASED ON DRAWINGS DEVELOPED BY TRANSITION ENGINEERING INC. DATED 9/26/2024
 2. SEDIMENT AT RIVER BOTTOM IS SANDY MUCK

VERTICAL DATUM CONVERSION
NAVD 88 DATUM MLW DATUM

+2.1' MHW	EL. 4.4' MHW
-0.1' MTL	EL. 2.2' MTL
-2.3' MLW	EL. 0' MLW

VERTICAL DATUM



GRAPHIC SCALE

Jacobs

100 Great Meadow Road, Suite 707
Wethersfield, CT 06109

DESIGNED BY: MAA
CHECKED BY: MDA
DATE: NOVEMBER 2025
SHEET: 4
OF: 6

SCALE AS NOTED

REVISIONS			REVISIONS		
NO.	DATE	BY	NO.	DATE	BY
4					
6					

PROPERTY OF BDPS, LLC

EAST PROVIDENCE EXISTING CONDITIONS RHODE ISLAND

TRESTLE PROFILE