



State of Rhode Island
Coastal Resources Management Council
Oliver H. Stedman Government Center
4808 Tower Hill Road, Suite 3
Wakefield, RI 02879-1900

(401) 783-3370
Fax (401) 783-2069

PUBLIC NOTICE

File Number: A2005-02-037 Date: October 25, 2024

This office has under consideration the application of:

**Ram Island Properties LLC
c/o Art Colello
158 Laurel Ridge Lane
North Kingstown, RI 02852**

for a State of Rhode Island Assent to construct and maintain: Modify CRMC Assent 2005-02-037. Modification includes the T-Fixed pier is increase in size from 4' x 8' to 4.7' x 10' (includes 0.7' step and bumper). The ramp and fixed pier section dimensions are 3.5' x 17' and 4' x 8' respectively (Original Assent dimensions were 3' x 18' and 4' x 8'). Additionally, the dock location has changed from the original assent (new and current location is 1' from southern abutting property line. A sign off from the affected southern abutter has been obtained.

Project Location:	262 Ram Island Road
City/Town:	Charlestown/South Kingstown
Plat/Lot:	Charlestown - Plat 11, Lot 539; South Kingstown - Plat 89-4, Lot 13
Waterway:	Green Hill Pond

Plans of the proposed work can be requested at Cstaff1@crmc.ri.gov.

In accordance with the Administrative Procedures Act (Chapter 42-35 of the Rhode Island General Laws) you may request a hearing on this matter.

You are advised that if you have good reason to enter protests against the proposed work it is your privilege to do so. It is expected that objectors will review the application and plans thoroughly, visit site of proposed work if necessary, to familiarize themselves with the conditions and cite what law or laws, if any, would in their opinion be violated by the work proposed.

If you desire to protest, you must attend the scheduled hearing and give sworn testimony. A notice of the time and place of such hearing will be furnished you as soon as possible after receipt of your request for hearing. If you desire to request a hearing, to receive consideration, it should be in writing (**with your correct mailing address, e-mail address and valid contact number**) and be received at this office on or before **November 25, 2024**.

Please email your comments/hearing requests to: cstaff1@crmc.ri.gov; or mail via USPS to: Coastal Resources Management Council; O. S. Government Center, 4808 Tower Hill Road, Rm 116; Wakefield, RI 02879.

Previous Approved Plans

Application for boat dock, repair and replace

Property of: Carmen Ferrante
262 Ram Island Rd.
Charlestown, R.I.

Map 11, lot # 539

PH. 1-203-676-8141

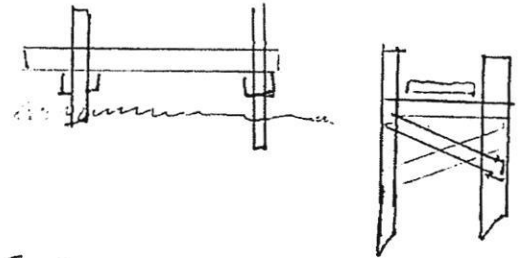
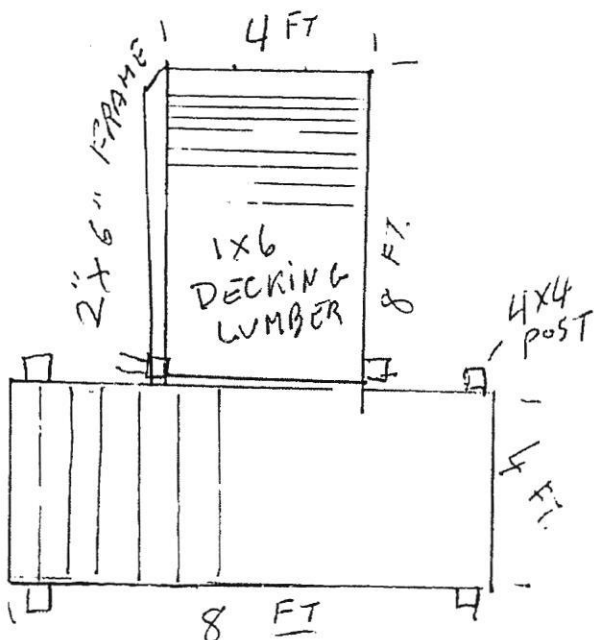
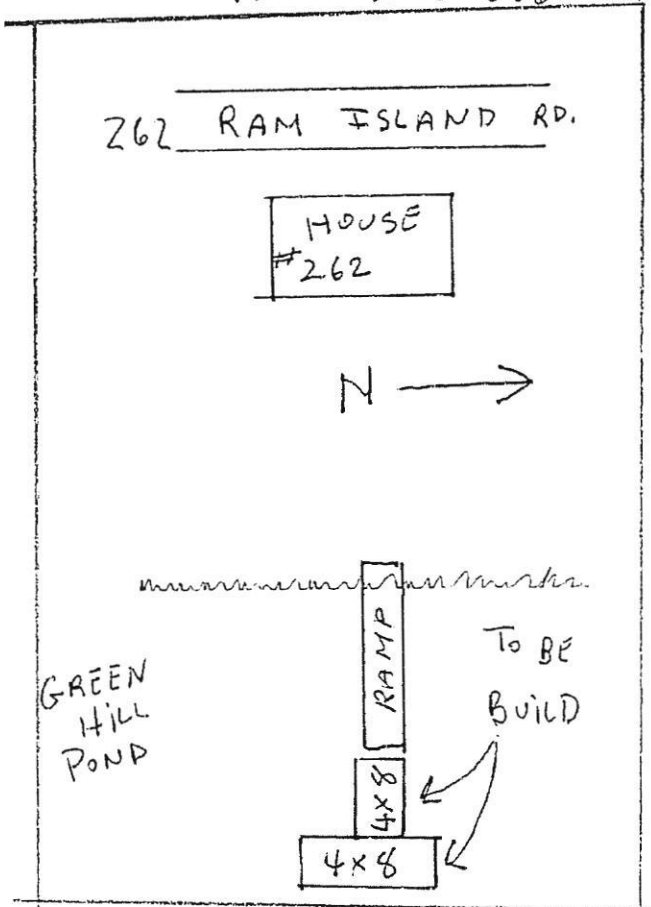

- ① TOTAL DOCK AREA 64 SQ. FT.
- ② DOCK TO BE BUILT ON PERS, MOVABLE FOR THE WINTER, AND IT WILL BE ROPE TIED TO LAND, IN CASE OF STORMS.
- ③ DOCK TO BE BUILT OF TREATED LUMBER.
- ④ RAMP TO BE REPLACED, SOME TIME IN THE FUTURE WITH TREATED LUMBER.
- ⑤ APR. COST OF MATERIAL TO BUILD DOCK: \$200.00
- ⑥ APR. TIME TO BUILD AN FINISH DOCK - "1 DAY"

RECEIVED

9/17/2024

COASTAL RESOURCES
MANAGEMENT COUNCIL



Jackson Surveying, Inc.

SURVEYING AND ENGINEERING

DATE 7/25/24 CREW CMB/MCE WX SUN SEC

JOB NO. 23-065 NAME ARTHUR COLENO
MAP 11 LOT 539 TOWN CHARLESTOWN
STREET 262 RAM ISLAND ROAD
REF. AS-BUILT DECK

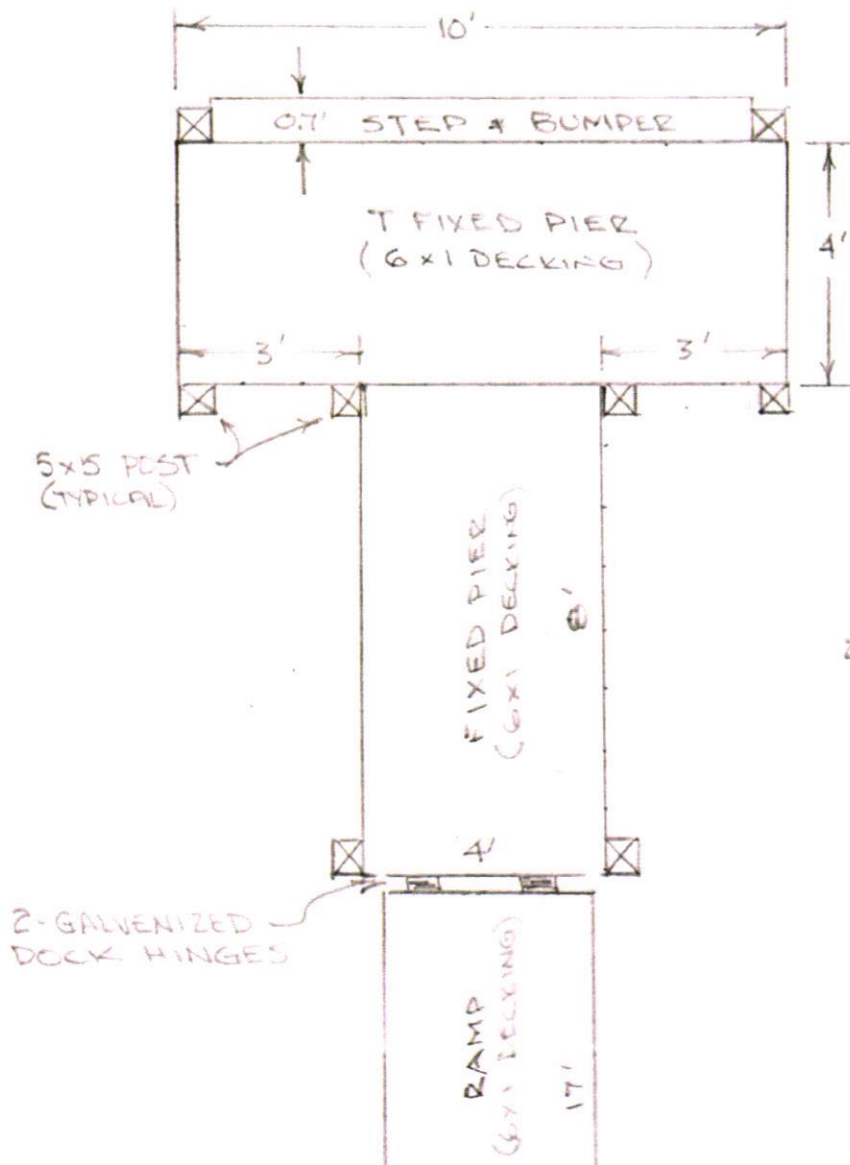

RAMP DETAIL

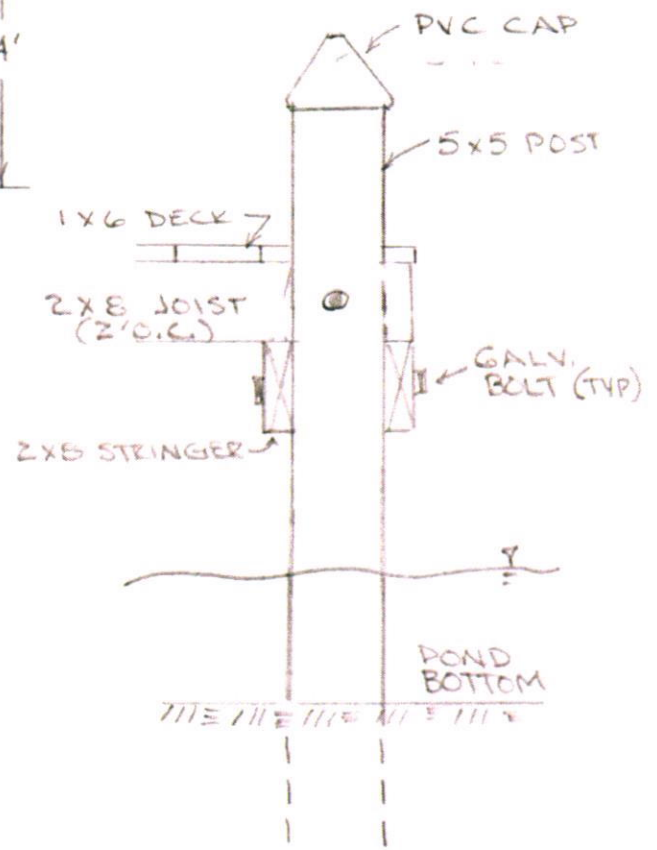

FIXED PIER PROFILE

NOTES:

- 1) ALL HARDWARE IS GALVANIZED
- 2) ALL LUMBER IS PRESSURE TREATED
- 3) POST DEPTH IS UNKNOWN

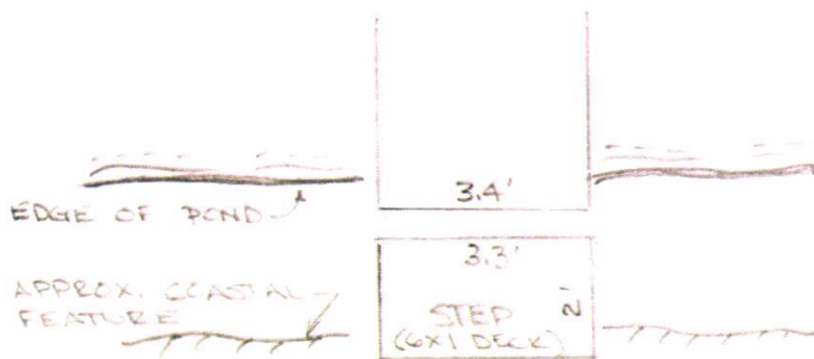

RECEIVED

9/17/2024

COASTAL RESOURCES
MANAGEMENT COUNCIL

RAM ISLAND ROAD

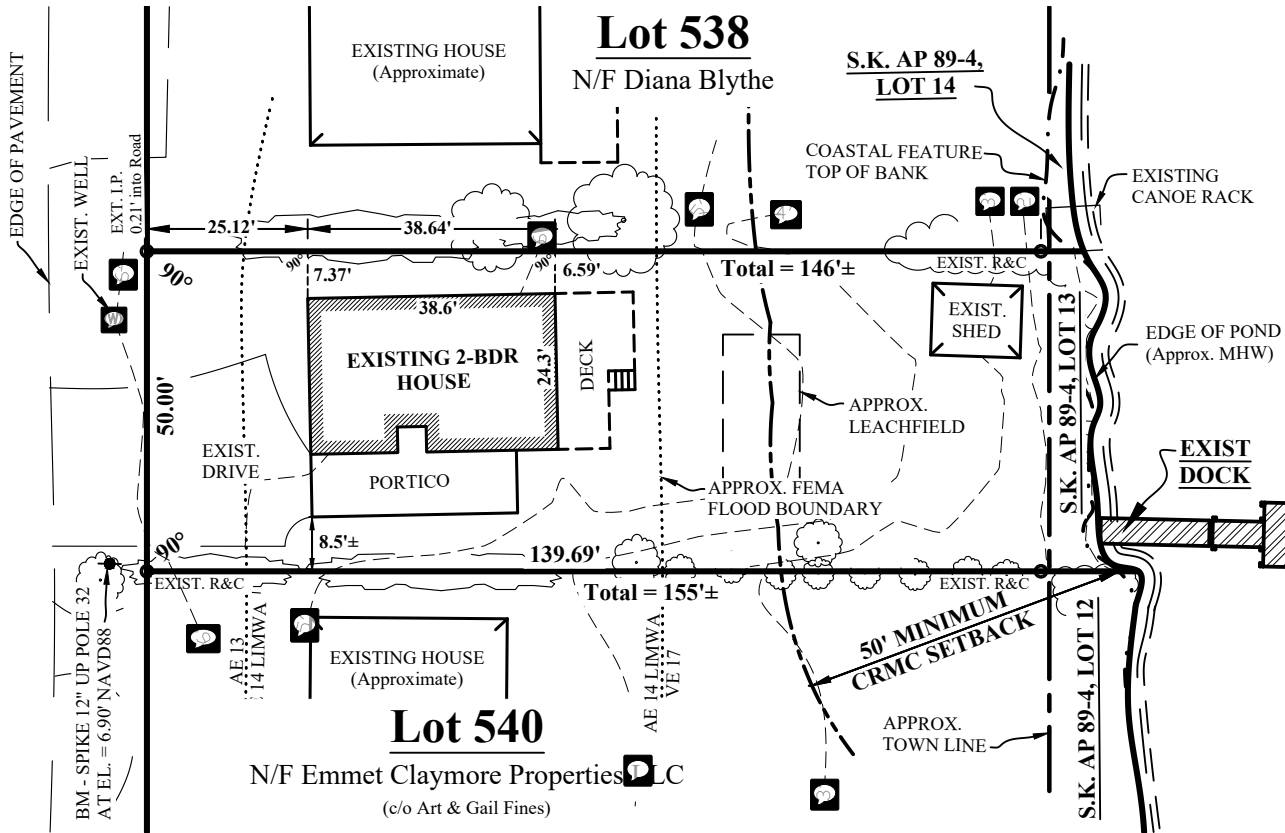

EXISTING CONDITIONS

Scale: 1" = 30'

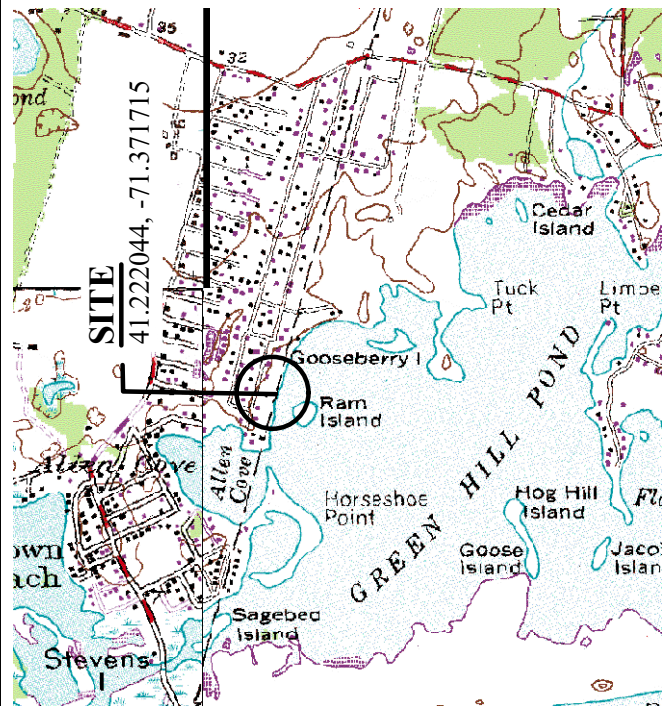

LOCATION MAP

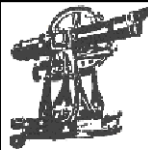

JACKSON SURVEYING, Inc.
SURVEYING & ENGINEERING

P.O. BOX 454 CHARLESTOWN, RI 02813 PH. (401) 364-3130

NOTES:

1. THE MODIFIED DOCK IS A RESIDENTIAL BOATING FACILITY FOR THE USE OF 4 BOATS MAXIMUM.
2. THE MODIFIED DOCK IS NOT LOCATED IN A HIGH FETCH AREA.
3. THERE ARE NO UTILITIES SERVICING THE DOCK.
4. THE DOCK IS LOCATED IN A VE17 FEMA FLOOD ZONE PER THE FEMA FLOOD INSURANCE RATE MAPS.
5. THE DOCK & COASTAL FEATURE IS LOCATED WITHIN THE TOWN OF SOUTH KINGSTOWN PORTION OF THE PARCEL DELINEATED AS LOT 13 OF AP 4.
6. BOUNDARY & TOPOGRAPHIC DATA AS SHOWN HEREON WAS CREATED BY JACKSON SURVEYING, INC. UNDER THE PLS LICENSE OF CHAREE M. JACKSON.
7. SEE AS-BUILT DOCK SKETCH BY JACKSON SURVEYING, INC. DATED 7/25/24 FOR LUMBER & HARDWARE DETAILS.

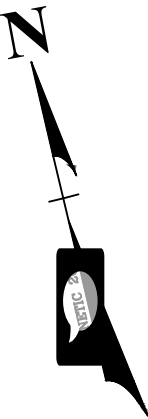

GREEN HILL POND

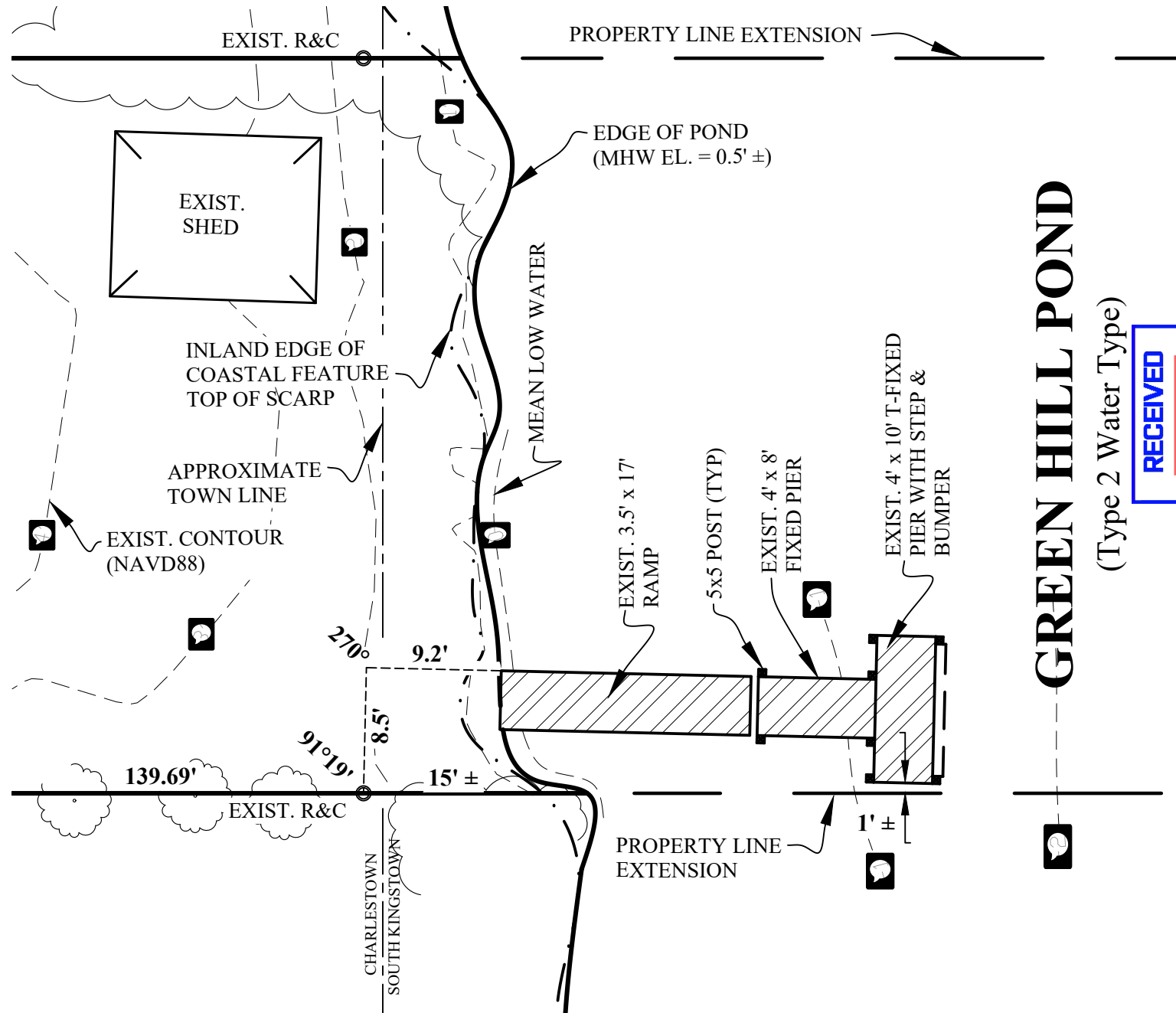

SITE PLAN FOR DOCK MODIFICATION OF CRMC ASSENT # 2005-02-037

**Lot 539, AP 11, Charlestown &
Lot 13, AP 89-4, South Kingstown**
262 RAM ISLAND ROAD, CHARLESTOWN, RI
OWNER & APPLICANT
RAM ISLAND PROPERTIES, LLC.

C/O Arthur Colello, 158 Laurel Ridge Lane, North Kingstown, RI 02852

SEPTEMBER 2024

SCALE : 1" = 20'



(Type 2 Water Type)

RECEIVED

9/17/2024

COASTAL RESOURCES
MANAGEMENT COUNCIL