

Cstaff1

From: Tracy Silvia <tsilvia@crmc.ri.gov>
Sent: Wednesday, May 29, 2024 10:06 AM
To: 'Cstaff1'
Subject: FW: Application #2022-12-075

Follow Up Flag: Follow up
Flag Status: Flagged

For file, from Town DPW

From: Stephen Daignault <sdaignault@narragansettri.gov>
Sent: Tuesday, May 28, 2024 4:33 PM
To: Tracy Silvia <tsilvia@crmc.ri.gov>
Subject: Fwd: [EXTERNAL] Re: Application #2022-12-075

Hi Tracy,
Please see below for a new development at the Wilson Dr. property.
Please feel free to contact me with any questions.
Sincerely,

Stephen L Daignault Jr.
Director of Public Works
Town of Narragansett RI
401-782-0687

On Monday, May 20, 2024 at 02:49:29 PM EDT, Stephen Daignault <sdaignault@narragansettri.gov> wrote:

Mr. Veltri

In regards to my email to CRMC on February 9, 2023, which stated that the proposed structure is planned over or near Town drainage outfall pipes, it turns out that my statement was incorrect. The Town has received the updated survey of the property on Wilson Dr at Pettaquamscutt Ave. which was done by John A. Tzitzouris Land Surveying. This survey shows that the Town Drainage Pipes are within the Town Right of Way on Pettaquamscutt Ave. I visited the site today with our Engineering Staff and have verified that the pipe outflows are on our property. Therefore, DPW no longer has any issues with the drainage as it pertains to your lot.

Sincerely,

Stephen L. Daignault Jr.

Stephen L. Daignault Jr.

Town of Narragansett

Director of Public Works

Tree Warden

260 Westmoreland St.

Narragansett, RI 02882

401-782-0687; Fax 401-782-0694

sdaignault@narragansetttri.gov

www.narragansetttri.gov

Disclaimer

The information contained in this communication from the sender is confidential. It is intended solely for use by the recipient and others authorized to receive it. If you are not the recipient, you are hereby notified that any disclosure, copying, distribution or taking action in relation of the contents of this information is strictly prohibited and may be unlawful.

This email has been scanned for viruses and malware, and may have been automatically archived by **Mimecast Ltd**, an innovator in Software as a Service (SaaS) for business. Providing a **safer** and **more useful** place for your human generated data. Specializing in; Security, archiving and compliance. To find out more [Click Here](#).

Cstaff1

From: Stephen Daignault <sdaignault@narragansettri.gov>
Sent: Thursday, February 9, 2023 10:26 AM
To: cstff1@crmc.ri.gov
Cc: John Lawless; Michael Deluca; Daren McConnell
Subject: Application # 2022-12-075
Attachments: North End Drainage Maps 11x17 Wilson @ Pettaquamscutt ave.pdf

Follow Up Flag: Follow up
Flag Status: Flagged

Good Morning,
Please be advised as this drainage location/existence seems to have fallen through the cracks on this application. Apparently a proposed structure is planned over or near these drainage outfall pipes and obviously these need to be protected. I'm not sure how this happened because I believed that our staff double checked the location and on paper it was in the Right of Way. A site visit shows that the outfall pipe is within the private property according to the survey marker. Please make sure that this is considered with the application # 2022-12-075.

Stephen L. Daignault Jr.

Stephen L. Daignault Jr.
Town of Narragansett
Director of Public Works
Tree Warden
260 Westmoreland St.
Narragansett, RI 02882
401-782-0687; Fax 401-782-0694
sdaignault@narragansettri.gov
www.narragansettri.gov

Disclaimer

The information contained in this communication from the sender is confidential. It is intended solely for use by the recipient and others authorized to receive it. If you are not the recipient, you are hereby notified that any disclosure, copying, distribution or taking action in relation of the contents of this information is strictly prohibited and may be unlawful.

This email has been scanned for viruses and malware, and may have been automatically archived by **Mimecast Ltd**, an innovator in Software as a Service (SaaS) for business. Providing a **safer** and **more useful** place for your human generated data. Specializing in; Security, archiving and compliance. To find out more [Click Here](#).



Utility & Feature Legend

- OUTFALL (GPS DATA POINT)
- Catchbasin
- Drainage Manhole
- Storm Drain
- WETLANDS
- SWALE (NOT TO SCALE)
- STREAM
- POND - NATURAL
- POND - CONSTRUCTED

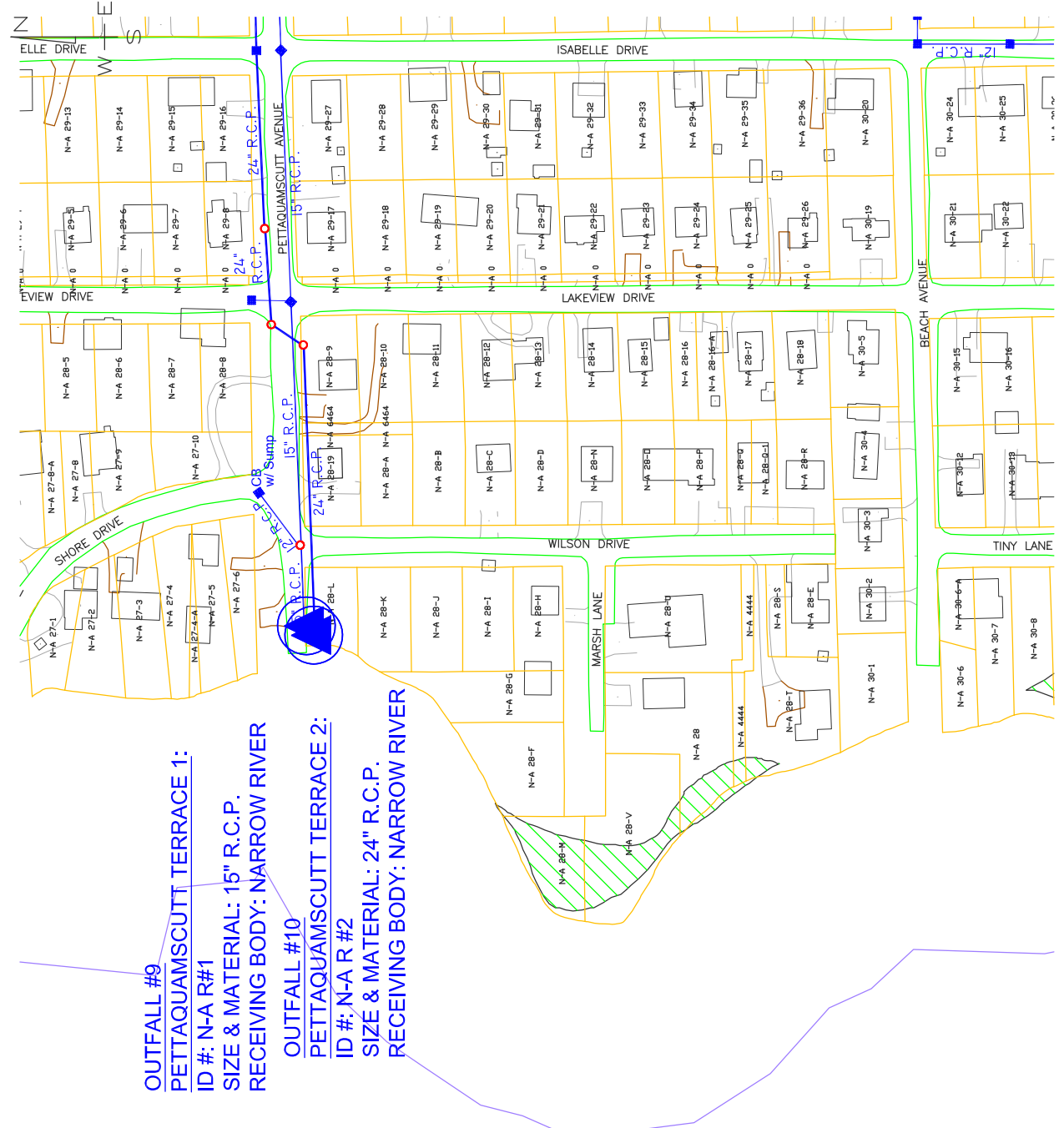

OUTFALL #9
PETTAQUAMSCUTT TERRACE 1:
ID #: N-A R #1
SIZE & MATERIAL: 15" R.C.P.
RECEIVING BODY: NARROW RIVER

OUTFALL #10
PETTAQUAMSCUTT TERRACE 2:
ID #: N-A R #2
SIZE & MATERIAL: 24" R.C.P.
RECEIVING BODY: NARROW RIVER