

April 9, 2025

Via Electronic Mail to cstaffl@crmc.ri.gov
State of Rhode Island Coastal Resources Management Council
Oliver H. Stedman Government Center
4808 Tower Hill Road, Suite 3
Wakefield, RI 02879-1900

Re: **CRMC File No. 2023-08-084 TSL, LLC; RIDEM Water Quality Certification Number 24-008**
– Installation of a berthing facility and expansion of existing marina for the mooring of a pool boat
for recreational purposes.

Dear Mr. Willis,

We have enclosed additional materials that were copied to CRMC on December 18, 2023, in association with TSL, LLC's filing with the RI Historic Preservation and Heritage Commission on this project. The applicant may use these additional materials at the CRMC hearing on this application.

In addition, TSL, LLC agrees to revise its storm response proposal filed with CRMC on November 7, 2024, to require removal of the pool boat from the water in the event of any tropical storm or hurricane that is forecasted to impact Bristol Harbor.

Thank you.

Sincerely,

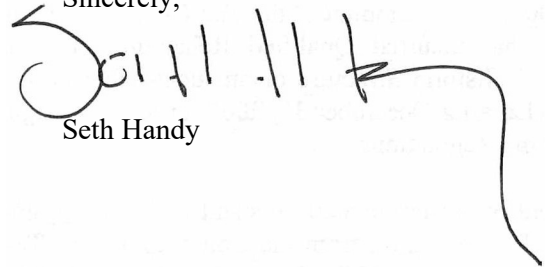
A handwritten signature in black ink, appearing to read "Seth Handy", with a long, sweeping horizontal line extending to the right.

Seth Handy

cc. Mark Ryan, Esq.
Tenessa Azar, Esq.

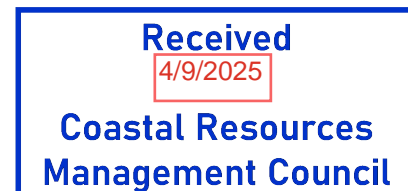

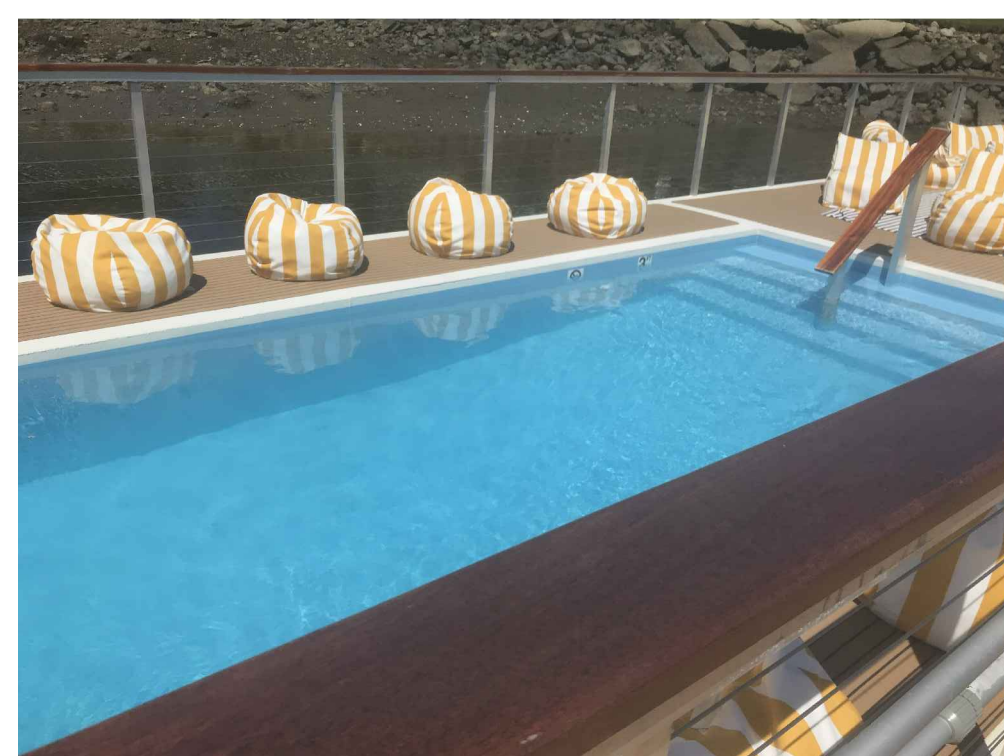
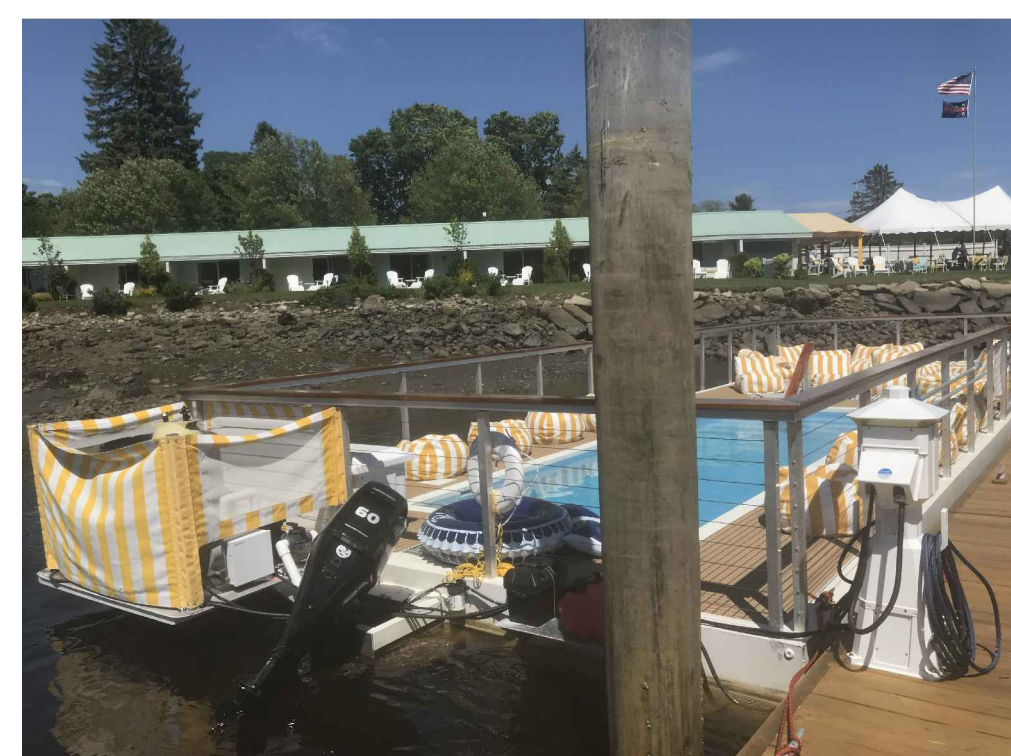
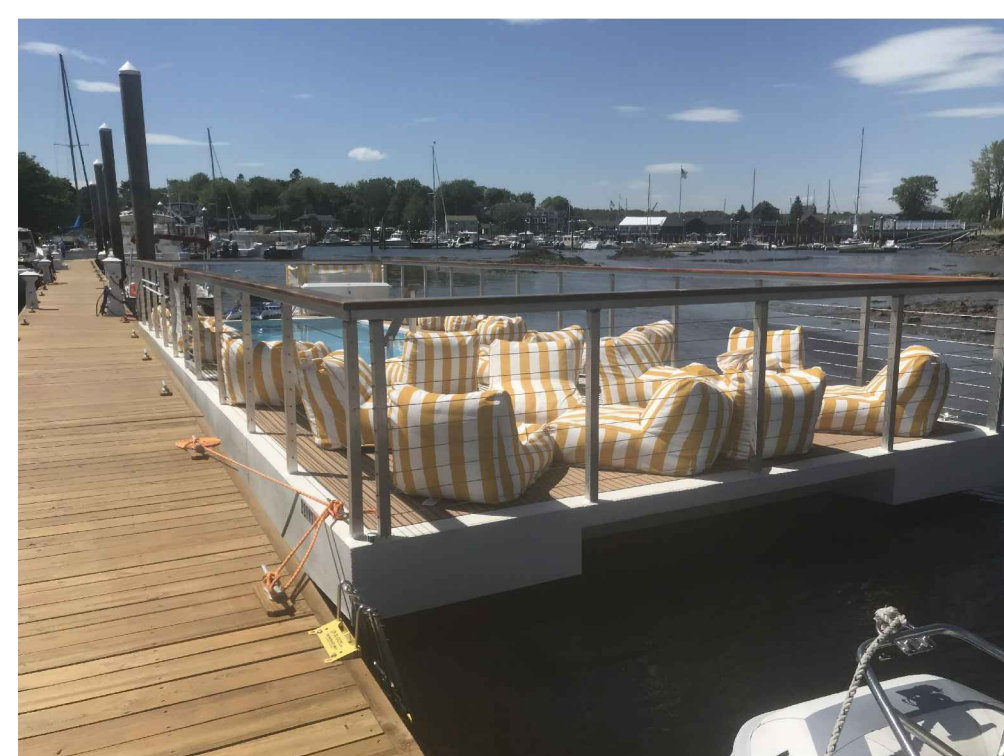
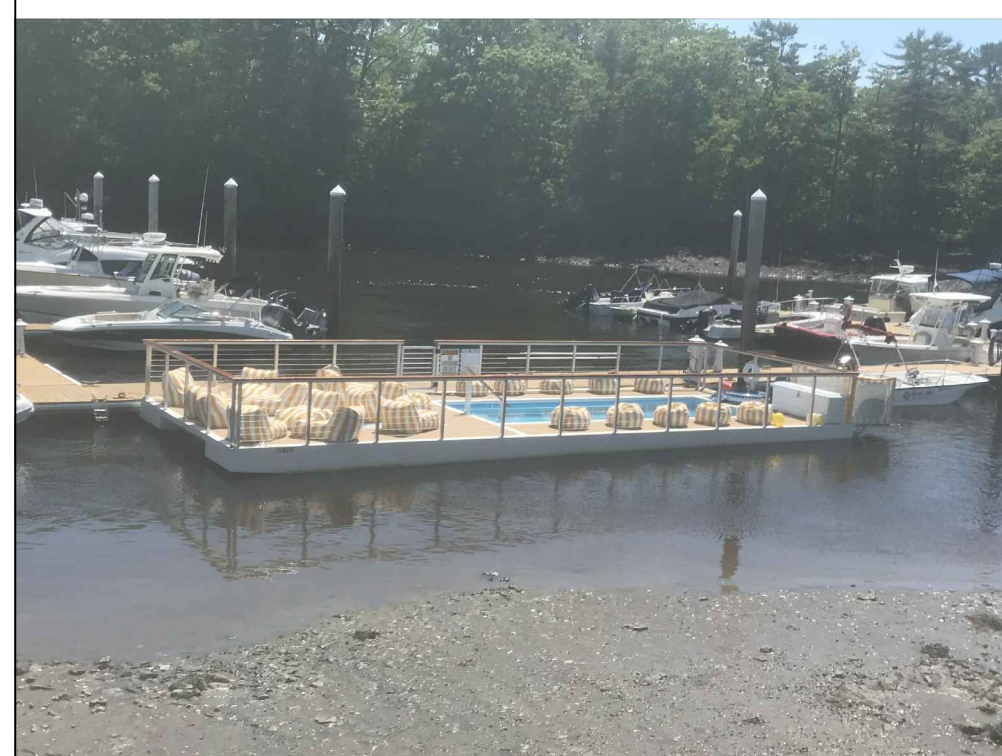
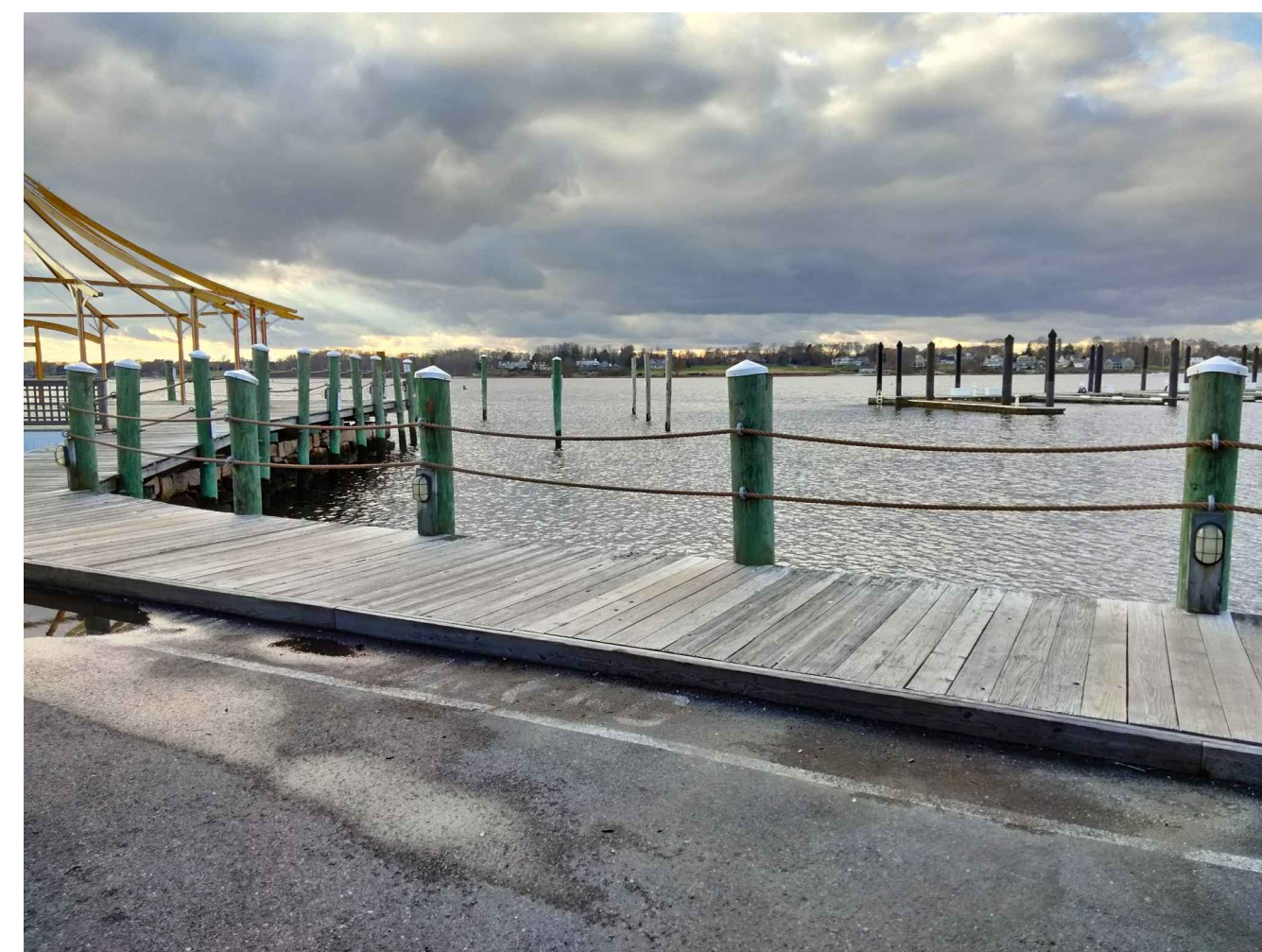
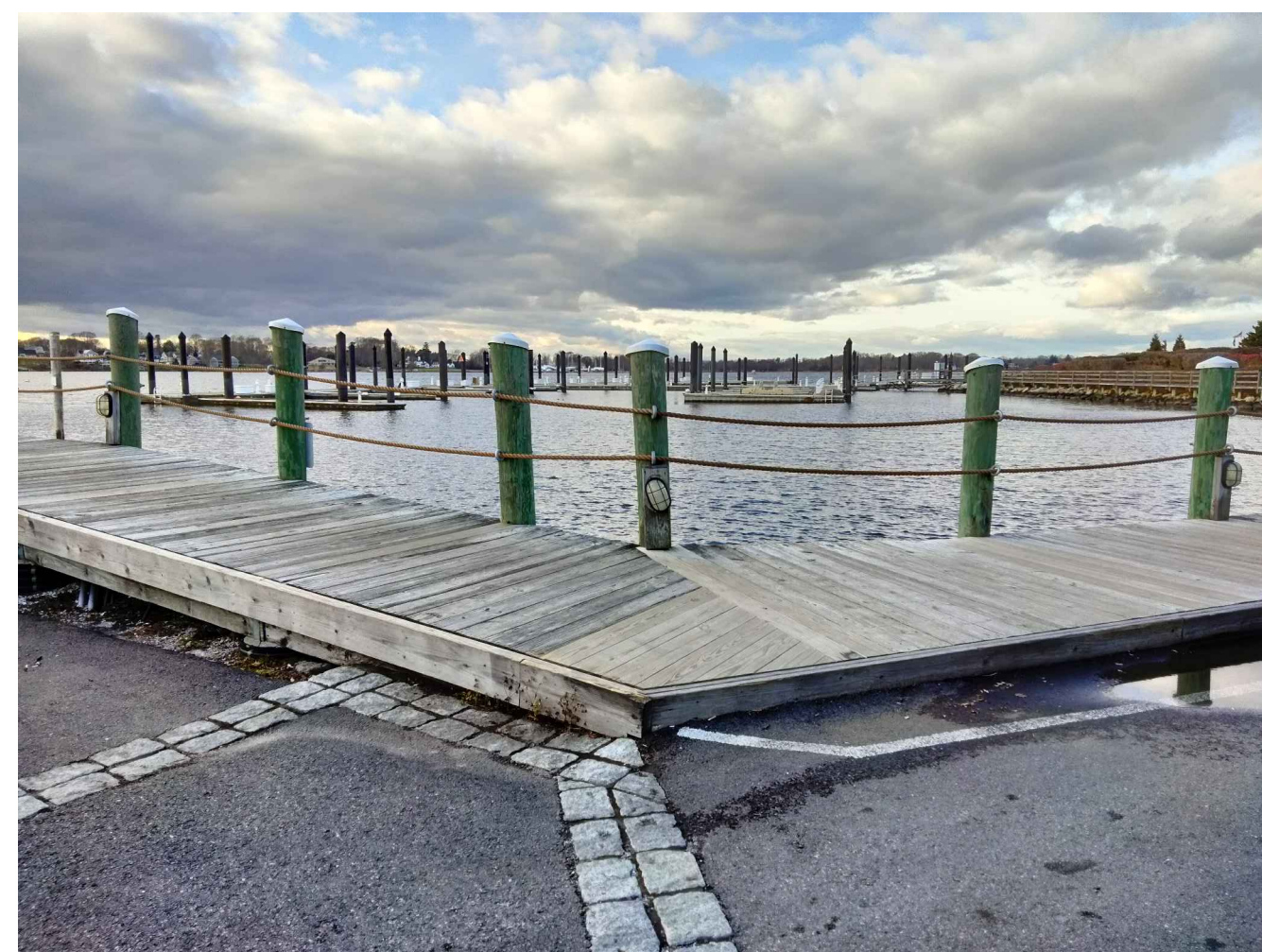
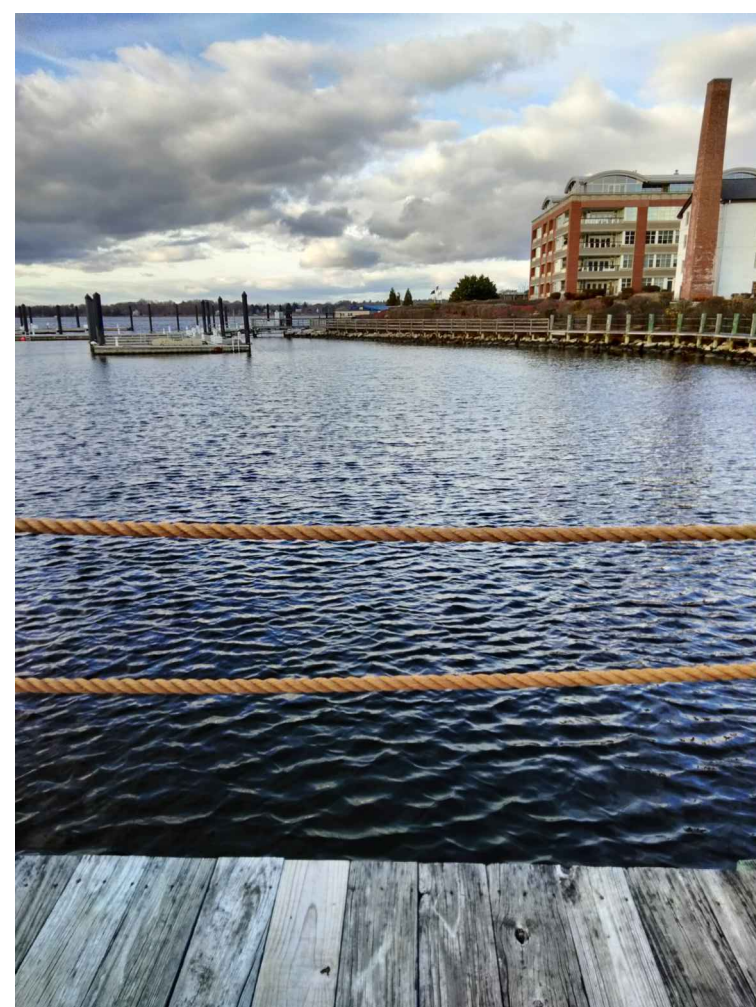
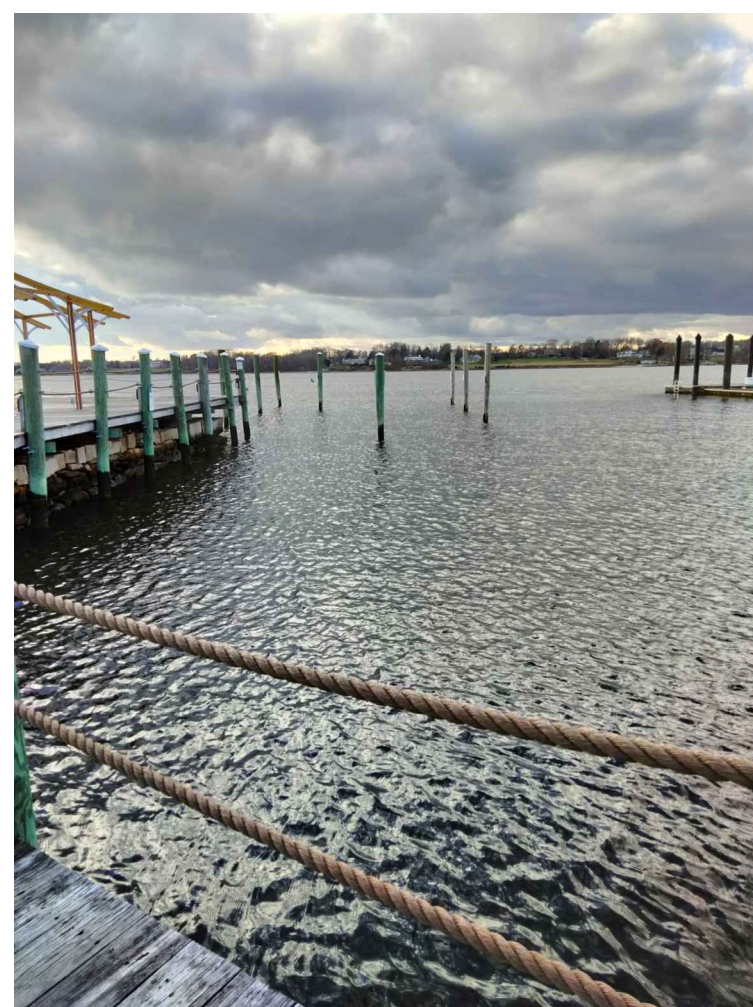

POOL BOAT PHOTOS ARE TYPICAL OF WHAT IS PROPOSED IN TERMS OF SIZE AND CONFIGURATION. PHOTOS ARE FROM EXISTING INSTALLATION AT ANOTHER SITE.

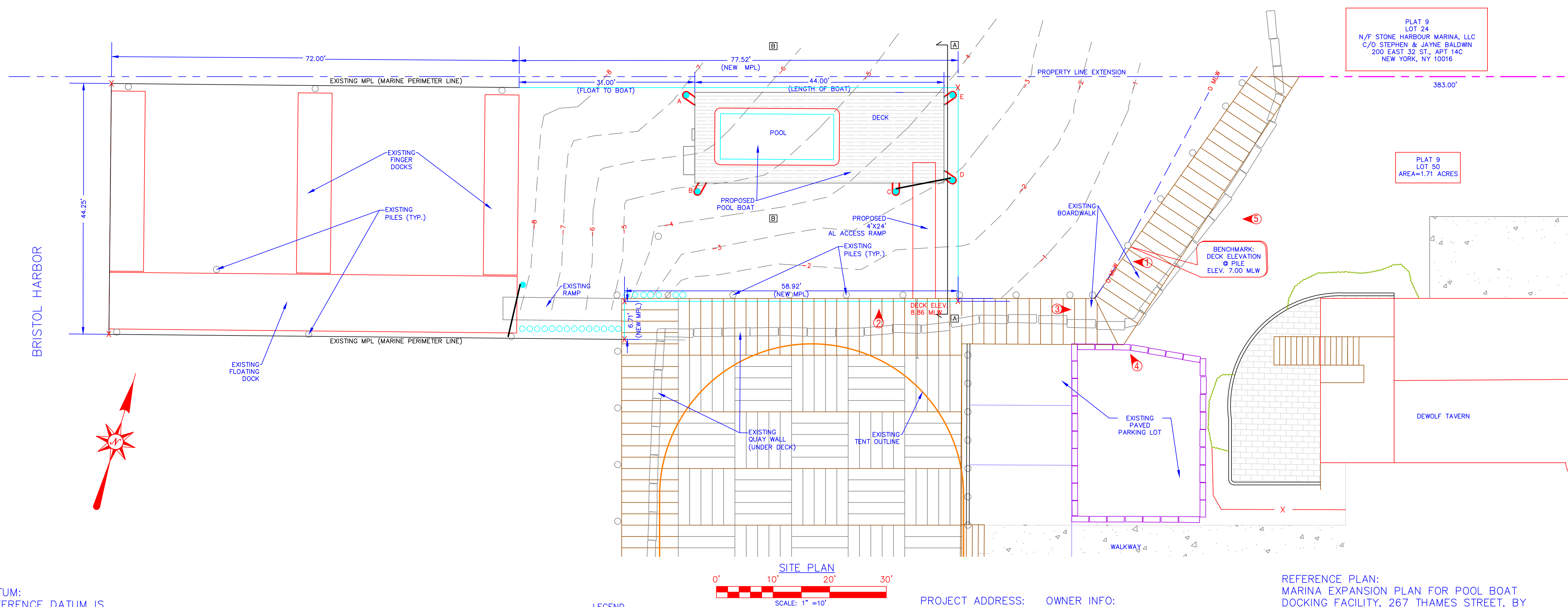

DATUM:
REFERENCE DATUM IS
MEAN LOW WATER

LEGEND

 PHOTO KEY

PROJECT ADDRESS:
267 THAMES ST.
BRISTOL, RI 02809

OWNER INFO:
TSL, LLC
244 GANO ST.
PROVIDENCE, RI 02906

REFERENCE PLAN:
MARINA EXPANSION PLAN FOR POOL BOAT
DOCKING FACILITY, 267 THAMES STREET, BY
SITE ENGINEERING INC. LAST REVISION DATE
5/23/23

Received
4/09/2025
Coastal Resources
Management Council

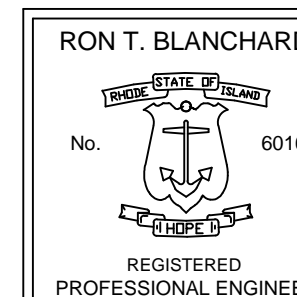

SITE PHOTOS
FOR POOL BOAT DOCKING FACILITY
267 THAMES ST.
PLAT 9, LOT 50

SEI
SITE ENGINEERING INC.

75 WOOD STREET
BRISTOL, RI 02809
PHONE: (401) 253-8231

RHODE ISI AND

BRISTOL

SCALE: AS NOTED

SHEET: 1 OF 2

SP-1