

RHODE ISLAND CONTRACT NO.	FISCAL YEAR	SHEET NO.	TOTAL SHEETS
	2025	1	6

PROPERTY OF BDPS, LLC EXISTING CONDITIONS TRESTLE PERMIT

CITY OF EAST PROVIDENCE
COUNTY OF PROVIDENCE

SHEET NO.	DESCRIPTION
1	COVER SHEET AND GENERAL NOTES
2	SURVEY PLAN AND EXISTING LAYOUT
3	TRESTLE PLAN
4	TRESTLE PROFILE
5	TRESTLE FRAMING PLAN
6	SECTION AND DETAILS

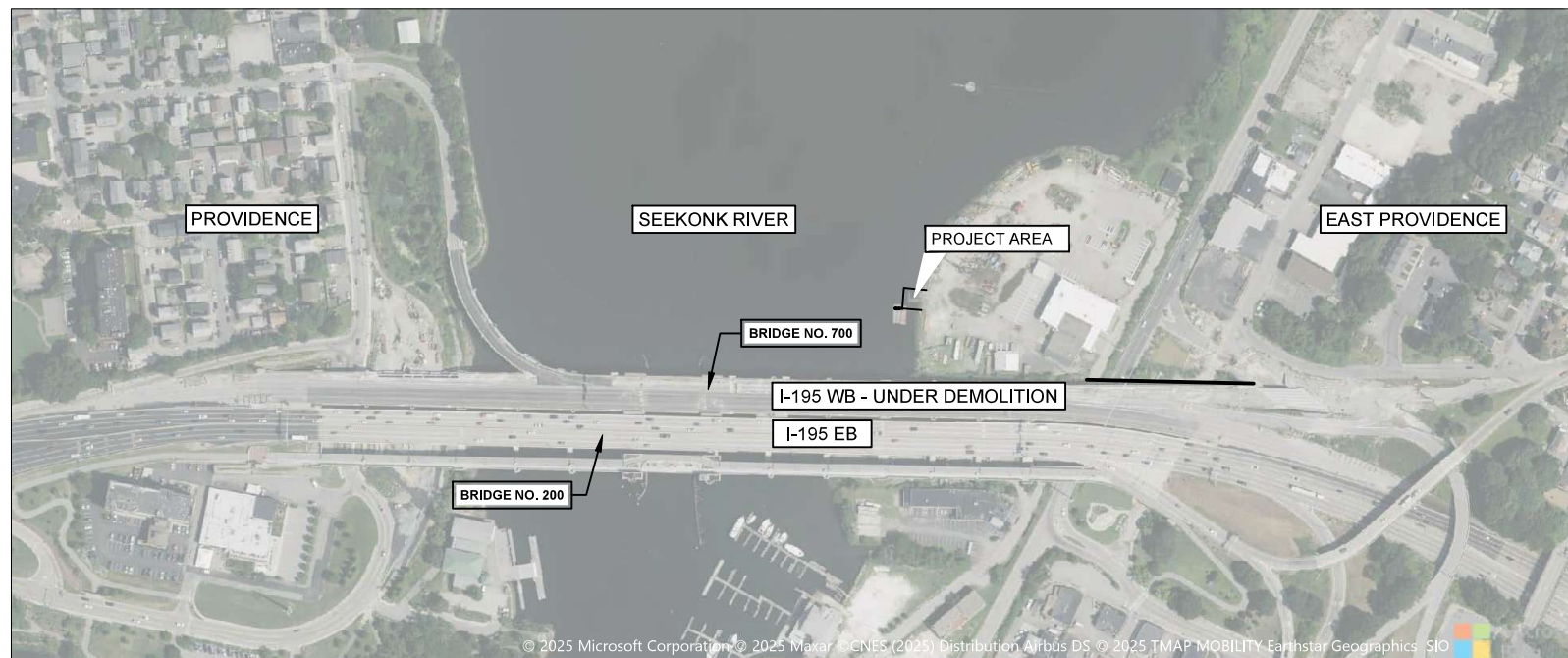

GENERAL NOTES

- LANDSIDE TOPOGRAPHY AND EXISTING CONDITIONS PLAN INFORMATION FOR THE PROPOSED AREA IS DEVELOPED FROM THE SURVEY PERFORMED, PREPARED AND PROVIDED BY NARRAGANSETT ENGINEERING INC., DATED 11/05/2025. REFER TO DRAWING SHEET 2 FOR SURVEY PLAN. ALL DIMENSIONS ARE IN FEET AND DECIMAL FEET. ELEVATIONS ARE REFERENCED TO THE NORTH AMERICAN VERTICAL DATUM OF 1988 (NAVD 88).
- CRMC WATER TYPE CLASSIFICATION AT THE PROPOSED SITE IS TYPE 4 PER RHODE ISLAND CRMC.
- WORK TRESTLE IMPROVEMENT TO THE DECK AND LANDSIDE FOOTING WERE AUTHORIZED AS TEMPORARY IMPROVEMENTS PER CRMC ASSENT A2025-02-013 ISSUED FEBRUARY 2025 AND USACE FILE NUMBER NAE-2020-01204 ISSUED IN JUNE 2025. CRMC ASSENT 1987-12-037 ISSUED IN DECEMBER OF 1987 AUTHORIZED THE EXISTING SHORELINE IMPROVEMENTS, INCLUDING THE EXISTING RIPRAP REVETMENT BORDERING THE SEEKONK RIVER.
- AS-BUILT DIMENSIONS AND MATERIALS IDENTIFIED ON THESE SHEETS FOR THE TRESTLE ARE FROM DRAWINGS AND CALCULATIONS DEVELOPED BY TRANSITION ENGINEERING INC., DATED 9/26/2024 TO AETNA BRIDGE COMPANY. THE DESIGN LOADS ARE BASED ON A CAT 390 EXCAVATOR.
- LOCATION OF WORK TRESTLE IS NOT IN A HIGH FETCH AREA PER REQUIREMENTS IN CRMC § 1.3.1.D.12

LAYOUT PLAN

SCALE: 1"=200'

Received
 2/16/2026
 Coastal Resources
 Management Council

Jacobs
100 Great Meadow Road, Suite 707
Wethersfield, CT 06109



Digitally signed by
Donald Costello
Date: 2025.12.08
12:18:08-05'00'

DESIGNED BY: MAA
CHECKED BY: MDA
DATE: NOVEMBER 2025
SHEET: 1
OF: 6

SCALE AS NOTED

REVISIONS			REVISIONS		
NO.	DATE	BY	NO.	DATE	BY

PROPERTY OF BDPS, LLC

EAST PROVIDENCE EXISTING CONDITIONS RHODE ISLAND

COVER SHEET AND GENERAL NOTES

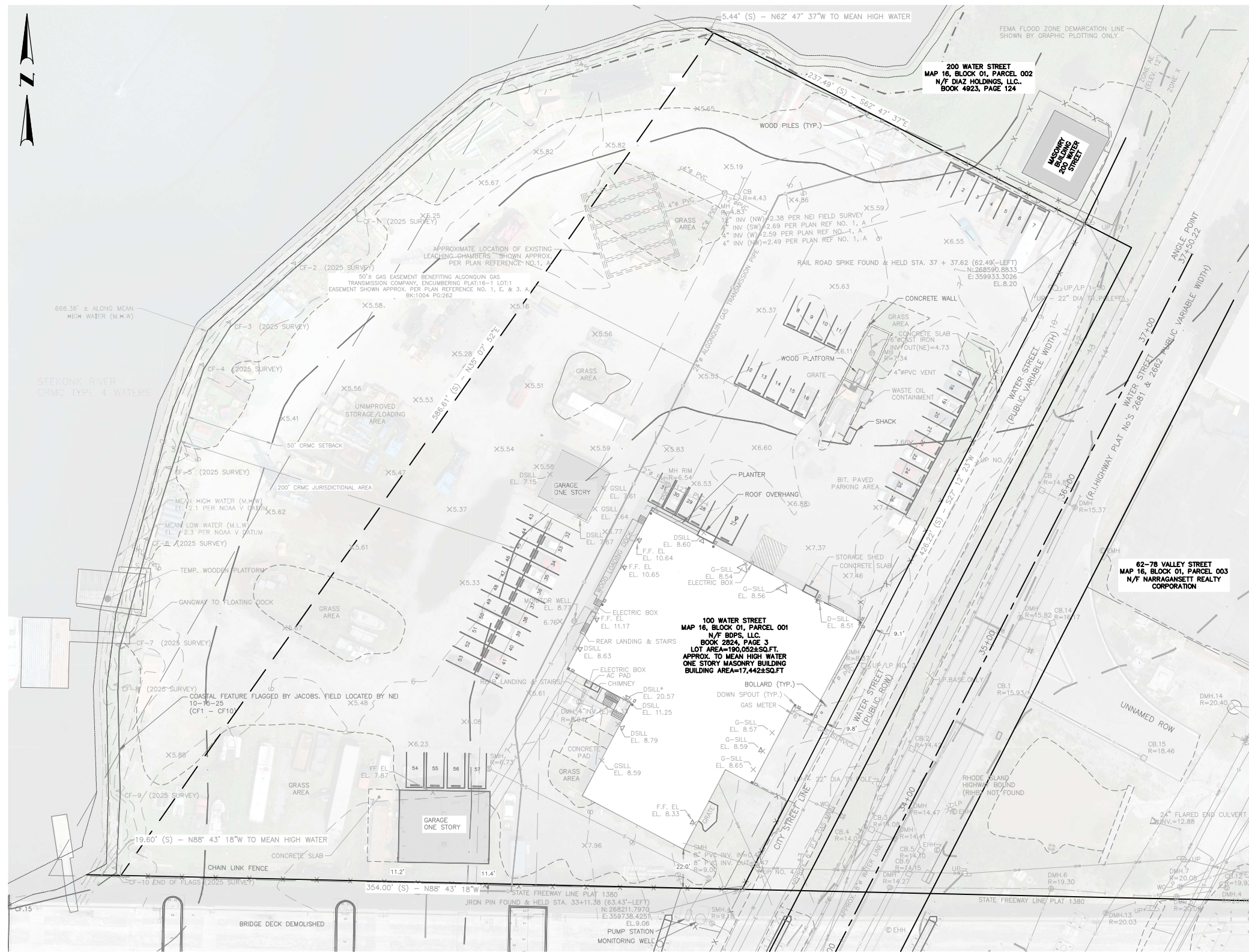

PLAN REFERENCES:
NOTES / REFERENCES

- REFERENCE IS MADE TO THE FOLLOWING MAPS AND PLANS OF RECORD:
 - PLAN ENTITLED 'BOUNDARY & TOPOGRAPHIC SURVEY PLAN' A.P. 16, BLOCK 1, PARCEL 1, 100 WATER STREET, EAST PROVIDENCE, RHODE ISLAND 02914, AMERICAN EQUIPMENT & FABRICATING CORP, PROJECT NO. 14-066, SCALE 1"=40' DATE 05/28/14 DRAWN BY BJT STAMPED 1-21-15
 - R.I. HIGHWAY PLATS No. 2681, 2662, 1732, 1400 & 1380.
 - PLAN ENTITLED 'BOUNDARY & TOPOGRAPHIC SURVEY PLAN' A.P. 16, BLOCK 2, PARCELS 1, 2 & 3 AND A.P. 16, BLOCK 3, PARCEL 2 WATER ST., MAURAN AVE. & WATERFRONT DR, EAST PROVIDENCE, RHODE ISLAND ALBERTINO MILHO 288 WARREN AVENUE EAST PROVIDENCE, RHODE ISLAND 02914 PROJECT NO. 12-048 SCALE: 1" = 30' DATE: 09/11/12 BY WATERMAN ENGINEERING CO.
 - PLAN ENTITLED 'LAND BELONGING TO THISTON BURGESS IN SEYONK, MASS. BY J. HOWE JULY, 1854 SCALE: 100 FT. TO AN INCH' WHICH IS RECORDED WITH THE LAND EVIDENCE RECORDS AT THE CITY OF EAST PROVIDENCE, RHODE ISLAND IN PLAT BOOK 1, PAGE 1.
- REFERENCE IS MADE TO THE FOLLOWING CITY OF EAST PROVIDENCE LAND EVIDENCE RECORDS REGARDING RECORDED TITLE TO THE PREMISES SURVEYED:
 - MAP 16, BLOCK 1, PARCEL 1 - BDPS, LLC - VOLUME 2824, PAGE 3
- THESE PREMISES MAY BE SUBJECT TO THE FOLLOWING EASEMENTS, RIGHTS OF WAY OR AGREEMENTS OF RECORD:
 - EASEMENT GRANTED TO THE ALGONQUIN GAS TRANSMISSION COMPANY AS DESCRIBED IN VOLUME 1004, PAGE 262 AND SHOWN ON PLAN REF. 1(E).
 - EASEMENTS MAY EXIST REGARDING THE LOCATION OF THE GUY WIRES AS THEY CURRENTLY EXIST (NO RECORDS FOUND.)
 - AN EASEMENT MAY EXIST REGARDING THE LOCATION OF THE WATER SERVICE TO 200 WATER STREET AS IT CURRENTLY EXISTS (NO RECORDS FOUND.)
- THESE PREMISES ARE SITUATED IN A BHP ZONE (BOLD POINT HARBOR SPECIAL DEVELOPMENT SUB-DISTRICT).
- THESE PREMISES ARE SITUATED IN A ZONE M² (EL. 12) AS DESIGNATED ON THE 'NATIONAL FLOOD INSURANCE PROGRAM, FIRM FLOOD INSURANCE RATE MAP PROVIDENCE COUNTY, RHODE ISLAND (ALL JURISDICTIONS) PANEL 309 OF 451 CITY OF EAST PROVIDENCE MAP NUMBER 4400700309J EFFECTIVE DATE: SEPTEMBER 18, 2013. FEDERAL EMERGENCY MANAGEMENT AGENCY.'
- ANY UTILITIES SHOWN ON THIS PLAN HAVE BEEN LOCATED FROM FIELD SURVEY INFORMATION AND EXISTING PLANS. THE SURVEYOR MAKES NO GUARANTEE THAT THE UTILITIES SHOWN COMPRISE ALL SUCH OR ABANDONED. THE SURVEYOR DOES NOT WARRANT THAT THE UTILITIES SHOWN ARE IN THE EXACT LOCATION INDICATED. ALTHOUGH THEY ARE LOCATED AS ACCURATELY AS POSSIBLE FROM ALL AVAILABLE INFORMATION, (PLEASE CALL DIG SAFE AT LEAST 72 HOURS PRIOR TO CONSTRUCTION AT PHONE NO. 1-888-DIG-SAFE AND/OR LOCAL UTILITY COMPANIES.)
- THE HORIZONTAL DATUM FOR THIS PROJECT IS THE R.L.S.P.C.S. (NAD 83) AND THE VERTICAL DATUM FOR THIS PROJECT IS NAVD 88. ELEVATIONS WERE ESTABLISHED FROM DATA TRANSMITTED FROM MTS REFERENCE STATIONS USING THE MTS RTK NETWORK VIA LEICA GPS1200 SERIES & CARLSON SURVEYOR SERIES GPS ANTENNAS/RECEIVERS CONTROL POINTS OBSERVED WITH LEICA GPS1200 SERIES & CARLSON SURVEYOR - DATA COLLECTOR.
- THE HARBOR LINES SEAWARD OF THE MEAN HIGH-WATER LINE SHOWN ARE THOUGHT TO BE EXTINGUISHED BY THE RHODE ISLAND GENERAL ASSEMBLY.

COASTAL FEATURE FLAGGING:

FLAGGING PERFORMED BY JACOBS (CRAIG WOOD PWS) IN OCTOBER 2025
 - FIELD LOCATED BY NARRAGANSETT ENGINEERING INC. VIA GPS ON OCTOBER 26, 2025
 - FLAG LINE CF-1 TO CF-10

Received
 2/16/2026
 Coastal Resources
 Management Council

NOTES

- THIS PLAN IS BASED OFF OF DRAWINGS PREPARED BY NARRAGANSETT ENGINEERING INC. DATED NOVEMBER 14, 2025

GRAPHIC SCALE

*ORIGINAL SHEET SIZE IS 22"X34"



DESIGNED BY:	MAA	SCALE AS NOTED	
CHECKED BY:	MDA		
DATE:	NOVEMBER 2025		
SHEET:	2		
OF:	6		

PROPERTY OF BDPS, LLC		EAST PROVIDENCE			EXISTING CONDITIONS			RHODE ISLAND		
		SURVEY PLAN AND EXISTING LAYOUT								

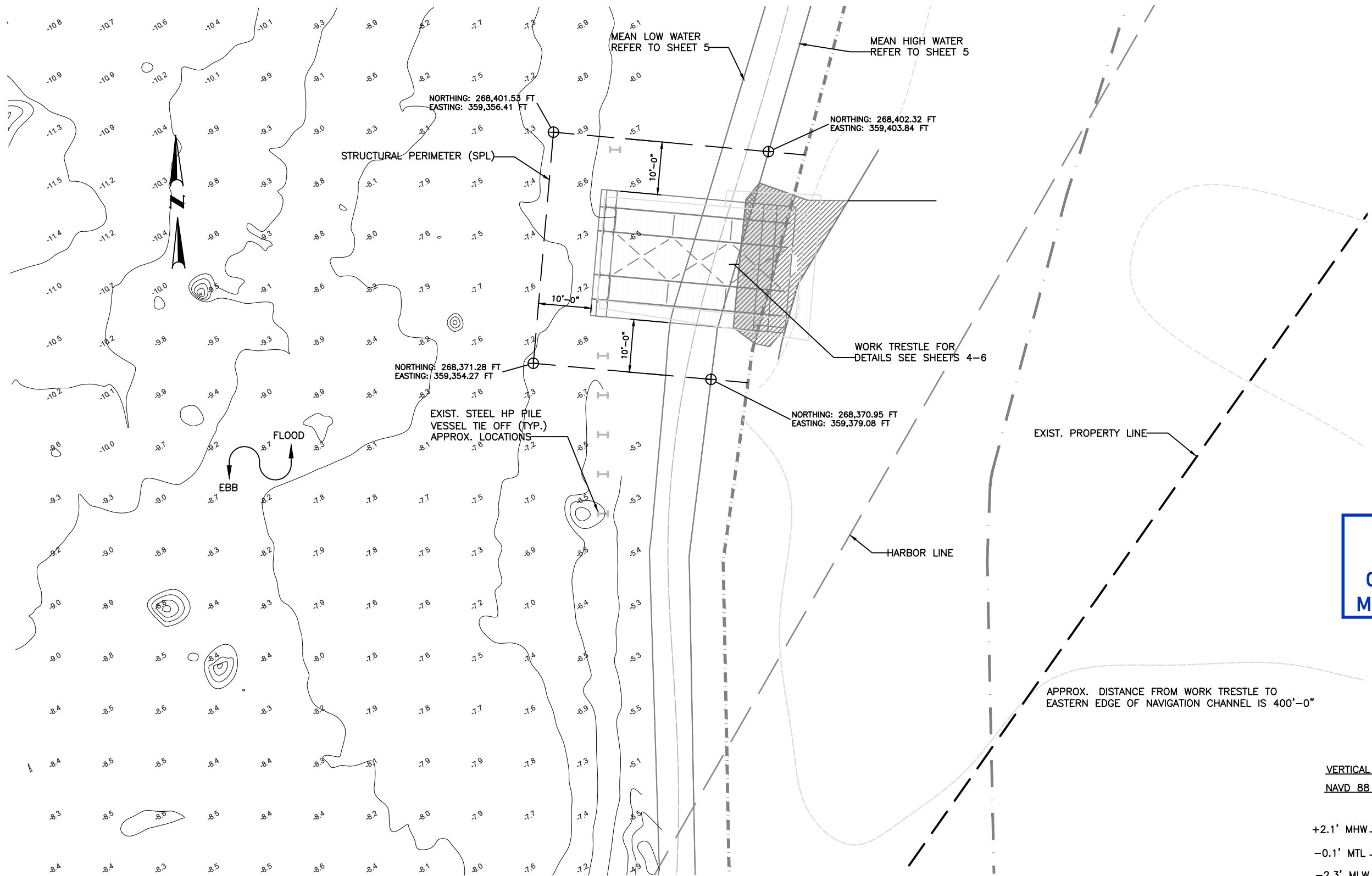

Received
 2/16/2026
Coastal Resources Management Council

VERTICAL DATUM CONVERSION

NAVD 88 DATUM	MLW DATUM
+2.1' MHW	EL. 4.4' MHW
-0.1' MTL	EL. 2.2' MTL
-2.3' MLW	EL. 0' MLW

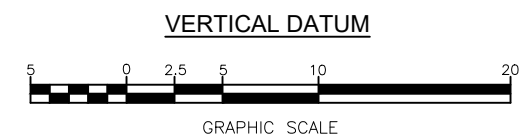
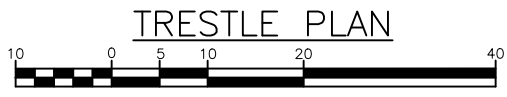

NOTES

1. TOPOGRAPHY AND EXISTING CONDITIONS INFORMATION ARE BASED ON THE FIELD SURVEY DRAWING DEVELOPED BY NARRAGANSETT ENGINEERING INC. DATED NOVEMBER 5, 2025.

Jacobs
 100 Great Meadow Road, Suite 707
 Wethersfield, CT 06109

DESIGNED BY:	MAA	SCALE AS NOTED					
CHECKED BY:	MDA						
DATE:	NOVEMBER 2025	REVISIONS			REVISIONS		
SHEET:	3	NO.	DATE	BY	NO.	DATE	BY
OF:	6						

PROPERTY OF BDPS, LLC
 EAST PROVIDENCE EXISTING CONDITIONS RHODE ISLAND
TRESTLE PLAN

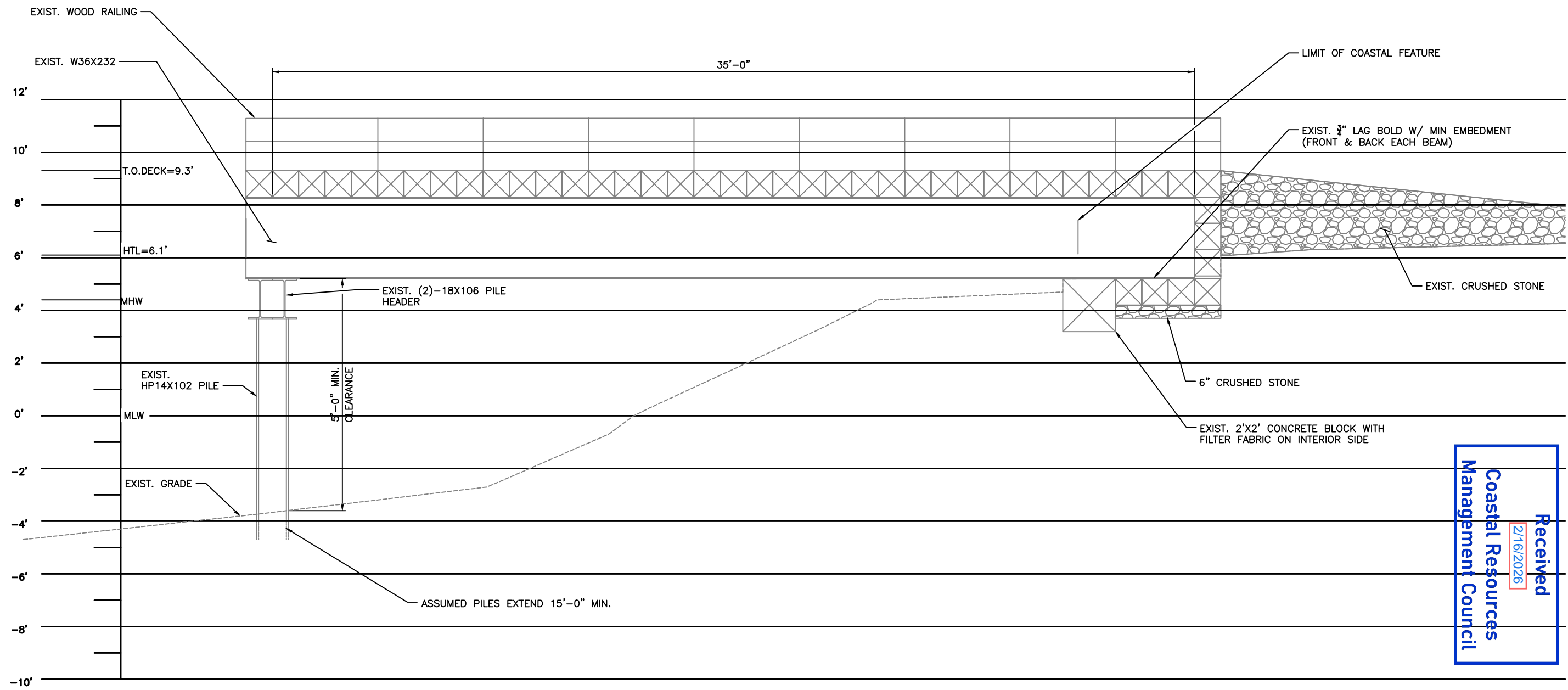

Received
 2/16/2026
 Coastal Resources
 Management Council

TRESTLE PROFILE



*ORIGINAL SHEET SIZE IS 22"x34"

- NOTES:
- TRESTLE WORK IMPROVEMENTS ARE MODELED BASED ON DRAWINGS DEVELOPED BY TRANSITION ENGINEERING INC. DATED 9/26/2024
 - SEDIMENT AT RIVER BOTTOM IS SANDY MUCK

VERTICAL DATUM CONVERSION
 NAVD 88 DATUM MLW DATUM

+2.1' MHW	EL. 4.4' MHW
-0.1' MTL	EL. 2.2' MTL
-2.3' MLW	EL. 0' MLW

VERTICAL DATUM

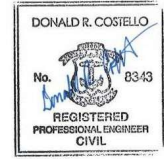
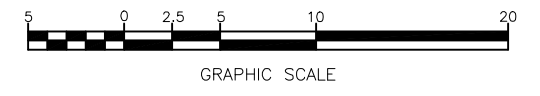

DESIGNED BY:	MAA	SCALE AS NOTED					
CHECKED BY:	MDA						
DATE:	NOVEMBER 2025	REVISIONS			REVISIONS		
SHEET:	4	NO.	DATE	BY	NO.	DATE	BY
OF:	6						

PROPERTY OF BDPS, LLC
 EAST PROVIDENCE EXISTING CONDITIONS RHODE ISLAND
TRESTLE PROFILE

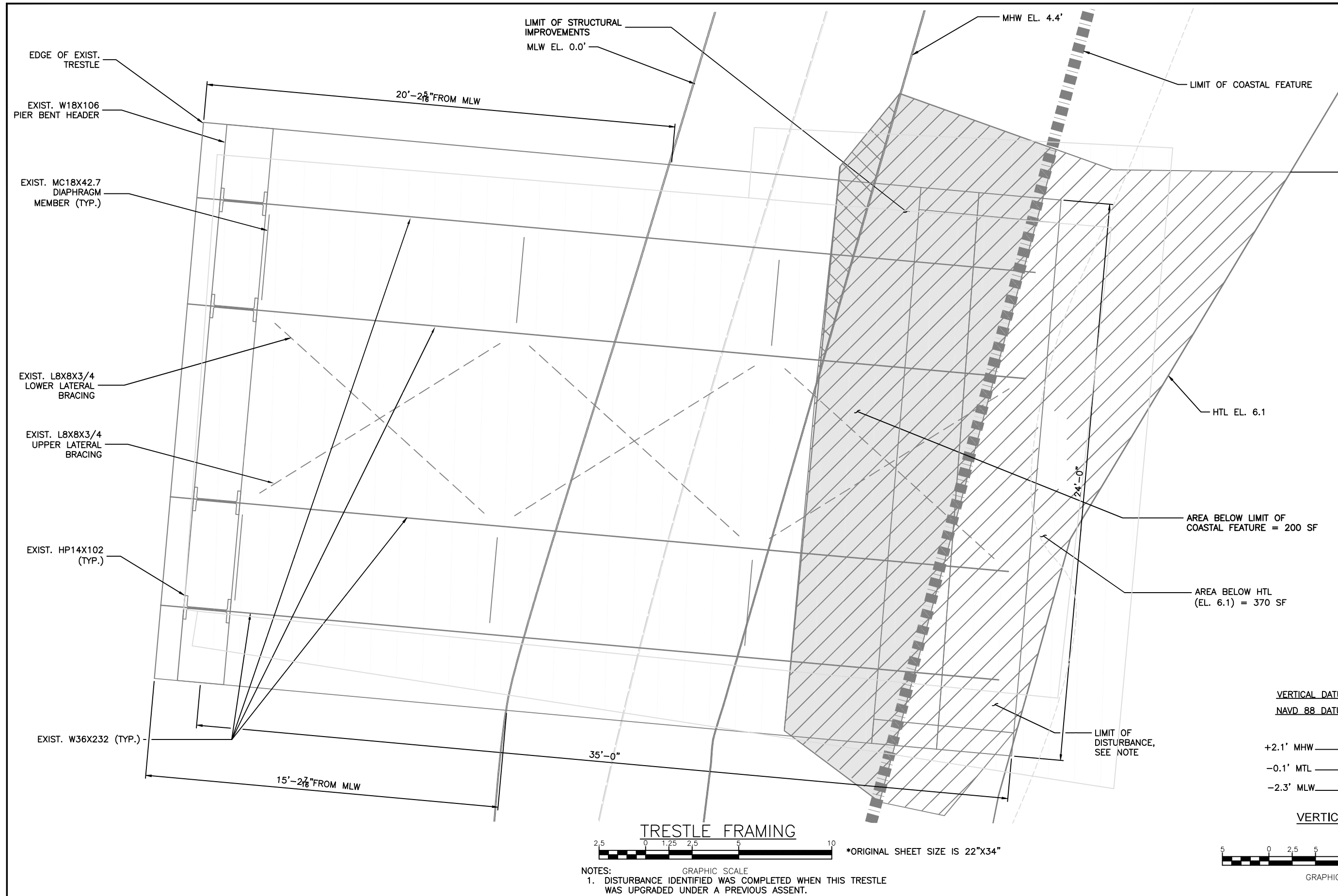

Received
 2/16/2026
 Coastal Resources
 Management Council

VERTICAL DATUM CONVERSION

NAVD 88 DATUM	MLW DATUM
+2.1' MHW	EL. 4.4' MHW
-0.1' MTL	EL. 2.2' MTL
-2.3' MLW	EL. 0' MLW

VERTICAL DATUM



*ORIGINAL SHEET SIZE IS 22"X34"



NOTES:
 1. DISTURBANCE IDENTIFIED WAS COMPLETED WHEN THIS TRESTLE WAS UPGRADED UNDER A PREVIOUS ASSENT.

Jacobs
 100 Great Meadow Road, Suite 707
 Wethersfield, CT 06109



*ORIGINAL SHEET

DESIGNED BY: MAA
 CHECKED BY: MDA
 SIZE IS 24X36
 DATE: NOVEMBER 2025
 SHEET: 5
 OF: 6

SCALE AS NOTED

REVISIONS			REVISIONS		
NO.	DATE	BY	NO.	DATE	BY

PROPERTY OF BDPS, LLC
 EAST PROVIDENCE EXISTING CONDITIONS RHODE ISLAND
TRESTLE FRAMING PLAN

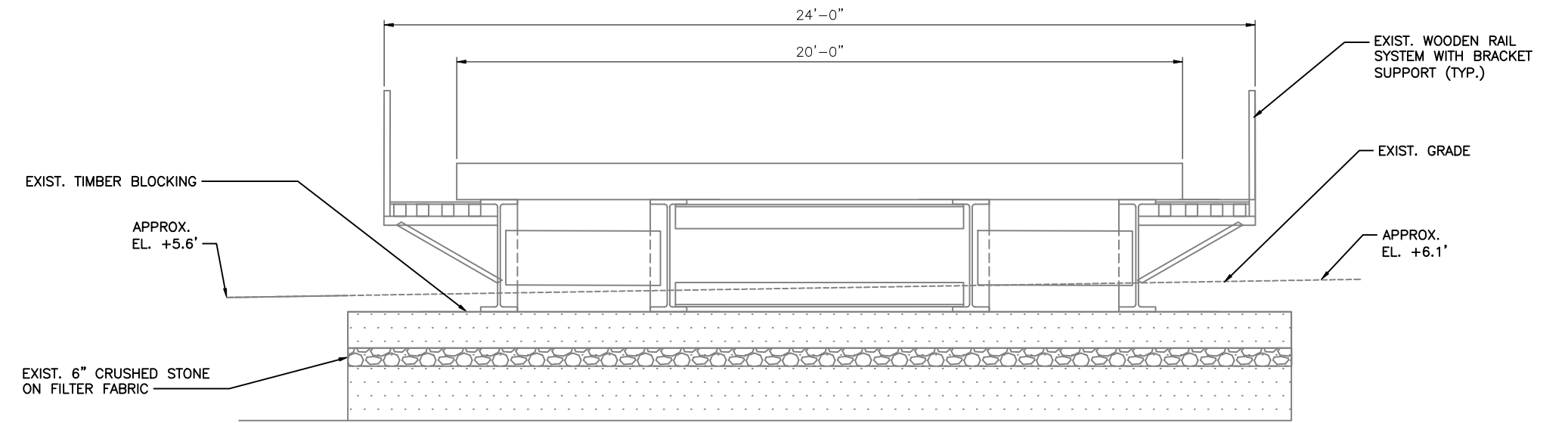

TRESTLE SECTION AT LANDSIDE

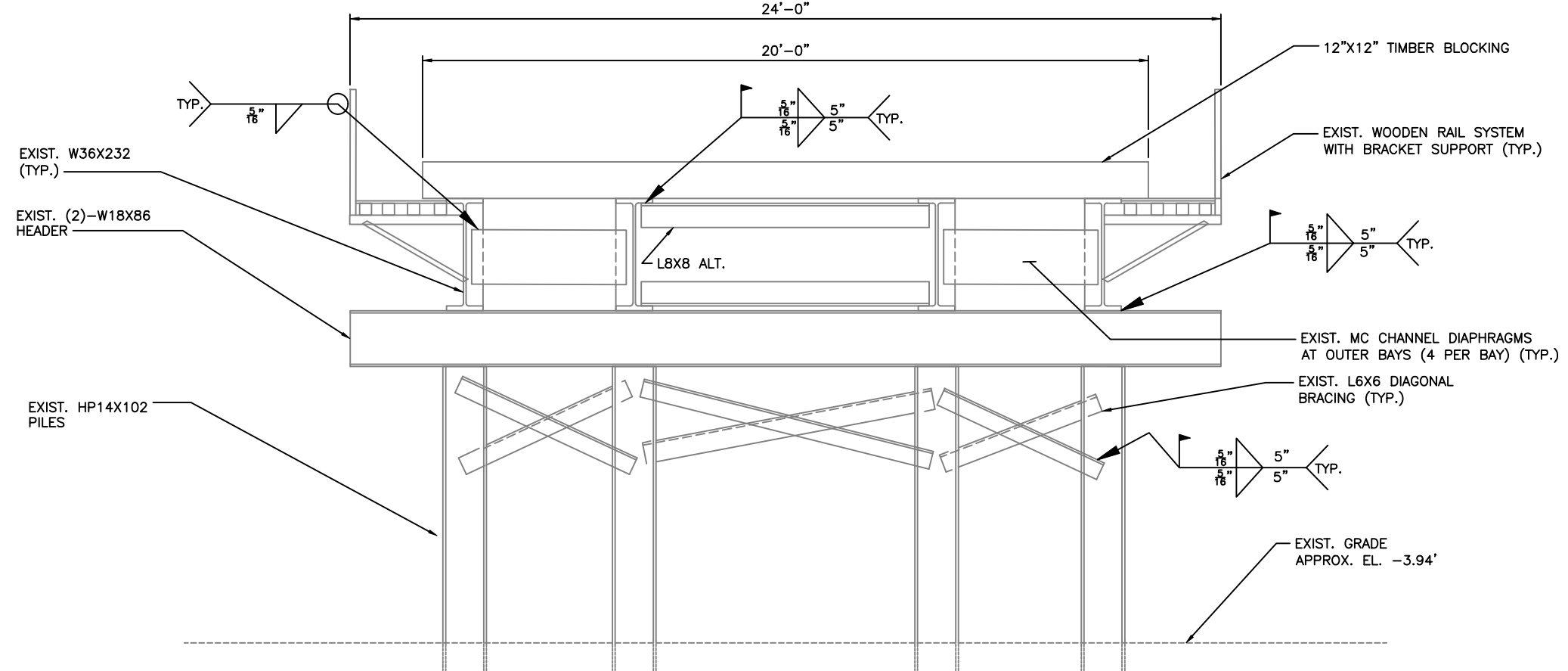

TRESTLE SECTION AT PILE BENT



- NOTES:
- TRESTLE WORK IMPROVEMENTS ARE MODELED BASED ON FIELD SURVEY AND DRAWINGS DEVELOPED BY TRANSITION ENGINEERING INC. DATED 9/26/2024.
 - ALL TRESTLE COMPONENTS ARE EXISTING AND TO REMAIN IN PLACE

Received
 2/16/2026
 Coastal Resources
 Management Council

VERTICAL DATUM CONVERSION

NAVD 88 DATUM	MLW DATUM
+2.1' MHW	EL. 4.4' MHW
-0.1' MTL	EL. 2.2' MTL
-2.3' MLW	EL. 0' MLW

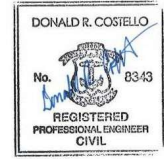
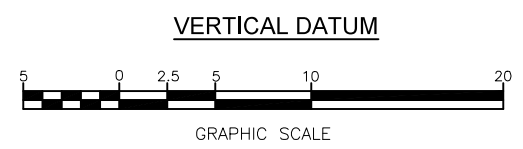

DESIGNED BY:	MAA	SCALE AS NOTED					
CHECKED BY:	MDA						
DATE:	NOVEMBER 2025	REVISIONS			REVISIONS		
SHEET:	6	NO.	DATE	BY	NO.	DATE	BY
OF:	6						

PROPERTY OF BDPS, LLC
 EAST PROVIDENCE EXISTING CONDITIONS RHODE ISLAND
 SECTION AND DETAILS