



State of Rhode Island
Coastal Resources Management Council
Oliver H. Stedman Government Center
4808 Tower Hill Road, Suite 3
Wakefield, RI 02879-1900

(401) 783-3370
Fax (401) 783-2069

PUBLIC RE-NOTICE

File Number: 2026-03-014 Date: June 15, 2026

This office has under consideration the application of:

Bradley J. Herman & Stacey Herman, TE
14 Holmested Court
Jamestown, RI 02835

for a State of Rhode Island Assent to construct and maintain:

A residential boating facility consisting of a 4' x 154' fixed timber pier including a 4' x 20' "L" section at seaward terminus, including a 1,200 lb capacity boat tender lift, and pier and beach access stairs. The facility extends 73' seaward of Mean Low Water (MLW) to -5' MLW water depth, per SAV regulations (§1.3.1.D.11.(w), and, §1.3.1.R.). A 23' variance to the 50' MLW standard is required (§1.3.1.D.11(l)(2)).

Project Location:	14 Holmested Court
City/Town:	Jamestown
Plat/Lot:	Plat 2, lot 100
Waterway:	Narragansett Bay, East Passage

Plans of the proposed work can be requested at Cstaff1@crmc.ri.gov.

In accordance with the Administrative Procedures Act (Chapter 42-35 of the Rhode Island General Laws) you may request a hearing on this matter.

You are advised that if you have good reason to enter protests against the proposed work it is your privilege to do so. It is expected that objectors will review the application and plans thoroughly, visit site of proposed work if necessary, to familiarize themselves with the conditions and cite what law or laws, if any, would in their opinion be violated by the work proposed.

If you desire to protest, you must attend the scheduled hearing and give sworn testimony. A notice of the time and place of such hearing will be furnished you as soon as possible after receipt of your request for hearing. If you desire to request a hearing, to receive consideration, it should be in writing (**with your correct mailing address, e-mail address and valid contact number**) and be received at this office on or before **July 15, 2026**.

Please email your comments/hearing requests to: cstaff1@crmc.ri.gov; or mail via USPS to: Coastal Resources Management Council; O. S. Government Center, 4808 Tower Hill Road, Rm 116; Wakefield, RI 02879.

/lat

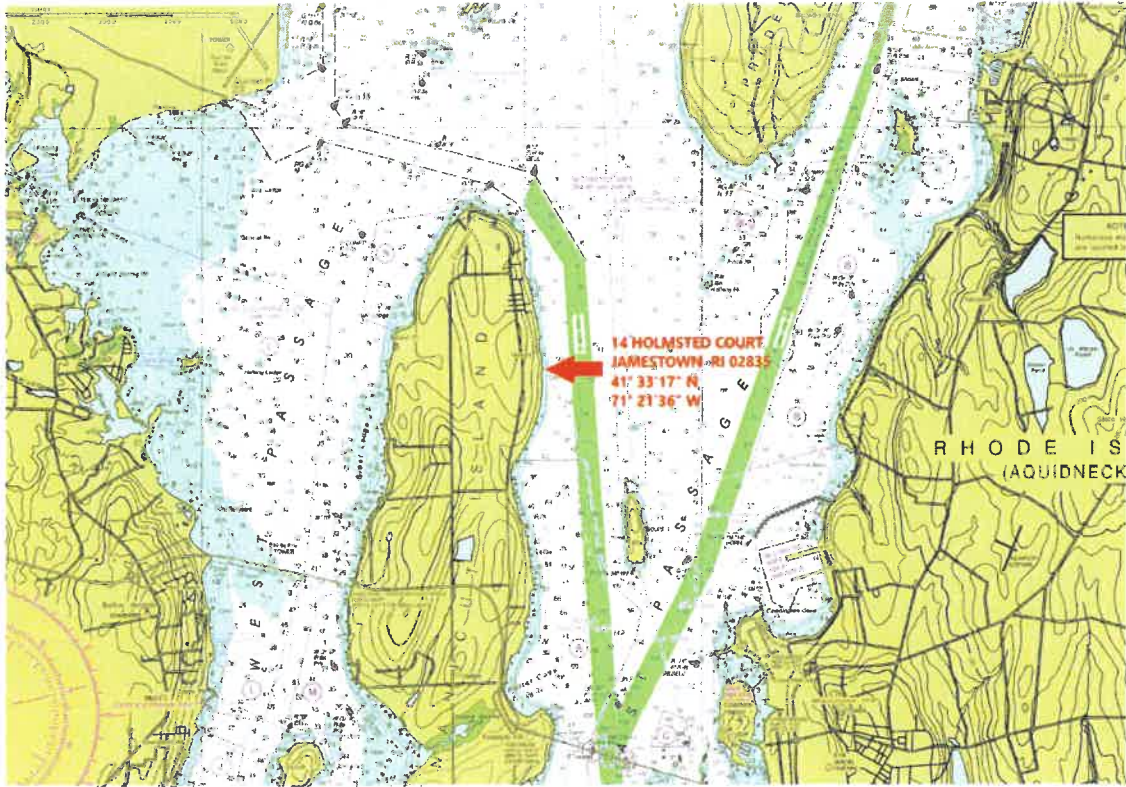

LOCUS (NOAA CHART 13221)

APPLICATION BY:
 Brad J. Herman
 14 Holmsted Court
 Jamestown, RI 02835



APPLICATION FOR:
 C/M 4' X 154' Fixed Timber Pier
 including 4' x 20' "L" section at terminus
 including 1,200 lb capacity boat tender lift,
 and pier and beach access stairs. Facility
 extends 73' seaward of MLW to -5' MLW
 per SAV regulations.

APPLICATION BY:
 Ken Anderson PE
 725 N Main Rd
 Jamestown, RI 02835

KENNETH W. ANDERSON



1/30/26

HERMAN RESIDENTIAL BOATING FACILITY

14 HOLMSTED COURT
 JAMESTOWN, RI 02835

by KWA

scale NOTED

date 1/30/26

sheet 1 of 9



JAMESTOWN PLAT MAP (2023)



AERIAL (2025)



LOOKING WEST (2025)

KENNETH W. ANDERSON



REGISTERED
PROFESSIONAL ENGINEER
1/30/26

HERMAN RESIDENTIAL BOATING FACILITY

14 HOLMESTED COURT
JAMESTOWN, RI 02835

by KWA

scale NTS

date 1/30/26

sheet 2 OF 9

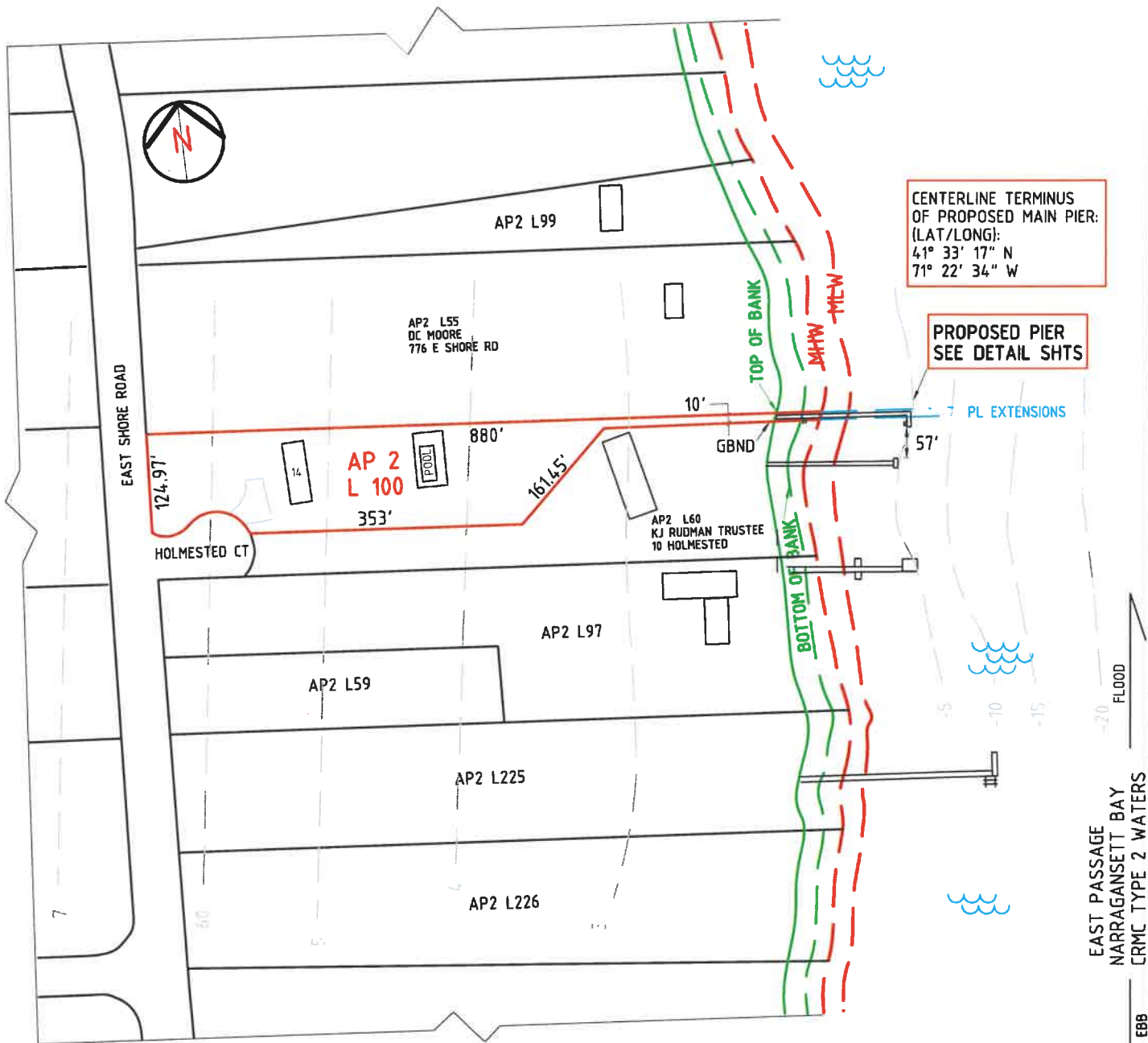

CENTERLINE TERMINUS
OF PROPOSED MAIN PIER:
(LAT/LONG):
41° 33' 17" N
71° 22' 34" W

PROPOSED PIER
SEE DETAIL SHTS

PROPOSED SITE PLAN

REF NOAA, USGS, & TOWN OF
JAMESTOWN GIS. ALL DATA APPROX.



KENNETH W. ANDERSON

No. 5063

Kenneth W. Anderson

REGISTERED
PROFESSIONAL ENGINEER

1/30/26

HERMAN RESIDENTIAL BOATING FACILITY

14 HOLMSTED COURT
JAMESTOWN R1 02835

by KWA scale NOTED date 1/30/26

sheet 3 OF 9

RECEIVED
FEB 26 2026
COAST GUARD SERVICES
MANAGEMENT COUNCIL



AP 2, LOT 55
DC MOORE
776 E SHORE RD
JAMESTOWN RI 02835

APPLICANT:
AP 2, LOT 100
B&S HERMAN
14 HOLMESTED CT
JAMESTOWN RI 02835

REBUILD EXTG
STAIRS INTO
NEW PIER
(CENTER W/IN
10' PROP WTH)

WOODED TREE
& GRASS COVER

TOP OF BANK

BOTTOM OF BANK

VEG'D
SLOPE

SAND & EXP'D
LEDGE & BLDRS

REF ECOTONES INC
SAV REPORT
DTD 11/21/25

BURDICK & SHORT HEIGHTS
H=3.08m + .02(X)
H=3.08m + .2(8) = 4.68m=15.4'
H=3.08m + .2(0) = 3.08m=10.1'

HERMAN MOORING
184' FROM MLW

PROPERTY LINE

PROPERTY LINE

GRANITE BOUND

583' +/- TO
DWELLING

GRASS/SHRUB
COVER

TOP OF
BANK

BOTTOM
OF BANK

ELEV 14.4' MLW

1:17.6 SLOPE

+11.9'

EL 7' MLW

6'X8' "CAT 1" SM BOAT
LIFT (1200# MAX)
(hurricaneboatlifts.com)

PROPOSED 4'X154' PIER
INCL 4'X20' "L" AT TERMINUS
INCL 1200# BOAT TENDER LIFT,
PIER AND BEACH ACCESS STAIRS

~70' TO
PL EXT.

- PLE
- PLE

FLOOD

EAST PASSAGE
NARRAGANSETT BAY
CRMC TYPE 2 WATERS

AP 2, LOT 60
KJ RUDMAN TRUST
10 HOLMESTED CT
JAMESTOWN RI 02835

CRMC PIER ASSENT
A*2021-11-090

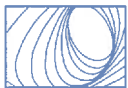

ANDERSON COASTAL
ENGINEERING LLC
(401) 742 - 2232

RECEIVED

FEB 26 2026

COASTAL RESOURCES
MANAGEMENT COUNCIL

KENNETH W. ANDERSON



REGISTERED
PROFESSIONAL ENGINEER



KWA
drawn by

1/30/26
date

HERMAN RESIDENTIAL BOATING FACILITY

4 OF 9
rev sheet

NOTED
scale

APPLICANT:
 AP 2, LOT 100
 BRAD HERMAN
 14 HOLMESTED CT
 JAMESTOWN RI 02835



REBUILD EXTG
 STAIRS INTO
 NEW PIER
 (CENTER W/IN
 10' PROP WTH)



BURDICK & SHORT HEIGHTS
 H=3.08m + .02(X)
 H=3.08m + 2(8) = 4.68m=15.4'
 H=3.08m + 2(0) = 3.08m=10.1'
 E-W MIN HT = 15.4'; N-S = 10.1'

HERMAN MOORING
 184' FROM MLW



PLAN

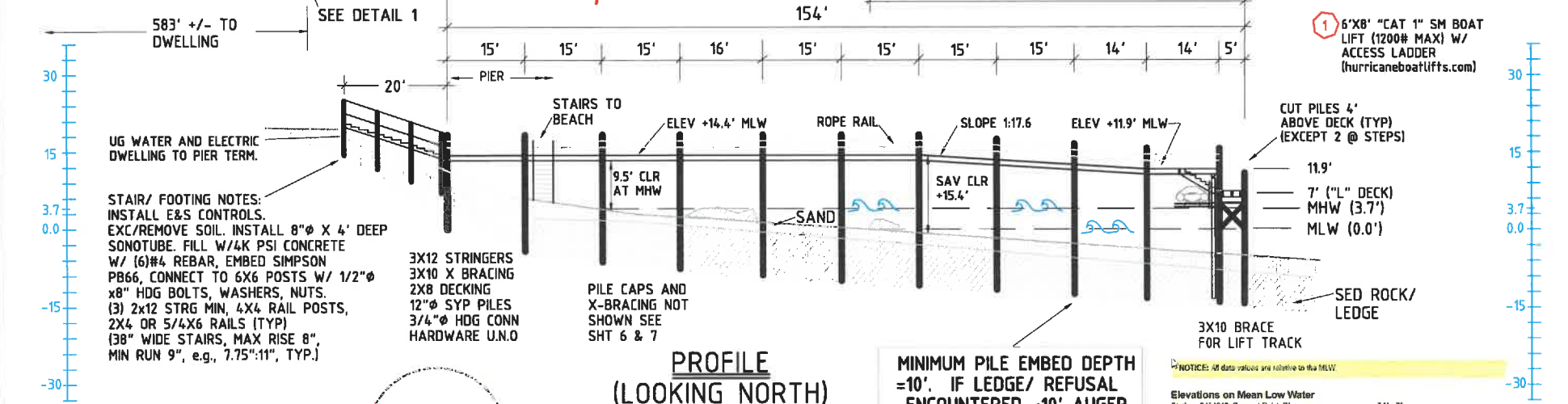

**PROFILE
 (LOOKING NORTH)**

MINIMUM PILE EMBED DEPTH = 10'. IF LEDGE/ REFUSAL ENCOUNTERED <10' AUGER PILE MINIMUM 6' INTO LEDGE. TOTAL EMBED >10'. OVER-DRILL PILE SOCKET ($\phi + 3"$), INSTALL PILE, FILL/COMPACT ANNULUS WITH NOM 1.5" ANGULAR CRUSHED STONE. IF DEPTH NOT ATTAINED CONTACT KWA FOR PLAN/ PERMIT RESOLUTION. (TYP)

NOTICE: All data values are relative to the MLW

Elevations on Mean Low Water
 Station: 0452019, Gloucester Point, RI
 Status: Accepted (May 22 2020)
 Units: Feet
 Control Station: 0452060 Newport, RI

Datum	Value	Description
MHHW	3.95	Mean Higher-High Water
MHW	3.70	Mean High Water
MTL	1.05	Mean Tide Level
MSL	1.71	Mean Sea Level
DTL	1.99	Mean Diurnal Tide Level
MLW	0.00	Mean Low Water
MLLW	-0.16	Mean Lower Low Water
NAVD83	2.08	North American Vertical Datum, of 1988
STND	-73.17	Station Datum
GT	4.10	Great Diurnal Range
MR	3.70	Mean Range of Tide

PLE = PROPERTY LINE EXTENSION
 CL = CENTER LINE



ANDERSON COASTAL
 ENGINEERING LLC
 (401) 742 - 2232

KENNETH W. ANDERSON
 No. 5063
 REGISTERED
 PROFESSIONAL ENGINEER
 1/30/26

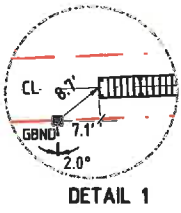

PROPOSED 4'X154' PIER
 INCL 4'X20' "L" AT TERMINUS
 INCL 1200# BOAT TENDER LIFT,
 PIER AND BEACH ACCESS STAIRS

KWA 1/30/26
 drawn by date

HERMAN RESIDENTIAL BOATING FACILITY

FEB 26 2026

5 OF 9
 rev sheet scale

COASTAL RESOURCES
 MANAGEMENT COUNCIL

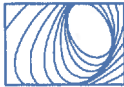

ANDERSON COASTAL
ENGINEERING LLC
(401) 742 - 2232

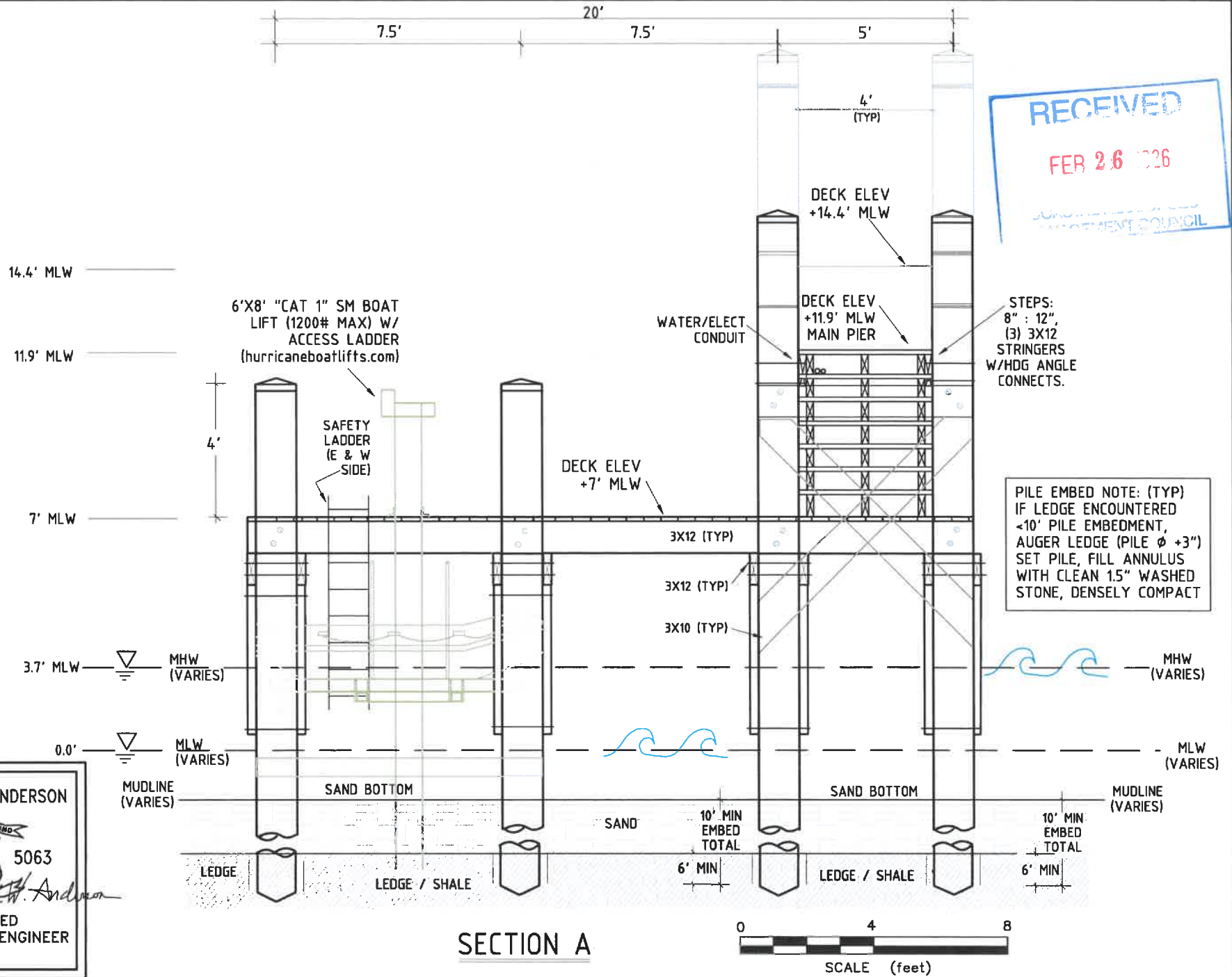

KENNETH W. ANDERSON

No. 5063

REGISTERED
PROFESSIONAL ENGINEER
1/30/26

KWA
drawn by

1/30/26
date

HERMAN RESIDENTIAL BOATING FACILITY

6 OF 9
sheet

NOTED
scale

KENNETH W. ANDERSON
 No. 5063
 REGISTERED PROFESSIONAL ENGINEER
 1/30/26

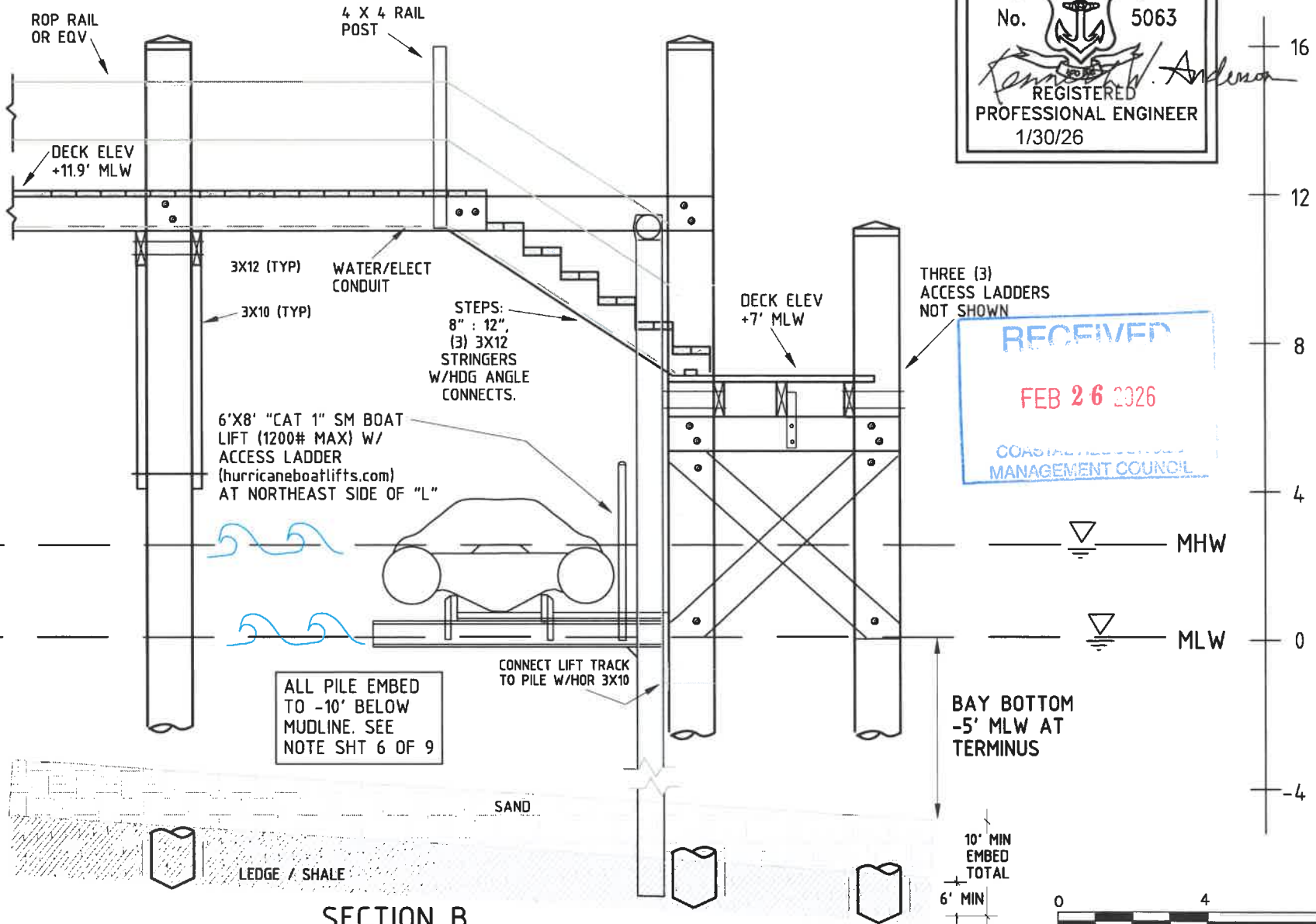
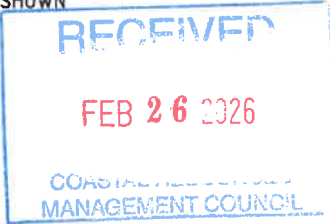

ALL PILE EMBED TO -10' BELOW MUDLINE. SEE NOTE SHT 6 OF 9

SECTION B

KWA
 drawn by

1/30/26
 date

HERMAN RESIDENTIAL BOATING FACILITY

7 OF 9
 rev sheet

NOTED
 scale

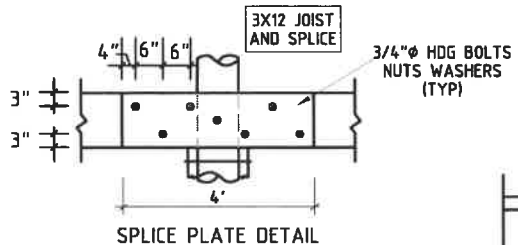

3X10 X-BRACING ALL CONNECTION
 HARDWARE HDG 3/4" DIA (MIN)
 BOLTS, NUTS, WASHERS (TYP)

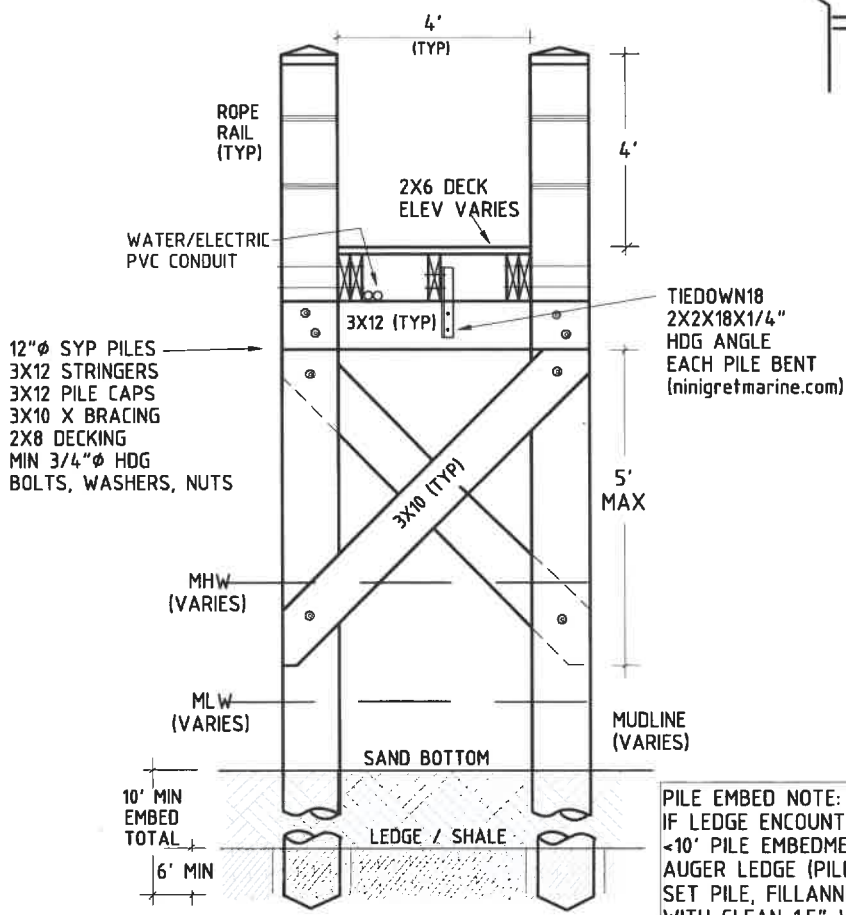
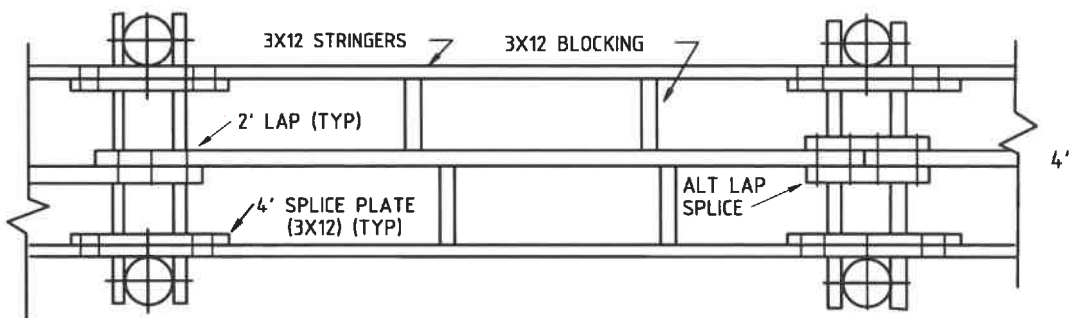

12"Ø SYP PILES
 3X12 STRINGERS
 3X12 PILE CAPS
 3X10 X BRACING
 2X8 DECKING
 MIN 3/4"Ø HDG
 BOLTS, WASHERS, NUTS

PILE EMBED NOTE: (TYP)
 IF LEDGE ENCOUNTERED
 <10' PILE EMBEDMENT
 AUGER LEDGE (PILE Ø +3")
 SET PILE, FILL ANNULUS
 WITH CLEAN 1.5" WASHED
 STONE, COMPACT

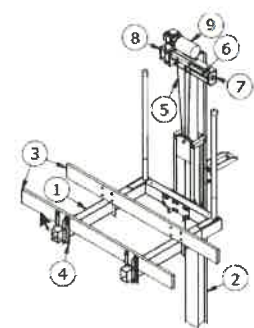

ISOMETRIC "CAT 1" SM BOAT
 LIFT (1200# MAX) (NTS)
 (hurricaneboatlifts.com)

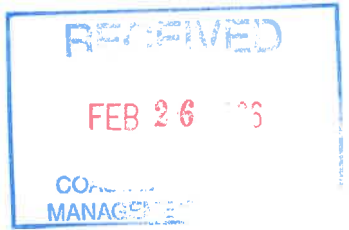

KENNETH W. ANDERSON
 No. 5063
 REGISTERED PROFESSIONAL ENGINEER

1/30/26

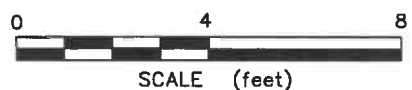

TYPICAL DETAILS



MATERIAL NOTES:

1. UNLESS NOTED OTHERWISE, ALL TIMBER MATERIAL SHALL BE SOLID SAWN LUMBER (S4S) SOUTHERN YELLOW PINE GRADE NO. 1 OR BETTER IN ACCORDANCE WITH THE TIMBER PRODUCTS INSPECTION BUREAU GRADING RULES. PILES SHALL BE SYP CLASS "B" W/STEEL DRIVING TIPS, OR GREENHEART PILES MAY BE SUB'D.
2. ALL TIMBER MATERIAL USED SHALL BE TREATED WITH MCA PRESERVATIVE SUFFICIENT FOR MARINE CONSTRUCTION (MIN. RETENTION 1.0 PCF FOR PILES AND X BRACING. MIN. 0.31 PCF FOR ALL OTHERS. DIMENSIONALLY EQUIVALENT GREENHEART TIMBER SHALL NOT REQUIRE PRESERVATIVE TREATMENT.
3. BRUSH APPLY TWO (2) COATS OF WOOD PRESERVATIVE TO SURFACE OF PRESERVATIVE TREATED MATERIALS WHICH HAVE BEEN FIELD CUT, DRESSED, OR DRILLED.
4. ALL HARDWARE INCLUDING NAILS, SCREWS, BOLTS, NUTS, AND WASHERS SHALL BE HOT-DIPPED GALVANIZED (HDG) STEEL, OR STAINLESS STEEL (TYPE 316).
5. ALL BOLTS SHALL BE ASTM A307 OR BETTER.
6. ALL CONNECTION BOLTS SHALL BE ACCOMPANIED BY APPROPRIATELY SIZED NUTS AND WASHERS.
7. COUNTER SINK AREAS WHERE HARDWARE INTERFERES WITH CONSTRUCTION OR VESSEL BERTHING AREAS.
8. NAILS SHALL BE STAINLESS STEEL W/ ANNULAR RINGED BARBED THREADS.

GENERAL CONSTRUCTION NOTES:

1. ALL WORK SHALL CONFORM TO THE STANDARDS AND REQUIREMENTS AS SHOWN IN THESE PLANS.
2. ALL WORK SHALL COMPLY WITH FEDERAL, STATE, AND LOCAL LAWS AND STATUTES AND THE REQUIREMENTS AND CONDITIONS OF ANY REGULATORY PERMITS ISSUED FOR THE WORK.
3. ALL WORK SHALL STRICTLY ADHERE TO ALL STIPULATIONS CONTAINED IN RICRMC/ACOE PERMIT, AND THE RISBC, WHERE APPLICABLE.
4. THE CONTRACTOR SHALL BE RESPONSIBLE FOR BRINGING ALL ELEMENTS OF THE PROJECT INTO CONFORMANCE WITH THESE PLANS AND SPECIFICATIONS. ANY DEVIATION FROM THESE APPROVED PLANS SHALL BE SUBMITTED IN WRITING TO THE ENGINEER FOR APPROVAL AND PERMIT MODIFICATION.
5. ALL OSHA SAFETY REGULATIONS ALL TO STRICTLY ADHERED TO. METHODS OF CONSTRUCTION AND ERECTION OF STRUCTURAL MATERIAL ARE THE RESPONSIBILITY OF THE CONTRACTOR.
6. THE CONTRACTOR SHALL BE RESPONSIBLE FOR TRANSPORTING ALL EQUIPMENT, PERSONNEL, AND MATERIALS ASSOCIATED WITH THE PROJECT TO/FROM THE SITE AS NEEDED DURING THE DURATION OF THE PROJECT.
7. THE CONTRACTOR SHALL MAINTAIN STRICT EROSION AND SEDIMENTATION CONTROLS FOR ALL UPLAND ELEMENTS OF THE PROJECT. ALL EXCAVATED AREAS SHALL BE PROTECTED AS NECESSARY TO PREVENT OFF-SITE MIGRATION OF SEDIMENTS.
8. THE CONTRACTOR SHALL MAINTAIN STRICT IN-WATER TURBIDITY CONTROLS DUE TO CONSTRUCTION OF THE NEW BOATING FACILITY.
9. ALL TIMBER PILE EMBEMENT DEPTHS SHOWN ON THE PLANS SHALL BE THE MINIMUM. IF REFUSAL IS ENCOUNTERED PRIOR TO MINIMUM, THE ENGINEER SHALL BE CONTACTED FOR APPROPRIATE RESOLUTION.
10. CONTRACTOR SHALL MAINTAIN RECORD OF ALL PILE EMBEDMENT DEPTHS AND PROVIDE TO ENGINEER.



UTILITY NOTES:

1. CONTRACTOR TO EXTEND WATER AND ELECTRIC SERVICE FROM DWELLING TO PIER TERMINUS.
2. ALL UTILITY WORK SHALL BE PERFORMED BY LICENSED CONTRACTORS IN ACORDANCE WITH ALL LOCAL AND STATE CODES.
3. ELECTRICAL WIRING SHALL BE ENCASED IN MARINE GRADE (SCH 80 MIN) PVC CONDUIT WITH DOUBLE RECEPTACLE AT TERMINUS.
4. WATER LINE: INSTALL 3/4" POLYETHYLENE TUBING WITH BACKFLOW PREVENTER AT DWELLING, DRAIN LINE AND SPIGOT AT PIER HEAD.
5. UTILITY LINES FROM DWELLING SHALL BE BURIED 12" MIN BELOW GRADE AND SECURED AT UNDERSIDE OF PIER WITH HDG OR SS FASTENERS 4' C-C.



KENNETH W. ANDERSON

No. 5063

Kenneth W. Anderson

REGISTERED PROFESSIONAL ENGINEER

1/30/26

HERMAN RESIDENTIAL BOATING FACILITY

14 HOLMESTED COURT
JAMESTOWN RI 02835

by	KWA	scale	N/A
date	1/30/26	sheet	9 OF 9