



State of Rhode Island
Coastal Resources Management Council
Oliver H. Stedman Government Center
4808 Tower Hill Road, Suite 3
Wakefield, RI 02879-1900

(401) 783-3370
Fax (401) 783-2069

PUBLIC NOTICE

File Number: 2026-05-074 Date: June 2, 2026

This office has under consideration the application of:

Jeffrey & Anne Swinney
Bristol, RI 02809

for a State of Rhode Island Assent to construct and maintain: A residential boating facility consisting of an upland ramp, a 4'x98' fixed timber pier, 4'x6' timber landing, 3'x 20' aluminum gangway and 10'x15' (150sf) terminal float. The facility will extend 75' from the cited MLW mark, requiring a 25' length variance to Redbook 650-RICR-20-00-01 Section 1.3. 1(D)(11)(l).

Project Location:	35 Brookwood Road
City/Town:	Bristol
Plat/Lot:	Plat 79, lot 485
Waterway:	II, Low Intensity Use, Narragansett Bay

Plans of the proposed work can be requested at Cstaff1@crmc.ri.gov.

In accordance with the Administrative Procedures Act (Chapter 42-35 of the Rhode Island General Laws) you may request a hearing on this matter.

You are advised that if you have good reason to enter protests against the proposed work it is your privilege to do so. It is expected that objectors will review the application and plans thoroughly, visit site of proposed work if necessary, to familiarize themselves with the conditions and cite what law or laws, if any, would in their opinion be violated by the work proposed.

If you desire to protest, you must attend the scheduled hearing and give sworn testimony. A notice of the time and place of such hearing will be furnished you as soon as possible after receipt of your request for hearing. If you desire to request a hearing, to receive consideration, it should be in writing (**with your correct mailing address, e-mail address and valid contact number**) and be received at this office on or before **July 2, 2026**.

Please email your comments/hearing requests to: cstaff1@crmc.ri.gov; or mail via USPS to: Coastal Resources Management Council; O. S. Government Center, 4808 Tower Hill Road, Rm 116; Wakefield, RI 02879.

/lat

C:\Users\pnc\pnc\Engineering\Dropbox\Dock Design\DD-2025-3_35 Brookwood Road_Bristol_Dock Design_MONOPILES 5.7.26.dwg, 5/6/2026 2:53:31 PM, DWG To PDF.pc3

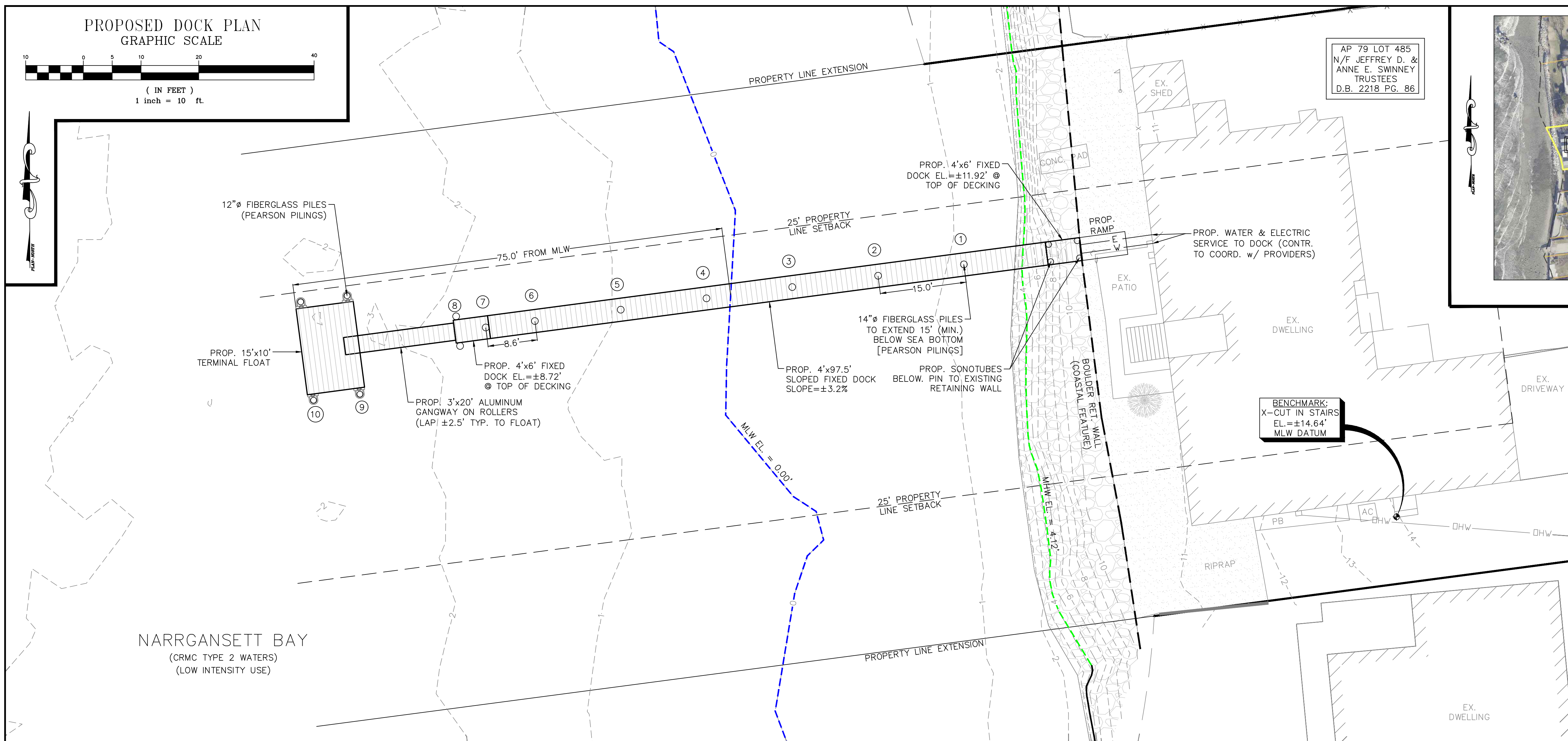

SITE LOCUS NOT TO SCALE

SURVEY NOTE:
 1.) EXISTING CONDITIONS AND BATHYMETRY TAKEN FROM PRINCIPLE COMPANY - SURVEYING DIVISION (DATE: 03/31/2026)

DOCK COVERAGE:
 PROPOSED FIXED DOCK: ±438 S.F.
 PROPOSED GANGWAY: ±60 S.F.
 PROPOSED FLOATING DOCK: ±150 S.F.

PLAN NOTE:
 ALL CONSTRUCTION ACCESS WILL COME FROM THE WATER SIDE OF THE SITE. NO STOCKPILES WILL BE LOCATED ON LAND.

VARIANCE NOTE:
 THE FOLLOWING IS A LIST OF ITEMS THAT DO NOT MEET THE CRMC RULES & REGULATIONS DUE TO THE SITE CONSTRAINTS OF THE SUBJECT PROPERTY AND REQUIRE RELIEF:

- 1.) 50' DOCK LENGTH FROM MLW
 75' PROVIDED TO ACHIEVE GREATER SEPARATION FROM SEA BOTTOM

FEMA NOTE:
 THIS SITE IS LOCATED IN FLOOD ZONE VE (EL=16) [NAVD-88 DATUM] PER FIRM PANEL #44001C0010H - EFFECTIVE DATE: 07/07/2014

TIDAL STATION 8452154
 BRISTOL HIGHLANDS, R.I.
 PUBLICATION DATE 12-30-2015

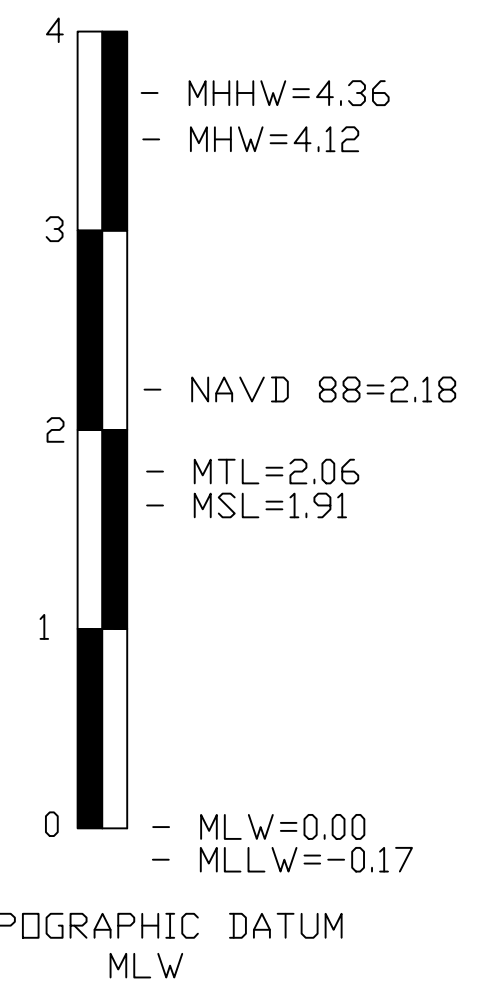

LEGEND

- PROPERTY LINE
- EXISTING CONTOUR
- EDGE OF MLW / MHW
- PROPOSED DOCK DECKING
- PROPOSED EDGE OF DOCK

DRAWING ISSUE:

- CONCEPT
- CUSTOMER APPROVAL
- PERMITTING
- CONSTRUCTION
- AS-BUILT
- OTHER:

ONLY PLANS ISSUED FOR CONSTRUCTION SHALL BE USED FOR CONSTRUCTION

OWNER/APPLICANT
 JEFFREY D. & ANNE E. SWINNEY

REGISTERED PROFESSIONAL ENGINEER
 Thomas J. Principe, III

PRINCIPLE COMPANY, INC.
 ENGINEERING DIVISION
 27 SAKONNET RIDGE DRIVE
 TIVERTON, RI 02878
 401.816.5385
 WWW.PRINCIPLECOMPANY.COM

PLAN VIEW

TOPOGRAPHIC DATUM
 MLW

REGISTERED PROFESSIONAL ENGINEER
 Thomas J. Principe, III

REVISIONS

No.	DATE	DRWN	CHKD

NEW DOCK PLANS
 for
AP 79 LOT 485
35 BROOKWOOD ROAD
 in
BRISTOL, RHODE ISLAND

SCALE: AS NOTED SHEET NO: 1 OF 3
 DRAWN BY: CTH DESIGN BY: BRM CHECKED BY: TJP
 DATE: 05/08/2026 PROJECT NO.: DD-2025-3

